

SHARP SERVICE MANUAL

No. S58J8LC46XL2E

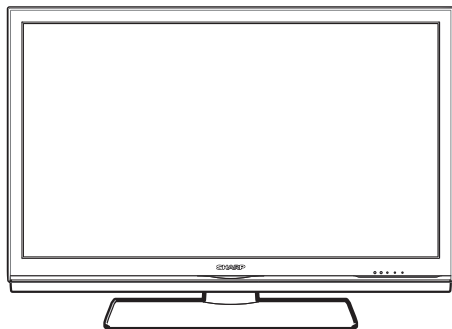

SUPPLEMENT

LCD COLOUR TELEVISION

MODEL LC-46XL2E/S/RU

In the interests of user-safety (Required by safety regulations in some countries) the set should be restored to its original condition and only parts identical to those specified should be used.

OUTLINE

For this model, the LCD panel module has been changed.

When servicing the product, use this manual with the service manual LC-46XL2E/S/RU (S8707LC42XL2E) already issued.

The previous LCD panel models and the new model can be identified with the following markings.

- The B character is added at the end of the model name on the model label.
- The B character is also added at the end of the model name on the number label (barcode label) of the packing case.

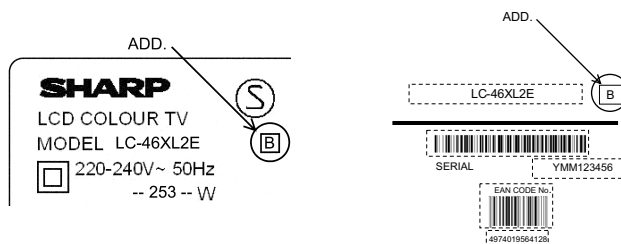

- The serial product numbers are 806011112 and on.

CONTENTS

OUTLINE AND MODIFIED PARTS

OUTLINE.....	i
MODIFIED PARTS.....	i

SAFETY PRECAUTION

IMPORTANT SERVICE SAFETY PRE-CAUTION.....	ii
Precautions for using lead-free solder	iii

Parts Guide

Parts marked with "⚠" are important for maintaining the safety of the set. Be sure to replace these parts with specified ones for maintaining the safety and performance of the set.

OUTLINE AND MODIFIED PARTS

OUTLINE

For this model, the LCD panel module has been changed.

When servicing the product, use this manual with the service manual LC-46XL2E/S/RU (S87O7LC42XL2E) already issued.

The previous LCD panel models and the new model can be identified with the following markings.

- The **[S]** character is added at the end of the model name on the model label.
- The **[B]** character is also added at the end of the model name on the number label (barcode label) of the packing case.

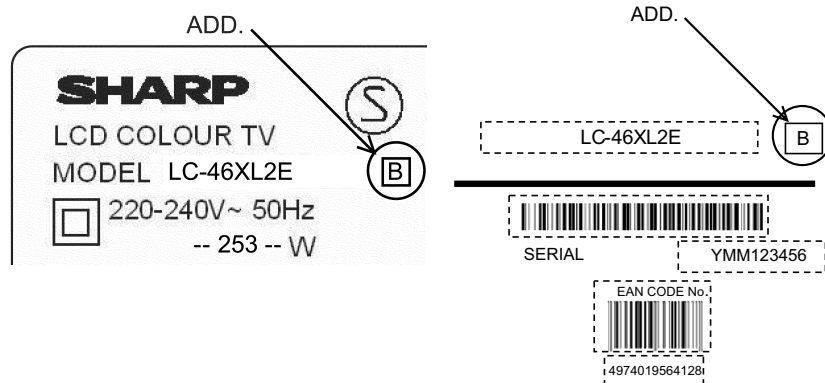

- The serial product numbers are 806011112and on.

MODIFIED PARTS

Ref.No.	Description	No. (Base Models)	No. (This Model)	Remarks
PRINTED WIRING BOARD ASSEMBLIES				
Refer to Parts List				
N	MAIN Unit	DUNTKE186FM01	DUNTKE186FM01	No Change
N	TERMINAL Unit	DUNTKE187FM01	DUNTKE187FM01	No Change
N	R/C, LED Unit	DUNTKE264FM01	DUNTKE264FM01	No Change
N	KEY Unit	DUNTKE266FM01	DUNTKE266FM01	No Change
N	MIN IAV Unit	DUNTKE188FM01	DUNTKE188FM01	No Change
N	ILLUMINATION Unit	DUNTKE270FM01	DUNTKE270FM01	No Change
N	POWER Unit (Unit Replacement Item)	RDENCA231WJQZ	RDENCA231WJQZ	No Change
N	AC INLET Unit (Unit Replacement Item)	RUNTKA311WJQZ	RUNTKA311WJQZ	No Change
N	LCD CONTROL Unit	CPWBY3821TPXK	CPWBY3893TPXA	Change
N	INVERTER Unit A	RUNTKA323WJZZ	RUNTKA387WJZZ	Change
N	INVERTER Unit B	RUNTKA324WJZZ	RUNTKA388WJZZ	Change
N	INVERTER Unit C	RUNTKA325WJZZ	RUNTKA389WJZZ	Change
N	INVERTER Unit D	RUNTKA326WJZZ	RUNTKA390WJZZ	Change
LCD PANEL				
N	46" Full HD LCD Panel Module	R1LK460D3LZ60Y	R1LK460D3LZ6DY	Change
Refer to the part list for detailed information.				
CABINET PARTS				
Refer to Parts List				
SUPPLIED ACCESSORIES				
Refer to Parts List				
PACKING PARTS				
No Change				
Service Jigs				
No Change				

SAFETY PRECAUTION

IMPORTANT SERVICE SAFETY PRECAUTION

■ **Service work should be performed only by qualified service technicians who are thoroughly familiar with all safety checks and the servicing guidelines which follow:**

■ WARNING

1. For continued safety, no modification of any circuit should be attempted.
2. Disconnect AC power before servicing.

CAUTION:
 FOR CONTINUED PROTECTION AGAINST A RISK OF FIRE REPLACE ONLY WITH SAME TYPE FUSE.
 F7000 (6.3A/250V)

■ BEFORE RETURNING THE RECEIVER (Fire & Shock Hazard)

Before returning the receiver to the user, perform the following safety checks:

3. Inspect all lead dress to make certain that leads are not pinched, and check that hardware is not lodged between the chassis and other metal parts in the receiver.
4. Inspect all protective devices such as non-metallic control knobs, insulation materials, cabinet backs, adjustment and compartment covers or shields, isolation resistor-capacitor networks, mechanical insulators, etc.
5. To be sure that no shock hazard exists, check for leakage current in the following manner.
 - Plug the AC cord directly into a 220~240 volt AC outlet.
 - Using two clip leads, connect a 1.5k ohm, 10 watt resistor paralleled by a 0.15μF capacitor in series with all exposed metal cabinet parts and a known earth ground, such as electrical conduit or electrical ground connected to an earth ground.

- Use an AC voltmeter having with 5000 ohm per volt, or higher, sensitivity or measure the AC voltage drop across the resistor.
- Connect the resistor connection to all exposed metal parts having a return to the chassis (antenna, metal cabinet, screw heads, knobs and control shafts, escutcheon, etc.) and measure the AC voltage drop across the resistor.

All checks must be repeated with the AC cord plug connection reversed. (If necessary, a nonpolarized adaptor plug must be used only for the purpose of completing these checks.)

Any reading of 1.05 V peak (this corresponds to 0.7 mA peak AC.) or more is excessive and indicates a potential shock hazard which must be corrected before returning the monitor to the owner.

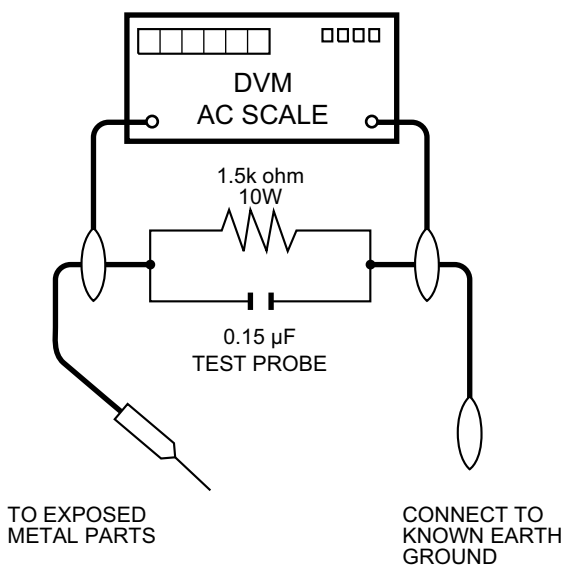

SAFETY NOTICE

Many electrical and mechanical parts in LCD color television have special safety-related characteristics.

These characteristics are often not evident from visual inspection, nor can protection afforded by them be necessarily increased by using replacement components rated for higher voltage, wattage, etc.

Replacement parts which have these special safety characteristics are identified in this manual; electrical components having such features are identified by “⚠” and shaded areas in the Replacement Parts List and Schematic Diagrams.

For continued protection, replacement parts must be identical to those used in the original circuit.

The use of a substitute replacement parts which do not have the same safety characteristics as the factory recommended replacement parts shown in this service manual, may create shock, fire or other hazards.

Precautions for using lead-free solder

■Employing lead-free solder

- “PWBs” of this model employs lead-free solder. The LF symbol indicates lead-free solder, and is attached on the PWBs and service manuals. The alphabetical character following LF shows the type of lead-free solder.

Example:



Indicates lead-free solder of tin, silver and copper.



Indicates lead-free solder of tin, silver and copper.

■Using lead-free wire solder

- When fixing the PWB soldered with the lead-free solder, apply lead-free wire solder. Repairing with conventional lead wire solder may cause damage or accident due to cracks.

As the melting point of lead-free solder (Sn-Ag-Cu) is higher than the lead wire solder by 40 °C, we recommend you to use a dedicated soldering bit, if you are not familiar with how to obtain lead-free wire solder or soldering bit, contact our service station or service branch in your area.

■Soldering

- As the melting point of lead-free solder (Sn-Ag-Cu) is about 220 °C which is higher than the conventional lead solder by 40 °C, and as it has poor solder wettability, you may be apt to keep the soldering bit in contact with the PWB for extended period of time. However, Since the land may be peeled off or the maximum heat-resistance temperature of parts may be exceeded, remove the bit from the PWB as soon as you confirm the steady soldering condition.

Lead-free solder contains more tin, and the end of the soldering bit may be easily corroded. Make sure to turn on and off the power of the bit as required.

If a different type of solder stays on the tip of the soldering bit, it is alloyed with lead-free solder. Clean the bit after every use of it.

When the tip of the soldering bit is blackened during use, file it with steel wool or fine sandpaper.

- Be careful when replacing parts with polarity indication on the PWB silk.

Lead-free wire solder for servicing

Part No.	★	Description	Code
ZHNDai123250E	J	φ0.3mm 250g (1roll)	BL
ZHNDai126500E	J	φ0.6mm 500g (1roll)	BK
ZHNDai12801KE	J	φ1.0mm 1kg (1roll)	BM

SHARP PARTS GUIDE

No. S58J8LC46XL2E

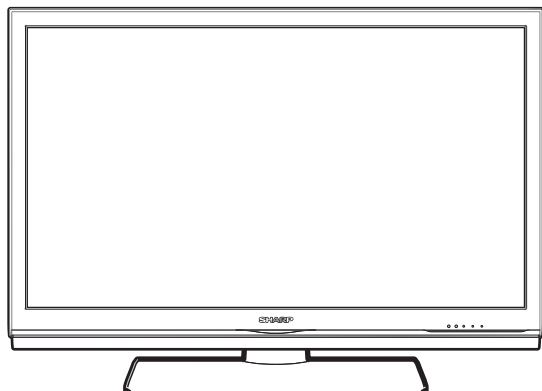

LCD COLOUR TELEVISION

MODEL LC-46XL2E/S/RU

CONTENTS

[1] CABINET PARTS

[3] SUPPLIED ACCESSORIES

[2] LCD MODULE Assembly

Parts marked with "△" are important for maintaining the safety of the set. Be sure to replace these parts with specified ones for maintaining the safety and performance of the set.

[1] CABINET PARTS

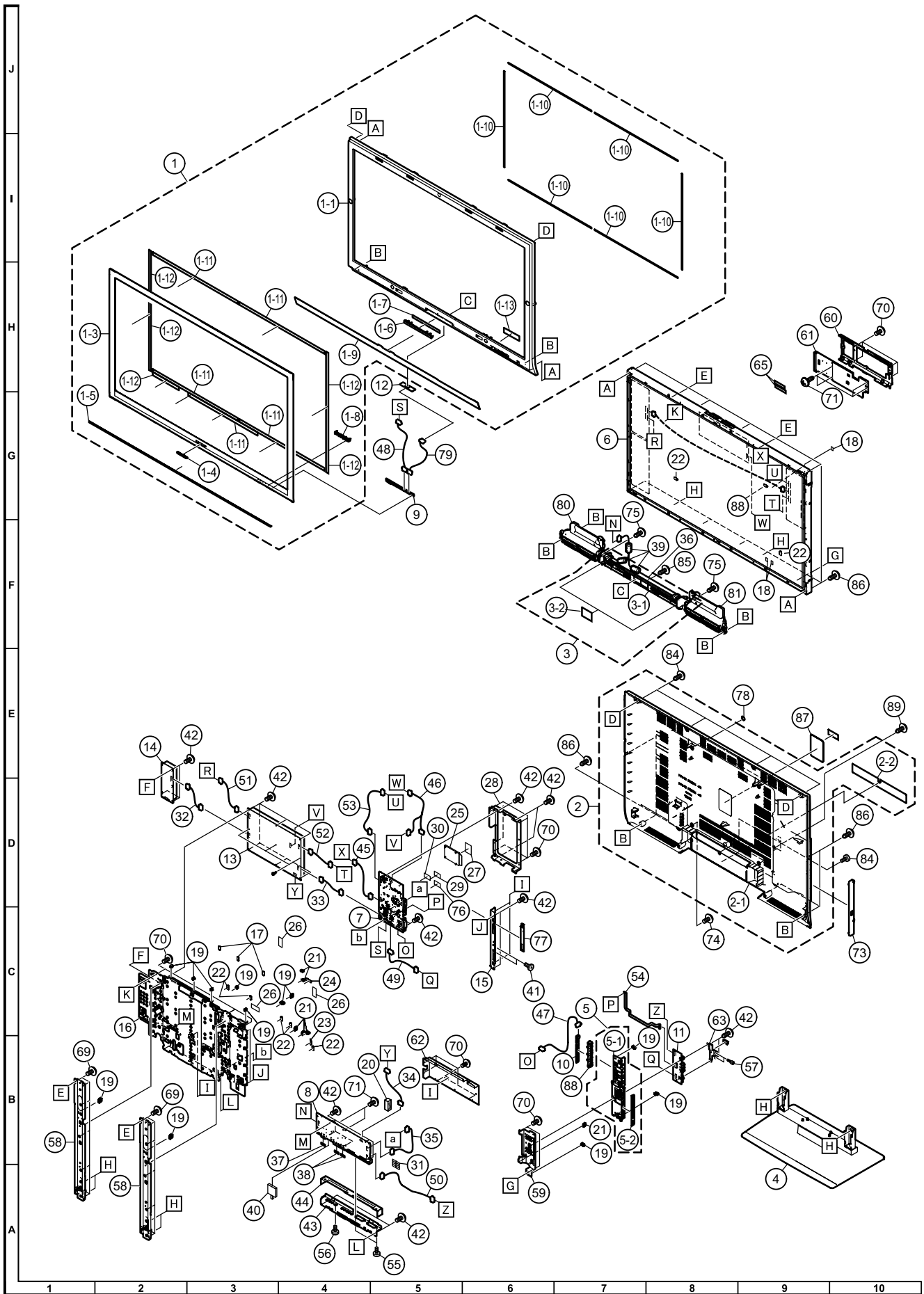

NO.	PARTS CODE	PRICE RANK	NEW MARK	PART DELIVERY	DESCRIPTION
[1] CABINET PARTS					
1	CCABAB818WJ11	CE	N	P	Front Cabinet Ass'y
1-1	Not Available	-	N	-	Front Cabinet
1-3	Not Available	-	N	-	Front Cover
1-4	HBDGBA061WJSA	AF		J	Sharp Badge
1-5	Not Available	-		-	Shine Trim
1-6	Not Available	-	N	-	Center Dec Holder
1-7	Not Available	-	N	-	Front Dec
1-8	Not Available	-	N	-	LED Decoration
1-9	Not Available	-	N	-	SP Sheet
1-10	Not Available	-	N	-	Mask Himeron, x6
1-11	Not Available	-	N	-	Front Cover Tape, x5
1-12	Not Available	-	N	-	Front Cover Tape, x5
1-13	PSPA2B624WJZZ	AA	N	P	Spacer
2	CCABBB100WJ11	BT	N	P	Rear Cabinet Ass'y
2-1	Not Available	-	N	-	Rear Cabinet
2-2	Not Available	-	N	-	Terminal Label
3	CCOVAC336WJ11	AY	N	P	Bottom Cover Ass'y
3-1	Not Available	-		-	Bottom Cover F
3-2	PSPAHB307WJZZ	AA		P	Bottom Cover SPD, x2
4	CDAI-A397WJ12	AQ	N	P	Stand Ass'y
5	CCOVAC748WJ12	AU		P	MINI AV Key Cover Ass'y
5-1	Not Available	-	N	-	Side Key Cover
5-2	Not Available	-	S	-	MINI Terminal Label
6	R1LK460D3LZ6DY		N	J	46" Full HD LCD Panel Module
7	DUNTKE186FM01	CT	N	R	MAIN Unit
8	DUNTKE187FM01	BY	N	R	TERMINAL Unit
9	DUNTKE264FM01	AS	N	R	R/C, LED Unit
10	DUNTKE266FM01	AR		R	KEY Unit
11	DUNTKE188FM01	BD		R	MINI AV Unit
12	DUNTKE270FM01	AS	N	R	ILLUMINATION Unit
13	RDENCA231WJQZ	BZ	N	R	POWER Unit
14	RUNTKA311WJQZ	BA	N	R	AC Inlet Unit
15	LANGKB173WJ1A	AN	N	R	Side Terminal Angle
16	LCHSMA429WJFW	AX	N	R	Chassis Tray
17	LHLDFA036WJKZ	AB	-	J	Wire Holder (Tray), x3
18	LHLDWA133WJKZ	AC	N	J	Wire Holder (Tray), x4
19	LHLDWA143WJKZ	AC	-	J	Wire Holder (Tray), x12
20	LHLDWA144WJKZ	AC	N	R	Wire Holder (Terminal PWB)
21	LHLDWA151WJKZ	AB	-	J	Wire Holder (Tray), x6
22	LHLDWA163WJKZ	AC	-	J	Wire Holder (Tray), x4
23	LHLDWA172WJKZ	AD	-	R	Wire Holder (Tray)
24	PMLT-A487WJZZ	AD	N	R	Gasket (10x30x7)
25	PRDARA482WJ1W	AV	N	R	Main Radiator
26	PSLDMA702WJZZ	AD	-	R	Conductiv Shield (10x20), x5
27	PSLDMB154WJQZ	AD	-	J	13x30x10 Gasket, x2
28	PSLDMB327WJFW		N	R	Main Shiled
29	PSPA2B312WJKZ	AD	N	J	Spacer (25*25 T2.0)
30	PSPA2B313WJKZ	AC	-	J	Spacer (20*20 T2.0)
31	QCNCMA673WJZZ	AG	N	J	Connector (B_To_B Plug_80)
32	QCNCW-F946WJQZ	AH	N	R	Connecting Cord (AC:POWERAC)
33	QCNCW-G634WJQZ	AN	N	R	Connecting Cord (PD:MAINPOWER)
34	QCNCW-F948WJQZ	AK	N	R	Connecting Cord (PE:TERMINPOWER)
35	QCNCW-G419WJQZ	AP	N	R	Connecting Cord (FE:MAINTERMINA)
36	QCNCW-G015WJQZ	AL	N	R	Connecting Cord (SP:TERMINALSP)
37	QEARZA108WJFW	AE	N	R	Earth Plate(L)
38	QEARZA109WJFW	AD	N	R	Earth Plate(S), x2
39	RCORFA023WJZZ	AK		J	Core (for SP Wire), x3
40	RTUDAA014WJQZ	AZ	N	R	Tuner
41	XBPS830P06000	AA	-	J	Screw, x2 (FOR HDMI)
42	XJPS730P08WS0	AA	-	J	Screw, x32 (Main Pow Termin)
43	LANGKB175WJ1A	AL		P	Terminal Angle Bottom
44	LANGKB248WJFW	AE		P	Scart Angle
45	QCNCW-F950WJQZ	BD		R	Connecting Cord (LW:MAINLCDCTL)
46	QCNCW-F968WJQZ	AH		R	Connecting Cord (PL:POWERLCDCTL)
47	QCNCW-G010WJQZ	AG		R	Connecting Cord (KM:MAINKEY)
48	QCNCW-G011WJQZ	AH		P	Connecting Cord (RA:MAINLED)
49	QCNCW-G013WJPZ	AN		P	Connecting Cord (US:MAINMINI AV)
50	QCNCW-G014WJQZ	AS		R	Connecting Cord (VD:SUBMINI AV)
51	QCNCW-G016WJQZ	AH		R	Connecting Cord (LA1:POWERINV_R)
52	QCNCW-G017WJQZ	AH		R	Connecting Cord (LA2:POWER-INV_L)
53	QCNCW-G018WJQZ	AH		R	Connecting Cord (LB:MAININV)
54	QPWBHE322WJQZ	AX		J	FPC (HM:MAINMINI AV)
55	XBBS830P08000	AA		J	Screw (for Scart), x2
56	XBBS930P04000	AA		J	Screw (for Tuner Fix), x1
57	XiPSN20P04000	AA	N	J	Screw (for HDMI), x2
58	LANGKB186WJ1W	AT	N	P	Panel Support Ang, x2
59	LANGKB215WJ1W	AM	N	P	MINI AV Angle
60	PCOV2605WJZZ	AM	N	J	Control Shield
61	PRDARA513WJFW	AX	N	R	Heat Sink
62	PSLDMB159WJ1W	AH	N	P	AV Shield
63	PSLDMB179WJ1W	AD	N	P	MINI AV Shield
65	PSPA2B611WJKZ	AN	N	R	Sheet (10x50x7.5), x2
69	XBBS740P08000	AA		J	Screw (for Center Ang), x14
70	XBBS830P06000	AA		J	Screw (Mini av,Tay,Ctl), x18
71	XBPS730P04WS0	AA		J	Screw (for Heat Sink), x4

NO.	PARTS CODE	PRICE RANK	NEW MARK	PART DELIVERY	DESCRIPTION
[1] CABINET PARTS					
73	GCOVAC356WJ1A	AY	N	P	Side AV Cover
74	LX-BZA170WJF9	AC		S	Screw (for Rear Cabinet), x2
75	LX-HZA003WJFN	AC		J	Screw (for SP), x2
76	PCOVZA105WJKZ	AE		P	CI Card Cover (Spacer)
77	PSHEPA541WJZZ	AD		P	Terminal Sheet
78	PSHEPA543WJZZ	AA	S	P	Sheet for Boss, x2
79	QCNW-G012WJQZ	AE	N	P	Connecting Cord (IL:LEDILLU)
80	RSP-ZA347WJZZ	AY	N	P	Speaker L
81	RSP-ZA348WJZZ	AY	N	P	Speaker R
84	XBPS740P10JS0	AA		P	Screw (for Rear Cabinet), x7
85	XEBS930P10000	AA		J	Screw (for Bottom Cover), x1
86	XEBS940P16000	AB		J	Screw (for Rear Cabinet), x14
87	TLABNC117WJZZ	AC		S	Model Label
88	JBTN-A676WJ1A	AH		P	Control Button
89	LX-BZA214WJ00	AC		P	Plastic Screw

[2] LCD MODULE Assembly

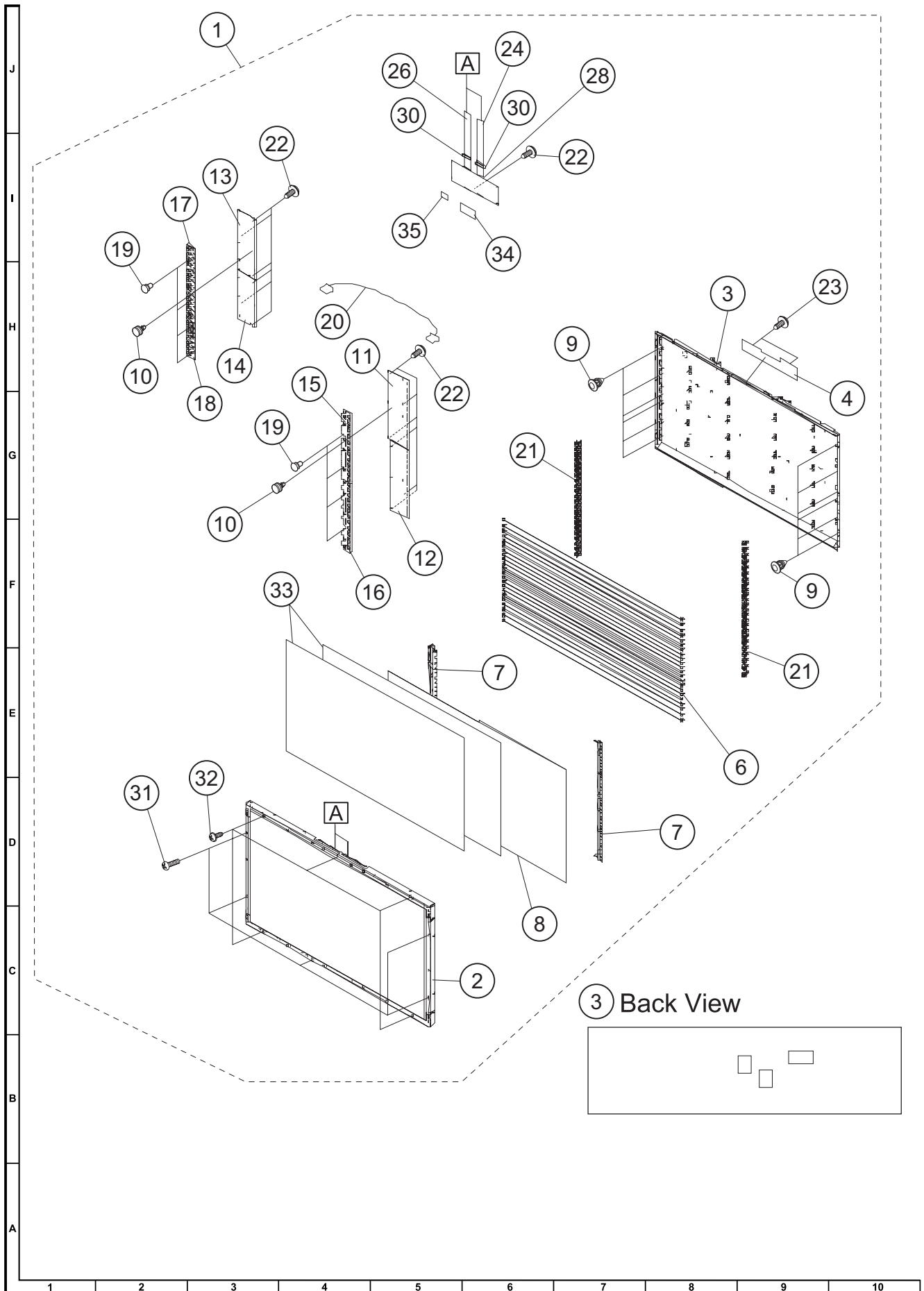

NO.	PARTS CODE	PRICE RANK	NEW MARK	PART DELIVERY	DESCRIPTION
[2] LCD MODULE Assembly					
1	R1LK460D3LZ6DY		N	J	46" Full HD LCD Panel Module
2	Not Available	-		-	Bezel Ass'y
3	CCHSM0030TP07		N	J	BL Chassis Ass'y
4	LANGTA468WJFW	AE		J	Ferrite Core Angle
6	RLMPLA012WJN1	AS		J	Lamp, x22
7	LHLDZ3764TPZZ	AL		J	Lamp Holder, x2
8	PCOVUA113WJZZ	BA		J	Diffusion Plate
9	LHLDFA035WJKZ	AB		J	INVERTER Spacer, x12 (for BL Chassis)
10	PSPAzb030WJKZ	AB		J	INVERTER Spacer, x2 (for Connector)
11	RUNTKA387WJZZ	BF		J	INVERTER Unit A
12	RUNTKA388WJZZ	BF		J	INVERTER Unit B
13	RUNTKA389WJZZ	BF		J	INVERTER Unit C
14	RUNTKA390WJZZ	BF		J	INVERTER Unit D
15	PCOVPA087WJKZ	AG		J	Invasion Prevention Cover A
16	PCOVPA088WJKZ	AG		J	Invasion Prevention Cover B
17	PCOVPA089WJKZ	AG		J	Invasion Prevention Cover C
18	PCOVPA090WJKZ	AG		J	Invasion Prevention Cover D
19	LX-LZA105WJZZ	AB		J	Push Rivet, x8
20	QCNW-G150WJQZ	AP		J	Cable
21	QSOCFA002WJZZ	AD		J	Socket, x44
22	LX-BZA207WJF7	AA		J	Screw, x13 (for INVERTER Unit, LCD CONTROL Unit)
23	XBPS730P06WS0	AA		J	Screw, x2 (for Ferrite Core Angle)
24	QPWBM0566TPZZ	AG		J	CS-FPC
26	QPWBM0574TPZZ	AG		J	CS-FPC
28	CPWBY3893TPXA	CE	N	J	LCD CONTROL Unit
30	RCORFA061WJZZ	AG		J	Ferrite Core, x2
31	LX-BZA196WJF7	AB		J	Screw, x7 (for BL Chassis)
32	LX-BZA216WJF7	AC		J	Screw, x3 (for BL Chassis)
33	PSHEPA659WJZZ	AY		J	Diffusion Sheet, x2
34	PSHEP2933TPZZ	AP		J	Heat Radiation Sheet
35	PSHEP2934TPZZ	AH		J	Heat Radiation Sheet

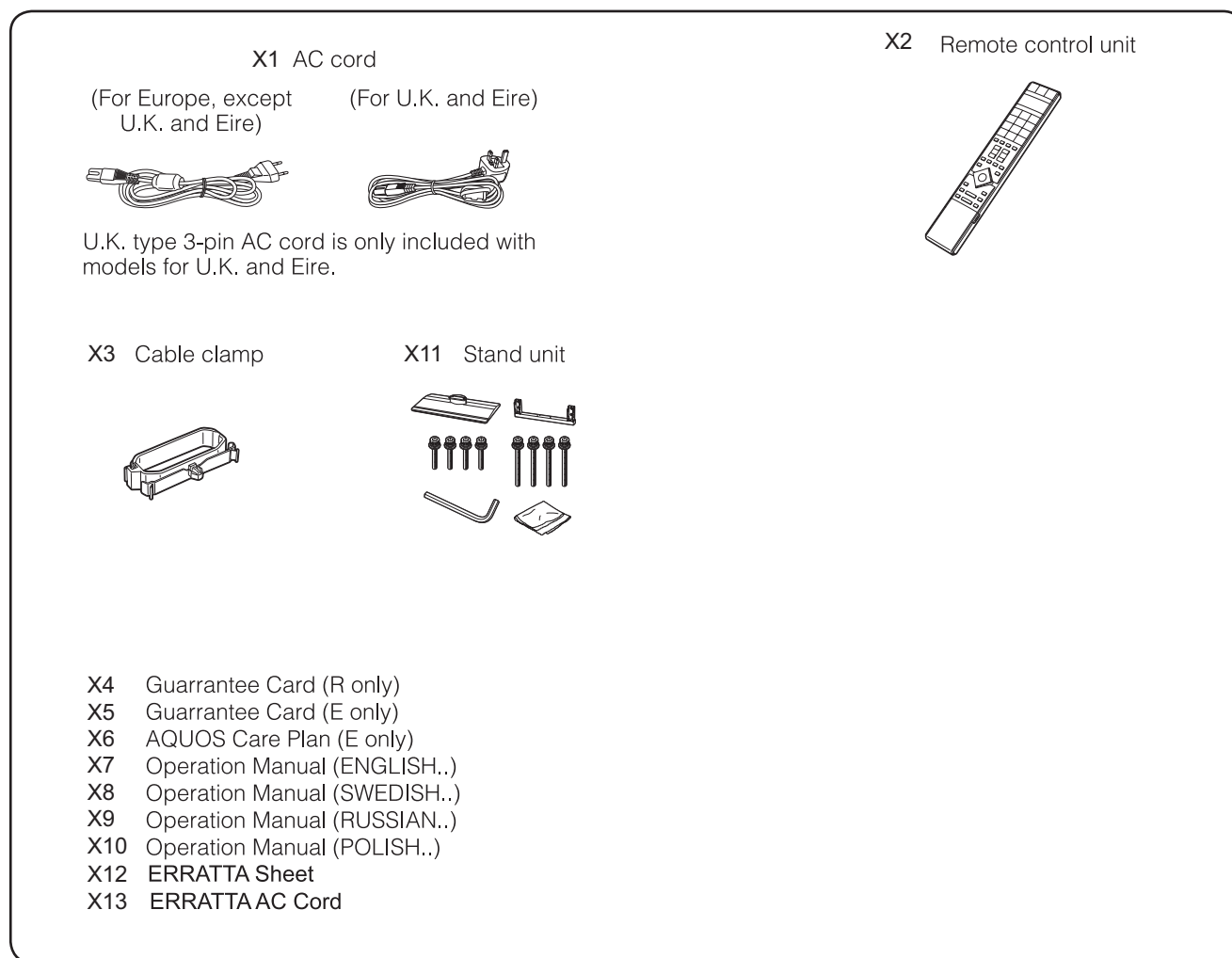
[3] SUPPLIED ACCESSORIES

NO.	PARTS CODE	PRICE RANK	NEW MARK	PART DELIVERY	DESCRIPTION
[3] SUPPLIED ACCESSORIES					
X1	QACCB A073WJPZ	AV		J	AC Cord (for UK and Eire)
X1	QACCKA021WJPZ	AT		S	AC Cord (for Europe without UK and Eire)
X2	RRMCGA585WJSA	BS	N	P	Remote Control Unit
X3	LHLDWA173WJKZ	AE	N	R	Cable Clamp
X4	TGAN-A077WJZZ	AE		P	Guarrantee Card (RU only)
X5	TGAN-A801WJZZ	AB		P	Guarrantee Card (E only)
X6	TGAN-A802WJZZ	AC		P	AQUOS Care Plan (E only)
X7	TINS-D177WJN1	AQ	N	P	Operation Manual (ENGLISH..)
X8	TINS-D178WJN1	AQ	N	P	Operation Manual (SWEDISH..)
X9	TINS-D179WJN1	AH	N	P	Operation Manual (RUSSIAN..)
X10	TINS-D180WJN1	AS	N	P	Operation Manual (POLISH..)
X11	CDAi-A397WJ12	AQ	N	P	Stand Ass'y
X12	TCAUHA337WJZZ	AA	N	P	ERRATTA Sheet (E/S)
X12	TCAUHA338WJZZ	AA	N	P	ERRATTA Sheet (RU)
X13	TCAUZA321WJZZ		N	P	ERRATA AC Cord

SHARP

COPYRIGHT © 2008 BY SHARP CORPORATION

ALL RIGHTS RESERVED.

No Part of this publication may be reproduced, stored in a retrieval system, or transmitted in any form or by any means, electronic, mechanical, photocopying, recording, or otherwise, without prior written permission of the publisher.