



# VACUUM CLEANER **SERVICE MANUAL**

## CAUTION

BEFORE SERVICING THE UNIT, READ THE  
"SAFETY PRECAUTIONS" IN THIS MANUAL.

MODEL: V-KC402CT, V-KC402CTU, V-KC402CTQ, V-KC402CTUQ  
V-KC402CTQU, V-K8501CTU, V-K8502CTU, V-C8200CTU  
V-K8503CTU, VCC402CTU, V-KC442CTU

# CONTENTS

---

SAFETY PRECAUTIONS .....	3
CAUTIONS.....	3
DESCRIPTION .....	4
SPECIFICATION.....	4
DISPLAY LED .....	5
VOICE ALARM.....	6
DISASSEMBLY .....	7~8
TROUBLE SHOOTING GUIDE.....	7~9
SCHEMATIC DIAGRAM.....	10
CIRCUIT DIAGRAM.....	10
SCHEMATIC DIAGRAM.....	11
CIRCUIT DIAGRAM.....	11
EXPLODED VIEW .....	12~15
REPLACEMENT PARTS LIST .....	16~17
THE TYPE OF POWER CORD .....	18

# SAFETY PRECAUTIONS

---

**BEFORE OPERATING THIS VACUUM CLEANER, READ THIS SERVICE MANUAL THOROUGHLY, AND OBSERVE EACH POINT CAREFULLY.**

## **1. Motor filter(Air Cleaner)**

- 1) This filter is reusable.
- 2) Never use the vacuum cleaner without filter.  
It may damage the motor.
- 3) When the light of body is on, wash the motor filter with water.
- 4) Even if the light is not on, wash the motor filter at least once 6 months.

**NOTE :** Reusing of the motor filter.

- Never wash the filter in a washing machine or in a dishwasher.
- Never use hot water for washing the filter.
- Reuse the filter after drying it completely in the shade for a day.
- Do not dry near fire or direct sunray.

## **2. Exhaust filter(Washable HEPA filter)**

- 1) This filter is reusable HEPA filter.
- 2) For clean air, this filter must be assembled.
- 3) Wash the exhaust filter with water once a year.
- 4) When the light of body is on, wash the exhaust filter with water.

**NOTE :** Reusing of the exhaust filter.

- Never wash the filter in a washing machine or in a dishwasher.
- Never use hot water for washing the filter.
- Reuse the filter after drying it completely in the shade for a half day.
- Do not dry near fire or direct sunray.
- Do not brush the filter. This will cause permanent damage allowing dust to by-pass the filter.
- Do not wash the blue side of the filter.

## **3. Avoid suction such materials as :**

- 1) Liquid or wet dust :  
Clogs the ventilation holes, reduces the suction power significantly and harms the motor.
- 2) Inflammable liquids such as benzene, alcohol or solvents.
- 3) Burning objects such as cigarette butts.
- 4) Bulky objects such as vinyl, paper etc.
- 5) Sharp objects such as needles, pins, metal, glass particles etc.

## **4. Attachments**

- Nozzle : for cleaning wooden floor, the room floor and carpet.
- Crevice Tool : for cleaning any crevice, inside corners or window frames. However, do not use the crevice tool more than 20 minutes because it may cause harm to the motor.
- Dusting brush : for cleaning clothes curtains.

## **5. Close supervision is necessary when this vacuum cleaner is used by or near children. Children's carelessness may cause damage to the cleaner or injure persons.**

## **6. Air exhausted from the vacuum cleaner is normally warm. But if extraordinarily hot air is exhausted, check if the telescopic tube, hose or clean filter is clogged or not.**

## **7. Electric shock could occur if used outdoors or on wet surfaces.**

# CAUTIONS

---

**BEFORE ATTEMPTING TO SERVICE OR ADJUST ANY PART OF THE VACUUM CLEANER, DISCONNECT THE ELECTRICAL POWER SUPPLY CORD FROM THE WALL OUTLET.**

## **1. Motor exchange**

- 1) Separate the Body Cover and Body Base by unfastening the screws.
- 2) After disconnecting the lead wires, replace the old motor with a new one.

## **2. In case of exchanging other parts. refer to the exploded view.**

# DESCRIPTION

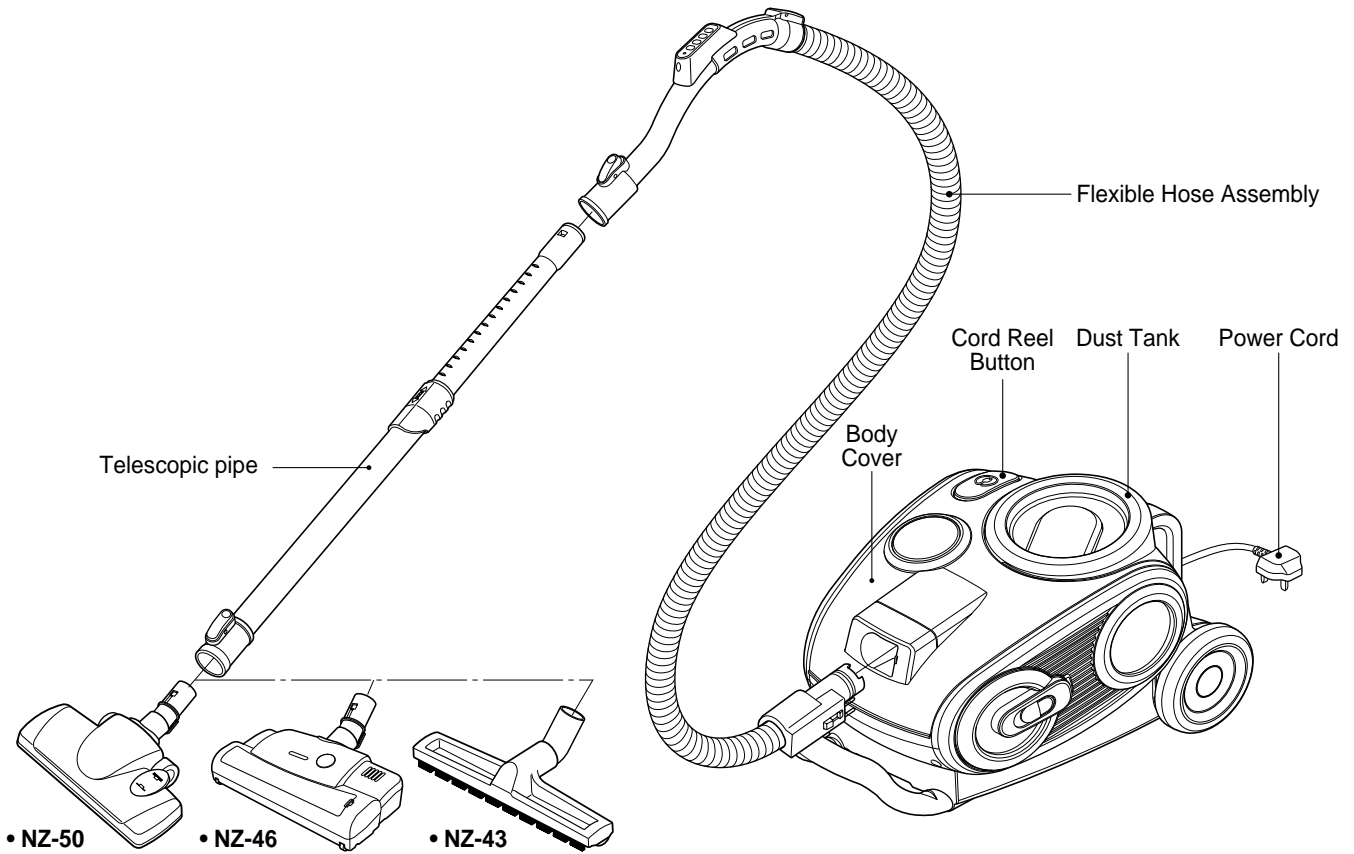

## ATTACHMENTS

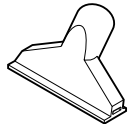

DUSTING BRUSH

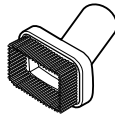

UPHOLSTERY NOZZLE



CREVICE TOOL



ACCESSORY HOLDER

# SPECIFICATIONS

- **MODEL** : REFER TO THE COVER PAGE
- **POWER SOURCE** : ON RATING PLATE
- **POWER CONSUMPTION** : ON RATING PLATE
- **POWER CONTROL** :  
- MAIN : PUSH ON/OFF (GRIP HANDLE)
- **CORD LENGTH** : 6 m
- **HOSE LENGTH** : 1.5 m
- **NET WEIGHT** : 7.5 kg
- **PACKING WEIGHT** : 13 kg
- **NET DIMENSION** : 341 x 521 x 300 (W x D x H)mm
- This specifications are subject to change according to the buyer's request.
- **PACKING DIMENSION** : 370 x 580 x 455 (W x D x H)mm
- **ATTACHMENTS**
  - HOSE .....1EA
  - TELESCOPIC PIPE ASSEMBLY .....1EA
  - NOZZLE ASSEMBLY .....1EA
  - NOZZLE ASSEMBLY PARQUET .....1EA
  - DUSTING BRUSH.....1EA
  - UPHOLSTERY NOZZLE .....1EA
  - CREVICE TOOL.....1EA
  - ACCESSORY HOLDER.....1EA

# DISPLAY LED

- OFF** : All LEDs turn on when powering off or being in Standby mode.
- MIN** : Mode that noise is weakest in minimum power status. Use this mode at night or when calmness is needed.
- MAX** : Mode to indicate maximum suction power operation.
- AUTO** : Auto mode measures quantity of dust via the dust sensor mounted in the cleaner and automatically adjusts suction power accordingly. If dust is discovered, the mode becomes Max status, and if dust is removed, the mode becomes Min status.

## • Auto Mode •

### Auto on

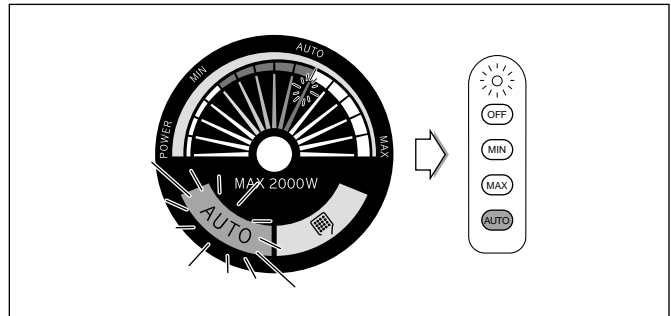

### Dust detection

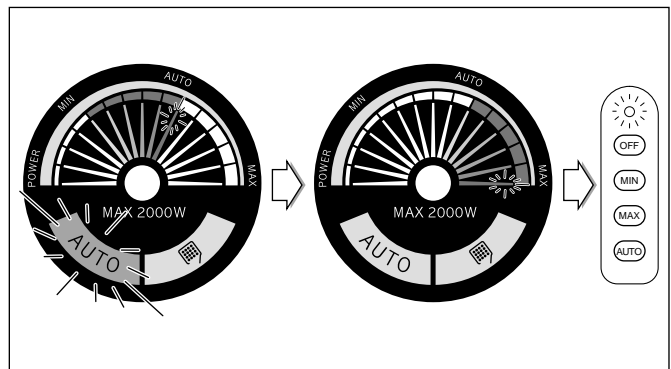

When operating in Auto Mode, the LED flickers if the dust sensor detects dust.

After that operation mode change to MAX mode.

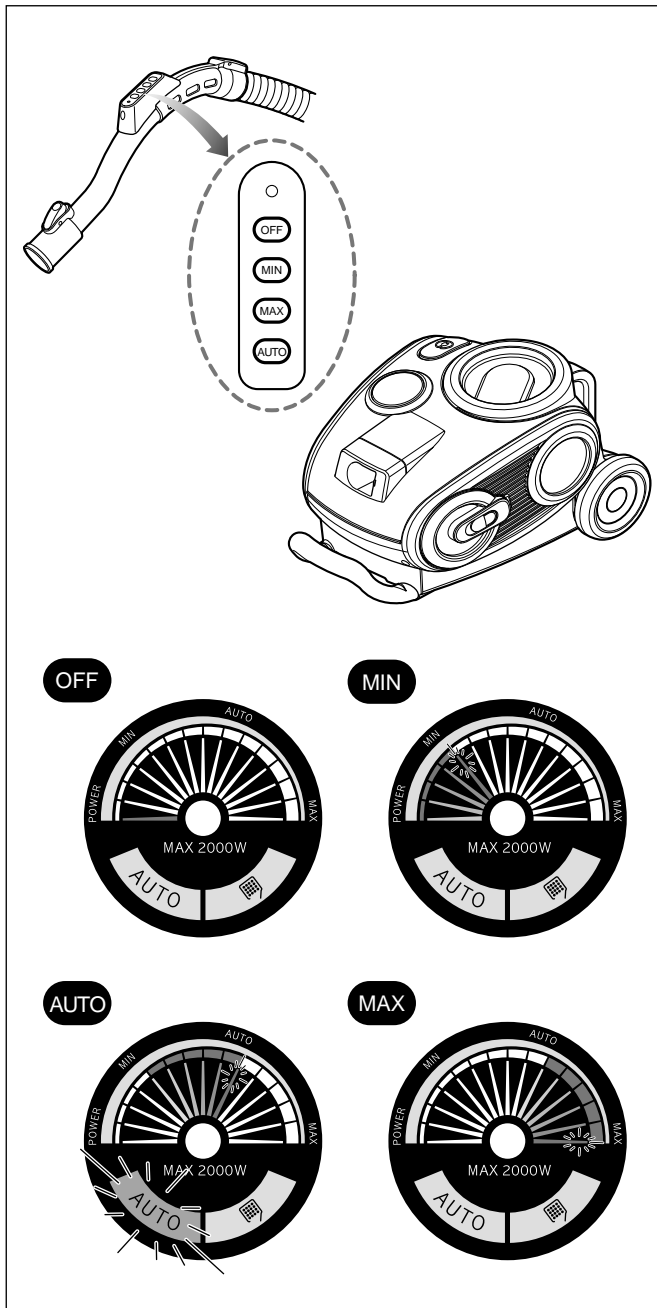

# VOICE ALARM

## 1. VOICE ALARM

Voice alarm to inform operation status of the cleaner.

- Informs operation status of the cleaner with a speaker mounted inside of the cleaner cover.

**Power On:** Hello, Power on. Select desired mode.

**When  LED turns on:** Empty dust bin, and clean pre-filter. Please.

**When cleaning stops:** Stop.

**MIN:** Minimum mode.

**MAX:** Maximum mode.

**AUTO:** Auto mode.

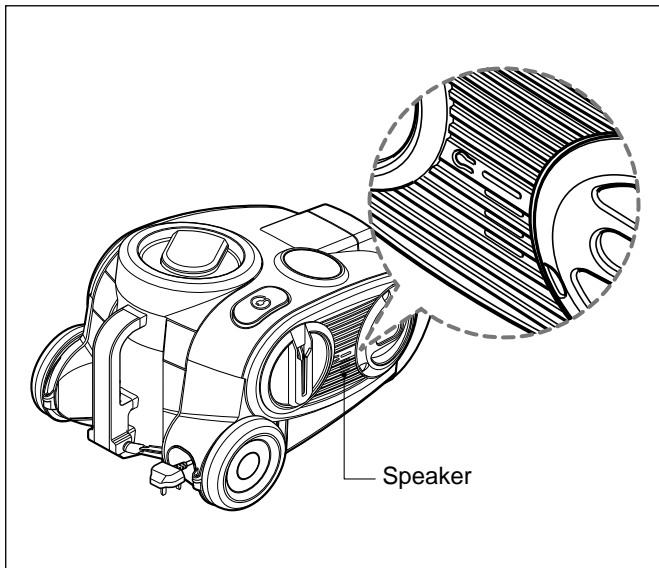

## 2. VOICE ALARM ON/OFF(default : ON)

- To let voice alarm OFF, press "OFF" button for three second.

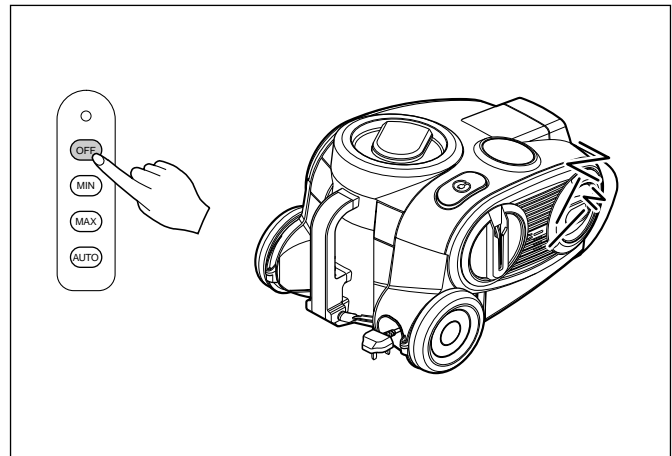

- To let voice alarm ON, press "OFF" button for three second.

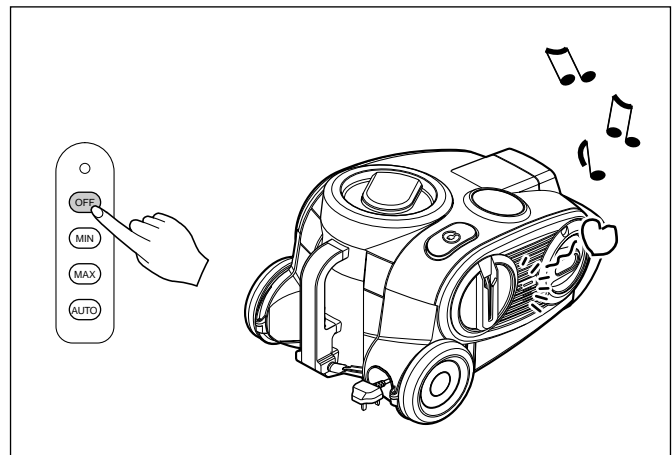

### CAUTION

When the dust tank is full lamp(  ) is on, also, it(cleaner) makes suction power low rapidly by itself to protect the motor after 1 and half minute.

This time full LED is still on.

Even if the dust tank does not appear to be full at this stage, it should be cleaned.

The air filter should be cleaned at once.

Voice alarm : Empty the dust bin and clean the pre-filter.

# DISASSEMBLY

**NOTE:** Before attempting to service or adjust any part of the vacuum cleaner, disconnect the electrical power supply cord from the wall outlet.

- Almost all of the parts of this vacuum cleaner can be disassembled with a screw driver and each connecting component easily fits each other. Disassemble one by one referring to the exploded view.
- If possible, don't disassemble except for the necessary parts. It is not necessary to disassemble the parts that are not detailed in the exploded view.

## 1. Body Cover Assembly Replacement

- 1) Remove the dust tank from the set.

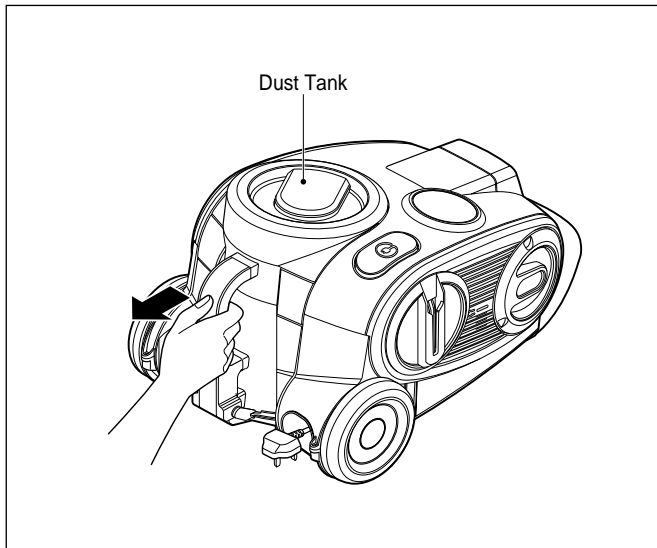

- 3) Remove the four screws fastening the body cover.
- 4) Disassemble the body cover, raising the body cover.

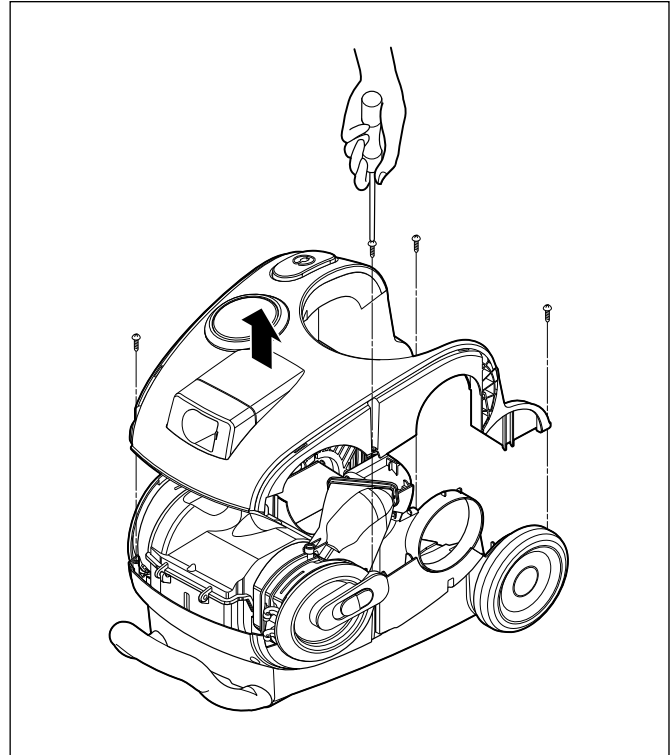

## 2. Motor Assembly Replacement

- 1) Remove the connect pipe.

- 2) Remove the two screws fastening the deco cover. After that remove the deco cover.

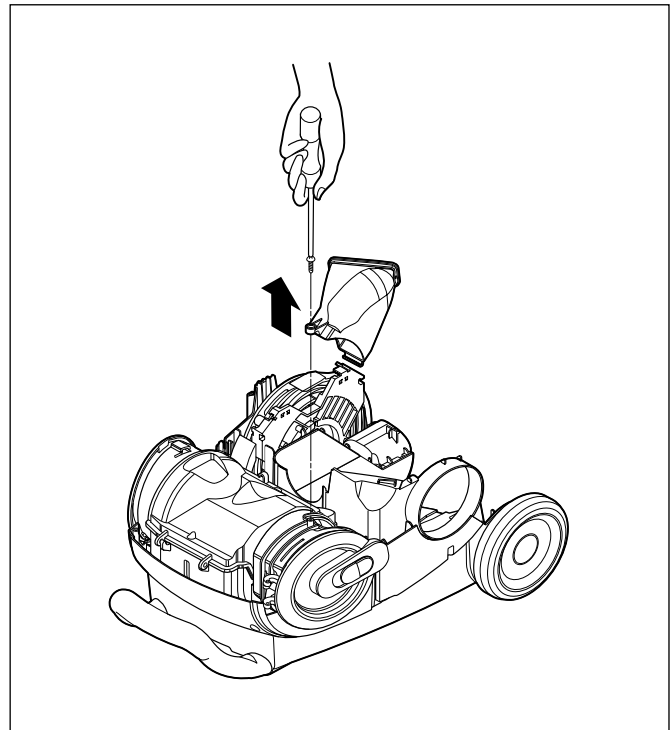
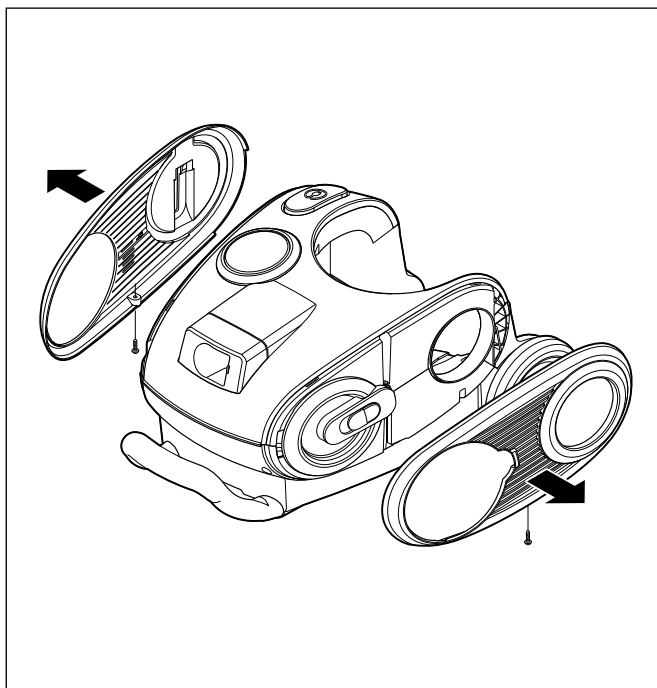

- 2) Remove the two screws fastening the motor chamber.
- 3) Unhook the two hook.

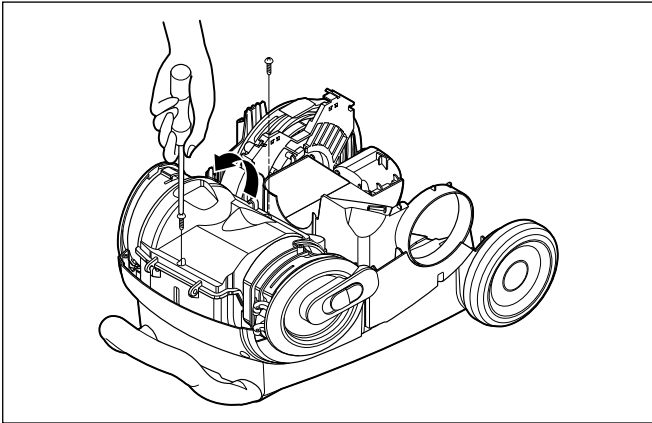

- 4) Pull out motor and disconnect the lead wires from it.

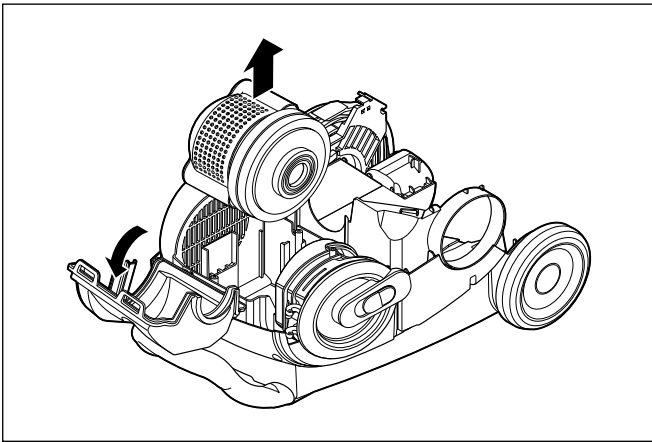

### 3. Disassembly of Body Base Assembly and Cord Reel Assembly.

- 1) Remove the two screws fastening the motor chamber.
- 2) Pull out the motor chamber.

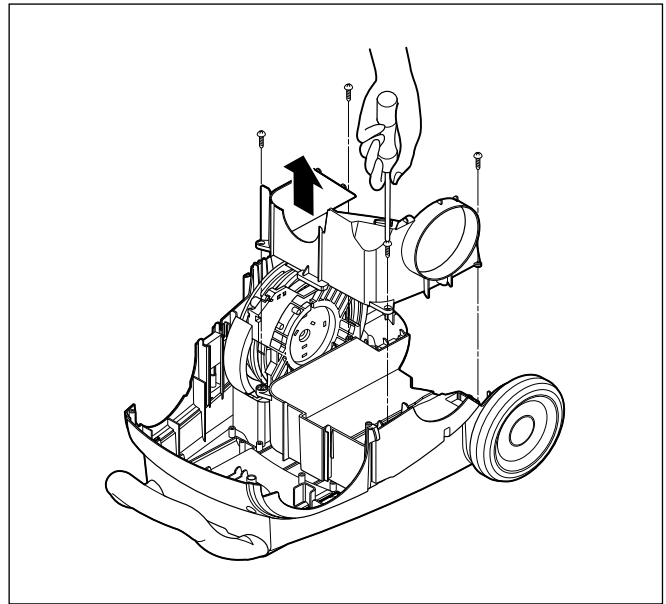
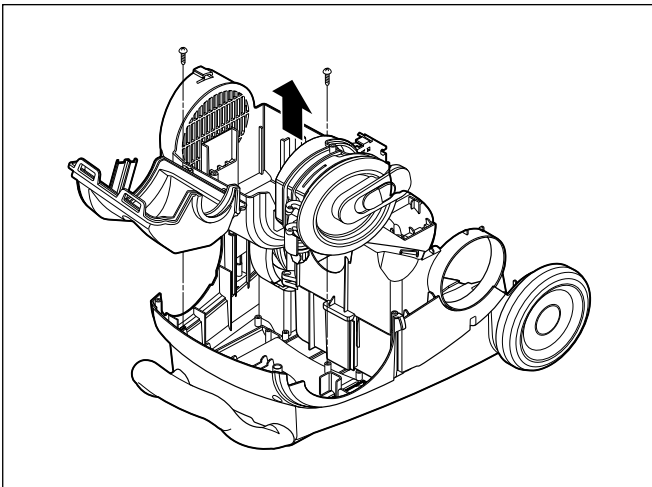

- 3) Lift the cord reel assembly from the body base.

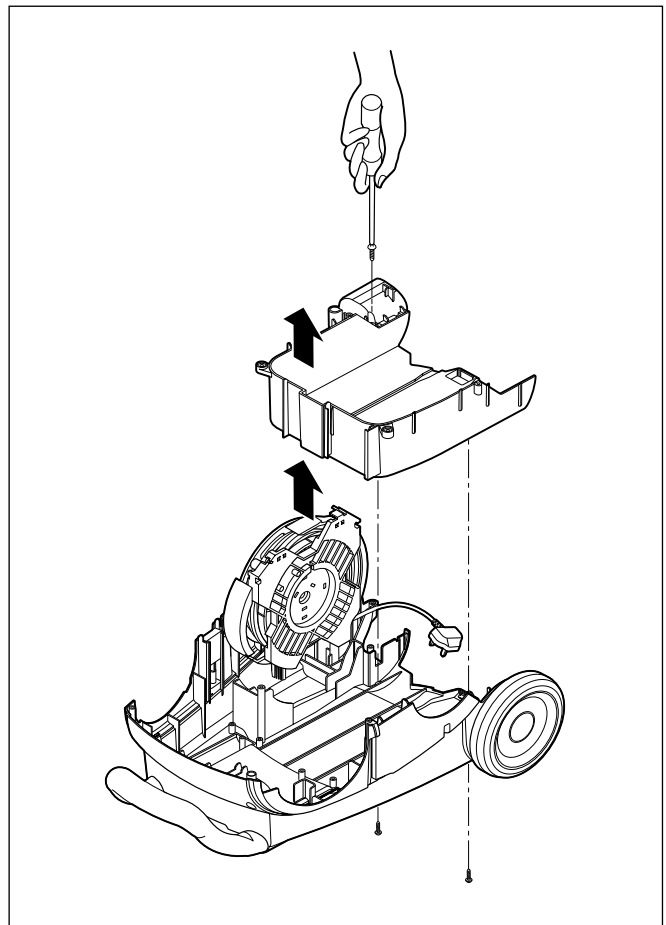



# TROUBLESHOOTING

---

## 1. SWITCH ON BUT MOTOR DOES NOT TURN.

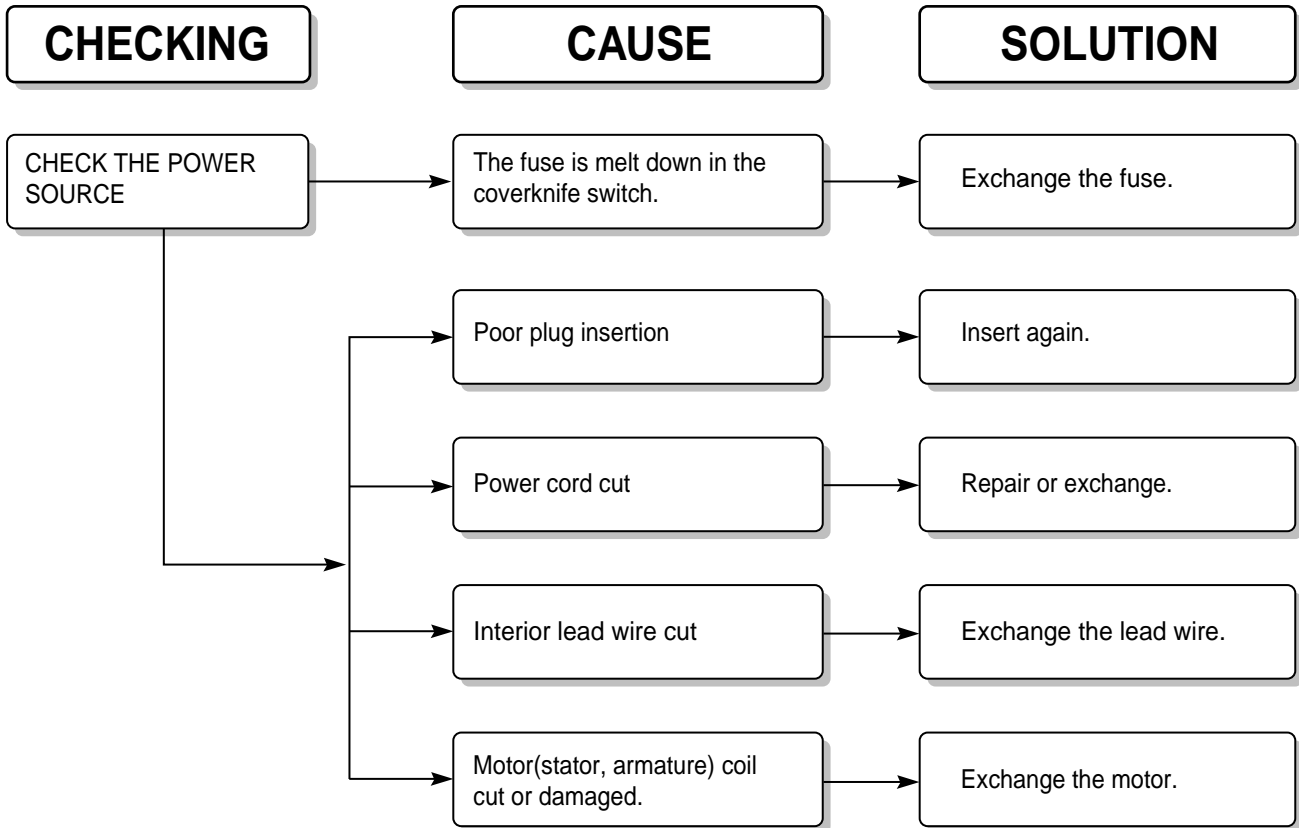

## 2. SWITCH ON, MOTOR DOES NOT TURN BUT BUZZES.

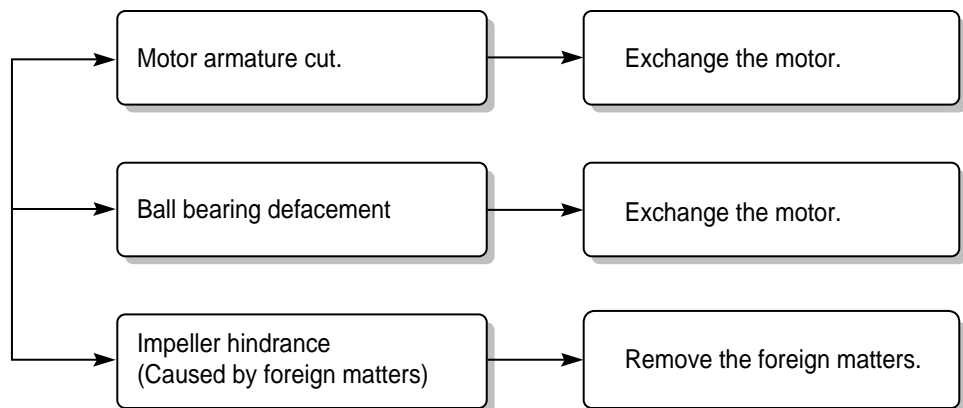

---

### 3. SWITCH OFF BUT MOTOR TURNS

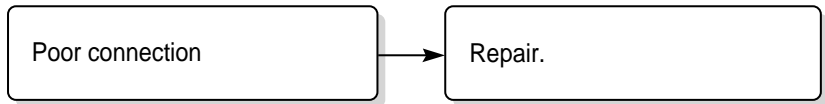

### 4. WEAK SUCTION POWER

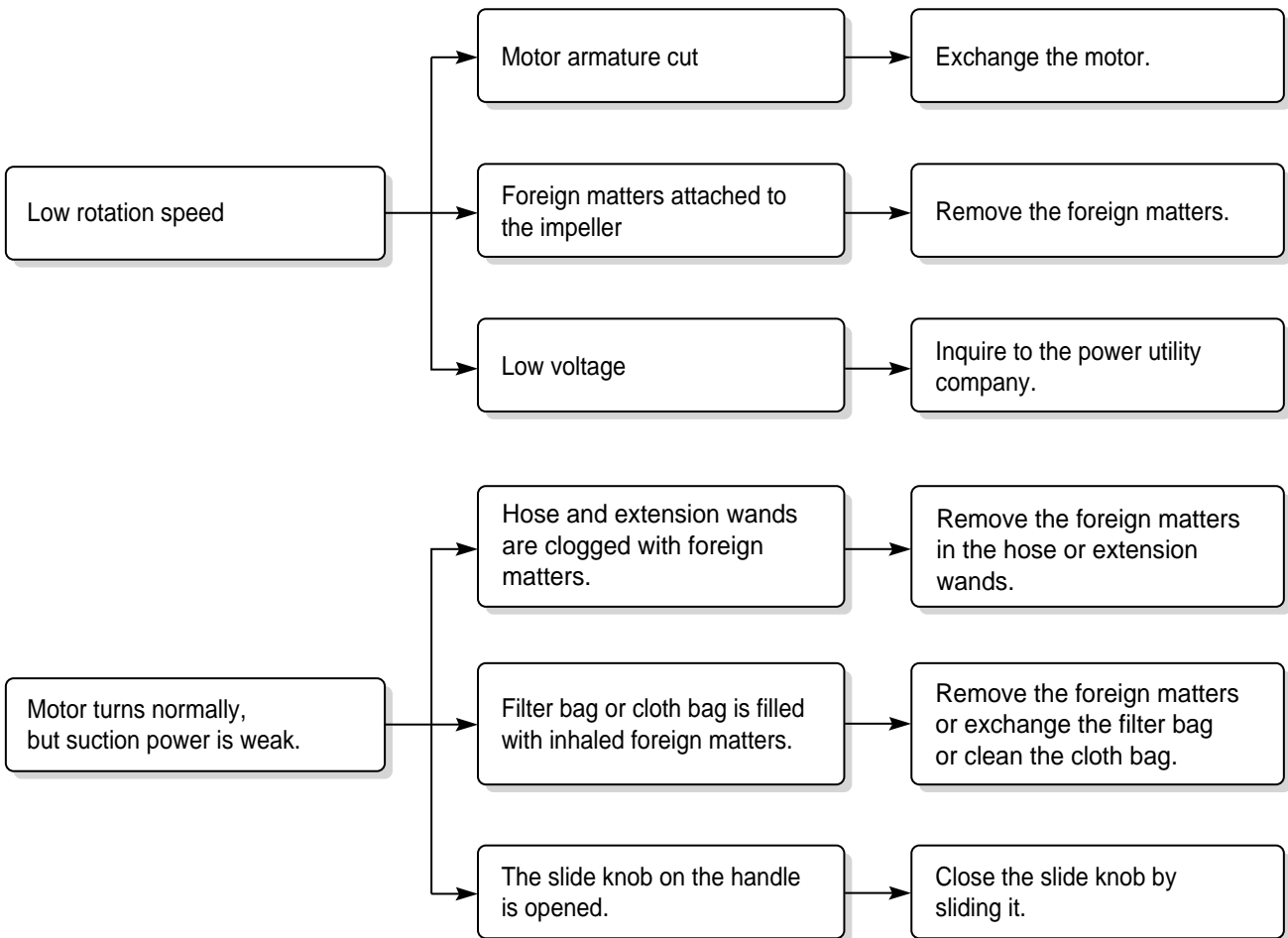

---

## 5. VIBRATION NOISES

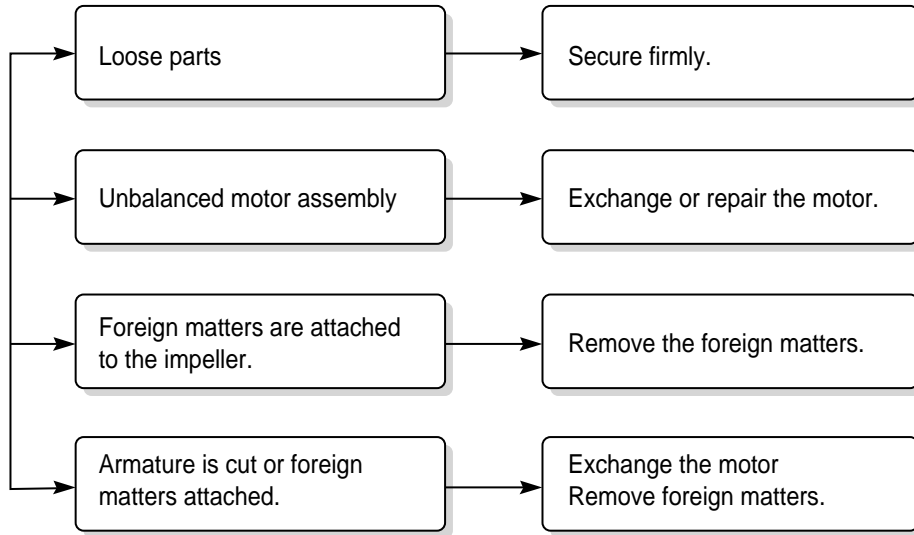

## 6. RADIO, TV RECEPTION DISTURBANCE

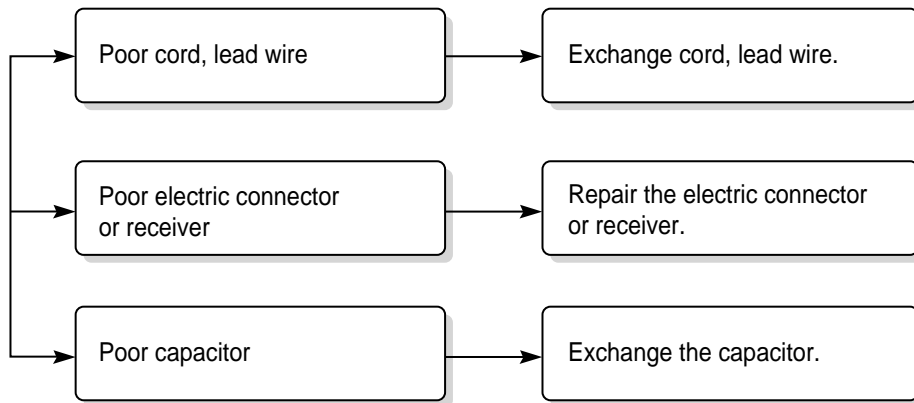

## 7. IMPROPER TUBE OF NOZZLE CONNECTION

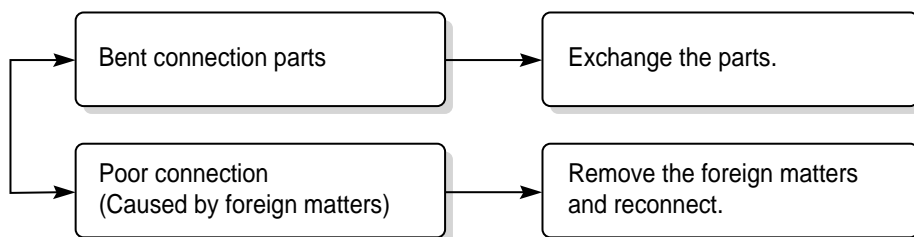

# SCHEMATIC DIAGRAM

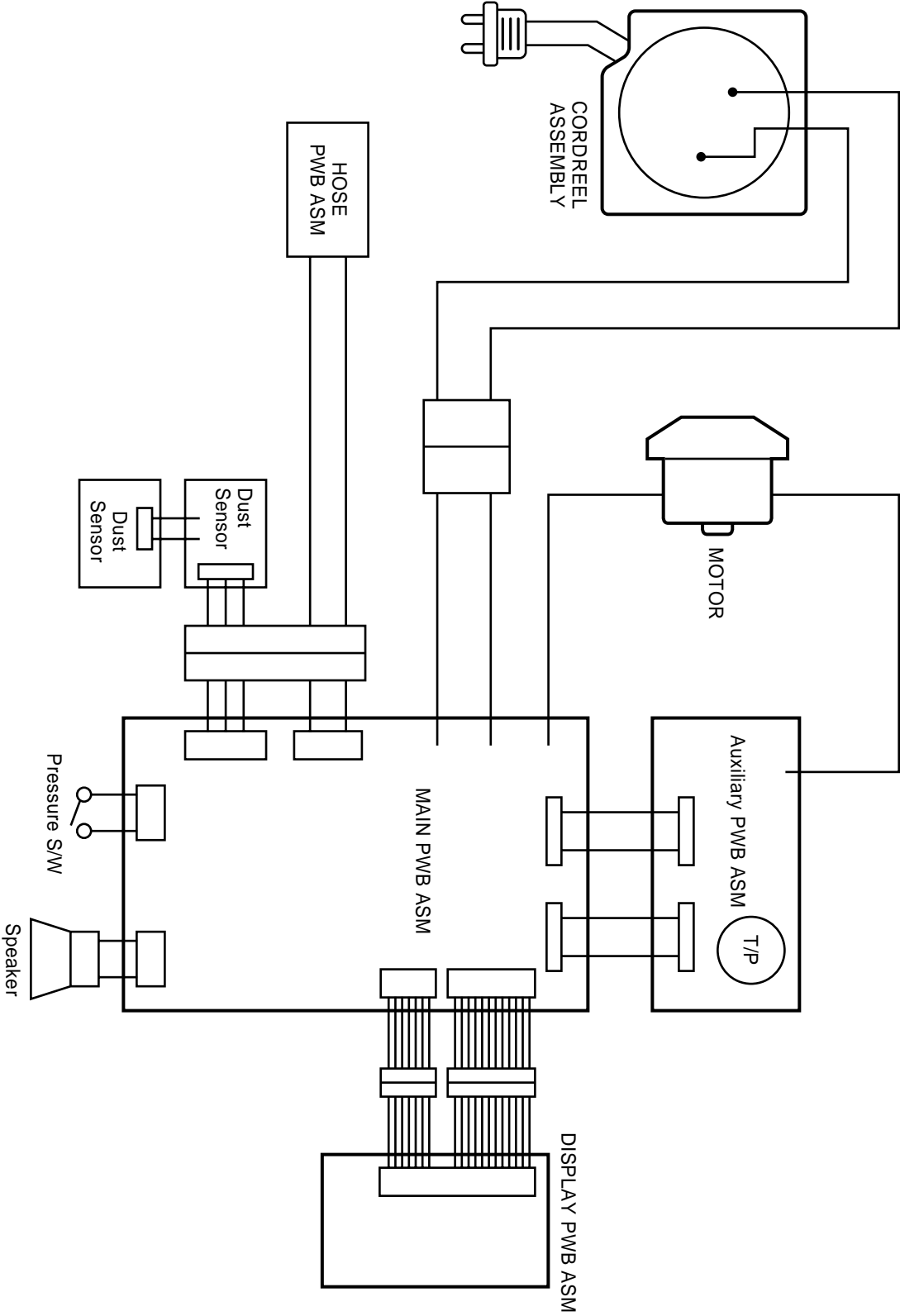

# SCHEMATIC DIAGRAM

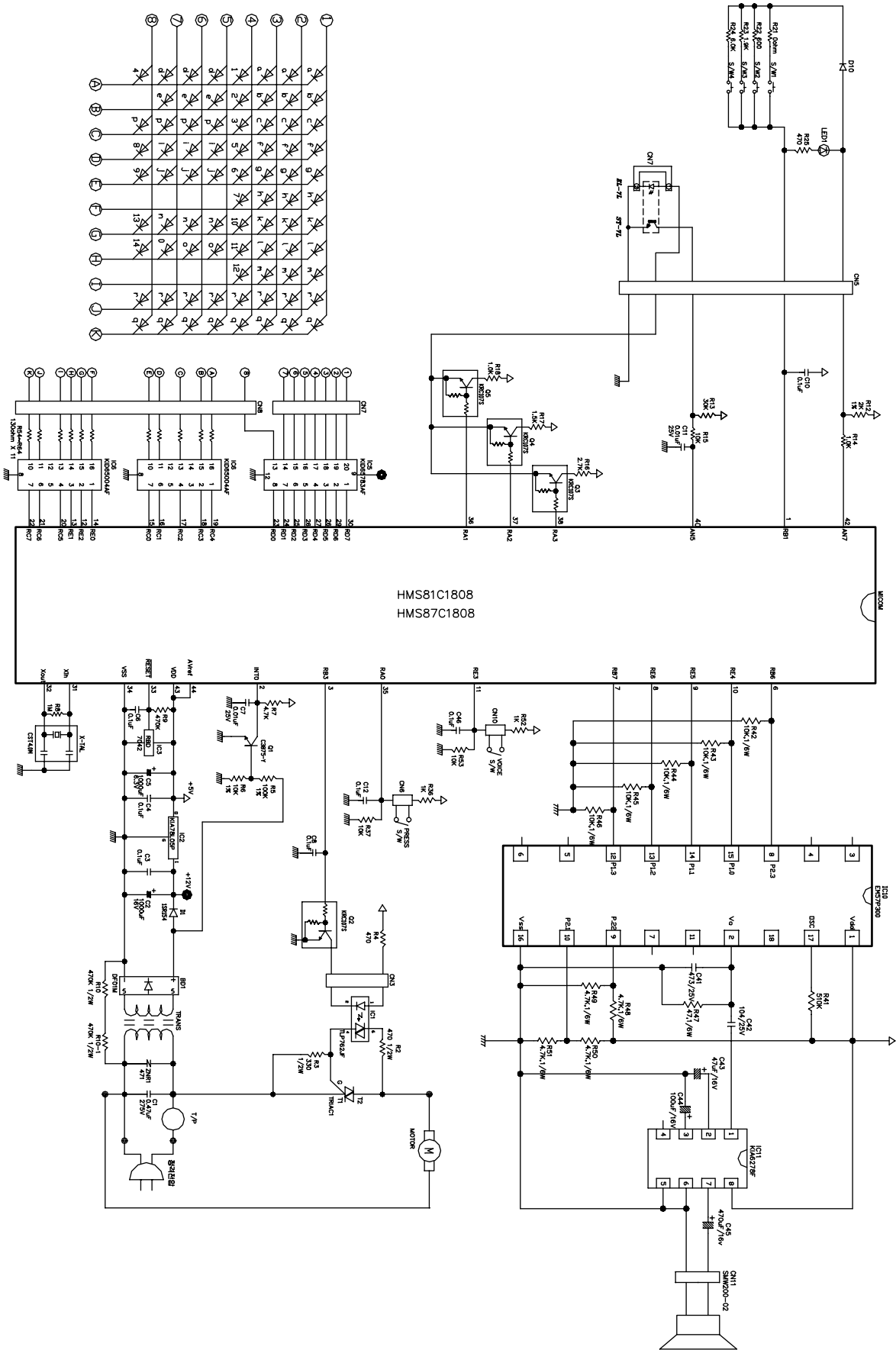

# EXPLODED VIEW

## BASE ASS'Y, BODY

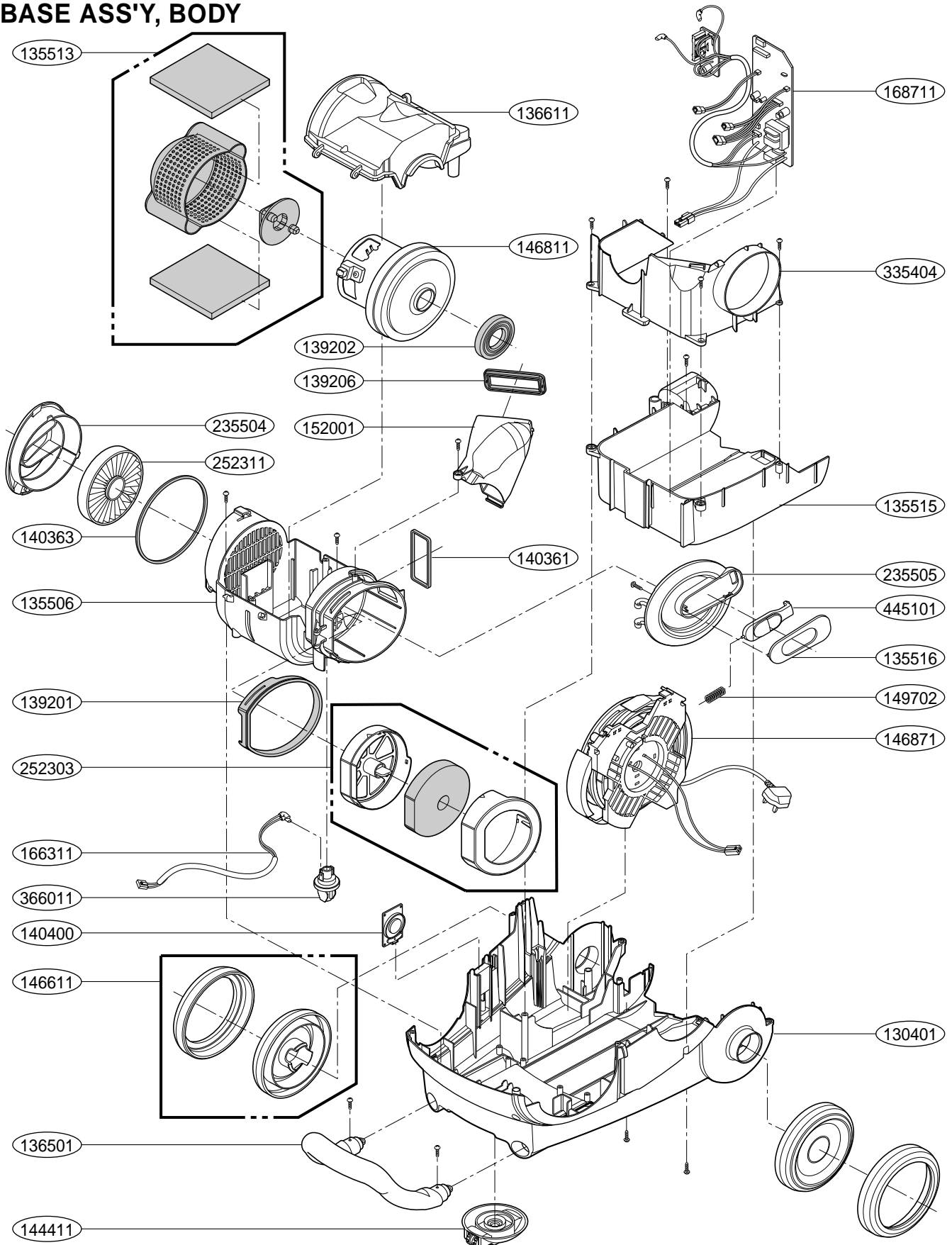

# COVER ASS'Y, BODY

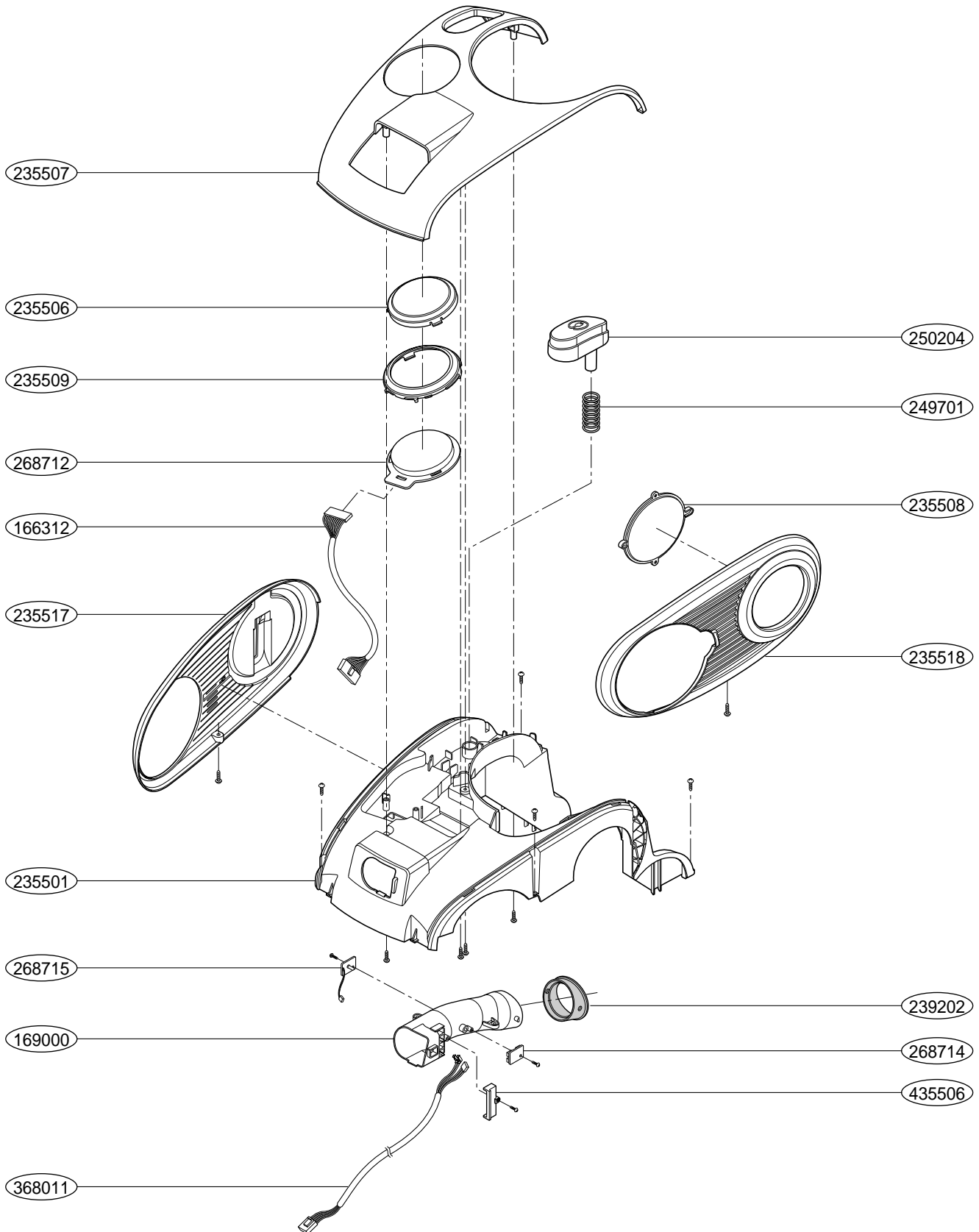

# TANK ASS'Y, DUST

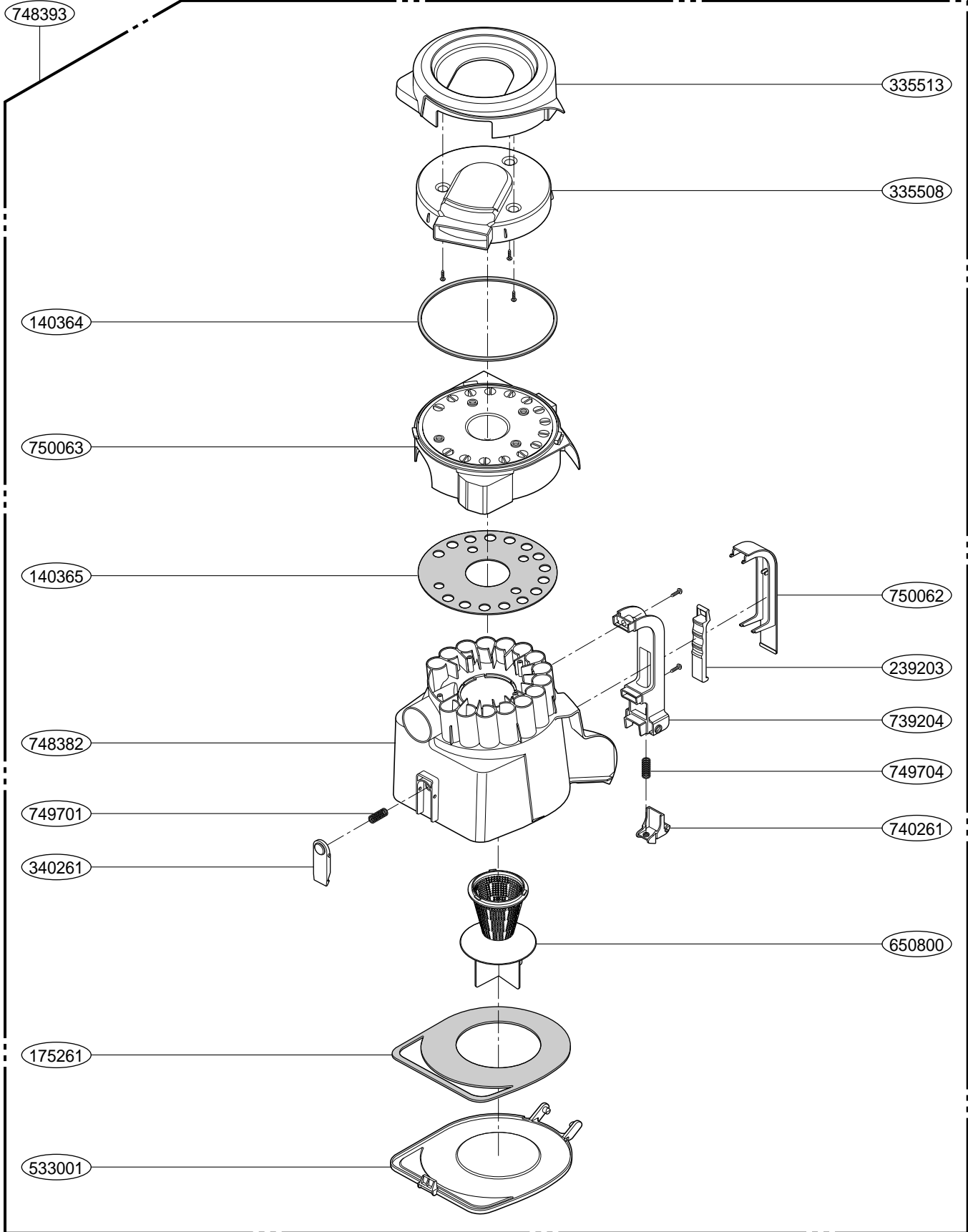



# HOSE ASS'Y, FLEXIBLE

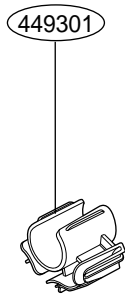
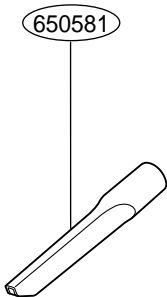
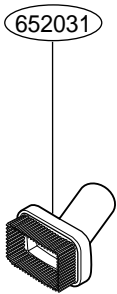
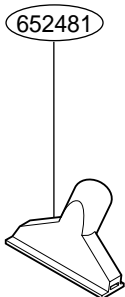
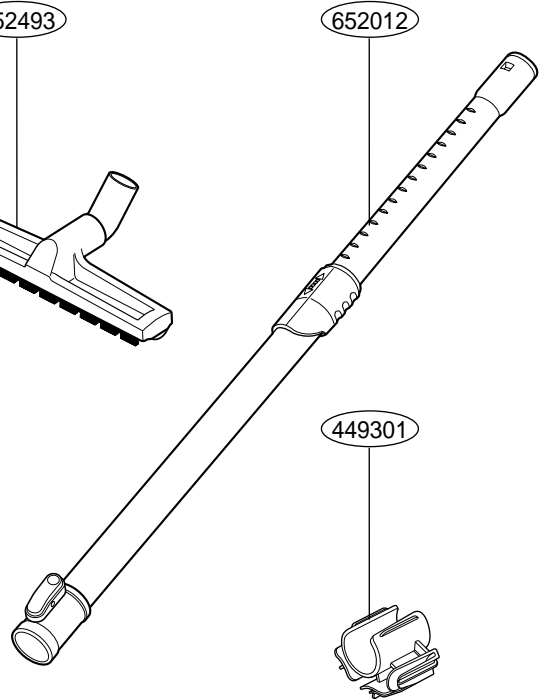
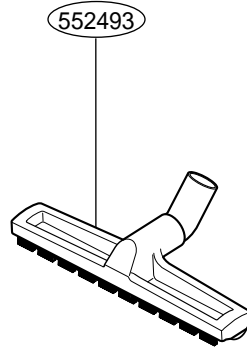
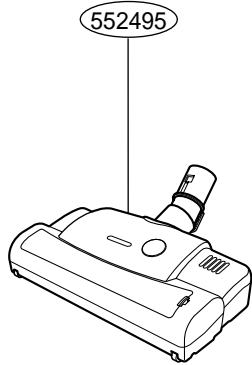
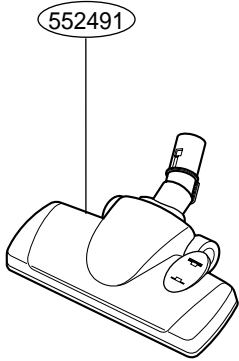
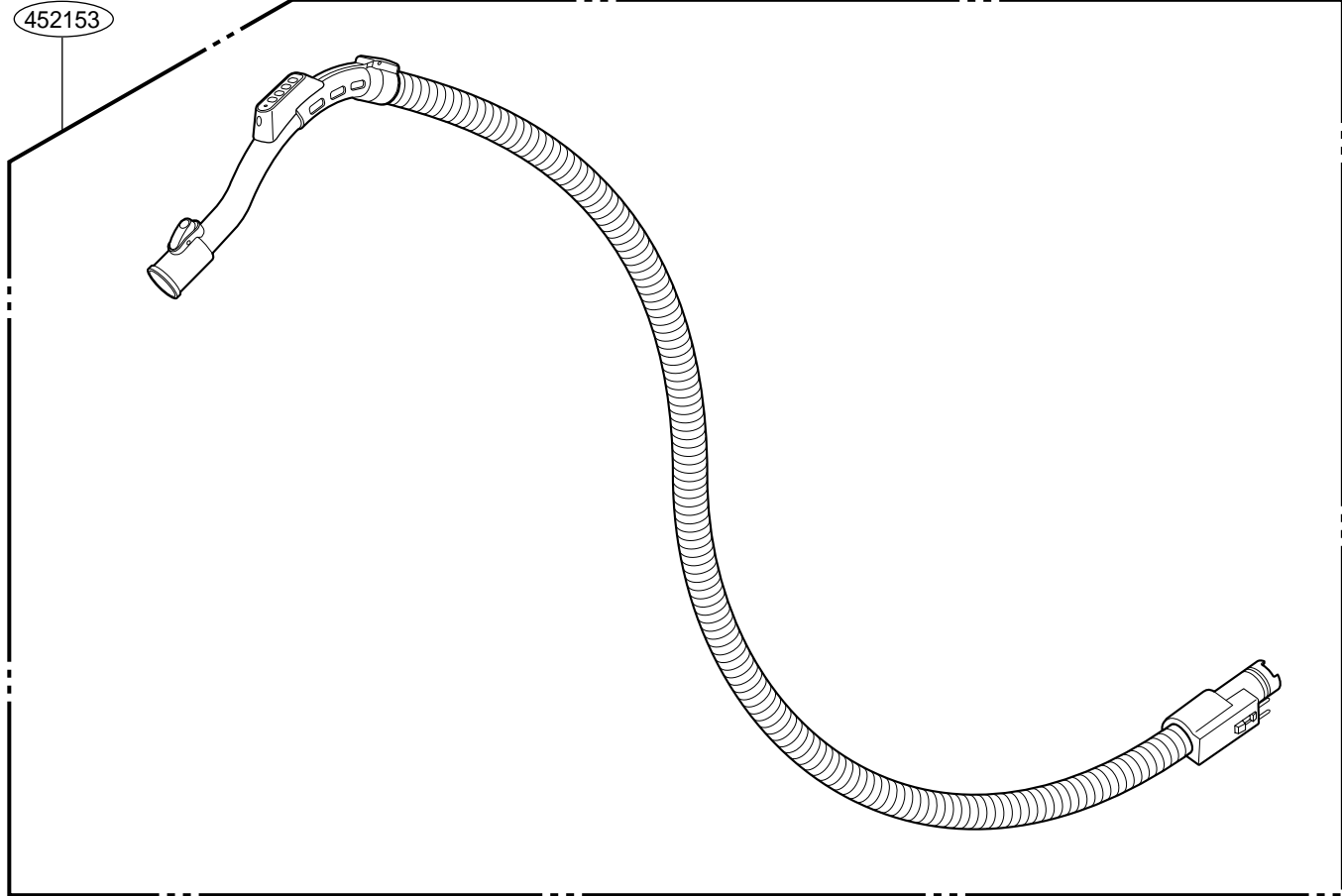

# REPLACEMENT PARTS LIST

LOCATION No.	DESCRIPTION	P/No	REMARK
130401	BASE BODY		REFER TO APPENDIX
135515	COVER, BACK		REFER TO APPENDIX
335404	COVER, TOP		REFER TO APPENDIX
135506	COVER, MOTOR HOUSING	3550FI1891A	
136611	HOUSING, MOTOR	3660FI1253A	
152001	PIPE, CONNECTOR	5200FI2543A	
235504	COVER, EXHAUST FILTER		REFER TO APPENDIX
235505	COVER, EXHAUST FILTER		REFER TO APPENDIX
135516	COVER, LEVER		REFER TO APPENDIX
445101	LEVER, RELEASE		REFER TO APPENDIX
146611	WHEEL, ASS'Y	4661FI2424A	
		4661FI2424B(LFS)	
136501	HANDLE, CARRIER		REFER TO APPENDIX
366011	SWITCH, PRESSURE	6601FI3488B	
249011	DAMPER	4901FI2001F	
252311	FILTER ASSEMBLY, EXHAUST	5231FI2508C	
252303	FILTER ASSEMBLY,PRE	5231FI3806A	
140361	SEALER	4036FI3725A	
140363	SEALER	4036FI3720A	
168711	PWB ASSEMBLY		REFER TO APPENDIX
166311	CONNECTOR ASSEMBLY	6877FI3082G	
140400	SPEAKER	6401FI1001B	
139206	PACKING, SEAL	3920FI3930A	
149702	SPRING	4970FI4719G	
146871	CORDREEL ASSEMBLY		REFER TO APPENDIX
144411	CASTER ASSEMBLY	4441FI3616A	
139201	PACKING, DUST SEAL	3920FI2430A	
235508	COVER, DECO	3550FI3945A	
235518	COVER, DECO		REFER TO APPENDIX
235517	COVER, DECO		REFER TO APPENDIX
135513	COVER ASSEMBLY,MOTOR	3551FI3745A	
146811	MOTOR ASSEMBLY,VC		REFER TO APPENDIX
139202	PACKING,MOTOR MOUNTING	3920FI4746B	
235501	COVER, BODY		REFER TO APPENDIX
235507	COVER, DECO		REFER TO APPENDIX
250204	BUTTON, CORDREEL		REFER TO APPENDIX
269000	PIPE, CONNECTOR	5200FI1237A	
235506	COVER, DISPLAY	3550FI3943A	
235509	COVER, DECO	3550FI3944A	
268712	PCB(LED)	6871FX3129A	
435506	COVER, TERMINAL	3550FI3802A	
239202	PACKING, SEAL	3920FI3932A	
249701	SPRING, BUTTON	4970FI4728A	
268714	PWB ASSEMBLY, SENSOR	6871FX3077B	
268715	PWB ASSEMBLY, SENSOR	6871FX3077F	
368011	TERMINAL ASSEMBLY	6631FI3168A	
166312	CONNECTOR ASSEMBLY	6877FI3082G	

# REPLACEMENT PARTS LIST

LOCATION No.	DESCRIPTION	P/No	REMARK
748382	TANK, CYCLONE	4838F11425A	
750063	CAP, DUST	5006F11342A	
335508	COVER, DUST	3550F11893A	
335513	COVER, DECO		REFER TO APPENDIX
533001	BOTTOM, PLATE		REFER TO APPENDIX
740261	LATCH	4026F13712A	
340261	LATCH	4026F13713A	
239203	LATCH	4026F13716A	
650800	SHIELD, INNER		REFER TO APPENDIX
750062	CAP, HANDLE	5006F13718A	
739204	HANDLE, CARRIER		REFER TO APPENDIX
749703	SPRING	4970F13217A	
749701	SPRING	4970F14260E	
140364	SEALER	4036F13722A	
140365	SEALER	4036F13723A	
175261	SEALER	4036F13724A	
552491	NOZZLE ASSEMBLY,FLOOR		REFER TO APPENDIX
552495	NOZZLE ASSEMBLY,TURBIN		REFER TO APPENDIX
452153	HOSE ASSEMBLY,FLEXIBLE		REFER TO APPENDIX
652012	PIPE ASSEMBLY,TELESCOPIC		REFER TO APPENDIX
449301	ACCESSORY HOLDER		REFER TO APPENDIX
650581	TOOL,CREVICE		REFER TO APPENDIX
652031	BRUSH ASSEMBLY,DUST		REFER TO APPENDIX
652481	NOZZLE,UPHOLSTERY		REFER TO APPENDIX
552493	NOZZLE ASSEMBLY,FLOOR		REFER TO APPENDIX

# APPENDIX

## 1. THE TYPE OF POWER CORD & PARTS NUMBER

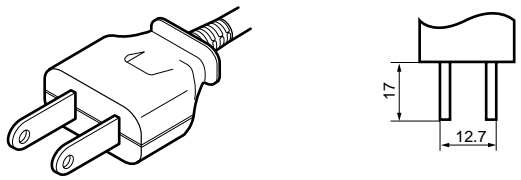
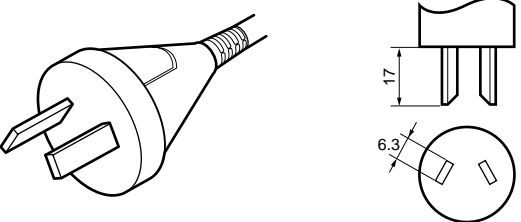
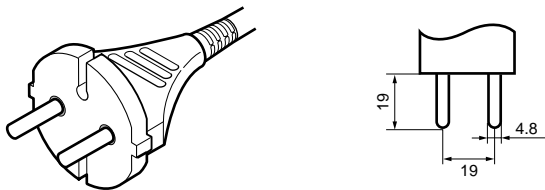
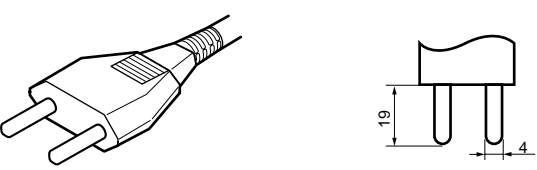
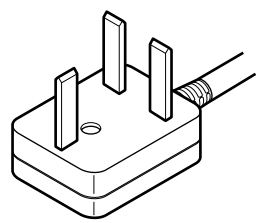
Type	Type of plug	Cord Reel ASS'Y P/No. (L/No. : 146871)						
A - 1		<b>4687FI1494L</b>						
S - 1								
C - 2		<b>4687FI1494E</b>						
C - 1		<b>4687FI1494P</b>						
B - 3	 <table border="1" data-bbox="722 1702 1079 1904"> <thead> <tr> <th colspan="2">Color identification of fuse</th> </tr> </thead> <tbody> <tr> <td>Brown</td> <td>13A</td> </tr> <tr> <td>Yellow</td> <td>5A</td> </tr> </tbody> </table>	Color identification of fuse		Brown	13A	Yellow	5A	<b>4687FI1494D</b>
Color identification of fuse								
Brown	13A							
Yellow	5A							

## 2. COLOR & PART NUMBER

LOCATION/No.	DESCRIPTION	COLOR	SHADOW GRAY	NEO GRAY
130401	BASE BODY		3040FI1553A	3040FI1553B
135515	COVER, BACK		3550FI1896A	3550FI1896B
335404	COVER, TOP		3550FI1897A	3550FI1897B
136501	HANDLE, CARRIER		3650FI2434A	3650FI2434B
235501	COVER, BODY		3550FI1889A	3550FI1889B
533001	BOTTOM, PLATE		330FI1473A	330FI1473B
739204	HANDLE, CARRIER		3650FI2432A	3650FI2432B
552491	NOZZLE ASSEMBLY, FLOOR		5249FI1445A	5249FI1445B
			5249FI1445F(LFS)	-
452153	HOSE ASSEMBLY, FLEXIBLE		5215FI1368B	5215FI1368C
652012	PIPE ASSEMBLY, TELESCOPIC		5201FI2493F	5201FI2493H
449301	ACCESSORY HOLDER		4930FI3850A	4930FI3850C
650581	TOOL, CREVICE		5058FI3592C	5058FI3592D
652031	BRUSH ASSEMBLY, DUST		5203FI2072F	5203FI2072S
652481	NOZZLE, UPHOLSTERY		5249FI2456C	5249FI2456D
552493	NOZZLE ASSEMBLY, FLOOR		5249FI1426F	5249FI1426G

LOCATION/No.	DESCRIPTION	COLOR	FERRARI RED	MET SILVER	DARK TITAN SILVER
235507	COVER, DECO		3550FI1890A	3550FI1890B	3550FI1890C
250204	BUTTON, CORDREEL		5020FI3836A	5020FI3836B	5020FI3836C
552495	NOZZLE ASSEMBLY, TURBIN		5249FI1431G	5249FI1431H	5249FI1431D

LOCATION/No.	DESCRIPTION	COLOR	LIGHT SILVER	DARK TITAN SILVER
235504	COVER, EXHAUST FILTER		3550FI2652A	3550FI2652B
235505	COVER, EXHAUST FILTER		3550FI2651A	3550FI2651B
135516	COVER, LEVER		3550FI3942A	3550FI3942B
445101	LEVER, RELEASE		4510FI3636A	4510FI3636B
235518	COVER, DECO		3550FI1894A	3550FI1894B
235517	COVER, DECO		3550FI1895A	3550FI1895B
335513	COVER, DECO		3550FI1892A	3550FI1892B

LOCATION/No.	DESCRIPTION	SPEC	ENGLISH (230V~50Hz) (GREEN)	ENGLISH (240V~50Hz)	RUSSIAN (BLUE)	MEXICO (120V~60Hz)	FRANCE (230V~50Hz)	VOICE & SPEAKER DELETE (230V~50Hz)
168711	PWB ASSEMBLY		6871FX2225A	6871FX2225B	6871FX2225C	6871FX2225D	6871FX2225F	6871FX2225G
146811	MOTOR ASSEMBLY, VC		4681FI2467A	4681FI2467B	-	4681FI2451J	-	-
650800	SHIELD, INNER		4814FI2002A	-	4814FI2002B	-	-	-

LOCATION/No.	DESCRIPTION	TYPE	C2 TYPE	S1 TYPE	B3 TYPE	C1 TYPE	A1 TYPE
146871	CORDREEL ASSEMBLY		4687FI1494E	4687FI1494H	4687FI1494D	4687FI1494P	4687FI1494L

# Memo

---

# Memo

---



P/No.: 3828FI00002

September, 2005  
Printed in Korea