

6. ANTI HI-JACK MODE

There are three different ways to activate Anti Hi-Jack (AHJ).

1. By Ignition (Programmable Feature #7, Default setting is OFF)
When Programmable Feature #7 is ON, and the ignition is turned on, the alarm will enter AHJ mode. The siren will chirp three times and the LED will flash fast.

Note: If programmable feature #7 hi-jack through ignition is enabled (ON) you must exit hi-jack mode using the valet button before entering programming mode, see section 4 to enter programming mode. Do not turn ignition off, leave ignition on, then press valet button 5 times to enter programming mode.

2. By Door (Programmable Feature #8, Default setting is OFF)
When Programmable Feature #8 is ON, and when the Ignition is ON AND the driver door is opened then closed, alarm will enter AHJ mode. The siren will chirp three times and the LED will flash fast.
3. By Remote Control (Programmable Feature #9, Default setting is OFF)
When Programmable Feature #9 is ON and Ignition ON, Press and hold PANIC and AUX together for 2 seconds – alarm will enter AHJ mode. Siren will chirp three times and LED will flash fast.

NOTE: All three features can be set to ON.

ANTI HI-JACK MODE ACTIVATED STATUS

- From 0-60 sec LED will flash quickly.
- From 61-70 sec LED will flash quickly, siren chirps, and the parking light will flash.
- From 71-80 sec LED will flash quickly, siren chirps, parking light will flash, and ignition cut output constantly.
- After 81 sec LED will flash quickly, siren chirps, parking light will flash and ignition cut output constantly.

EXIT ANTI HI-JACK MODE

- From 00-60 sec, Turn on the ignition, then press and hold UNLOCK button for 2 sec. The system will be in disarm mode.
- After 60 sec, Turn on ignition, then press override switch for 1 sec. The system will be in disarm mode.



#6888 INSTALLATION MANUAL



LOCK BUTTON

• Press and release the LOCK button to ARM ALARM and LOCK DOORS	Ignition must be OFF
• Press and release the LOCK button to LOCK DOORS	During Valet Mode
• Press and release LOCK button and press it again for 2 SECONDS to BYPASS SHOCK SENSOR and ARM ALARM (Use this to bypass shock sensor)	Ignition must be OFF



UNLOCK BUTTON

• Press and release the UNLOCK button to DISARM ALARM and UNLOCK DOORS	Alarm must be ARMED and Ignition OFF
• Press and release the UNLOCK button to STOP ALARM TRIGGER	When siren / horn is Sounding
• Press and release the UNLOCK button to UNLOCK DOOR	During Driving or Valet Mode
• Press and Hold the UNLOCK button for 2 SECONDS to switch ALARM to KEYLESS basic mode.	Alarm must be DISARMED and Ignition ON.



PANIC BUTTON

• Press and hold the PANIC button for 2 SECONDS to TRIGGER HORN / SIREN

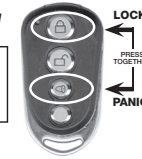

2nd AUXILIARY

• Press LOCK and PANIC buttons together to get AUX2 Output. Note: Contact installer to make sure this option is enabled.



AUX BUTTON

• Press and release the AUX button for TRUNK RELEASE	
• Press and hold the AUX button for 2 SECONDS for SILENT ARMING and Lock Doors	Alarm must be DISARMED and ignition OFF
• Press and hold the AUX button for 2 SECONDS for SILENT DISARMING and Unlock Doors	Alarm must be ARMED and ignition OFF

VALET OVERRIDE SWITCH OPERATION

USED FOR: 1. Stopping horn/siren: Turn ignition on, press and hold valet switch until horn/siren stops.
2. To enter/exit keyless basic mode (LED steady on): Ignition on and hold valet switch for 5 seconds.
3. Use to program remotes: Turn ignition on, press and release valet switch 5 times, press lock buttons on each remote to be programmed, turn ignition off. Up to 4 remotes may be programmed.

Most Common Locations (Ask installer where it is located.)

- Inside glove compartment, driver's kick panel, behind the fuse panel access door, underneath the dashboard in front of the driver.



REPLACEMENT REMOTE PART NUMBER: #REMOTE-6888

THIS IS ONLY A GUIDE

These instructions are a general guideline of possible applications. Specifications may change dependent upon vehicle. Always review the vehicle's service manual and wiring diagram when performing an installation. Manufacturer does not assume any responsibility for damages to property or persons which may occur due to incorrect applications or product failure. Not responsible for typographical errors. Specifications are subject to change without notice.

Warranty void if not installed by authorized dealer.
Specification and date are subject to change or withdrawal without notice.
© 2011 Micro Alarm, Inc. • 6888-Inst-oct2011.indd

4.A PROGRAMMABLE FEATURE TABLE

	FEATURES	LOCK: Siren chirp once LED flash once	UNLOCK: Siren chirp twice LED flash twice	PANIC: Siren chirp 3 times LED flash 3 times	AUX: Siren chirp 4 times LED flash 4 times	Siren Chirp Indicator
1	Lock / Unlock Pulse	Single*	Double			1 Short Chirp
2	Disarm Parking Light O/P	Flash Twice*	Light 30 sec			1 Short Chirp
3	Disarm (1st AUX)	Trunk*	Car Start (see Note 1)			1 Short Chirp
4	2nd AUX / Horn	Pulse* (see Note 2)	Latch (see Note 3)	Horn (see Note 4)	Limited Horn (see Note 5)	1 Short Chirp
5	IGN Lock / Unlock	On*	Off			1 Short Chirp
6	Keyless Entry	Off*	On			1 Short Chirp
7	IGN Anti Hi-Jack	Off*	On Note 6			1 Short Chirp
8	Door Anit Hi-Jack	Off*	On			1 Short Chirp
9	Remote Anit Hi-Jack	Off*	On			1 Short Chirp
10	Back to Factory Default	Press AUX for 3 seconds. Siren will chirp 6 times. Light will flash 6 times. All features will be returned to default settings.				1 Short Chirp

*All settings shaded in gray are factory default settings.

Note 1: CAR START – Press and release AUX button to get a 0.5 second negative output on the 1st channel (trunk release wire). This will bypass the sensor and ignition.

Note 2: PULSE – Press and hold the LOCK and PANIC buttons, and the 2nd Channel Output will send signal as long as the LOCK and PANIC buttons are held.

Note 3: LATCH – Press LOCK and PANIC buttons for a 30 second signal output.

Note 4: HORN – The Horn wire will have an output whenever the Siren wire has an output.

Note 5: LIMITED HORN – The Horn will sound only during Door Trigger, Ignition, or when the Shock Sensor is triggered. The siren will sound/chirp on all events.

Note 6: If ignition hi-jack is enabled, you must disable hi-jack using the valet button before entering programming mode. Leave ignition on after turning off hi-jack. See ignition hi-jack on page 8.

4.B LED INDICATION TABLE

Type of Trigger in Armed Mode	LED Status
No Trigger	LED Flash rapidly (Auto Rearm Activated)
Ignition	1 Flash & 1 Pause
Pin Switch Zone	2 Flash & 1 Pause
Door Zone	3 Flash & 1 Pause
Sensor Zone	4 Flash & 1 Pause

2A. JUMPER PIN INFORMATION

Jumper 1

OPEN – Last Door Arm/Auto Rearm = OFF

CLOSE – Last Door Arm/Auto Rearm = ON

Jumper 2

OPEN – Last Door Arm/Auto Rearm without Door Lock

CLOSE – Last Door Arm/Auto Rearm with Door Lock

Jumper 3

OPEN – Dome Light Delay for 60sec = ON

CLOSE – Dome Light Delay for 60sec = OFF

Jumper 4

OPEN – Central Door Lock (CDL) Pulse Timer = 3.5sec

CLOSE – Central Door Lock (CDL) Pulse Timer = 0.5sec

Default setting for all jumpers is **CLOSED**.

2.B POWER HARNESS WIRING CONFIGURATION

Pin#1: RED/WHITE = PARKING LIGHT INPUT VOLTAGE (+/-)

- This Input will provide the Voltage and Polarity to White Wire, fused at 10 Amps.

Pin#2: RED = MAIN POWER CONNECTION, 12V (+)

- Connect to the (+)12V Battery Terminal, Fused at 15 Amps.

Pin #3: WHITE = PARKING LIGHT OUTPUT (+/-)

- Connect this Wire to the Vehicle 12 Volts Parking Light Circuit.
- This Output will provide a Flashing 12 Volts fused at 10 Amps to energize vehicle's Parking Light.

Pin #4: BLACK = GROUND (-)

- Connect this wire to Chassis ground.

Pin #5: BROWN = SIREN OUTPUT (+)

- This wire will provide a (+)12Volts positive Output for powering a Siren(3A).

Pin #6: YELLOW = IGNITION INPUT (+)

- Connect to the Vehicle (+)12 Volt Ignition Wire

Pin #7: GRAY = AUXILIARY/TRUNK RELEASE OUTPUT, 500mA (-)

- This wire will provide a 12V. Negative output.
- May be used for remote starter, see programmable feature #3.

2.B POWER HARNESS WIRING CONFIGURATION CONTINUED

Pin #8: GREEN = Negative Trigger Door Input (-)

- This Input will trigger the Alarm if it becomes Grounded while alarm is armed (if door is opened).

Pin #9: N/A

Pin #10: PURPLE = Positive Trigger Door Input (+)

- This Input will trigger the Alarm if it receive +12 Volts while alarm is armed (if door is opened).

Pin #11: ORANGE = Starter Kill Output (-)

- This output needs to be used with a relay to be cut into the vehicle starter wire.

Pin #12: BLUE = Hood Pin Input (-)

- This Input will trigger the Alarm if it becomes Grounded while alarm is armed (if the hood is opened).

Pin #13: BROWN/WHITE = 2nd Auxiliary or horn honk output.

Note: Controlled through programmable feature #4.

Pin #14: N/A

Pin #15: BLACK/WHITE = Dome Light Supervision (-)

- This wire will provide a 0-60 sec for illuminated vehicle when Alarm is Disarmed.

Pin #16: N/A

2.C SHOCK SENSOR

Adjust Sensitivity for best protection.

1. If car receives light Impact, siren / horn will chirp 5 times in quick succession and Parking Light will Flash once for warning purpose.
2. If car receives heavy impact, siren / horn will sound and Parking Lights will Flash for 60 sec.

NOTE: Shock Sensor will sound maximum of 5 times, then will reset to deactivate until armed again.

2.D 2 PIN HARNESS(LOCK/UNLOCK) WIRING CONFIGURATION

GREEN:(-) Connect this Wire to Vehicle Lock Wire.

BLUE: (-) Connect this Wire to Vehicle Unlock Wire.

Note: For vacuum operated door lock system remove jumper pin #4.

Use Optional Part RRAL-DL to add door lock on-board relay interface.

3. VALET OVERRIDE SWITCH OPERATION

The Valet switch has five functions:

- **To Program Remote Controls** (see Section 1 – How to “Code Learn” a Remote Control)
- **To Program the “Programmable Features”** (see Section 4 – Programmable Features)
- **Basic Keyless Entry Mode**
 - With Ignition ON, hold Valet switch for 5 seconds (repeat to exit).
 - Only locks and unlocks doors; Horn and siren only work in “Panic Mode”. LED steady on.
 - NOTE: This is different from Programmable Feature #6, which does Keyless Entry where all features work except door, hood, and shock sensor triggers.
- **To Stop Panic Mode if Remote is Lost or Not Present**
 - With Ignition ON, hold Valet switch until Horn/Siren stops.
- **To Exit from Hi-jack mode**
 - Turn on ignition, then press override switch for 1 sec. The system will be in disarm mode.

4. PROGRAMMABLE FEATURES

To change any of the programmable features, please follow these steps.

1. Turn ignition ON.
2. Press Valet Override switch 5 times – the siren / horn will chirp once and parking light and LED will stay on.
3. Press the Valet switch the number of times equal to the number of the feature to be programmed
4. Press the button to be programmed (LOCK, UNLOCK, PANIC, AUX) on the remote to choose the setting you desire.
5. Turn ignition OFF.

Note: If 10 seconds expire without any programming activity, the parking light and LED will turn OFF, and the System will return to Disarm mode.