

Price quote for: **Aftermarket Tractor/Skidsteer Attachments**

Vendor Name:	Titan Machinery Inc.
Contact Person:	Andy Bethel
Street Address:	6340 County Road 101E
P.O. Box:	
City, State, Zip	Shakopee, MN, 55379
Phone #:	952-445-5400
Toll Free #:	800-795-9274
Fax #:	952-445-0365
Email Address:	andy.bethel@titanmachinery.com

1.0	Manufacturer's Name	Rockhound
		www.rockhound.com
	Attachment Description	All Attachments
	Warranty Term (months, years)	1 year
	Discount to be applied to Price List	3%
	Date & I.D. of Price List	1-Jul-13
2.0	<u>Delivery Charges</u>	NO FLAT RATE ALLOWED
	(SEE SPECIAL TERMS AND CONDITIONS)	
	<u>DELIVERY STARTING POINT: City, State, Zip</u>	Nearest Titan Case CE Location
	Price per loaded mile:	\$ 4.00
	Minimum Delivery Charge (if any)	\$ 100.00
	(SEE SPECIAL TERMS AND CONDITIONS)	
3.0	Price for additional Service Manual	Free
	Price for additional Parts Manual	Free
4.0	Installation Labor Rate - Per Hour	\$ 108.00
	Installation services may be requested on a "as needed" basis. If not available, list 'N/A' (See Special Terms and Conditions).	

(Typed Your Responses Required in Yellow Cells)

5.0 New Aftermarket Attachment Rental Program

If rental programs are available on the new equipment offered, with the option to purchase, list the hourly/weekly/monthly rental rate. Indicate the percent of rental fee paid by the purchaser that will be applied to the purchase price. (See Solicitation Special Terms & Conditions.)

Hourly Rental Rate:	N/A
Weekly Rental Rate:	N/A
Monthly Rental Rate:	N/A
Percent (%) of Rental Fee applied toward purchase price:	

6.0 Vendor Owned Rental or Demo Attachment Sales Program

(See Solicitation Special Terms and Conditions.)

<u>DEDUCT</u> 'Cost per Used Hour' from the original Contract Price	N/A
--	-----

Warranty Program Options:

(provide details)

N/A

RockHound
Price Pages
July 1, 2013

The Original RockHound 60B Landscape Rake



Model No. **60B**

Suggested List Price

\$8,285

Includes 1 pair of complementary hydraulic hoses and 3/4" flat faced hyd. couplers.

B-3 Series (3-POINT MOUNT) Includes B-3 Conversion Kit

Model No. **60B-3**

Suggested List Price

\$9,748

Includes 1 pair of complementary hydraulic hoses and 3/4" flat faced hyd. couplers.

Note: Tractor must have 2 hyd circuits & 6 GPM hydraulic flow. To convert a 60B to 3 point hitch tractor mount items below are required.

B-3 SERIES = 3-pt hitch SSA Plate cat. 1 & 2
3x12 Top Link Dump Cylinder w/o hoses

B-3 Conversion Kit

Suggested List Price

\$1,463

Features

- Picks up rocks down to 3/4" (19mm)
- Hydraulic cylinder opens top cover-for easy dumping, and also allows the bucket to be used separately
- Rake bars provide better leveling and longer ground contact (replaceable, bolt on)
- High strength teeth for the longest life
- Adjustable side skids provide accurate depth control

Specifications

- Working Width 60" (152.4cm)
- Overall Width 67" (170.1cm)
- Weight 1010 lbs. (485 kg)
- Number of Tooth Bars 12
- Number of Teeth (total) 384
- Capacity 10 Cu. Ft. (0.28 cu.m.)
- 6-13 gpm hydraulics minimum

NOTE: Consult your loader or tractor's manual to insure lift capacities are not exceeded. "B3" models feature 3 point hitch mounting for utility tractors. Specifications and design are subject to change without notice. Safety begins with a thorough understanding of the equipment. Always make sure you and your operators read the Operator's Manual before using the equipment. Pay close attention to all safety and operating decals and never operate machinery without all shields, protective devices and structures in place. Specifications are applicable to units sold in Canada, the United States, its territories and possessions, and may vary outside these areas. © 2011 Rock-Hound Attachments. Visit our web site at www.rockhound.com Or, call toll-free: 1-800-426-5615 PRINTED IN U.S.A.

The Original RockHound 72B Landscape Rake

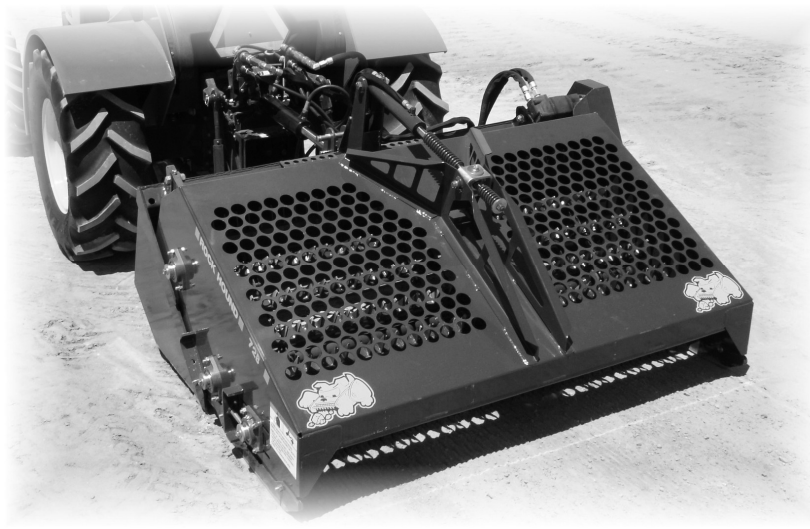

Model No. **72B**

Suggested List Price

\$9,150

Includes 1 pair of complementary hydraulic hoses and 3/4" flat faced hyd. couplers.

B-3 Series (3-POINT MOUNT) Includes B-3 Conversion Kit

Model No. **72B-3**

Suggested List Price

\$10,614

Includes 1 pair of complementary hydraulic hoses and 3/4" flat faced hyd. couplers.

Note: Tractor must have 2 hyd circuits & 6 GPM hydraulic flow. To convert a 72B to 3 point hitch tractor mount items below are required.

B-3 SERIES = 3-pt hitch SSA Plate cat. 1 & 2
3x12 Top Link Dump Cylinder w/o hoses

B-3 Conversion Kit

Suggested List Price

\$1,463

Features

- Picks up rocks down to 3/4" (19mm)
- Hydraulic cylinder opens top cover-for easy dumping, and also allows the bucket to be used to scrape high spots
- Rake bars provide better leveling and longer ground contact (replaceable, bolt on)
- High strength teeth for the longest life
- Adjustable side skids provide accurate depth control

Specifications

- Working Width 72" (182.8 cm)
- Overall Width 79" (200.6cm)
- Weight 1130 lbs. (510 kg)
- Number of Tooth Bars 12
- Number of Teeth (total) 484
- Capacity 12 Cu. Ft. (0.34 cu.m.)
- 6-13 gpm hydraulics minimum

NOTE: Consult your loader or tractor's manual to insure lift capacities are not exceeded. "B3" models feature 3 point hitch mounting for utility tractors. Specifications and design are subject to change without notice. Safety begins with a thorough understanding of the equipment. Always make sure you and your operators read the Operator's Manual before using the equipment. Pay close attention to all safety and operating decals and never operate machinery without all shields, protective devices and structures in place.

Specifications are applicable to units

sold in Canada, the United States, its territories and possessions, and may vary outside these areas. © 2011 RockHound Attachments. Visit our web site at www.rockhound.com Or, call toll-free: 1-800-426-5615 PRINTED IN U.S.A.

The RockHound 48C Compact Landscape Rake For mini skid steer loaders & compact tractors



Model No **48C**
Suggested List Price
\$5,839

C-3 Series (3-POINT MOUNT) Includes B-3 Conversion Kit

Model No. **48C-3**
Suggested List Price
\$7,106

Includes 1 pair of complementary hydraulic hoses and 3/4" flat faced hyd. couplers.

Note: Tractor must have 2 hyd circuits & 6 GPM hydraulic flow. To convert a 48C to 3 point hitch tractor mount, items below are required.

C& B-3 SERIES = 3-pt hitch SSA Plate cat. 1 & 2
3x12 Top Link Dump Cylinder w/o hoses

B C-3 Conversion Kit
Suggested List Price
\$1,267

Features

- Rakes up rocks down to 3/4" (19mm)
- Rake bars provide better leveling and longer ground contact (replaceable, bolt on)
- High strength teeth for the longest life
- Adjustable side skids for depth control
- Light weight and versatile
- Optional custom mount call for price

Specifications

- Working Width 46" (116.9 cm)
- Overall Width 52" (132 cm)
- Weight 520 lbs. (235.8kg)
- Number of Tooth Bars 10
- Number of Teeth (total) 250
- Capacity rakes only
- 6-13 gpm hydraulics recommended

NOTE: Consult your loader or tractor's manual to insure lift capacities are not exceeded. "C3" models feature 3 point hitch mounting for utility tractors. Specifications and design are subject to change without notice. Safety begins with a thorough understanding of the equipment. Always make sure you and your operators read the Operator's Manual before using the equipment. Pay close attention to all safety and operating decals and never operate machinery without all shields, protective devices and structures in place. Specifications

are applicable to units sold in Canada, the United States, its territories and possessions, and may vary outside these areas. © 2011 RockHound Attachments. Visit our web site at www.rockhound.com Or, call toll-free: 1-800-426-5615 PRINTED IN U.S.A.

The RockHound Cat 1&2 3-point skid steer adapter plate & accessories

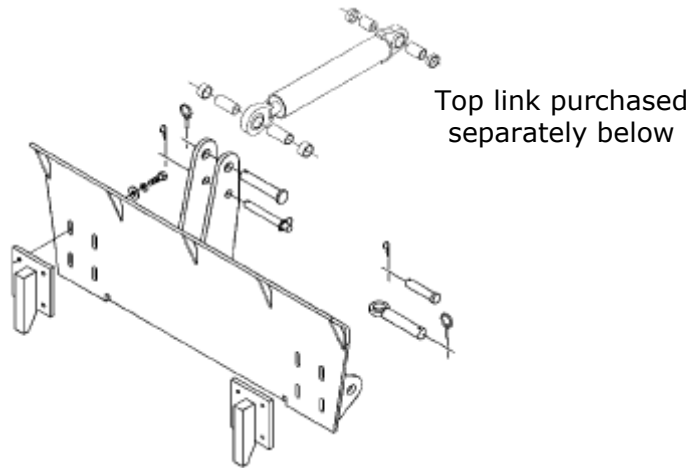

Top link purchased
separately below

Model No.

Skid Steer Adapter Plate #SSA

Suggested List Price

\$605

3.5" x 12" Top Link cylinder #TLC12

Does not include hydraulic hoses or couplers

Suggested List Price

\$645

2 spool hydraulic valve w/ d-tent #HV2S

Does not include hydraulic hoses or couplers

Suggested List Price

\$565

Features

Permits the use of a wide variety of skid-steer attachments such as pallet forks and many landscape tools on tractor 3-point.

Rugged design and positive locking wedges.

Quickly pins to tractor 3-point and wedge attaches to your skid-steer attachments.

Designed to be used with or without top link cylinder kit (shown).

Top link cylinder kit replaces the tractor top link for hydraulically positioning attachments. Note hoses are not included.

2 spool is required to convert older tractors with 4 quick couplers to operate all rake functions and dump / down force ram.

NOTE: Consult your loader or tractor's manual to insure lift capacities are not exceeded. "B3 & C3" models feature 3 point hitch mounting for utility tractors. Specifications and design are subject to change without notice. Safety begins with a thorough understanding of the equipment. Always make sure you and your operators read the Operator's Manual before using the equipment. Pay close attention to all safety and operating decals and never operate machinery without all shields, protective devices and structures in place. Specifications

are applicable to units sold in Canada, the United States, its territories and possessions, and may vary outside these areas. © 2011 RockHound Attachments. Visit our web site at www.rockhound.com Or, call toll-free: 1-800-426-5615 PRINTED IN U.S.A.

The BrushHound F Series Front Finish Mower

safe, rugged & reliable flail mower



Shown with optional front caster style gauge wheel

Model No. **48F**
Suggested List Price
\$6,490

Model No. **60F**
Suggested List Price
\$6,732

Model No. **72F**
Suggested List Price
\$6,975

Optional foam filled, front "caster style" adjustable gauge wheel
#HDWK Suggested List Price
\$830

Includes complementary hydraulic hoses and 3/4" flat faced couplers

Specifications & Features

Working Width	46" (116.8cm)	58" (147.3cm)	72" (182.8 cm)
Overall Width	56" (142.2cm)	68" (172.7cm)	80" (203.2 cm)
Weight	637 lbs. (288.9 kg)	722 lbs. (327.5 kg)	837 lbs. (379.8 kg)
Cutting Height	0-6" (0-15.2 cm)	0-6" (0-15.2 cm)	0-6" (0-15.2 cm)
# of knives	42 HD industrial knives	54 HD industrial knives	66 HD industrial knives
Capacity	1". (5.1 cm.)	1". (5.1 cm.)	1". (5.1 cm.)
HP required	18hp / 8 gpm	22hp / 10 gpm	32hp / 13 gpm

- Front & rear discharge flaps to minimize throw
- Standard universal skid steer style hitch mount
- Heavy duty reversible hydraulic drive
- High strength welded steel construction
- Reversible electronically balanced industrial knives
- Adjustable ground roller height control
- Replaceable, adjustable side skid shoes
- Optional grass scoop or dethatching knives

NOTE: Consult your skid steer loader's "Operators Manual" to insure lift capacities are not exceeded. Safety begins with a thorough understanding of the equipment. Always make sure you and your operators read the Operator's Manual before using the equipment. Pay close attention to all safety and operating decals, never operate machinery without all shields, protective devices and structures in place.

Specifications are applicable to units sold in Canada, the United States, its territories and possessions, and may vary outside these areas. © 2011 RockHound Attachments. Visit our website at www.rockhound.com Or, call toll-free: 1-800-426-5615 PRINTED IN U.S.A.

The BrushHound FH Series Front Brush Shredder

Heavy duty cost effective brush mower



Model No. **60FH**

Suggested List Price \$ **11,652**

optional Triple Knife \$ 12,084

Model No. **72FH**

Suggested List Price \$ **11,956**

optional Triple Knife \$ 12,442

Model No. **84FH**

Suggested List Price \$ **12,534**

optional Triple Knife \$13,074

Includes complementary hydraulic hoses
and 3/4" flat faced couplers, case drain 3rd line
Available in high flow or standard flow with 3400 psi

Specifications & Features

	60FH	72FH	84FH
Working Width	60"(152.4 cm)	72" (182.8 cm)	84" (213.3 cm)
Overall Width	72"(182.8 cm)	84" (213.3 cm)	96" (243.8 cm)
Weight	1475 lbs (669kg)	1625lbs (737kg)	1850lbs (839kg)
Cutting Height	0-6" (0-15.2 cm)	0-6" (0-15.2 cm)	0-6" (0-15.2 cm)
# of "J" knives 2.25lb	32 HD 72 lbs	40 HD 90 lbs	48 HD 108 lbs
# of "I" knives 2.0lb	16 HD 32 lbs=104#	20 HD 40 lbs=130#	24 HD 48 lbs =156# total
Capacity	5". (12.7cm.)	4".(10.6cm.)	3". (7.6cm.)
Horsepower required	30-60+ hp	50-80+ hp	70-125+ hp
GPM recommendations	16-20+ gpm	18-30+ gpm	20-40+ gpm

- Electronically balanced cutter drums
- Industry standard skid steer mount
- High strength double liner & 1/2" end plates
- Severe duty sched 80 1/2" thick cutter drum
- Adjustable ground roller height control
- Chain debris discharge curtain
- Reversible 2.25 pound flail knives standard
- Optional front "T" bar push bumper
- Optional replaceable side skid shoes
- Optional 5000 psi piston motor upgrade

NOTE: Consult your power unit's operators manual to insure lift capacities are not exceeded. Safety begins with a thorough understanding of the equipment. Always make sure you and your operators read the Operator's Manual before using the equipment. Pay close attention to all safety and operating decals and never operate machinery without all shields, protective devices and structures in place.

Specifications are applicable to units sold in Canada, the United States, its territories and possessions, and may vary outside these areas. © 2011 RockHound Attachments. Visit our website at www.rockhound.com Or, call toll-free: 1-800-426-5615 PRINTED IN U.S.A.

The BrushHound "Push Pull Mower" Can operate on both ends of the tractor



Model No.

2120F-C3

2120F-C 10' Suggested List Price **\$12,739**

Model No.

2180F-C3

2180F-C 15' Suggested List Price **\$14,163**

SPECIFICATIONS & FEATURES

- Safely cut and mulch material quickly
- Standard cat 1 & 2- 3 point hitch style mount
- Heavy duty reversible gear box & driveline
- High strength steel construction & internal liners
- Reversible electronically balanced industrial knives
- Adjustable ground roller height control
- Adjustable / replaceable side skid shoes
- Standard front adjustable caster wheels

Working Width	10' - 15'
Overall Width	12' - 16'
Weight	2440= 10' 3130=15'
Cutting Height	0-6" (0-15.2 cm)
Number of knives	112=10' - 184=15'
Capacity	under 1.5". (3.8 cm.)
Horsepower required (minimum)	75 hp

Call for pricing on special configurations and sizes

NOTE: Consult your power unit's manual to insure lift capacities are not exceeded. Both models feature Cat 2 three point hitch. Custom mounting options are available call for pricing. Safety begins with a thorough understanding of the equipment. Always make sure you and your operators read the Operator's Manual before using the equipment. Pay close attention to all safety and operating decals and never operate machinery without all shields, protective devices and structures in place.

Specifications are applicable to units sold in Canada, the United States, its territories and possessions, and may vary outside these areas. © 2011 RockHound Attachments. Visit our website at www.rockhound.com Or, call toll-free: 1-800-426-5615 PRINTED IN U.S.A.

Valley Tool & Manufacturing Limited 12 Month Warranty

For a period of 12 months from date of delivery of product to the original user/owner, Valley Tool & Mfg. warrants each product to be free from manufacturing defects, subject to the limitations contained in this policy.

This warranty does not apply to defect caused, in whole or in part, by unreasonable use while in the possession of the user, including, but not limited to: failure to properly set up product; failure to provide reasonable and necessary maintenance; normal wear; routine tune ups or adjustments; improper handling or accidents; operation at speed or load conditions contrary to published specification; improper or insufficient lubrication; improper storage. This warranty is also not a guarantee that the performance of each product will meet the expectations of the purchaser.

Valley Tool & Mfg. shall not be liable for consequential damages of any kind, including, but not limited to: consequential labor costs or transportation charges in connection with the replacement or repair of defective parts; lost time or expense which may have accrued because of said defects. In no event shall Valley Tool & Mfg. total liability hereunder exceed the product purchase price.

Valley Tool & Mfg. makes no warranty with respect to trade accessories or any components or accessory of the product which was not manufactured by Valley Tool & Mfg., including any purchased components of any kind. These are subject to the warranties of their respective manufacturers. The warranty will be considered void if the product or any part of the product is modified or repaired in any way not expressly authorized by Valley Tool & Mfg., or if closed components are disassembled prior to return. Closed components include, but are not limited to: gearboxes, hydraulic pumps, motors, cylinders, and actuators.

Our obligation under the warranty is expressly limited, at our option, to the replacement or repair at Valley Tool & Mfg., of Hughson CA, or at a service facility designated by us, or such part or parts as inspection shall disclose to have been defective. We are not responsible for unauthorized repairs or replacements. Warranty must be pre approved. Authorized parts will be sent to dealer 2nd day UPS at no charge. Any implied or statutory warranties, including any warranty merchantability or fitness for a particular purpose, are expressly limited to the duration of this written warranty. We make no other express or implied warranty, nor is anyone authorized to make any on our behalf. This warranty cannot be extended, broadened, or changed except in writing by an authorized officer of Valley Tool & Mfg.

Travel time of mechanics and transportation of the product to the authorized service dealer for warranty work are the responsibility of the attachment owner.

Warranty Registration

Customer's Name: _____	Dealer's Name: _____
Address: _____	Address: _____
City: _____ State: _____ Zip: _____	City: _____ State: _____ Zip: _____
Phone: _____	Phone: _____
Check one:	
Equipment Model: _____	Construction Use: _____
Delivery Date: _____	Agricultural Use: _____
Model or Part # : _____	Landscape Use: _____
Serial #: _____	Other: _____

Dealer Inspection (check items applicable)

_____ All Decals installed (see operator's manual)	_____ Review Operating & Safety Instructions
_____ Hydraulic fittings tight & free of leaks	_____ Guards & covers in place & secure
_____ Fasteners tight	_____ Product functions properly

I have read the warranty and have thoroughly instructed the buyer on the above described equipment. This review included: The Operator's manual content, equipment care, adjustments, safe operation and applicable warranty policy.

Date: _____ Dealer's Rep. Signature: _____