

# OWNER'S GUIDE

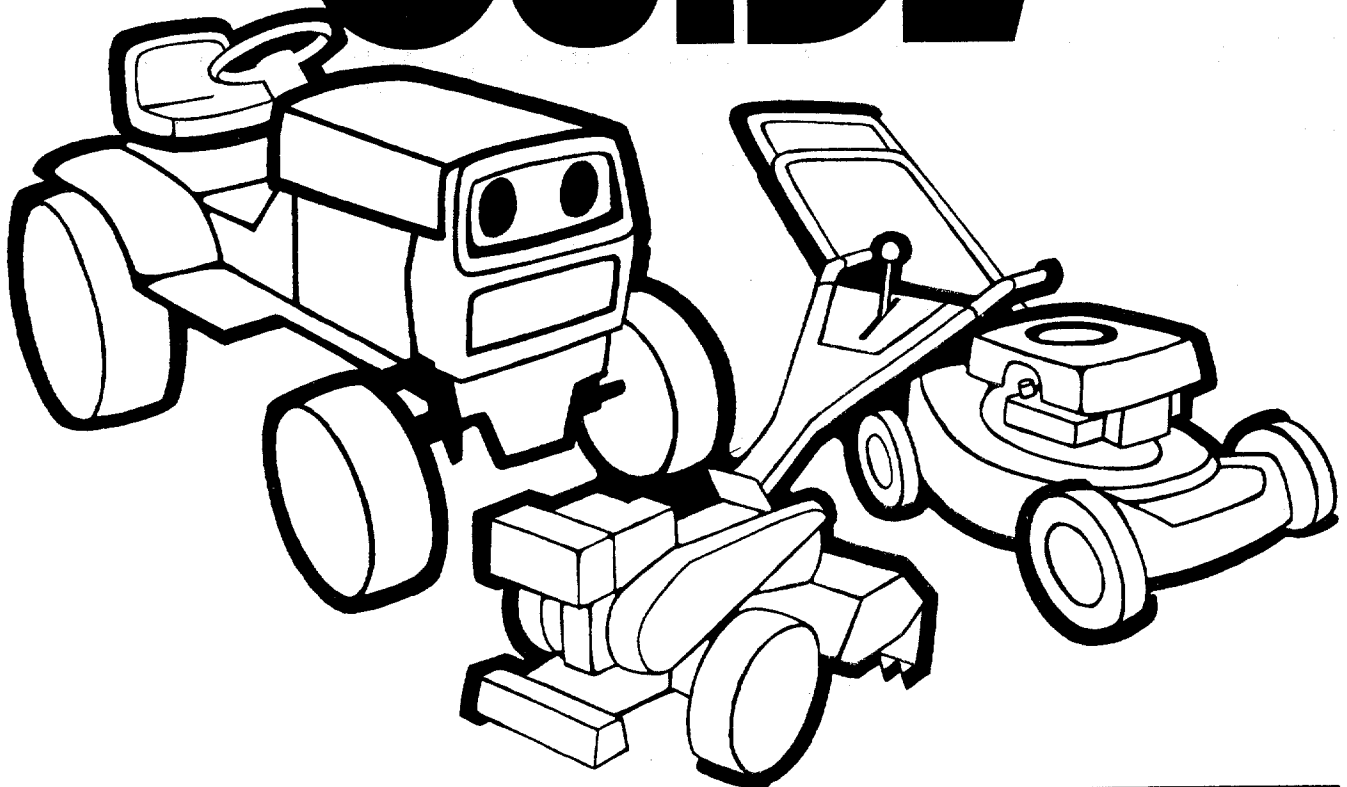

**ASSEMBLY  
OPERATION  
MAINTENANCE  
PARTS LIST**

**IMPORTANT:  
Read Safety Rules  
and Instructions**

**MODEL NUMBERS**

**240-670A**

**240-680A**

**POWER  
VACUUMS**

# INDEX

|                                |   |                         |              |
|--------------------------------|---|-------------------------|--------------|
| Safe Operation Practices ..... | 3 | Exploded Views .....    | 6, 8, 10, 12 |
| Assembly Instructions .....    | 4 | Repair Parts List ..... | 7, 9, 11, 12 |
| Operation Instructions .....   | 5 | Parts Information ..... | Back Cover   |
| Adjustments .....              | 5 |                         |              |

## LIMITED WARRANTY

For one year from the date of original retail purchase, MTD PRODUCTS INC will either repair or replace, at its option, free of charge, F.O.B. factory or authorized service firm, any part or parts found to be defective in material or workmanship. Transportation charges for any parts submitted for replacement under this warranty must be paid by the purchaser unless such return is requested by MTD PRODUCTS INC.

This warranty will not apply to any part which has become inoperative due to misuse, excessive use, accident, neglect, improper maintenance, alterations, or unless the unit has been operated and maintained in accordance with the instructions furnished. This warranty does not apply to the engine, motor, battery, battery charger or component parts thereof. Please refer to the applicable manufacturer's warranty on these items.

This warranty will not apply where the unit has been used commercially.

Warranty service is available through your local authorized service dealer or distributor. If you do not know the dealer or distributor in your area, please write to the Customer Service Department of MTD.

The return of a complete unit will not be accepted by the factory unless prior written permission has been extended by MTD.

This warranty gives you specific legal rights. You may also have other rights which vary from state to state.

### WARNING TO PURCHASERS OF INTERNAL COMBUSTION ENGINE EQUIPPED MACHINERY OR DEVICES IN THE STATE OF CALIFORNIA

The equipment which you have just purchased does not have a spark arrester. If this equipment is used on any forest covered land, brush covered land, or grass covered unimproved land in the State of California, before using on such land, the California law requires that a spark arrester be provided. In addition, spark arrester is required by law to be in effective working order. The spark arrester must be attached to the exhaust system and comply with Section 4442 of the California Public Resources Code.

## **IMPORTANT**

It is suggested that this manual be read in its entirety before attempting to assemble or operate. Keep this manual in a safe place for future reference and for ordering replacement parts.

This unit is shipped WITHOUT GASOLINE or OIL. After assembly, see operating section of this manual for proper fuel and amount.

### **SAFE OPERATION PRACTICES FOR POWER VACUUMS**

1. Read the operating and service instructing manual carefully. Be thoroughly familiar with the controls and proper use of the power vacuum.
2. Never allow children to operate this power vacuum.
3. Keep the area of operation clear of all persons, particularly small children and pets.
4. Check fuel before starting engine. Do not fill fuel tank indoors, when engine is running, or while engine is hot. Wipe off any spilled fuel before starting engine.
5. Do not change engine governor settings.
6. Do not put hands near rotating parts for any reason.
7. If the power vacuum should start to vibrate abnormally, stop the engine and check immediately for the cause. Vibration is generally a warning of trouble.
8. Before cleaning, repairing or inspecting make certain all moving parts have come to a complete stop. Disconnect spark plug wire and keep wire away from plug to prevent accidental starting. Also keep throttle control lever in the stop position.
9. If the power vacuum should become blocked with debris at any point shut engine off and wait until the impeller comes to a complete stop before attempting to remove the obstruction. Disconnect spark plug wire to prevent accidental starting.
10. Check all bolts for tightness at frequent periods.
11. Never store this power vacuum with fuel in the tank. Allow engine to cool before starting in any enclosure.
12. Keep bag and equipment free of debris when not in use.
13. Never operate this power vacuum unless air duct and vacuum bag are properly affixed in their place. Large zippered end of bag must be closed when operating to prevent objects from being blown out.
14. Never empty vacuum bag when engine is running.
15. Never change inlet nozzle or auxiliary hose attachment when engine is running.
16. The manufacturer recommends that the operator wear safety glasses or some other suitable eye protection when operating this machine.
17. Check the vacuum bag frequently for wear and replace when necessary.

# ASSEMBLY INSTRUCTIONS

(Refer to figures 1, 2 and 3)

1. Place the upper handle in position and fasten with four (4) hex screws and hex centerlock nuts provided.
2. Place the air duct liner (studded end first) into the elbow of air duct. See figure 1.

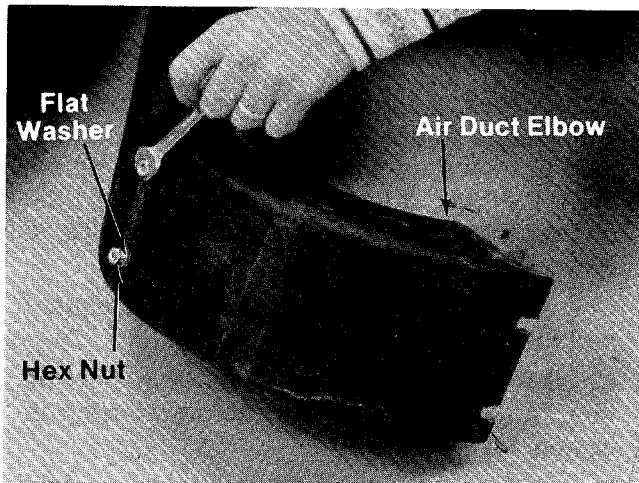

FIGURE 1.

3. Insert studs of air duct liner through holes in air duct. Thread on two (2) flat washers and hex nuts (provided) several turns—do not tighten. See figure 2.

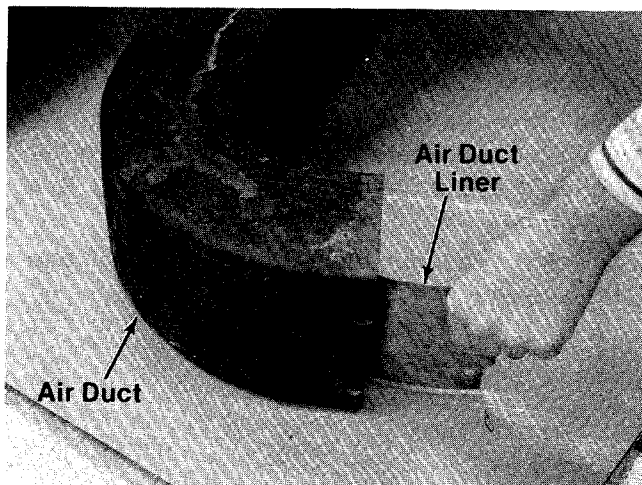

FIGURE 2.

4. Place the air duct in position on the blower housing and fasten with four (4) flat washers and hex nuts provided. See figure 3.

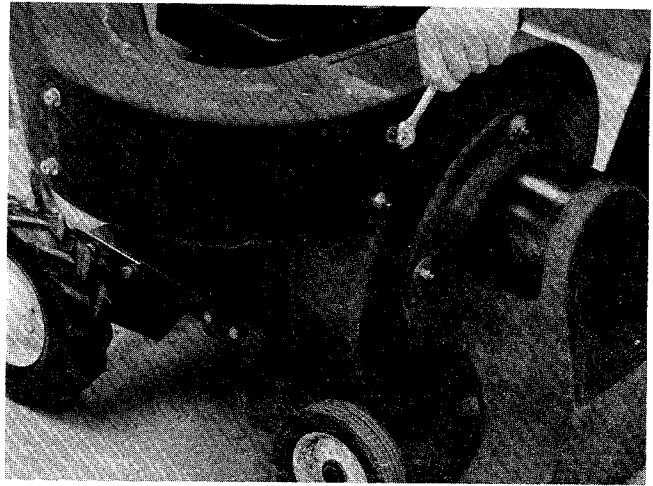

FIGURE 3.

5. Secure the two (2) hex nuts onto the air duct liner studs at the air duct elbow.
6. Slide the vacuum bag over the back of the upper handle and snap the four flaps to hold the bag.
7. Fasten the deflector on the top of the air duct with three hex screws, flat washers and hex nuts. (See figure 1.)
8. Slide the bag over the air duct.
9. Fasten the nozzle to the front of the vacuum with four flat washers and thumb nuts provided.
10. Use the following steps on the self propelled unit only.
11. Fasten the throttle control to the right hand side of the upper handle with one hex screw and hex center locknut provided.
12. Secure throttle control cable to the lower handle with the cable clip provided.

## NOTE

Cable clip must be assembled to lower handle with the open end towards the engine. This will prevent wear to the bag.

13. Place ferrule through control lever.
14. Place flat washer over ferrule and thread control rod into ferrule about eight or nine turns.
15. Hook formed end of control rod in the shifting finger.
16. Place curved face of spacer towards the outside of upper handle left hand side.

## **IMPORTANT**

It is suggested that this manual be read in its entirety before attempting to assemble or operate. Keep this manual in a safe place for future reference and for ordering replacement parts.

This unit is shipped WITHOUT GASOLINE or OIL. After assembly, see operating section of this manual for proper fuel and amount.

### **SAFE OPERATION PRACTICES FOR POWER VACUUMS**

1. Read the operating and service instructing manual carefully. Be thoroughly familiar with the controls and proper use of the power vacuum.
2. Never allow children to operate this power vacuum.
3. Keep the area of operation clear of all persons, particularly small children and pets.
4. Check fuel before starting engine. Do not fill fuel tank indoors, when engine is running, or while engine is hot. Wipe off any spilled fuel before starting engine.
5. Do not change engine governor settings.
6. Do not put hands near rotating parts for any reason.
7. If the power vacuum should start to vibrate abnormally, stop the engine and check immediately for the cause. Vibration is generally a warning of trouble.
8. Before cleaning, repairing or inspecting make certain all moving parts have come to a complete stop. Disconnect spark plug wire and keep wire away from plug to prevent accidental starting. Also keep throttle control lever in the stop position.
9. If the power vacuum should become blocked with debris at any point shut engine off and wait until the impeller comes to a complete stop before attempting to remove the obstruction. Disconnect spark plug wire to prevent accidental starting.
10. Check all bolts for tightness at frequent periods.
11. Never store this power vacuum with fuel in the tank. Allow engine to cool before starting in any enclosure.
12. Keep bag and equipment free of debris when not in use.
13. Never operate this power vacuum unless air duct and vacuum bag are properly affixed in their place. Large zippered end of bag must be closed when operating to prevent objects from being blown out.
14. Never empty vacuum bag when engine is running.
15. Never change inlet nozzle or auxiliary hose attachment when engine is running.
16. The manufacturer recommends that the operator wear safety glasses or some other suitable eye protection when operating this machine.
17. Check the vacuum bag frequently for wear and replace when necessary.

# ASSEMBLY INSTRUCTIONS

(Refer to figures 1, 2 and 3)

1. Place the upper handle in position and fasten with four (4) hex screws and hex centerlock nuts provided.
2. Place the air duct liner (studded end first) into the elbow of air duct. See figure 1.

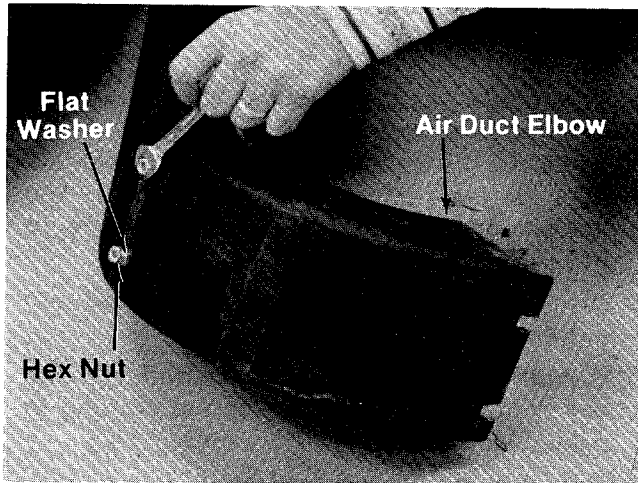

**FIGURE 1.**

3. Insert studs of air duct liner through holes in air duct. Thread on two (2) flat washers and hex nuts (provided) several turns—do not tighten. See figure 2.

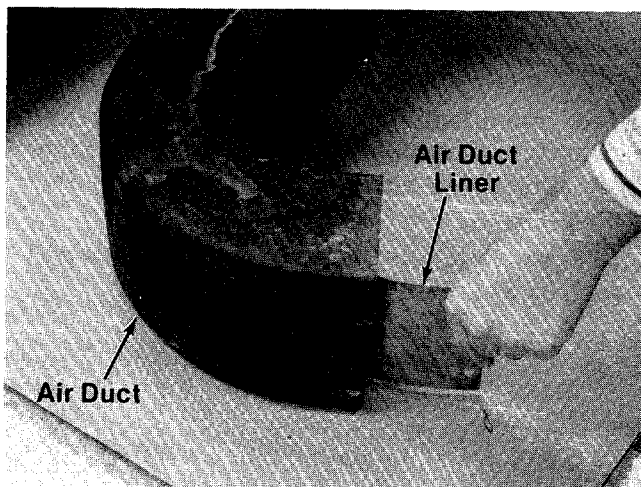

**FIGURE 2.**

4. Place the air duct in position on the blower housing and fasten with four (4) flat washers and hex nuts provided. See figure 3.

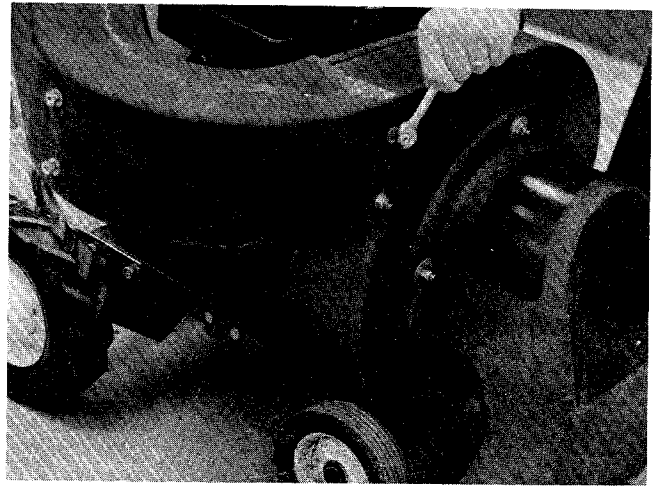

**FIGURE 3.**

5. Secure the two (2) hex nuts onto the air duct liner studs at the air duct elbow.
6. Slide the vacuum bag over the back of the upper handle and snap the four flaps to hold the bag.
7. Fasten the deflector on the top of the air duct with three hex screws, flat washers and hex nuts. (See figure 1.)
8. Slide the bag over the air duct.
9. Fasten the nozzle to the front of the vacuum with four flat washers and thumb nuts provided.
10. Use the following steps on the self propelled unit only.
11. Fasten the throttle control to the right hand side of the upper handle with one hex screw and hex center locknut provided.
12. Secure throttle control cable to the lower handle with the cable clip provided.

**➔ NOTE**

Cable clip must be assembled to lower handle with the open end towards the engine. This will prevent wear to the bag.

13. Place ferrule through control lever.
14. Place flat washer over ferrule and thread control rod into ferrule about eight or nine turns.
15. Hook formed end of control rod in the shifting finger.
16. Place curved face of spacer towards the outside of upper handle left hand side.

17. Fasten control lever in position with hex screw and two hex nuts provided.
18. Engage and disengage control lever, check for free pivoting action. It may be necessary to readjust the control rod.

## **OPERATION**

1. Service engine with gas and oil. See engine manual packed with vacuum for complete instructions for care and maintenance of engine. READ DIRECTIONS CAREFULLY.

### **START ENGINE**

After the engine has been properly fueled and oiled (refer to engine operating and maintenance instructions), start engine in the following manner.

### **PUSH MODEL**

1. Move throttle control lever on engine to START position.
2. Crank engine. Pull recoil with a quick firm pull. Do not pull out so far that rope stops with a jerk as this will cause rope failure. Do not allow rope and handle to snap back into place.
3. After two or three full firm pulls on recoil (or as soon as engine fires), move speed control to run position.

4. Operate a new engine at intermediate speeds and light load for the first few hours as you would a new automotive engine.
5. To stop engine, move speed control lever on engine to STOP position.
6. If carburetor needs adjustment to start or for operation, see "Carburetor Readjustment" section.

### **SELF PROPELLED MODEL**

1. Place drive engagement lever in the neutral position (towards the operator).
2. Move throttle control lever on handle to START position.
3. Crank engine. Pull recoil with a quick firm pull. Do not pull out so far that rope stops with a jerk as this will cause rope failure. Do not allow rope and handle to snap back into place.

## **ADJUSTMENTS**

### **HEIGHT ADJUSTMENT**

Standing on the right hand side of vacuum move the index handle towards the left. Move handle towards rear of unit to lower height. Move the handle forward to raise the height.

# 240-670A 240-680A

IF YOU WRITE TO US ABOUT THIS ARTICLE  
OR IF YOU ORDER REPLACEMENT PARTS AL-  
WAYS MENTION THIS MODEL & SERIAL NO  
MODEL

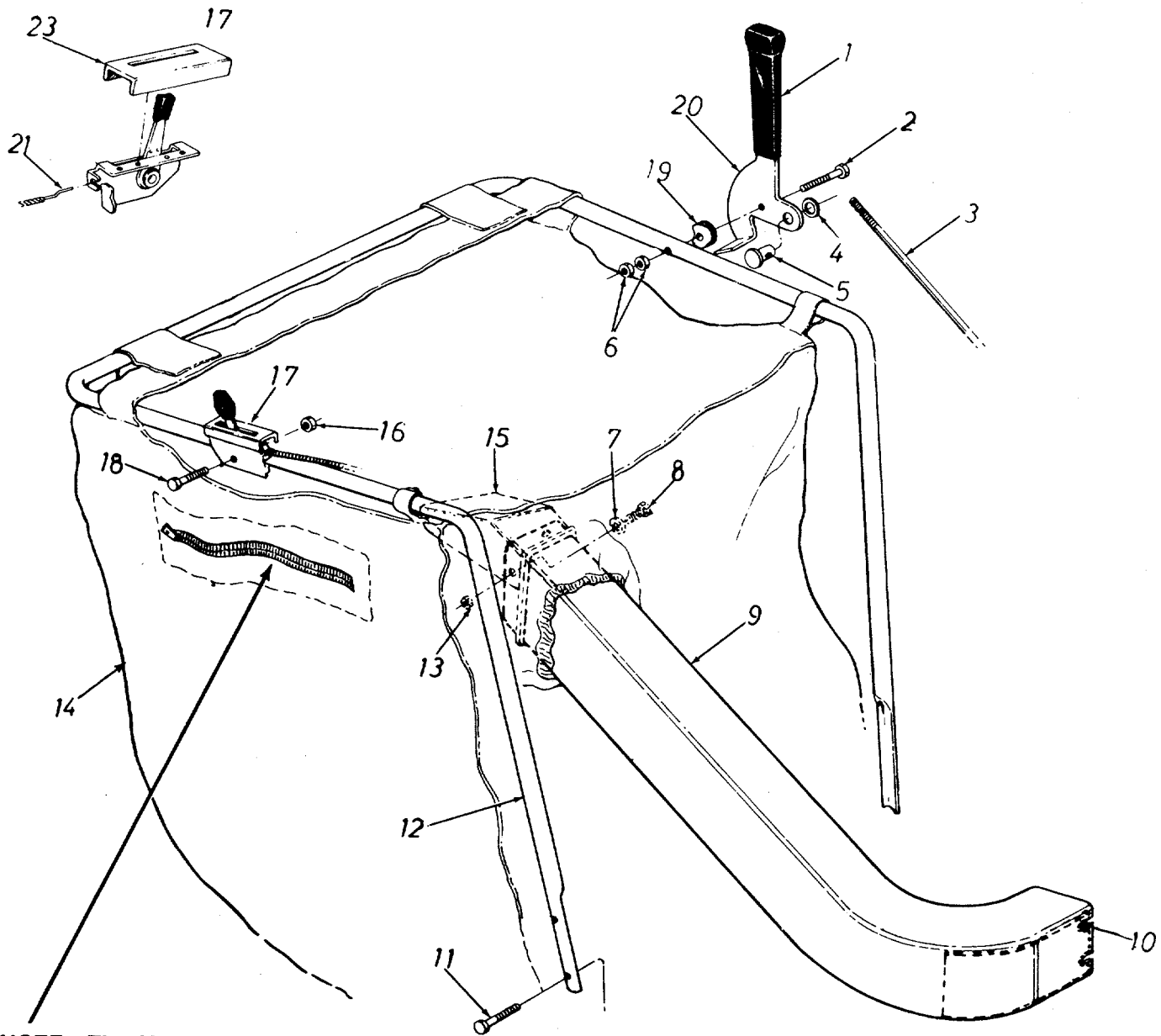

**NOTE:** The Vacuum Bag has an air escape located on the upper right hand side. This should be open when the bag becomes half full.

**EXPLODED VIEW OF UPPER HANDLE**



**PARTS LIST FOR MODELS 240-670A AND 240-680A**

| REF. NO. | PART NO. | COLOR CODE | DESCRIPTION                             | NEW PART |
|----------|----------|------------|---|----------|
| 1        | 720-0142 |            | Grip (680A)                             |          |
| 2        | 710-0606 |            | Hex Bolt 1/4-20 x 1.50" Lg.* (680A)     |          |
| 3        | 711-0596 |            | Control Rod (680A)                      |          |
| 4        | 736-0108 |            | Fl. Wash. .510" I.D. x .75" O.D. (680A) |          |
| 5        | 711-0179 |            | Adj. Ferrule (680A)                     |          |
| 6        | 712-0107 |            | Hex Center L-Nut 1/4-20 Thd. (680A)     |          |
| 7        | 736-0173 |            | Flat Wash. .28" I.D. x .75" O.D. x .063 |          |
| 8        | 710-0289 |            | Hex Bolt 1/4-20 x .50" Lg.*             |          |
| 9        | 731-0404 |            | Air Duct                                |          |
| 10       | 13316    |            | Air Duct Liner                          |          |
| 11       | 710-0106 |            | Hex Bolt 1/4-20 x 1.25" Lg.*            |          |
| 12       | 12234    |            | Upper Handle                            |          |
| 13       | 712-0107 |            | Hex Center L-Nut 1/4-20 Thd. (680A)     |          |
| 14       | 764-0127 |            | Vacuum Bag                              |          |
| 15       | 12104    |            | Deflector                               |          |
| 16       | 712-0107 |            | Hex Center L-Nut 1/4-20 Thd. (680A)     |          |
| 17       | 746-0202 |            | Throttle Control Ass'y.—Comp. (680A)    |          |
| 18       | 710-0606 |            | Hex Bolt 1/4-20 x 1.50" Lg.* (680A)     |          |
| 19       | 748-0210 |            | Spacer (680A)                           |          |
| 20       | 12226    |            | Control Lever(680A)                     |          |
| 21       | 746-0229 |            | Conduit and Wire                        |          |
| 23       | 731-0344 |            | Plastic Label                           |          |

\*For faster service obtain standard nuts, bolts and washers locally. If these items cannot be obtained locally, order by part number and size as shown on parts list.

(488—Mack Truck Yellow)

When ordering parts, if color or finish is important use the appropriate color code shown above. (e.g. Mack Truck Yellow Finish—12236 (488).)

NOTE: The engine is not under warranty by the vacuum manufacturer...If repairs or service is needed on the engine, please contact your nearest authorized engine service outlet. Check the "Yellow Pages" of your telephone book under "Engines—Gasoline."



**NOTE**

This instruction manual covers various models and all specifications shown do not necessarily apply to your model. Specifications subject to change without notice or obligation.

# 240-670A 240-680A



## NOTE

Cable clip must be assembled to lower handle as shown, with open end towards the engine. This will prevent wear to the bag.

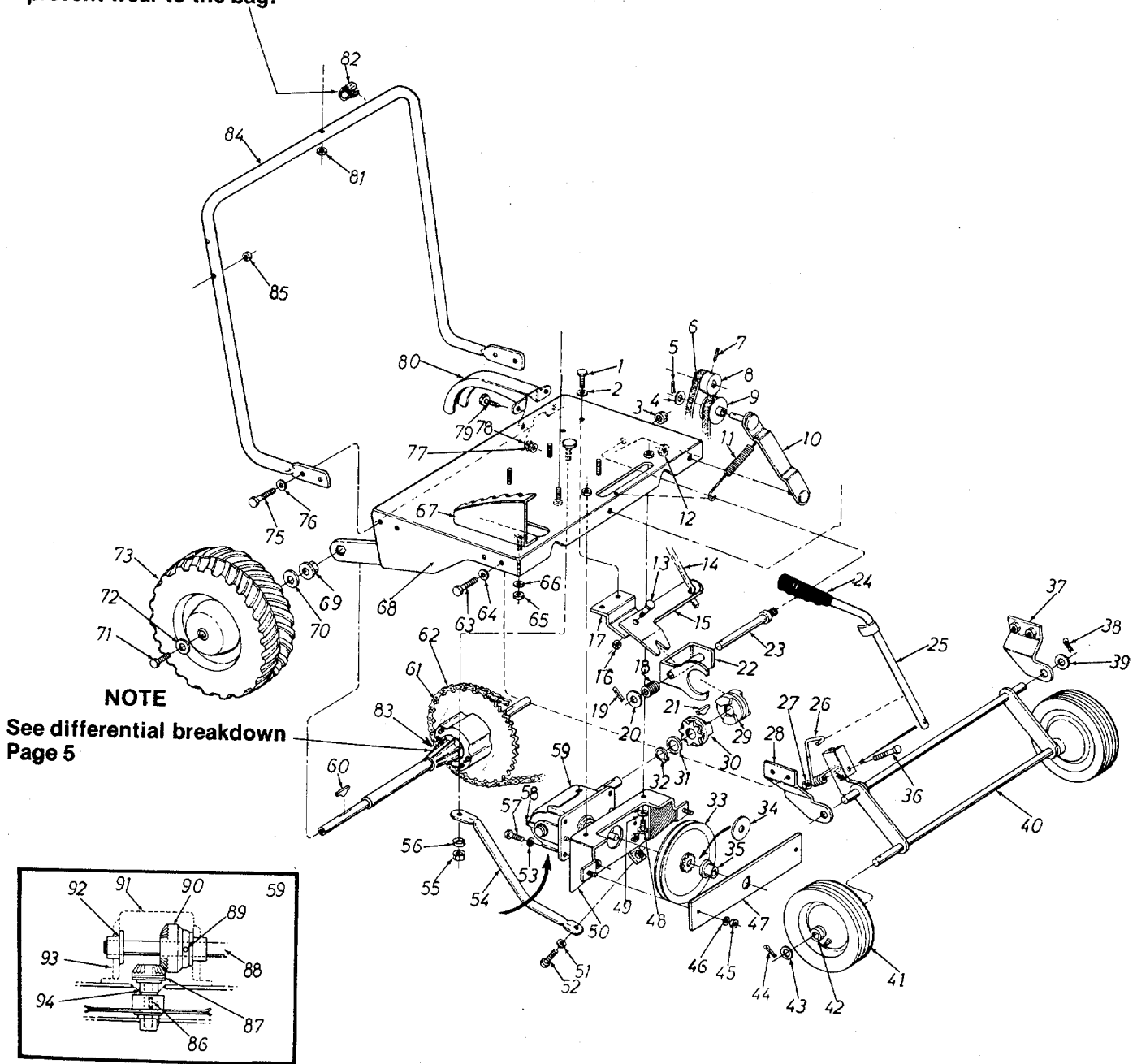

## NOTE

See differential breakdown  
Page 5

EXPLODED VIEW OF FRAME

PARTS LIST FOR MODELS 240-670A AND 240-680A

| REF. NO. | PART NO. | COLOR CODE | DESCRIPTION                                      | NEW PART | REF. NO. | PART NO. | COLOR CODE | DESCRIPTION  | NEW PART |
|----------|----------|------------|--|----------|----------|----------|------------|--|----------|
| 1        | 710-0258 |            | Hex Scr. 1/4-20 x .62" Lg.* (680A)               |          | 49       | 736-0119 |            | L-Wash. 5/16" Scr.* (680A)                         |          |
| 2        | 736-0329 |            | Spring L-Wash. 1/4" Scr.* (680A)                 |          | 50       | 12211    | —488       | Gear Box Mtg. Brkt. Ass'y. (680A)                  |          |
| 3        | 712-0116 |            | Hex Ins. L-Nut 3/8-24 Thd. (680A)                |          | 51       | 736-0119 |            | L-Wash. 5/16" Scr.* (680A)                         |          |
| 4        | 736-0117 |            | FI-Wash. (680A)                                  |          | 52       | 710-0118 |            | Hex Scr. 5/16-18 x .75" Lg.* (680A)                |          |
| 5        | 714-0127 |            | Cotter Pin 1/16" Dia. x .75" (680A)              |          | 53       | 736-0329 |            | L-Wash. 1/4" Scr.* (680A)                          |          |
| 6        | 754-0176 |            | "V"-Belt 1/4" x 22.76" Lg. (680A)                |          | 54       | 12222    | —488       | Gear Box Brace (680A)                              |          |
| 7        | 710-0938 |            | Set Scr. 1/4-28 x .25" Lg. (680A)                |          | 55       | 712-0267 |            | Hex Nut 5/16-18 Thd.* (680A)                       |          |
| 8        | 711-0614 |            | P.T.O. Sheave (680A)                             |          | 56       | 736-0119 |            | L-Wash. 5/16" Scr. (680A)                          |          |
| 9        | 756-0194 |            | Idler Pulley (680A)                              |          | 57       | 710-0258 |            | Hex Scr. 1/4-20 x .62" Lg.* (680A)                 |          |
| 10       | 12206    |            | Idler Brkt. Ass'y. (680A)                        |          | 58       | 710-0148 |            | Hex Wash. Hd. F-Tapp Scr. #8 -32 x .38" Lg. (680A) |          |
| 11       | 732-0157 |            | Spring .38" O.D. (680A)                          |          | 59       | 717-0325 |            | Gear Box Ass'y.—Comp. (680A)                       |          |
| 12       | 712-0429 |            | Hex Ins. L-Nut 5/16-18 Thd. (680A)               |          | 60       | 714-0126 |            | #9 Hi-Pro-Key 3/16" x 3/4" Dia. (680A)             |          |
| 13       | 738-0140 |            | Shoulder Bolt .437" Dia. x .180 (680A)           |          | 61       | 713-0118 |            | Chain #41 x 61 Links (680A)                        |          |
| 14       | 711-0596 |            | Control Rod (680A)                               |          | 62       | 713-0723 |            | #41 Master Link 1/2" Pitch Type II (680A)          |          |
| 15       | 12231    |            | Shifting Finger (680A)                           |          | 63       | 710-0118 |            | Hex Scr. 5/16-18 x .75" Lg.*                       |          |
| 16       | 712-0429 |            | Hex Ins. L-Nut 5/16-18 Thd. (680A)               |          | 64       | 736-0119 |            | L-Wash. 5/16" Scr.*                                |          |
| 17       | 12213    | —488       | Pivot Brkt. Ass'y. (680A)                        |          | 65       | 712-0267 |            | Hex Nut 5/16-18 Thd.*                              |          |
| 18       | 732-0273 |            | Compression Spring (680A)                        |          | 66       | 736-0119 |            | L-Wash. 5/16" Scr.*                                |          |
| 19       | 714-0474 |            | Cotter Pin 1/8" Dia. x .75" Lg.* (680A)          |          | 67       | 12224    |            | Index Plate Ass'y.                                 |          |
| 20       | 736-0300 |            | FI-Wash. (680A)                                  |          | 68       | 12200    | —488       | Engine Mtg. Frame Ass'y.                           |          |
| 21       | 714-0137 |            | Hi-Pro-Key 3/16" x 3/4" Dia. x 1.062" Lg. (680A) |          | 69       | 748-0227 |            | Hex Flange Bearing .630" I.D.                      |          |
| 22       | 12216    |            | Shifting Yoke Ass'y. (680A)                      |          | 70       | 736-0116 |            | FI-Wash.   |          |
| 23       | 711-0594 |            | Shifting Fork Rod (680A)                         |          | 71       | 710-0258 |            | Hex Scr. 1/4-20 x .62" Lg.*                        |          |
| 24       | 720-0132 |            | Grip   |          | 72       | 736-0211 |            | FI-Wash.   |          |
| 25       | 12208    |            | Index Handle Ass'y.                              |          | 73       | 734-0576 |            | Rear Wheel Ass'y.—Comp.                            |          |
| 26       | 732-0231 |            | Torsion Spring                                   |          | 75       | 710-0118 |            | Hex Scr. 5/16-18 x .75" Lg.*                       |          |
| 27       | 712-0107 |            | Hex Center L-Nut 1/4-20 Thd.                     |          | 76       | 736-0119 |            | L-Wash. 5/16" Scr.*                                |          |
| 28       | 12240    | —488       | Pivot Brkt. Ass'y.—R.H.                          |          | 77       | 712-0287 |            | Hex Nut 1/4-20 Thd.* (680A)                        |          |
| 29       | 748-0161 |            | Clutch Collar (680A)                             |          | 78       | 736-0329 |            | L-Wash. 1/4" Scr.* (680A)                          |          |
| 30       | 748-0164 |            | Sprocket 10 Teeth (680A)                         |          | 79       | 710-0258 |            | Hex Scr. 1/4-20 x .62" Lg.* (680A)                 |          |
| 31       | 736-0116 |            | FI-Wash. (680A)                                  |          | 80       | 12232    |            | Chain Guard (680A)                                 |          |
| 32       | 716-0115 |            | Snap Ring for .625" Dia. (680A)                  |          | 81       | 712-0107 |            | Hex Center L-Nut 1/4-20 Thd.                       |          |
| 33       | 756-0195 |            | Drive Pulley (680A)                              |          | 82       | 726-0178 |            | Cable Tie (680A)                                   |          |
| 34       | 736-0160 |            | FI-Wash. (680A)                                  |          | 83       | 738-0185 |            | Rear Axle (670A)                                   |          |
| 35       | 748-0742 |            | Flange Bearing (680A)                            |          |          | 717-0353 |            | Differential Ass'y.—Comp. (680A)                   |          |
| 36       | 710-0136 |            | Hex Scr. 1/4-20 x 1.75" Lg.*                     |          | 84       | 12233    |            | Lower Handle                                       |          |
| 37       | 12241    | —488       | Pivot Brkt. Ass'y.—L.H.                          |          | 85       | 712-0107 |            | Hex Center L-Nut 1/4-20 Thd.                       |          |
| 38       | 714-0115 |            | Cotter Pin 1/8" Dia. x 1.00" Lg.*                |          | 86       | 714-0229 |            | #2 Woodruff Key 3/32 x 1/2" Dia. Hdn. (680A)       |          |
| 39       | 736-0116 |            | FI-Wash.   |          | 87       | 748-0136 |            | Pinion Gear .50" I.D. x 14 Teeth (680A)            |          |
| 40       | 12217    | —488       | Front Axle Ass'y.                                |          | 88       | 711-0593 |            | Drive Shaft (680A)                                 |          |
| 41       | 734-0225 |            | Front Wheel Ass'y.—Comp.                         |          | 89       | 715-0246 |            | Spring Pin Spiral 3/16" Dia. x 1.25 (680A)         |          |
| 42       | 748-0176 |            | Flange Bearing .630" I.D.                        |          | 90       | 748-0135 |            | Bevel Gear .62" I.D. 28 Teeth (680A)               |          |
| 43       | 736-0116 |            | FI-Wash.   |          | 91       | 08187    |            | Gear Box Cover (680A)                              |          |
| 44       | 714-0115 |            | Cotter Pin 1/8" Dia. x 1.00" Lg.*                |          | 92       | 748-0110 |            | Flange Bearing .630" I.D. (680A)                   |          |
| 45       | 712-0107 |            | Hex Center L-Nut 1/4-20 Thd. (680A)              |          | 93       | 08189    |            | Gear Box (680A)                                    |          |
| 46       | 736-0329 |            | L-Wash. 1/4" Scr.* (680A)                        |          | 94       | 748-0108 |            | Flange Bearing .503" I.D. (680A)                   |          |
| 47       | 12227    | —488       | Bearing Support Brkt. (680A)                     |          | 95       | 710-0442 |            | Hex Scr. 5/16-18 x 1.50 Lg.*                       |          |
| 48       | 710-0118 |            | Hex Scr. 5/16-18 x .75" Lg. (680A)               |          |          |          |            |  |          |

# 240-670A 240-680A

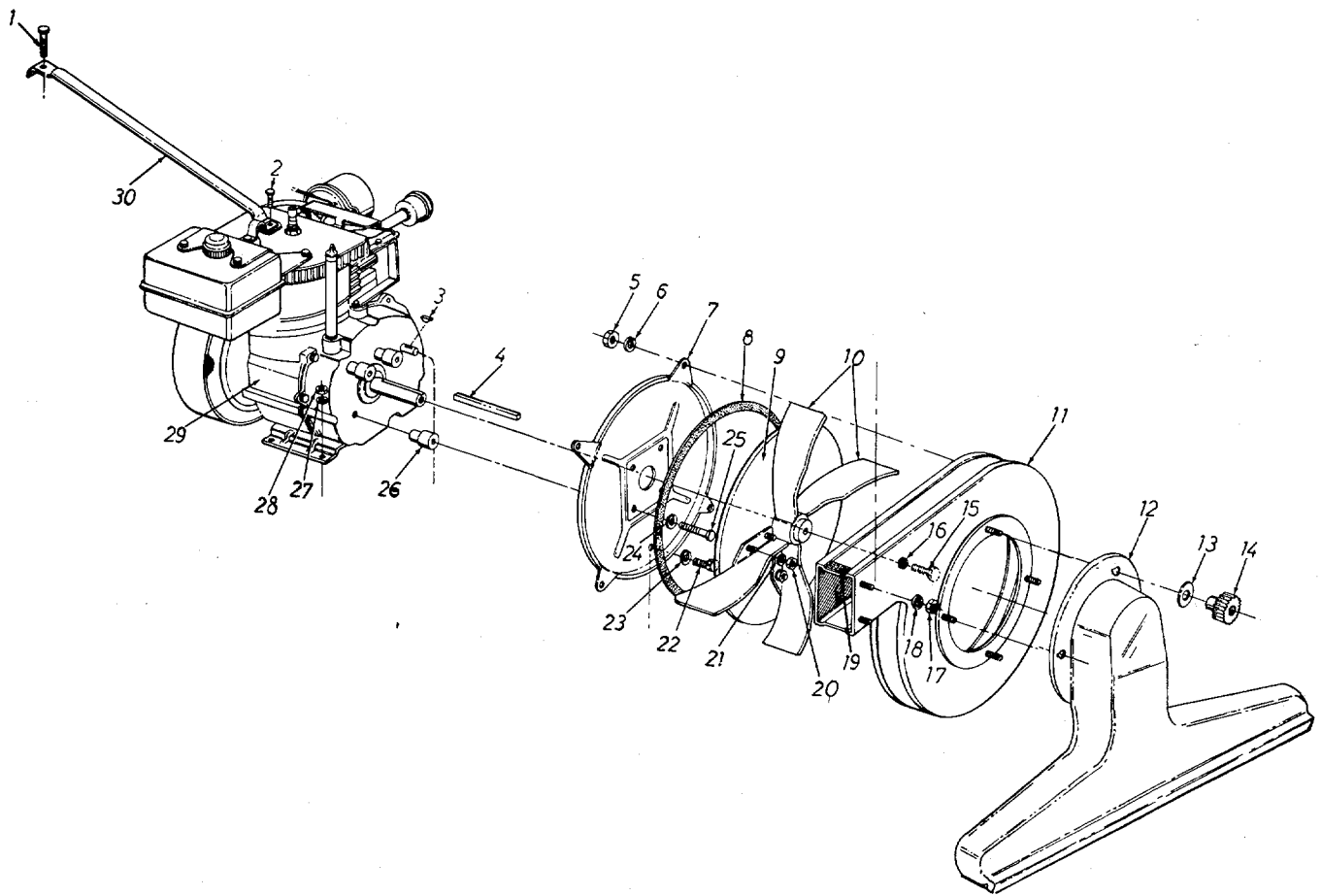

EXPLODED VIEW OF DRIVE ASSEMBLY

**PARTS LIST FOR MODELS 240-670A AND 240-680A**

| REF. NO. | PART NO. | COLOR CODE | DESCRIPTION                                 | NEW PART |
|----------|----------|------------|---|----------|
| 1        | 710-0106 |            | Hex Scr. 1/4-20 x 1.25" Lg. *               |          |
| 2        | —        |            | Part of Engine                              |          |
| 3        | 714-0108 |            | Woodruff Key (680A)                         |          |
| 4        | 714-0114 |            | Sq. Key 1/4" x 2.00" Lg.                    |          |
| 5        | 712-0267 |            | Hex Nut 5/16-18" Thd. *                     |          |
| 6        | 736-0119 |            | L-Wash. 5/16" Scr. *                        |          |
| 7        | 11452    | —488       | Hopper to Engine Mtg. Plate                 |          |
| 8        | 721-0128 |            | Gasket Strip—Pressure Sen.                  |          |
| 9        | 12203    | —488       | Vane Plate Ass'y.                           |          |
| 10       | 12230    | —488       | Air Vane                                    |          |
| 11       | 13320    | —488       | Blower Housing Ass'y.                       |          |
| 12       | 731-0211 |            | Nozzle                                      |          |
| 13       | 736-0159 |            | Fl.-Wash. .344" I.D. x .88"<br>O.D. x .063  |          |
| 14       | 712-0254 |            | Thumb Nut 5/16-18 Thd.                      |          |
| 15       | 710-0239 |            | Hex Scr. 3/8-24 x 1.75" Lg.<br>H.T.         |          |
| 16       | 736-0217 |            | L-Wash. 3/8" Scr. Heavy Duty                |          |
| 17       | 712-0107 |            | Hex Center L-Nut 1/4-20 Thd.                |          |
| 18       | 736-0211 |            | Fl.-Wash. .285" I.D. x 1.25"<br>O.D. x .060 |          |
| 19       | 721-0129 |            | Dust Pad—Pressure Sensitive                 |          |
| 20       | 712-0241 |            | Hex Nut 3/8-24" Thd. *                      |          |
| 21       | 736-0217 |            | L-Wash. 3/8" Scr. Heavy Duty                |          |
| 22       | 710-0118 |            | Hex Scr. 5/16-18 x .75" Lg. *               |          |
| 23       | 736-0119 |            | L-Wash. 5/16" Scr. *                        |          |
| 24       | 736-0119 |            | L-Wash. 5/16" Scr. *                        |          |
| 25       | 710-0409 |            | Hex Scr. 5/16-24 x 1.75" Lg. *              |          |
| 26       | 711-0591 |            | Engine Spacer                               |          |
| 27       | 736-0119 |            | L-Wash. 5/16" Scr. *                        |          |
| 28       | 712-0267 |            | Hex Nut 5/16-18 Thd. *                      |          |
| 29       | —        |            | Engine                                      |          |
| 30       | 749-0326 |            | Engine Brace (670A)                         |          |
|          | 12228    |            | Engine Brace (680A)                         |          |

\*For faster service obtain standard nuts, bolts, and washers locally. If these items cannot be obtained locally, order by part number and size as shown on parts list.

(488—Mack Truck Yellow)

When ordering parts, if color or finish is important use the appropriate color code shown above. (e.g. Mack Truck Yellow Finish—12236 (488).)

NOTE: The engine is not under warranty by the vacuum manufacturer... If repairs or service is needed on the engine, please contact your nearest authorized engine service outlet. Check the "Yellow Pages" of your telephone book under "Engines—Gasoline."



# 240-680A (ONLY)

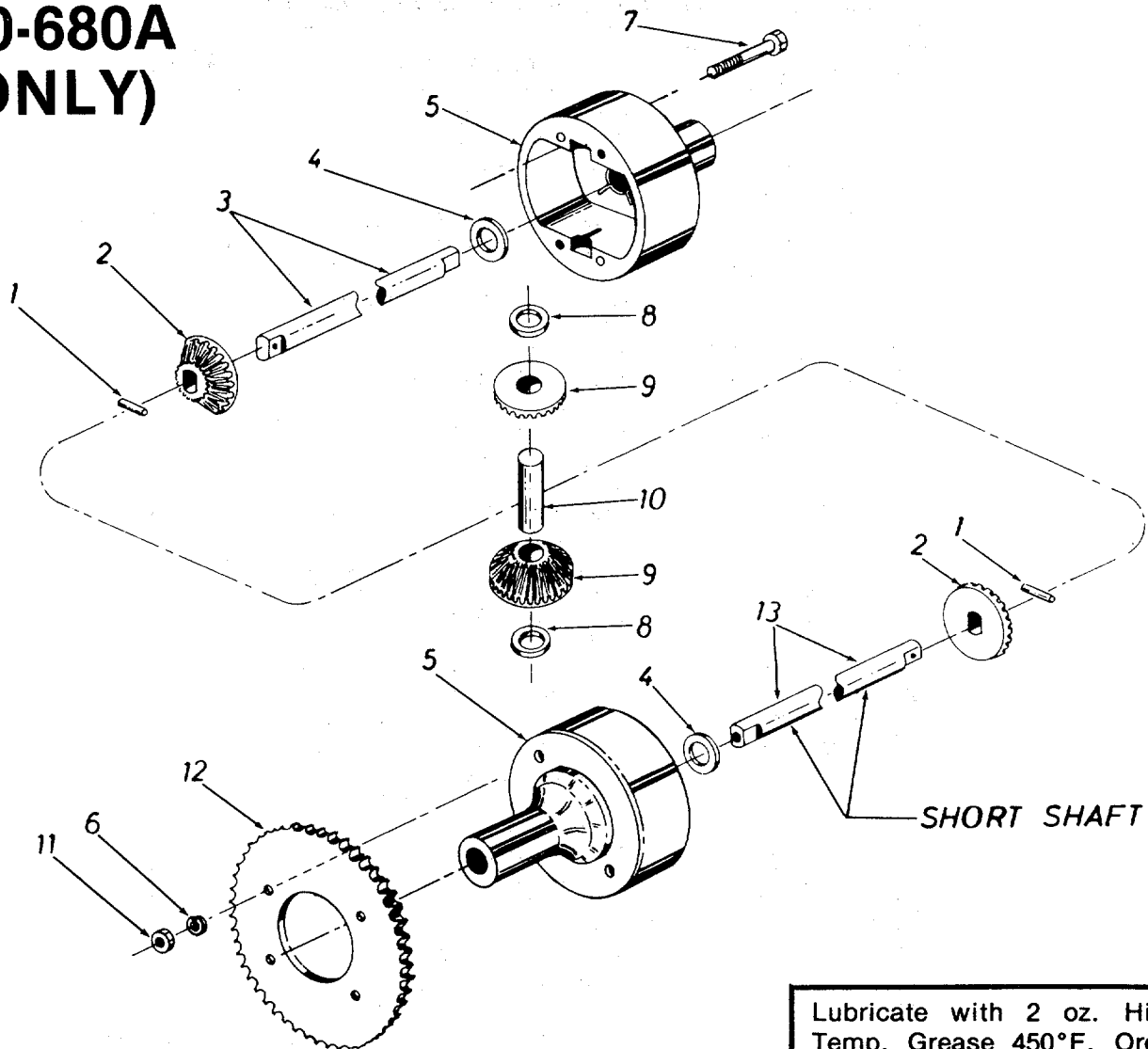

Lubricate with 2 oz. High Temp. Grease 450°F. Order Part No. 737-0120.

**FIGURE 4.  
MODEL 717-0353 DIFFERENTIAL ASSEMBLY**

### PARTS LIST FOR FIGURE 4 MODEL 240-680A

| REF. NO. | PART NO. | Qty. Req'd. | DESCRIPTION                             | NEW PART |
|----------|----------|-------------|---|----------|
| 1        | 715-0247 | 2           | Spring Pin Spir. 3/16" Dia. x 1.00" Lg. |          |
| 2        | 748-0185 | 2           | Gear—Double "D" Hole                    |          |
| 3        | 738-0218 | 1           | Shaft—Long 15.38" Lg.                   |          |
| 4        | 736-0188 | 2           | FI-Wash. .760 I.D. x 1.49 O.D.          |          |
| 5        | 717-0341 | 2           | Housing Half                            |          |
| 6        | 736-0119 | 2           | L-Wash. 5/16" Scr.*                     |          |
| 7        | 710-0526 | 2           | Hex Scr. 5/16-24 x 4.00" Lg.*           |          |
| 8        | 736-0187 | 2           | FI-Wash. .640 I.D. x 1.24 O.D.          |          |
| 9        | 748-0158 | 2           | Gear—Round Hole                         |          |
| 10       | 711-0276 | 1           | Drive Pin                               |          |
| 11       | 712-0237 | 2           | Hex Cent. L-Nut 5/16-24 Thd.            |          |
| 12       | 09054    | 1           | Sprocket—40 Tooth                       |          |
| 13       | 738-0217 | 1           | Shaft—Short 8.31" Lg.                   |          |

\*For faster service obtain standard nuts, bolts and washers locally. If these items cannot be obtained locally, order by part number and size as shown on parts list.

# PARTS INFORMATION

## POWER EQUIPMENT PARTS AND SERVICE

Parts and service for all MTD manufactured power equipment are available through the authorized service firms listed below. All orders should specify the model number of your unit, parts number, description of parts and the quantity of each part required.

|                                     |                                |       |
|-------------------------------------|--------------------------------|-------|
| <b>ALABAMA</b>                      | <b>BIRMINGHAM</b>              |       |
| Auto Electric & Carburetor Co. .... | 2625 4th Ave. S. ....          | 35233 |
| <b>ARKANSAS</b>                     | <b>FORT SMITH</b>              |       |
| Mity Mite Motors, Inc. ....         | 4515 South 16th Street         | 72901 |
|                                     | <b>NORTH LITTLE ROCK</b>       |       |
| Sutton's Lawn Mower Shop ....       | Rt. 4 Box 368. ....            | 72117 |
| <b>CALIFORNIA</b>                   | <b>PORTERVILLE</b>             |       |
| Billious ....                       | 75 North D Street              | 93257 |
|                                     | <b>SAN BERNARDINO</b>          |       |
| Lawn Mower Supply Co. ....          | 25608 E. Baseline              | 92410 |
|                                     | <b>SAN FRANCISCO</b>           |       |
| J.W. Jewett Co. ....                | 981 Folsom St. ....            | 94107 |
| <b>COLORADO</b>                     | <b>DENVER</b>                  |       |
| South Denver Lawn Equip. ....       | 527 West Evans                 | 80223 |
| <b>FLORIDA</b>                      | <b>JACKSONVILLE</b>            |       |
| Radco Distributors ....             | 2403 Market St. ....           | 32206 |
|                                     | <b>OPA LOCKA</b>               |       |
| Small Eng. Dist. ....               | 2351 N.W. 147th St. ....       | 33054 |
| <b>GEORGIA</b>                      | <b>EAST POINT</b>              |       |
| East Point Cycle & Key ....         | 2834 Church St. ....           | 30344 |
| <b>ILLINOIS</b>                     | <b>LYONS</b>                   |       |
| Keen Edge Co. ....                  | 8615 Ogden Ave. ....           | 60534 |
| <b>INDIANA</b>                      | <b>ELKHART</b>                 |       |
| Parts & Sales Inc. ....             | 2101 Industrial Pkwy. ....     | 46514 |
| <b>IOWA</b>                         | <b>DUBUQUE</b>                 |       |
| Power Lawn & Garden Equip. ....     | 2551 J.F. Kennedy ....         | 52001 |
| <b>LOUISIANA</b>                    | <b>NEW ORLEANS</b>             |       |
| Suhren Engine Co. ....              | 8330 Earhart Blvd. ....        | 70118 |
| <b>MARYLAND</b>                     | <b>TAKOMA PARK</b>             |       |
| Center Supply Co. ....              | 6867 New Hampshire Ave. ....   | 20012 |
| <b>MASSACHUSETTS</b>                | <b>SPRINGFIELD</b>             |       |
| Morton B. Collins Co. ....          | 300 Birnie Ave. ....           | 01107 |
| <b>MICHIGAN</b>                     | <b>LANSING</b>                 |       |
| Lorenz Service Co. ....             | 2500 S. Pennsylvania           | 48910 |
|                                     | <b>MOUNT CLEMENS</b>           |       |
| Power Equipment Dist. ....          | 36463 South Gratiot ..         | 48043 |
| <b>MINNESOTA</b>                    | <b>HOPKINS</b>                 |       |
| Hance Distributing Inc. ....        | 420 Excelsior Ave. W. ....     | 55343 |
|                                     | <b>ST. PAUL</b>                |       |
| Power Tools Inc. ....               | 3771 Sibley Memorial Hwy. .... | 55122 |
| <b>MISSISSIPPI</b>                  | <b>BILOXI</b>                  |       |
| Biloxi Sales & Service, Inc. ....   | 506 Caillavet St. ....         | 39533 |
| <b>MISSOURI</b>                     | <b>KANSAS CITY</b>             |       |
| Automotive Equip. Service ....      | 3117 Holmes St. ....           | 64109 |
|                                     | <b>ST. JOSEPH</b>              |       |
| Ross-Frazier Supply Co. ....        | 8th and Monterey               | 64503 |
|                                     | <b>ST. LOUIS</b>               |       |
| Henzler, Inc. ....                  | 2015 Lemay Ferry Rd. ....      | 63125 |
| <b>NEW JERSEY</b>                   | <b>BELLMAWR</b>                |       |
| Lawnmower Parts Inc. ....           | 717 Creek Rd. ....             | 08030 |
|                                     | <b>RUTHERFORD</b>              |       |
| Feld Distributor ....               | 28 Glen Rd. ....               | 07070 |
| <b>NEW YORK</b>                     | <b>CARTHAGE</b>                |       |
| Gamble Dist., Inc. ....             | West End Ave. ....             | 13619 |

## BRIGGS AND STRATTON, TECUMSEH AND PEERLESS PARTS AND SERVICE

Briggs & Stratton, Tecumseh and Peerless parts and service should be handled by your nearest authorized engine service firm. Check yellow pages of your telephone directory under the list **Engines—Gasoline**, Briggs & Stratton or Tecumseh Lauson.

|                                     |                            |       |
|-------------------------------------|----------------------------|-------|
|                                     | <b>SYRACUSE</b>            |       |
| GTP Leisure Products Inc. ....      | 420 Marcellus St. ....     | 13204 |
| <b>NORTH CAROLINA</b>               | <b>GOLDSBORO</b>           |       |
| Smith Hardware Co. ....             | 515 N. George St. ....     | 27530 |
|                                     | <b>GREENSBORO</b>          |       |
| Dixie Sales Company ....            | 327 Battleground Ave. .... | 27402 |
| <b>OHIO</b>                         | <b>CARROLL</b>             |       |
| Stebe's Mid-State Mower Supply ...  | Box 366-71 High St. ...    | 43112 |
|                                     | <b>CLEVELAND</b>           |       |
| Bleckrie, Inc. ....                 | 7900 Lorain Ave. ....      | 44102 |
|                                     | <b>WADSWORTH</b>           |       |
| National Central ....               | 687 Seville Rd. ....       | 44281 |
|                                     | <b>YOUNGSTOWN</b>          |       |
| Burton Supply Co. ....              | 1301 Logan Ave. Box 929 .. | 44501 |
| <b>OKLAHOMA</b>                     | <b>ADA</b>                 |       |
| Ada Auto Supply ....                | 301 E. 12th St. ....       | 74820 |
|                                     | <b>MUSKOGEE</b>            |       |
| Victory Motors, Inc. ....           | 605 S. Cherokee. ....      | 74401 |
|                                     | <b>OKLAHOMA CITY</b>       |       |
| Forest Sales Inc. ....              | 1039 NW 63rd St. ....      | 73116 |
| <b>OREGON</b>                       | <b>PORTLAND</b>            |       |
| Kenton Supply Co. ....              | 8216 N. Denver Ave. ...    | 97217 |
| <b>PENNSYLVANIA</b>                 | <b>CHESTER</b>             |       |
| Stull Equipment Corp. ....          | 742 W. Front St. ....      | 19013 |
|                                     | <b>HARRISBURG</b>          |       |
| EECO Inc. ....                      | 4021 N. 6th St. ....       | 17110 |
|                                     | <b>PHILADELPHIA</b>        |       |
| Thompson Rubber Co. ....            | 5222-24 N. Fifth St. ...   | 19120 |
|                                     | <b>PITTSBURGH</b>          |       |
| Bluemont Co. ....                   | 11125 Frankstown Rd. ....  | 15235 |
| <b>TENNESSEE</b>                    | <b>KNOXVILLE</b>           |       |
| Master Repair Service. ....         | 2000 Western Ave. ....     | 37    |
|                                     | <b>MEMPHIS</b>             |       |
| Memphis Cycle & Supply Co. ....     | 421 Monroe Ave. ....       | 38103 |
| American Sales & Service, Inc. .... | 1922 Lynnbrook. ....       | 38116 |
| <b>TEXAS</b>                        | <b>DALLAS</b>              |       |
| Marr Brothers, Inc. ....            | 423 E. Jefferson. ....     | 75203 |
|                                     | <b>FORT WORTH</b>          |       |
| Woodson Sales Corp. ....            | 1702 N. Sylvania           | 76111 |
|                                     | <b>HOUSTON</b>             |       |
| Bullard Supply Co. ....             | 2409 Commerce St. ...      | 77003 |
|                                     | <b>SAN ANTONIO</b>         |       |
| Catto & Putty, Inc. ....            | 414 Live Oak               | 78298 |
| <b>UTAH</b>                         | <b>SALT LAKE CITY</b>      |       |
| A-1 Engine & Mower Co. ....         | 437 E. 9th St. ....        | 84111 |
| <b>VERMONT</b>                      | <b>BURLINGTON</b>          |       |
| Vermont Hdwe. Co. Inc. ....         | 180 Flynn Ave. ....        | 05401 |
| <b>VIRGINIA</b>                     | <b>RICHMOND</b>            |       |
| RBI Corp. ....                      | 963 Myers St. ....         | 23260 |
| <b>WASHINGTON</b>                   | <b>SEATTLE</b>             |       |
| Bailey's Inc. ....                  | 1414 14th Ave. ....        | 98102 |
| <b>WEST VIRGINIA</b>                | <b>CHARLESTON</b>          |       |
| Young's, Inc. ....                  | 233 Virginia St., E. ....  | 25301 |
| <b>WISCONSIN</b>                    | <b>APPLETON</b>            |       |
| Automotive Supply Co. ....          | 123 S. Linwood Ave. ...    | 54911 |

## WARRANTY PARTS AND SERVICE POLICY

The purpose of warranty is to protect the customer from defects in workmanship and materials, defects which are NOT detected at the time of manufacture. It does not provide for the unlimited and unrestricted replacement of parts. Use and maintenance are the responsibility of the customer. The manufacturer cannot assume responsibility for conditions which it has no control. Simply put, if it's the manufacturer's fault, it's the manufacturer's responsibility; if it's the customer's fault, it's the customer's responsibility.

### CLAIMS AGAINST THE MANUFACTURER'S WARRANTY INCLUDES

1. Replacement of Missing Parts on new equipment.
2. Replacement of Defective Parts within the warranty period.
3. Repair of Defects within the warranty period.

All claims MUST be substantiated with the following information:

1. Model Number of unit involved.
2. Date unit was purchased or first put into service.
3. Date of failure.
4. Nature of failure.