

Option Printer

d-Color MF360 - MF280 - MF220
d-Color MF451

PK-517

SERVICE MANUAL

Code Y111280-7

PUBLICATION ISSUED BY:

Olivetti S.p.A.

77, Via Jervis - 10015 Ivrea (TO)

Italy

Copyright© 2009, Olivetti

All rights reserved

CONTENTS

PK-517

OUTLINE

1. PRODUCT SPECIFICATIONS 1

MAINTENANCE

2. PERIODICAL MAINTENANCE PROCEDURE 3

3. OTHER MAINTENANCE ITEM 4

 3.1 Items not allowed to be disassembled and adjusted 4

 3.2 Disassembly/reassembly parts list..... 5

 3.3 Disassembly/reassembly procedure 5

 3.3.1 Punch kit 5

ADJUSTMENT/SETTING

4. HOW TO USE THE ADJUSTMENT SECTION 7

5. MECHANICAL ADJUSTMENT 8

 5.1 Mechanical adjustment of the punch section..... 8

 5.1.1 Punch hole deviation correction 8

PK-517

OUTLINE

MAINTENANCE

ADJUSTMENT / SETTING

PK-517

OUTLINE

MAINTENANCE

ADJUSTMENT / SETTING

Blank Page

OUTLINE

1. PRODUCT SPECIFICATIONS

A. Type

Name	Punch kit
Type	FS-integrated type punching operation device

B. Functions

Punching method	Stops and punches every paper
No. of holes	2-3 holes / 4 holes / Sweden 4 holes
Hole diameter/pitch	2 holes / ϕ 8.0 mm / 70 mm pitch - 3 holes / ϕ 8.0 mm / 108 mm pitch 4 holes / ϕ 6.5 mm / 80 mm pitch Sweden 4 holes / ϕ 6.5 mm / 70 mm, 21 mm pitch
Supported mode	Punch mode
Applicable post processing mode	Sort, group, staple

C. Paper type

Size	2 hole punch setting: 11 x 17, 8-1/2 x 14, 8-1/2 x 11/8-1/2 x 11S 3 hole punch setting: 11 x 17, 8-1/2 x 11 4 hole punch setting: A3, B4, A4, B5 Sweden 4 hole punch setting: A3, B4, A4/A4S, B5
Supported paper	Plain paper, bond paper, thick paper 1/2/3 (d-Color MF360/MF280/MF220) 1/1+2/3 (d-Color MF451) Main unit specifications prioritized
Weight	60to256g/m ² (d-Color MF360/280/MF220) - 64 to 256 g/m ² (d-Color MF451)
Punch prohibited paper	Label paper, tab paper, transparency film, 2nd base paper, holed paper, and the other paper that may interfere with the operation of the punch kit or the punch blade

D. Machine specifications

Power requirements	DC 24 V (supplied from the main body d-Color MF360/MF280/MF220)
	DC 5 V (supplied from the main body d-Color MF360/MF280/MF220)
Max. power consumption	30 W or less (d-Color MF360/MF280/MF220)
Dimensions	58 mm (W) x 470 mm (D) x 135 mm (H) 2.28 inch (W) x 18.50 inch (D) x 5.31 inch (H)
Weight	1.8 kg (3.97 lb)

E. Operating environment

- Conforms to the operating environment of the main body.

NOTE

- **These specifications are subject to change without notice.**

PK-517

OUTLINE

Blank Page

MAINTENANCE

2. PERIODICAL MAINTENANCE PROCEDURE

- Periodically replaced parts are not employed.

3. OTHER MAINTENANCE ITEM

3.1 Items not allowed to be disassembled and adjusted

A. Paint-locked screws

NOTE

- To prevent loose screws, a screw lock in blue or green series color is applied to the screws.
- The screw lock is applied to the screws that may get loose due to the vibrations and loads created by the use of machine or due to the vibrations created during transportation.
- If the screw lock coated screws are loosened or removed, be sure to apply a screw lock after the screws are tightened.

B. Red-painted screws

NOTE

- The screws which are difficult to be adjusted in the field are painted in red in order to prevent them from being removed by mistake.
- Do not remove or loosen any of the red-painted screws in the field. It should also be noted that, when two or more screws are used for a single part, only one representative screw may be marked with the red paint.

C. Variable resistors on board

NOTE

- Do not turn the variable resistors on boards for which no adjusting instructions are given in Adjustment/Setting.

D. Removal of PWBs

CAUTION

- When removing a circuit board or other electrical component, refer to “Handling of PWBs” and follow the corresponding removal procedures.
- The removal procedures given in the following omit the removal of connectors and screws securing the circuit board support or circuit board.
- Where it is absolutely necessary to touch the ICs and other electrical components on the board, be sure to ground your body.

3.2 Disassembly/reassembly parts list

Section	Part name	Ref. page
Unit	Punch kit	P.5

3.3 Disassembly/reassembly procedure

3.3.1 Punch kit

1. Remove the finisher from the main body.

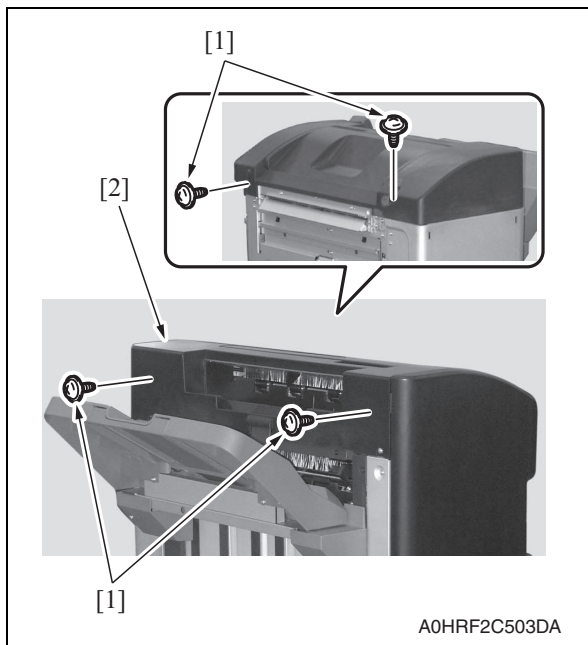

2. Remove four screws [1], and remove the finisher upper cover [2].

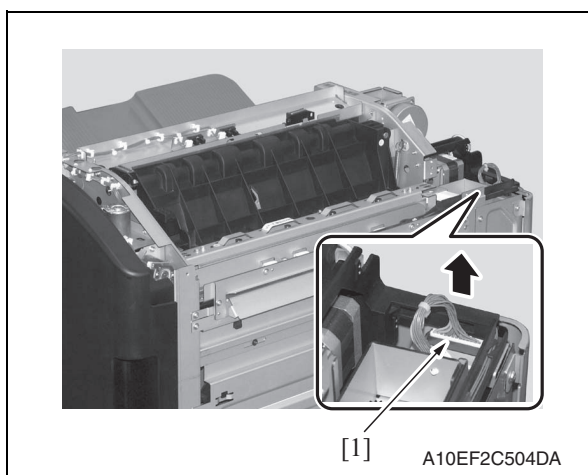

3. Disconnect the connector [1].

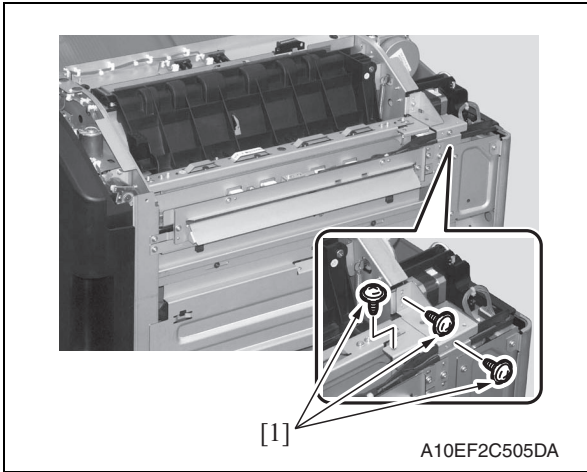

4. Remove three screws [1].

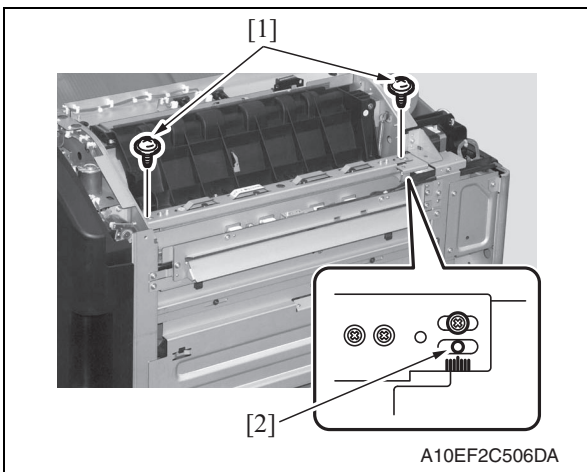

5. Remove two screws [1].

NOTE

- At the time of installation, secure it by adjusting the plate dowel [2] to the center of the stamp mark.

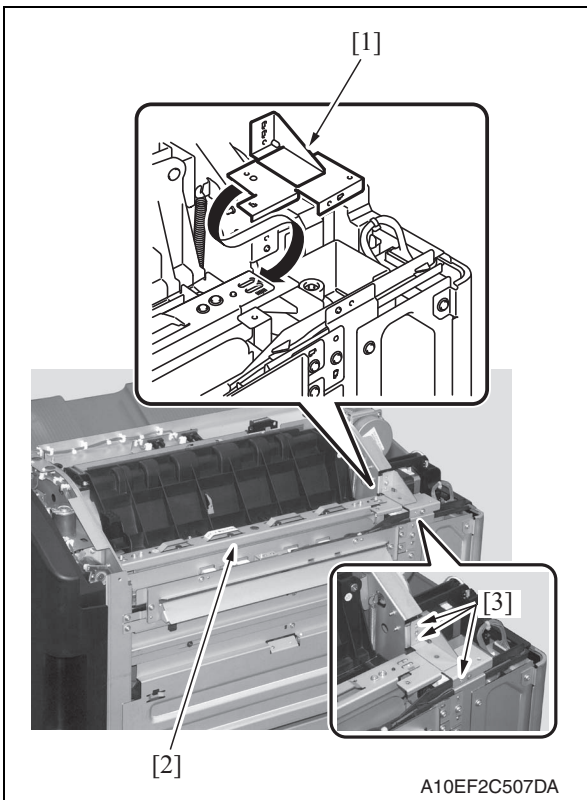

6. Remove the plate [1], and remove the punch kit [2].

NOTE

- At the time of installation, align the position of the three dowel holes of the plate [3].

7. Reinstall the above parts following the removal steps in reverse.

ADJUSTMENT/SETTING

4. HOW TO USE THE ADJUSTMENT SECTION

- “Adjustment/Setting” contains detailed information on the adjustment items and procedures for this machine.
- Throughout this “Adjustment/Setting,” the default settings are indicated by “ ”.

Advance checks

Before attempting to solve the customer problem, the following advance checks must be made. Check to see if:

- The power supply voltage meets the specifications.
- The power supply is properly grounded.
- The machine shares the power supply with any other machine that draws large current intermittently (e.g., elevator and air conditioner that generate electric noise).
- The installation site is environmentally appropriate: high temperature, high humidity, direct sunlight, ventilation, etc.; levelness of the installation site.
- The original has a problem that may cause a defective image.
- The density is properly selected.
- The original glass, slit glass, or related part is dirty.
- Correct paper is being used for printing.
- The units, parts, and supplies used for printing (developer, PC drum, etc.) are properly replenished and replaced when they reach the end of their useful service life.
- Toner is not running out.

⚠ CAUTION

- **Be sure to unplug the power cord of the machine before starting the service job procedures.**
- **If it is unavoidably necessary to service the machine with its power turned ON, use utmost care not to be caught in the scanner cables or gears of the exposure unit.**
- **Special care should be used when handling the fusing unit which can be extremely hot.**
- **The developing unit has a strong magnetic field. Keep watches and measuring instruments away from it.**
- **Take care not to damage the PC drum with a tool or similar device.**
- **Do not touch IC pins with bare hands.**

5. MECHANICAL ADJUSTMENT

5.1 Mechanical adjustment of the punch section

5.1.1 Punch hole deviation correction

- This adjustment must be made in the following case:
The punch holes are on a slanted line.

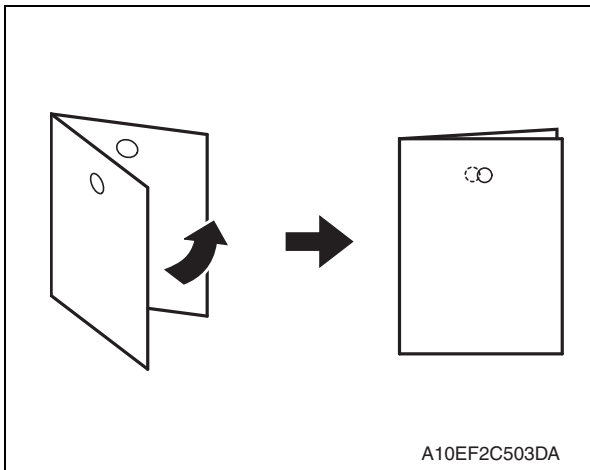

1. Set the mode to Punch mode for printing.
2. Hold the output paper half and check the displacement of the punch hole.
Standard value: 0 ± 2.0 mm

3. In case the figure exceeds the above mentioned standard value, follow the procedures shown below.

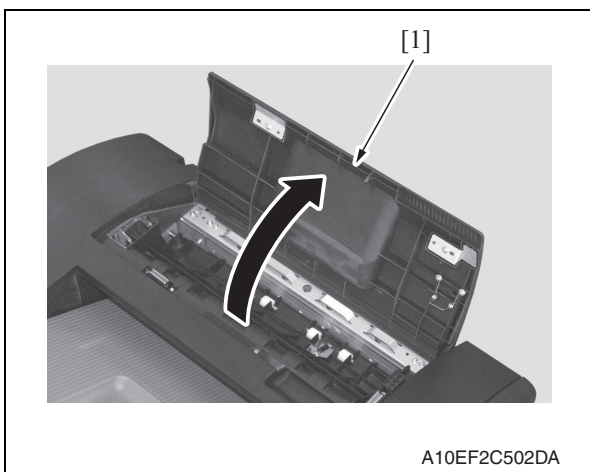

4. Open the upper cover [1].

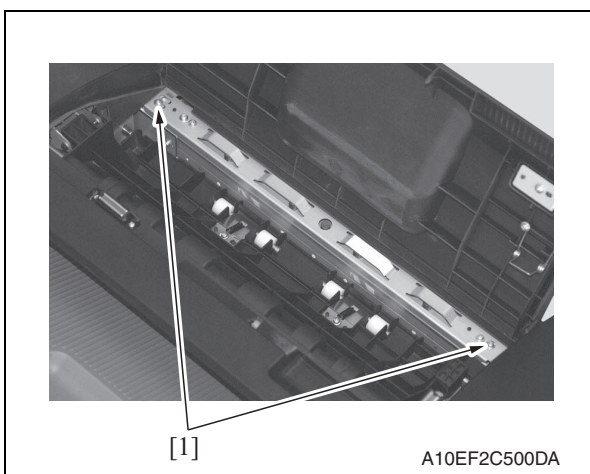

- Loosen two screws [1].

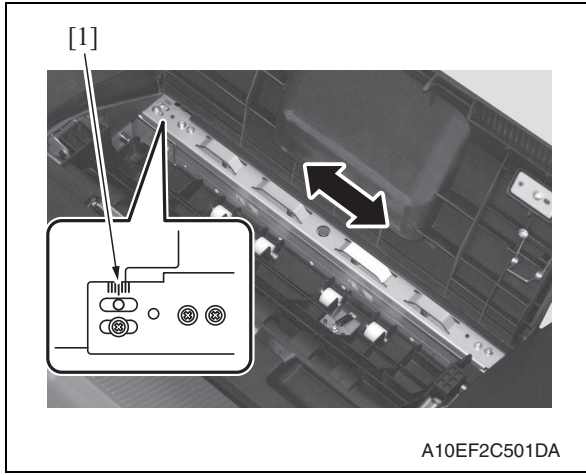

- Move the punch unit forward or backward for adjustment referring the mark-off line [1].

Blank Page

