

## FM-170 DRIVE ASSEMBLY REBUILD KIT (P/N 118 800)

### Description

The following procedure details the rebuild of a failed drive assembly and replacement of the idler bearing assembly in Nordson FM-170H (hopper-type) and FM-170T (tank-type) FoamMelt® applicators using this rebuild kit. For more detailed information about FM-170 applicators and their operation, refer to the FM-170 service manual that accompanied your unit or contact your Nordson service representative.

### Rebuild Kit Parts List

Item No.	Part No.	Description	Req'd
	-	Drive Assembly Rebuild	
2	118 819	• Bearing with High Temperature Grease, Single Row, Upper	1
3	118 823	• Bearing with High Temperature Grease, Single Row, Lower	1
5	986 106	• Ring, Retaining, Exterior	1
6	981 796	• Screw, Shoulder, Slotted	1
9	984 111	• Nut, Hex	1
11	273 698	• Seal, Face, 0.63 in. Diameter Shaft	1
12	986 311	• Ring, Retaining, Interior, 2.05 in.	1
14	118 751	• Retainer, Bearing	1
15	983 010	• Washer, Flat, No. 8	1
16	900 419	• Adhesive, Loctite No. 620	-
	-	Idler Bearing Assembly Replacement	
19	983 007	• Washer, Flat, 0.531 x 1.00 in.	1
22	111 210	• Screw, Shoulder, Socket	1
23	111 213	• Bearing, Yoke Roller	1
24	111 211	• Spacer, Idler	1
26	111 212	• Nut, Idler	1
27	310 850	• Belt Timing	1

**NOTE: Item numbers not given remain as in FM-170 service manual.**

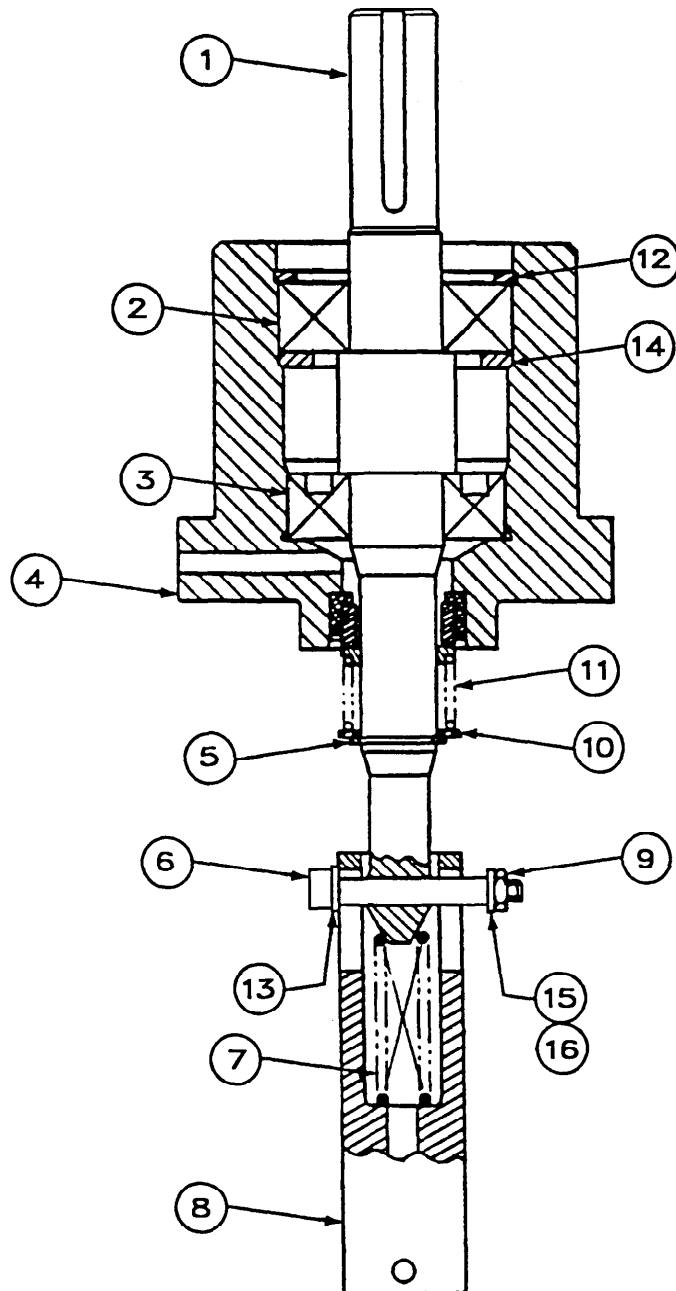

Figure 1 - FM-170 Drive Assembly with Rebuild Kit Components

## Drive Assembly Rebuild

**NOTE: All item numbers (in parentheses) refer to Figure 1 of this publication.**

**NOTE: Figure 1 and the kit parts list in this publication are similar to but not identical to Figure 8.14 and its accompanying parts list in the FM-170 service manual.**

**NOTE: All items described as "new" are replacement items from this kit. Discard old items as instructed below.**

1. Complete steps 1 through 14 of the Pump and Pump O-Ring Replacement procedure on pages 7-2 and 7-3 of your FM-170 service manual to remove the drive assembly from the unit.
2. Remove the locknut (9), socket head screw (6) and flat washers (13), then remove the compression spring (7) and drive coupling assembly (8). Discard the locknut, the socket head screw and one of the flat washers. Do not discard items 7 and 8.
3. Remove and discard the exterior retaining ring (5), flat washer (10) and spring for the face seal (11).
4. Remove and discard the upper retaining ring (12).
5. Press the drive shaft (1) out from the bottom of the drive body (4).
6. Remove and discard the old bearings (2 and 3) and face seal (11).
7. Press the new lower bearing (3) onto the drive shaft.

**NOTE: The open face of the bearing should face up.**

8. Place the new bearing retainer (14) on the drive shaft above the bearing.
9. Press the new upper bearing (2) onto the drive shaft.

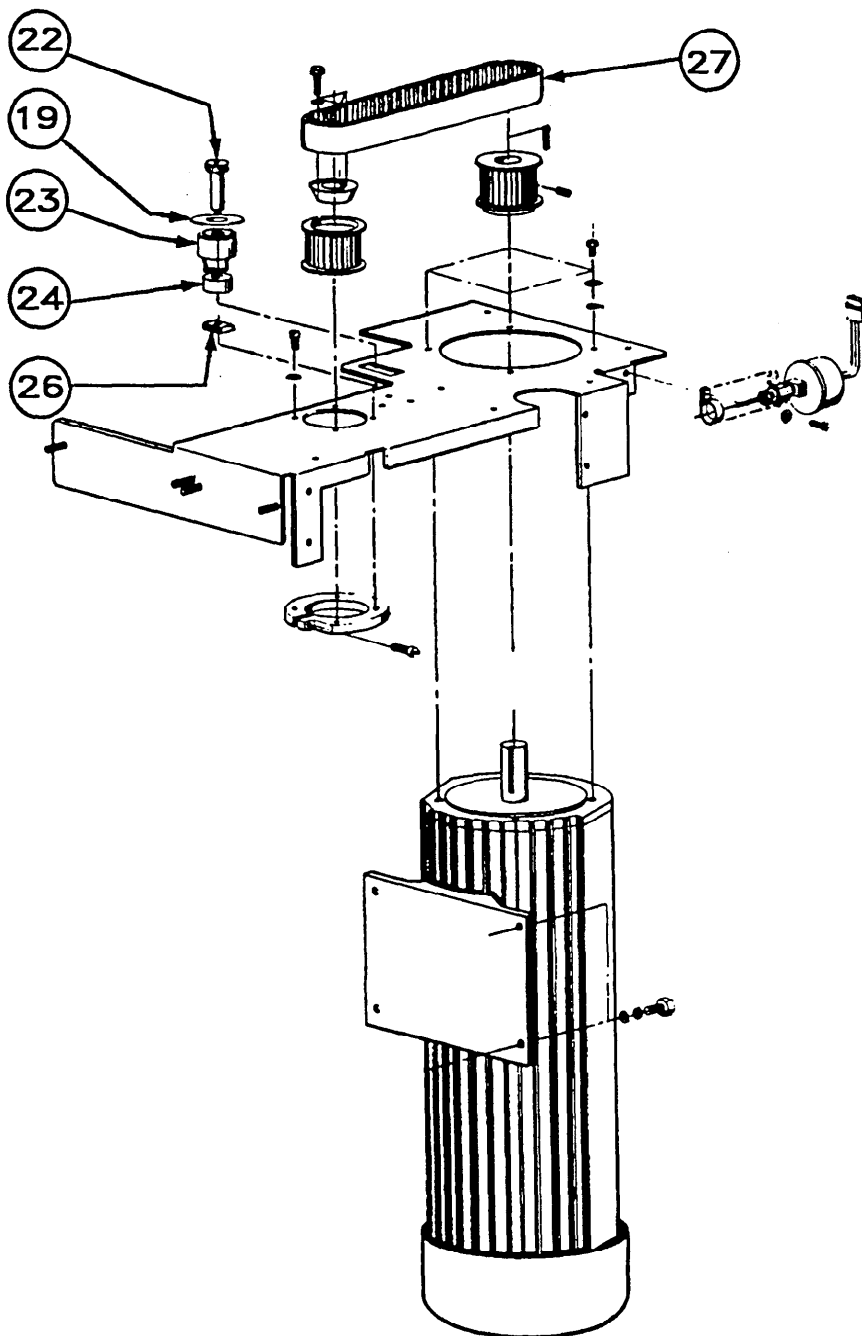

Figure 2 - FM-170 Idler Bearing Assembly with New Components  
(See FM-170 Service Manual for Detailed Parts Identification)

10. Push the drive shaft with bearings into the drive body.
11. Install the new retaining ring (12) on the drive shaft.
12. Slide the new face seal (11) with spring onto the drive shaft and into the drive body.
13. Install the new flat washer (10) and new exterior retaining ring (5).
14. Reinstall the compression spring (7) and drive assembly coupling (8) onto the end of the drive shaft.
15. Slide the remaining flat washer (13) from step 2 onto the new shoulder screw (6), then slide the screw/washer assembly through the coupling and drive shaft, and secure it in place with the new flat washer (15), Loctite adhesive (16) and the new hex nut (9).

## **Idler Bearing Replacement**

**NOTE: All item numbers (in parentheses) refer to Figure 2 of this publication.**

**NOTE: Figure 2 in this publication is similar to Figure 8.1 (sheet 3) and Figure 8.2 (sheet 3) in the FM-170 service manual. Figure 2 item numbers match those of Figure 8.1 (sheet 3). Figure 8.2 (sheet 3) item numbers are different.**

**NOTE: All items described as "new" are replacement items from this kit. Discard old items as instructed below.**

1. Remove and discard the idler bearing shoulder screw (22), yoke roller bearing (23), idler spacer (24), idler nut (26) and timing belt (27).
2. Reassemble the idler bearing assembly using the new items from this kit to replace discarded items from step 1.

**NOTE: Tighten all fasteners as specified in the FM-170 service manual.**

