



- Using compressed air, clean the inside of the drive pulley including the gaps between the fins.



- Apply contact cleaner to a cloth and clean the sliding surfaces of the drive pulley.



- Clean the plate using compressed air. If necessary clean with contact cleaner.



- Clean the dampers with compressed air. If necessary clean with contact cleaner.



- Reassemble the removable drive assembly according to Service Manual procedure.



8. Clean the fixed drive pulley using compressed air.



9. Clean the clutch side driven face pulley using compressed air.



10. Clean the engine side driven face using compressed air.



11. Clean the clutch shoe using compressed air. Ensure that the shoe friction material is completely clean.



12. Clean the clutch housing with compressed air. If necessary, apply contact cleaner to a cloth and clean the clutch housing.



13. Clean all cogs on the belt with compressed air.



14. Apply contact cleaner to the cloth and clean the drive pulley face.



15. Apply contact cleaner to a cloth and clean the driven pulley faces.

Reassemble the CVT according to the procedure described in the 2007- AN400 Service Manual. Refer to section 5A of both the Service Manual and the K9 Supplement on Suzukinet.



## CVT AIR DUCT PARTS INSTALLATION

On a customer complaint basis only of clutch judder and/or shoe noise, even after cleaning the dust from the CVT chamber and filter, install one of each of the AN400AK9 type CVT Air Duct parts which are listed below. When installing these parts, follow the procedures described in the 2007- AN400 Service Manual. Refer to section 5A and the 2009 Supplement. If necessary, clean all CVT parts again according to this Service Bulletin.

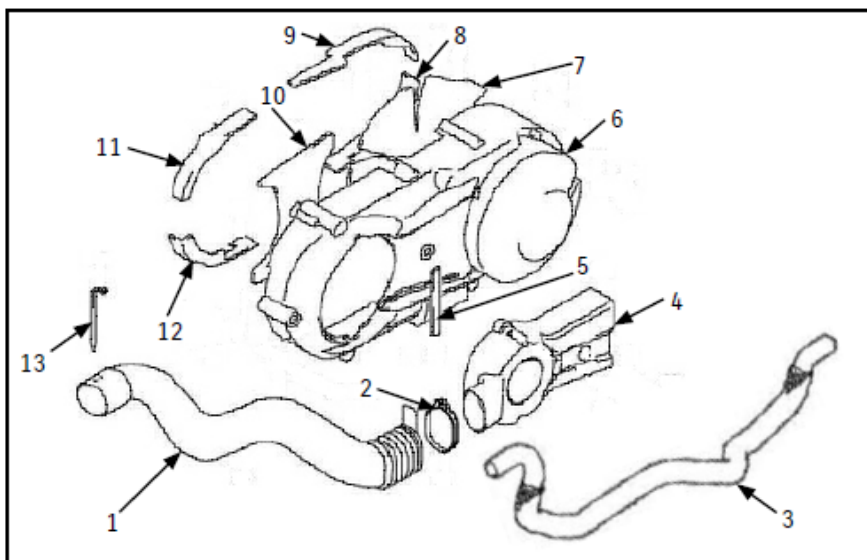

	Part Number	Description
1	11383-05H40	Hose
2	11384-05H40	Clamp
3	17851-05H10	Hose
4	11380-05H40	Duct
5	11382-05H30	Cushion
6	11371-05H20	Cover
7	11486-05H00	Cushion
8	11489-05H00	Cushion
9	11488-05H00	Cushion
10	11487-05H00	Cushion
11	11491-05H00	Cushion
12	11492-05H00	Cushion
13	09407-14403	Clamp

## CLUTCH SHOE AND HOUSING INSTALLATION

On a customer complaint basis only of clutch judder and/or shoe noise, even after cleaning the dust from the CVT chamber and installing the late type. Air Duct parts, install the AN400AK9 type Clutch Housing (21220-05H20) and Clutch Shoe Assy. (21501-05H20). When installing these parts, follow the procedures Described in the 2007~ AN400 Service Manual. Refer to section 5A. If necessary, clean all CVT parts again according to this Service Bulletin.

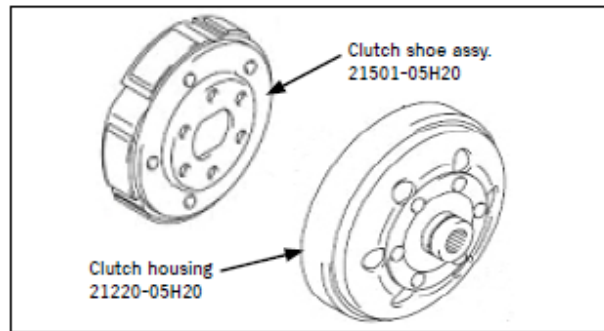

## WARRANTY CLAIM

**NOTE: CLEANING THE COOLING FAN FILTER AND ASSOCIATED CVT PARTS IS MAINTENANCE WHICH IS NOT WARRANTABLE.**

Should you need further clarification on this matter please contact SAPL service department.

CVT Air Duct Parts Installation	
Detailed Failure Information	Clutch judder/noise. Install CVT Air Duct Parts per Bulletin 09-06.
Labour Operation	GA9999
Hours	1.4
Causal Part No.	11383-05H40
Qty	1
Complaint Code	26
Defect Code	41
Replaced Parts	Part numbers you replaced

Clutch Shoe & Housing Installation	
Detailed Failure Information	Clutch judder/noise. Install Clutch Shoe and Housing per Bulletin 09-06.
Labour Operation	GA9999
Hours	1.0
Causal Part No.	21220-05H20
Qty	1
Complaint Code	26
Defect Code	41
Replaced Parts	21501-05H20
Qty	1