



*Fett Brothers Performance, behind you all the way...*

**2012-2013**



## **MAKING TRACKS**

Our snowflap/track cover photo makes us think of riding in new fallen snow, twisting through the trails, crossing a frozen lake or busting drifts down a windblown ditch. The key ingredient to enjoying these scenarios is a well tuned snowmobile. Our customer, "a better than average snowmobiler", wants improved performance without taking a second mortgage. We offer products and services that make a noticeable difference in handling and performance yet don't break the bank. Many times a few small changes can increase the "fun factor" of snowmobiling. An improvement in clutching (putting more power to the track) and/or suspension work (make the sled absorb the terrain, not your back) can make a so-so sled into a great trail/lake runner machine.

The manufacturers have gone overseas with many parts to reduce cost but as we have all discovered this does not guarantee quality. Imported items may cost less but many times they fall short in long term reliability and thus are not cost effective. We ride throughout the winter testing new ideas before deciding if there is "real" performance value. Our products may not always be the cheapest but they are Made in the USA and have been tested as "Performance Products that Make Sense".

A catalog is a major expense in time and money but like many of you, we like our information in print form that we can hold in our hand. A disadvantage of the catalog is that new items or changes cannot be made until the next printing. Our website has solved this problem with information and tips on various applications and installations. Our E-Store is secure for credit card information and offers special e-store only prices. Visit us for the latest product news at [www.fettbros.com](http://www.fettbros.com).

We would like to thank our friends, customers, and family for their support. We welcome your comments and suggestions on existing products or new ideas. Many times common sense and a garage mechanic are the best solutions to a problem. Be sure to schedule some riding time this winter and make your own tracks.

Ride Smart!

Dale and Dennis Fett



**DALE**



**DENNIS**

## **POLICIES**

**Hours:** Monday – Friday, 8:00 a.m. - noon and 1:00 p.m. - 5:00 p.m. CST. Saturday and after hour pick-ups are available by appointment.

**Catalog:** New catalog is mailed to current USA customers or can be downloaded from website.

**Phone:** We may not be available to answer all calls but voice mail is always on duty. Leave a message as we do return calls.

**Orders:** E-store is identity theft protected, open 24/7, and offers web only savings. Phone, fax, or email orders are always welcome.

**Back orders:** We will contact before shipping.

**Payment:** Discover, Visa, and MasterCard. Only certified check or money order for COD (\$12 fee). No COD on international orders.

**Shipping:** UPS ground is preferred as tracking is simple and accurate with priority mail our second choice. Alaska, Canada, and European orders shipped by priority mail unless requested otherwise. Fed Ex or UPS red/blue service available by request.

**Freight charges:** Shipping cost based on weight/size with a small handling charge included (average UPS freight charge is \$9 to \$13). Insurance available upon request.

**Returns:** You **must** call for return authorization. All returns are subject to a 20% restocking fee, must be in new, re-sellable condition, and made within 14 days of shipment. No returns on special orders or credit on freight charges.

**Shipping to FBP:** Tightly pack items (newspaper is best) and include name, address, phone, year & model. Shock service should include Ride Tech Service Form. We will call for payment information.

**Tech Calls:** We will answer tech calls about our products. For free advice on other products, see your dealer, buy a service manual, or call the company that made it.

**Catalog Pricing:** Prices are subject to change without notice and is correct to the best of our knowledge at time of printing. We reserve the right to change specifications or pricing. E-store reflects the most current price.

**Dealers:** Contact our office for dealer application. We reserve the right to accept or refuse dealers.

**Warranty:** Due to the nature of FBP products and services, all items and work performed are sold "AS IS" with no warranties either expressed or implied including any implied warranty of merchantability or fitness for a particular purpose. We will pass on the warranty made by the manufacturer of any product we distribute, who has the sole responsibility of such warranties. The manufacturer shall be solely responsible for any damage to person or property arising from the design or manufacture of its product; we accept no liability for such damages and shall not be liable for indirect or consequential damages. Any references to manufacturers names and part numbers is for identification only and does not denote an original part.

**Phone:** 218-334-FETT (3388)

**Fax:** 218-334-3723

**E-mail:** [fettbros@loretel.net](mailto:fettbros@loretel.net)

**Web:** [www.fettbros.com](http://www.fettbros.com)

**FBP**  
11684 Woods Drive  
Frazee, MN. 56544

***FETT BROTHERS PERFORMANCE LLC***



## ACCELERATOR CLUTCH KIT

### True "Trail Performance" Clutch Kit!

\*Harder acceleration, more mid range, great top end, and quick backshift.  
 \*No loss of reliability and improved belt life.  
 \*Quicker corner to corner acceleration.  
 \*Gains of 2-3 lengths @ 1,000 feet with better top end.  
 \*Adjustable to compensate for various differences (engine/track/weight/etc).  
 \*Many companies have a generic kit of pins, ramps, springs, and helix. All sleds do not need the same parts to get the job done. If it doesn't improve performance, it won't be in the kit!  
 \*Kits contain "Fat Body" Arms with adjustable pins, needed components (springs, ramps, rollers, etc.) and baseline instruction setup.  
 Call or check web site for latest applications and contents.



<b>AKSK811:</b> 11-13 800E-Tec XP/Renegade	<b>\$359.99</b>
<b>AKSK808:</b> 08-11 800R Rev/Renegade	<b>\$324.99</b>
<b>AKSK804:</b> 04-07 800 Rev/Renegade	<b>\$324.99</b>
<b>AKSK609:</b> 09-13 600E-Tec XP/Renegade	<b>\$259.99</b>
<b>AKSK608:</b> 08 600 XP/Renegade	<b>\$324.99</b>
<b>AKSK603:</b> 03-07 600 Rev	<b>\$324.99</b>
<b>AKSK803:</b> 03 800 Rev	<b>\$449.99</b>
<b>AKSK109:</b> 09-13 1200 XP/Renegade	<b>\$324.99</b>

## TRA III ACCELERATOR ARMS

### "Fat Body" gives maximum belt grip

\*Increased belt grip improves belt life and acceleration.  
 \*Proper weight position transfers more power to the track.  
 \*Quicker throttle response and faster backshift.  
 \*Machined billet arm weighs 43g (stock arm is 34.5g).  
 \*Pulls harder in low and mid range; pin weight controls top rpm.  
 \*Lighter pins are recommended for top performance from arms.  
 \*Can be used with stock or aftermarket ramps and springs.  
 \*Drop in installation and allow full use of clicker adjustments.  
 \*Includes 3 bushed arms, cotter pins, and tuning instructions.



**#SKAA1:** Set of 3 arms **\$199.99**

## NEW TRAIL III LW ACCELERATOR ARMS

\*Modified "Fat Body" arms are 39 grams.  
 \*Lighter mid- range for quicker throttle response and backshift.  
 \*Still increases belt grip for acceleration and belt life.  
 \*Great for high altitudes or deep snow work.  
**#SKAA2:** Set of 3 arms **\$199.99**



Save with a complete tuning kit:

**#SKAA1K or SKAA2K:** Set of arms with your choice of pin kit\* **\$229.99**

\*Choose TPK001, TPK002, or TPK003 pin kit.

## TRA CLUTCH ROLLERS

### Improved rollers are "Made in the USA"

\*Last longer and perform better than stock rollers.  
 \*Stock imported OEM rollers use plastic composite bushing.  
 \*Teflon fiber bushing improves durability and reliability.  
 \*Fiber resists heat (plastic melts) for consistent clutch action.  
 \*Drop in installation for TRAIL, TRAILI, TRAILV with no tuning required.



**#SKR155:** Standard (10g) (set of 3 w/cotter pins) **\$67.99**

### OverSize Rollers:

\*Larger diameter increases acceleration and holeshot.  
 \*1mm weighs 12.5g and 2mm weighs 14.5 g.  
 \*Great tuning option, adjustable pins are recommended.  
 \*Works with any ramp/spring combo or clicker position.

**#SKR165:** 1mm oversize (set of 3 w/cotter pins) **\$69.99**

**#SKR175:** 2mm oversize (set of 3 w/cotter pins) **\$69.99**

### Related Parts:

\*Roller Kits include plastic stopper washers on each side of roller.

**SKR155K:** Standard rollers/washers **\$89.99**

**SKR165K:** 1mm oversize rollers/washers **\$91.99**

**SKR175K:** 2mm oversize rollers/washers **\$91.99**

\*See Clutch Components page 3 for replacement bushings.

## QRS SECONDARY CLUTCH ROLLERS

### Top performance with "Made in the USA" durable fiber roller

\*Stock imported plastic roller is used because of low cost.  
 \*Fiber composite is heat, wear, and corrosion resistant.  
 \*Tighter pin clearance stops roller from twisting and binding.  
 \*Concentricity roundness is held to .0005".  
 \*Closer tolerances have less friction and transfer more power.  
 \*Quicker response, consistent RPM, lower belt temps.

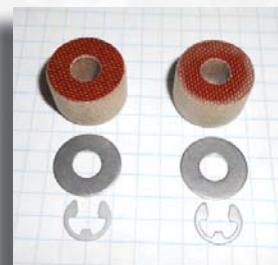

**#SKSR1:** 08-13 XP models (set of 2) **\$59.99**

**#SK7259WC:** Roller pivot pin, washer, circlip for SKSR1 roller or stock roller **\$19.99**

**#SKSR1K:** Complete set of rollers (SKSR1) with two pins (SK7259WC) **\$91.99**





## QUIKSHIFT PIN KIT

Adjustable pin kits offer quick TRA tuning

\*Adjust pin weight to match altitude or performance mods.

\*Fit stock or aftermarket arms and rollers.

\*More weight gives faster upshift increasing acceleration.

\*Each kit contains 3 pins (9 for TPK004), screws, and cotter pins.

\*Weight combination chart included for accurate adjustments without a gram scale.



#TPK001: Standard pin 10.5 to 17.7 grams	\$42.99
#TPK002: Heavy pin 14.5 to 20.5 grams	\$42.99
#TPK003: Light pin 3.6 to 7.8 grams	\$42.99
#TPK004: Wide Range kit 3.6 to 20.5 grams*	\$89.99

\*Contains pins from 001, 002, and 003.

## TRA III CLUTCH RAMPS

Custom machined ramps for bolt-in performance

\*Work with stock or aftermarket arms, rollers and springs.

\*Adjustable pin kit recommended for maximum performance.

\*Two series allow tuning for type of performance desired.

\*Sold by set of 3 for one clutch.

Accelerator Ramps

\*Modified profile gives great trail performance.

\*Accelerate harder through mid-range with great top end.

\*Bolt-in performance on stock application.



#TRAR412: Modified OEM 412 ramp which is stock on 07-12 500SS, 09-12 600MXZ E-Tec.	\$109.99
#TRAR414: Modified OEM 414 ramp which is stock on 07 800HO MXZ, 08 600SDI MXZ/Renegade, 08-11 800R MXZ, 10-12 800R E-Tec MXZ.	\$109.99

### Aggressor Ramps

\*Custom ramp, not a modified stock profile.

\*Harder acceleration, fast backshift, and stronger top end.

\*Adjustable pin kit will be needed as these arms pull HARD!

#TRAR1: Super aggressive profile makes a great drag ramp, best on 800's or higher horsepower sleds.	\$109.99
#TRAR2: Aggressive shift profile in low through mid range makes a good drag/trail combo ramp, works on 600's or mid to higher horsepower sleds.	\$109.99

*"While many clutch kits improve acceleration, the Accelerator Clutch Kit's acceleration improvement was dramatic, with improved roll-on at trail speeds, and more smoke at the top end than stock."*

- Snow Goer Magazine

## TRA CLUTCH COMPONENTS

Save money with a clutch that is in top condition

\*Longer belt life and more MPG.

\*Worn clutches cause most performance problems.

\*TRAII=02 & older, TRAIII=03 & newer.

Note: Ski-doo used both in 02/03.

\*See Page 18 for tools to make clutch service easy.



#SKR155: Standard roller (set of 3)	\$67.99
#SK4302: Roller stopper washers (set of 6)	\$25.99
#SKR155K: Standard rollers/stopper washer set	\$89.99
#SK3021: Slider shoes or buttons (set of 6)	\$21.99
#SK7500: Spring cap assy TRAIII, 25mm long bolt casting; 03-07 800, 03-13 600	\$35.99
#SK2759: Spring cap assy TRAIII, 15mm long bolt casting; 08-13 800R, 07 800R/XRS	\$35.99
#SK2304: Spring cap assy TRAII	\$59.99

**NEW** #CAB235: 03-13 TRAIII sliding sheave bushing with circlip. Made in the USA, one piece Teflon fiber bushing gives smoother clutch action and longer wear than stock split metal unit.



\$22.99

**NEW** #CAB236: Bushing driver for #CAB235, dual head for removing/installing sheave bushing. \$21.99  
#SK4201: Sliding sheave bushing TRAII \$19.99

#SKTRA KIT: TRAIII rebuild kit includes SKR155K, SK3021K or K2, and CAB235	\$139.99
#SKTRAB KIT: TRAII rebuild kit includes SKR155K, SK3021K or K2, and SK4201	\$136.99

### Related Parts

#CAB230: Roller bushings: fits 08 and older OEM or SKR155/165/175 rollers (set of 3)	\$39.99
#CAB213: CAB230 bushing installation driver	\$17.99
#CAB240: Clutch arm pivot bushings (set of 6)	\$44.99

### Primary Clutch Springs

#HSS102: Spring 200/325 blk/pnk	\$29.99
#HSS103: Spring 200/380 blk/wht	\$29.99
#HSS104: Spring 185/360 blu/wht	\$29.99

## **NEW** SLIDER SHOE O-RINGS

Keep slider buttons tight

\*Viton o-rings hold up better than imported stockers.

\*Tight o-rings prevent vibration wear.

#SKOR1: Std. size slider o-rings (set of 6)	\$5.99
#SK3021K: Slider shoes/o-rings (set of 6)	\$27.49



### O-Ring Super Set

\*Slightly oversize o-rings keep sliders snug.

\*3 oversize/3 std. size o-rings for loose clutches.

#SKOR2: 3 std. & 3 oversize o-rings (set of 6)	\$6.99
#SK3021K2: Slider shoes/o-rings (set of 6)	\$28.49



## BELT DEFLECTION ADJUSTERS

Correct belt deflection improves performance and extends belt life

- \*Infinite adjustability for precise and accurate belt adjustments.
- \*Eliminates the stripped threads of stock plastic where applicable.
- \*Stock cast metal is brittle and takes limited adjustments.
- \*Uses stock tool kit wrench for adjustments.
- \*Works great to spread the sheaves for quick, easy belt changes.
- \*Belt deflection should be checked as belt wears and whenever a new belt is installed.
- \*Machined aluminum adjuster, Allen wrench, and instructions.

#SKBR1: 08-09 XP QRS roller secondary **\$89.99**

#SKNL2: 10-13 QRS **\$64.99**



## SPANNER WRENCH

- \*Replaces the flimsy stock spanner on 08-09 XP's.
- \*Fits the stock or FBP adjuster.
- \*Compact 6" spanner makes adjustments easy.

#SKSPW: 08-09 Ski-doo spanner wrench **\$29.99**



## Adjuster/Spanner 08-09 Combo Pack

#SKBSK: Save with adjuster/spanner combo pack. **\$109.99**

## RAGE CAGE POWER PACKS

Gains of up to SEVEN Horsepower

- \*Easiest, most reliable mod for dollar spent.
- \*Power picks up sooner, peaks higher, and carries longer.
- \*Save \$\$ over buying components separately.
- \*One kit per engine, only available for listed models.

#RAD84-1-KIT: 03-07 800HO/Power TEK **\$369.49**

Rage Cages, reed spacers, gaskets, and bolts.

#RAD84-KIT: 03-07 800HO/Power TEK **\$441.59**

Rage Cages, Power Wings, and gaskets.

#RAD85A-KIT: 08-13 800R Power TEK **\$422.39**

Rage Cages, Power Wings, and gaskets.

#RAD86A-KIT: 04-07 600HO SDI **\$459.99**

Rage Cages, reed spacers, Power Wings, gaskets, and bolts.



## REED SPACER TORQUE KITS

Increased performance and quicker throttle response

- \*Aluminum spacer increases the torque curve in the lower part of the RPM range.
- \*Gains of up to 3 hp. from low to upper mid-range.
- \*No loss of top end or jetting changes.

- \*Kits are complete with longer bolts and washers, spacers, new gaskets.

\*03-07 800HO: Replace the thick stock spacer for more low to mid range

#SKRS78: Ski-doo 600HO, 600HO SDI, 700, 07 and older 800 twins

#SKRSG1: Replacement gasket **\$77.99**

**\$4.99 ea**



## RAGE CAGE by Boyesen

No One Else Can Come Close!

\*Power: Add 3-4 hp on 800E-tec without fuel controller.

\*Precision Casting: Seamless one piece cage maximizes airflow.

\*Ram Air: Aerodynamic dividers pack intake charge into cylinder.

\*Multi Stage Reeds: High flow velocity across entire RPM range.

\*Model Specific: Unique to the model, year, and displacement.

\*For best value, see Rage Cage Power Packs and SAVE \$\$\$.



#RAD81A-2: 01-04 700, 01-03 800

(all have balance tubes)

**\$306.99**

#RAD83-2: 00-03 500, 08-10 500SS, 99-03 600, 0-13 600carb

**\$263.99**

#RAD83A-2: 04-07 500SS

(cage and manifold replacement)

**\$297.49**

#RAD84-2: 03-07 600HO, 03-07 800HO P-Tek/R

**\$297.49**

#RAD85A-2: 08-13 800R P-Tek

**\$277.99**

#RAD86A-2: 04-07 600 SDI

**\$316.79**

#RAD88-2: 11-13 800R E-Tec

**\$306.99**

## CARBON TECH REEDS

Big gains, value priced

\*Lightweight carbon fiber gives immediate reed action.

\*Improved throttle response and acceleration.

\*Bolts onto stock reed cages for up to 3 hp gain.

#277: 99-02 440, 03-13 550 fan, 00-10 500SS

**\$105.49**

#206: 03-07 600HO, 04-08 600SDI, 09-13 600E-tec, 10-13 600 carb, 00-04 700, 01-03 800

**\$123.49**

#207: 03-13 800SDI, 800HO/R P-Tek/E-Tec, 05-07 1000SD **\$179.49**



## POWER X-WINGS

Increased airflow velocity

\*More horsepower and torque.

\*Quicker throttle response, better low to mid power.

\*No loss of top end.

#PW-27: 04-07 600HO SDI

**\$191.99**

#PW-25: 03 600HO, 03-07 800HO, 08-13 800R P-tec

**\$191.99**

#PW-28: 11-13 800R E-Tec

**\$191.99**



DENNIS



**RIDE -----****----- TECH****Suspension Stage Kits\***

Suspension Upgrade for MXZ,  
Renegade, REV, XP, XS, XR

Includes shock service, re-valving,  
and parts for a complete package!

\*Stage kits that match sled suspension to rider's weight and style.

\*Model tested for improved overall ride and handling.

\*Your shocks + our service & mods = less harshness and more control.

\*Includes all 4 shocks and components for a complete suspension upgrade.

\*Improved ride on Rev or XP models; MXZ, Renegade, and Summit!



**RIDE Tech Stage #1:** Basic shock service with re-valve mods (rider choice for softer or stiffer valving) fine tunes the suspension system.

**\$249.00**

**RIDE Tech Stage #2:** Most popular kit for handling washboard and whooped out trails. Better overall handling; improved front end control, less ski lift, with a rear end that smoothes the stutter bumps yet resists bottoming in the big hits.

**\$395.00**

**RIDE Tech Stage 2 Plus:** A boost to Stage 2 with firmer settings for more aggressive and/or heavier riders. Stiffer overall yet not into hardcore Stage 3.

**\$435.00**

**RIDE Tech Stage #3:** Sacrifices some low speed compliancy but swallows up the big crunchers for super aggressive riders or racers.

**\$499.00**

See more Ride Tech Stage Kit information on pages 21 and 22.

\*Prices are average based for standard shocks and may vary with model/year and work required.

### Control from the Ground UP!



CADBURY "SHOP MASCOT"

**BELLY BRACE**

Protects and strengthens A-arm/  
steering area

\*Save on costly repairs of cast steering mount.

\*Steel is zinc plated black for great appearance.

\*Will mount under skid plates.

\*Fits all XP/XR models.

\*Includes hardware for easy bolt-on installation.



#SKBB1: 08-13 XP/XR models

**\$74.99**

**FRONT BUMPER**

Heavy Duty Nose Protection

\*1" square aluminum tubing for strength.

\*Extra space between hood and bumper for hand hold.

\*Wide wings provide side impact protection.

\*Save over \$800 in parts if a tree jumps in front of you.



#SKFB1: 08-12 XP front bumper black

**\$139.99**

#SKFB2: 2013 XS/XM front bumper black

**\$149.99**

**RACE BRACE**

Support your 08-12 XP

\*Prevent sagging running boards on these lightweight sleds.

\*Stock running board holes and grip teeth still functional.

\*Adds strength and a great personalized appearance.

\*Sold in pairs with mounting rivets.



SK500B: black

**\$86.99**

SK500Y: yellow

**\$86.99**

*"We've used Dyno Port exhaust systems with consistent power gains and weight reductions in each case."*

*- Snow Tech Magazine*



## DYNO PORT PIPES

Real power, not hyped dyno numbers

\*Fit into stock or aftermarket cans.

\*Tested on long, hot pulls for up to **6 real horsepower**.

\*5 second dyno runs may show big gains but 30 second runs show the real numbers.

\*Made for snowmobilers, not dyno riders.



## DYNO PORT CANS

Don't pay for noise with less power

\*Baffled cans keep the power up

\*Controlled back pressure for consistent power.

\*Open, loud cans can lose 1-4 horsepower.

\*Throaty sound with no jetting required.



Model	Part # Pipe Ceramic	Part # Pipe Black	Part # Can Ceramic	Part # Can Black
10-13 XP800 E-Tec	S2871	S2870	S2877	S2876
08-11 XP800R	S2531	S2530	S2527	S2526
07 Summit 800R	S2434	S2433	S2436	S2435
04-07 Rev 800HO/TEK	S2051	S2050	S2028	S2027
03 Rev 800	S1943	S1942	S1941	S1940
02 MXZ 800	S1775	S1774	S1771	S1770
00-01 MXZ800	S1666	S1548	S1665	S1549
02 MXZ700	S1773	S1772	S1771	S1770
00-01 MXZ700		S1677		S1660
09-13 XP600 E-Tec	S2643	S2642	S2877	S2876
08-09 XP600 SDI	S2639	S2638	S2546	
04-07 Rev 600carb	S2074	S2073	S2060	S2059
04-07 Rev 600 SDI	S2074	S2073	S2062	
03 Rev 600HO	S1969	S1968	S1908	S1907
03 MXZ600HO	S1952	S1953	S1951	S1950
08-13 XP500SS/600carb	S2611	S2609	S2521	S2520
04-07 Rev 500SS	S2450	S2449	S2060	S2059
00-03 MXZ500/600	S1230	S1229		
01-03 MXZ500/600			S1663	S1662
99-00 MXZ500/600			S1160	S1159
<b>Price</b>	<b>\$547.99</b>	<b>\$447.99</b>	<b>\$347.99</b>	<b>\$297.99</b>

## OFFSET IGNITION KEY

\* Advance the timing curve for up to 2 hp. gain.

\* 1 to 3.5 degrees advance dependent upon stroke and rod offset.

\* Better throttle response, mid-range, and top end.

\* Fits Ski-doo models from early to present, replaces OEM #420246015.



#SKW010 (1.1 degree)

\$21.99

#SKW020 (2.4 degree)

\$21.99

#SKW030 (3.6 degree)

\$21.99

## XP800R & 800 E-TEC Y-PIPE

Bolt-on up to 3 horsepower

\*Matched port, correct length, and symmetrical taper.

\*Works with stock or aftermarket pipe and/or can.



#S2562: 08-09 800 black

\$197.99

#S2563: 08-09 800 ceramic

\$247.99

#S2651: 10-11 800 black

\$197.99

#S2652: 10-11 800 ceramic

\$247.99

#S2872: 10-13 800E black

\$197.99

#S2873: 10-13 800E ceramic

\$247.99



## QUICK ADJUST CAM ARMS

Tune without removing arm from the clutch

- \*No need to remove cam arm when adding or subtracting weight.
- \*Up to 7.5 grams of adjustability in each arm.
- \*Put weight where needed when fine tuning.
- \*Quick and easy for altitude adjustments.
- \*Save money/time vs. buying and/or grinding multiple sets.
- \*Same profile as stock for easy bolt-in tuning.
- \*Great for turbo sleds when adding boost.
- \*Includes 3 cam arms, Allen wrench, tuning screws, and instructions.



### 04-13 Cat fixed pin cam arms\*

\$218.99

**#QACA-XLW:** 62-69.5 grams

**#QACA-LW:** 63.5-71 grams

**#QACA-1W:** 67.5-75 grams

**#QACA-1BW:** 70.5-78 grams

**#QACA-2W:** 73.5-81 grams

**#QACA-2BW:** 76.5-84 grams

**#QACA-3W:** 80-87.5 grams

**#QACA-4W:** 83.5-91 grams

**#QACA-5W:** 86.5-94 grams

**#QACA-6WL:** 87-94.5 grams\*\*

**#QACA-6W:** 89.5-97 grams

**#QACA-7W:** 94.5-102 grams

\*\*6WL: slightly lighter mid-tip than 6W (6W has more early mass than 1W-5W)

### Pre 04 Cat bushed cam arms\*

\$228.99

**#QAA-1:** 57.5-65 grams

**#QAA-2:** 61.5-69 grams

**#QAA-3:** 65.5-73 grams

**#QAA-4:** 69.5-77 grams

**\*Tuning Note:** Lighter weight listed is an empty arm, included multiple length set screws allow arm to be fully loaded up to the maximum weight listed. Purchase a set that is slightly lighter (when empty) than your stock arm so tuning weight can be added.

## SUPER SLUGS

\*More mass without buying a new set of cam arms.

\*Tungsten screws add almost 4 grams to standard set.

**#QACA-SS:** 5.4 gram, 7/8" set screw (set of 6)

\$98.99

## DIAMOND DRIVE ACT CLUTCH ROLLERS

Extra hard fiber composite outperforms plastic rollers

\*Fiber replacement rollers transfer more power.

\*High load, heat resistant fiber for today's high output engines.

\*Tighter tolerances prevent clutch binding with less wear.

\*Quicker response, consistent RPM, lower belt temps.

**#ACSR2:** 04-13 ACT secondary clutches (set of 6)

\$39.99

## PRO-CROSS/PRO-CLIMB SECONDARY ROLLERS

Quicker response, consistent RPM, and less belt wear

\*Made in the USA machined roller not imported plastic.

\*Machined tolerance (+or - .0005") eliminates binding.

\*Fiber is heat, wear, and corrosion resistant.

\*Great for turbo horsepower.

\*Set of 2 with stainless steel washers to reduce friction.

**#ACSR3:** 12-13 800/1100/1100 turbo

\$59.99



## ACCELERATOR CLUTCH KIT

True "Trail Performance" Clutch Kit!

\*Harder acceleration, more mid range, great top end, and quick backshift.

\*No loss of reliability and improved belt life.

\*Quicker corner to corner acceleration.

\*Gains of 2-3 lengths @ 1,000 feet with better top end.

\*Adjustable feature allows for different mods, style, or weight.

\*Kits contain adjustable cam arms, needed components (springs, helix, gears, etc), and basic set-up instructions. Many companies offer a standard kit of arms, two springs, and helix. All sleds do not need the same parts to get the job done. **If it doesn't improve performance, it won't be in the kit!**

Call or check web site for latest applications and contents.



<b>#AKAC812:</b> 12-13 F800 Pro Cross	\$359.99
<b>#AKAC812X:</b> 12-13 XF800 Pro Cross	\$359.99
<b>AKAC810:</b> 10-11 800HO; CFR, Crossfire, F, EXT	\$359.99
<b>AKAC809:</b> 09 800 CFR	\$359.99
<b>AKAC807:</b> 07-09 F8	\$359.99
<b>AKAC807X:</b> 07-09 Crossfire 800	\$359.99
<b>AKAC706:</b> 06 F7	\$359.99
<b>AKAC705:</b> 05 F7, 06 Crossfire 7	\$315.99
<b>AKAC704:</b> 04 F7, 04-05 F7/reverse, 04-06 Saber 7	\$286.99
<b>AKAC703:</b> 03 F7	\$299.99
<b>AKAC607:</b> 07-11 F6, 07-08 Crossfire 6	\$359.99
<b>AKAC606:</b> 06 F6	\$359.99
<b>AKAC606X:</b> 06-07 Crossfire 6	\$359.99
<b>AKAC605:</b> 05 F6	\$315.99
<b>AKAC604:</b> 04 F6, 05-06 F6/reverse, 04-06 Saber 6	\$299.99
<b>AKAC903:</b> 03 ZR900	\$299.99
<b>AKAC802:</b> 02-03 800 ZR, ZL	\$299.99
<b>AKAC801:</b> 01 800 ZR, ZL	\$299.99



## CLUTCH COMPONENTS

Save money with a clutch that is in top condition

\*Longer belt life and more MPG.

\*Worn clutches cause most performance problems.



### Drive clutch components

#CA9029: Spider rebuild kit (6 and 9 post) includes rollers, pins, washers, slider buttons.

\$109.99

#CA9030: Cam arm pin kit (pre 04 non fixed pin) includes bolts, nuts, washers, bushings.

\$45.99

#CA9674: Cam arm pin kit (04 & up fixed pin) includes bolts, nuts, o-rings, set screws.

\$32.99



#CAB215: Cam arm bolt bushing kit (fixed pin 04 & up) longer Teflon fiber extends wear for faster, clutch response (set of 6).

\$54.99

#CAB210: Cam arm bushing kit (pre 04 non-fixed style) (set of 3).

\$26.99

#CAB213: CAB210 bushing installation driver

\$17.99

#CAB216: Cover bushing with clip (03 & up) fits stock or turbo cover.

\$18.99

#CAB217: Bushing driver for #CAB216, dual head for removing/installing cover bushing.

\$21.99

\*See Page 18 for tools to make clutch service easy.

### Clutch Springs

#### Primary Springs

#HSAP102: 140/300 red/wht\*

\$24.99

#HSAP103: 168/310 yel/pnk\*

\$24.99

**NEW** #HSAP105: 130/345 aqua/blk\*

\$30.99

\*Spring load measured at 2.5" and 1.25"

#### Secondary Spring (Std. Torsional)

#HSA201: 85/145 pur/wht\*

\$30.99

\*Spring load measured at 2.5" and 1.4"

#### Secondary Springs (ACT Drive)

#HSAE201: 165/269 mar/pnk\*

\$30.99

#HSAE202: 152/245 ble/wht\*

\$30.99

#HSAE205: 180/295 yel/pnk\*\*

\$30.99

\*Spring load measured at 2.2" and 1.1"

\*\*Spring load measured at 3" and 1.5"

#### Secondary Springs (12-13 Pro Cross)

**NEW** #HSAS201: 152-258 grn/brz\*

\$30.99

**NEW** #HSAS202: 185/320 grn/gld\*

\$30.99

\*Spring load measured at 2.75" and 1.5"

Stock 2012 Cat black/blue is 175/285

## PRIMARY TURBO FLOW COVER

Turbo flow venting gives longer belt life

\*Directional venting forces cool air through the clutch.

\*Machined aluminum is lighter than stock.

\*Tight tolerances keep towers aligned.

\*Includes replaceable bushing and circlip.

#ACPC1: 03 & newer, 6 tower

\$199.99



### Related parts

#CAB216: Cover bushing with circlip (also fit stock covers)

\$18.99

#CAB217: Driver to remove/install CAB216 bushing.

\$21.99

## HD CLUTCH SPIDER

Machined billet takes big loads

\*All bases covered with two types of threads.

\*No flex billet gives precise sheave action.

\*Eliminates stripped threads and cracked castings.

\*Bare spider, rollers must be ordered separately.



#ACBSP: SAE threads, fits up to 09

\$199.99

**NEW** #ACBSPM: Metric threads, fits 2010 & up

\$199.99

#CA9029: Spider roller kit

\$109.99

#DCT-SK1: 10-13 spider jam nut socket

\$49.99

## OFFSET IGNITION KEYS

More power and acceleration, up to 2 hp. gain

\*Simple timing option for fixed stator plates.

\* 1-4 degrees advance dependent upon stroke, rod, and offset.

\* Premium fuel may be required with more advance.



#CTW010 (1.4degree)

\$21.99

#CTW020 (2.5degree)

\$21.99

#CTW030 (3.5degree)

\$21.99

440/500/600/700 ZR, 600 ZRT, 04-06 =F6, Saber EFI, 03-06= F7, Saber EFI, 05-08 =M6, M7 EFI, Crossfire 6/7, 07-13 =F5/6/8/1000, M6/8/1000, Crossfire 6/8/1000, Jag Z1, Pro-Cross F/XF, Pro-Climb M.

#CTR010 (1degree)

\$21.99

#CTR015 (2degree)

\$21.99

#CTR020 (3degree)

\$21.99

#CTR030 (4degree)

\$21.99

800/900 ZR, 800 ZRT, 900/1000 T Cat, 03-06 =F5, 04-05= F6 Carb, Saber Carb, 03-06= F7 Carb, M7 Carb



SPENCER FETT

Photos Courtesy of:  
John Sandberg

218-334-3388 • WWW.FETTBROS.COM

Arctic Cat



## BELT DEFLECTION ADJUSTERS

Correct belt deflection improves performance and extends belt life

\*Infinite adjustability eliminates need for special shims that are too thick or too thin.

\*Machined aluminum for precise and accurate belt adjustments.

\*Works great to spread the sheaves for quick, easy belt changes.

\*Belt deflection should be checked as belt wears and whenever a new belt is installed.



### Adjuster Diamond Drive 05-09

\*Adjust with stock tool kit spanner (05-06); 07-09 models will need FBP Spanner #ACSPW.

\*Aluminum adjuster, Allen wrench, vented bolt/washer, and instructions.

#ACBLx: LH threads; 05 white plastic, all 06-09 Diamond Drive

\$89.99

### Spanner Wrench

\*Fits ACBLx or stock plastic adjuster.

\*Easy adjustments with compact 6" wrench.

#ACSPW:

\$29.99



### Combo Pack Adjuster/Spanner Wrench

#ACBSKLx: Save \$\$, includes #ACBLx and #ACSPW

\$109.99

### Adjuster Diamond Drive 10-13

\*Same great features of our original adjuster.

\*Aluminum adjuster, Allen wrench, and instructions.

#ACBR2: 10-13 Diamond Drive

\$89.99



### Adjuster Pro-Cross/Pro-Climb 12-13

\*Fits the NEW Cat secondary.

\*Same great features as our original adjuster.

\*Aluminum adjuster, Allen wrench, and instructions.

#ACBR3: Pro-Cross/Pro-Climb with chain case

\$94.99

## PROCROSS/PROCLIMB MUFFLERS

Shed some serious pounds

\*Trail friendly with a bit more bark than stock.

\*No loss of reliability, perform the same or better than stock.

\*800 muffler is 4-6 decibels quieter than stock @ 4000 rpm.

\*Bolt on using stock location and hardware.



### 2012-2013 F/XF/M Procross/Proclimb

#AC800M: 800 black can, save 11 lbs.

\$249.99

#AC800M-C: 800 ceramic can, save 11 lbs.

\$354.99

#AC1100M: 1100 non turbo black can, save 8 lbs.

\$249.99

#AC1100M-C: 1100 non turbo ceramic can, save 8 lbs.

\$354.99

## SNO PRO 500 TRAIL KIT

Butt kicking 5-7 hp increase

\*Trail porting/head mods wake up engine.

\*Quicker throttle response.

\*Premium fuel recommended.

\*No fuel controller needed.

\*New head & base gaskets.

\*Fun like the old "ZR440" without the jetting issues.

\*Send your cylinders/head for mods.

#SP500TK: 10-13 SP500

\$369.99



### Clutching SP500TK

\*QACA cam arms put mod trail kit power to the track.

\*Includes arms and set-up instructions.

#QACA-LW: QACA cam arms

\$218.99

Save:

Purchase SP500TK with cam arms

\$559.99

### RIDE TECH STAGE KIT for Sno Pro 500

\*Send in your 4 shocks for a Ride Tech Stage 2 Kit.

\*Smooth out the stutters and corner sharper.

\*Takes the sharp kick out rear end.

\*Sucks up the 12" moguls.

\*Sharper handling and more control.

#RT500SP: Ride Tech Stage 2

\$449.00

### SAVE on Complete Package:

SP500TK + QACA-LW + RT500SP

\$979.99

## RAIL REPAIR BRACKET KIT

Fix for elongated slide rail mount holes

\*Bolts tend to loosen on center shock lower mount shaft.

\*Bolt on brace eliminates the need for welding or rail replacement.

\*Add to new rails for extra strength and prevent damage.

\*Includes 2 aluminum pre-drilled plates and hardware.

#ACRB1: 12-13 800/1100/1100 turbo Pro Cross F models

\$79.99



## STEEL CROSS SHAFT

Steel fixed shaft on Slide Action rear suspension

\*Front aluminum stock shaft bends with aggressive riding (see photo).

\*Shaft is included on many Ride Tech suspension kits.

\*Keeps suspension running straight for improved shock action.

#ACSFT1: (15.4") 07 F series

(STD, LXR, Z1, or SP)

\$27.99

#ACSFT2: (15") 08-13 F series

(STD, LXR, Z1, or SP)

\$27.99





## RIDE TECH FLOAT AIR CANISTER

### Eliminate Fox Float washboard harshness

- \*Increased air volume gives softer, more linear shock action.
- \*Smoother/softer ride at low speeds yet soaks up big hits.
- \*"Made for dummies" with no knobs or screws to adjust.
- \*Small volume changes give big results as stock capacity is minimal.
- \*Fits Fox Float 1 or 2, no special tools, adjust with stock pump.
- \*Compact size (3.5"x1/2" with AIRC2 slightly longer).
- \*Easy install, no special tools, adjust with stock air pump.

**Two sizes to better match suspension duties!**

#### Air Can 1:

- \*Gives more compliant low speed shock action.
- \*Smoother/softer stutter compliance, ramps up for big hits.
- \*Aggressive riders who need quick ramp up for the deep holes.

#AIRC1: Set of 2

\$98.99

#AIRC1E: Single Unit

\$59.99



#### Air Can 2:

- \*3 times more air capacity than Air Can 1 offers a wider range of tuneability.
- \*Larger volume allows shock to stay soft through more of the travel before stiffening up.

\*Groomed trail riders looking for more overall compliance with big bump absorption.

#AIRC2: Set of 2

\$141.99

#AIRC2E: Single Unit

\$84.99



#### Air Can 2 Black:

- \*Same as AIRC2 except anodized black.
- \*Classy appearance sets your sled apart from the crowd.

#AIRC2B: Set of 2

\$151.99

#AIRC2EB: Single Unit

\$91.99



**Note: Air Canisters are no substitute for proper shock valving, see Ride Tech Kits for best suspension action. Adding Air Canisters to stock or Ride Tech kits allows extra tuning of low to mid-range shock compliance. See Shop Talk on our web site for latest tips.**

*"Ride Tech Suspension Kits made our Cat handle better, corner flatter, and keep the sled on track in rough conditions."*

*- Snow Goer Magazine*

## RIDE -----

### ----- TECH

#### Suspension Stage Kits\*

**Suspension Upgrade for ZR, Firecat, Crossfire, F series, Sno Pro, Pro-Cross**

**Includes shock service, re-valving, and parts for a complete package!**

\*Stage kits that match sled suspension to rider's weight and style.

\*Model tested for improved overall ride and handling.

\*Your shocks + our service & mods = less harshness and more control.

\*Includes all 4 shocks and components for a complete suspension upgrade.

\*Improved ride on all Cats, big results on Firecat, CFR, Sno Pro, and Pro Cross!



**RIDE Tech Stage 1:** Basic shock service with re-valve mods (rider choice for softer or stiffer valving) fine tunes the suspension system.

**\$249.00**

**RIDE Tech Stage 2:** Most popular kit for handling washboard and whooped out trails. Better overall handling; improved front end control, less ski lift, with a rear end that smoothes the stutter bumps yet resists bottoming in the big hits.

**\$395.00**

**RIDE Tech Stage 2 Plus:** A boost to Stage 2 with firmer settings for more aggressive and/or heavier riders. Stiffer overall yet not into hardcore Stage 3.

**\$435.00**

**RIDE Tech Stage 3:** Sacrifices some low speed compliance but swallows up the big crunchers for super aggressive riders or racers.

**\$499.00**

**RIDE Tech Sno Pro 500 Kit:** Smooth the stutters, corner sharper, reduce the sharp rear end rebound "kick", and still sucks up the moguls.

**\$449.00**

**See more Ride Tech Stage Kit information on pages 21 and 22.**

\*Prices are average based for standard shocks and may vary with model/year and work required.

**Control from the Ground UP!**

## OVERLOAD SUSPENSION BLOCKS

### Spring blocks for the Big Boys

\*Durable aluminum replaces stock plastic unit.

\*Overload setting option for heavy loads.

\*Used on many Ride Tech Kits.



#ACADJ-OL: 95-13 all models

**\$45.99**



## FRONT BUMPER

### Great looking nose protection

- \*Solid aluminum tubing gives lightweight strength.
- \*Plenty of room for gloved handhold when moving sled.
- \*Awesome appearance with 2 powder coated options.

### Sno Pro 500/600

- \*More clearance than factory optional bumper.
- \*Gives more crush room before damaging nose cone.
- \*Complete with mounting hardware.

#ACFB2: Black; 10-13 Sno Pro 500, 08-11 Sno Pro 600 **\$129.99**



#ACFB3: White; 10-13 Sno Pro 500, 08-11 Sno Pro 600 **\$129.99**



### Pro Cross/Pro Climb

- \*More clearance than stock for better nose protection.
- \*Extra protection for exposed lower nose cone.
- \*Complete with mounting hardware.

#ACFB4: Black; 12-13 800 and 1100 non-turbo **\$129.99**



#ACFB5: White; 12-13 800 and 1100 non-turbo **\$129.99**



## RAGE CAGE by Boyesen

### No One Else Can Come Close!

- \***Power:** Add 4-5 hp on 800HO without fuel controller.
- \***Precision Casting:** Seamless one piece cage maximizes airflow.
- \***Ram Air:** Aerodynamic dividers pack intake charge into cylinder.
- \***Multi Stage Reeds:** High flow velocity across entire RPM range.
- \***Model Specific:** Unique to the model, year, and displacement.

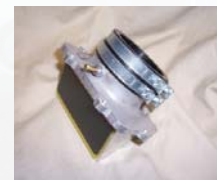

#RAD51B-2: 01-06 800/900 ZR/ZL/Mtn, 07-09 500 XFire; 06-13 500SP/FCat/XFire/M5; 04-11 600 FCat/XFire/M6/F6; 03-06 700 FCat/XFire/M7. **\$263.99**  
 #RAD51C-2: 07-09 800 F/M/XFire **\$277.99**  
 #RAD53-2: 10-13 800HO **\$306.99**  
 #RAD52-2: 07-11 1000 F/M/XFire **\$306.99**

## CARBON TECH REEDS

### Big gains, value priced

- \*Lightweight carbon fiber gives immediate reed action.
- \*Improved throttle response and acceleration.
- \*Bolts onto stock reed cages for up to 3 hp gain.
- #273: 01-06 800/900 ZR, ZL; 03-12 5/6/7/8 Fire Cat/XFire/M/F; 10-13 SP500 **\$117.79**  
 #274: 10-13 800HO; 07-11 1000 F, M, XFire **\$117.79**



## REED SPACER TORQUE KITS

### Increased performance and quicker throttle response

- \*Aluminum spacer increases the torque curve in the lower part of the RPM range.
- \*Gains of up to 3 hp. from low to upper mid-range.
- \*No loss of top end or jetting changes.
- \*Kits are complete with spacers, new gaskets.

#ACRS02: 440/500/600 ZR/ZL twins **\$77.99**  
 #ACRS82: 800/900 twins, F5/6/7/8/1000 **\$77.99**  
 #ACRS03: Triple cylinders **\$99.99**  
 Replacement gaskets available **\$4.99 ea**



"I am 100% satisfied with my order, Thanks!"

- Ken Stoner



DALE

FETT BROTHERS PERFORMANCE LLC



## RIDE -----

### ----- TECH

#### Suspension Stage Kits\*

Suspension Upgrade for Edge, Fusion, IQ, Dragon, Rush

**Includes shock service, re-valving, and parts for a complete package!**

\*Stage kits that match sled suspension to rider's weight and style.

\*Model tested for improved overall ride and handling.

\*Your shocks + our service & mods = less harshness and more control.

\*Includes all 4 shocks and components for a complete suspension upgrade.

\*Improved ride for Edge, IQ, and big results on the Rush models.



**RIDE Tech Stage #1:** Basic shock service with re-valve mods (rider choice for softer or stiffer valving) fine tunes the suspension system.

**\$249.00**

**RIDE Tech Stage #2:** Most popular kit for handling washboard and whooped out trails. Better overall handling; improved front end control, less ski lift, with a rear end that smoothes the stutter bumps yet resists bottoming in the big hits.

**\$405.00**

**RIDE Tech Stage 2 Plus:** A boost to Stage 2 with firmer settings for more aggressive and/or heavier riders. Stiffer overall yet not into hardcore Stage 3.

**\$459.00**

**RIDE Tech Stage #3:** Sacrifices some low speed compliancy but swallows up the big crunchers for super aggressive riders or racers.

**\$499.00**

**RIDE Tech Rush Kit:** 121"/136" Rush/Switchback. Sharper cornering, smooths the washboard, eliminates the harsh jar at mid stroke, better control in big moguls at speed.

**\$469.00**

**See more Ride Tech Stage Kit information on pages 21 and 22.**

\*Prices are average based for standard shocks and may vary with model/year and work required.

**Control from the Ground UP!**

*"My Rush Guard could not have been easier to install, fits and looks great! Nice add-on item, fast shipping, thank you."*

*- Rich Dundon*

## RUSH GUARD

**Body Armor for the heat exchanger**

\*Extra protection for the exposed heat exchanger.

\*Designed to provide plenty of air flow for proper cooling.

\*Solid aluminum tubing for lightweight strength.

\*3 powder coated colors for an awesome appearance.

\*Bolt-on installation, will fit with skid plates.

\*Fits 10-13 Rush 600/800, 12-13 Rush Switchback 600/800.



**#PLRG1: Red**

**\$134.99**

**#PLRG2: Black**

**\$134.99**

**#PLRG3: White**

**\$134.99**



## CLUTCH COMPONENTS

**Save money with a clutch that is in top condition**

\*Longer belt life and more MPG.

\*Worn clutches cause most performance problems.



### Drive clutch components

**#PL1169:** Wide roller spider rebuild kit (.55" roller)

Includes: rollers, pins, washers, slider buttons, and cam arm bolts.

**\$122.99**

**#PL6516:** Cover bushing

**\$14.99**

**#PL6502:** Moveable sheave bushing

**\$18.99**

**#CAB210:** Cam arm bushing kit (set of 3)

**\$26.99**

**#CAB213:** CAB210 bushing installation driver

**\$17.99**

**#PL5105:** Cam arm pivot bolt with nut (set of 3)

**\$22.99**

**\*See Page 18 for tools to make clutch service easy.**

### Clutch Springs

Primary Springs:

**#HSAP102:** 140/300 red/wht\*

**\$24.99**

**#HSAP103:** 168/310 yel/pnk\*

**\$24.99**

**NEW #HSAP105:** 130/345 aqua/blk

**\$30.99**

\*Spring load measured at 2.5" and 1.25"

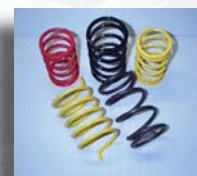

Secondary Springs (TEAM):

**#HSPT203:** 140/245 org/wht\*

**\$30.99**

**#HSPT204:** 180/260 red/wht\*

**\$30.99**

\*Spring load measured at 2.2" and 1.1"



## ACCELERATOR CLUTCH KITS

### True "Trail Performance" Clutch Kit!

\*Harder acceleration, more mid range, great top end, and quick backshift.  
 \*No loss of reliability and improved belt life.  
 \*Quicker corner to corner acceleration.  
 \*Gains of 2-3 lengths @ 1,000 feet with better top end.  
 \*Adjustable feature allows for different mods, style, or weight.  
 \*Kits contain adjustable cam arms, needed components (springs, helix, gears, etc), and basic set-up instructions. Many companies offer a standard kit of arms, two springs, and helix. All sleds do not need the same parts to get the job done. **If it doesn't improve performance, it won't be in the kit!**



AKPL811: 11-13 800 Rush	\$269.99
AKPL812S: 12-13 800 Rush Switchback	\$269.99
AKPL610: 10-13 600 Rush	\$269.99
AKPL612S: 12-13 600 Rush Switchback	\$269.99
AKPL708: 08 700 Switchback	\$269.99
AKPL608: 08-09 600 IQ/Dragon	\$298.99
AKPL608S: 08-11 600 Switchback	\$269.99
AKPL707: 07-08 700 Dragon	\$239.99
AKPL606: 06-07 600 Fusion/IQ, 08 600 Shift	\$298.99
AKPL606S: 06-07 600 Switchback	\$269.99
AKPL802: 02-03 800 Edge	\$359.99
AKPL701: 01-03 700 Edge	\$359.99
AKPL601: 01-03 600 Edge	\$359.99

## QUICK ADJUST CAM ARMS

### Tune without removing arm from the clutch

\*No need to remove cam arm when adding or subtracting weight.  
 \*Up to 7.5 grams of adjustability in each arm.  
 \*Put weight where needed when fine tuning.  
 \*Quick and easy for altitude adjustments.  
 \*Save money/time vs. buying and/or grinding multiple sets.  
 \*Same profile as stock for easy bolt-in tuning.  
 \*Great for mod work or adding turbo boost.  
 \*Includes 3 cam arms, Allen wrench, tuning screws, and instructions.



<b>Polaris bushed cam arms</b>	<b>\$228.99</b>
#QAP-1: 58-65.5 grams	
#QAP-2: 62-69.5 grams	
#QAP-3: 66-73.5 grams	
#QAP-4: 70-77.5 grams	

**\*Tuning Note: Lighter weight listed is an empty arm, included multiple length set screws allow arm to be fully loaded up to the maximum weight listed. Purchase a set that is slightly lighter (when empty) than your stock arm so tuning weight can be added.**

## SUPER SLUGS

\*More mass without buying a new set of cam arms.  
 \*Tungsten screws add almost 4 grams to standard set.  
 #QACA-SS: 5.4 gram, 7/8" set screw (set of 6)

**\$98.99**

## RAGE CAGE by Boyesen

### No One Else Can Come Close!

\*Power: Up to 5 hp increase.  
 \*Precision Casting: Seamless one piece cage maximizes airflow.  
 \*Ram Air: Aerodynamic dividers pack intake charge into cylinder.  
 \*Multi Stage Reeds: High flow velocity across entire RPM range.  
 \*Model Specific: Unique to the model, year, and displacement.



#RAD65-2: 98-07 500, 98-05 600, 97-05 700	\$263.99
#RAD67B-2: 08-10 800 CFI	\$306.99
#RAD68-2: 11-13 800 CFI	\$306.99

## CARBON TECH REEDS

### Big gains, value priced

\*Lightweight carbon fiber for immediate reed action.  
 \*Improved throttle response and acceleration.  
 \*Bolts onto stock reed cages for up to 3 hp gain.



#275: 99-07 500, 98-05 600, 97-05 700, 00-05 800	\$111.99
#276: 06-13 600carb/CFI, 06-13 700/800CFI, 05-06 900	\$178.99

## REED SPACER TORQUE KITS

### Increased performance and quicker throttle response

\*Aluminum spacer increases the torque curve in the lower part of the RPM range.  
 \*Gains of up to 3 hp. from low to upper mid-range.  
 \*No loss of top end or jetting changes.  
 \*Kits are complete with longer bolts and washers, spacers, new gaskets.



#PLRS02: Polaris domestic twins	\$77.99
#PLRS03: Polaris triples	\$99.99
#PLRSG1: Replacement gasket	\$4.99 ea



## DYNO PORT PIPES

Real power, not hyped dyno numbers

\*Fit into stock or aftermarket cans.

\*Tested on long, hot pulls for up to **6 real horsepower**.

\*5 second dyno runs may show big gains but 30 second runs show the real numbers.

\*Made for snowmobilers, not dyno riders.



## DYNO PORT CANS

Don't pay for noise with less power

\*Baffled cans keep the power up

\*Controlled back pressure for consistent power.

\*Open, loud cans can lose 1-4 horsepower.

\*Throaty sound with no jetting required.



Model	Part # Pipe Ceramic	Part # Pipe Black	Part # Can Ceramic	Part # Can Black
11-13 800 Rush	P2895	P2894	P2887	P2886
08-10 800 Drag/IQ			P2615	P2616
01-05 800 Edge	P2055	P1825		P1594
01-04 800 Pro X				P1987
00-01 800XC/RMK				P1414
07-09 700	P2491	P2620	P2488	P2487
01-05 700 Edge	P2055	P1825		P1594
01-04 700 Pro X				P1987
00-01 700 XC/RMK				P1414
97-99 700 XC/RMK				P1219
10-13 600 Rush			P2685	P2684
07-10 600CFI	P2439	P2622	P2354	P2358
06-10 600 Carb	P2355	P2359	P2354	P2358
01-05 600 Edge				P2067
01-04 600 Pro X				P1987
00 600(ves) XC/RMK				P1449
00-01 600XC/RMK				P1414
98-99 600XC/RMK				P1219
01-06 500(ves) XC/RMK				P2067
02 500XC/RMK				P1931
00-01 500XC/RMK				P1442
99 500 XC/RMK				P1154
<b>Price</b>	<b>\$547.99</b>	<b>\$447.99</b>	<b>\$347.99</b>	<b>\$297.99</b>

Call or check website for unlisted models.

## OFFSET IGNITION KEY

\* Advance the timing curve for up to 2 hp. gain.

\* 1 to 3.5 degrees advance dependent upon stroke, rod, and offset.

\* Better throttle response, mid-range, and top end.

\* Replaces stock OEM #7721117.

\* Fits all 01-13 600/700/800 twins also in 6/7/8 ATV, Rangers, or Razors.



#PLW010 (1.5 degree)	\$21.99
#PLW020 (2.5 degree)	\$21.99
#PLW030 (3.5 degree)	\$21.99

## 800 DRAGON/IQ & RUSH Y-PIPE

Bolt-on up to 3 horsepower

\*Matched port, correct length, and symmetrical taper.

\*Works with stock or aftermarket pipe and/or can.

**P2633:** 08-10 800 Dragon/IQ black

**\$197.99**

**P2634:** 08-10 800 Dragon/IQ ceramic

**\$247.99**

**P2884:** 11-13 800 Rush black

**\$197.99**

**P2885:** 11-13 800 Rush ceramic

**\$247.99**





## ACCELERATOR CLUTCH KITS

### True "Trail Performance" Clutch Kit!

- \*Harder acceleration, more mid range, great top end, and quick backshift.
- \*No loss of reliability and improved belt life.
- \*Quicker corner to corner acceleration.
- \*Gains of 2-3 lengths @ 1,000 feet with better top end.
- \*Adjustable feature allows for various differences (engine/track/weight/etc).
- \*Many companies have a standard kit of arms, two springs, and helix.
- All sleds do not need the same parts to get the job done. **If it doesn't improve performance, it won't be in the kit!**

\*Kits contain adjustable cam arms, needed components (springs, helix, gears, etc), and baseline instruction setup.

Call or check web site for latest applications and contents.



AKYA507: 07-13 Phazer	\$349.99
AKYA108: 08-13 Nytro	\$419.99
AKYA106: 06-10 Apex	\$389.99
AKYA106L: 06-08 Attak	\$389.99
AKYA905: 05-06 Vector/Range	\$389.99
AKYA103: 03-05 RX1	\$389.99
AKYA104: 04-05 Warrior	\$389.99
AKYA702: 02-04 Viper	\$389.99

## CLUTCH ROLLERS

### Improved rollers are "Made in the USA"

- \*Last longer and perform better than stock rollers.
- \*Stock OEM rollers use plastic composite bushing.
- \*Our Teflon fiber bushing improves durability and reliability.
- \*Fiber resists heat (plastic melts) for consistent clutch action.
- \*Smaller diameter upshifts faster/lowers rpm; larger diameter opposite effect.
- \*Rollers have 9mm ID which fits 06-13 4 strokes and late model 2 strokes



#YAR148: 14.8 mm O.D.	\$89.99
#YAR158: 15.8 mm O.D.	\$89.99
#CAB250: Replacement bushing fits YAR or OEM rollers (set of 3)	\$49.99

See Clutch Components for clutch replacement parts

## QUICK ADJUST CAM ARMS

### Tune without removing arm from the clutch

- \*No need to remove cam arm when adding or subtracting weight.
- \*Up to 7.5 grams of adjustability in each arm.
- \*Put weight where needed when fine tuning.
- \*Quick and easy for altitude adjustments.
- \*No pound and peen rivets, saves time.
- \*Includes 3 cam arms, Allen wrench, tuning screws, and instructions.



<b>Standard Cam Arms**</b>	<b>\$258.99</b>
#QAY-54: 54-61.4 grams (good Nytro arm)	
#QAY-62: 62-69.4 grams (good for Apex/RX1)	

<b>Boosted Cam Arms** (turbo or super charged)</b>	<b>\$258.99</b>
#QAY-T1: 73.6-81 grams (low boost, high altitude long tracks)	
#QAY-T2: 79-86.4 grams (most boost applications)	
#QAY-T3: 84.6-92 grams (higher boost applications)	

**\*\*Tuning Note: Lighter weight listed is an empty arm, set screws allow arm to be fully loaded up to the maximum weight listed. Arms have a slightly more aggressive profile than stock. This gives similar results with less weight and a lighter arm is more responsive with less spinning mass and faster backshift.**

## RIDE -----

### ----- TECH Suspension Upgrade

#### Suspension Upgrade for Ski Fox Floats

- \*Yamaha's Fox Float ski shocks are known for their harshness.
- \*Internally valves are still used to control shock action.
- \*Re-valving mods soften up the initial stroke yet keep the big hit resistance.
- \*Includes basic service and revalve mods to your set of Floats.
- \*Save on Air Canisters if added to package for improved shock action.



#### RIDE Tech Floater Stage 1:

\$165.00

## NYTRO BUMPER

### Heavy Duty Front Protection

- \*1" square aluminum tubing for strength.
- \*Extra space between hood and bumper for hand hold.
- \*Wide wings provide side impact protection.
- \*Save over \$700 in parts if a tree jumps in front of you.



#### #YAFB1: Nytro front bumper black

\$179.99

## CLUTCH COMPONENTS

### Save money with a clutch that is in top condition

- \*Longer belt life and more MPG.
- \*Worn clutches cause most performance problems.



#### Drive clutch components (1998 & newer)

#YAR148/158: 14.8mm & 15.8mm Rollers (set of 3)	\$89.99
#CAB250: Roller bushings (set of 3)	\$49.99
#YA9227: Roller spacer washers (set of 6)	\$8.99

#CAB220: Cam arm bushings (set of 3)	\$39.99
#YA8204: Cam arm spacer washer (set of 6)	\$12.99
#CAB225: Dual head installation driver for CAB220 and CAB250 bushings.	\$17.99
#YA8237: Outer cover bushing	\$15.99

\*See Page 18 for tools to make clutch service easy.

#### Primary clutch springs

#HSY101: 150/300 black*	\$27.99
-------------------------	---------

\*Spring load measured at 2.5" and 1.25"

#HSY102: 90/275 blk/sil**	\$30.99
---------------------------	---------

#HSY105: 85/295 red/wht**	\$30.99
---------------------------	---------

\*\*Spring load measured at 2.9" and 1.6"

#### Secondary clutch spring:

#HSY201: red/wht-more side force than Yamaha silver	\$30.99
---	---------



## ATV AND UTV CLUTCH KITS by Dalton

\*Restore lost power from larger tires or wake up stock units.

\*Improved belt grip for longer belt/clutch life.

\*Better acceleration, faster backshift, and quicker throttle response.

See E-store or call for latest applications and full details.



Part #	Application	Price
<b>Arctic Cat</b>		
DA450H	10-12 425/450, 11-12 Kymco MXU450: stock or oversize tires	\$69.99
DMT500C	500i 4x4 auto: stock or oversize tires	\$169.99
DKA6570MT	650 V-twin: stock or oversize tires 27"-28"	\$69.99
DA650HC	08 up 650/700, 07 up 650/700 Prowler: oversize tires	\$109.99
DSK750C	06 up 700EFI Suzuki engine only: stock or oversize tires	\$169.99
DA950HC	08 up H-2 1000: stock or oversize tires	\$109.99



<b>Can Am</b>		
DBO400	03 up 400HO: stock or oversize tires	\$314.99
DBO500	07 up 500HO: oversize tires	\$77.99
DBO650	650HO: stock or oversize tires	\$239.99
DBO800	06 up 800HO: stock or oversize tires	\$239.99
DBO800R	800HO Renegade: stock or oversize tires	\$239.99
DBO1000R	1000 Outlander stock tires/Renegade oversize tires	\$239.99
DBC1000	1000 Commander Side x Side	\$304.99



<b>Kawasaki</b>		
DK650/700S	650/700 Prairie, 650i Brute Force: 25"-26" tires	\$69.99
DKA6570MT	650/700 Prairie, 650i Brute Force: 27"-28" tires	\$69.99
DK750BF	05-07 750 Brute Force: stock or oversize tires	\$277.99
DK750E	08-11 750 Brute Force: stock or oversize tire up to 27"	\$349.99
DK750 B12	2012 750 Brute Force: 26"-28" tires	\$69.99
DUV-K750TX	08-12 750 Teryx: stock or oversize tires	\$394.99



<b>Polaris</b>		
DBW700	02-04 700 Sportsman: stock or oversize tires	\$234.99
DP700EBT	04.5 up 700EFI Sportsman: oversize tires only	\$244.99
DP850	09-10 850 Sportsman: stock or oversize tires	\$318.99
DUV-P7XP	05-07 700 Ranger: stock tires only	\$204.99
DUV-P8RZ	08-09 800 RZR/RZR/S: stock or oversize tires	\$318.99
DUV-P8RZ10	2010 800 RZR/RZR/S: RZR stock tires/ "S" stock or oversize	\$328.99
DUV-P8RZ11	11-12 800 RZR/RZR/S: stock or oversize tires (not for 900)	\$328.99
DUV-P8RZ4	11 up 800 RZR 4 seat: stock or oversize tires	\$328.99
DUV-P9XP	11 up 900 RZR XP: stock or oversize tires	\$308.99



<b>Suzuki</b>		
DSK450	450 King Quad: stock or oversize tires	\$155.99
DMT500C	03 up 500 Vinson: stock or oversize tires	\$169.99
DK650/700S	700 V-Twin: use with 25"-26" tires	\$69.99
DKA6570MT	700 V-Twin: use with 27"-28" tires	\$69.99
DSK750C	700/750 King Quad: stock or oversize tires	\$169.99



<b>Yamaha</b>		
DBW700Y	07 up 700 Grizzly: oversized tires	\$109.99
DP660Y	660 Rhino: secondary spring for 26"-27" tires	\$41.99
DP700Y	700 Rhino: secondary spring 26" & up tires	\$41.99

218-334-3388 • WWW.FETTBROS.COM



## CYLINDER RE-PLATING

Economical repair of damaged cylinders

\*Repair of scoring or broken ring/piston gouges.  
\*Less than a new cylinder and outperforms sleeving.

\*Turn time of 10-12 working days.

\*1 year warranty against defects.

**Strip, re-plate, and hone cylinder**

**\$189.99**

**Strip, skim bore, re-plate, and hone cylinder**

**\$219.99\***

**Strip, weld, bore, re-plate, and hone cylinder**

**\$249.99\*\***

**Rush Service Available** (4-6 working days)

**\$55.00**

\*Boring required prior to plating if there are score marks, grooves, or wear spots in bore up to .010".

\*\*Welding required prior to plating if damage is deeper than .010" or there are cracks in the cylinder.

**NOTE: Remove all studs, power valves, and fittings to avoid extra charge.**



## PISTON KITS

Available for most popular models

\*Include one piston, rings, pin, and circlips.

Cat 01-04 ZR/ZL800:

**\$70.99**

Polaris 00-06 800 twins:

**\$75.99**

Ski-doo 01-07 800/800HO:

**\$69.99**

\*Call or email for prices on your model.



## CYLINDER BORING

Precision fitment = long engine life

\*Oversize boring of 2 or 4 strokes.

\*Big bores or plated cylinders have extra charge.

\*Includes boring, honing, and port chamfering.

\*Piston required for proper fit.

\*Piston kits/gasket sets are available



**\$50/cylinder**

## HEAD MACHINING

Higher compression = more horsepower

\*Tighten up squish to factory specs for more power.



**\$50/cylinder**

## POWER HEAD MOD

\*More power and reliability than standard head machining.

\*Less chance of detonation with proper squish angle.

\*Machining of both squish band and gasket surface.

\*Carb or EFI (not recommended for deto sensor type heads).

**\$100/cylinder**

## CLUTCH BALANCING

Stock clutches vary up to 3 grams

\*Mass production means 3 grams is "close enough".

\*Computerized balancer is accurate (+/- .5 gram).

\*"Racer" secret to get maximum performance.

\*Increase drive train reliability and transfer more power.

**Primary:**

Cat/Polaris/Yamaha: Remove cam arms, cam arm bolts, and spring.

Ski-doo: Remove arms and arm bolts. Spring and ramps can be left intact.

**Secondary:** Leave complete.

**NOTE: \$15 charge to remove the above listed parts**



**\$50/clutch or \$90/set**

## CRANKSHAFT EXCHANGE

Saves time and money

\*When rods or bearings fail, it makes \$ense to replace all parts.

\*New rods, pins, and all bearings (seals not included).

\*90 day warranty offers great value.

\*Old crank needed to avoid core charge.

\*Normal turn time of 3-5 days.

\*Examples listed, call with make/model for current price.



**Polaris**

07-10 600HO cleanfire twin

**\$480.00**

00-05 800 twin with HD PTO bearing

**\$565.00**

**Ski-doo**

03-07 600HO twin

**\$490.00**

00-08 800/800HO twin

**\$490.00**

07-11 800R/800R Ptek twin

**\$650.00**

## SHOP SERVICES AND PARTS

We have a fully equipped shop with shock dyno, lathe, mill, boring bar, hone, hydraulic press, porting tools, specialty shock equipment, OEM special tools, and a track treadmill. This allows us to perform most service work in-house for better quality control. We stock fast moving hard parts for many popular models and can get any non-inventoried part quickly.

### Services

\*Carb cleaning

\*Clutch rebuilds

\*Suspension work

\*Clutch kit installation

\*Engine teardown/rebuild

\*Crankshaft replacement

\*Shock services

\*Cylinder porting/blueprinting

### Parts

\*Clutch Components

\*Shock Components

\*Carbides

\*Hyfax

\*Drive Belts

\*Plugs

\*Lubricants

**FETT BROTHERS PERFORMANCE LLC**



## MASTER CLUTCH COMPRESSOR

Fits all snowmobiles or ATV primary or secondary clutches

\*Universal fit with adjustable compression fingers.

\*Mandatory tool when working on modern day clutches.

\*Bench mount or toss in tool box/trailer for use "in the field".

\*One tool for all clutch service needs.



#CLCOM:

\$114.99

## CLUTCH PULLERS

Primary clutch removal pullers

\*High quality machined steel.

\*Precision cut threads.

**CAT:**

#ACPUL2: 96-09 except 1000 clutch. (OEM #0644-207)

#ACPUL3: 07-13 4 strokes and 10-13 2 stroke models (OEM #0744-052)

\$36.99

**POLARIS:**

#PLPUL3: All U.S. twins 00-13 500/600/700/800/900; 99-04 Edge 440; 99-03 XCR 700/800 (OEM #2872085)

\$36.99

**SKI-DOO:**

#SKPUL2: 99-13 2/4 stroke TRA; 95-01 triples; 93-99 twin 670. (OEM #529-0224-00)

\$36.99

**YAMAHA:**

#YAPUL1: All 4 strokes; 84-94 PZ480; 94-99 V-Max 500/600/700; 00-06 SX, SXR, SRX, Viper, Venom. (OEM #YS-39962 and YFO-1882A)

\$36.99



## SKI-DOO HELIX TOOL

QRS helix tool for XP/XS/XM series

\*Helix and spring compression tool.

\*Saves time/frustration with quick, easy changes.

#DCT-CQ: 08-09 XP models

#DCT-CQ10: 10-13 XP/XS/XM models

\$78.99

\$78.99



## SKI-DOO RETAINER CLIPS

\*Hold the buttons in position when TRA is disassembled.

#SKCLIP: Set of 3

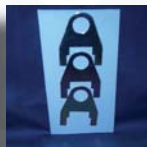

\$17.99

## CAT SPIDER SOCKET

Jam nut socket

\*36mm machined socket fits rounded jam nut.

\*Snug fit on nut and shaft prevents slippage.

DCT-SK1: 2010-2013 models



\$49.99

## CLUTCH C CLAMP TOOL

Easy clutch arm removal

\*Heavy-duty zinc plated steel.

\*Works with Arctic Cat, Polaris, and Yamaha clutches.

#CCCT:

\$4.99



## BUSHING DRIVERS

Easy installation of clutch bushings

\*Use in a vise or press for accurate bushing installation.

\*Dual head drivers offer multiple uses.

CAB213: Cat/Polaris cam arm (CAB210) and Ski-doo roller (CAB230)

\$17.99

CAB225: Yamaha cam arm (CAB220) and Yamaha rollers (CAB250)

\$17.99

CAB217: Cat primary cover (CAB216), installation and removal

\$21.99

CAB236: Ski-doo moveable sheave (CAB235), installation and removal

\$21.99



## CLUTCH TUNING HANDBOOK

\*Confused about clutching or need a refresher course?

\*Save time and money on testing?

\*Knowledge + testing = winning edge.

\*All this and more with sections on major brands plus aftermarket.

#CLHB001:

\$29.99

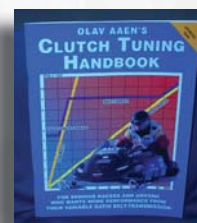

DALE "CLUTCH GUY"

218-334-3388 • WWW.FETTBROS.COM



## STEERING POST STAND

**Takes the back work out of maintenance**

- \*Prevents damage when sled is tipped on side for maintenance.
- \*Stand slides into handlebar riser mount tube at top of steering post.
- \*Stem is .63" (16mm) diameter and is height adjustable.
- \*Powder coated steel for durability.



#SPSTD1: Fits sleds with hollow steering post stem

\$114.99



## CARB COMPENSATORS

(Holtzman Engineering)

**EFI performance for carbureted sleds**

- \*Proper jetting = better throttle response and **increased mpg**.
- \*NO jetting in temps from -20 F to +50 F (ATACC or Tempa Flow).
- \*NO jetting from 1,200 to 11,000 feet altitude changes (ATACC).
- \*Controls float bowl air pressure, not a fuel jet system.
- \*One kit will work on single, twin, or triple cylinder engines.
- \*Mounts in airbox using hand tools, 1-2 hours install time.

You need this if sled runs well on cold days and worse on warm days.

## ATACC

**Automatic Temperature and Altitude Compensator**

- \*Automatically maintains consistent jetting for altitude and temperature changes.
- \*Polaris unit has model specific fittings.
- \*Great trail addition to Cat 600 Sno Pro 08-12.
- \*Will not fit 4 stroke CV carbs or 01-02 Ski-doo models.



#ATACC: all snowmobiles except those noted above

\$254.99

#ATACC-P: Polaris with racked, air box vented TM flatslides

\$246.99

## TEMPA FLOW

**Automatic Temperature Compensator**

- \*Automatically maintains consistent jetting for temperature changes.
- \*Cat/Polaris/Ski-doo units have model specific fittings.
- \*Great trail addition to Cat 600 Sno Pro 08-12.
- \*Will not fit 4 stroke CV carbs or 01-02 Ski-doo models.

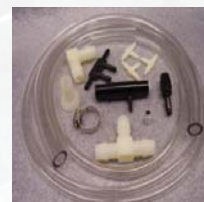

#TEMFLO: all snowmobiles except those noted above

\$182.99

#TEMFLO-C: FireCat

\$182.99

#TEMFLO-P: Polaris with racked, air box vented TM flatslides

\$173.99

#TEMFLO-S: Ski-doo XP with racked, air plenum vented TM flatslides.

\$173.99

## EXHAUST SPRING TOOL

**Easy removal of hard to reach exhaust springs**

- \*Heavy duty 3/8" plated tool resists bending.
- \*Long 15" for leverage in those hard to reach spots.
- \*Notch allows you to push, pull, or twist springs into place.



#EXST15: HD exhaust spring tool

\$17.99

## SPRING TESTER

- \*Test spring poundage with +/-2% accuracy.
- \*Use in a hydraulic, arbor, or drill press.
- \*Gauge displays in 10 pound increments.
- \*Fast and accurate method to check spring rates.

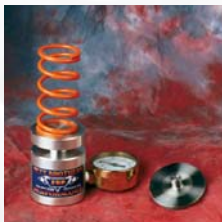

#CST600: 0-600 lbs.

\$136.99



DENNIS

**FETT BROTHERS PERFORMANCE LLC**



## RIDE TECH FLOAT AIR CANISTER

### Eliminate Fox Float washboard harshness

- \*Increased air volume gives softer, more linear shock action.
- \*Smoother/softer ride at low speeds yet soaks up big hits.
- \*"Made for dummies" with no knobs or screws to adjust.
- \*Small volume changes give big results as stock capacity is minimal.
- \*Fits Fox Float 1 or 2, no special tools, adjust with stock pump.
- \*Compact size (3.5"x1/2" with AIRC2 slightly longer).
- \*Easy install, no special tools, adjust with stock air pump.

**Two sizes to better match suspension duties!**

### AIR CAN 1:

- \*Gives more compliant low speed shock action.
- \*Smoother/softer stutter compliance, ramps up for big hits.
- \*Aggressive riders who need quick ramp up for the deep holes.



#AIRC1: Sold as set

\$98.99

#AIRC1E: Single Unit

\$59.99

### AIR CAN 2:

- \*3 times more air capacity than Air Can 1 offers a wider range of tuneability.
- \*Larger volume allows shock to stay soft through more of the travel before stiffening up.
- \*Groomed trail riders looking for more overall compliance with big bump absorption.



#AIRC2: Sold as set

\$141.99

#AIRC2E: Single Unit

\$84.99

### AIR CAN 2 BLACK:

- \*Same as Airc2 except anodized black.
- \*Classy appearance sets your sled apart from the crowd.



#AIRC2B: Sold as set

\$151.99

#AIRC2EB: Single Unit

\$91.99

**Note: Air Canisters are no substitute for proper shock valving, see Ride Tech Kits for best suspension action. Adding Air Canisters to stock or Ride Tech kits allows extra tuning of low to mid-range shock compliance. See Shop Talk on our web site for latest tips.**



DALE & JEFF SALVE "TEST CREW"

## FOX SHOCKS FOR SKI-DOO & YAMAHA

### When suspension performance is critical

Totally rebuildable, nitrogen charged, adjustable valving, and readily available parts make them the reliable choice. Zero Pro's give great performance at a great price and the Float uses air instead of springs for weight savings. Both use similar internal parts that allow valving mods to match your riding style/weight for an improved, custom ride.

## ZERO PRO SHOCKS

\*Nitrogen charged, adjustable valving, and 100% rebuildable.

\*Bolt-on using stock spring and fasteners.

\*Improved ride over stock throw away shocks.



### Ski-doo

#### Ski

#FX50Z-S1 (16.9"): 04-13 MXZ/Renegade,  
03-13 Summit

\$269.99

#### Center

#FX51Z-S1 (13.2"):  
04-05 MXZ/Renegade,  
02-09 Summit

\$269.99

#FX51Z-S2 (13.2"):  
06-13 MXZ/Renegade\*

\$269.99

#### Rear

#FX52Z-S1 (17.2"): 04-05 MXZ, 02-13 Summit

\$289.99

#FX52Z-S2 (17.2"): 06-13 MXZ\*

\$289.99

#FX52Z-S3 (22"): 02-05 Renegade

\$309.99

#FX52Z-S4 (22"): 06-13 Renegade\*

\$309.99

\*Not applicable to R-Motion suspension

### Yamaha

#### Center

#FX51Z-Y1: 07-13 Phazer

\$269.99

#FX51Z-Y2: 08-13 Nitro FX/RTX

\$269.99

#### Rear

#FX52Z-Y1: 07-13 Phazer

\$289.99

#FX52Z-Y2:

08-13 Nitro FX/RTX

\$289.99

## FLOAT SHOCKS

\*Air adjustable for big bump performance.

\*Air pump included with shocks.



### Ski-doo

#### Ski

#FX50F-S1 (17"): 04-13 MXZ/Renegade,  
03-13 Summit

\$699.99/pair

### Yamaha

#### Ski

#FX50F-Y1: 07-13 Phazer

\$699.99/pair

#FX50F-Y2: 08-13 Nitro

\$699.99/pair



## RIDE -----

### -----TECH

#### Suspension Stage Kits

Includes shock service, re-valving, and parts for a complete suspension package!

\*Stage kits that match suspension to rider's weight and style.

\*Includes 4 shock service, valving, and components for complete set-up.

\*Your shocks + our shock mods + parts = less harshness and more control.

\*Kits are model specific so may not contain the same components.

\*Set-up instructions and suspension tips included.

\***Note:** We will upgrade only the front or rear if requested.



**Shipping: Include Ride Tech Shock Service Form with your shocks. The Form is on the page 22 or on our website in the Ride Tech section.**

#### RIDE TECH STAGE 1:

Basic shock service with re-valving mods fine tunes ride quality. Valving can be firmer or softer to fit rider's style, weight, and request. Valving alone may not solve suspension problems; a Stage Kit with other components may be required.

#### RIDE TECH STAGE 2:

Most popular and recommended trail set-up gives better overall handling from front to rear. Includes basic shock service with valving mods to all 4 shocks and required components (springs, couplers, shafts, or blocks). More progressive shock action improves front end control with sharper cornering and less ski lift. The rear suspension is smoother in the stutters, eliminates the harshness of the washboard, and still resists bottoming in the big hits. Riders over 240 pounds may opt for Stage 2 Plus.

#### RIDE TECH STAGE 2 PLUS:

A boost to Stage 2 with the addition of heavier springs and valving mods to better match aggressive and/or heavier riders. Gives a firmer and more progressive ride without getting into race mod Stage 3.

#### RIDE TECH STAGE 3:

Designed for hardcore riders who attack the roughest terrain or on the higher side of weight scale. Includes valving and parts which sacrifice some low speed comfort but stiffens up the suspension in the big crunchers. Variations used for Sno Crosser big air landings, Cross Country high speed whoops, and Big Guys who need a stiffer suspension.

**For prices check your brand on pages 5, 10, 12, 15.**

## SHOCK DYNO

**Repeatable testing = accurate valving**

\*Allows accurate and consistent testing of shock valving changes.

\*Graph printout shows how changes affected shock action.

\*Shock clickers can be tested for their real effectiveness.

\*Test if a rebuild is needed for a set of used shocks.

\*Shortens field test time on a new model set-up.

\*Consistent testing gives us better set-ups as we improve the comfort and handling of your sled.



## SHOCK COMPONENTS

We service hundreds of shocks in a season and carry basic parts for **Fox, Ryde FX, HPG, ACT, and Walker Evans** shocks. This includes seal kits, o-rings, wipers, and popular shafts including HPG shafts and seal head kits. Due to constantly changing models, we do not publish a parts breakdown for each shock. Do-it-yourselfers call for latest prices and availability.

RydeFX IFP SHOCK ABSORBER COMPONENTS - DIAGRAM 1-A

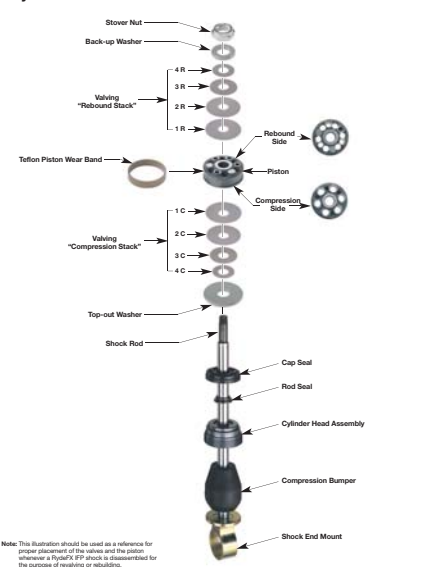

## RIDE TECH SHIM STACKS:

We have requests from do-it-yourselfers for a valve stack. We will sell the complete valve stacks used in our Ride Tech Stage Kits. These stacks will consist of a complete set of compression and rebound shims for easy installation. Must have year, model, and valving change required (firmer, softer, etc).

**#RTVS: Complete valve stack**



**\$49.99/shock**



**RIDE -----**

**-----TECH**

**Shock Service**

**ACT, Fox, HPG, Ryde FX,  
Walker Evans**

\*ALL shocks need regular service  
to give top performance.

\*We know shocks with 40 years of shock experience.

\*Heat and condensation cause oil breakdown regardless of brand.

\*Regular service extends shock life and improves ride.



**BASIC SERVICE INCLUDES:**

\*Complete drain and flush of shock

\*Internals inspected for damage or wear

\*Custom blend synthetic oil and nitrogen filled

\*Seals are not replaced unless needed or requested

\*Parts and replacement is extra, only worn parts replaced.

**PRICES:**

Save 10% on set of 4 shocks starting at **\$143.96**

Standard Shock **\$39.99**

Remote Reservoir, Clicker, or Air **\$42.99**

Remote Clicker or Position Sensitive **\$45.99**

Seal/shaft replacement or revalve **\$19.99**

Quick Adjust Front Track (Cat) **\$59.99**

Cat Cross Link Rear **\$129.99**

Polaris PPS upgrade mod **\$89.99**

**RECOMMENDED SHOCK SERVICE  
SCHEDULE:**

ALL shocks are plagued by condensation, sludge, and oil  
breakdown.

\*Initial oil change 500-1,000 miles, then regular schedule.

\*1,500-2,000 miles for average rider or every other year.

\*Annual for high performance/aggressive riders.

**Regular service schedule for extended shock life, less wear, and  
improves handling to give a better ride.**

**See Ride-Tech Stage Kits (page 21) for complete suspension  
options!**



**DENNIS "SHOCK GURU"**

**RIDE -----**

**-----TECH**

**SHOCK SERVICE FORM**

Ride Tech Shock Service, using the latest suspension technology,  
improves the ride and handling of your snowmobile. We offer basic  
shock service or complete stage kits.

**SHIPPING: Remove all bushings. DO NOT tie shocks in a closed  
position or release air/nitrogen pressure.** Pack shocks tightly in  
crumpled newspaper. Include a copy of this form or download form  
from the Ride Tech section of our website. Springs may be removed  
to save freight costs. Ship with carrier of your choice, we will contact  
you for payment information.

**Thank you for your business and enjoy the RIDE!**

**Check type of service you would like performed:**

☐ Basic shock service

(See Ride Tech Basic Service on this page)

☐ Ride Tech Stage 1

☐ Ride Tech Stage 2 Plus

☐ Ride Tech Stage 2

☐ Ride Tech Stage 3

(details on Ride Tech Stage Kits see page 21)

Name: \_\_\_\_\_

Address: \_\_\_\_\_

City: \_\_\_\_\_

State: \_\_\_\_\_ Zip: \_\_\_\_\_ Code: \_\_\_\_\_

Phone (cell): \_\_\_\_\_ and/or

Phone (home/work): \_\_\_\_\_

Weight: \_\_\_\_\_ Age: \_\_\_\_\_

Email: \_\_\_\_\_

Type of rider: ☐ Hardcore: mostly standing

☐ Aggressive: standing and sitting

☐ High Performance: mostly sitting

☐ Cruiser: touring/sitting

Make: \_\_\_\_\_

Model: \_\_\_\_\_ Year: \_\_\_\_\_

Miles on shocks since last serviced: \_\_\_\_\_

Are shocks stock (no changes from factory settings)?

☐ Yes

☐ No

**Ride Tech Stage Kit Feedback (not needed for Basic Shock  
Service):** What changes do you need or what you do not like about

your current ride (example: bottoms on big hits, rides too rough in  
washboard, front end pushes, tips in corners, front soft/rear ok, etc)?

You may use extra paper for feedback or download this Service Form  
from our website in the Ride Tech section.

**218-334-3388 • WWW.FETTBROS.COM**



**FETT BROTHERS  
PERFORMANCE, LLC**



11684 Woods Drive Frazee, MN 56544  
Phone: 218-334-FETT (3388)

Presort Standard  
U.S. Postage  
**PAID**  
Frazee, MN  
Permit 33

# FAST FAVES



**ROLLERS**  
Pgs. 2,7



**BELT ADJUSTER**  
Pgs. 4, 9



**BELLY BRACE**  
Pg. 5



**RUSH GAURD**  
Pg. 12



**FLOAT AIR  
CANISTERS**  
Pgs. 10, 20



**RIDE TECH SUSPENSION/  
SHOCK SERVICE**



**BUMPERS**  
Pgs. 5, 11, 15



**ACCELERATOR  
CLUTCH KITS**  
Pgs. 2, 7, 13, 15

**FETT BROTHERS PERFORMANCE LLC**