

### Fitting Instructions:

### Trophy and Trophy SE

### A9708259, A9708276, A9708350, A9708351 and A9708260

Thank you for choosing this Triumph genuine accessory kit. This accessory kit is the product of Triumph's use of proven engineering, exhaustive testing, and continuous striving for superior reliability, safety and performance.

Completely read all of these instructions before commencing the installation of the accessory kit in order to become thoroughly familiar with the kit's features and the installation process.

These instructions should be considered a permanent part of your accessory kit, and should remain with it even if your accessory-equipped motorcycle is subsequently sold.

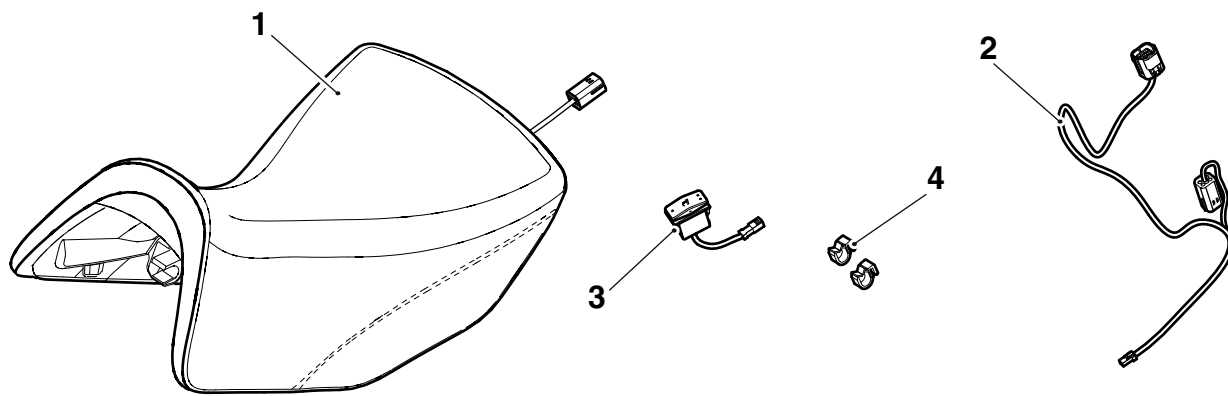

#### Parts Supplied A9708259, A9708276, A9708350 and A9708351:

1. Rider seat - heated	1 off	3. Switch	1 off
2. Sub-harness	1 off	4. Cable clip	2 off

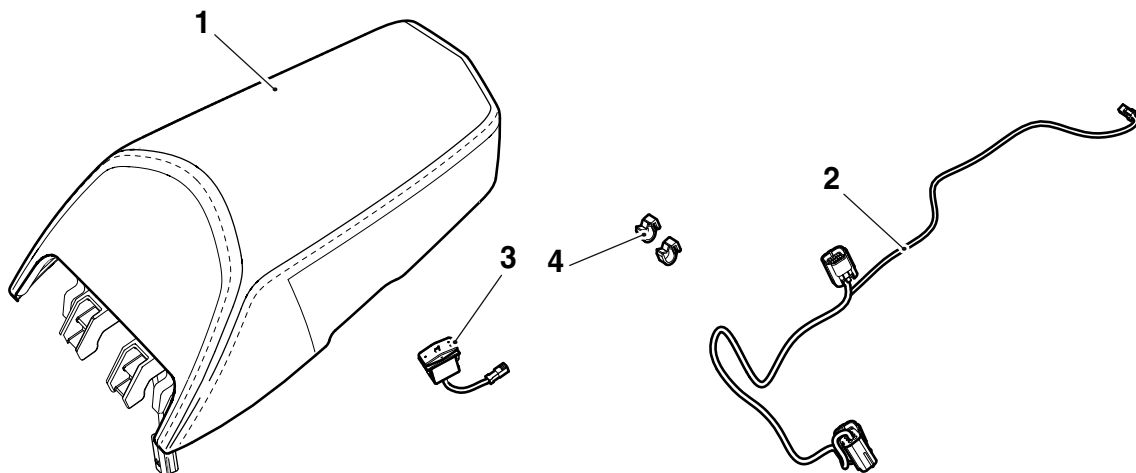

#### Parts Supplied A9708260:

1. Pillion seat - heated	1 off	3. Switch	1 off
2. Sub-harness	1 off	4. Cable clip	2 off

**Warning**

This accessory kit is designed for use on Triumph Trophy and Trophy SE motorcycles only and should not be fitted to any other Triumph model or any other manufacturer's motorcycle. Fitting this accessory kit to any other Triumph model or any other manufacturer's motorcycle, will affect the performance, stability and handling of the motorcycle. This may affect the rider's ability to control the motorcycle and could cause an accident.

**Warning**

Always have Triumph approved parts, accessories and conversions fitted by a trained technician of an authorised Triumph dealer. The fitment of parts, accessories and conversions by a technician who is not of an authorised Triumph dealer may affect the handling, stability or other aspects of the motorcycle's operation which may result in loss of motorcycle control and an accident.

**Warning**

Always ensure that the newly installed wiring does not chafe against other parts of the motorcycle such that it may be rubbed through and cause an electrical problem. In addition, always ensure that the newly installed wiring will not restrict steering movement. Both conditions are hazardous and could give rise to a dangerous riding condition resulting in a fire, loss of motorcycle control and an accident.

**Warning**

Throughout this operation, ensure that the motorcycle is stabilised and adequately supported to prevent risk of injury from the motorcycle falling.

**Caution**

When removing the seats for any reason always disconnect the heated seat harness. Do not allow the heated seats to hang freely on the sub-harness as this would result in irreparable damage to the heated seat.

**Note:**

- **If fitting the heated rider seat only, continue as described below.**
- **If fitting the heated pillion seat only, continue from Heated Pillion Seat on page 6.**
- **If fitting the heated rider and pillion seats, continue from Heated Rider and Pillion Seats on page 9.**

After fitting any seat combination, carry out the Heated Seat System Testing on page 15.

**Heated Rider Seat**

1. Remove the rider seat, as described in the owner's handbook. Retain the rider seat for re-use if the motorcycle is returned to original condition. Retain the pillion seat for re-use.
2. Disconnect the battery, as described in the service manual.
3. Remove the left hand side panel, as described in the service manual.
4. Remove the switch blanking plug, carefully pressing the plug out from the underside of the panel to prevent damage. Retain the blanking plug for re-use if the motorcycle is to be returned to its original condition.

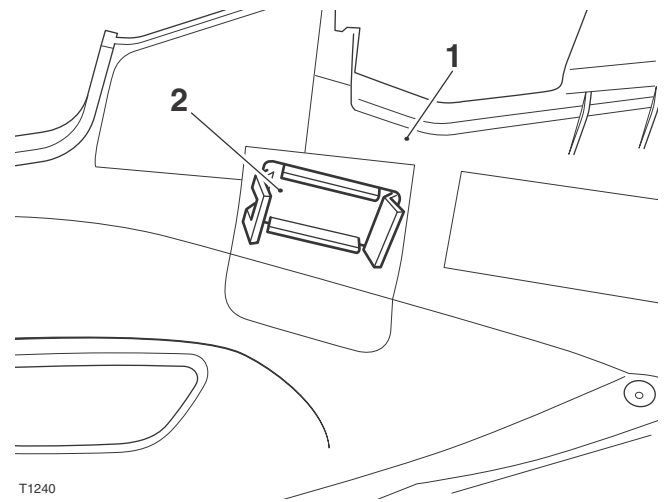

T1240

1. Side panel
2. Blanking plug

5. Fit the heated seat switch provided to the side panel, in the orientation shown below.

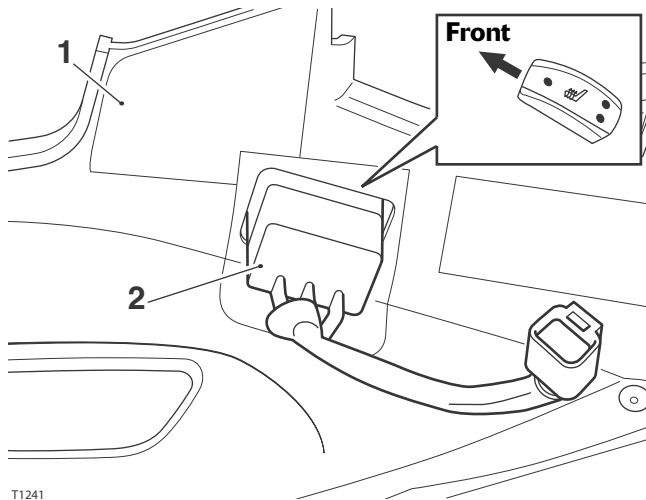

T1241

- 1. Side panel
- 2. Heated seat switch

6. Feed the sub-harness, power connector with fir-tree clip first, down past the fuse box and behind the frame as shown.

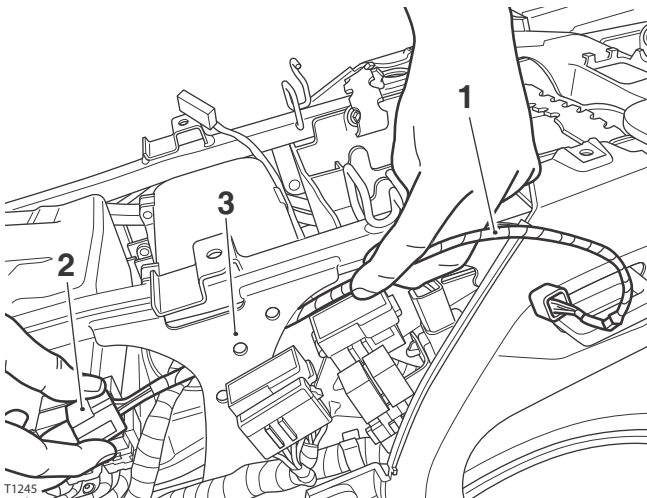

T1245

- 1. Sub-harness
- 2. Power connector with fir-tree clip
- 3. Motorcycle frame

7. Route the sub-harness power connector, back up behind the frame into the rear undertray area.

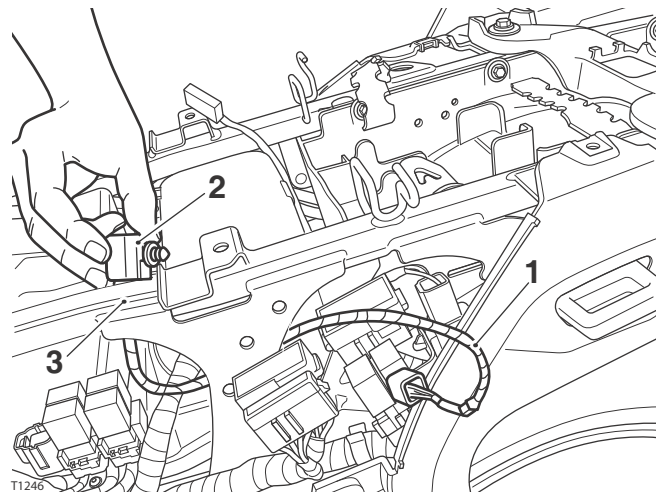

T1246

- 1. Sub-harness
- 2. Power connector
- 3. Motorcycle frame

8. Route the sub-harness up into the rear undertray, around the under-seat stowage box.

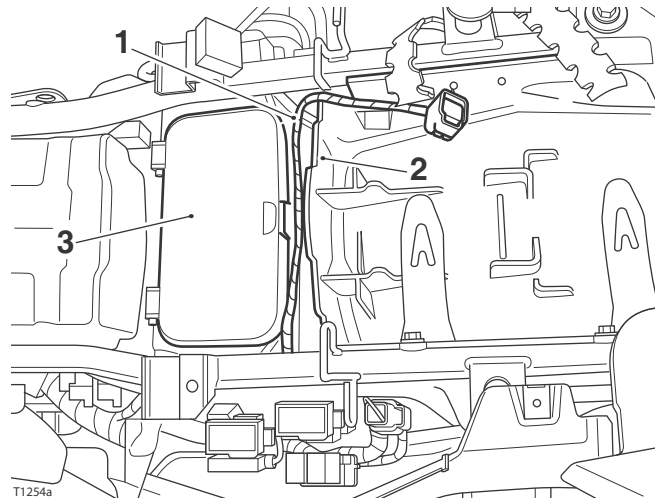

T1254a

- 1. Sub-harness
- 2. Rear undertray
- 3. Under-seat stowage box

- Keeping the sub-harness above any existing wiring harnesses, route around the right hand side of the rear undertray until the fir-tree clip on the power connector is aligned with the front location hole (3) in the rear undertray.

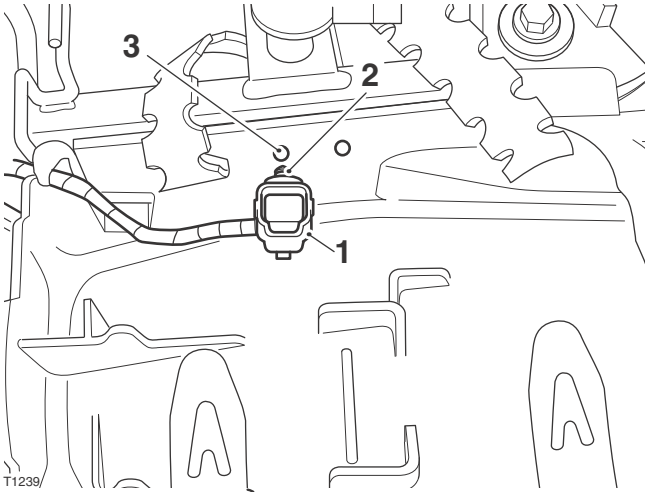

- Power connector
- Fir-tree clip
- Location hole

- Press the fir-tree clip into the hole to secure the heated seat power socket to the mudguard undertray.
- Secure the sub-harness to the rear undertray with the cable clips from the kit.

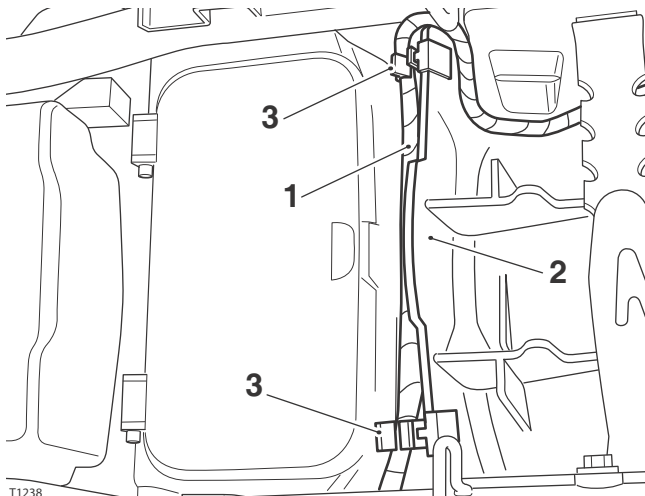

- Sub-harness
- Rear undertray
- Cable clip

**Note:**

- If a heated pillion seat is not fitted, continue from step 14.

- If a heated pillion seat is fitted, locate the rider seat connection on the pillion seat sub-harness, situated next to the main wiring harness connector.
- Remove the blanking plug and connect the rider seat sub-harness to the socket. Retain the blanking plug for re-use if the motorcycle is returned to original condition. Continue from step 16.

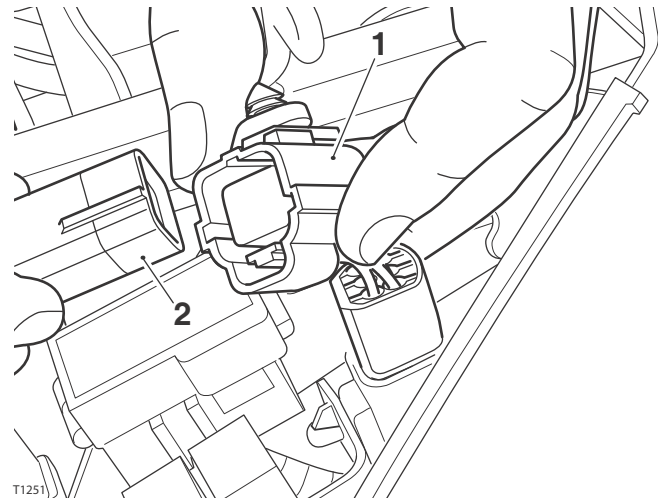

- Rider seat connection, pillion seat sub-harness
- Rider seat sub-harness connector

- Locate the heated seat connection on the main harness, situated next to the fuse block. The connector will be fitted with a blanking plug.

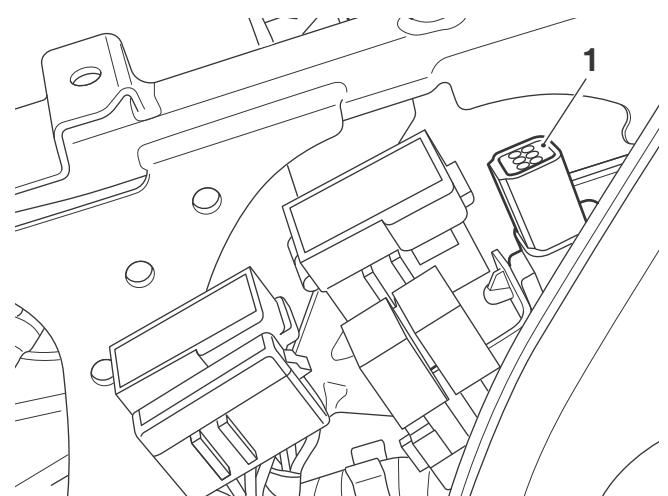

- Blanking plug, heated seat connector

15. Remove the blanking plug from the heated seat connection on the main wiring harness and connect the rider seat sub-harness. Retain the blanking plug for re-use if the motorcycle is returned to original condition.

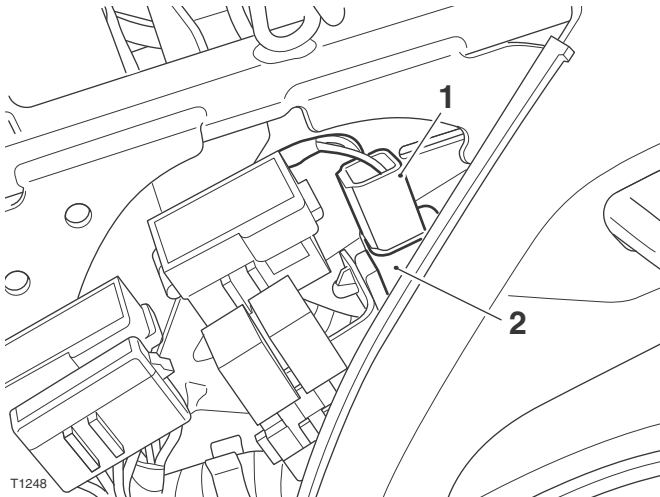

1. Sub-harness connector
2. Heated seat connection

16. Route the rider heated seat switch connector on the sub-harness, back behind the frame towards the rear of the motorcycle, up to the left hand side rear of the rear undertray.

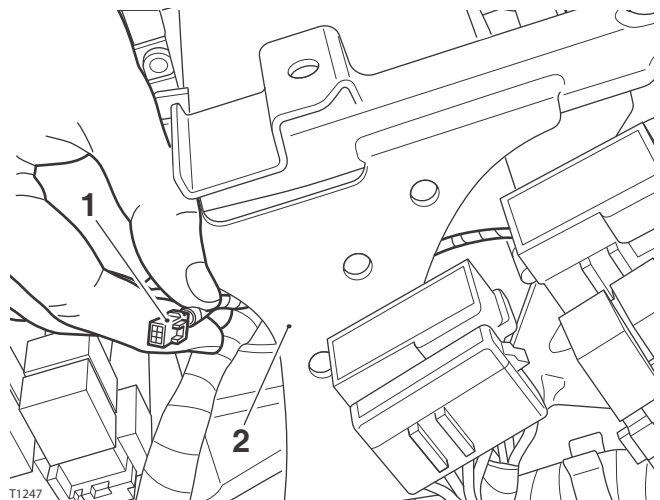

1. Heated seat switch connector
2. Motorcycle frame

17. Refit the left hand side panel, as described in the service manual, ensuring the heated seat switch connector is routed behind the frame in to the rear undertray area.
18. Connect the rider heated seat switch connector to the heated seat sub-harness.

**Note:**

- If a heated pillion seat is fitted, the rider seat power socket can be identified by red tape on the harness.

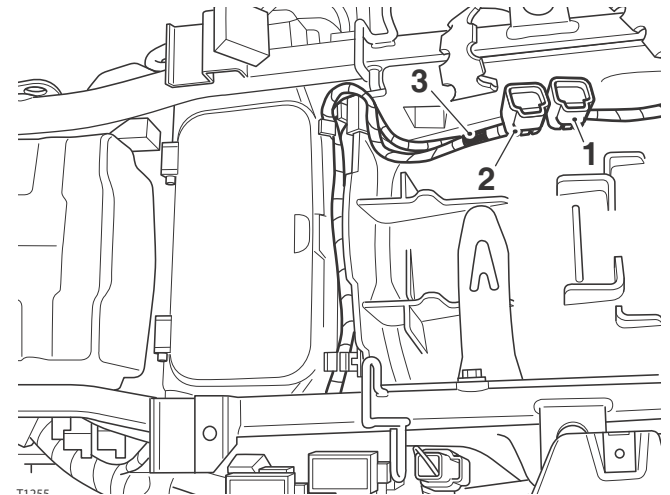

1. Pillion seat power socket
2. Rider seat power socket
3. Red identification tape

19. Connect the heated rider seat connector to the rider seat power socket.
20. Reconnect the battery as described in the service manual.
21. Refit the rider and pillion seats as described in the service manual. Ensure the harness for the heated seat does not become trapped between the seat and the motorcycle frame.
22. Refer to the owner's handbook for details regarding the operation of the heated seats.

## Heated Pillion Seat

### **Caution**

When removing the seats for any reason always disconnect the heated seat harness. Do not allow the heated seats to hang freely on the sub-harness as this would result in irreparable damage to the heated seat.

1. Remove the pillion seat, as described in the owner's handbook. Retain the pillion seat for re-use if the motorcycle is returned to original condition. Retain the rider seat for re-use.
2. Disconnect the battery, as described in the service manual.

#### Note:

- **If a heated rider seat is fitted, disconnect the heated seat switch before removing the left hand side body panel.**
3. Remove the luggage rack, as described in the service manual.
  4. Remove the left hand side panel and right hand rear panel, as described in the service manual.
  5. Remove the switch blanking plug, carefully pressing the plug out from the underside of the panel to prevent damage. Retain the blanking plug for re-use if the motorcycle is returned to original condition.

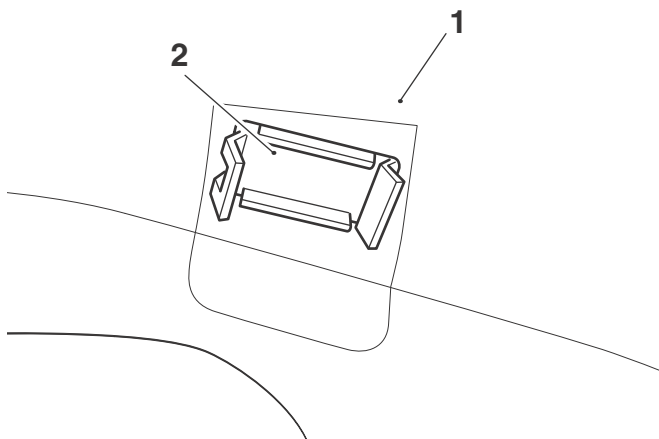

1. Rear panel
2. Blanking plug

6. Fit the heated seat switch provided in to the rear panel, in the orientation shown below.

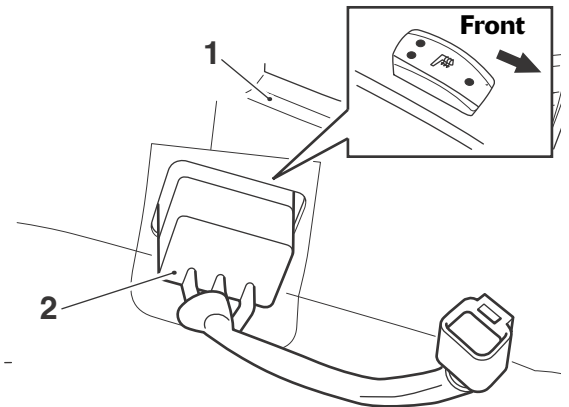

1. Rear panel
2. Heated seat switch

7. Feed the sub-harness, seat switch connector and power connector with fir-tree clip first, down past the fuse box and behind the frame, as shown.

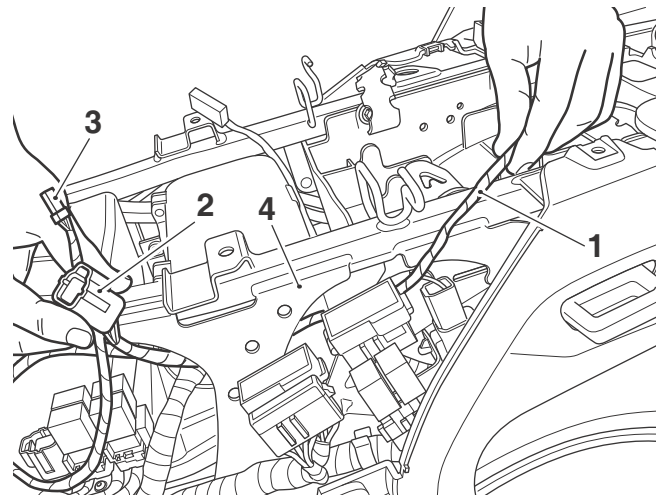

1. Sub-harness
2. Power connector with fir-tree clip
3. Seat switch connector
4. Motorcycle frame



- Route the sub-harness, seat switch harness and power connector, back up behind the frame into the rear undertray area.

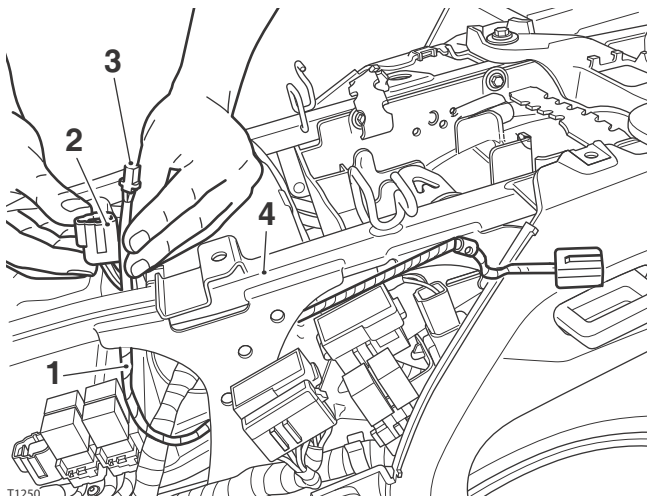

- Sub-harness
- Power connector
- Seat switch
- Motorcycle frame

- Keeping the sub-harness above any existing wiring harnesses, route the sub-harness, including the switch connector, around the under-seat stowage box to the right hand side of the rear undertray until the fir-tree clip on the power connector is aligned with the rear location hole (3) in the rear undertray.

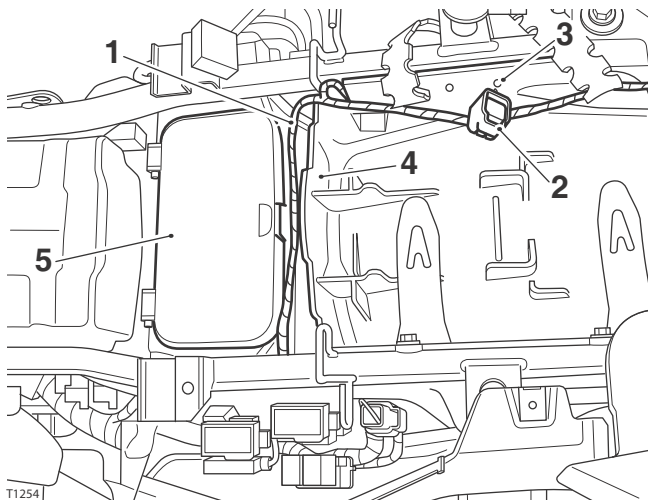

- Sub-harness
- Power connector
- Location hole
- Rear undertray
- Under-seat stowage box

- Press the fir-tree clip in to the hole to secure the heated seat power socket to the rear undertray.

- Secure the sub-harness to the rear undertray with the cable clips from the kit.

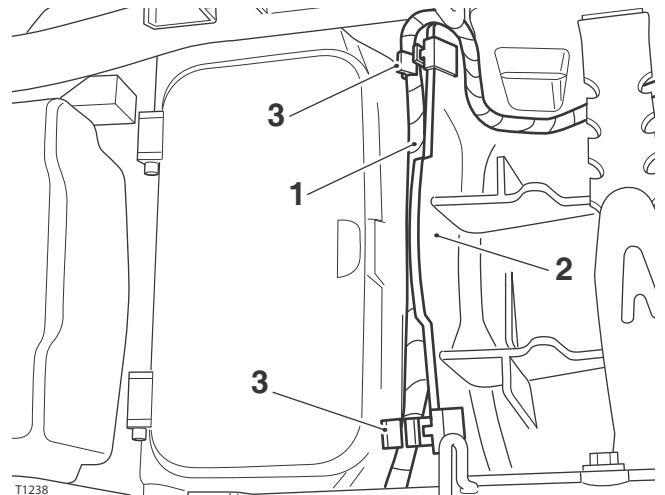

- Sub-harness
- Rear undertray
- Cable clip

**Note:**

- If a heated rider seat is not fitted, continue from step 14.**
- If a heated rider seat is fitted, remove the rider seat sub-harness connector from the main wiring harness heated seat connection and replace with the pillion seat sub-harness connector.
  - Locate the rider seat connection on the pillion seat sub-harness. Remove the blanking plug and connect the rider seat sub-harness to the socket. Retain the blanking plug for re-use if the motorcycle is returned to original condition. Continue from step 16.

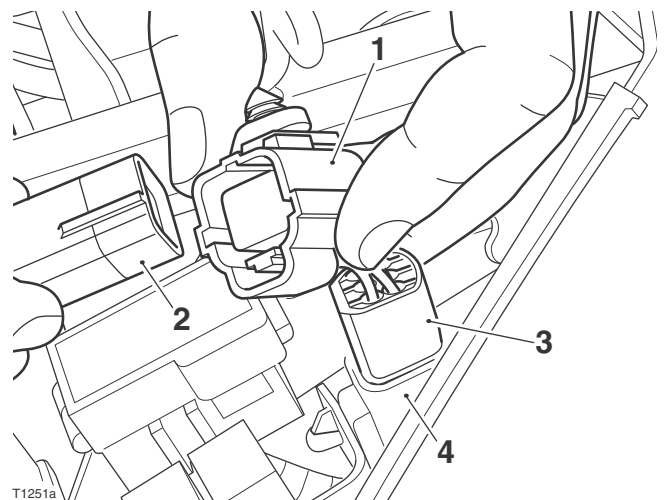

- Rider seat connection, pillion seat sub-harness
- Rider seat sub-harness connector
- Sub-harness connector, pillion seat
- Heated seat connection

14. Locate the heated seat connection on the main harness, situated next to the fuse block. The connector will be fitted with a blanking plug.

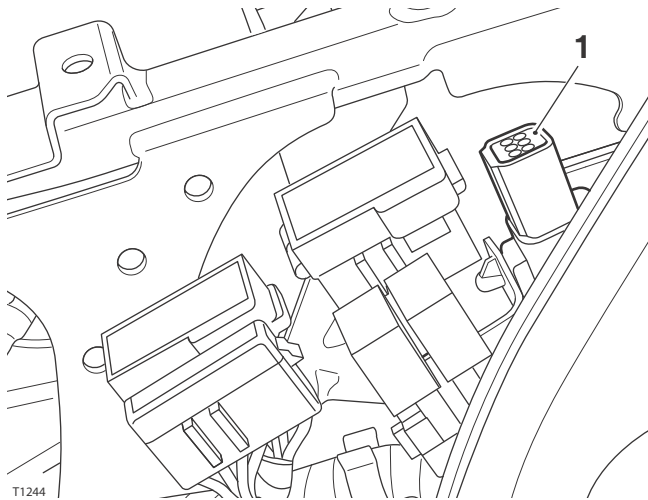

**1. Blanking plug, heated seat connection**

15. Remove the blanking plug from the heated seat connector on the main wiring harness and connect the pillion seat sub-harness. Retain the blanking plug for re-use if the motorcycle is returned to original condition.

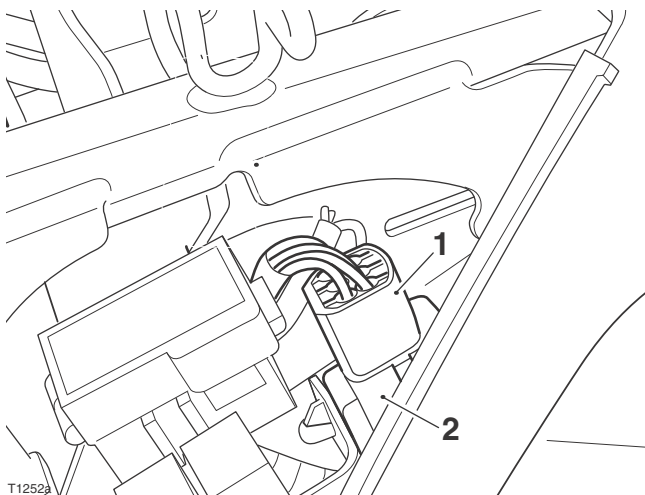

**1. Sub-harness connector**  
**2. Heated seat connection**

16. Refit the left hand panel, as described in the service manual.
17. Refit the right hand rear panel, as described in the service manual.
18. Refit the luggage rack, as described in the service manual.

19. Route the heated seat switch wiring on the sub-harness, along the right hand side of the frame, over the luggage rack, towards the rear of the motorcycle.
20. Connect the pillion heated seat switch connector to the heated seat sub-harness.

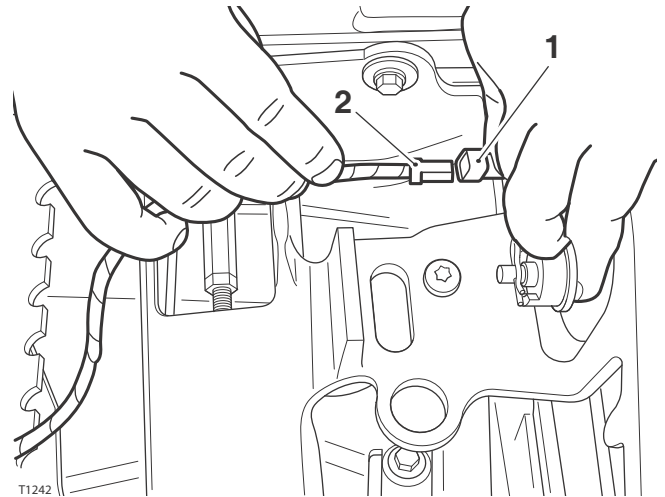

**1. Heated seat switch connector**  
**2. Sub-harness switch connector**

21. Ensure the switch connector wiring is retained to the luggage rack, as shown below.

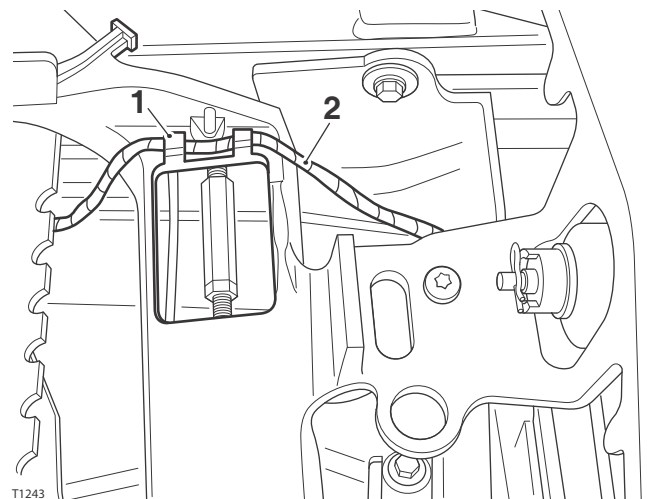

**1. Luggage rack**  
**2. Heated seat switch wiring**



**Note:**

- **If a heated rider seat is fitted, the rider seat power socket can be identified by red tape on the harness.**

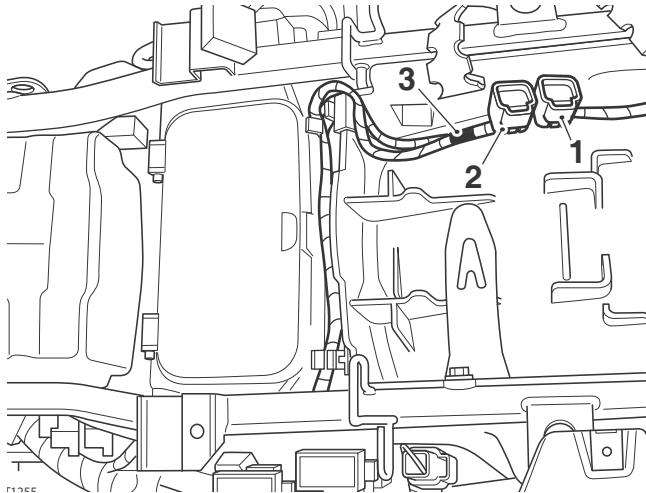

- 1. Pillion seat power socket**
- 2. Rider seat power socket**
- 3. Red identification tape**

22. Connect the heated pillion seat connector to the pillion seat power socket.
23. If a heated rider seat is fitted, connect the rider seat connector to the rider seat power socket.
24. Reconnect the battery as described in the service manual.
25. Refit the rider and pillion seats as described in the owner's handbook. Ensure the harness for the heated seat does not become trapped between the seat and the motorcycle frame.
26. Refer to the owner's handbook for details regarding the operation of the heated seats.

## Heated Rider and Pillion Seats



When removing the seats for any reason always disconnect the heated seat harness. Do not allow the heated seats to hang freely on the sub-harness as this would result in irreparable damage to the heated seat.

1. Remove the rider and pillion seats, as described in the owner's handbook. Retain the rider and pillion seats for re-use if the motorcycle is returned to original condition.
2. Disconnect the battery, as described in the service manual.
3. Remove the luggage rack, as described in the service manual.
4. Remove the left hand side panel and right hand rear panel, as described in the service manual.
5. Remove the switch blanking plug from the left hand side panel, carefully pressing the plug out from the underside of the panel to prevent damage. Retain the blanking plug for re-use if the motorcycle is returned to original condition.

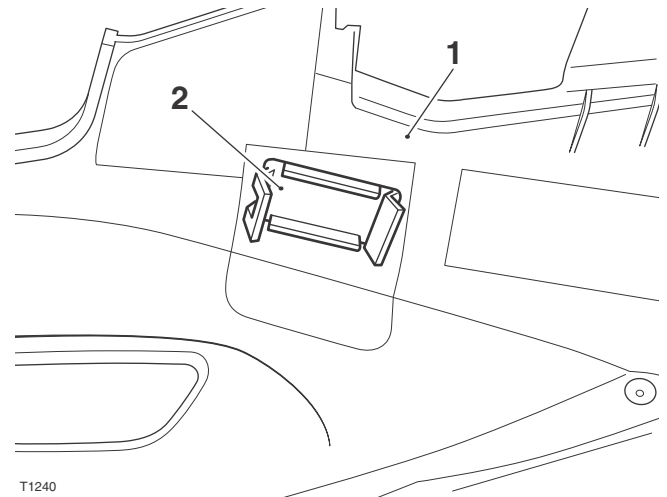

- 1. Side panel**
- 2. Blanking plug**

- Fit the one of the heated seat switches provided in to the left hand side panel, in the orientation shown below.

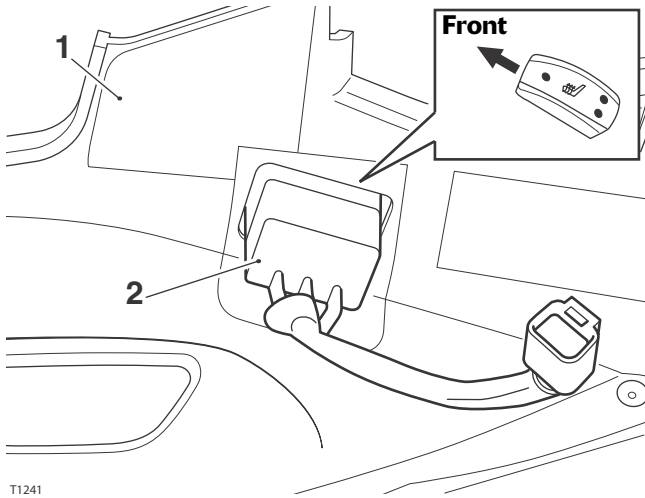

T1241

- Side panel
- Heated seat switch

- Remove the switch blanking plug from the right hand rear panel, carefully pressing the plug out from the underside of the panel to prevent damage. Retain the blanking plug for re-use if the motorcycle is returned to original condition.

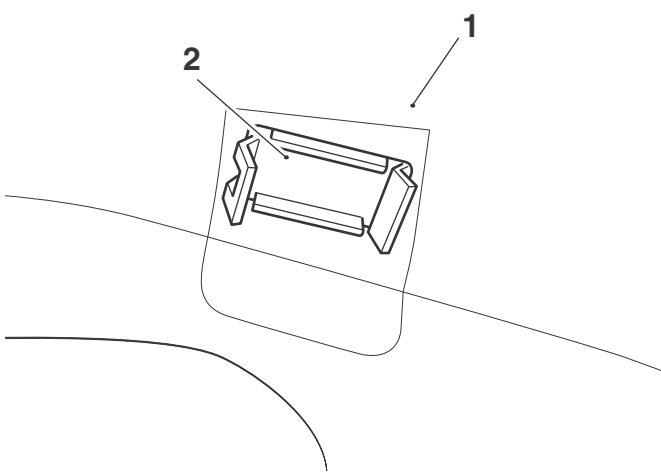

T1240a

- Rear panel
- Blanking plug

- Fit the second heated seat switch provided in to the right hand rear panel, in the orientation shown below.

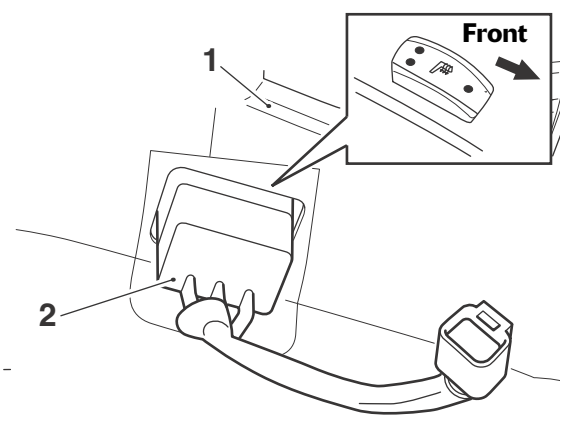

- Rear panel
- Heated seat switch

**Pillion Seat Sub-Harness Installation**

- Feed the sub-harness, seat switch connector and power connector with fir-tree clip first, down past the fuse box and behind the frame, as shown.

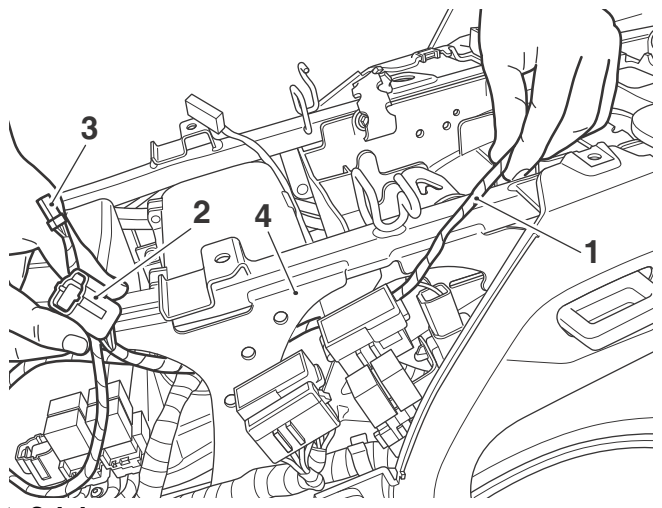

- Sub-harness
- Power connector with fir-tree clip
- Seat switch connector
- Motorcycle frame

10. Route the sub-harness, seat switch harness and power connector, back up behind the frame into the rear undertray area.

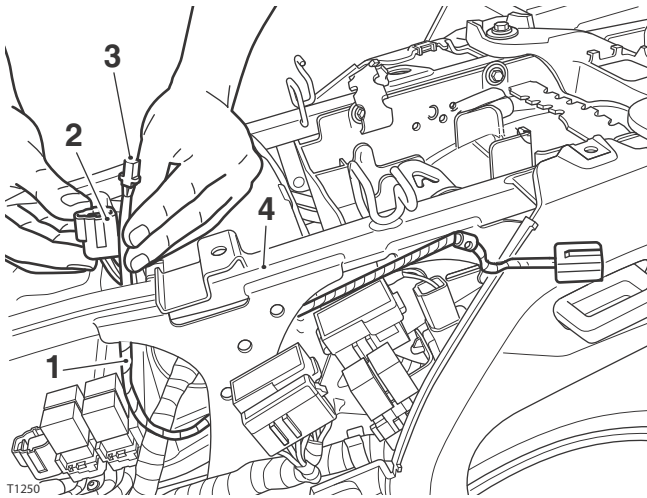

- 1. Sub-harness**  
**2. Power connector**  
**3. Seat switch**  
**4. Motorcycle frame**

11. Keeping the sub-harness above any existing wiring harnesses, route the sub-harness, including the switch connector, around the under-seat stowage box to the right hand side of the rear undertray until the fir-tree clip on the power connector is aligned with the rear location hole (3) in the rear undertray.

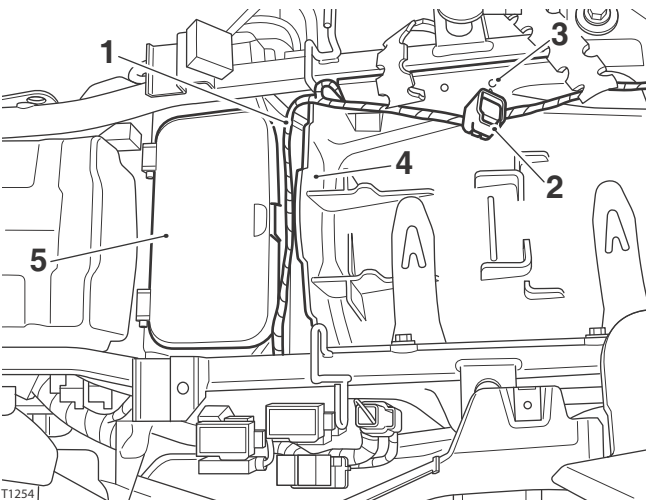

- 1. Sub-harness**  
**2. Power connector**  
**3. Location hole**  
**4. Rear undertray**  
**5. Under-seat stowage box**

12. Press the fir-tree clip in to the hole to secure the heated seat power socket to the rear undertray.

13. Secure the sub-harness to the rear undertray with the cable clips from the kit.

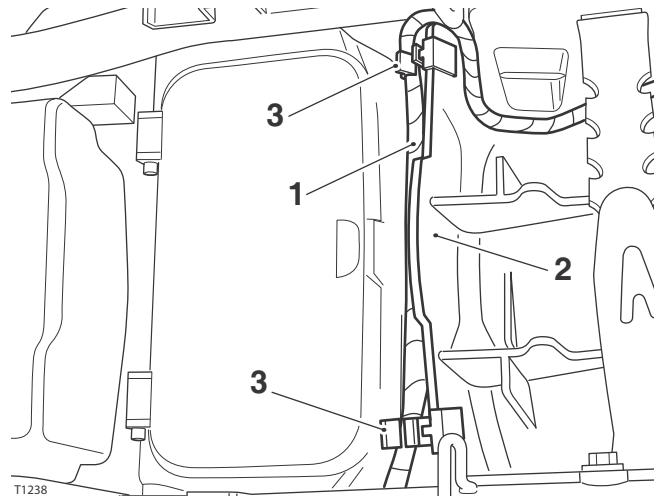

- 1. Sub-harness**  
**2. Rear undertray**  
**3. Cable clip**

14. Locate the heated seat connection on the main harness, situated next to the fuse block. The connector will be fitted with a blanking plug.

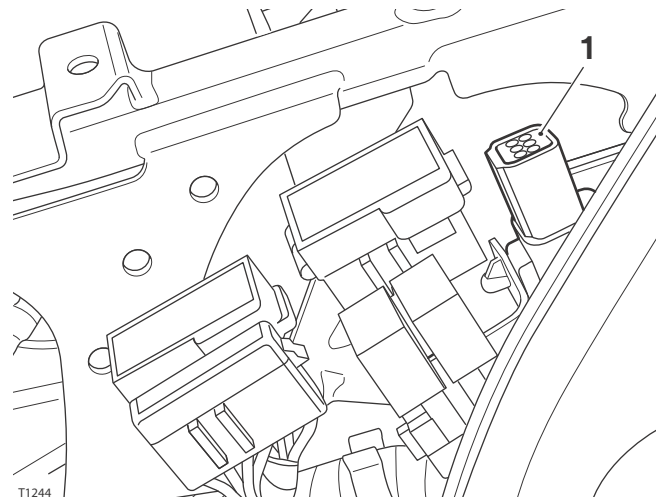

- 1. Blanking plug, heated seat connector**

- Remove the blanking plug from the heated seat connector on the main wiring harness and connect the pillion seat sub-harness. Retain the blanking plug for re-use if the motorcycle is to be returned to its original condition.

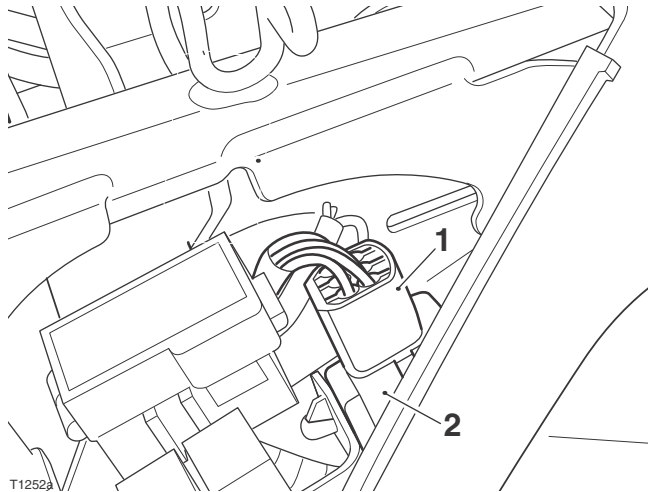

- Sub-harness connector**
- Heated seat connection**

- Refit the right hand rear panel, as described in the service manual.
- Refit the luggage rack, as described in the service manual.
- Route the heated seat switch wiring on the sub-harness, along the right hand side of the frame, over the luggage rack, towards the rear of the motorcycle.
- Connect the pillion heated seat switch connector to the heated seat sub-harness.

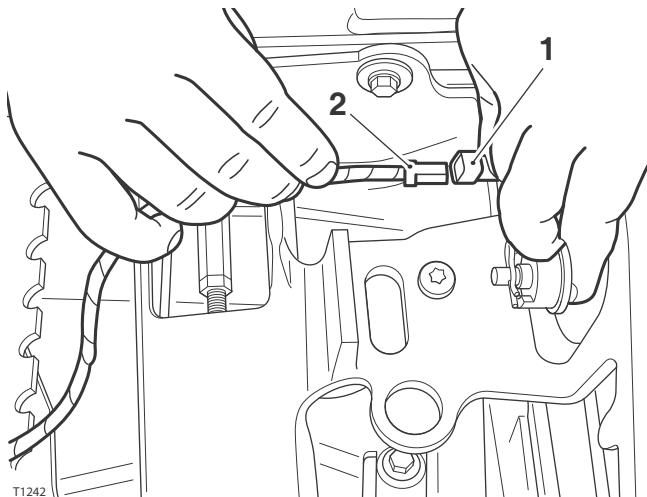

- Heated seat switch connector**
- Sub-harness switch connector**

- Ensure the switch connector wiring is retained to the luggage rack, as shown below.

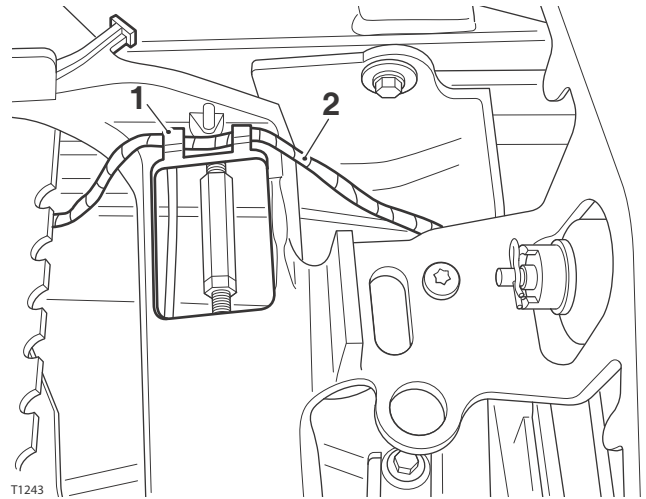

- Luggage rack**
- Heated seat switch wiring**

#### Rider Seat Sub-Harness Installation

- Feed the sub-harness, power connector with fir-tree clip first, down past the fuse box and behind the frame as shown.

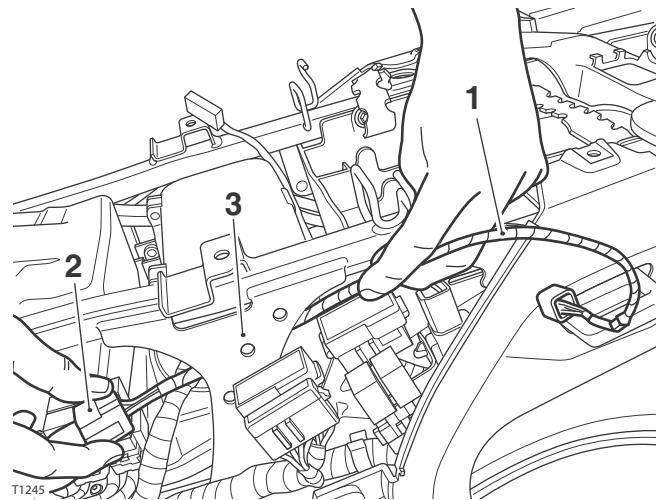

- Sub-harness**
- Power connector with fir-tree clip**
- Motorcycle frame**

22. Route the sub-harness power connector, back up behind the frame into the rear undertray area.

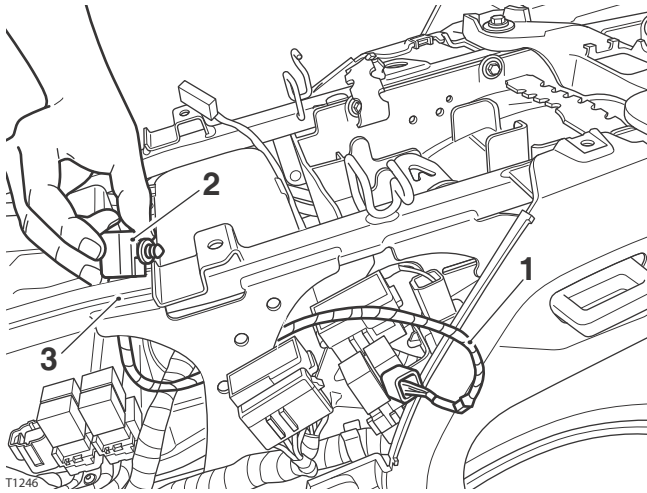

- 1. Sub-harness
- 2. Power connector
- 3. Motorcycle frame

23. Route the sub-harness up into the rear undertray, around the under-seat storage box.

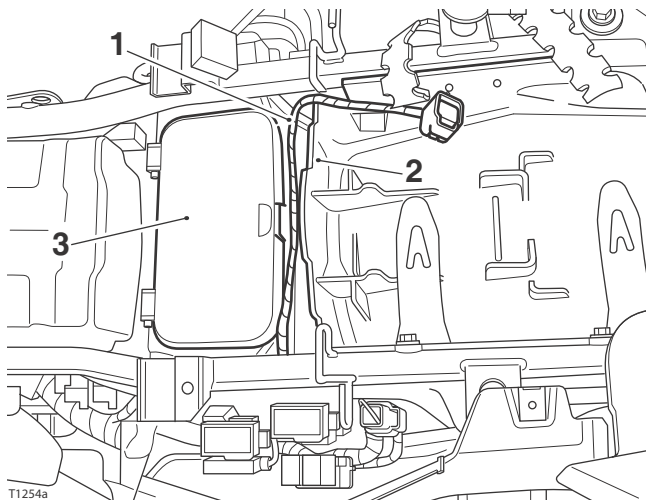

- 1. Sub-harness
- 2. Rear undertray
- 3. Under-seat storage box

24. Keeping the sub-harness above any existing wiring harnesses, route around the right hand side of the rear undertray until the fir-tree clip on the power connector is aligned with the front location hole (3) in the rear undertray.

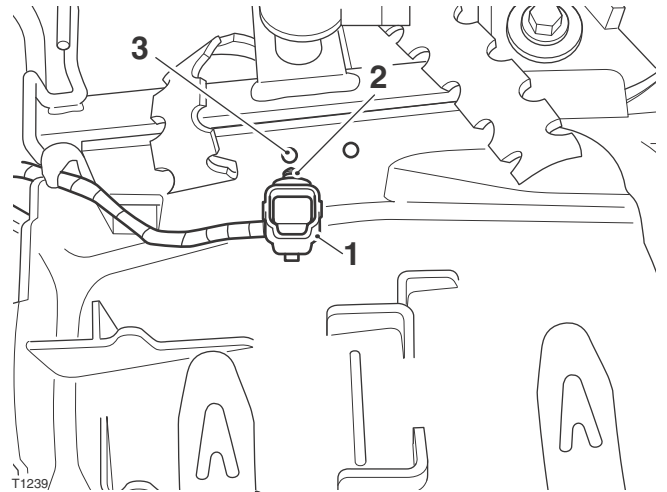

- 1. Power connector
- 2. Fir-tree clip
- 3. Location hole

25. Press the fir-tree clip in to the hole to secure the heated seat power socket to the mudguard undertray.

26. Secure the sub-harness to the rear undertray with the cable clips from the kit.

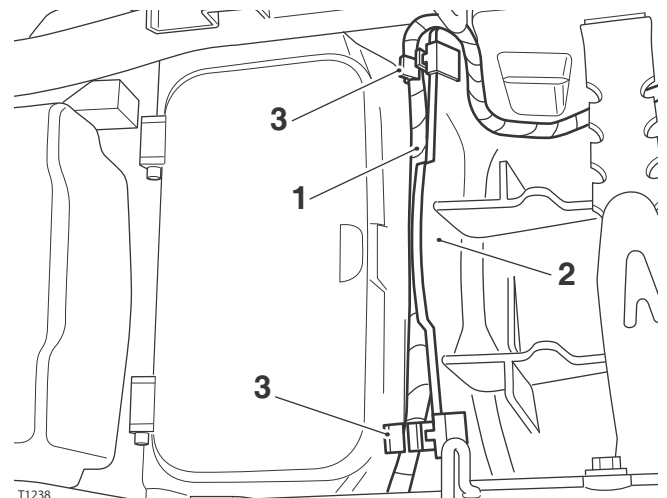

- 1. Sub-harness
- 2. Rear undertray
- 3. Cable clip



27. Locate the rider seat connection on the pillion seat sub-harness, situated next to the main wiring harness connector. Remove the blanking plug and connect the rider seat sub-harness to the socket. Retain the blanking plug for re-use if the motorcycle is returned to original condition.

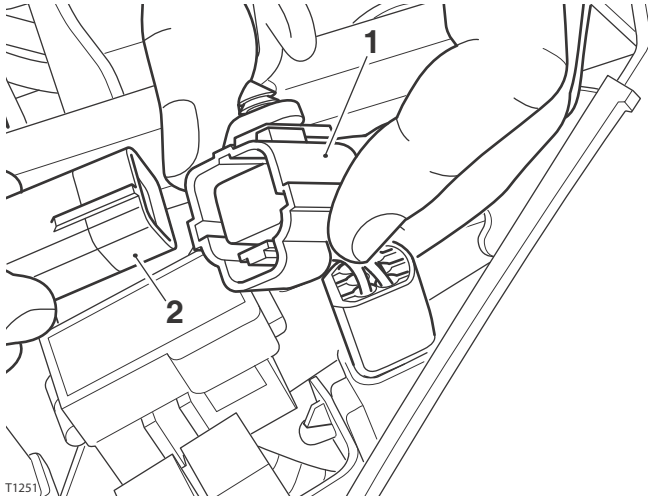

- 1. Rider seat connection, pillion seat sub-harness**  
**2. Rider seat sub-harness connector**

28. Route the rider heated seat switch connector on the sub-harness, back behind the frame towards the rear of the motorcycle, up to the rear left hand side of the rear undertray.

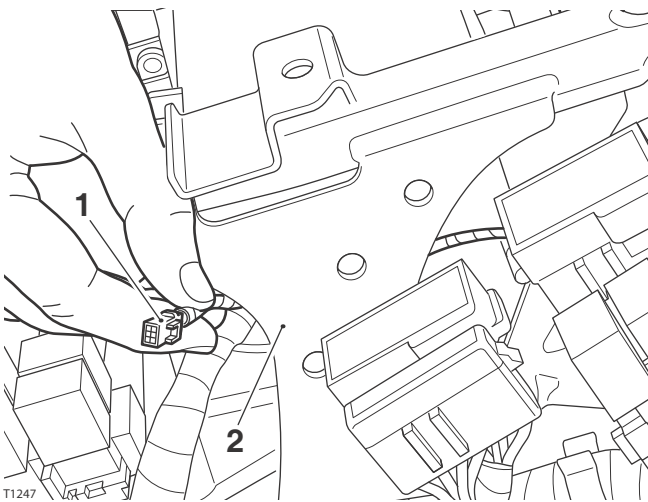

- 1. Heated seat switch connector**  
**2. Motorcycle frame**

29. Refit the left hand side panel, as described in the service manual, ensuring the heated seat switch connector is routed behind the frame in to the rear undertray area.

30. Connect the rider heated seat switch connector to the heated seat sub-harness.

**Note:**

- **The heated rider seat power socket can be identified by red tape on the harness.**

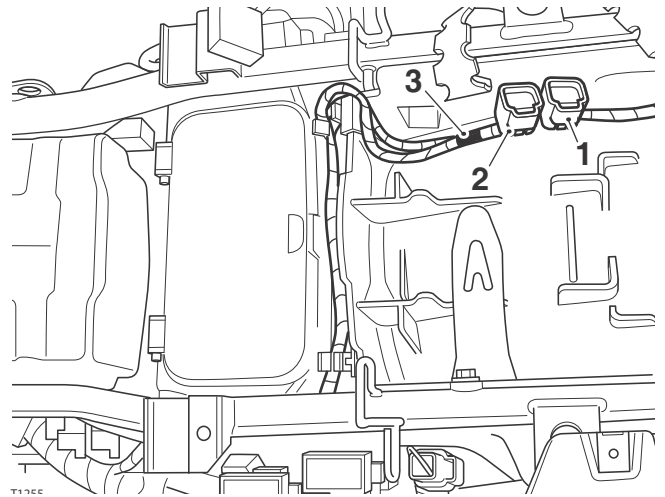

- 1. Pillion seat power socket**  
**2. Rider seat power socket**  
**3. Red identification tape**

31. Connect the heated pillion seat connector to the pillion seat power socket.
32. Connect the rider seat connector to the rider seat power socket.
33. Reconnect the battery as described in the service manual.
34. Refit the rider and pillion seats as described in the owner's handbook. Ensure the harnesses for the heated seats do not become trapped between the seat and the motorcycle frame.
35. Refer to the owner's handbook for details regarding the operation of the heated seats.



---

## Heated Seat System Testing

### **Warning**

Never start the engine or let it run for any length of time in a closed area. The exhaust fumes are poisonous and may cause loss of consciousness and death within a short time. Always operate the motorcycle in the open-air or in an area with adequate ventilation.

1. Run the engine to avoid draining the battery.
2. Operate the switch at both positions and check that the heated seat/s warm up.
3. The fuse number 1 of the front fuse box protects the heated seat circuit. Refer to the label in the fuse box lid for fuse amperage.

### **Warning**

If, after fitment of this accessory kit, you have any doubt about the performance of any aspect of the motorcycle, contact an authorised Triumph dealer and do not ride the motorcycle until the authorised dealer has declared it fit for use. Riding a motorcycle when there is any doubt as to any aspect of the performance of the motorcycle may result in loss of control of the motorcycle, leading to an accident.

### **Warning**

Never ride an accessory equipped motorcycle at speeds above 80 mph (130 km/h).

The presence of accessories will cause changes in the stability and handling of the motorcycle. Failure to allow for changes in motorcycle stability may lead to loss of control or an accident.

Remember that the 80 mph (130 km/h) limit will be reduced by the fitting of non-approved accessories, incorrect loading, worn tyres, overall motorcycle condition and poor road or weather conditions.

### **Warning**

The motorcycle must not be operated above the legal road speed limit except in closed course conditions.

### **Warning**

Only operate this Triumph motorcycle at high speed in closed course, on-road competitions or on closed course racetracks. High speed operation should only be attempted by riders who have been instructed in the techniques necessary for high speed riding and are familiar with the motorcycle's characteristics in all conditions.

High speed operation in any other circumstances is dangerous and will lead to loss of motorcycle control and an accident.