

CI8100

IMI Wilshire, Inc.



IMI WILSHIRE, INC.

COUNTER INTELLIGENCE BEVERAGE SYSTEM

CI8100

INSTALLATION AND SERVICE MANUAL

SECTION I CI8100 COUNTER INTELLIGENCE[®] BEVERAGE SYSTEM

General Description..... 1
 Specifications (See Individual Component Manuals)..... 1
 Unpacking and Inspection 1
 Installation Requirements..... 1
 Installation Instructions 3
 Module Assembly 3
 Module Parts List 6
 Figure 1 - Exploded View..... 7
 Figure 2 - Module Assembly 8

SECTION II OMEGA BEVERAGE DISPENSER (Manual 83587) (Service Parts, See 83587-600)

General Description..... 1
 Specifications 1
 Unpacking and Inspection 2
 Installation Requirements - See Section I
 Installation Instructions - See Section I
 Start Up and Operation..... 6
 Timed Carbonator Cycle Liquid Level Control..... 7
 Cleaning and Maintenance 8
 Equipment and Supplies..... 10
 Cleaning and Sanitizing Procedure 10
 Water Bath Cleaning..... 12
 MER24 Merchandiser Installation¹
 Plain Water Boost System (Optional) 14
 Bypass Regulator Adjustment 15
 Plain Water Boost System Plumbing Schematic..... 16
 Mini Pump System (Optional)..... 17
 Ice Bank Control Replacement..... 17
 Carbonated Water/Plain Water Conversion 18
 Double Check Valve Instruction..... 19
 Removing Refrigeration Deck (Units with Carbonator Pump)..... 21
 Removing Dispenser from Service 25
 Service and Trouble Shooting, Refrigeration System 26
 Service and Trouble Shooting, *Omega Plus* Integral Carbonator 33
 Wiring Diagram..... 37
RC Omega Plus Remote Chiller₁

SECTION III MER40 MERCHANDISER

General Description..... 1
 Installation Requirements..... 1
 Operation 1
 Changing Lamps 2
 Changing Graphics 2
 Parts List..... 3
 Figure 1 - MER40 Exploded View I 4
 Figure 2 - MER40 Exploded View II 5

₁ Not applicable to Counter Intelligence[®] Beverage System

IMPORTANT: *To the user - This manual is a guide for installing, operating and maintaining this equipment. Please read and maintain this document for service and trouble shooting.*

GENERAL DESCRIPTION

The C18100 consists of three sub-modules (OMEGA mechanically refrigerated dispenser, M15 ice dispenser and MER40 merchandiser) in an integrated package.

SPECIFICATIONS

See individual manuals for specifications.

UNPACKING AND INSPECTION

The units, packed individually, were thoroughly inspected before leaving the factory. Any damage should be noted at the time of delivery (no later than 15 days from date of delivery) and immediately reported to the carrier. File the claim with the delivering carrier.

INSTALLATION REQUIREMENTS

COUNTER A flat surface able to support 700 pounds. Counter cut outs for product lines, drainage lines and electrical cords. See template provided with installation kit for dimensions and locations.

Clearance above the C18100 must be a minimum of 18" to allow removal of the upper cabinet for servicing the power deck, filling the ice bin as well as providing adequate ventilation. There should be a minimum of 4 inches clearance on each side and rear of the unit. **FAILURE TO COMPLY MAY RESTRICT AIR MOVEMENT SUFFICIENTLY TO IMPAIR REFRIGERATION PERFORMANCE.**

SEAL A silastic caulk, approved for use in a food zone (Dow Corning 732 or equivalent) is required to seal equipment to the counter top.

ELECTRICAL Use separate 120VAC 20 amp 60HZ grounded duplex outlets to accommodate each module and/or accessories. The outlets should be located below the counter and within three (3) feet of the unit and installed according to national and local electrical codes.

DRAIN An approved three (3) inch or larger drain must be located within three (3) feet of the dispenser. The preferred drain is an open floor sink with a center cone. Do not use copper for soft drink drains.

WATER Water pipe connections and fixtures directly connected to a potable water supply shall be sized, installed and maintained according to

federal, state and local laws. A minimum of 3/8"ID tubing is required to dispenser

An optional carbonator is required.

Noncarbonated drinks require a minimum incoming water pressure of 55 psi and a maximum of 75 psi. An optional booster pump is required if pressure is not maintained at or above 55 psi. If above 75 psi, install a water regulator.

Use water filters to eliminate undesirable elements in the water, such as chlorine in excess of 1.5 ppm. Use a type that does not remove all chlorine.

CO₂ SYSTEM

The CO₂ tank must be located next to a solid wall and chained.

The CO₂ storage area must be open and vented.

On bulk CO₂ tanks ensure vaporizing and regulator capacity is sufficient (i.e., 8-9 scfm average per dispenser and carbonator).

Set CO₂ regulators as appropriate:

Room temp. carbonators	- 105 psi for all valves with minimum flow rate of
	1.5oz/sec
Cold carbonator	- 90 psi

If CO₂ is to be located under the counter, 30 inches under counter clearance is required.

SYRUP SYSTEM

Allow no more than two (2) Fast Flow Valves per Bag-In-Box (BIB) pump or Figal.

Up to 4 BIB's can be connected together, whether a selector (automatic switch-over device) is used or not, as long as all bags are at the same level, not above or below each other.

Because of pressure drop within figal fittings, no more than two (2) Figals should be connected in series.

INSTALLATION INSTRUCTIONS

The installation process described below should be performed in the sequence as presented:

DISPENSER MODULE ASSEMBLY

1. Remove packaging and crating material from each module. Save the packing material in case items need to be returned. Remove protective covering as each part is assembled.
2. Using the template, provided with the installation kit, mark the counter to indicate the location of the modules.
3. Cut the access holes and slots as indicated.
4. Apply a generous bead of silastic to the counter top in all areas where the riser (mounting base) will contact the counter.
5. Set the *OMEGA* beverage dispenser, in its proper position (note which side ice dispenser is mounted), making sure the cabinet is set on the riser.
6. Set the *M15* ice dispenser on the riser. Gently slide it to the rear. The three (3) inch wide slot in the bottom of the ice dispenser should align with the corresponding hole in the counter top.
7. Place side panels on each side of the beverage system. For systems with a front channel attached with three screws on each side, align them so that the keyholes face toward the rear of the unit. Install the rear straps by inserting them into the keyholes in the side panels (the flange on the rear straps should be against the ice dispenser). Push down on the straps locking them into place. Next, align the dispensers by lining them up so that the rear straps are flush against the back of the dispenser.

For systems with a front channel that attaches to the side panels by locking into the keyholes in the return flange of the side panels, be sure the front panels with the keyholes in the return flange are positioned at the front of the system.

8. For systems without keyholes in the return flange, install the front channel assembly by attaching it to each side panel using three hex head screws. (It is recommended that a socket wrench be used to tighten the hex head screws.) Apply a bead of silastic to all areas where the drip pan support will contact the counter. Place the drip pan support on the counter, aligning its mounting holes to those in the side panels. Attach the drain pan support to the front of the side panels using hex head screws through the back of the support. At this point, the *COUNTER INTELLIGENCE* BEVERAGE SYSTEM should be properly aligned. If necessary,

reposition the components slightly to ensure any gaps are less than 1/32 inches wide.

For systems with keyholes in the return flange: With the hinge halves above the top plate, install the front channel by inserting the rivets into the keyholes of each side panel simultaneously and push down, locking it into place. Use one (1) hex head screw on each side to secure the front channel in place. **WARNING: HEX HEAD SCREWS MUST BE INSTALLED TO PREVENT THE FRONT CHANNEL FROM DISENGAGING FROM THE KEYHOLES DURING SERVICING OF THE BEVERAGE SYSTEM OR ITS MERCHANDISER.**

9. Complete sealing all the modules to the counter top by wiping the excess silastic off the counter and leave a smooth joint between the counter and modules.
10. Connect the drain hoses to the drain pan and install drain pan on the support frame. All counter cutouts for drain and electrical lines must be sealed with an acceptable material in accordance with local and state health and building codes.
11. The *MER40* is a lighted sign and is shipped partially assembled (See Section IV):
 - a. Remove two screws from top cover on *MER40*;
 - b. Remove top cover and plastic lens, diffuser and graphics panel;
 - c. Removed fluorescent lamps packed inside *MER40*;
 - d. Install the *MER40* merchandiser by mating the slip hinges at the top of the merchandiser and dispensers;
 - e. Rotate the *MER40* upward and rest it on the two support brackets;
 - f. Plug the *MER40* cord into the outlet located on the top front panel of the OMEGA, then close supports to allow the *MER40* to hang in its vertical position;
 - g. Install fluorescent lamps into lamp holders;
 - h. Clean lens and diffusers, being careful not to scratch. Carefully insert graphics panel between diffuser and lens and slide into slots along front edge of the merchandiser body;
 - i. Replace *MER40* top cover and two screws. Merchandiser is illuminated when dispenser is plugged in and power switch is turned on.
12. Connect all product lines, carbonated water lines, potable water lines and drain lines as marked.

13. Activate the ice dispenser lever to assure proper placement of the ice dispenser front cover. Install the splash plate and cup rests.

The installation is now complete. The system should be sanitized in accordance with the cleaning and sanitizing procedures found in the Installation and Service Manuals for the modules. See individual manuals for start-up and operation.

CI8100
See Figure 1

*Not Shown

ITEM NO	PART NO	DESCRIPTION
1	84202	Rear Strap Assembly, Sabre Grey
	84202-001	Rear Strap Assembly, Stainless Steel
2	84242-002	Upper Cabinet
*	84244	Top Plate
3	84200-001	Side Panel, Left, Sabre Grey
	84200-201	Side Panel, Left, Stainless Steel
4	84200-002	Side Panel, Right, Sabre Grey
	84200-202	Side Panel, Left, Stainless Steel
5	84239-001	Front Channel
5A*	84241	Splash Plate
6	84220	Bracket, Upper Cabinet
7	84213	Drip Pan
8	84211-001 (Was 84211)	Drip Skirt
9	84214	Cup Rest, Beverage
10	84113	Cup Rest, Ice
11	84000-655	Riser
12	24844-003	Access Panels
14	82991-101	Valve Mounting Plate
15	83475-100	Liner Assembly, Foamed
16	84000-200	Ice Dispenser, Lever (Not Shown)
*	84000-206	Ice Dispenser, M15C, Push Button
*	84000-565	MER40 Merchandiser
*	84000-559	MER40 Merchandiser
*	60093-100	Fuse for MER40

CI8100 EXPLODED VIEW
Figure 1

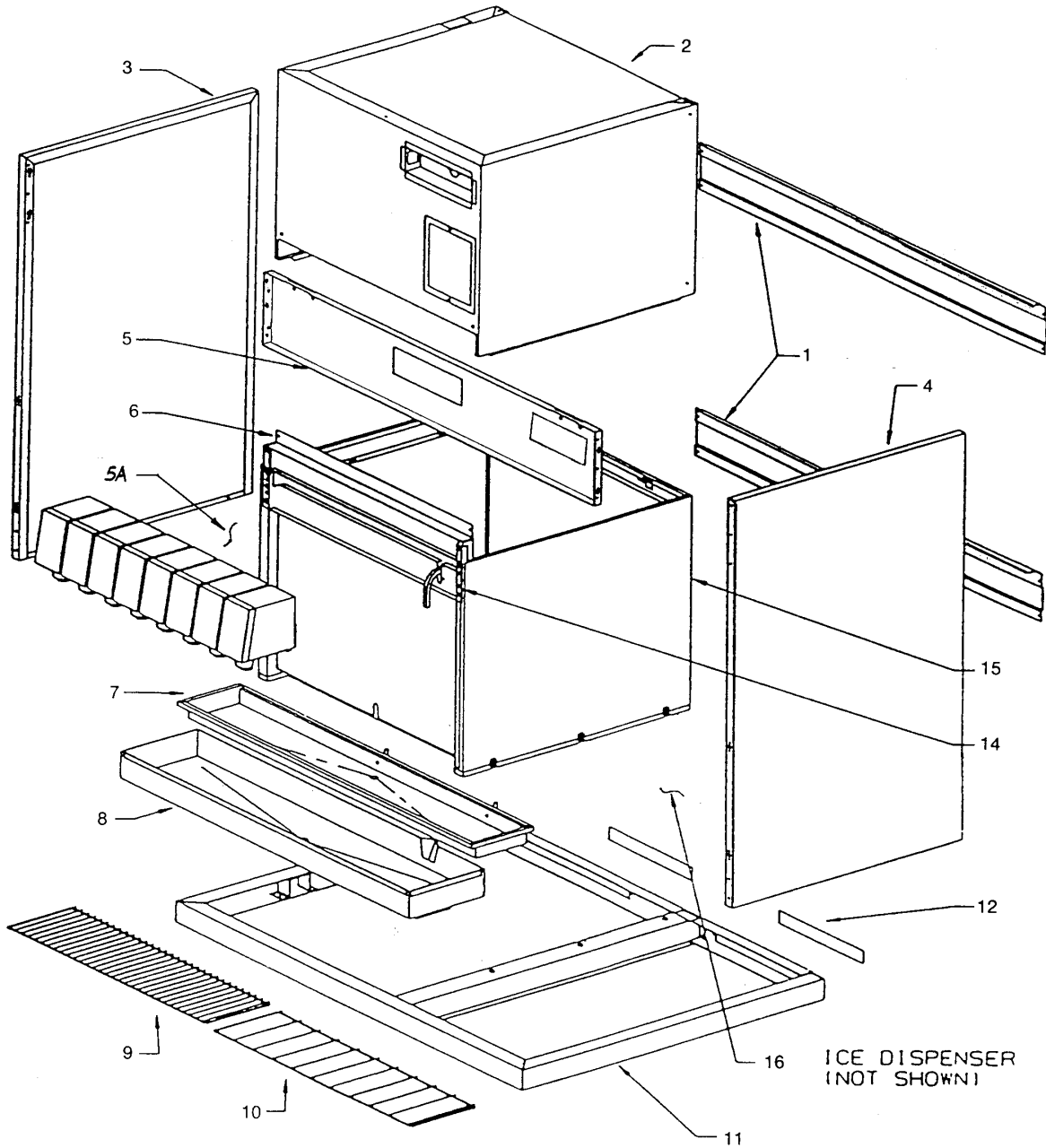

CI8100 MODULE ASSEMBLY
Figure 2

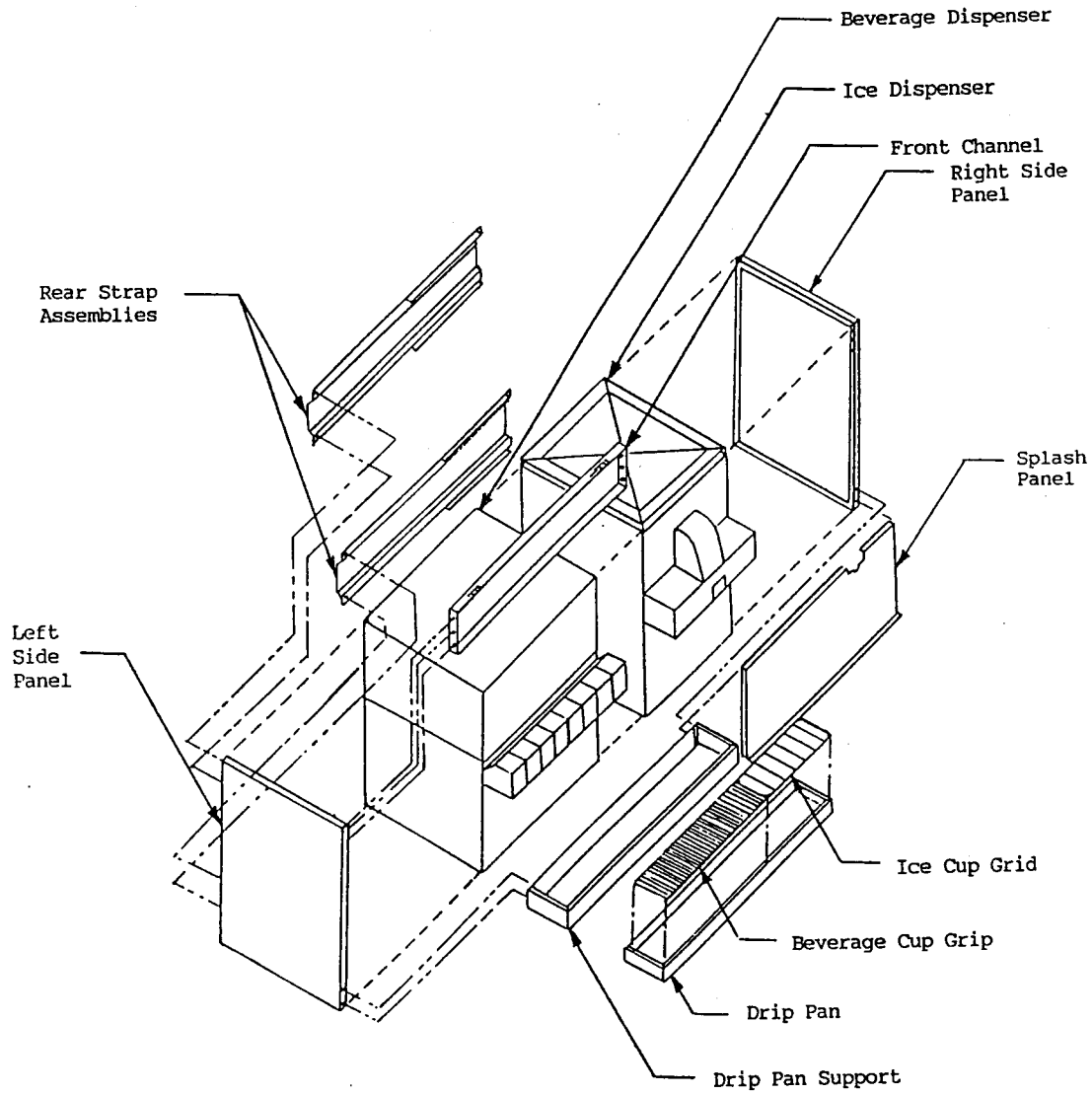

IMPORTANT: *To the user - This manual is a guide for installing, operating and maintaining this equipment. Please read and maintain this document for service and troubleshooting.*

GENERAL DESCRIPTION

The *MER40* merchandiser is an internally lit graphics display illuminated by two 42 watt (F30T12CWHO) fluorescent lamps.

INSTALLATION REQUIREMENTS

LOCATION The *MER40* is designed to be mounted on a vertical surface. The supporting structure must be able to support 30 pounds. The *MER40* is approximately 34-7/8 inches long by 13-3/16 inches high by 5 inches deep.

ELECTRICAL Use a 120VAC 20 amp 60HZ grounded outlet.

INSTALLATION

The top back corners of the *MER40* contain two slip pin hinge half brackets which are used to hang the sign. The sign may be attached so that the sign may be rotated about the hinge brackets.

1. Fasten the two hinge halves to the to the mating hinge brackets on the supporting surface. The half which has the spring-loaded pin must be mounted on the right side. The fasteners used to mount the hinge brackets must be able to support a minimum of 40 pounds.
2. Pull the spring-loaded pin to the right and insert the left side of the merchandiser onto the left hinge half.
3. Align the right hinge on the *MER40* with the spring hinge on the supporting surface.
4. Release the spring pin to engage the hinge.
5. Move the merchandiser form side to side to make sure the pins are engaged.
6. Fluorescent tubes have been carefully packed inside the *MER40* and have to be installed. Refer to *Changing Lamps*.

OPERATION

Plug power cord into a 120VAC 60HZ grounded outlet.

CHANGING LAMPS

1. Unplug the *MER40* from power source.
2. Remove the *MER40* from its supporting surface and remove two screws and top cover.
3. Carefully slide the plastic lens and graphics panels up and out.
4. Remove the old lamp by rotating it 90 degrees and lift out of the socket.
5. Install the new lamp by rotating it 90 degrees to the locked position.
6. Carefully replace the lens and graphics panels, making sure that the clear plastic panel is on the outside.
7. Replace the cover and two screws.

CHANGING THE GRAPHICS

1. Unplug the *MER40* from power source.
2. Remove the *MER40* from its supporting surface and remove two screws and top cover.
3. Spread the lens panels slightly and lift the graphics panel out the top.
4. Insert the new graphics panel.
5. Replace the top cover and two screws.

MER40
See Figure 1 and 2

ITEM NO	DESCRIPTION	PART NO
1	Body	84232-200
2	Lamp Holder Assembly	84141-006
3	Lamp Socket	60098-001
4	Cover, Wireway	84232-003
5	Ballast	60097-001
6	Clear Panel Lens	84235-001
7	Graphic Panel	Consult Factory
8	Diffuser Panel Lens, White	84235-002
9	Top Assembly	84234-202
10	Hinge, Right	84223-002
10a	Hinge, Left	84223-004
11	Cord Set	60195-031 (Before 11-14-96) 82051-001 (After 11-14-96)
12	Strain Relief	60040-078

MER40 EXPLODED VIEW I
Figure 1

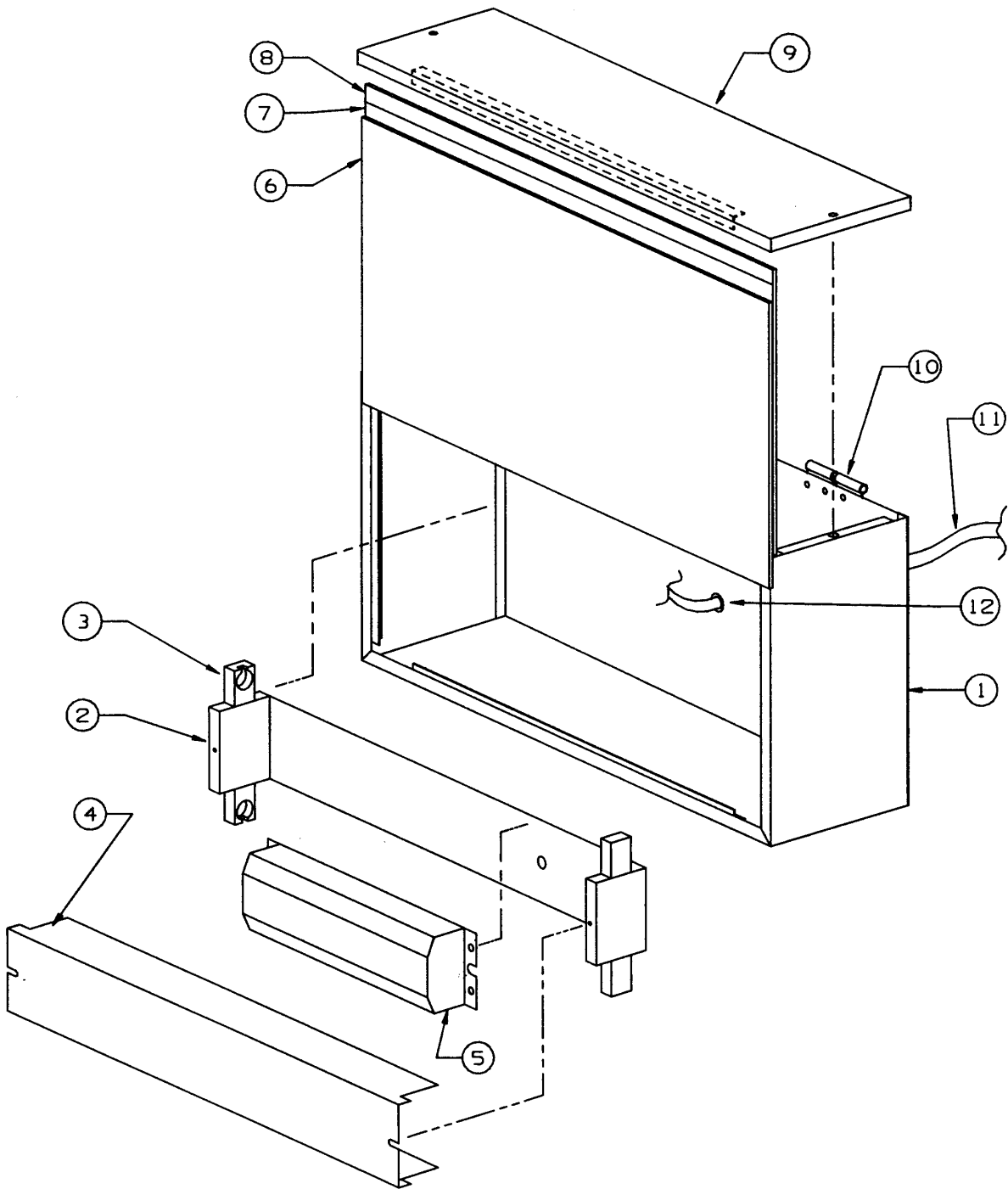

MANUAL-MER52

MER40 EXPLODED VIEW II
Figure 2

