

864293A02

4.3L (262 CID) MANIFOLD CONVERSION

Models Covered

Models Covered	Serial Number Or Year
4.3L (262 CID) Single Piece Manifolds	0F803800 and Above

Notice

NOTICE
After completing installation, these instructions should be placed with the product for the owner's future use.

NOTICE
This document is written to aid our dealers, boatbuilders, and company service personnel in the proper installation or service of our products. Persons who are not familiar with these or similar products produced by Mercury Marine, and who have not been trained in the recommended servicing or installation procedures should have the work performed by an authorized Mercury Marine dealer technician. Improper installation or servicing of the Mercury product could result in damage to the product or personal injury to the installer or persons operating the product.

Parts List

Qty.	Description	Part Number
2	Exhaust tube (exhaust elbow to intermediate exhaust elbow)	32-44358001
2	Exhaust tube (use with original exhaust Y pipe)	32-807458T
2	Exhaust tube (use with new exhaust Y pipe)	32-44348
8	Hose clamps	54-815504272
2	Gasket - elbow, 4 slot	27-863726
12	Screw - 3/8-16 x 4-5/8 in. (542 mm) long	10-53728
4	Screw - 3/8-16 x 1-1/4 in. (32 mm) long	10-58640
4	Washer - split	13-41471
8	Screw - 3/8-16 x 5-3/4 in. (146 mm) long	10-43749
3	Screw - 1/4-20 x 3/4 in. (19 mm) long	10-65746
3	Screw set - pressure rod	10-65746
3	Spacer - nylon	23-806981
3	Washer - stainless steel	12-35462
3	Nut - 1/4-20 hex stainless steel	11-64015

Additional Parts Needed

Qty.	Description	Part Number
2	Exhaust elbow	807988A2
2	Exhaust manifold	99746A17
1	Y pipe assembly (lower exhaust pipe) optional only required if replacing the existing Y pipe	807130A4
2	Intermediate exhaust elbow (for use without exhaust risers)	14478T01

NOTE: If exhaust risers are being added to this kit: Refer to the appropriate Mercury Accessories Guide to identify the correct part numbers for the exhaust riser kit and intermediate exhaust elbow kit for your application.

Removal

IMPORTANT: The installation of the two piece exhaust manifold will result in the loss of 12.7 mm (1/2 in.) of exhaust elbow height. Prior to removing the original exhaust manifold, it is recommended that the exhaust elbow height above the waterline be checked. Refer to the appropriate Mercury MerCruiser Installation Manual. If the current exhaust elbow height minus 12.7 mm (1/2 in.) is not within the minimum exhaust elbow height specification limits it will be necessary to order and install the appropriate exhaust riser kit and intermediate exhaust elbow.

1. If replacing the Y pipe (lower exhaust pipe):
 - a. Remove the engine and the exhaust tube assembly from the boat. Refer to the appropriate Mercury MerCruiser Service Manual.
 - b. Install the new Y pipe (lower exhaust pipe) assembly. Refer to the appropriate Mercury MerCruiser Service Manual
 - c. Remove and retain the components mounted on the exhaust manifolds.
 - d. Disconnect the water hose from the fitting on the bottom of the exhaust manifold.
 - e. Remove and discard the existing one piece exhaust manifolds. Refer to the appropriate Mercury MerCruiser Service Manual.

NOTE: The following steps can be performed with the engine in the boat.

2. If the Y pipe (lower exhaust pipe) is not being replaced:
 - a. Remove and retain the components mounted on the exhaust manifolds
 - b. Disconnect the water hose from the fitting on the bottom of the exhaust manifold.
 - c. Remove and discard the existing one piece exhaust manifolds. Refer to the appropriate Mercury MerCruiser Service Manual.

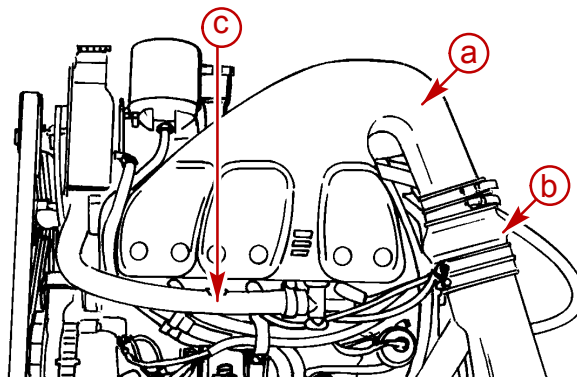

17112

a - One piece exhaust manifold

c - Water hose

b - Exhaust tube

Installation

1. Apply Sealant to the new water hose fittings and install in the exhaust manifolds. Tighten securely and position toward the front of the engine, facing slightly outboard (approximately 5-10 degrees).

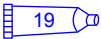
Tube Ref No.	Description	Where Used	Part No.
 19	Perfect Seal	Water hose fitting	92-34227-1

2. Install the new exhaust manifolds with the new gaskets. Refer to the appropriate Mercury MerCruiser Service Manual. Torque the exhaust manifold screws.

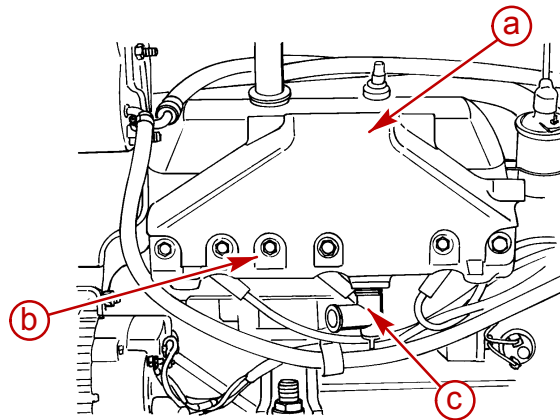

17104

a - Exhaust manifold**c** - Water hose fitting**b** - Exhaust manifold screw (6 each side)

Description	Nm	lb. in.	lb. ft.
Exhaust manifold screw	34		25

3. On 1996 Models:

- Remove the nut that secures the port water hose clamp to the engine block.
- Disconnect and discard the clamp.
- Reinstall and torque the port water hose clamp nut.

Description	Nm	lb. in.	lb. ft.
Port water hose clamp nut	34		25

- Route the port water hose beneath the power steering pump.

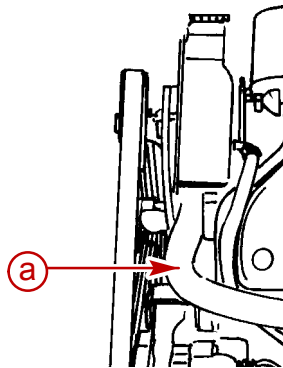

17106

a - Port water hose routed beneath the power steering pump

4. Reconnect the port water hose to the water hose fitting on the bottom of the port exhaust manifold. Tighten the hose clamp securely.

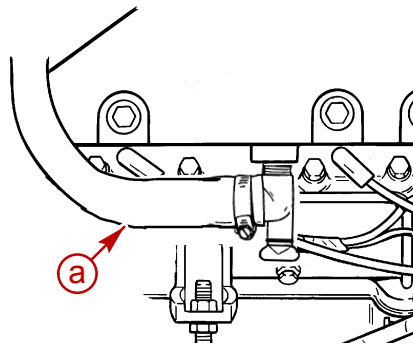

17107

a - Port water hose

5. Ensure that the water shutters are in good condition and correctly installed in the exhaust Y pipe (lower exhaust pipe). Refer to the appropriate Mercury MerCruiser Service Manual.
6. Apply sealant to the threads of the pipe plugs and install the pipe plugs into the new exhaust elbows. Tighten 1 and 1/2 turns past hand tight.

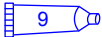
Tube Ref No.	Description	Where Used	Part No.
	Loctite 567 PST Pipe Sealant	Pipe plug	92-809822

7. Apply sealant to the threads of the exhaust elbow to exhaust manifold screws.
8. Apply a liberal coat of sealant to both sides of the exhaust elbow to exhaust manifold gasket.

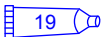
Tube Ref No.	Description	Where Used	Part No.
	Perfect Seal	Exhaust elbow to exhaust manifold screws and exhaust elbow to exhaust manifold gasket	92-34227-1

9. Install the exhaust elbows to the exhaust manifolds using the new gaskets and screws. Torque the screws.

Description	Nm	lb. in.	lb. ft.
Exhaust elbow to exhaust manifold screw	59		44

10. Connect the intermediate exhaust elbows to the exhaust elbows with the exhaust tubes and clamps included in the kit. Tighten the clamps securely.
11. Reinstall the engine, if it was removed. Refer to the appropriate Mercury MerCruiser Service Manual.

Exhaust Alignment And Installation

Due to the variation in transom thickness and transom angle, it will be necessary to measure the alignment of the intermediate exhaust elbow to the exhaust Y pipe. If there is a forward over lap or rear overlap of the exhaust Y pipe that exceeds 9.52 mm (3/8 in.), it will be necessary to make adjustments using the following procedures to gain the correct alignment.

1. Do not install the lower exhaust tube at this time.
2. If the intermediate elbow overlaps the exhaust Y pipe to the rear by more than 9.52 mm (3/8 in.):

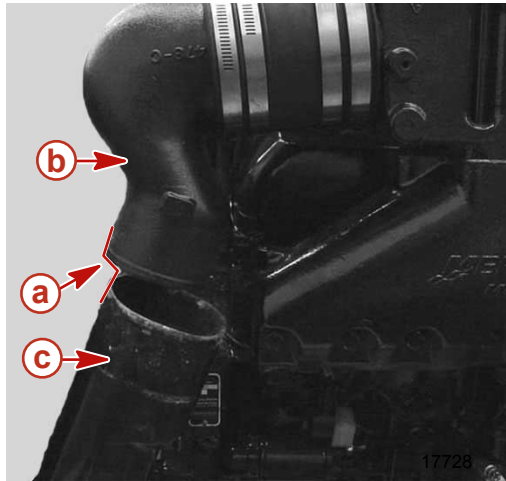

Rear overlap of the exhaust Y pipe shown, forward overlap similar

- a** - Location for measurement of overlap
- b** - Intermediate exhaust elbow
- c** - Y pipe (lower exhaust pipe)
- a. Remove the intermediate exhaust elbow from the upper exhaust tube.
 - b. Cut approximately 12.7 mm (1/2 in.) off of the upper portion of the intermediate exhaust elbow.

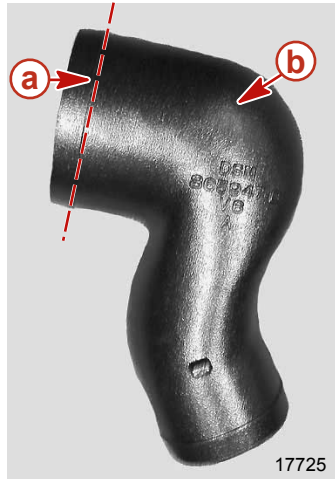

- a** - Location of cut
- b** - Upper portion of the intermediate exhaust elbow
- c. Install the modified intermediate exhaust elbow into the upper exhaust tube.
 - d. Verify proper alignment of the intermediate exhaust elbow to the exhaust Y pipe.
 - e. Remove the intermediate exhaust elbow.
 - f. Apply a soap and water solution to the outer surface of the exhaust Y pipe.

- g. Slide the correct lower exhaust tube onto the the exhaust Y pipe as low as possible.

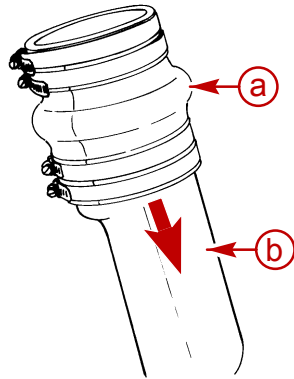

17109

Bell-mouth Y pipe

a - Lower exhaust tube

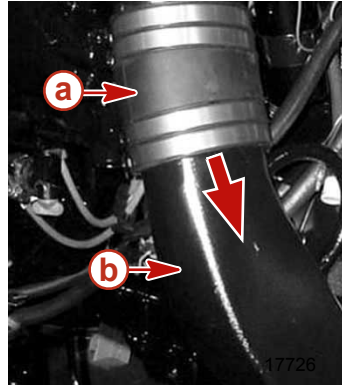

17726

Current production Y pipe

b - Y pipe (lower exhaust pipe)

- h. Reinstall the modified intermediate exhaust elbow into the upper exhaust tube. Tighten the hose clamps securely.
- i. Pull the lower exhaust tube up onto the lower portion of the intermediate exhaust elbow. Tighten the hose clamps securely.

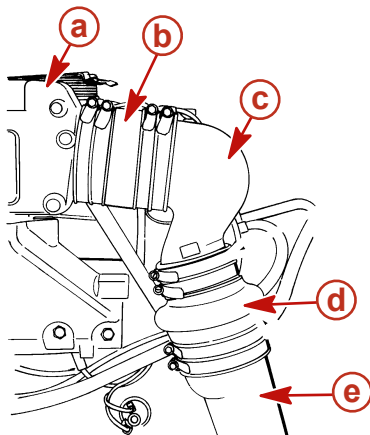

17110

a - Exhaust elbow

b - Upper exhaust tube

c - Intermediate exhaust elbow

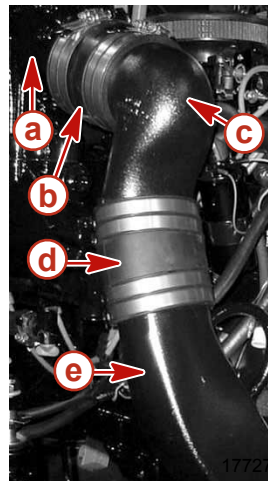

17727

d - Lower exhaust tube

e - Y pipe (lower exhaust pipe)

3. If the intermediate elbow has an overlap forward of the exhaust Y pipe that exceeds 9.52 mm (3/8 in.):

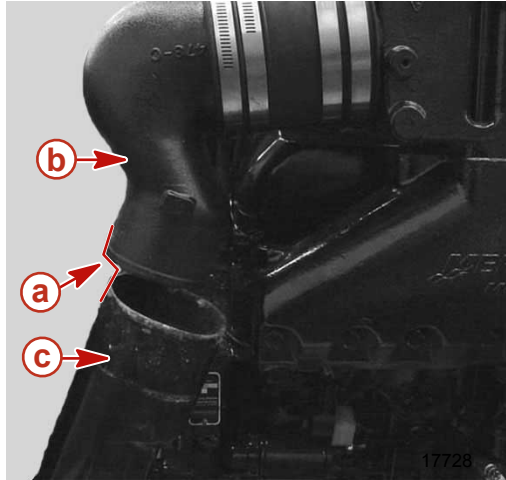

Rear overlap of the exhaust Y pipe shown; forward overlap similar

- a** - Location for measurement of overlap
b - Intermediate exhaust elbow
c - Y pipe (lower exhaust pipe)

- Loosen the upper exhaust tube hose clamps at the intermediate exhaust elbow.
- Pull the intermediate exhaust elbow away from the exhaust elbow to eliminate the forward overlap and achieve proper alignment with the exhaust Y pipe.
- Verify proper alignment of the intermediate exhaust elbow to the exhaust Y pipe.
- Remove the intermediate exhaust elbow.
- Apply a soap and water solution to the outer surface of the exhaust Y pipe.
- Slide the correct lower exhaust tube onto the exhaust Y pipe as low as possible.

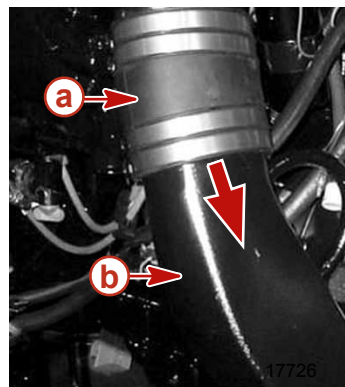
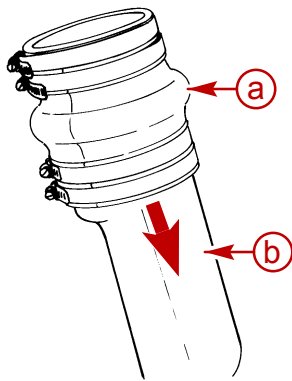

- a** - Lower exhaust tube
b - Y pipe (lower exhaust pipe)

- Reinstall the intermediate exhaust elbow into the upper exhaust tube. Tighten the hose clamps securely.

- h. Pull the lower exhaust tube up onto the lower portion of the intermediate exhaust elbow. Tighten the hose clamps securely.

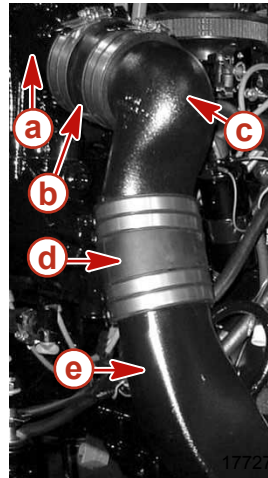
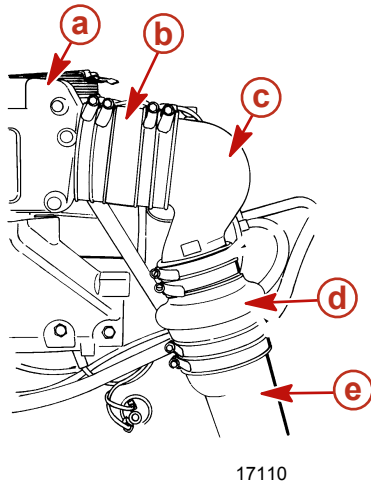

- | | |
|---------------------------------------|--|
| a - Exhaust elbow | d - Lower exhaust tube |
| b - Upper exhaust tube | e - Y pipe (lower exhaust pipe) |
| c - Intermediate exhaust elbow | |

4. Reinstall all the components previously removed from the exhaust manifolds.