



INSTRUCTIONS

-J00430

REV. 5-1-95

Kit Numbers 68431-95 and 68432-95

FLAT LENS TURN SIGNAL KIT

General

These kits differ as follows:

Part No. 68431-95 - Contains 4 single filament lamp assemblies

Part No. 68432-95 - Contains 2 single and 2 dual filament lamp assemblies

These kits are designed for installation on the following model motorcycles:

Part No. 68431-95 may be installed on all 1973 and later XL, FX, Softail® (except Heritage), FXR (except FXRT) and Dyna models **not equipped with running lights**.

Part No. 68432-95 may be installed on all 1986 and later XL, FX, Softail® (except Heritage), FXR (except FXRT) and Dyna models **equipped with running lights**.

Kit Contents

These kits contains the following components:

PART NO. 68431-95

QTY	DESCRIPTION
8	Butt connectors, included with turn signal assemblies
4	Turn signal lamp assemblies (single filament)

PART NO. 68432-95

QTY	DESCRIPTION
10	Butt connectors, included with turn signal assemblies
2	Turn signal lamp assemblies (single filament)
2	Turn signal lamp assemblies (dual filament)

Installation



WARNING
To avoid accidental start-up of the vehicle and possible personal injury, disconnect battery cables (negative cable first) before performing any wiring procedures.

Rear Directional

REMOVING ORIGINAL EQUIPMENT (OE) REAR DIRECTIONALS

1. Refer to the Service Manual that covers model being worked on and remove seat.

2. Reach under fender or fender supports and follow wire(s) forward to area under seat. Find a convenient location at which to cut the stock wire(s). Before cutting the wires, measure the wire length on the lamp assemblies to make sure the new wires will reach to the location selected.
3. Cut stock wire(s). Note position and routing of wires back to stock directional lamp. Remove wire(s) from clips under fender and remove directional lamp assembly and attached wires.

INSTALLING REAR FLAT LENS DIRECTIONAL

NOTE

The fender struts and shocks may need to be removed on the Dyna Wide Glide to route the wire(s) from rear to under seat.

1. Mount the new flat lens directional and route the new wires in the same location as the stock wires that were removed in step 3 above.
2. Make wire connections following step 2A or 2B as applicable. Strip wires 3/8 in., insert wires into butt connector and crimp connector with Packard 115 crimper or equivalent.
- 2A. **If stock lamp had only one wire**, connect the violet wire of the new lamp to the stock wire using one of the butt connectors contained in the kit. Either ground or remove the black wire connected to the new directional.
- 2B. **If stock lamp had two wires**, connect the violet wire of the new lamp to the stock violet/brown or copper stranded wire. Stagger the connectors to allow the conduit to cover the splices. Connect the two remaining black wires together using one of the butt connectors contained in the kit.
3. Repeat Removal and Installation for other rear directional.
4. Test the directional signals using the procedure in the WARNING at the end of this procedure.

Front Directional

REMOVING OE FRONT DIRECTIONALS

1. Follow wire(s) from front directional and find a convenient location at which to cut the stock wire(s). Before cutting the wires, measure the wire length on the lamp assemblies to make sure the new wires will reach to the location selected.
2. Cut stock wire(s). Note position and routing of wires back to stock directional lamp. Remove directional lamp assembly and attached wires.

INSTALLING FRONT FLAT LENS DIRECTIONAL

1. Mount the new flat lens directional and route the new wires in the same location as the stock wires that were removed in step 2 above.

NOTE

The stock directional light wiring is identified as follows:

Lamps with one lead have: black wire with copper strands

Lamps with two leads have: one wire with copper strands for directional light filament (32 candle power) and another wire with silver strands for running light filament (2 candle power)

Lamps with three leads have wires color coded as follows:

violet/brown for directional light filament

blue for running light filament

black for ground wire

2. Make wire connections following step 2A, 2B or 2C as applicable. Strip wires 3/8 in., insert wires into butt connector and crimp connector with Packard 115 crimper or equivalent.
- 2A. **If stock lamp had only one wire**, connect the violet wire of the new lamp to the stock wire using one of the butt connectors contained in the kit. Either ground or remove the black wire connected to the new directional.

- 2B. **If stock lamp had two wires**, connect the violet wire of the new lamp to the stock violet/brown or copper stranded wire. Stagger the connectors to allow the conduit to cover the splices. Connect the two remaining black wires together using one of the butt connectors contained in the kit.

- 2C. **If stock lamp had three wires**, connect the violet wire of the new lamp to the stock violet/brown wire. Stagger the connectors to allow the conduit to cover the splices. Connect the blue wires together and connect the two remaining black wires together using the butt connectors contained in the kit.

3. Repeat Removal and Installation for other front directional.

4. Test the directional signals using the procedure in the following WARNING.

⚠ WARNING

Test directional signals after finishing installation. Weak, intermittent, or non-operational lights indicate a poor connection or a short in the wires. The motorcycle must never be operated in this condition as it could result in personal injury or vehicle damage. Inspect the bulb and socket. Examine wiring for bare spots or loose connectors. After reinstalling the wiring, test directional signals again for satisfactory operation.



Service Parts

P/N. 68431-95, 68432-95

Date 5/95

Flat Lens Turn Signal Kit

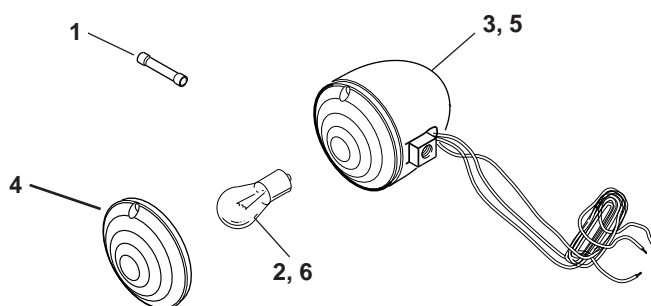

68432-95

Item	Description	Part No.
1	Butt connector	31509-80
2	Bulb, dual filament	68168-89
3	Turn signal, dual filament	68395-95
4	Lens, flat	68759-96
5	Turn signal, single filament	68499-95
6	Bulb, single filament	68572-64B

68431-95

Item	Description	Part No.
1	Butt connector	31509-80
4	Lens, flat	68759-96
5	Turn signal, single filament	68499-95
6	Bulb, single filament	68572-64B