



INSTALLATION

SUB-FENDER LICENSE PLATE MOUNT with TURN SIGNAL MOUNT

9258

PARTS INCLUDED

- 1 Chrome Curved Plate
- 1 Taillight Bracket, Black
- 1 Right Signal Mount, Black
- 1 Right Taillight Bezel Bracket
- 1 Left Signal Mount, Black
- 1 Left Taillight Bezel Bracket
- 1 Curved License Plate Frame
- 1 Hardware Kit
 - 2 Turn Signal Spacers
 - 4 1/4"-20 x 7/8 Flat Cap Screws
 - 1 1" x 3" Single Side Adhesive Foam
 - 2 M6 x 1.0 x 16MM Hex Head Cap Screw
 - 7 1/4"-20 Nylon Locking Nuts
 - 2 1/4"-20 x 1/2" Button Socket Cap Screw
 - 4 Turn Signal Adhesive
 - 5 1/4" Flat Washers
 - 2 Butt Connectors
 - 4 Cable Ties
 - 1 Dielectric Grease Packet
- 1 Installation Instructions

Please read and understand entire instructions before starting installation.

THANK YOU FOR CHOOSING KÜRYAKYN!

IN ORDER TO PROTECT YOU AND OTHERS FROM POSSIBLE INJURY AND/OR PROPERTY DAMAGE OR LOSS, PLEASE PAY CLOSE ATTENTION TO ALL INSTRUCTIONS, WARNINGS, CAUTIONS AND ATTENTION NOTES REGARDING THE USE AND CARE OF THIS PRODUCT.

WARNING! THIS INDICATION ALERTS YOU TO THE FACT THAT IGNORING THE CONTENTS DESCRIBED HEREIN CAN RESULT IN POTENTIAL DEATH OR SERIOUS INJURY

ATTENTION! This indication alerts you to the fact that ignoring the contents described herein may negatively affect product performance and functionality.

TOOLS SUGGESTED

Set of Hex Wrenches, Combination Wrenches or Socket Set with Ratchet, Screw Drivers, Wire Cutter/Wire Stripper

STRICTLY OBSERVE THE FOLLOWING GUIDELINES IN ORDER TO USE THE PRODUCT PROPERLY AND AVOID POTENTIALLY DANGEROUS ACCIDENTS.

NOTE: For Yamaha Raider Models. Allows re-installation of OEM turn signals or Small Silver Bullets, Universal Bullet Lights, or universal turn signals with 5/16" mount bolt.

STEP 1

Read and understand all steps in the instructions before starting the installation. Park the motorcycle on a hard, level surface and turn off the ignition.

ATTENTION! A factory service manual may be helpful in performing this installation. Do not attempt to perform this installation if you are not confident in your ability to complete all of the steps in the procedure; consult a trained technician.

CUSTOMER SERVICE

877.370.3604 (toll free)

INSTALLATION QUESTIONS

techsupport@kuryakyn.com
or call 715.247.2983

LIMITED WARRANTY

Kuryakyn warrants that any Kuryakyn products sold hereunder, shall be free of defects in materials and workmanship for a period of one (1) year from the date of purchase by the consumer excepting the following provisions:

- Kuryakyn shall have no obligation in the event the customer is unable to provide a receipt showing the date the customer purchased the product(s).
- The product must be properly installed, maintained and operated under normal conditions.
- Kuryakyn makes no warranty, expressed or implied, with respect to any gold plated products.
- Kuryakyn shall not be liable for any consequential and incidental damages, including labor and paint, resulting from failure of a Kuryakyn product, failure to deliver, delay in delivery, delivery in nonconforming condition, or for any breach of contract or duty between Kuryakyn and a customer.
- Kuryakyn products are often intended for use in specific applications. Kuryakyn makes no warranty if a Kuryakyn product is used in applications other than intended.
- Kuryakyn electrical products are warranted for one (1) year from the date of purchase by the consumer. L.E.D.'S contained in components of Kuryakyn products will be warranted for defects in materials and workmanship for 3 years from the date of purchase where as all other components shall be warranted for one(1) year. This includes, but is not limited to; control modules, wiring, chrome & other components.
- Kuryakyn makes no warranty of any kind in regard to other manufacturer's products distributed by Kuryakyn. Kuryakyn will pass on all warranties made by the manufacturer and where possible, will expedite the claim on behalf of the customer, but ultimately, responsibility for disposition of the warranty claim lies with the manufacturer.

ABOUT OUR CATALOG

For purchasing Kuryakyn® products, you can receive a complete catalog free of charge.

Send the Proof-of-Purchase below with your address to: Kuryakyn, P.O. Box 339, Somerset, WI 54025.

Please indicate either Accessories Catalog for Harley-Davidson® or GL & Metric Cruisers.

Be sure to ask your local dealer about other Kuryakyn® products, the motorcycle parts and accessories designed for riders by riders.

©2005 Kuryakyn USA® All Rights reserved.



kuryakyn.com

STEP 2 Remove the stock license plate bracket assembly from the motorcycle. Remove the two self-locking nuts located inside the fender at the top of the bracket assembly. Remove the two flange bolts securing the bracket assembly, one bolt located inside the fender on each side. Refer to the factory service manual.

STEP 3 Remove the taillight chrome bezel from the stock assembly. Remove the tapping screw (PIC 1) located at the top of the chrome bezel, keep these screws they will be re-used. Remove the spring nuts (PIC 1) that the tapping screws were fastened to; keep these nuts they will be re-used. Remove the plastic rivet being careful not to damage it. Keep the rivets they will be re-used.

STEP 4 Remove the taillight from the assembly by removing the three screws (PIC 2) with collars and rubber dampeners. This hardware will be re-used.

STEP 5 Using the taillight and hardware that was removed in Step 4, locate the Taillight Bracket from the kit and attach it to the taillight using the hardware from Step 4. PIC 3

STEP 6 Assemble the taillight bezel using the plastic rivets from Step 3 and the Left/Right Taillight Bezel Brackets (PIC 4 – LEFT side shown). Install the bezel bracket on the inside of the taillight bezel and insert the plastic rivet from the outside and secure the plastic rivet.

STEP 7 Install the spring nuts that were removed in Step 3 on the taillight bezel. PIC 5

STEP 8 Secure the taillight bezel assembly to the taillight bracket assembly with the tapping screws from Step 3. PIC 6

STEP 9 Assemble the Curved License Plate Frame, Chrome Curved Plate and Right/Left Signal Mounts. Mount the Plate Frame (light on the top) on the front of the Chrome Curved Plate. Place the Left/Right Signal Mounts behind the Curved Plate (PIC 7) and secure with the four 1/4"-20 x 7/8" Flat Cap Screws and 1/4"-20 Nylon Locking Nuts. Insert a 1/4"-20 x 1/2" Button Socket Cap Screw through the upper hole and secure with a 1/4"-20 Nylon Locking Nut.

NOTE: The Left and Right Signal Mounts are optional and do not have to be used if alternate turn signals or mounting locations are being used.

STEP 10 Take the plate/signal assembly from Step 9 and fit it to the taillight/bezel assembly. The plate/signal assembly will fit outside of the tabs on the taillight bracket (PIC 8). Be sure that the large tab from the taillight bracket fits over the stud (PIC 9) on the plate/signal assembly and secure with a 1/4"-20 Nylon Locking Nut.

STEP 11 Line up the top holes from the plate/bracket assembly and the taillight/bezel assembly (PIC 10). Rotate the bezel brackets so that all the holes line up. To aid in installation, you may wish to use a small piece of tape to hold the bezel bracket in place with the holes lined up.

STEP 12 Install the complete assembly in to the fender.

STEP 13 Place the assembly over the mounting studs (PIC 11) and loosely install the self-locking nuts that were removed in Step 2.

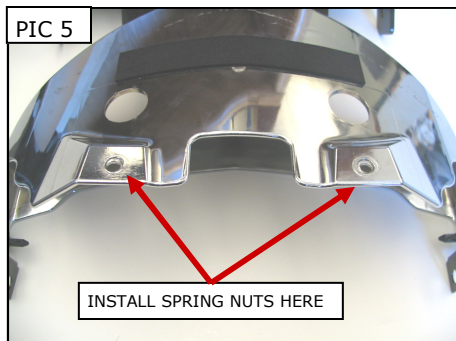
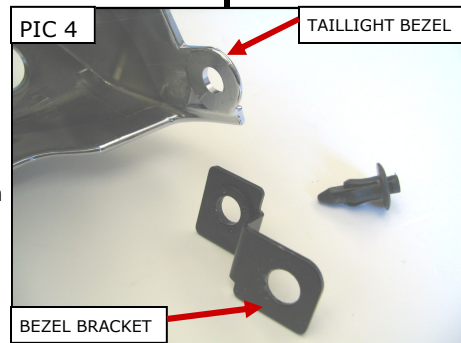
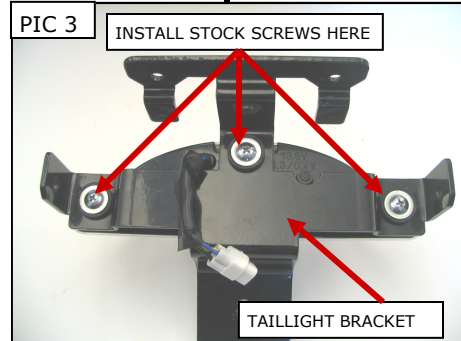
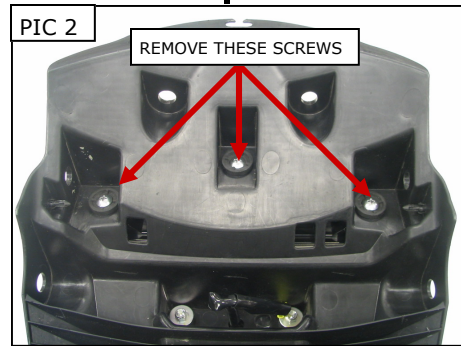
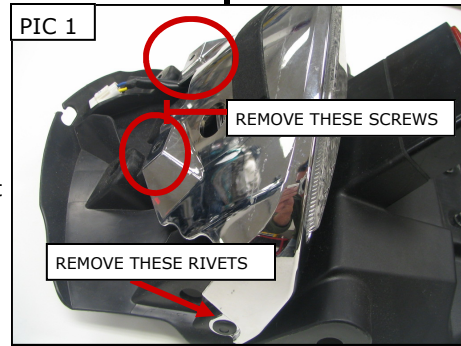

STEP 14 Install the M6 x 1.0 x 16MM HHCS through the top holes and bracket and in to the side of the fender. PIC 12 It is very important to make sure that the bolt goes through the bezel bracket.

STEP 15 On the stock plastic license plate assembly, cut the stock license plate light wiring about 2" from the connector and strip the ends of the wire. Cut the new license plate frame wiring to the desired length and strip the ends of the wire. Using the included butt connectors, connect the wires (black across from black) and crimp the butt connectors. Test the function of the license plate light. Heat shrink the butt connector insulation to seal.

ATTENTION! Secure all wiring away from any moving parts, pinch points or extreme heat. Küryakyn WILL NOT issue a warranty on any electrical component that fails due to pinched, crimped, broken, abraded, melted or frayed wires.

STEP 16 If using the stock turn signals, use the included "U" shaped signal adhesives. Apply the adhesives to the turn signals and attach the signal to the assembly using the stock nut. PIC 13 If the stock turn signals are replaced turn signals using a smaller diameter fastener, use the supplied turn signal spacers to reduce the size of the hole in the turn signal bracket. PIC 14

STEP 17 Tighten all fasteners and connect all electrical connections. Test all turn signal and brake light functions.

WARNING! ENSURE PROPER TAILLIGHT AND TURN SIGNAL OPERATION BEFORE RIDING THE MOTORCYCLE. VISIBILITY IS A MAJOR CONCERN FOR MOTORCYCLISTS. TAILLIGHT AND TURN SIGNAL MALFUNCTION COULD RESULT IN DEATH OR SERIOUS INJURY.

STEP 18 The stock reflector bracket may be re-installed using the lower fasteners on the license plate assembly. PIC 14

NOTE: The reflector bracket may need to be slightly bowed in order to get the bracket to fit correctly.

ATTENTION! It is the installer's responsibility to ensure that all of the fasteners (including preassembled) are tightened before operation of the motorcycle. Küryakyn will not warranty components lost due to improper installation. Periodic maintenance may be required.

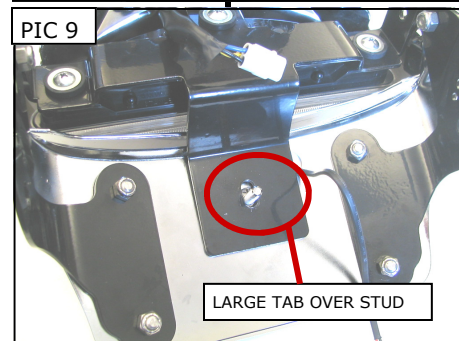
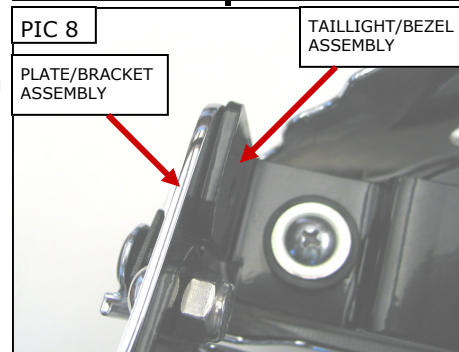
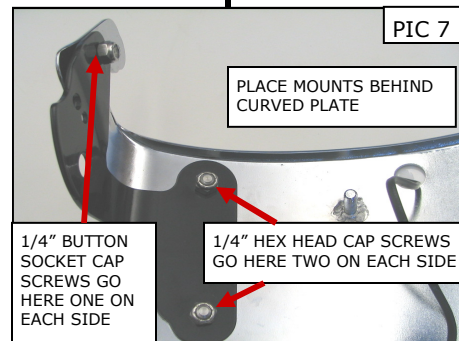
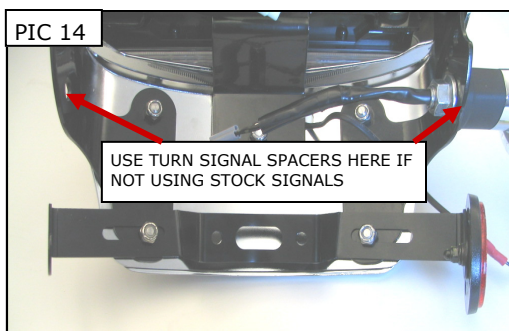
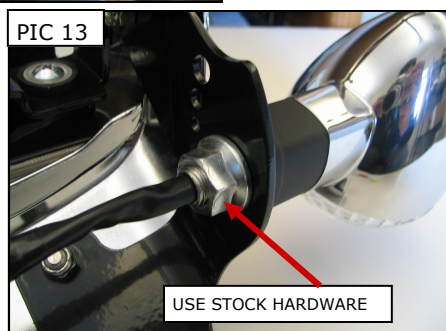
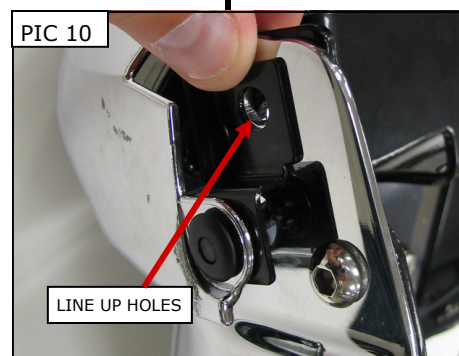
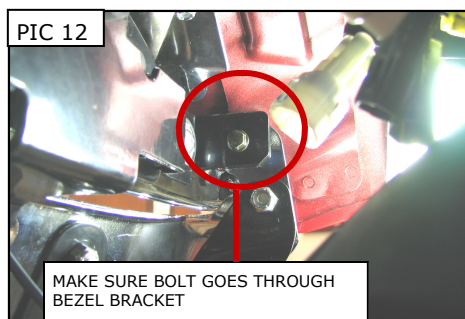
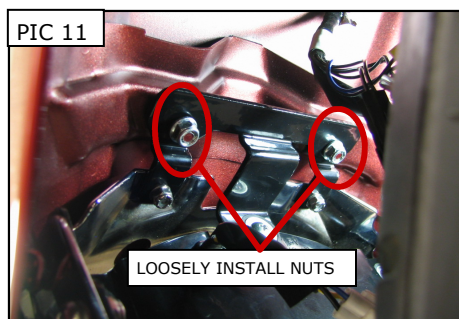

Ride On!

PAGE
3

LICENSE PLATE MOUNT

INSTALLATION