

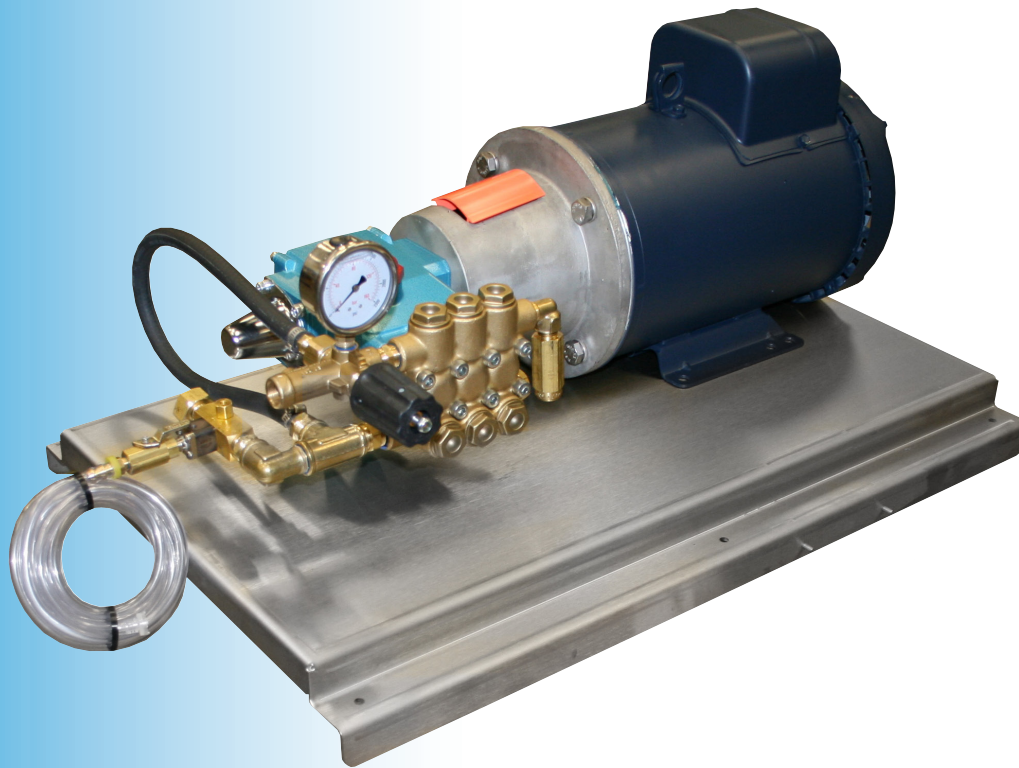

CAT PUMPS® Pressure Washer with Soap Injector

**DU PMC1551 / DU PMC1553
DU PM1301C / DU PM1303C**



Owner's Manual #0777 031110

Serial Number:

Installation Date:

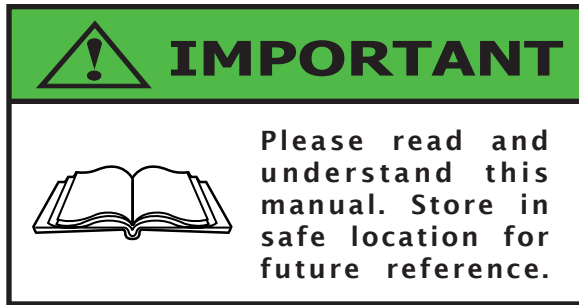

Everyone who operates this unit should understand basic operations and safety precautions! The time you take to fully understand the proper installation, maintenance and use of the machine will prolong its service life, and assure you of trouble free operation.

When unpacking, check to make sure all the parts shown on the Parts Breakdown near the end of this manual are included. If any parts are missing or broken, please call Dultmeier Sales as soon as possible.

Consumers should notice that this manual may differ slightly from the actual product as more improvements are made to our products. Some of the pictures in this manual may differ slightly from the actual product as well. Dultmeier Sales reserves the right to update designs and / or change the specifications at any time without incurring any obligation to install them on units previously sold.

If you have any questions or suggestions about this manual, please contact us.

Table of Contents

Safety Information	1
Specifications	2
Installation & Operating Instructions	3-4
Maintenance & Storage	4
Parts Breakdown	5
Warranty Information	6
Checklist	7

To avoid serious or fatal personal injury or major property damage, read and follow all safety and operation instructions in the manual.



This is a **Safety Alert Symbol** -

When you see this symbol in the manual, look for the following signal words & be alert to the potential for personal injury or property damage.



Warns of potential hazards that **WILL** cause serious personal injury, death or property damage.



Warns of potential hazards that **CAN** cause serious personal injury, death or property damage.



Warns of potential hazards that **WILL** or **CAN** cause minor personal injury, death or property damage.



Indicates special instructions that **MUST** be followed but not related to hazards.

This manual is intended to assist in the installation and operation of this unit. Do not attempt to operate this unit without reading and understanding this manual.

General Safety

To avoid the risk of serious bodily injury and property damage, read safety instructions carefully before installing this system. Follow all local and/or national plumbing and electrical codes when installing.



Do Not Allow System or Components to Freeze.

To do so may damage the system and will void the warranty.



Never Run the System Dry.

Running the unit dry (without fluid) can damage internal parts, overheat pump (which can cause burns to people handling or servicing the pump), and will void the warranty.



Risk of Electric Shock.

Keep the unit dry at all times -

Do not wash the motor or electrical panel or allow the unit to sit in standing water.

Use only Ground Fault Circuit Interrupter (GFCI) protected grounded outlet for the cord plug. If you must use an extension cord, use only UL approved indoor/outdoor, 3-wire, grounding type cords. The cord must be rated to support amp draw. Do not allow any part of cord or receptacle ends to sit in water.

To avoid fatal shocks, proceed as follows if service is needed:

- Turn off water to the system.
- Disconnect the power at main electrical service before unplugging the unit.
- Ground the electrical outlet box.
- Take extreme care when changing fuses.



Do not run the unit with discharge shut off, as hose may burst or damage may occur.



Modern motors can operate at high temperatures. To avoid burns when servicing pump, allow it to cool for 20 minutes after shutdown before handling.

CAT PUMPS® Pressure Washer with Soap Injector Specifications

DU PMC1551

PSI	1800
Capacity	4 GPM
Pump	CC 3CP1120
Motor	CE CL3612TM

CE CL3612TM	5 HP, 1 PH	
Volts:	230	
Amps:	23	

DU PMC1553

PSI	1800
Capacity	4 GPM
Pump	CC 3CP1120
Motor	CE CM3615T

CE CEM3615T	5 HP, 3 PH	
Volts:	208 - 230	460
Amps:	13.9 - 13.4	6.7

DU PMC1301C

PSI	1200
Capacity	3.6 GPM
Pump	CC 3CP1140
Motor	CE CL3619TM

CE CL3619TM	3 HP, 1 PH	
Volts:	230	
Amps:	13.2	

DU PMC1303C

PSI	1200
Capacity	3.6 GPM
Pump	CC 3CP1140
Motor	CE CM3611T

CE CEM3611T	3 HP, 3 PH	
Volts:	208 - 230	460
Amps:	9.1 - 8.4	4.2

Common Specifications

Style	High Pressure Plunger Pump
Maximum Inlet Pressure	70 PSI
Maximum Inlet Temperature	130° F
	*See Included CAT PUMPS® Service Manual for Higher Temperatures
Crankcase Capacity	11.8 oz.
Pump Drive	Direct
Dimensions	Approx. 30" x 18" x 15"
Shipping Weight	Approx. 85 lbs.
Pump Inlet	1/2"
Pump Discharge	3/8"
Features	Adjustable Pressure Unloader Valve, Chemical Injector, Pressure Gauge, Safety Pop Off Valve, 50' High Pressure Hose, Trigger Style Spray Gun with: Insulated Extension, Gun Swivel, and Spray Nozzle; and Heavy Duty Stainless Steel Base Plate. All units are Pre-Assembled and tested prior to shipping.

Installation

1. Select a location for pressure washer and chemical container. Locate near water & electrical sources and floor drain. Surface must be level & kept dry.
2. Electrician to run power from main supply panel to motor starter or stop start station, & then to motor wiring box. Check motor wiring schematic to ensure wired for proper voltage. (Fig. 1)



Follow all local codes for proper fittings, conduit, & wire sizing.

3. Run a 3/4" city pressure hose line to female garden hose connector on inlet of pressure washer. If running hot water, temperature should be no more than 130°. (Fig. 2)



It is recommended that soft water supply is used if available.



Water supply pressure should not exceed 60 PSI. Plumber to supply pressure regulator if required.

4. Connect one end of the high pressure hose to the outlet of the pump & install trigger gun to opposite end. (Fig. 2)
5. Set chemical container next to pressure washer & insert chemical suction tube with strainer into the container. (Fig. 2)
6. Turn the manual ball valve on chemical suction line off for initial testing. (Fig. 2)

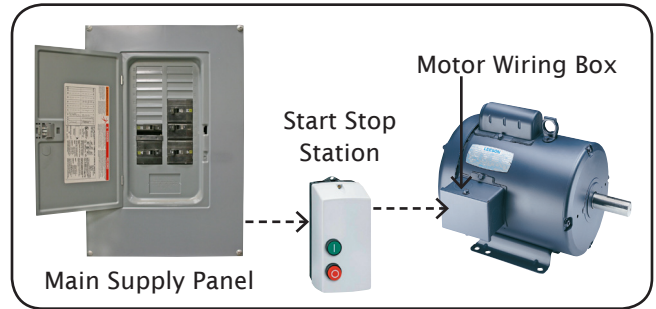

figure 1

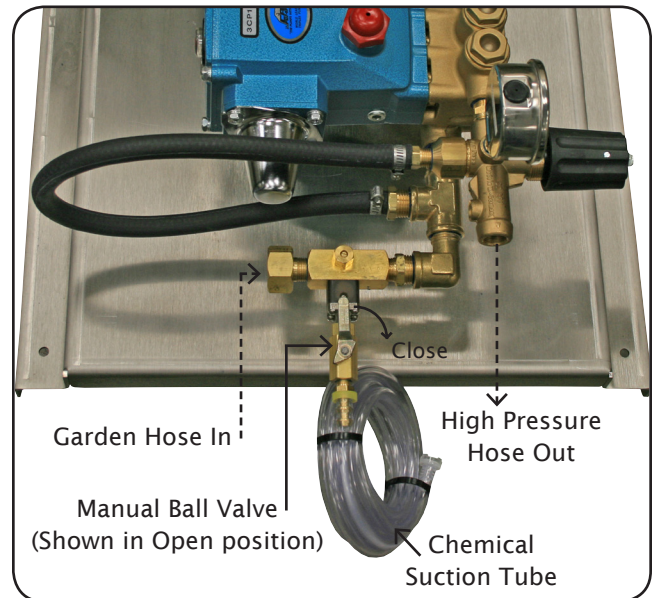

figure 2

Operation

1. While holding trigger gun open, start system. All units are tested at production and pressure should come up to specifications. Opening and closing of the trigger gun may be required to bleed out any trapped air. When gun is closed unloader will bypass flow back to inlet of pump. Gauge should read 0 PSI when in bypass mode.



Leaving pump in bypass mode for an extended period of time can damage pump due to friction heat buildup.

2. Regulating unloader valve is set and locked for Max. PSI listed under unit specifications. Pressure can be adjusted by turning the handle on regulating unloader valve. (Fig. 3)

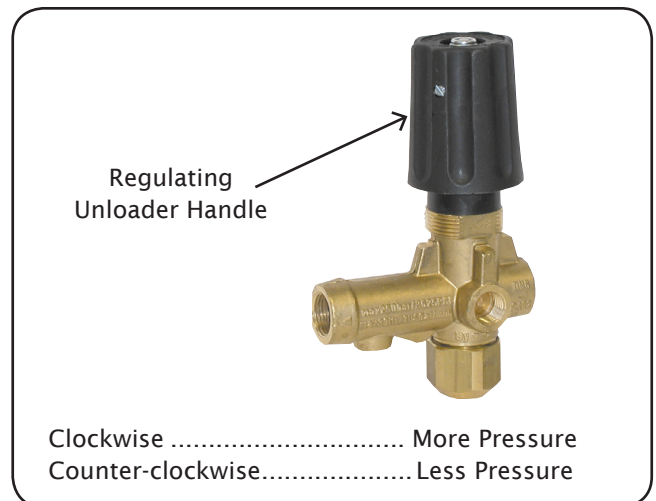

figure 3

Operation (continued)

CAUTION Hazardous Pressure.
Do not exceed pressure rating.

IMPORTANT Due to various inlet pressure conditions adjustment of the injector may be required.

- With trigger gun open turn manual ball valve to open position. Turn water bypass screw on injector clockwise until pump starts to chatter. Turn screw out counterclockwise until pump smooths out. At this point soap should appear at discharge of nozzle. Use chemical metering screw to adjust amount of soap. You may have to consult chemical container for further dilution information.

(Fig. 4)

- Turn manual ball valve to close position when chemical use is no longer desired.

IMPORTANT Pump oil must be changed per manufacturer's recommendations.

IMPORTANT Do not run pump with frozen liquid.

WARNING Hazardous Pressure.
Do not discharge toward body.

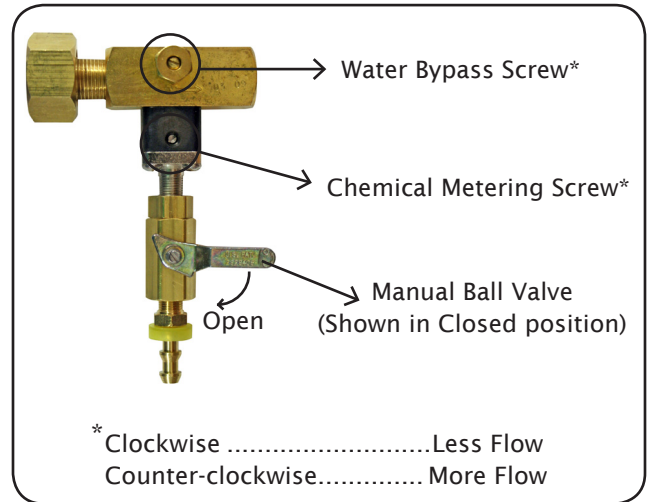

figure 4

Maintenance & Storage

- Change the oil after initial 50 hours. Use Cat Oil, part number CC 6100-1 for 21 oz. bottles or CC 6105-1 for 2.5 gallon jug. (Fig. 5)

IMPORTANT This pump takes 11.8 oz.

- The oil should be changed every 500 hours. If other than Cat Pumps special custom blend multi-viscosity ISO68 hydraulic oil is used, change the oil every 300 hours.
- Regulating Unloader Valve should be serviced or replaced when leaks occur or if not functioning properly.
- For extended storage or between use in cold climates, drain all pumped liquids from pump and flush with antifreeze to prevent freezing and damage to the pump. When running antifreeze through system, open and close trigger gun so entire system is protected.



figure 5

Please refer to the included CAT PUMPS® reference materials for additional information on the Maintenance & Storage of your CAT PUMPS® Pressure Washer.

Parts Breakdown: DU PMC1551

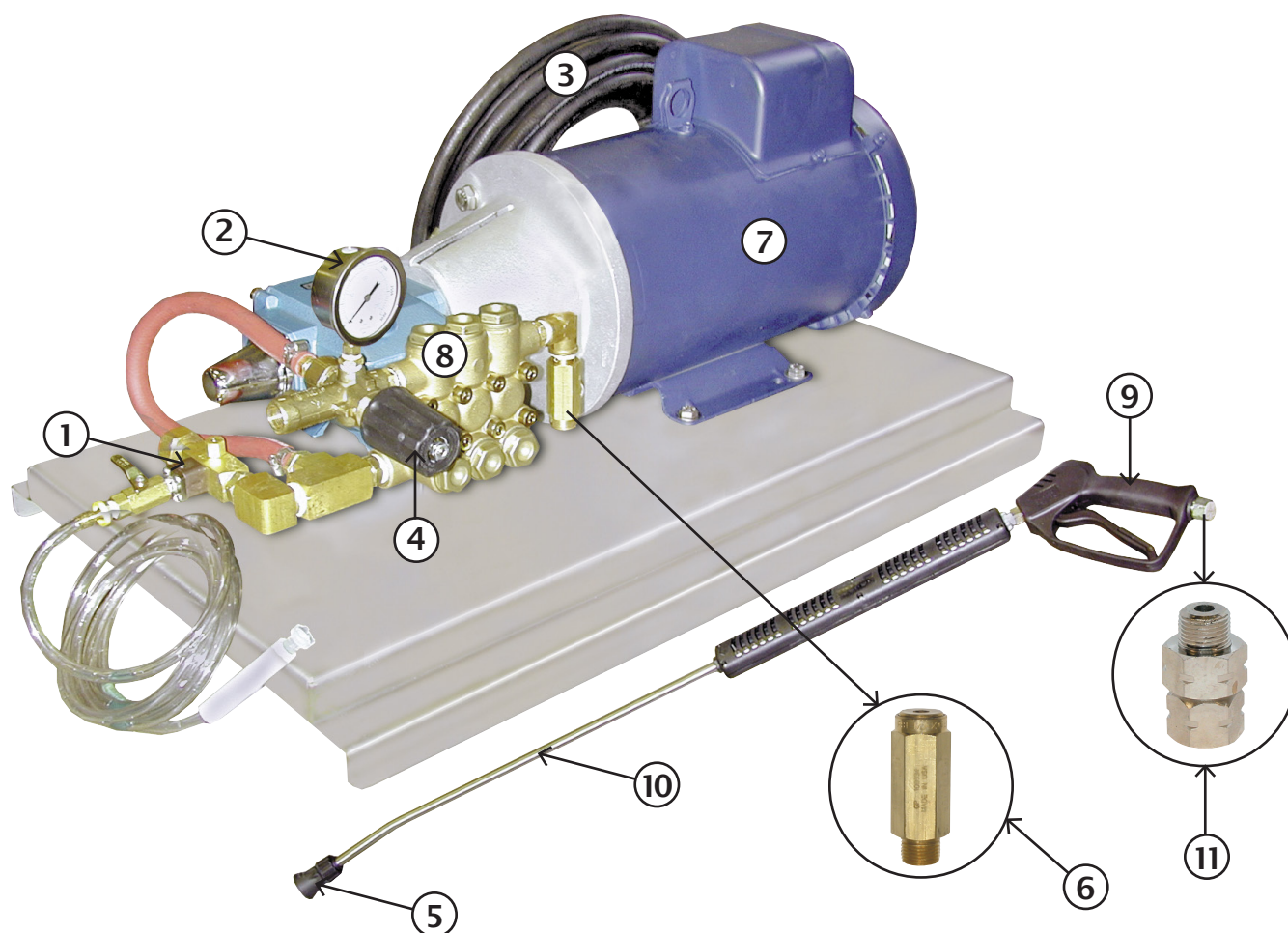

Item	Part Number	Description
1	DE 203B-2450	Chemical Injector
2	AH 2750-4	3600# Liquid Filled Pressure Gauge (Models PMC1551 & PMC1553)
	AH 2750-3	2300# Liquid Filled Pressure Gauge (Models PM1301C & PM1303C)
3	GA 6HR50	3/8" x 50' Black Wash Hose
4	NP ST261	Unloader Valve
	NP 200261526	Unloader Valve Repair Kit (Optional - Not Shown)
5	GS ST15	Nozzle Protector
	SS 1/4MEG2506	Spray Nozzle (Not Visible)
6	IP 100534	Safety Pop Off Valve
7	CE CL3612TM	Baldor C-Face Motor 5 HP 1 PH (Shown - Model PMC1551)
	CE CEM3615T	Baldor C-Face Motor 5 HP 3 PH (Model PMC1553)
	CE CL3619TM	Baldor C-Face Motor 3 HP 1 PH (Model PM1301C)
	CE CEM3611T	Baldor C-Face Motor 3 HP 3 PH (Model PM1303C)
8	CC 3CP1120	Cat Plunger Pump (Models PMC1551 & PMC1553)
	CC 3CP1140	Cat Plunger Pump (Models PM1301C & PM1303C)
9	NP ST1500	Trigger Gun
	NP 59603	Trigger Gun Repair Kit (Optional - Not Shown)
10	NP ST007-36	35" Wand Extension
11	NP ST300	3/8" Brass Swivel



Notice Regarding Manufacturer's Limited Warranty

Dultmeier Sales Limited Liability Company (hereinafter Dultmeier), notifies you that component part(s) carry a manufacturer's limited warranty provided by the manufacturer of said component part(s). These warranties do not pertain to normal wear of component part(s) that may occur within any specified period. While Dultmeier is not the manufacturer of any of the component part(s), Dultmeier will assist you in processing any and all manufacturer's warranty claim if applicable and available. Any and all manufacturer's claims must be submitted in writing to the manufacturer within the warranty periods provided by the manufacturer.

Defective component part(s) that are to be considered for manufacturer's limited warranty must be returned to the manufacturer by prepaid shipment with the applicable manufacturer's limited warranty period. If the component part(s) are deemed to be defective under the manufacturer's warranty, Dultmeier will assist in obtaining a replacement or repair of the component part(s). Said component part(s) will be returned F.O.B. Omaha, Nebraska. Replacement or repair shall be the exclusive remedy for any breach of warranty. Labor for installation, either with respect to original or replacement part or components, is not covered under the manufacturer's limited warranty.

Neither the manufacturer nor Dultmeier warrants loss of income or consequential damages for injury or commercial loss resulting from any breach of warranty or warranties stated above.

The manufacturer's limited warranty as stated does not apply to component part(s) which have been improperly installed, misused, altered, neglected, abused or not installed, adjusted, maintained, or used in accordance with applicable codes and ordinances and in accordance with the manufacturer's specifications as to such factors.

Notwithstanding Dultmeier's willingness to assist in the processing of the manufacturer's limited warranty, Dultmeier makes no warranty against infringement of the like, makes no warranty of merchantability, makes no warranty of fitness for a particular purpose, and makes no other warranty, express or implied, including implied warranty arising from the course of dealing or usage of trade.

Compliance with all local, state and federal codes regarding the installation and operation of said equipment, parts and components shall be the responsibility of the purchaser. The rights and obligations of the parties shall be governed by the laws of the State of Nebraska.

Dultmeier Sales • 1-800-228-9666 Omaha, NE • 1-800-553-6975 Davenport, IA

Production Checklist

- OK NA Oil Level
- OK NA Clamps Tight
- OK NA Bolts Tight & Anti-Seized
- OK NA Belts Tight
- OK NA Pulleys Aligned & Torqued to Specifications
- OK NA Fittings Straight
- OK NA Tested
- OK NA Winterized
- OK NA _____
- OK NA _____
- OK NA _____
- OK NA _____
- OK NA _____

- OK NA Pop-Off Valve Set _____ PSI
- OK NA Unloader Valve Locked
- OK NA PSI _____
- OK NA Pump RPM _____
- OK NA Motor Amps _____
- OK NA Motor Wired For _____

Accessories

- OK NA Safety Pop Off Valve
- OK NA Trigger Gun 1 2
- OK NA High Pressure Hose
- OK NA Injector / Injector Hose
- OK NA Gauge
- OK NA _____

Built By _____

Checked By _____

Customer Checklist

- OK NA Oil Level To Manufacturer's Specifications
- OK NA Accessories Included
- OK NA Shipping Container Was In Good Shape
- OK NA Overall Condition

If you have any questions or concerns about condition of this unit, please contact us before operating.