



INSTRUCTIONS

-J04744

REV. 2008-06-26

DETACHABLE TOUR-PAK KIT FOR ELECTRA GLIDE CLASSIC

GENERAL

Kit Number

53246-09

Models

For model fitment information, see the P&A Retail Catalog or the Parts and Accessories section of www.harley-davidson.com (English only).

Additional Parts Required

Separate purchase of LOCTITE® 262 Threadlocker and Sealant (94759-99) is required for proper installation of this kit. LOCTITE can be purchased from any Harley-Davidson Dealer.

WARNING

The rider's safety depends upon the correct installation of this kit. Use the appropriate service manual procedures. If the procedure is not within your capabilities or you do not have the correct tools, have a Harley-Davidson dealer perform the installation. Improper installation of this kit could result in death or serious injury. (00333a)

NOTE

This instruction sheet references service manual information. A service manual for your model motorcycle is required for this installation and is available from a Harley-Davidson Dealer.

Kit Contents

See Figure 5 and Table 1.

REMOVAL

1. Refer to service manual to remove saddlebags.
2. Refer to service manual to remove seat.
3. Remove the main fuse. See the owner's manual or service manual.
4. Refer to service manual to remove Tour-Pak®.
5. See Figure 1. Remove grab strap fastener (5), washer, grab strap (4) and forward saddlebag bracket (3). Save all parts for installation.
6. Remove rear fender support fastener (6) and fender support (1). Discard fender support cover and fastener. Repeat for other side.
7. Remove luggage rack-to-fender support fasteners (2).
8. Repeat all steps for the other side.

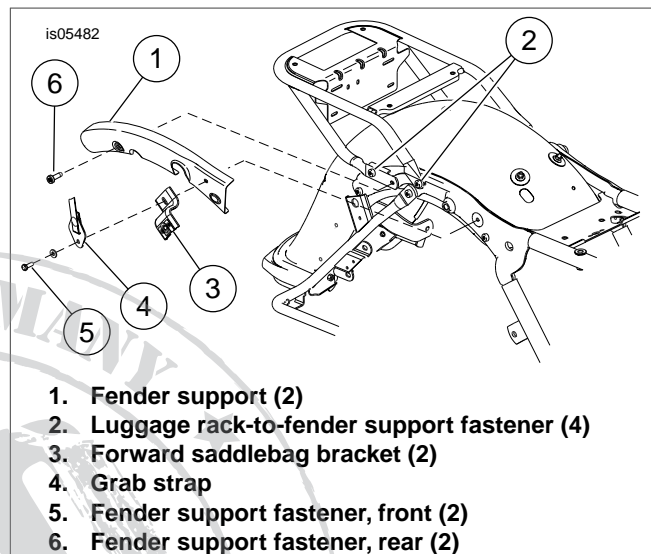

Figure 1. Remove Luggage Rack

INSTALLATION

Install Docking Brackets and License Plate Holder

NOTE

Protect the painted surfaces with a soft, clean cloth.

1. Install Detachable Tour-Pak Rack Kit to Tour-Pak. Refer to the instruction sheet provided with kit.
2. See Figure 5. Apply Loctite 262 to screw (5). Install fender support cover (29) and docking point bracket (3) with screw (5) and washer (8). Tighten to 17 ft-lbs (23 Nm).
3. Apply Loctite 262 to screw (5). Install fender support cover (30) and docking point bracket (2) with screw (5) and washer (8). Tighten to 17 ft-lbs (23 Nm).
4. Loosely install left side bracket (15) to docking point bracket, inserting alignment pin in the hole in the docking bracket. Install docking point (1) with screw (4) and nut (11).
Repeat to install right side bracket (14).
5. Loosely assemble the license plate holder (12) with screws (6), nuts (10) and bracket (16) to brackets (14 and 15).
6. Center the license plate holder over the tail light and tighten locknuts finger-tight.
7. Tighten bolts (4) to 25 ft-lbs (34 Nm).
8. Tighten license plate holder screws (6) to 15-19 ft-lbs (20-26 Nm).
9. Remove adhesive backing from red reflector (13) and carefully center and align it with the bottom edge of the license plate holder (12) and press firmly into place.

10. Install spacer (9), docking point (1), screw (17) and washer (7). Repeat for other side.
11. Tighten screws (17) to 125 **in-lbs** (14 Nm).
12. See Figure 1. Install the forward saddlebag bracket (3), grab strap (4), washer and grab strap fastener (5). Tighten to 12-15 ft-lbs (16-20 Nm).

Install Antenna and Bracket

1. Figure 2. Position the antenna bracket (5) as shown to the inside of the lower saddlebag support bar. Install screws (6). Tighten the screws to 22 **in-lbs** (2.5 Nm)
2. Install the internal tooth lockwasher (4) from the kit onto the larger threads of the antenna base (1), under the upper hex nut (3), and insert the antenna base through the hole in the antenna mounting bracket.
3. Install the lower hex nut (3) onto the threads of the antenna base. Tighten the lower nut to 6 ft-lbs (8 Nm).
4. See Figure 3. Gently remove left side cover (1) by pulling from frame tubes.
5. Route antenna cable/wiring between left frame rail and fender.
6. Coil excess antenna cable/wiring (2) and use long cable strap (3) to fasten cable to frame under left side cover (1) with vehicle wiring harness.

NOTE

The antenna cable should be routed rearward to the front luggage rack mount, then along the inside of the luggage rack and down the saddlebag support bar, over to the underside of the new antenna bracket. Correct the routing if necessary.

7. Plug the antenna cable connector into the bottom of the antenna base. Tighten the knurled nut to secure the connector to the antenna base. Allow slack in the cable at the antenna base to avoid kinking or binding at the connection.
8. Figure 5. Fasten the antenna cable to the saddlebag support bar with a cable strap (28) from the kit.
Use a second cable strap to tie the antenna cable to the frame rail, near the suspension air lines, underneath the chrome cover. **DO NOT** secure the cable to the air lines.
9. See Figure 2. Install the antenna mast assembly (2) securely onto the antenna base (1).

NOTE

To prevent possible damage to the sound system, verify that the ignition/key switch is in the OFF position before installing the main fuse. Refer to the owner's manual or service manual.

10. Verify that the ignition/key switch is in the OFF position. Refer to the owner's manual or service manual and follow the instructions given to install the main fuse.
11. Test the radio for proper operation.
12. See Figure 5. Cap unused wiring connector with connector housing (27).

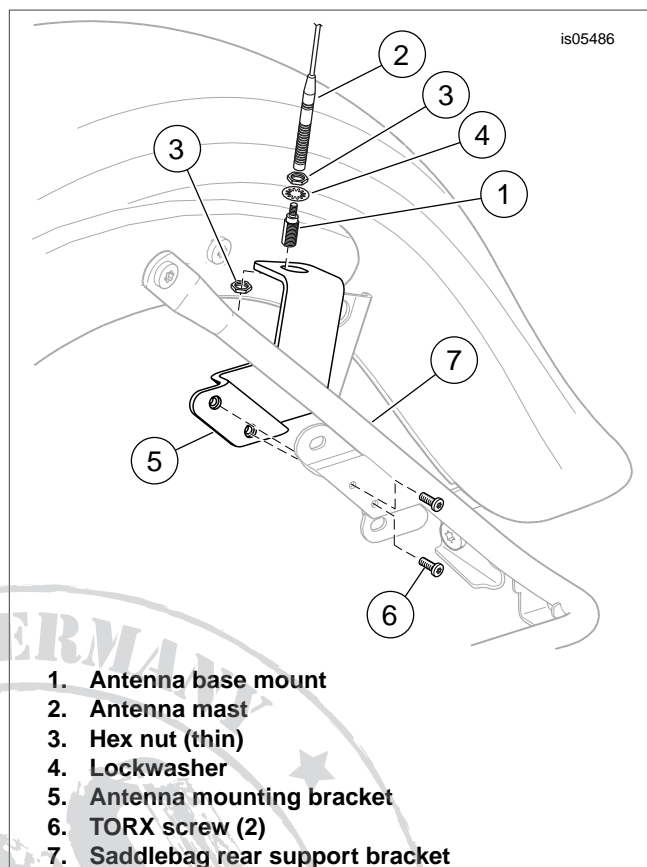

Figure 2. Antenna Mounting Bracket

FINAL ASSEMBLY

1. See Figure 3. Install left side cover (1).
2. See Figure 4. Apply protective tape (2) to the rear saddlebag mounting bracket (1) on the saddlebag. Repeat for the other side.
3. Refer to service manual to install saddlebags.
4. Refer to service manual to install seat.

Install Tour-Pak

1. Install Tour-Pak. Refer to instruction sheet provided with the Detachable Tour-Pak Rack kit.
2. See Figure 5. Install antenna adapter (22) by threading onto antenna mount joint assembly (24). Plug one end (connector) of antenna cable (23) onto top of antenna adapter (22) and tighten knurled nut to secure connector. Route other end up and through 3/4-inch diameter hole at the bottom front left side of Tour-Pak and plug into Tour-Pak antenna base. Tighten knurled nut. Make sure enough cable has been routed into Tour-Pak so that the cable rests flat on bottom of Tour-Pak. Secure cable in wire clips.
3. Install grommet (25) in hole in Tour-Pak.
4. Install antenna mast onto antenna base on the Tour-Pak.
5. Check antenna for proper operation.

To Remove Tour-Pak and Relocate Antenna

1. Remove the mast from the Tour-Pak.
2. See Figure 5. Remove the antenna cable (23) from the top of the antenna adapter (22).

3. Remove antenna adapter and save for installing the Tour-Pak.
4. Remove Tour-Pak, refer to Detachable Tour-Pak Rack instruction sheets for procedure.
5. Install antenna mast to the antenna mount joint assembly (24).
6. Check antenna for proper operation.

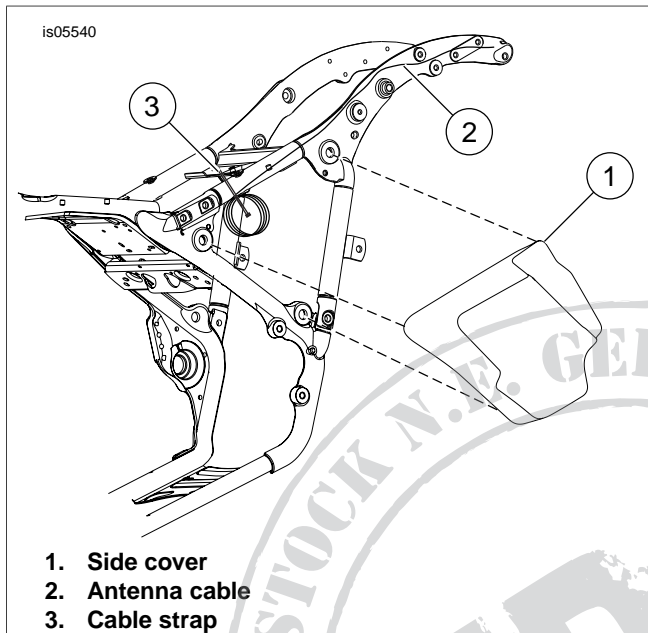

Figure 3. Side Cover and Antenna Cable Strap Location

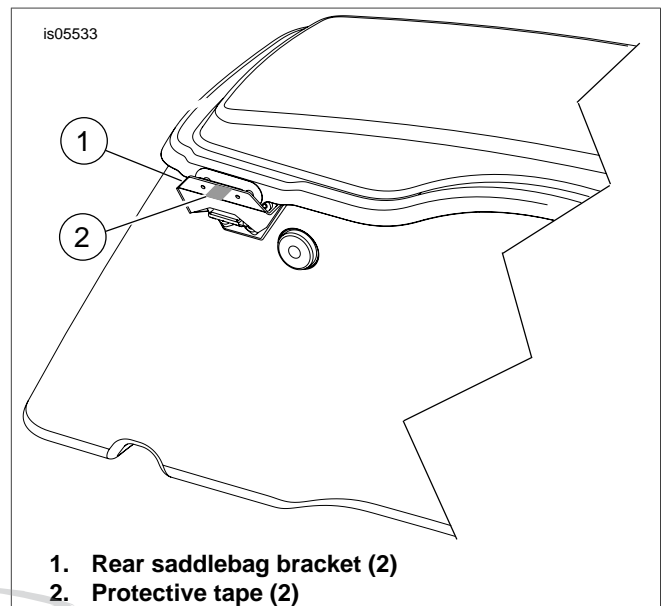

Figure 4. Apply Protective Tape

is05485

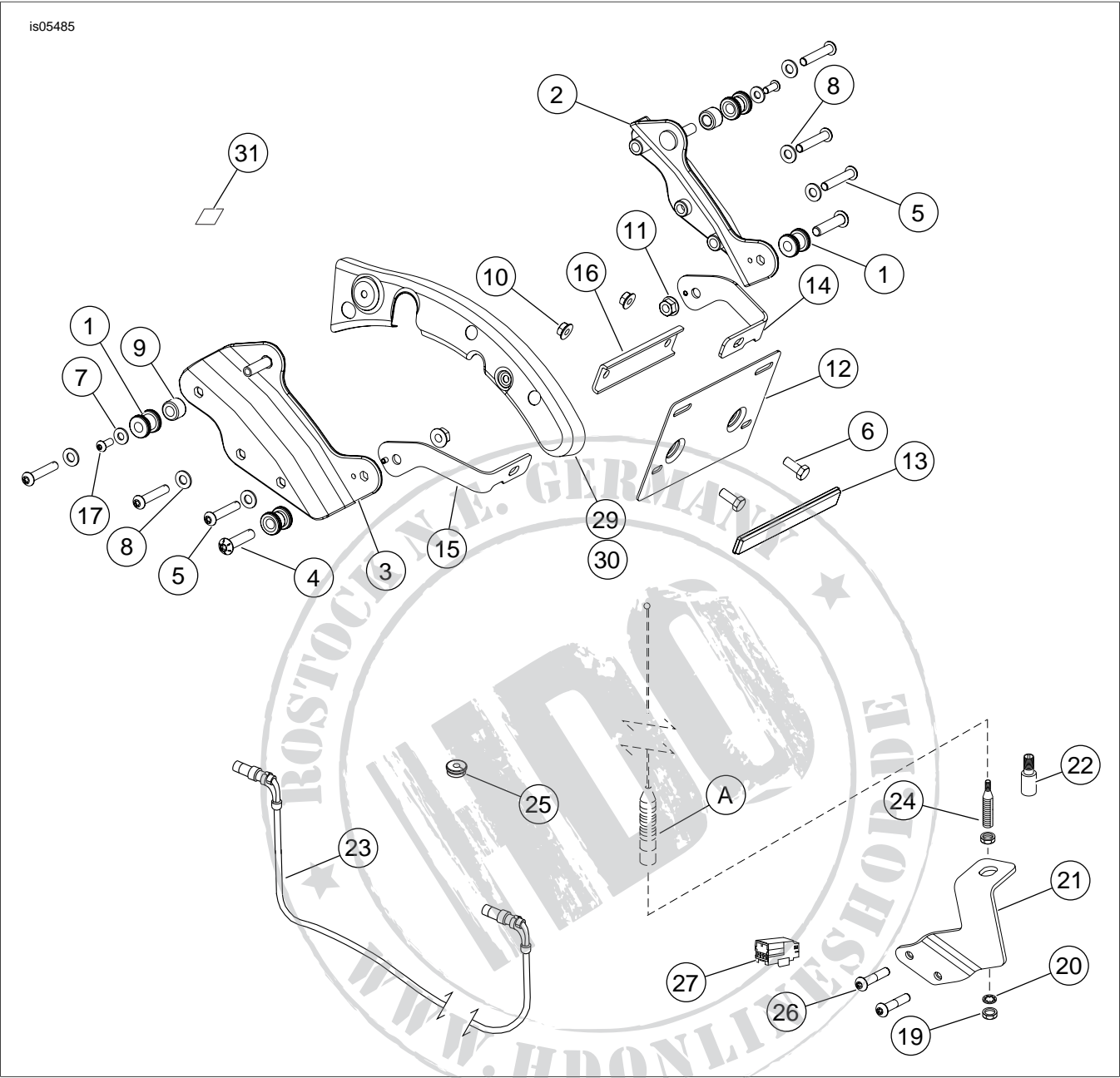

Figure 5. Service Parts: Detachable Tour-Pak Kit

Table 1. Service Parts Table

Item	Description (Quantity)	Part Number
License plate relocation kit (includes items 1 through 17 and item 31)		Not Sold Separately
1	Docking point (4)	53684-96A
2	Bracket, docking point, right	54208-09
3	Bracket, docking point, left	54209-09
4	Screw, TORX 0.375-16 x 1.625 inch (2)	3147
5	Screw, TORX 0.3125-18 x 1.75 inch (6)	4783
6	Screw, hex (2)	3987
7	Washer (2)	6339
8	Washer, plain (6)	6330

Table 1. Service Parts Table

Item	Description (Quantity)	Part Number
9	Spacers, docking point (2)	6946
10	Nut, flange (2)	7531
11	Nut, flange (2)	7601
12	License plate holder	53376-97
13	Reflector	59988-72A
14	Bracket, right	60911-09
15	Bracket, left	60912-09
16	Bracket, center	60913-09
17	Screw, TORX (2)	94592-98
18	Detachable Tour-Pak rack kit (not shown)	53276-09
19	Nut, hex 1/2-20 (2)	76353-00
20	Lockwasher, 1/2 inch	7129
21	Bracket, antenna mounting	76557-09
22	Adapter, antenna	76219-00
23	Cable, antenna	76229-00
24	Joint assembly, antenna mount	76354-00
25	Grommet	11486
26	Screw, TORX #10-24 (2)	2441
27	Connector housing	73103-96BK
28	Cable strap (4) (not shown)	10006
29	Frame cover, left	47502-09
30	Frame cover, right (not shown)	47504-09
31	Protective tape (2)	54233-09
Items mentioned in text, but not included in kit		
A	Antenna	