

7. Setting Guide

7.1 Printer overview

These are the main components of your machine:

7.1.1 Front view

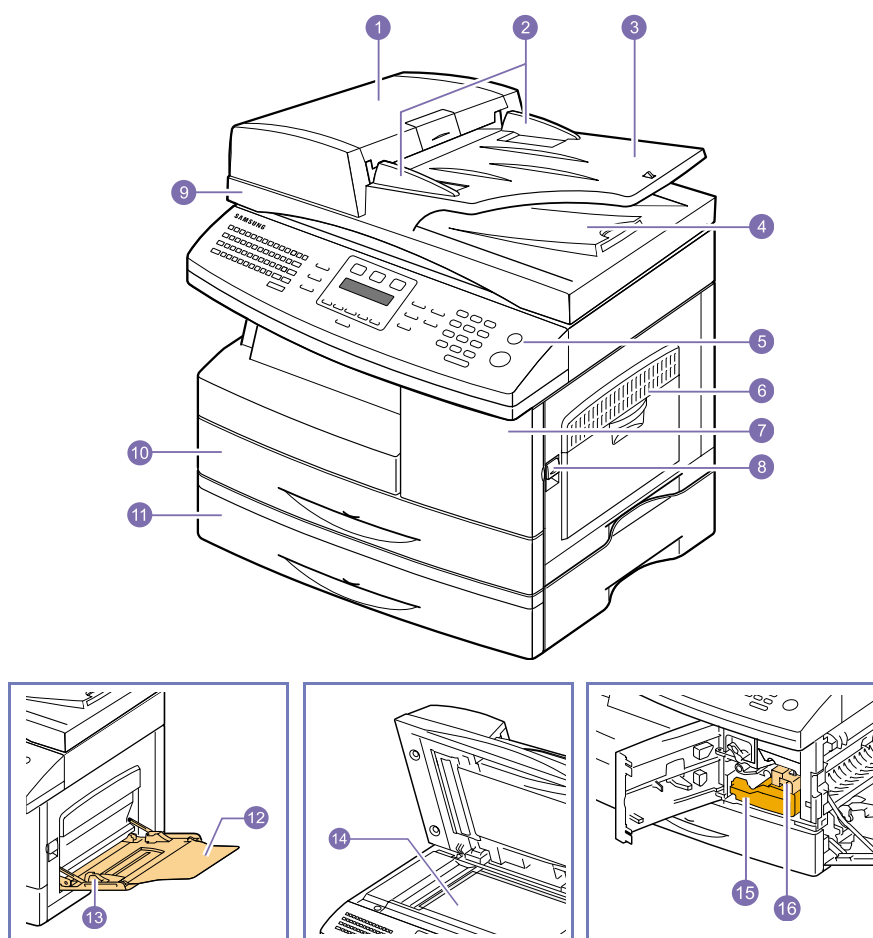

* The figure above shows an SCX-6322DN with all available accessories.

1	ADF (Automatic Document Feeder) ¹	9	scanner lid
2	document width guides	10	tray 1
3	document input tray	11	optional tray 2
4	document output tray	12	multi-purpose tray extension
5	control panel	13	multi-purpose tray paper width guides
6	multi-purpose tray	14	scanner glass
7	front cover	15	toner cartridge
8	release lever	16	drum cartridge

1. SCX-6122FN has the ADF function, while SCX-6322DN uses the duplex ADF function.

7.1.2 Rear view

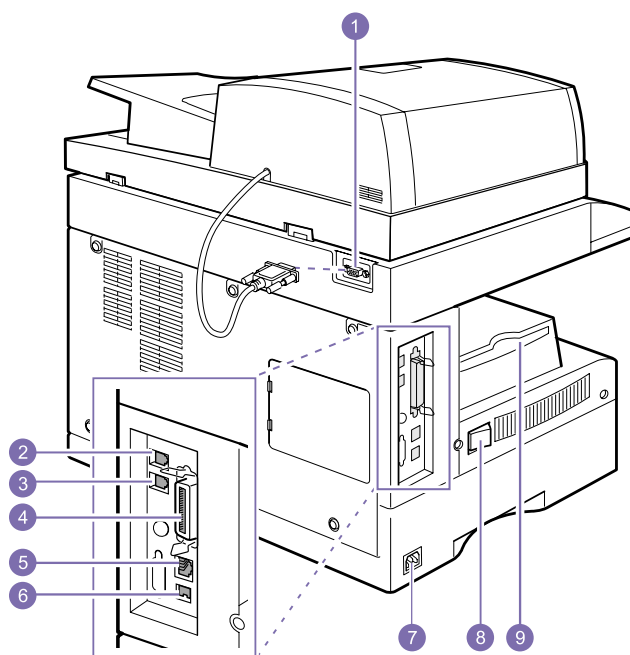

* The figure above shows an SCX-6322DN with all available accessories.

1	ADF connector
2	extension telephone socket (EXT)
3	telephone line socket (LINE)
4	parallel port
5	USB port

6	network port
7	power receptacle
8	power switch
9	output support

7.1.3 Control panel overview

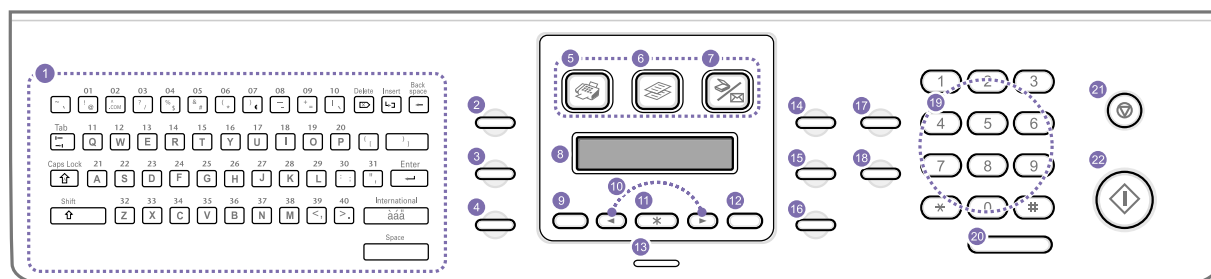

1	Keyboard: Used to enter characters. Used to store frequently dialed fax number and dial them with a touch of the buttons.	11	OK: Confirms the selection on the screen.
2	Address Book: Allows you to store frequently used fax numbers in memory or search for stored fax numbers or email addresses. Also allows you to print an Address Book/Phone Book list.	12	Back: Sends you back to the upper menu level.
3	Resolution: Adjusts the document resolution for the current fax job.	13	Status: Shows the status of your machine.
4	Redial/Pause: In Standby mode, redials the last number, or in Edit mode, inserts a pause into a fax number.	14	Darkness: Adjusts the document brightness for the current copy job.
5	Fax: Activates Fax mode.	15	Original Type: Selects the document type for the current copy job.
6	Copy: Activates Copy mode.	16	Reduce/Enlarge: Makes a copy smaller or larger than the original.
7	Scan/Email: Activates Scan mode.	17	Duplex: Allows you to print documents on both sides of the paper.
8	Display: Shows the current status and prompts during an operation.	18	Toner Save: Allows you to save on toner by using less toner in printing.
9	Menu: Enters Menu mode and scrolls through the available menus.	19	number keypad: dials a number or enters alphanumeric characters.
10	Scroll buttons: Scroll through the options available in the selected menu, and increase or decrease values.	20	On Hook Dial: Engages the telephone line.
		21	Stop/Clear: Stops an operation at any time. In Standby mode, clears/cancels the copy options, such as the darkness, the document type setting, the copy size, and the number of copies.
		22	Start: Starts a job.

7.2 Understanding the Status LED

The Status LED on the control panel shows the status of your machine.

See the table below to know your machine's status.

Status		Description
Off		<ul style="list-style-type: none"> • The machine is off-line. • The machine is in Power Save mode. When data is received, or any button is pressed, it switches to on-line automatically.
Green	On	The machine is on-line and can be used.
	Blinking	<ul style="list-style-type: none"> • When the backlight slowly blinks, the machine is receiving data from the computer. • When the backlight fast blinks, the machine is printing data.
Red	On	<ul style="list-style-type: none"> • The toner cartridge is totally exhausted. Remove the old toner cartridge and install a new one. • The drum cartridge is totally exhausted. Remove the old drum cartridge and install a new one. • A paper jam has occurred. To solve the problem. • The front cover is open. Close the front cover. • There is no paper in the tray. Load paper in the tray. • The toner cartridge installed is not a genuine cartridge, and you selected Stop at the NonGenuine Toner prompt. • The lifespan of the toner cartridge is reached, and you selected Stop at the Toner Exhausted prompt. • The machine has stopped due to a major error. Check the display message.
	Blinking	<ul style="list-style-type: none"> • A minor error occurs and the machine is waiting an error to be cleared. Check the display message. When the problem is cleared, the machine resumes. • The toner cartridge installed is not a genuine cartridge, and you selected Continue at the NonGenuine Toner prompt. • The lifespan of the toner cartridge is reached, and you selected Continue at the Toner Exhausted prompt. • The toner cartridge is low. Order a new toner cartridge. You can temporarily improve print quality by redistributing the toner.

7.3 Finding more information

You can find information for setting up and using your machine from the following resources, either printed or onscreen.

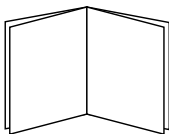
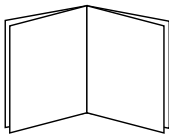
<p>Quick Install Guide</p> 	<p>Provides information on setting up your machine and, therefore, be sure to follow the instructions in the guide to get the machine ready.</p>
<p>Online User's Guide</p> 	<p>Provides you with step-by-step instructions for using your machine's full features, and contains information for maintaining your machine, troubleshooting, and installing accessories.</p> <p>This user's guide also contains the Software Section providing you with information on how to print documents with your machine on various operating systems, and how to use the supplied software utilities.</p> <p>Note : You can access the user's guides in other languages from the Manual folder on the printer software CD.</p>
<p>Network Printer User's Guide</p> 	<p>Contained on the network utilities CD, provides you with information on setting up and connecting your machine to a network.</p>
<p>Printer Driver Help</p>	<p>Provides you with help information on printer driver properties and instructions for setting up the properties for printing. To access a printer driver help screen, click Help from the printer properties dialog box.</p>
<p>Samsung website</p>	<p>If you have Internet access, you can get help, support, printer drivers, manuals, and order information from the Samsung website, www.samsungprinter.com.</p>

7.4 System setup

This chapter gives you an overview of menus available on your machine and step-by-step instructions for setting up the machine's systems.

This chapter includes:

- Menu overview
- Changing the display language
- Setting the date and time
- Changing the default mode
- Setting sounds
- Entering characters using the keyboard
- Entering characters using the number keypad
- Using the save modes
- Setting print job timeout

Menu overview

The control panel provides access to various menus to set up the machine or use the machine's functions. These menus can be accessed by pressing Menu. Refer to the following diagram. Menus available in Fax, Copy, or Scan mode vary.

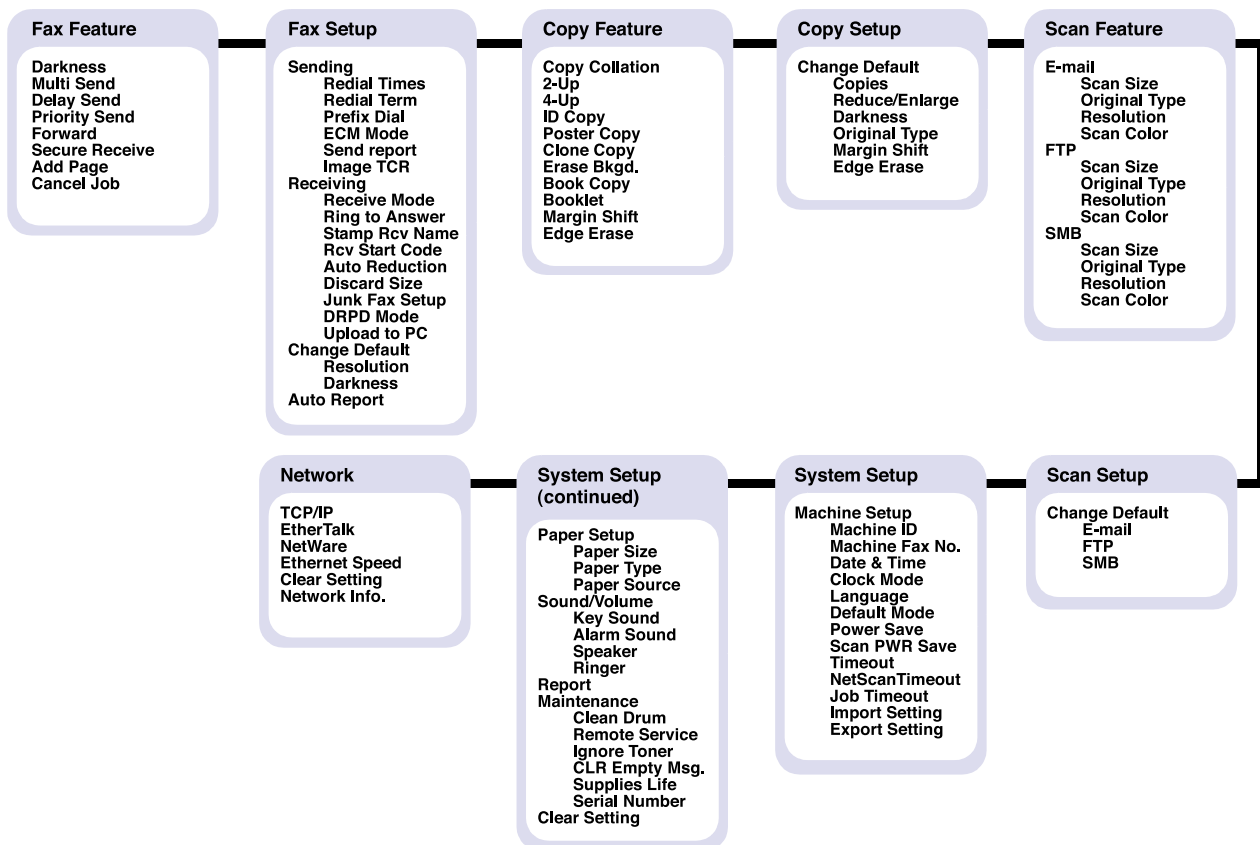

7.4.1 Changing the display language

To change the language that appears on the control panel, follow these steps:

1. Press Menu until System Setup appears on the bottom line of the display and press OK.
2. Press OK when Machine Setup appears.
3. Press the Scroll buttons until Language appears and press OK.
4. Press the Scroll buttons until the language you want appears and press OK.
5. Press Stop/Clear to return to Standby mode.

7.4.2 Setting the date and time

The current date and time are shown on the display when your machine is on and ready to work. All of your faxes will have the date and time printed on them.

1. Press Menu until System Setup appears on the bottom line of the display and press OK.
2. Press OK when Machine Setup appears.
3. Press the Scroll buttons until Date & Time appears and press OK.
4. Enter the correct time and date using the number keypad.

Month = 01 to 12

Day = 01 to 31

Year = requires four digits

Hour = 01 to 12 (12-hour mode)

00 to 23 (24-hour mode)

Minute = 00 to 59

You can also use the Scroll buttons to move the cursor under the digit you want to correct and enter a new number.

5. To select AM or PM for 12-hour format, press the or button * or # any number button.
When the cursor is not under the AM or PM indicator, pressing the * or # button immediately moves the cursor to the indicator.
You can change the clock mode to 24-hour format (e.g. 01:00 PM as 13:00). For details, see the next section.
6. Press OK to save the time and date.
When you enter a wrong number, Out of Range appears and the machine does not proceed to the next step. If this happens, simply reenter the correct number.
7. Press Stop/Clear to return to Standby mode.

Changing the clock mode

You can set your machine to display the current time using either a 12-hour or 24-hour format.

1. Press Menu until System Setup appears on the bottom line of the display and press OK.
2. Press OK when Machine Setup appears.
3. Press the Scroll buttons until Clock Mode appears and press OK.
4. Press the Scroll buttons to select the other mode and press OK.
5. Press Stop/Clear to return to Standby mode.

7.4.3 Changing the default mode

You can switch this default mode between Fax mode and Copy mode.

1. Press Menu until System Setup appears on the bottom line of the display and press OK.
2. Press OK when Machine Setup appears.
3. Press the Scroll buttons until Default Mode appears and press OK.
4. Press the Scroll buttons until the default mode you want appears and press OK.
5. Press Stop/Clear to return to Standby mode.

7.4.4 Setting sounds

You can control the following sounds:

- Key Sound: Turns the key sound on or off. With this option set to On, a tone sounds each time a key is pressed.
- Alarm Sound: Turns the alarm sound on or off. With this option set to On, an alarm tone sounds when an error occurs or fax communication ends.
- Speaker: Turns on or off the sounds from the telephone line through the speaker, such as a dial tone or a fax tone. With this option set to Comm. which means "Common," the speaker is on until the remote machine answers.
You can adjust the volume level using On Hook Dial.
- Ringer: Adjusts the ringer volume. For the ringer volume, you can select Off, Low, Mid, and High.

Speaker, ringer, key sound, and alarm sound

1. Press Menu until System Setup appears on the bottom line of the display and press OK.
2. Press the Scroll buttons until Sound/Volume appears and press OK.
3. Press the Scroll buttons until the sound option you want appears and press OK.
4. Press the Scroll buttons until the desired status or volume for the sound you have selected appears and press OK.
5. If necessary, repeat steps 3 through 5 to set other sounds.
6. Press Stop/Clear to return to Standby mode.

Speaker volume

1. Press On Hook Dial. A dial tone sounds from the speaker.
2. Press the Scroll buttons until you hear the volume you want.
3. Press On Hook Dial to save the change and return to Standby mode.

7.4.5 Entering characters using the keyboard

You can enter alphabet characters using the keyboard on the left side of the control panel. Especially this keyboard is arranged as like a normal keyboard for its better usability for user. In case of entering the machine ID or email addresses, it lets you enter letters easily.

Entering alphabet characters

You can enter the alphabet characters by just pressing the alphabet keys on the keyboard, as like a normal keyboard. To enter the uppercase characters, press Caps Lock button on the keyboard.

Entering numbers

You can enter the numbers by using the number keypad on the right side of the control panel.

Entering symbols

You can enter symbols by pressing the buttons on the upper part of the keyboard. To enter upper symbols on buttons, press and hold the Shift button and the symbol button simultaneously which you want to enter.

Entering international characters

You can enter the special multilingual characters using the international button.

1. Press the character button you want to enter.
2. Press the international button on the keyboard until the desired character you want displays.

Example: To enter Å, press A key first. And then, press the international button three times until Å character shows.

Refer to the table below for international character map.

Uppercase		Lowercase	
A	À, Á, Â, Ã, Ä, Å, Æ	a	à, á, â, ã, ä, å, æ
C	Ç	c	ç
E	È, É, Ê, Ë	e	è, é, ê, ë
I	Ì, Í, Î, Ï	i	ì, í, î, ï
N	Ñ	n	ñ
O	Ò, Ó, Ô, Õ, Ö, Ø, Æ, Ø	o	ò, ó, ô, õ, ö, ø, œ, ø
U	Ù, Ú, Û, Ü	u	ù, ú, û, ü
S	ß	s	ß
Y	›	y	”

7.4.6 Entering characters using the number keypad

As you perform various tasks, you may need to enter names and numbers. For example, when you set up your machine, you enter your name or your company's name, and the fax number.

Entering alphanumeric characters

1. When you are prompted to enter a letter, locate the button labeled with the character you want. Press the button until the correct letter appears on the display.

For example, to enter the letter O, press 6, labeled with MNO.

Each time you press 6, the display shows a different letter, M, N, O, and finally 6.

You can enter special characters, such as space, plus sign, and etc.

For details, see the below section.

2. To enter additional letters, repeat step 1.

If the next letter is printed on the same button, move the cursor by pressing the right Scroll button and then press the button labeled with the letter you want. The cursor will move to the right and the next letter will appear on the display.

You can enter a space by pressing 1 twice.

3. When you have finished entering letters, press OK.

Keypad letters and numbers

Key	Assigned numbers, letters, or characters
1	1 Space
2	A B C 2
3	D E F 3
4	G H I 4
5	J K L 5
6	M N O 6
7	P Q R S 7
8	T U V 8
9	W X Y Z 9
0	+ - , . ' / * # & @ 0

Correcting numbers or names

If you make a mistake while entering a number or name, press the left Scroll button to delete the last digit or character. Then enter the correct number or character.

Inserting a pause

With some telephone systems, you must dial an access code (9, for example) and listen for a second dial tone. In such cases, you must insert a pause in the telephone number. You can insert a pause while you are setting up one-touch dial numbers or speed dial numbers.

To insert a pause, press Redial/Pause at the appropriate place while entering the telephone number. A - appears on the display at the corresponding location.

7.4.7 Using the save modes

Toner Save mode

Toner Save mode allows your machine to use less toner on each page.

Activating this mode extends the life of the toner cartridge beyond what one would experience in the normal mode, but it reduces print quality.

To turn this mode on or off, press Toner Save.

Power Save mode

Power Save mode allows your machine to reduce power consumption when it is not in actual use. You can turn this mode on and select a length of time for which the machine waits after a job is printed before it switches to a reduced power state.

1. Press Menu until System Setup appears on the bottom line of the display and press OK.
2. Press OK when Machine Setup appears.
3. Press the Scroll buttons until Power Save appears and press OK.
4. Press the Scroll buttons until On appears and press OK.
5. Press the Scroll buttons until the time setting you want appears and press OK.
6. Press Stop/Clear to return to Standby mode.

Scan Power Save mode

Scan Power Save mode allows you to save power by turning off the scan lamp. The scan lamp under the scanner glass automatically turns off when it is not in actual use to reduce power consumption and extend the life of the lamp. The lamp automatically wakes up after some warm-up time when you start scanning.

You can set the length of time for which the scan lamp waits after a scan job is completed before it switches to the power save mode.

1. Press Menu until System Setup appears on the bottom line of the display and press OK.
2. Press OK when Machine Setup appears.
3. Press the Scroll buttons until Scan PWR Save appears and press OK.
4. Press the Scroll buttons until the time setting you want appears and press OK.
5. Press Stop/Clear to return to Standby mode.

7.4.8 Setting print job timeout

You can set the amount of time a single print job is active before it must print.

The machine handles incoming data as a single job if it comes in within the specified time. When an error occurs while processing data from the computer and the data flow stops, the machine waits the specified time and then cancels printing if data flow does not resume.

1. Press Menu until System Setup appears on the bottom line of the display and press OK.
2. Press OK when Machine Setup appears.
3. Press the Scroll buttons until Job Timeout appears and press OK.
4. Press the Scroll buttons until the time setting you want appears and press OK.
5. Press Stop/Clear to return to Standby mode.

7.5 Network setup

7.5.1 Supported operating systems

The following table shows the network environments supported by the machine:

Item	Requirements
Network interface	10/100 Base-TX
Network operating system	Novell NetWare 4.x, 5.x, 6.x Windows 98/Me/NT 4.0/2000/XP/2003 Various Linux OS Macintosh OS 10.3 ~ 10.4
Network protocols	NetWare IPX/SPX TCP/IP EtherTalk
Dynamic addressing server	DHCP, BOOTP

- IPX/SPX: Internet Packet eXchange/Sequenced Packet eXchange
- TCP/IP: Transmission Control Protocol/Internet Protocol
- DHCP: Dynamic Host Configuration Protocol
- BOOTP: Bootstrap Protocol

7.5.2 Configuring TCP/IP

Your machine can be set up with a variety of TCP/IP network information, such as an IP address, a subnet mask, a gateway, and DNS addresses.

There are several ways in which your machine can be assigned a TCP/IP address, depending on your network.

- Static addressing: A TCP/IP address is assigned manually by the system administrator.
- Dynamic addressing via BOOTP/DHCP (default): A TCP/IP address is assigned automatically by the server.

Static addressing

To enter a TCP/IP address from your machine's control panel, take the following steps:

1. Press Menu until Network appears on the bottom line of the display and press OK.
2. Press OK when TCP/IP appears.
3. Press the Scroll buttons until Static appears and press OK.
4. Press OK when IP Address appears.
5. Enter a byte between 0 and 255 using the number keypad and press the Scroll buttons to move between bytes.
Repeat this to complete the address from the 1st byte to the 4th byte.
6. When you have finished, press OK.
7. Repeat steps 5 and 6 to configure the other TCP/IP parameters:
subnet mask and gateway address.
8. Press the Scroll buttons until Primary DNS appears and press OK.
9. Enter each byte of the address and press OK.
10. Press the Scroll buttons until Secondary DNS appears and press OK.
11. Enter each byte of the address and press OK.
12. Press Stop/Clear to return to Standby mode.

Dynamic addressing (BOOTP/DHCP)

To have a TCP/IP address assigned automatically by the server, take the following steps:

1. Press Menu until Network appears on the bottom line of the display.
2. Press OK when TCP/IP appears.
3. Press the Scroll buttons until DHCP or BOOTP appears and press OK.
4. Press Stop/Clear to return to Standby mode.

7.5.3 Configuring EtherTalk

EtherTalk is AppleTalk used in an Ethernet network. This protocol is widely used in Macintosh network environments. To use EtherTalk, take the following steps:

1. Press Menu until Network appears on the bottom line of the display and press OK.
 2. Press the Scroll buttons until EtherTalk appears and press OK.
 3. Press the Scroll buttons until On appears and press OK.
 4. Press Stop/Clear to return to Standby mode.
- Restart your machine to apply new settings.

7.5.4 Configuring IPX frame types

To use IPX/SPX protocol networks (for example, Novell NetWare), the format of the network communication frames must be specified for the machine. In most cases, you can keep the Auto setting. However, you can manually set the frame type format, if required. Take the following steps to change the frame type format:

1. Press Menu until Network on the bottom line of the display and press OK.
 2. Press the Scroll buttons until NetWare appears and press OK.
 3. Press the Scroll buttons until the desired frame type appears.
 - Auto: Automatically senses and limits the frame type to the first one detected.
 - 802.2: Limits the frame type to IPX over IEEE 802.2 with IEEE 802.3 frames. All others will be discarded.
 - 802.3: Limits the frame type to IPX over IEEE 802.3 frames. All others will be discarded.
 - Ethernet II: Limits the frame type to IPX over Ethernet Frames. All others will be discarded.
 - SNAP: Limits the frame type to IPX over SNAP with IEEE 802.3 frames. All others will be discarded.
 - Off: The IPX/SPX protocol is disabled.
 4. Press OK to save the selection.
 5. Press Stop/Clear to return to Standby mode.
- Restart your machine to apply new settings.

7.5.5 Setting Ethernet speed

You can select the communication speed for Ethernet connections.

1. Press Menu until Network appears on the bottom line of the display and press OK.
 2. Press the Scroll buttons until Ethernet Speed appears and press OK.
 3. Press the Scroll buttons until the speed you want appears and press OK.
 4. Press Stop/Clear to return to Standby mode.
- Restart your machine to apply new settings.

7.5.6 Restoring the network configuration

You can return the network configuration to its default settings.

1. Press Menu until Network appears on the bottom line of the display and press OK.
2. Press the Scroll buttons until Clear Setting appears and press OK.
3. Press OK when Yes appears to restore the network configuration.
4. Power the machine off and back on.

7.5.7 Printing a network configuration page

The Network Configuration page shows how the network interface card on your machine is configured.

1. Press Menu until Network appears on the bottom line of the display and press OK.
2. Press the Scroll buttons until Network Info. appears and press OK.
3. Press OK when Yes appears.

The Network Configuration page prints out.