



Advanced Innovative Machinery

Installation Instructions

AIM PERFORMANCE PRODUCTS

Parts#MB001-002

•Reverse Gear MAMBA (Monoblock for Hydraulic operated)

For '07 and later Big Twin models (including '06 Dyna)

Read and become familiar with these installation instructions before start.

Monoblock for Hydraulic operated (Parts#MB001-002)

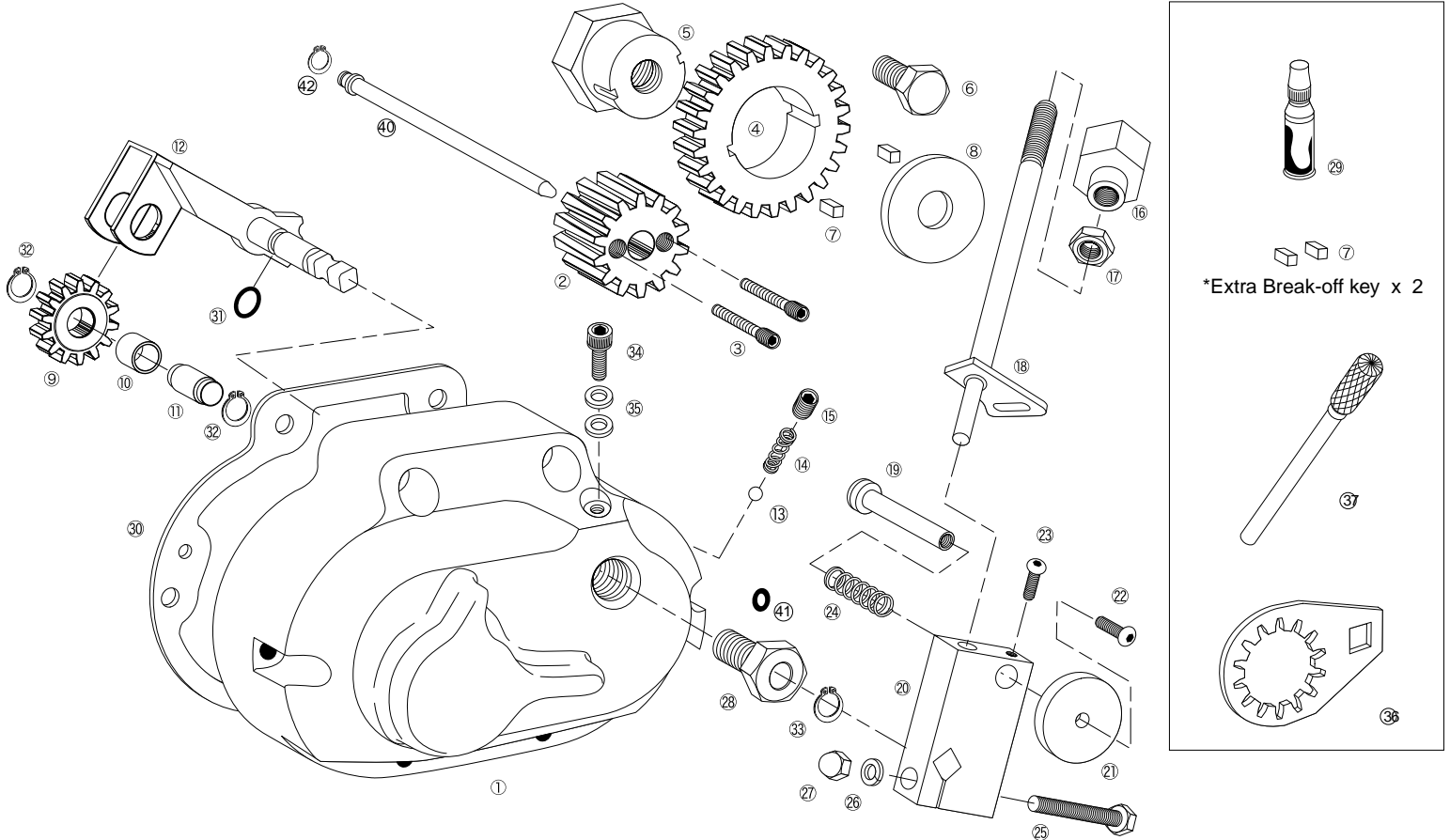

*Extra Break-off key x 2

Parts#	Name	Q
① PMB001-039	Gear housing	1
② PMB001-002	Main gear	1
③ PMB001-003	Lock pin screw	2
④ PMB001-004	Counter gear	1
⑤ PMB001-005	Counter nut	1
⑥ PMB001-006	Bolt M10x10	1
⑦ PMB001-007	Break-off key	4
⑧ PMB001-008	Washer 10mm x 32mm	1
⑨ PMB001-009	Idler gear	1
⑩ PMB001-010	Idler bushing	1
⑪ PMB001-011	Idler pin	1
⑫ PMB001-012	Reverse shifter	1
⑬ PMB001-013	Ball bearing 8mm	1
⑭ PMB001-014	Detent spring	1
⑮ PMB001-015	Detent set screw	1
⑯ PMB001-016	Shift knob	1
⑰ PMB001-017	Nut 10mm	1
⑱ PMB001-018	Shift lever	1
⑲ PMB001-019	Shift lock pin	1
⑳ PMB001-020	Shift body	1

Parts#	Name	Q
㉑ PMB001-021	Shift disc	1
㉒ PMB001-022	Bolt M6x10	1
㉓ PMB001-023	Bolt M5x15	1
㉔ PMB001-024	Spring	1
㉕ PMB001-025	Bolt M8x45	1
㉖ PMB001-026	Spring washer M8	1
㉗ PMB001-027	Nut M8	1
㉘ PMB001-028	Shifter bush bolt	1
㉙ PMB001-029	LockTite #620(Green)	1
㉚ PMB001-030	Gasket	1
㉛ PMB001-031	O-ring	1
㉜ PMB001-032	Retaining ring	2
㉝ PMB001-033	Retaining ring(Stainless)	1
㉞ PMB001-034	Cap screw M6x10	1
㉟ PMB001-035	Washer	2
㊱ PMB001-089	Plate wrench	1
㊲ PMB001-078	5mm burr	1
㊳ PMB001-040	Clutch push rod	1
㊴ PMB001-041	O-ring	1
㊵ PMB001-042	Retaining ring	1



Advanced Innovational Machinery

Installation Instructions 1/3

AIM PERFORMANCE PRODUCTS

Parts#MB001-002

•Reverse Gear MAMBA (Monoblock for Hydraulic operated)

For '07 and later Big Twin models (including '06 Dyna)

Read and become familiar with these installation instructions before start.

⚠ WARNING!!

To prevent accidental vehicle start-up, which could cause serious injury, disconnect negative(-) battery cable before proceeding. Always wear proper eye protection to protect your eyes.

Note

Touring models: '09-'10 models are not required pipe modifications. Other years require the True dual pipe(Parts#MB004-003) or changing full exhaust system due to clearance issue.

Softail, Dyna models and some aftermarket exhaust pipes: May be required pipe modifications or changing exhaust pipe due to clearance issue.

1. Drain the transmission oil. Remove exhaust pipe if it is necessary.
2. Remove the Rightside transmission side cover and oil slinger assembly.
3. Remove two nuts from the mainshaft and countershaft.
4. Clean threads of mainshaft and countershaft using a parts cleaner to remove oil. Apply plenty of the supplied LockTite# 620 (Green)Ⓣ to thread of mainshaft.

5. **Caution**

Do not use impact wrench (Power tool) to tighten the main gear which causes breaking mainshaft.

Note

To prevent rotating mainshaft during tightening main gear. Shift into 1st gear and apply rear brake.

See Figure 1. Tighten the main gear to 80ft-lbs (109Nm) using the supplied plate wrench Ⓞ.

6. **Caution**

Use Regular Drill which is less than 3000rpm. Do not use high speed air grinder and push the supplied 5mm bur very hard which causes breaking the bur.

Caution

Do not grind more than 0.945" (24mm) depth which causes damaging bearing inner race and bur.

See Figure 2. Using the drill and supplied 5mm bur Ⓡ, grind the mainshaft straight (This is for Lock pin) to the depth of 0.945"(24mm) from the main gear surface through two holes of the main gear.

7. Completely clean the drilled holes. Use care to ensure debris does not enter transmission.
8. See Figure 3. Do not apply any LockTite to lock pin screw . Install Lock pin screws into the main gear. Tighten the lock pin screw to 8 ft-lbs.
9. See Figure 4. Clean thread of the counter nut using parts cleaner to remove oil. Apply plenty of the supplied LockTite#620 (Green)Ⓣ to thread of countershaft.

Figure 1

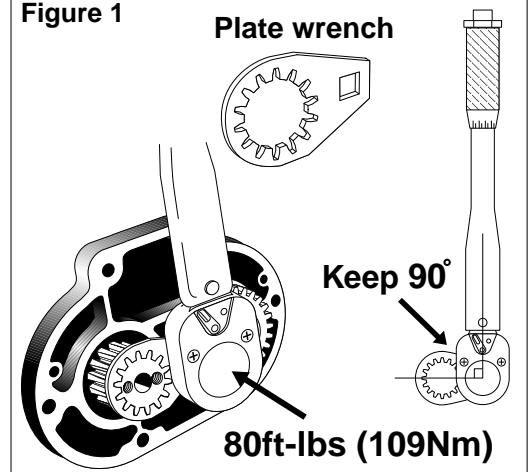
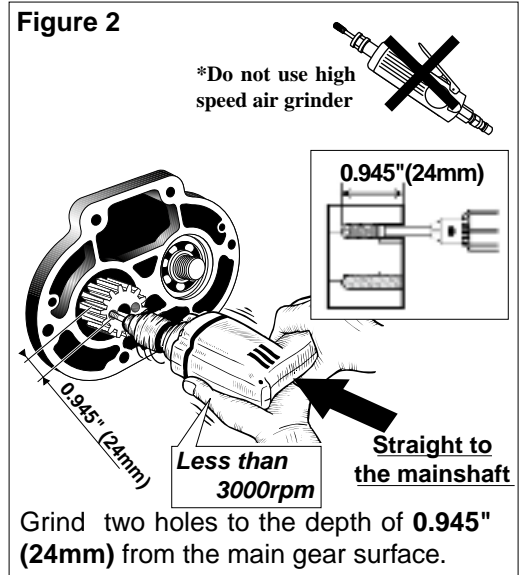

Figure 2





Advanced Innovative Machinery

AIM PERFORMANCE PRODUCTS

Parts#MB001-002

•Reverse Gear MAMBA (Monoblock for Hydraulic clutch operated)

For '07 and later Big Twin models (including '06 Dyna)

Installation Instructions 2/3

10. Caution
Do not use impact wrench (Power tool) to tighten the counter nut which causes breaking countershaft.

Note

To prevent rotating countershaft during tightening main gear. Shift into 1st gear and apply rear brake.

Tighten the counter nut to **80ft-lbs (109Nm)** using the 32mm socket.

11. Apply grease between the counter nut and counter gear. Install the counter gear on to the counter nut.

12. See Figure 5. Align key grooves on the counter nut and counter gear. Install two break-off keys into the grooves.

13. Note
 To prevent rotating countershaft during tightening main gear. Shift into 1st gear and apply rear brake.

See Figure 6. Apply LockTite#271 (Red) to the thread of bolt . Install bolt with the washer to the counter nut. Tighten the bolt to **56ft-lbs (75Nm)**.

14. Remove Hydraulic piston from the stock side cover.

15. Caution
 Be sure to install oil seals correctly. Do not pinch oil seals.

See Figure 7. Check oil seals are correctly seated piston grooves. Apply silicon grease slightly to both Hydraulic piston and bore. Install Hydraulic piston to Reverse gear housing.

16. Caution
 Be sure to get Hydraulic clutch line into the thread of Reverse gear housing correctly by hand untill hand tight.

See Figure 8. Install the O-ring in the kit. **Start with hand only** untill hand tight to connect hydraulic clutch line then use tool to tighten it in order to avoid cross threaded.

17. Install the side cover gasket and Reverse gear housing using stock bolts. Tighten the bolts to **9ft-lbs (12Nm)**.

18. Remove the derby cover. Remove clutch push rod retainer plate assembly.

20. See Figure 9. Remove retaining ring and clutch push rod from retainer plate.

21. Install clutch push rod in the kit to retainer plate. Install Retaining ring in the kit to push rod.

22. Install clutch push rod retainer plate assembly to clutch. Install retainer plate retaining ring.

23. Install derby cover.

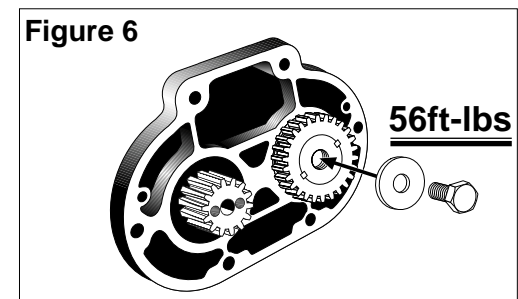
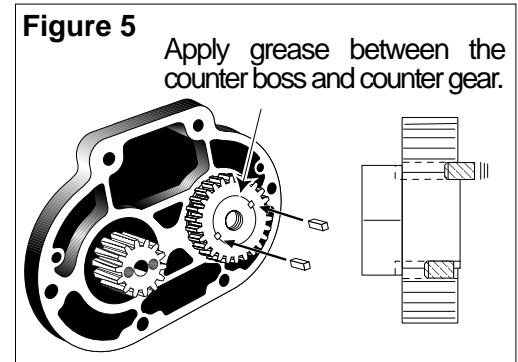
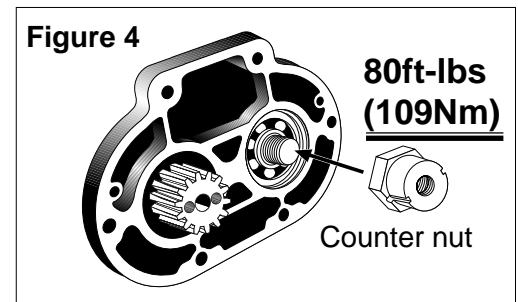
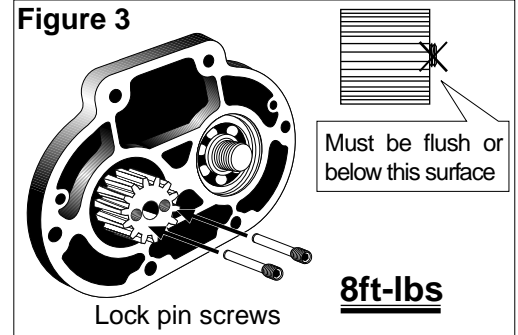



Advanced Innovative Machinery

Installation Instructions 3/3

AIM PERFORMANCE PRODUCTS

Parts#MB001-002

•Reverse Gear MAMBA (Monoblock for Hydraulic clutch operated)

For '07 and later Big Twin models (including '06 Dyna)

24. Breed clutch fluid line. See Harley-Davidson service manual.
25. Fill the transmission with transmission lubricant. See Harley-Davidson service manual.
26. Install the exhaust pipe if it is necessary.
27. Connect the battery.

Warranty

One year warranty on Reverse Gear parts only.

Figure 7

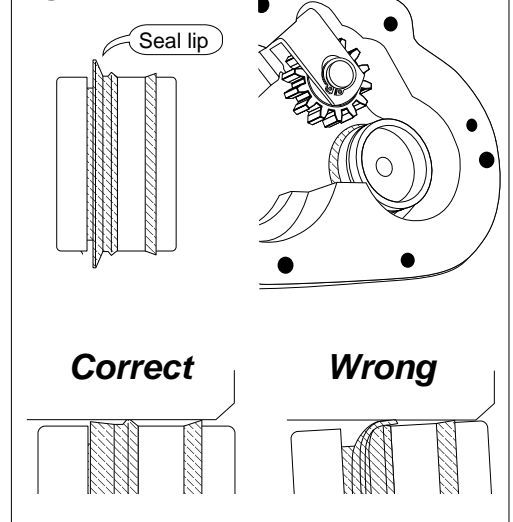

Figure 8

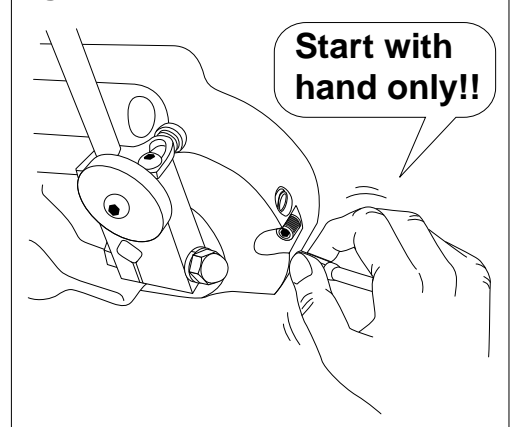

Figure 9





Advanced Innovative Machinery

Reverse gear operation

AIM PERFORMANCE PRODUCTS

Parts#MB001-001

• Reverse Gear MAMBA (Monoblock for cable)
For '07 and later Big Twin models (including '06 Dyna)

Reverse gear operation

To engage reverse gear:

⚠ WARNING

- Do not shift into the reverse gear before shift into 1st gear to stop spinning all gears in the transmission.
- Use reverse gear in Neutral. Transmission must be in Neutral when engaging or using reverse gear.
- Reverse gear is intended for light duty use only.

Failure to do so may result in breaking brake-off keys, damaged transmission or serious injury.

Note

No throttle, just release (engine idle speed) the clutch lever until you are accustomed with motorcycle going reverse.



Disengage the clutch. Shift into the 1st gear to stop spinning all gears in the transmission to prevent damaged transmission when put into the reverse gear.

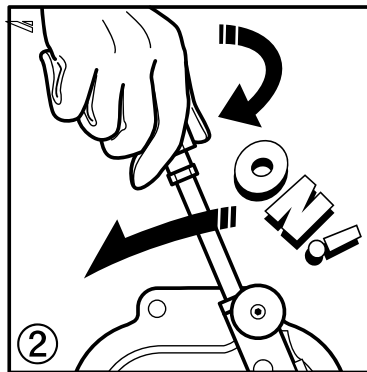

Twist the reverse handle (clockwise) and pull is back to shift into reverse gear. **Do not engage the clutch at this time.**

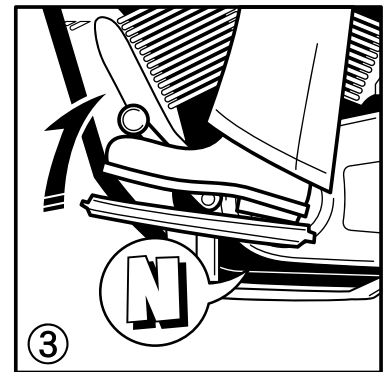

Shift transmission into Neutral. Engage the clutch to reverse motorcycle.

To disengage reverse gear:

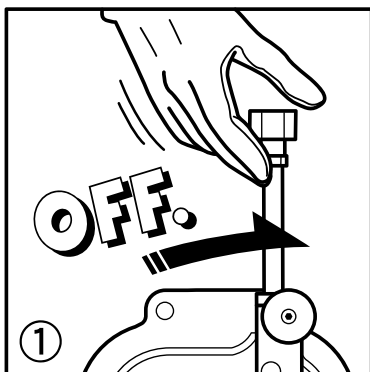

⚠ WARNING

Disengage the reverse gear before engaging any forward gears. Failure to do so may result in breaking brake-off keys, damaged transmission or serious injury.

Shift the reverse lever twist and forward to disengage reverse gear.



Advanced Innovative Machinery

Supplement

•Reverse Gear MAMBA (All models)

Read and become familiar with these installation instructions before start.

Break-off key replacement

There are two break-off keys between the counter nut and gear. These keys will break when excessive load was applied to save more expensive gears than break-off keys.

There are two of extra keys in the kit. If you break all keys in the kit. Please purchase new Break-off keys (Parts#PMB001-007).

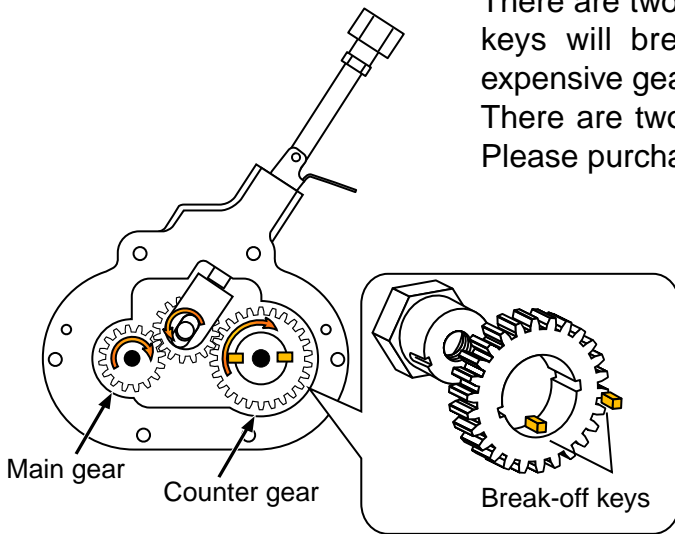

Excessive load!!

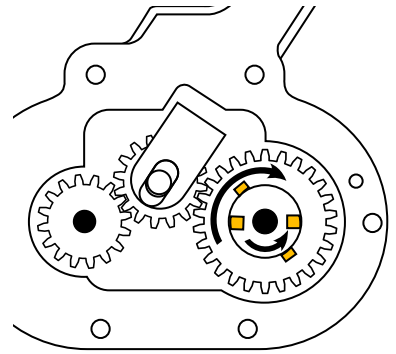
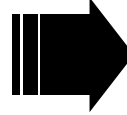

True Dual Pipe

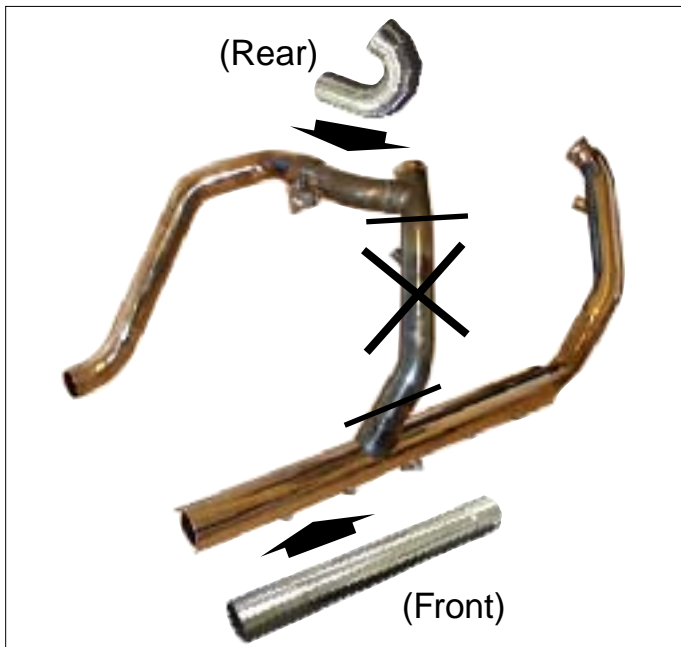

True Dual Pipe

For '87-'08 Touring model's stock exhaust pipe

- Eliminate cross over pipe to clear our Reverse gear kit for Touring models
- O2 sensor fitting for '07-'08 models
- Kit comes with O2 sensor plug for '87-'06 models

Parts#MB004-003 \$225.00



Advanced Innovative Machinery

AIM Corp.
16631 Gemini Lane
Huntington Beach, CA 92647
Phone: 714-848-3030 Fax: 714-848-3031

E-mail: info@aim-tamachi.com

www.aim-tamachi.com