

SERVICE MANUAL

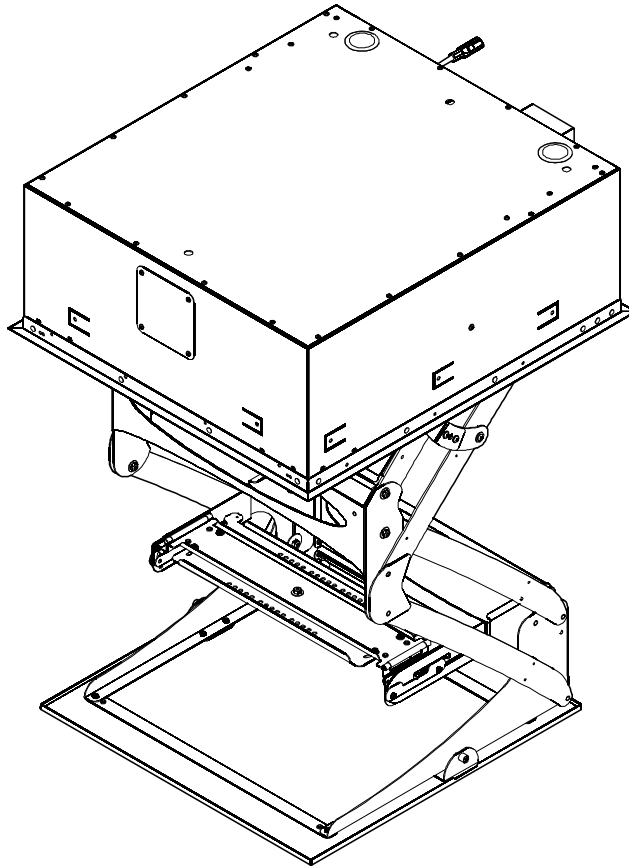

Lift Weldment Replacement

DISCLAIMER

Milestone AV Technologies and its affiliated corporations and subsidiaries (collectively "Milestone"), intend to make this manual accurate and complete. However, Milestone makes no claim that the information contained herein covers all details, conditions or variations, nor does it provide for every possible contingency in connection with the installation or use of this product. The information contained in this document is subject to change without notice or obligation of any kind. Milestone makes no representation of warranty, expressed or implied, regarding the information contained herein. Milestone assumes no responsibility for accuracy, completeness or sufficiency of the information contained in this document.

Chief® is a registered trademark of Milestone AV Technologies. All rights reserved.

! IMPORTANT SAFETY INSTRUCTIONS

! WARNING: A WARNING alerts you to the possibility of serious injury or death if you do not follow the instructions.

! CAUTION: A CAUTION alerts you to the possibility of damage or destruction of equipment if you do not follow the corresponding instructions.

! WARNING: Failure to read, thoroughly understand, and follow all instructions can result in serious personal injury, damage to equipment, or voiding of factory warranty! It is the installer's responsibility to make sure all components are properly assembled and installed using the instructions provided.

! WARNING: Use this mounting system only for its intended use as described in these instructions. Do not use attachments not recommended by the manufacturer.

! WARNING: Never operate this mounting system if it is damaged. Return the mounting system to a service center for examination and repair.

! WARNING: Do not use this product outdoors.

--SAVE THESE INSTRUCTIONS--

TOOLS FOR INSTALLATION / PARTS

- 2 to 3 ft pry bar
 - Permanent marker
 - Loctite

3/8"
 7/16"
 1/2"

A (1)
 [Lift weldment assembly - Right]

OR

A (1)
 [Lift weldment assembly - Left]

B (1)
 1/8"

K (2)
 [Lube grease]

C (4)
 .64 x 1.0 x .08

D (2)
 [Spacer]

E (4)
 .75 x .260 x .048

F (5)
 1/4-20

G (3)
 8-32 x 5/16"

H (6)
 10-24 x 3/16"

J (1)
 10-24 x 1/2"

***NOTE: The appearance of these parts may vary from the parts being removed during service due to Chief's program of continuous improvement.**

REMOVING LIFT WELDMENT ASSEMBLY

1. Fully lower SL236, if possible.
2. Turn off and remove power from SL236.
3. Remove projector from SL236 following instructions included with the SL236.
4. Remove signal and power cables from projector.
5. Remove projector cradle by removing four locking nuts (two on each side) and additional washers and spacers. (See Figure 1)

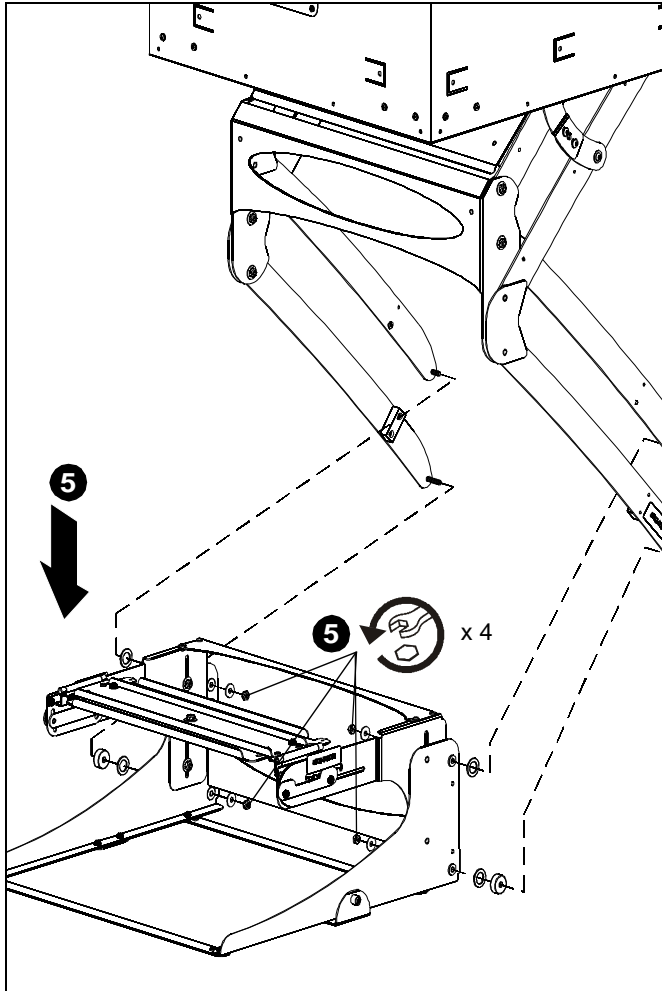

Figure 1

6. Remove six screws (three on each side) from sway panel and remove sway panel connecting the left and right side lifting arms. (See Figure 2)

IMPORTANT ! : Make note of which end of the sway panel is installed toward front of the lift and which end goes toward back of the lift.

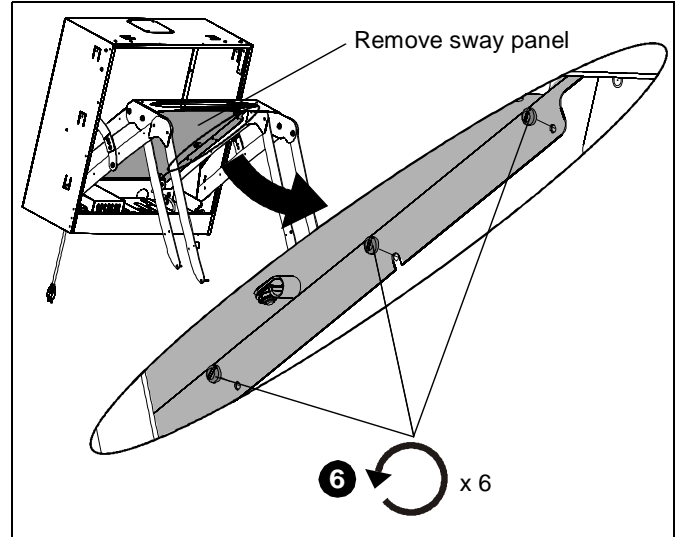

Figure 2

7. Remove three screws from top of affected side of lift. (See Figure 3)

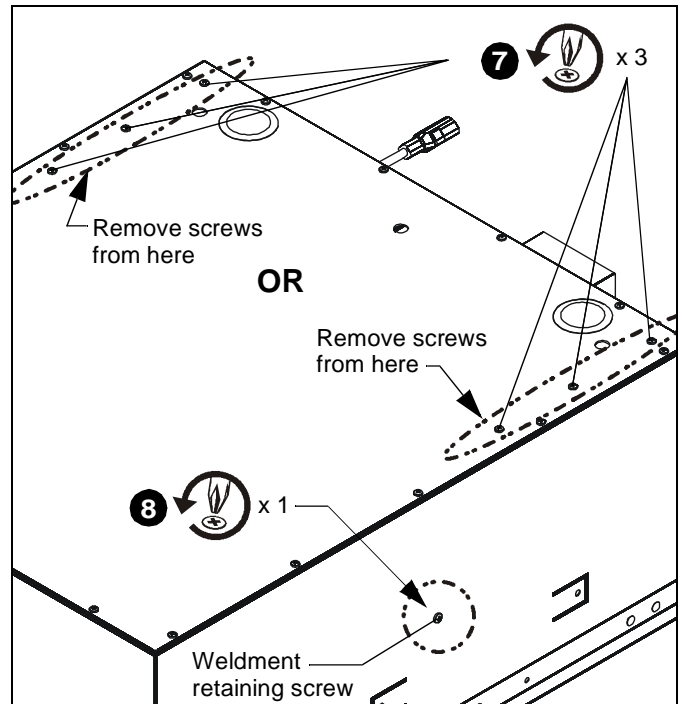

Figure 3

8. Remove one weldment retaining screw from outside center of affected side of lift. (See Figure 3)

9. Attach 18ga tie wire or something of equivalent strength to the joist mounting tabs on the SL236.
10. Connect these wires to the front of hinge assembly. (See Figure 4)

IMPORTANT ! : Wires should be connected in minimum of two places to prevent the hinge assembly from dropping.

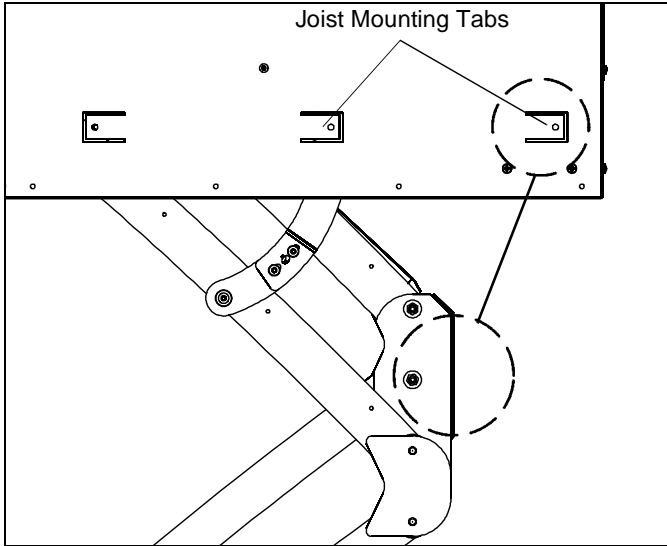

Figure 4

11. Remove one locknut from top of lifting link, and swing the lifting link out of the way. (See Figure 5)

NOTE: As soon as the lifting link is moved, that side of lift will shift, placing weight of mechanism on wire ties installed in Steps 9 and 10.

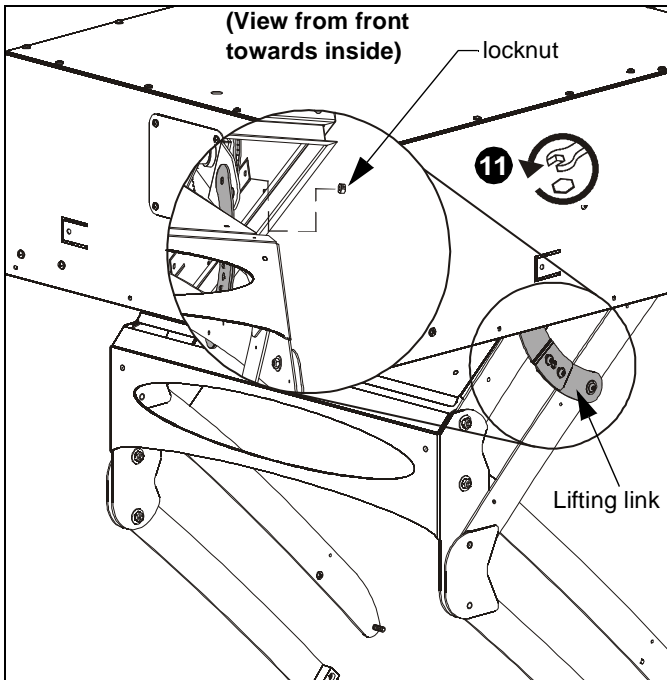

Figure 5

12. Mark relationship between chain and sprocket. (See Figure 6)

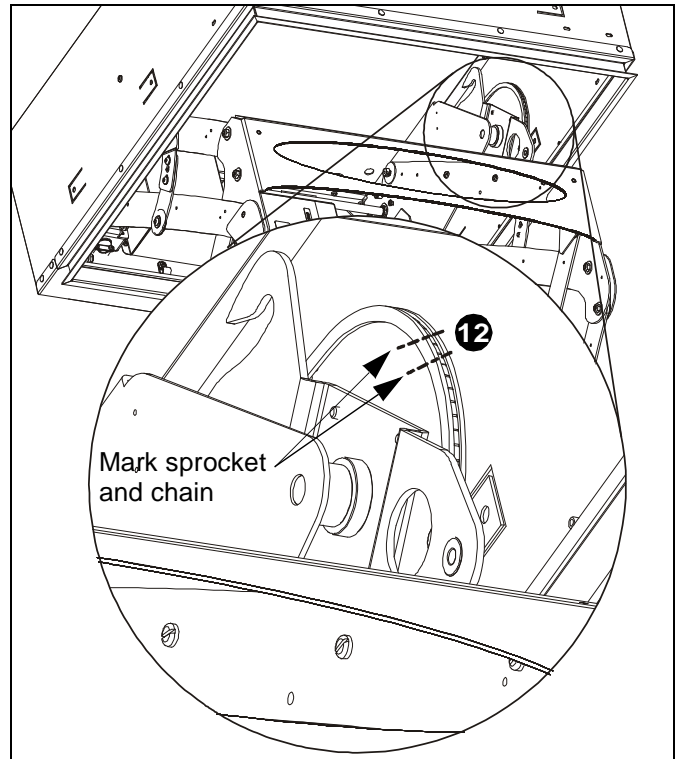

Figure 6

13. Loosen rear nut and move lower in slot to loosen chain tensioner in preparation for removal of lift weldment assembly. (See Figure 7)

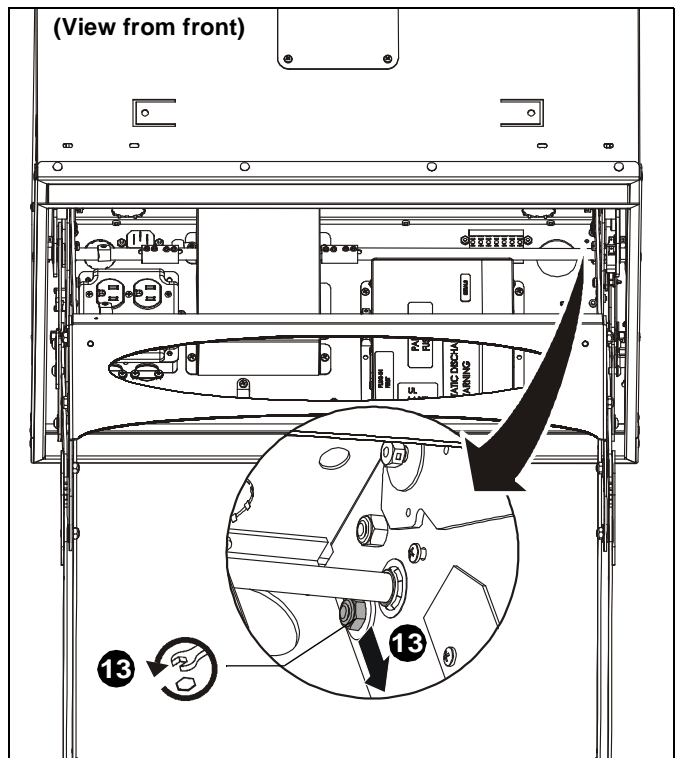

Figure 7

14. Insert pry bar behind main frame side panel (shown as gray). (See Figure 8)

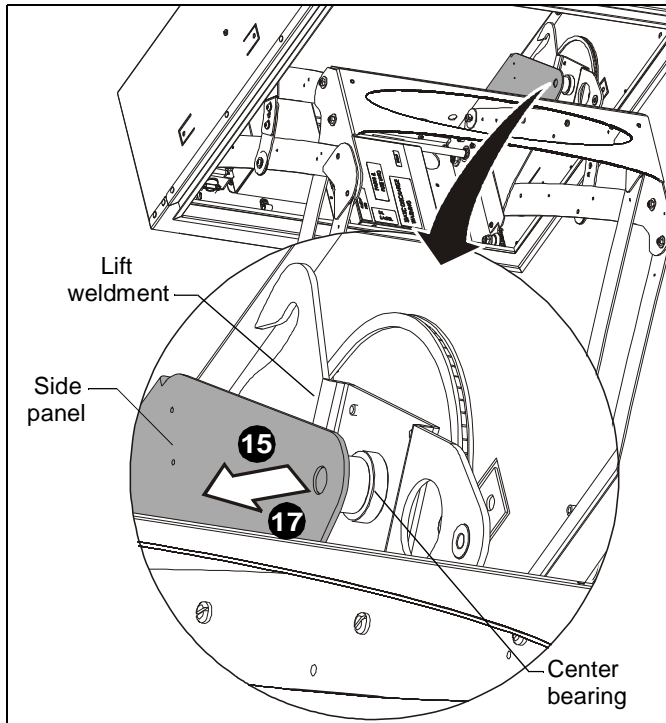

Figure 8

15. Pry side panel towards center of lift, far enough for attached shaft to come all the way out of center bearing on lift weldment. (See Figure 8)
16. After shaft is free from center bearing, move lift weldment towards back of lift and remove chain from large sprocket.

IMPORTANT ! : Be sure that chain does NOT come off small sprocket at rear of lift. If chain comes off small sprocket, the lift will need to be removed from ceiling and partially disassembled to reinstall chain.

17. Use pry bar to move side panel far enough to allow lift weldment to slide out towards front of lift. (See Figure 8)
18. Remove lift weldment.

REPLACING LIFT WELDMENT ASSEMBLY

1. Transfer marks from sprocket on removed lift weldment assembly to sprocket on new lift weldment assembly (A).
2. Use supplied grease packet (K) to lubricate center hole in new lifting weldment assembly (A).
3. Install new lift weldment assembly (A), placing chain onto large sprocket.
4. Place lift shaft into center bearing of new lift weldment assembly (A). (See Figure 9)

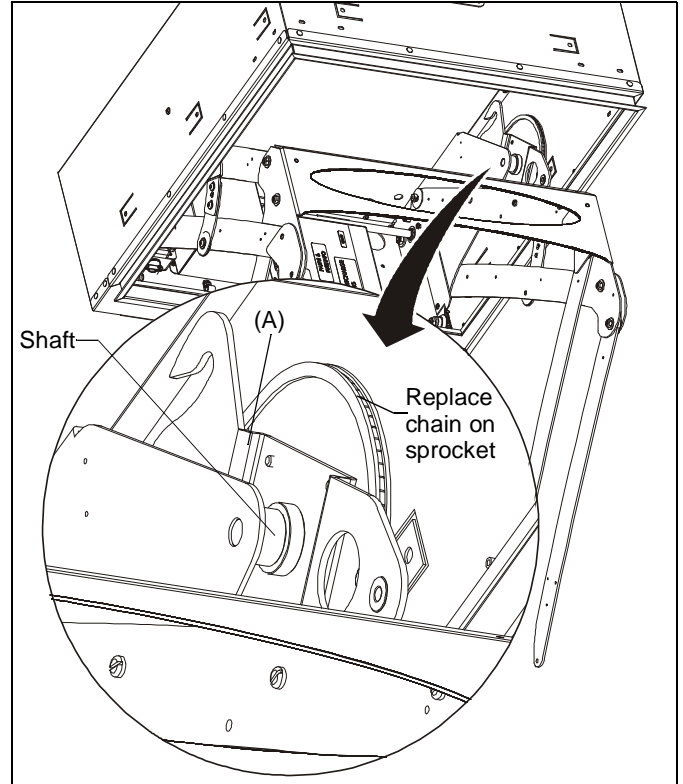

Figure 9

5. Ensure that both the new lift weldment assembly and the existing weldment on other side of lift are even before proceeding.
6. Tighten chain tensioner by moving the nut upwards in the slot and tightening nut. (See Figure 10)

NOTE: Adjust each side approximately the same amount.

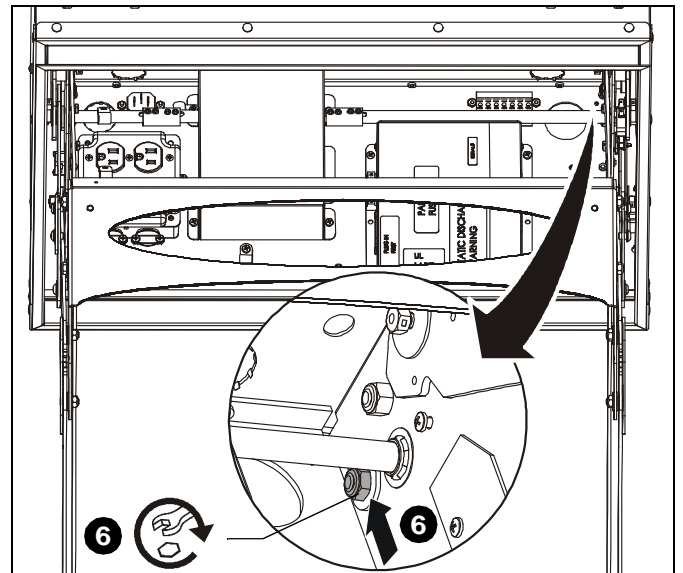

Figure 10

7. Replace loose end of lifting link (moved in Step 11 of **Removing Lift Weldment Assembly** section) and fasten in place using one 1/4-20 locknut (F).
8. Remove wire ties added in **Removing Lift Weldment Assembly** section.
9. Add two drops of Loctite (or similar) to one 10-24 x 1/2" buttonhead cap screw (J).
10. Fasten screw (J) with Loctite into side of lift. (See Figure 11)
11. Add three 8-32 x 5/16" Phillips screws (G) to top of lift on affected side of lift. (See Figure 11)

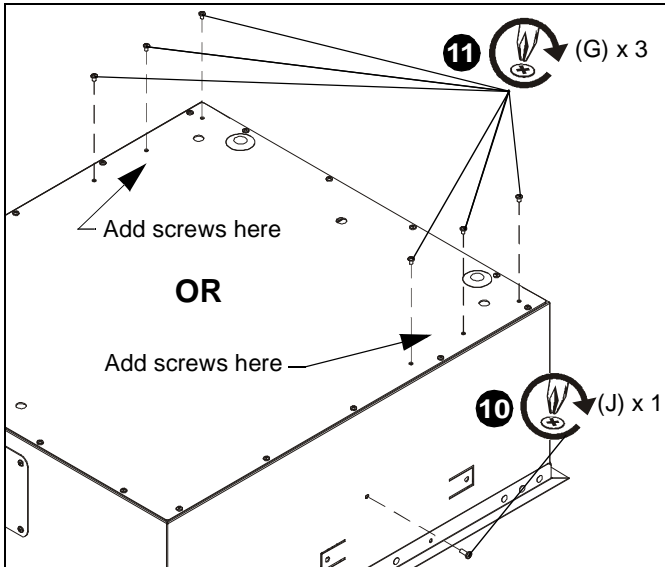

Figure 11

12. Replace sway panel removed in Step 6 of **Removing Lift Weldment Assembly** section and fasten with six 10-24 x 3/16" Phillips head screws (H). (See Figure 12)

NOTE: Install middle screw on each side first and set sway panel on top of two middle screws before adding additional four screws.

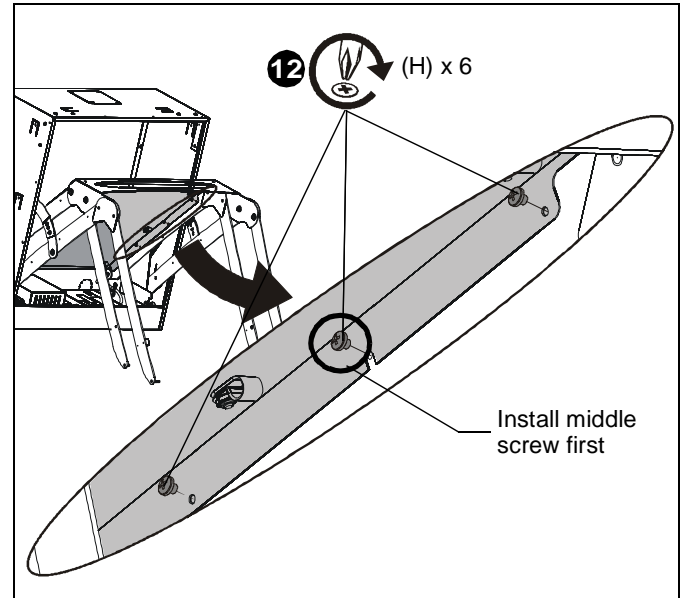

Figure 12

13. Reinstall projector cradle to SL236 lift. (See Figure 13)
 - Use two nylon spacers (C), two flat washers (E) and two locknuts (F) for rear lift arms.
 - Use two steel spacers (D), two nylon spacers (C), two flat washers (E) and two locknuts (F) for front lift arms.
14. Reinstall the projector into the SL236 following instructions included with the SL236.
15. Re-route projector power and signal cables following instructions in the SL236 installation instructions.
16. Restore power to SL236.

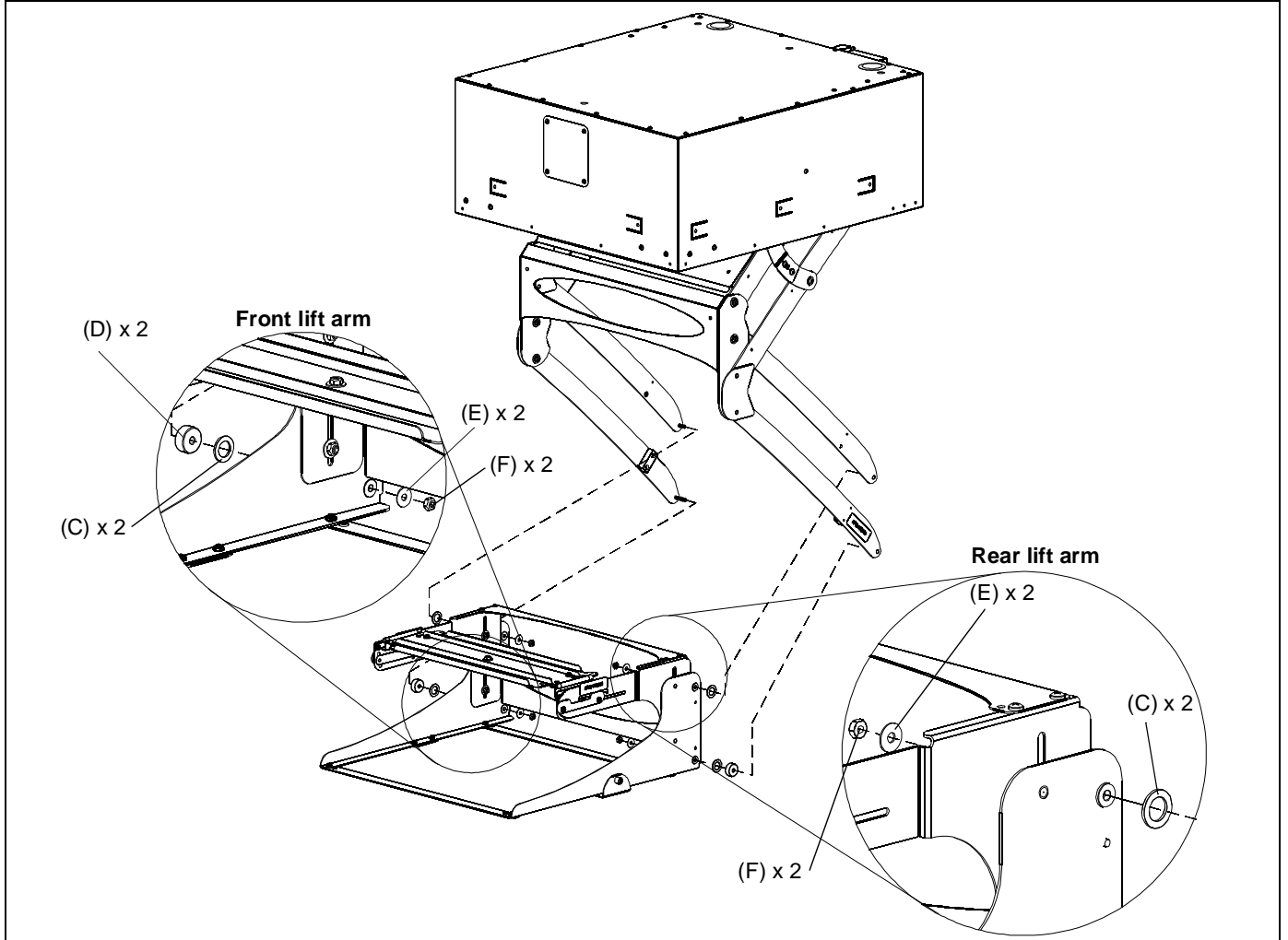

Figure 13



Our Mounts. **Your Vision.**

Chief Manufacturing, a products division
of Milestone AV Technologies

8800-002221 Rev00
©2012 Milestone AV Technologies, a
Duchossois Group Company
www.chiefmfg.com
09/12

USA/International	A 6436 City West Parkway, Eden Prairie, MN 55344
	P 800.582.6480 / 952.225.6000
	F 877.894.6918 / 952.894.6918
Europe	A Franklinstraat 14, 6003 DK Weert, Netherlands
	P +31 (0) 495 580 852
	F +31 (0) 495 580 845
Asia Pacific	A Office No. 1 on 12/F, Shatin Galleria 18-24 Shan Mei Street Fotan, Shatin, Hong Kong
	P 852 2145 4099
	F 852 2145 4477

