

**IMPORTANT:** Please read this bulletin and **pass on** to others in your organisation.



## Dryer

### Creaking Inlet Bearing Noise

**MARKETS:** USA only

**MODELS:** DEGX1, DGGX1

**ACTION:** If a creaking noise is encountered emitting from the inlet bearing area during operation, it could be due to either lack of oil in the bearing or a defect in the housing bearing drum inlet.

**Inlet Bearing**

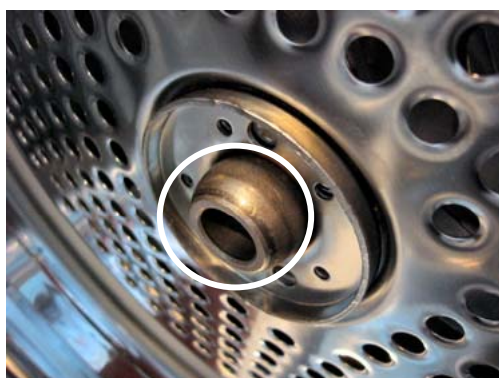

**Housing Bearing Drum Inlet**



Check for hairline cracks in the housing inner surface

There is no method to check for lack of oil in the bearing, however the bearing housing can be inspected for hairline cracks in the inner surface.

Either way we would recommend fitting 'Kit Bearing Inlet', part number 479332. Included in the kit are the following components:

Part	Description
<b>479332</b>	<b>KIT BEARING INLET</b>
	1 x Drum inlet cap screw
	1 x Drum inlet cap
	5 x Inlet bearing retainer screws
	1 x Thrust washer
	1 x Inlet bearing retainer
	1 x Inlet drum bearing
	1 x Bearing housing
	1 x Shaft*
	1 x Instruction sheet

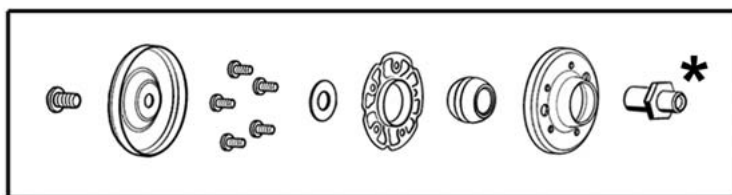

**Exploded view of inlet bearing kit components**

**Fisher & Paykel Appliances Ltd**  
78 Springs Road, East Tamaki, PO Box 58-732, Greenmount,  
Auckland, New Zealand, Ph: 09 273 0600, Fax: 09 273 0656  
**Fisher & Paykel Customer Services Pty Ltd**  
A.C.N. 003 3335 171, 19 Enterprise Street, Cleveland, QLD 4163  
PO Box 798, Cleveland, QLD 4163, Ph: 07 3826 9100, Fax: 07 3826 9164  
**Fisher & Paykel Appliances**  
150 Ubi Avenue 4, Sunlight Building #02-00, Singapore 408825  
Ph: 6547 0100, Fax: 6547 0123  
**Fisher & Paykel Appliances Inc**  
27 Hubble, Irvine, California, CA92618, USA,  
Ph: 949 790 8900, Fax: 949 790 8911  
**Fisher & Paykel Appliances Ltd UK**  
Ph: 08450 662200, Fax: 08450 662201

NZ = New Zealand  
AU = Australia  
ROW = International Markets  
USA = United States of America & Canada  
GB or UK = Great Britain & Ireland  
EU = Europe

# DR020.

October 2004

COPYRIGHT © FISHER & PAYKEL LTD 2004

## ASSEMBLY METHOD

**Step 1:** Remove the drum inlet cap by unscrewing with a M5 or 3/16" allen key.

**Step 2:** Remove the 5 screws securing the bearing retainer to the drum and remove the retainer.



**Step 3:** Lift the drum upwards slightly to take pressure off the bearing, then rotate the bearing housing and slide the bearing and the housing off the shaft.



**Step 4:** Refit in the reverse manner. Ensure that the bearing housing is orientated so that the rivet heads sit in the clearance holes, and the thrust washer is in place. Lift the drum upwards while sliding the bearing onto the shaft. Do not overtighten the screw securing the drum inlet cap. Tighten to 10 Newton metres (7 foot pounds).



### \* Note:

It is important that all components contained in this kit are fitted with the exception of the shaft. This will only need to be replaced if there is any evidence of damage on the surface of the shaft. For the shaft replacement procedure refer to the SmartLoad Service Manual, part number 517760.

## Long Drying Times / Radio Frequency Interference

**MARKETS:** USA only

**MODELS:** DEGX1, DGGX1

**ACTION:** The screw that secures the power module to the base panel (see photo below) is used by the electronics to provide a ground (earth) reference. If the screw is missing or not tightened sufficiently it can cause either long drying times (up to 3 hrs) or radio frequency interference. It is recommended that this is the first thing to check for either of these problems.

This is not a safety issue as the ground is only used as a reference rather than an electrical grounding.

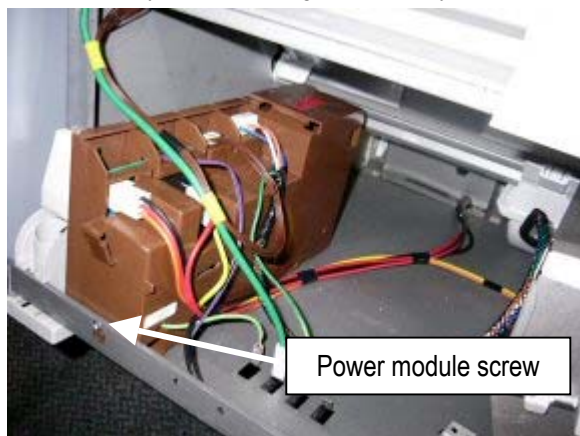

**Note:** When fitting or re-tightening the screw be careful not to over-tighten it to the point where it can strip (the screw only needs to be 'nipped' up).

# DR020

October 2004