

CHAPTER 2. PRODUCT OVERVIEW

[1] THE CAUTIONS ON USE

1. THE METHOD OF EFFECTIVE INSTALLATION

NOTE: The air purifier is designed to remove air-suspended dust and odor, but not harmful gases (for example, carbon monoxide contained in cigarette smoke). If the odor sources still exist, it cannot completely remove the odor. (for example, odors from construction materials and pet odors).

It is suggested to open the window a bit when you are smoking in order to facilitate ventilation.

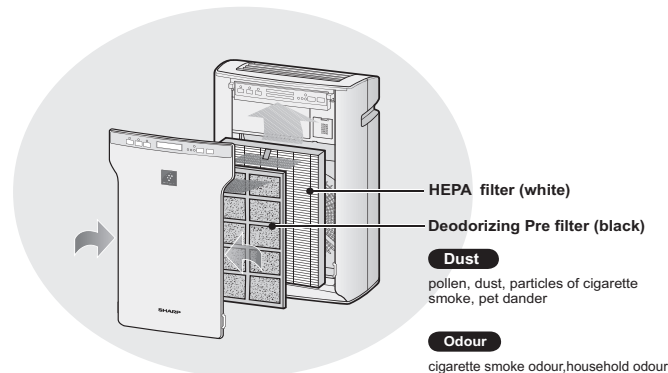

2. PRECAUTIONARY INFORMATION

Please follow these precautions when using the air purifier. Failure to do so may damage the unit and/or cause an accident (fire, electrical shock, injury).

- Do not use the air purifier as a ventilation fan or stove exhaust fan.
- Do not insert fingers or any objects into the air inlet or air outlet.
- The high-voltage components and rotating fan parts inside the air purifier are extremely dangerous.
- Do not use in humid place such as bathrooms.
- Do not use the air purifier when placed on top of or located close to heating equipment.
- Do not allow flammable substances to enter the air purifier.
- Do not block any opening.
- Do not knock over or drop the air purifier.
- Always ventilate closed rooms.
- The air purifier does not function to provide ventilation or remove carbon monoxide.

3. REPLACING THE AIR PURIFIER'S FILTER

3.1. FILTER SERVICE LIFE TIMES

Service lifetimes for the air purifier's filter in a normal residential setting are as follows:

- HEPA filter..... About 2 years after opening
- Deodorizing filter About 2 years after opening

These estimates indicate the period over which the air purifier's ability to absorb odors and collect dust will be reduced by 50% in an operating environment where 5 cigarettes are smoked daily (based on Japan Electrical Manufacturers' Association standard JEM 1467).

These service lifetimes are provided for reference purposes only. Depending on the conditions in which the air purifier is operated, filter performance may deteriorate within several months. It is recommended to replace the unit's filter as soon as any unpleasant odors become noticeable.

3.2. HOW FREQUENTLY TO REPLACE FILTER

How frequently the air purifier's filter will need to be replaced depends on where the unit is being used. When you start using a new set of filter, note the date on the maintenance label on the back of the air purifier and use this date in estimating when the filter will need to be replaced.

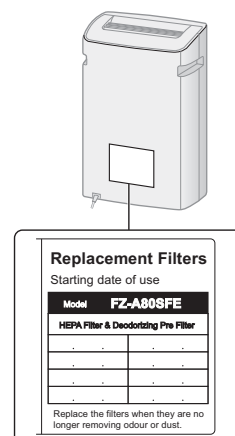

3.3. FILTER WILL NEED TO BE REPLACED MUCH MORE FREQUENTLY UNDER THESE CIRCUMSTANCES

When the purifier is used in proximity to soot or carbonized substances.

When the purifier is used in an office or business setting, such as a restaurant, mahjong parlor, barbershop, or hair salon.

3.4. THE OPTIONAL FILTER FOR EXCHANGE

MODEL:FZ-A80SFE.

[2] ABOUT THE BUTTON

1. POWER Button

Press the POWER Button to turn operation ON and OFF. Unless the power cord has been unplugged, the operation starts in the previous mode it was operated in.

2. FAN SPEED Button

2.1. AUTO OPERATION

The air purifier operates the airflow speed automatically according to the interior pollution level detected by the sensor.

2.2. LOW OPERATION

The unit will operate quietly using minimal air flow or volume.

2.3. MEDIUM OPERATION

The unit will operate at medium fan speed.

2.4. MAX OPERATION

The unit will operate at maximum fan speed.

3. CHILD LOCK Button

Press the CHILD LOCK Button for 3 seconds to select "CHILD LOCK".

Operation will be locked.

To cancel the "CHILD LOCK" mode, press "CHILD LOCK" button again.

4. Plasmacluster ON/OFF Button

Press the Plasmacluster ON/OFF Button to turn Plasmacluster Ion Mode ON and OFF. When Plasmacluster is ON, both the Indicator Light and Plasmacluster Indicator Light turn on.

5. SHOWER Button

The unit will operate at HIGH fan speed for 60 minutes, then will return to the prior operation. "SHOWER" mode is effective when you would like to clean quickly.