

# SHARP SERVICE MANUAL

No. SY6Z3LC32D8EA

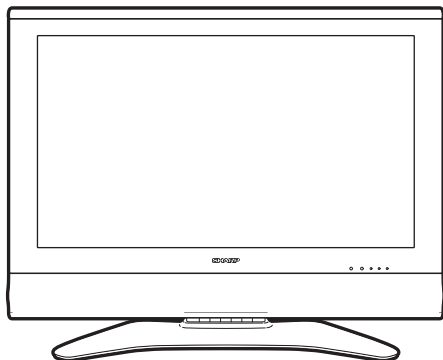

## LCD COLOUR TELEVISION

### MODELS **LC-32GD8EA/RUA** **LC-32BT8EA/RUA**

In the interests of user-safety (Required by safety regulations in some countries) the set should be restored to its original condition and only parts identical to those specified should be used.

#### OUTLINE

This model is based on the LC-32GD8E, LC-32BT8E and is changed some parts. This Service Manual covers the modifications alone. For the other points, refer to the LC-32/37GD8E/RU, LC-32/37BT8E/RU Service Manual.

#### CONTENTS

##### DIFFERENCES FROM BASE MODEL

LIST OF CHANGED PARTS .....i

##### SAFETY PRECAUTION

IMPORTANT SERVICE SAFETY PRE-  
CAUTION .....ii  
PRECAUTIONS FOR USING LEAD-FREE  
SOLDER .....iii

##### CHAPTER 1. SPECIFICATIONS

[1] SPECIFICATIONS ..... 1-1

##### CHAPTER 2. DIMENSIONS

[1] DIMENSIONS ..... 2-1

##### CHAPTER 3. SCHEMATIC DIAGRAM

[1] DESCRIPTION OF SCHEMATIC DIA-  
GRAM ..... 3-1  
[2] MAIN Unit..... 3-2

##### Parts Guide

Parts marked with "⚠" are important for maintaining the safety of the set. Be sure to replace these parts with specified ones for maintaining the safety and performance of the set.

**DIFFERENCES FROM BASE MODEL****LIST OF CHANGED PARTS**

Ref. No.	Description	LC-32GD8E	LC-32GD8EA/RUA, LC-32BT8EA/RUA	Note
<b>PWB ASSEMBLIES</b>				
	AV Unit	DUNTKD604FM10	←	-
	POWER Unit	DUNTKD605FM14	←	-
	OPERATION Unit	DUNTKD606FMV0	←	-
	R/C, LED Unit	DUNTKD607FMV0	←	-
	DIGITAL TUNER Unit	CKITKD609FM01	←	-
	DIGITAL Unit	DUNTKD628FM01	←	-
	MAIN Unit	DUNTKD890FM06	DUNTKD890FM28	Some parts changed
<b>MAIN Unit</b>				
C1747	Capacitor	-	VCCCCY1HH101JY	Add
C1748	Capacitor	-	VCCCCY1HH101JY	Add
C1749	Capacitor	-	VCKYCY1HB221KY	Add
C1750	Capacitor	-	VCCCCY1HH101JY	Add
C1751	Capacitor	-	VCCCCY1HH101JY	Add
C1752	Capacitor	-	VCCCCY1HH101JY	Add
IC1905	IC	VHISII9023+-1Q	VHISII9021+-1Q or VHISII9023+-1Q	or use
P1701	Plug	-	QPLGNA342WJZZY	Add
P2305	Plug	QPLGNA522WJQZY	QPLGNA493WJZZY	Change
R1715	Resistor	-	VRS-CY1JF470JY	Add
R1717	Resistor	VRS-CY1JF000JY	VRS-CY1JF470JY	Change
R1718	Resistor	-	VRS-CY1JF470JY	Add
R1730	Resistor	-	VRS-CY1JF470JY	Add
R1731	Resistor	-	VRS-CY1JF102JY	Add
R1736	Resistor	-	VRS-CY1JF102JY	Add
R1752	Resistor	VRS-CY1JF470JY	-	Delete
R1773	Resistor	VRS-CY1JF000JY	-	Delete
R1774	Resistor	VRS-CY1JF470JY	-	Delete
R1775	Resistor	VRS-CY1JF103JY	-	Delete
R2303	Resistor	VRS-CY1JF000JY	-	Delete
<b>CABINET AND MECHANICAL PARTS</b>				
Please refer to a Parts list.				
<b>PACKING PARTS AND ACCESSORIES</b>				
Please refer to a Parts list.				

# SAFETY PRECAUTION

## IMPORTANT SERVICE SAFETY PRECAUTION

■ Service work should be performed only by qualified service technicians who are thoroughly familiar with all safety checks and the servicing guidelines which follow:

### ■WARNING

1. For continued safety, no modification of any circuit should be attempted.
2. Disconnect AC power before servicing.

**CAUTION: FOR CONTINUED PROTECTION AGAINST A RISK OF FIRE REPLACE ONLY WITH SAME TYPE FUSE.**

F701 (4A / AC250V)

### ■BEFORE RETURNING THE RECEIVER (Fire & Shock Hazard)

Before returning the receiver to the user, perform the following safety checks:

3. Inspect all lead dress to make certain that leads are not pinched, and check that hardware is not lodged between the chassis and other metal parts in the receiver.
4. Inspect all protective devices such as non-metallic control knobs, insulation materials, cabinet backs, adjustment and compartment covers or shields, isolation resistor-capacitor networks, mechanical insulators, etc.
5. To be sure that no shock hazard exists, check for leakage current in the following manner.
  - Plug the AC cord directly into a 220~240 volt AC outlet. (Do not use an isolation transformer for this test).
  - Using two clip leads, connect a 1.5k ohm, 10 watt resistor paralleled by a 0.15μF capacitor in series with all exposed metal cabinet parts and a known earth ground, such as electrical conduit or electrical ground connected to an earth ground.

- A true RMS reading multimeter should be used for this test, especially where the equipment uses a switch mode power supply which may result in very non-sinusoidal leakage current.
- Connect the resistor connection to all exposed metal parts having a return to the chassis (antenna, metal cabinet, screw heads, knobs and control shafts, escutcheon, etc.) and measure the AC voltage drop across the resistor.

All checks must be repeated with the AC cord plug connection reversed. (If necessary, a nonpolarized adaptor plug must be used only for the purpose of completing these checks.)

Any reading of 1.05 peak (this corresponds to 0.7 mA. peak AC.) or more is excessive and indicates a potential shock hazard which must be corrected before returning the monitor to the owner.

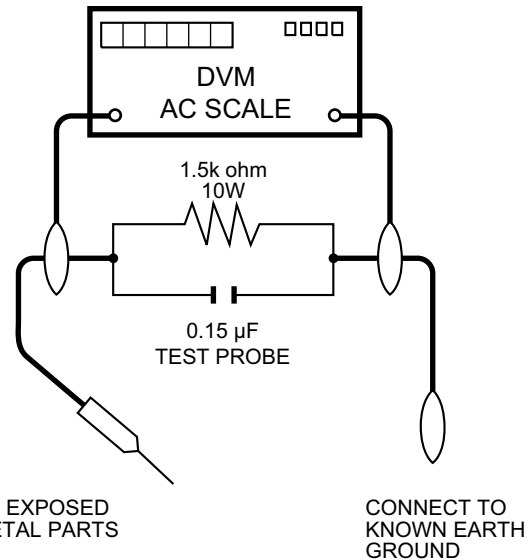

### SAFETY NOTICE

Many electrical and mechanical parts in LCD colour television have special safety-related characteristics.

These characteristics are often not evident from visual inspection, nor can protection afforded by them be necessarily increased by using replacement components rated for higher voltage, wattage, etc.

Replacement parts which have these special safety characteristics are identified in this manual; electrical components having such features are identified by "⚠" and shaded areas in the Replacement Parts List and Schematic Diagrams.

For continued protection, replacement parts must be identical to those used in the original circuit.

The use of a substitute replacement parts which do not have the same safety characteristics as the factory recommended replacement parts shown in this service manual, may create shock, fire or other hazards.

**PRECAUTIONS FOR USING LEAD-FREE SOLDER**

**■Employing lead-free solder**

- “ALL PWBs” of this model employs lead-free solder. The LF symbol indicates lead-free solder, and is attached on the PWBs and service manuals. The alphabetical character following LF shows the type of lead-free solder.

Example:

**LF**a  
Sn-Ag-Cu

Indicates lead-free solder of tin, silver and copper.

- For the Inverter PWB Units the type used in nickel, so they are marked as LFn.

**LF**n  
Sn-Ag-Ni

Indicates lead-free solder of tin, silver and nickel.

**■Using lead-free wire solder**

- When fixing the PWB soldered with the lead-free solder, apply lead-free wire solder. Repairing with conventional lead wire solder may cause damage or accident due to cracks.

As the melting point of lead-free solder (Sn-Ag-Cu) is higher than the lead wire solder by 40 °C, we recommend you to use a dedicated soldering bit, if you are not familiar with how to obtain lead-free wire solder or soldering bit, contact our service station or service branch in your area.

**■Soldering**

- As the melting point of lead-free solder (Sn-Ag-Cu) is about 220 °C which is higher than the conventional lead solder by 40 °C, and as it has poor solder wettability, you may be apt to keep the soldering bit in contact with the PWB for extended period of time. However, Since the land may be peeled off or the maximum heat-resistance temperature of parts may be exceeded, remove the bit from the PWB as soon as you confirm the steady soldering condition.

Lead-free solder contains more tin, and the end of the soldering bit may be easily corroded. Make sure to turn on and off the power of the bit as required.

If a different type of solder stays on the tip of the soldering bit, it is alloyed with lead-free solder. Clean the bit after every use of it.

When the tip of the soldering bit is blackened during use, file it with steel wool or fine sandpaper.

- Be careful when replacing parts with polarity indication on the PWB silk.

Lead-free wire solder for servicing

PARTS CODE	PRICE RANK	PART DELIVERY	DESCRIPTION
ZHNDai123250E	BL	J	φ0.3mm 250g (1roll)
ZHNDai126500E	BK	J	φ0.6mm 500g (1roll)
ZHNDai12801KE	BM	J	φ1.0mm 1kg (1roll)

# CHAPTER 1. SPECIFICATIONS

## [1] SPECIFICATIONS

<b>Item</b>		<b>32" LCD COLOUR TV, Model: LC-32GD8EA, LC-32GD8RUA, LC-32BT8EA, LC-32BT8RUA</b>	
LCD panel		32" Advanced Super View & BLACK TFT LCD	
Number of dots		3,147,264 dots (1366 × 768 × 3 dots)	
Video Colour System		PAL/SECAM/NTSC 3.58/NTSC 4.43/PAL 60	
TV Function	TV-Standard	Analogue	CCIR (B/G, I, D/K, L, L')
		Digital	DVB-T (2K/8K OFDM)
	Receiving Channel	VHF/UHF	E2-E69ch, F2-F10ch, I21-I69ch, IR A-IR Jch, (Digital: E5-E69ch)
		CATV	Hyper-band, S1-S41ch
	TV-Tuning System	Auto Preset 99 ch, Auto Label, Auto Sort	
STEREO/BILINGUAL		NICAM/A2	
Brightness		450 cd/m <sup>2</sup>	
Viewing angles		H : 176° V : 176°	
Audio amplifier		10W × 2	
Speaker		130 mm × 60 mm	
Terminals	Rear	Antenna input	UHF/VHF 75Ω Din type (Analogue & Digital)
		RS-232C	9 pin MINI-DIN male connector
		EXT 1	SCART (AV input, Y/C input, RGB input, TV output)
		EXT 2	SCART (AV input/output, Y/C input, RGB input, AV Link)
		EXT 3	S-VIDEO (Y/C input), RCA pin (AV input)
		EXT 4	∅3.5 mm jack (Audio input), 15 pin mini D-sub (PC/Component)
		EXT 5	HDMI, ∅ 3.5 mm jack (Audio input)
		C. I. (Common Interface)	EN50221, R206001
		OUTPUT	RCA pin (Audio)
		Headphones	∅3.5 mm jack (Audio output)
OSD language		English/German/French/Italian/Spanish/Dutch/Swedish/Portuguese/Finnish/Turkish/Greek/Russian/Polish	
Power Requirement		AC 220-240 V, 50 Hz	
Power Consumption		151 W (0.9 W Standby) (Method IEC60107)	
Weight		17 kg (Display only), 19 kg (Display with stand)	
Operating temperature		0°C to + 40°C	

- As a part of policy of continuous improvement, SHARP reserves the right to make design and specification changes for product improvement without prior notice. The performance specification figures indicated are nominal values of production units. There may be some deviations from these values in individual units.

# CHAPTER 2. DIMENSIONS

## [1] DIMENSIONS

Unit: mm

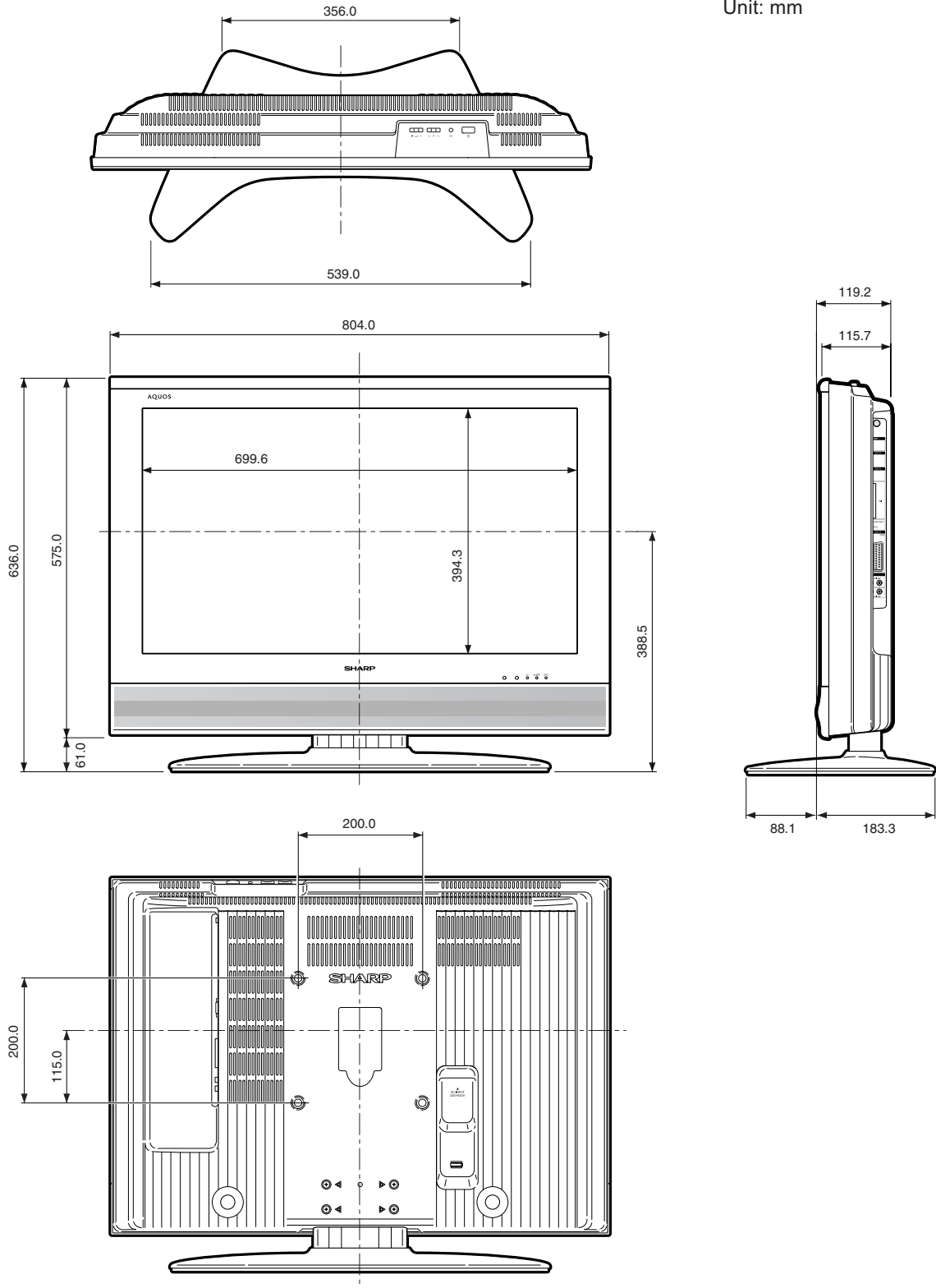

## CHAPTER 3. SCHEMATIC DIAGRAM

### [1] DESCRIPTION OF SCHEMATIC DIAGRAM

#### 1. VOLTAGE MEASUREMENT CONDITION:

- 1) The voltages at test points are measured on exclusive AC adaptor and the stable supply voltage of AC 120V. Signals are fed by a color bar signal generator for servicing purpose and the above voltages are measured with a 20k ohm/V tester.

#### 2. INDICATION OF RESISTOR & CAPACITOR:

##### RESISTOR

- 1) The unit of resistance " $\Omega$ " is omitted.  
(K=k $\Omega$ =1000 $\Omega$ , M=M $\Omega$ ).
- 2) All resistors are  $\pm 5\%$ , unless otherwise noted.  
(K=  $\pm 10\%$ , F=  $\pm 1\%$ , D=  $\pm 0.5\%$ )
- 3) All resistors are 1/16W, unless otherwise noted.

##### CAPACITOR

- 1) All capacitors are  $\mu\text{F}$ , unless otherwise noted.  
(P=pF= $\mu\mu\text{F}$ ).
- 2) All capacitors are 50V, unless otherwise noted.

##### CAUTION:

This circuit diagram is original one, therefore there may be a slight difference from yours.

##### SAFETY NOTES:

- 1) DISCONNECT THE AC PLUG FROM THE AC OUTLET BEFORE REPLACING PARTS.
- 2) SEMICONDUCTOR HEAT SINKS SHOULD BE REGARDED AS POTENTIAL SHOCK HAZARDS WHEN THE CHASSIS IS OPERATING.

##### IMPORTANT SAFETY NOTICE:

PARTS MARKED WITH " $\triangle$ " (            ) ARE IMPORTANT FOR MAINTAINING THE SAFETY OF THE SET. BE SURE TO REPLACE THESE PARTS WITH SPECIFIED ONES FOR MAINTAINING THE SAFETY AND PERFORMANCE OF THE SET.

[2] MAIN Unit

- MAIN Unit-1

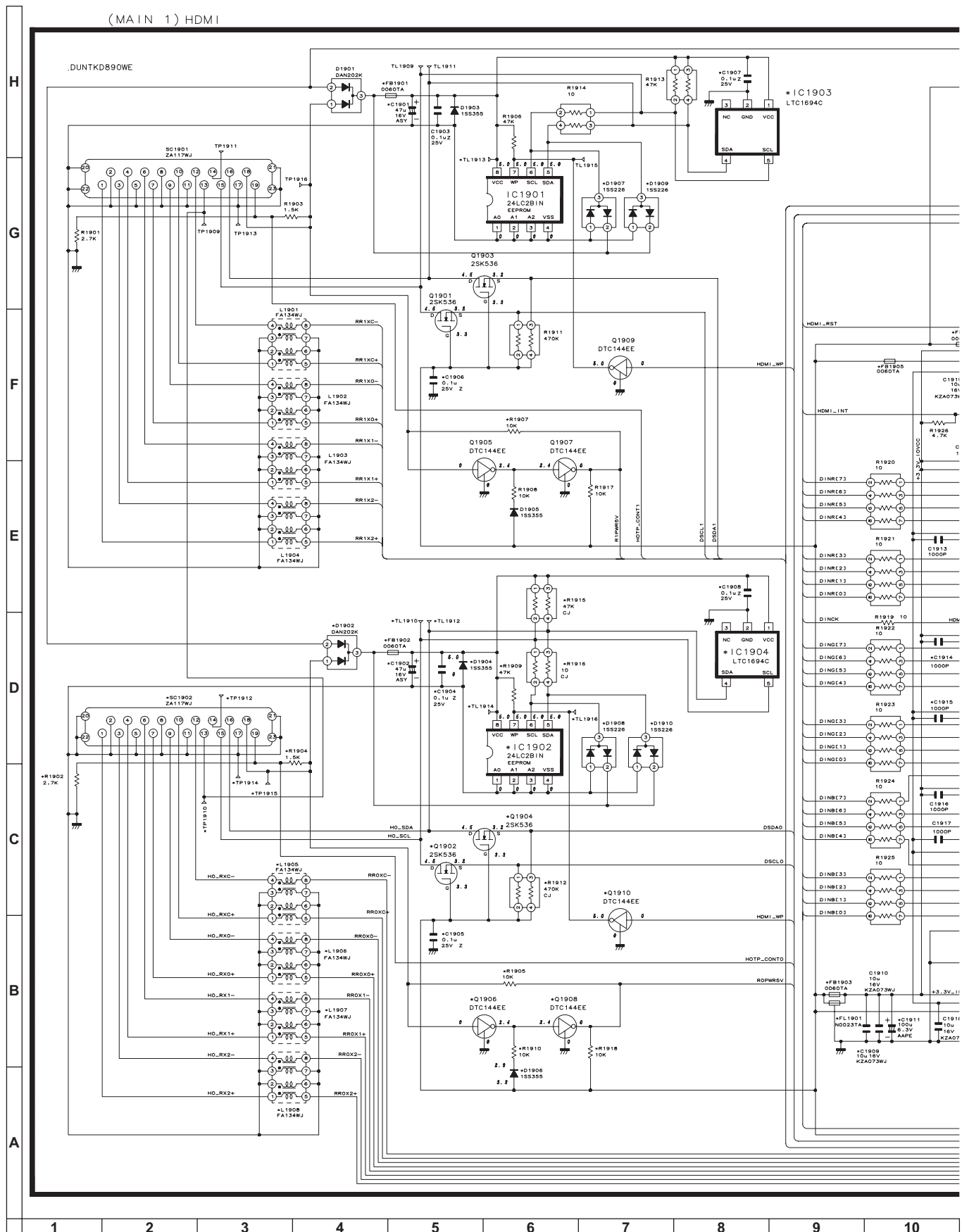





# LC-32GD8EA/RUA, LC-32BT8EA/RUA

• MAIN Unit-5

(MAIN 5) MISC

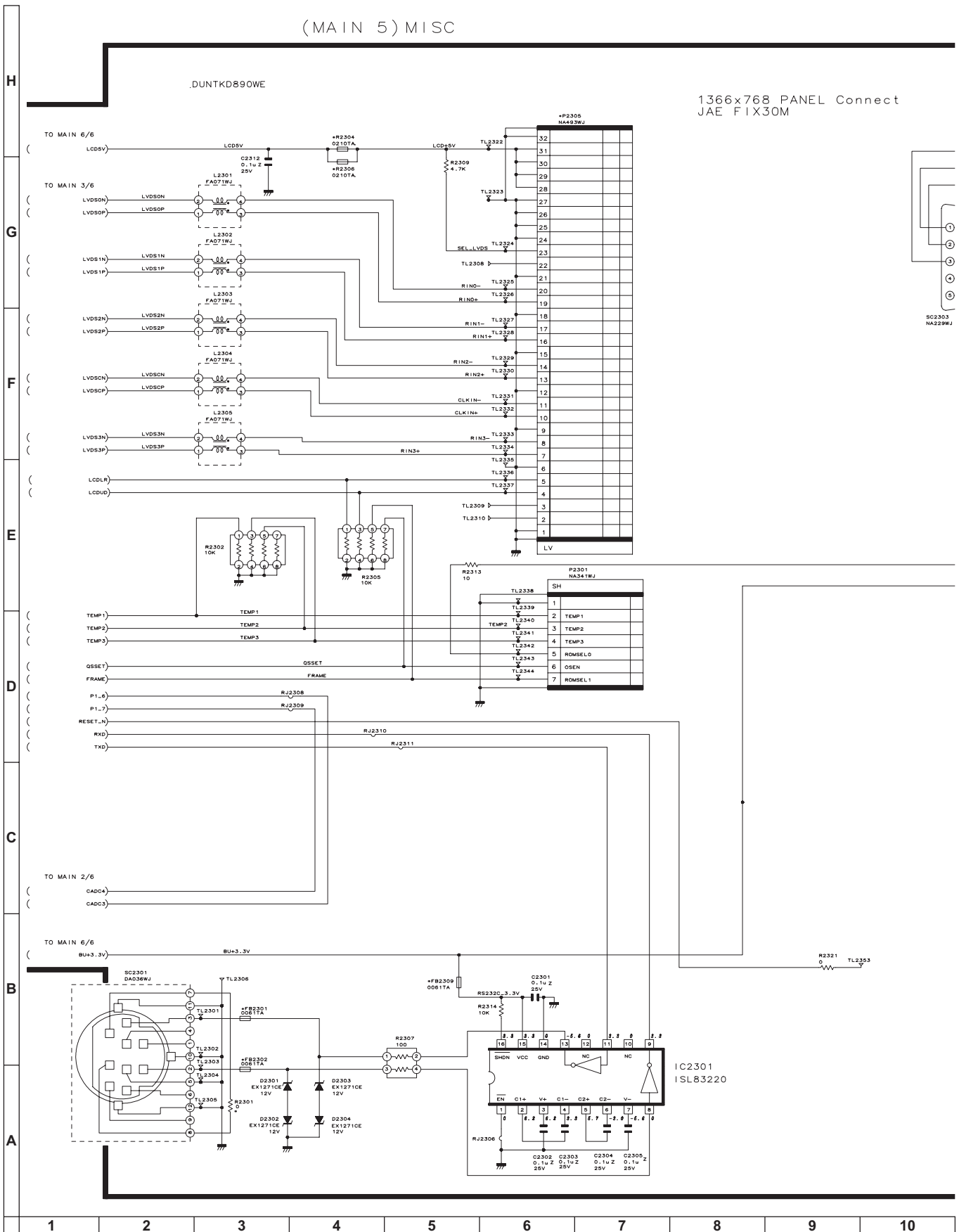

inct

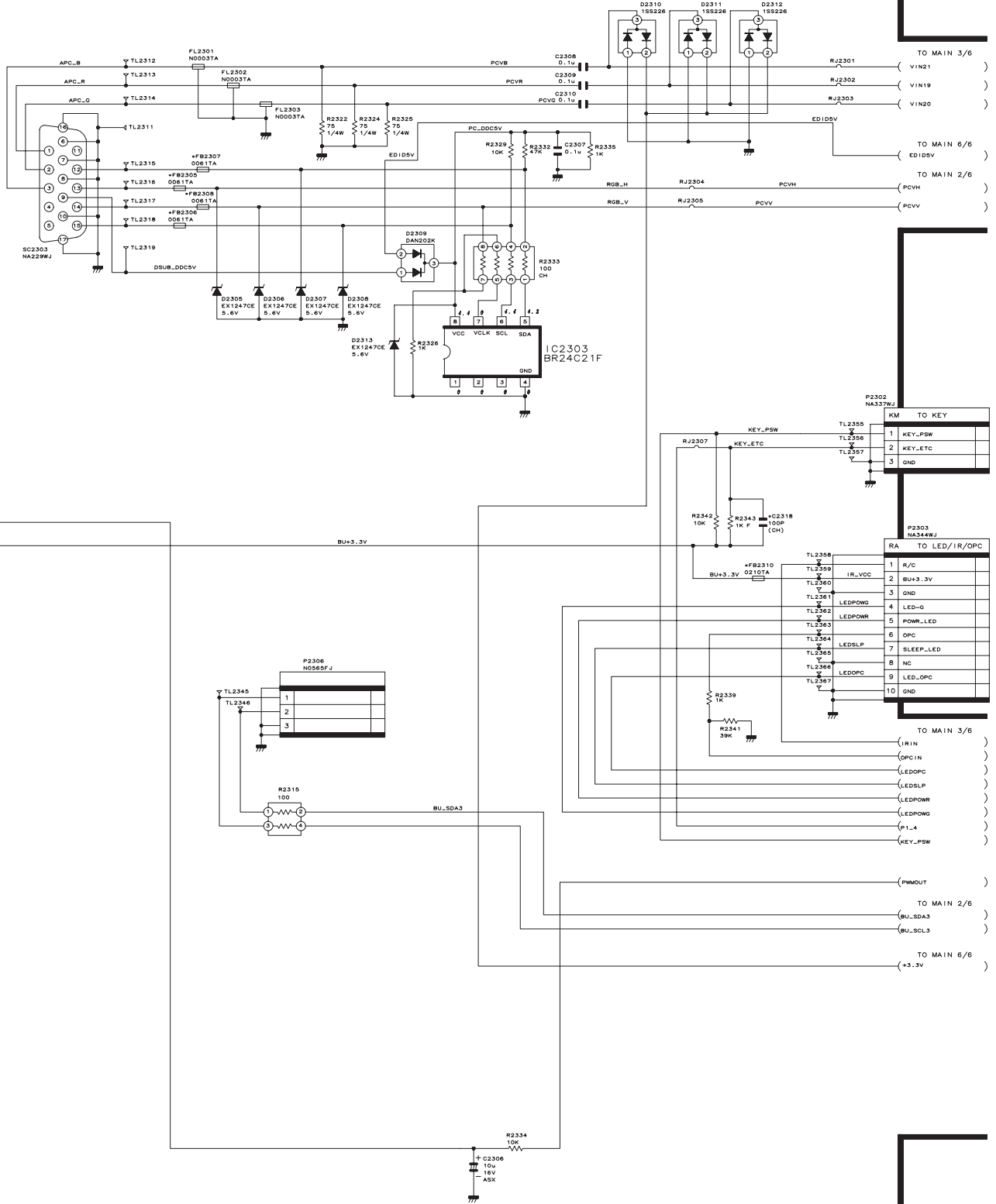

353

10	11	12	13	14	15	16	17	18	19
----	----	----	----	----	----	----	----	----	----

# LC-32GD8EA/RUA, LC-32BT8EA/RUA

## • MAIN Unit-6

(MAIN 6) PowerDC-DC

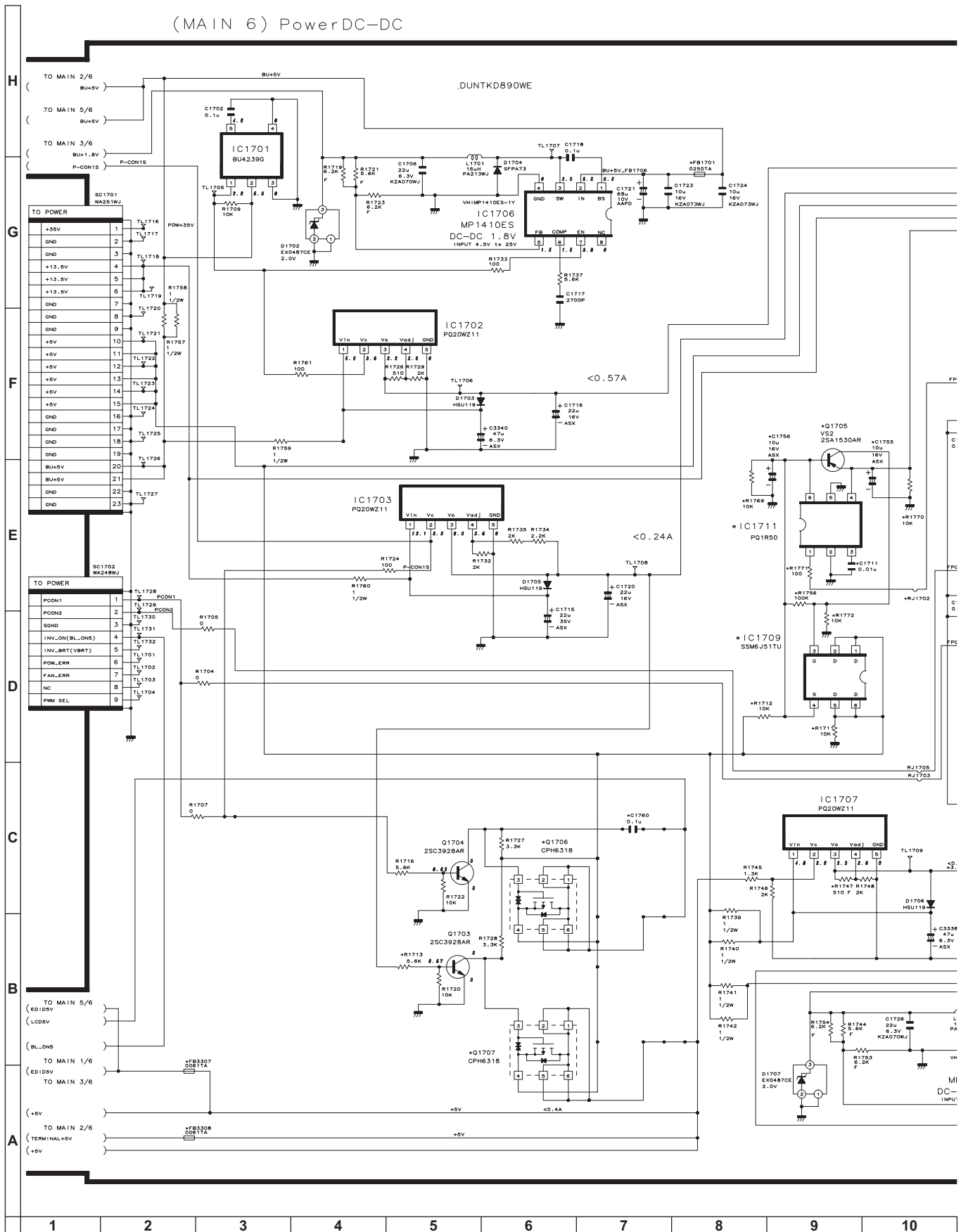

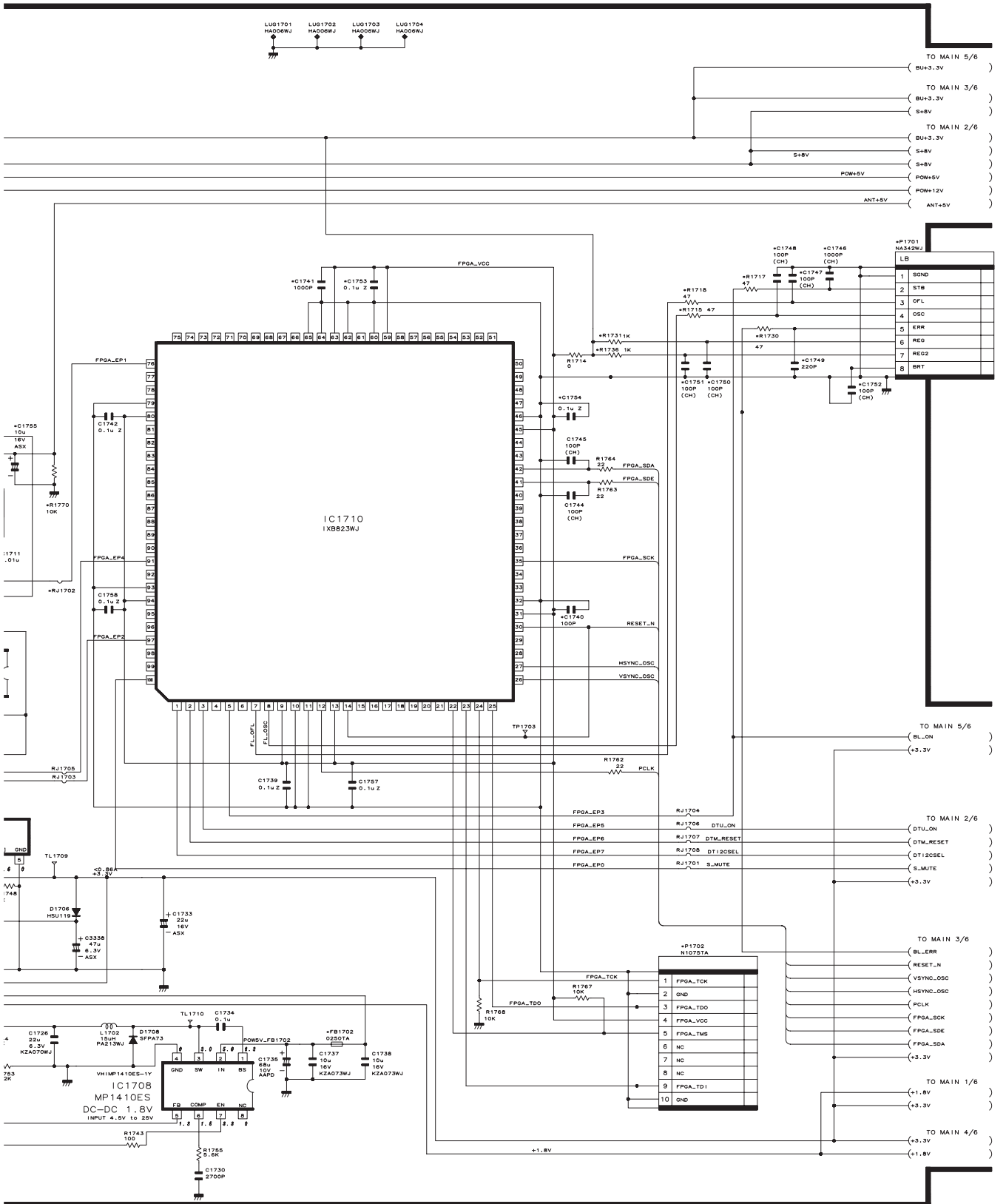

10	11	12	13	14	15	16	17	18	19
----	----	----	----	----	----	----	----	----	----



# SHARP PARTS GUIDE

No. SY6Z3LC32D8EA

**Note:**

The reference numbers on the PWB are arranged in alphabetical order.

## MODELS **LC-32GD8EA/RUA** **LC-32BT8EA/RUA**

### CONTENTS

- |   |  |
|---|--|
| [1] PRINTED WIRING BOARD ASSEMBLIES (NOT REPLACEMENT ITEM)                                    | [4] CABINET AND MECHANICAL PARTS         |
| [2] LCD PANEL (NOTE: THE PARTS HERE SHOWN ARE SUPPLIED AS AN ASSEMBLY BUT NOT INDEPENDENTLY.) | [5] SUPPLIED ACCESSORIES                 |
| [3] DUNTKD890FM28 (MAIN Unit)   | [6] PACKING PARTS (NOT REPLACEMENT ITEM) |

Parts marked with "△" are important for maintaining the safety of the set. Be sure to replace these parts with specified ones for maintaining the safety and performance of the set.

NO.	PARTS CODE	PRICE RANK	NEW MARK	PART DELIVERY	DESCRIPTION
<b>[1] PRINTED WIRING BOARD ASSEMBLIES (NOT REPLACEMENT ITEM)</b>					
N	DUNTKD890FM28	CD		R	MAIN Unit
<b>[2] LCD PANEL (NOTE: THE PARTS HERE SHOWN ARE SUPPLIED AS AN ASSEMBLY BUT NOT INDEPENDENTLY.)</b>					
N	R1LK315T3LZ4BX	EE		R	32" LCD Panel Module
<b>[3] DUNTKD890FM28 (MAIN Unit)</b>					
C1747	VCCCCY1HH101JY	AA		R	Capacitor, 100p 50V Ceramic
C1748	VCCCCY1HH101JY	AA		R	Capacitor, 100p 50V Ceramic
C1749	VCKYCY1HB221KY	AA		R	Capacitor, 220p 50V Ceramic
C1750	VCCCCY1HH101JY	AA		R	Capacitor, 100p 50V Ceramic
C1751	VCCCCY1HH101JY	AA		R	Capacitor, 100p 50V Ceramic
C1752	VCCCCY1HH101JY	AA		R	Capacitor, 100p 50V Ceramic
IC1905	VH i S i i 9021+-1Q	BC		R	IC, SII9021CTU
IC1905	VH i S i i 9023+-1Q	BD		R	IC
P1701	QPLGNA342WJZZY	AD		R	Plug, 8pins (LB)
P2305	QPLGNA493WJZZY	AM		R	Plug, 32pins (LV)
R1715	VRS-CY1JF470JY	AA		R	Resistor, 47 1/16W Metal Oxide
R1717	VRS-CY1JF470JY	AA		R	Resistor, 47 1/16W Metal Oxide
R1718	VRS-CY1JF470JY	AA		R	Resistor, 47 1/16W Metal Oxide
R1730	VRS-CY1JF470JY	AA		R	Resistor, 47 1/16W Metal Oxide
R1731	VRS-CY1JF102JY	AA		R	Resistor, 1k 1/16W Metal Oxide
R1736	VRS-CY1JF102JY	AA		R	Resistor, 1k 1/16W Metal Oxide





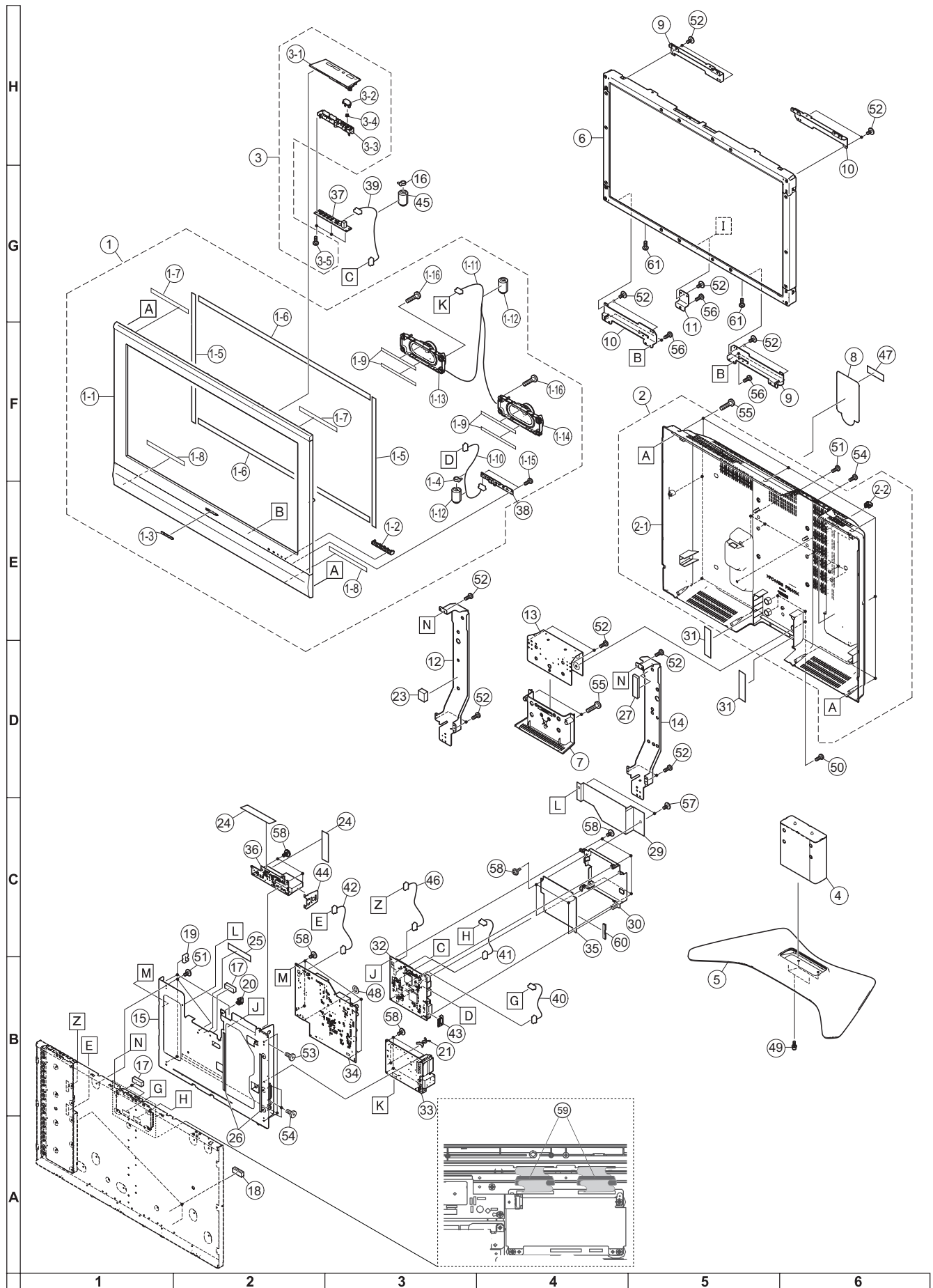

[4] CABINET AND MECHANICAL PARTS

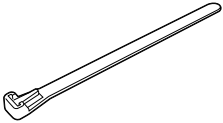

NO.	PARTS CODE	PRICE RANK	NEW MARK	PART DELIVERY	DESCRIPTION	
<b>[4] CABINET AND MECHANICAL PARTS</b>						
1	CCABAB441WJ01			S	Cabinet A Ass'y	[LC32-GD8EA/RUA]
1	CCABAB441WJ02			S	Cabinet A Ass'y	[LC32-BT8EA/RUA]
1-1	Not Available	-		-	Cabinet A	
1-2	GCOVAB478WJSA			S	R/C LED Cover	
1-3	HBDGBA056WJSA			S	SHARP Badge	
1-4	LHLDW1033PEZZ	AA		R	Wire Holder for SP/RA Wire	
1-5	PSPAHA607WJZZ			S	Mask Side spacer, x2	
1-6	PSPAHA608WJZZ			S	Mask Top/Bottom Spacer, x2	
1-7	PSPAHA786WJZZ			S	Top Corner Spacer, x2	
1-8	PSPAHA790WJZZ			S	Bottom Corner spacer, x2	
1-9	PSPA7B211WJZZ		N	S	Spacer for Speaker, x4	
1-10	QCNW-E233WJQZ			S	Connecting Cord (RA)	
1-11	QCNW-E800WJQZ		N	S	Connecting Cord (SP)	
1-12	RCORF0103CEZZ	AK		R	Ferrite Core for LED/Speaker Wire, x2	
1-13	RSP-ZA184WJN1		N	S	Speaker (L)	
1-14	RSP-ZA184WJN2		N	S	Speaker (R)	
1-15	XEBS930P08000	AA		R	Screw for LED PWB Unit, x2	
1-16	LX-HZA003WJFN	AC		R	Screw for Speaker, x2	
2	CCABBA861WJ01			S	Cabinet B Ass'y	
2-1	Not Available	-		-	Cabinet B	
2-2	LHLDWA055WJKZ	AC		R	Wire Holder for AC Code	
3	GCOVAB480WJ01			S	Top Cover Ass'y	
3-1	Not Available	-		-	Top Cover	
3-2	JBTN-A524WJKA		N	S	Power Button	
3-3	JBTN-A525WJKA		N	S	Operation Button	
3-4	MSPRCA068WJFW		N	S	Spring for Power Button	
3-5	XEBS930P08000	AA		R	Screw for PWB, x3	
4	CDAi-A290WJ01		N	S	Stand Support Ass'y	[LC32-GD8EA/RUA]
4	CDAi-A290WJ03		N	S	Stand Support Ass'y	[LC32-BT8EA/RUA]
5	CDAi-A287WJ01		N	S	Stand Base Ass'y	[LC32-GD8EA/RUA]
5	CDAi-A287WJ05		N	S	Stand Base Ass'y	[LC32-BT8EA/RUA]
6	R1LK315T3LZ4BX	EE		R	32" LCD Panel Module	
7	GCOVAB488WJKA			S	Stand Cover	
8	HiNDPC224WJSA		N	S	Model Label	[LC-32GD8EAE/EAK/EAF]
8	HiNDPC225WJSA		N	S	Model Label	[LC-32GD8EA]
8	HiNDPC226WJSA		N	S	Model Label	[LC-32GD8RUA]
8	HiNDPC230WJSA		N	S	Model Label	[LC-32BT8EAE/EAK/EAF]
8	HiNDPC231WJSA		N	S	Model Label	[LC-32BT8EA]
8	HiNDPC232WJSA		N	S	Model Label	[LC-32BT8RUA]
9	LANGKA638WJFW			S	LCD Angle-A, x2	
10	LANGKA639WJFW			S	LCD Angle-B, x2	
11	LANGKA672WJFW			S	LCD Angle-C, x1	
12	LANGTA263WJN1			S	Center Angle (L)	
13	LANGTA266WJN1			S	Stand Angle	
14	LANGTA267WJN1			S	Center Angle (R)	
15	LCHSMA324WJZZ	BA		R	Chassis Tray	
16	LHLDW1033CE00	AA		R	Wire Holder, x1	
17	LHLDW1123GEZZ	AB		R	Wire Holder, x2	
18	LHLDW1173CEZZ	AD		R	Wire Holder, x2	
19	LHLDW1205CEZZ	AC		R	Wire Holder, x2	
20	LHLDWA055WJKZ	AC		R	Wire Holder, x1	
21	LHLDWA137WJZZ	AB		R	Wire Holder, x2	
23	PCUSGA009WJKZ			S	Cushion Spacer, x1	
24	PFLT-A004WJZZ	AE		R	Felt Sheet, x2	
25	PMLT-A255WJZZ	AD		R	Spacer, x1	
26	PMLT-A315WJZZ	AP		R	Spacer, x2	
27	PSLDMAS84WJZZ	AE		R	Shield	
29	PSLDMAS877WJFW			S	Control PWB Unit Shield	
30	PSLDMAS943WJFW	AK		R	Digital PWB Shield	
31	PSPAHA902WJZZ			S	Spacer, x2	
32	DUNTKD890FM28	CD		R	MAIN Unit	
33	DUNTKD604FM10	BM		R	AV Unit	
34	DUNTKD605FM14	BU		R	POWER Unit	
35	DUNTKD628FM01	BY		R	DIGITAL Unit	
36	CKiTKD609FM01	BN		S	DIGITAL TUNER Unit	
37	DUNTKD606FMV0	AK		R	OPERATION Unit	
38	DUNTKD607FMV0	AQ		R	R/C, LED Unit	
39	QCNW-E232WJQZ	AG		R	Connecting Cord (KM)	
40	QCNW-E609WJQZ	AH		R	Connecting Cord (SH)	
41	QCNW-E237WJPZ			S	Connecting Cord (LV)	
42	QCNW-E235WJQZ	AN		R	Connecting Cord (LA)	
43	QEARPA212WJFW	AE		R	Ground Part	
44	QEARZA096WJFW			S	Ground Part	
45	RCORFA023WJZZ	AK	N	R	Ferrite Core	
46	QCNW-F185WJQZ	AN		R	Connecting Cord (LB)	
47	Not Available	-		-	Serial No Label	
48	LX-WZA042WJZZ			S	Washer	
49	LX-BZA146WJF7	AC		R	Screw for Stand Ass'y, x4	
50	LX-BZA147WJF7		N	S	Screw for Stand to Set, x4	
51	XBBS930P06000	AA		R	Screw, x10	
52	XBPS730P06WS0	AA		R	Screw, x17	
53	XBPS830P06000	AA		R	Screw for HDMI	
54	XEBS930P08000	AA		R	Screw, x4	
55	XEBS940P16000	AB		R	Screw, x11	
56	XEBSN40P10000	AB		R	Screw, x5	

NO.	PARTS CODE	PRICE RANK	NEW MARK	PART DELIVERY	DESCRIPTION
<b>[4] CABINET AND MECHANICAL PARTS</b>					
57	XJPS730P04WS0	AB		R	Screw, x2
58	XJPS730P08WS0	AA		R	Screw, x19
59	RCORFA064WJZZ		N	S	Ferrite Core for FPC Wire, x2
60	GCOVAB586WJKA			S	PC Card Cover
61	XBBS740P06000	AA		R	Screw, x2

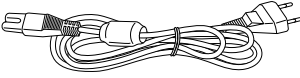
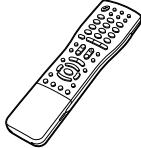
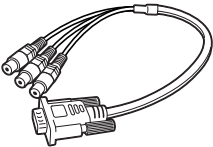
**[5] SUPPLIED ACCESSORIES**

X2	Cable Band	X1	Cable Clamp	X3	AC Cord	X5	Remote Control Unit
				 The forms of a plug differ in some countries.			
X4	3 RCA to 15-pin D-sub adapter	X10			Stand Unit		
							

NO.	PARTS CODE	PRICE RANK	NEW MARK	PART DELIVERY	DESCRIPTION
<b>[5] SUPPLIED ACCESSORIES</b>					
X1	LHLDW0110CESB	AF		R	Cable Clamp
X2	LHLDWA083WJ00	AD		R	Cable Band
X3	QACCKA073WJPZ			S	AC Cord [LC-32BT8EAK, LC-32GD8EAK]
X3	QACCKA021WJPZ		N	S	AC Cord [LC-32BT8EAE/EAF/EAI/RUA, LC-32GD8EAE/EAF/EAI/RUA]
X4	QCNWGA075WJPZ	AU		R	3 RCA to 15-pin D-sub adapter
X5	RRMCGA472WJSA			S	Remote Control Unit [LC-32GD8EA/RUA]
X5	RRMCGA490WJSA			S	Remote Control Unit [LC-32BT8EA/RUA]
X6	TGAN-A077WJZZ			S	Guarantee Card [LC-32BT8RUA, LC-32GD8RUA]
X6	TGAN-A342WJZZ			S	Guarantee Card [LC-32BT8EAK, LC-32GD8EAK]
X6	TGAN-A512WJZZ			S	Guarantee Card [LC-32BT8EAK, LC-32GD8EAK]
X7	TINS-C997WJZZ		N	S	Operation Manual [LC-32BT8EAE/EAK/EAF/EAI, LC-32GD8EAE/EAK/EAF/EAI]
X7	TINS-C998WJZZ		N	S	Operation Manual [LC-32BT8EE/EF, LC-32GD8EE/EF]
X7	TINS-D001WJZZ		N	S	Operation Manual [LC-32BT8EAF, LC-32GD8EAF]
X8	TINS-C999WJZZ		N	S	Operation Manual [LC-32BT8EAE, LC-32GD8EAE]
X9	Not Available	-		-	"AAA"size Battery, x2
X10	CDAi-A287WJ02		N	S	Stand Unit [LC32-GD8EA/RUA]
X10	CDAi-A287WJ06		N	S	Stand Unit [LC32-BT8EA/RUA]

△  
△

**[6] PACKING PARTS (NOT REPLACEMENT ITEM)**

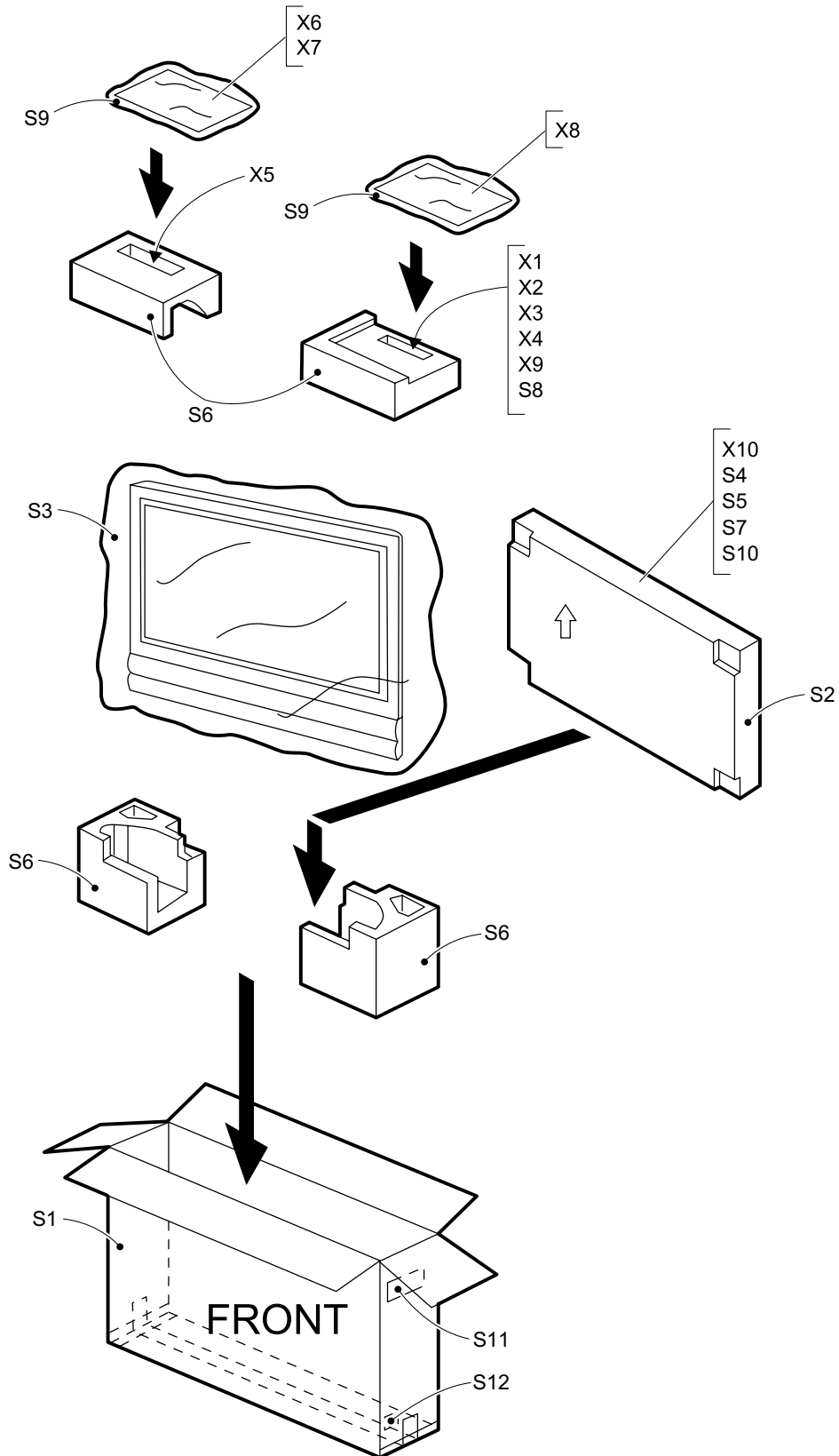

NO.	PARTS CODE	PRICE RANK	NEW MARK	PART DELIVERY	DESCRIPTION
<b>[6] PACKING PARTS (NOT REPLACEMENT ITEM)</b>					
S1	SPAKCD343WJZZ	-	N	-	Packing Case for Monitor [LC-32GD8EAE/EAK/EA/EA]
S1	SPAKCD344WJZZ	-	-	-	Packing Case for Monitor [LC-32GD8RUA]
S1	SPAKCD345WJZZ	-	N	-	Packing Case for Monitor [LC-32BT8EAE/EAK/EA/EA]
S1	SPAKCD346WJZZ	-	-	-	Packing Case for Monitor [LC-32BT8RUA]
S2	SPAKFB018WJZZ	-	N	-	Packing Case (Stand)
S3	SPAKPA382WJZZ	-	-	-	Wrapping Paper
S4	SPAKPA684WJZZ	-	N	-	Mirror Mat A
S5	SPAKPA602WJZZ	-	-	-	Wrapping Paper (Stand)
S6	SPAKXA919WJZZ	-	-	-	Buffer Material
S7	SPAKFB019WJZZ	-	N	-	Buffer Material (Stand) [LC-32GD8EA/RUA]
S7	SPAKFB027WJZZ	-	N	-	Buffer Material (Stand) [LC-32BT8EA/RUA]
S8	SSAKAA009WJZZ	-	-	-	Polyethylene Bag
S9	SSAKAA010WJZZ	-	-	-	Polyethylene Bag, x2
S10	SSAKHA020WJZZ	-	-	-	Pac for Screw
S11	TLABKA002WJZZ	-	-	-	Case No Label
S12	TLABSA050WJZZ	-	-	-	Green Dot Label

# SHARP

**COPYRIGHT © 2006 BY SHARP CORPORATION**

**ALL RIGHTS RESERVED.**

No part of this publication may be reproduced, stored in a retrieval system, or transmitted in any form or by any means, electronic, mechanical, photocopying, recording, or otherwise, without prior written permission of the publisher.