

# Panasonic®

## Operating Instructions Air Conditioner



Indoor Unit  
CS-E18JKR  
CS-E21JKR  
CS-E24JKR  
CS-E28JKR

Outdoor Unit  
CU-E18JKR  
CU-E21JKR  
CU-E24JKR  
CU-E28JKR



Before operating the unit, read these operating instructions thoroughly and keep them for future reference.



**QUICK GUIDE**

© Panasonic HA Air-Conditioning (M) Sdn. Bhd. 2009.  
Unauthorized copying and distribution is a violation  
of law.

# SAFETY PRECAUTIONS

## DEFINITION

The instructions to be followed are classified by the following symbols:



This symbol denotes an action that is **PROHIBITED**.



These symbols denote actions that are **COMPULSORY**.

To prevent personal injury, injury to others, or property damage, please observe the following. Incorrect operation due to failure to follow instructions may cause harm or damage, the seriousness of which is classified as below:



**Warning** This sign warns of death or serious injury.



**Caution** This sign warns of injury or damage to property.

### Remote Control



- Do not use rechargeable (Ni-Cd) batteries.
- Do not allow infants and small children to play with the remote control to prevent them from accidentally swallowing the batteries.



- Remove the batteries if the unit is not going to be used for a long period of time.
- New batteries of the same type must be inserted following the polarity stated to prevent malfunction of the remote control.

### Indoor Unit



- Do not install, remove and reinstall the unit by yourself; improper installation will cause leakage, electric shock or fire. Please consult authorized dealer or specialist for the installation work.
- Do not insert your fingers or other objects into the unit, rotating parts may cause injury.
- Do not attempt to repair the unit by yourself.

### Indoor Unit



- Do not install the unit in a potentially explosive atmosphere.
- Do not wash the unit with water, benzene, thinner or scouring powder.
- Do not use for other purposes such as preservation of food.
- Do not use any combustible equipment in front of the airflow outlet.
- Do not expose directly to cold air for a long period.
- Ensure that the drainage pipe is connected properly. Otherwise, leakage may occur.
- Aerate the room regularly.



### Power Supply



- Do not share the same power outlet with other equipment.
- Do not modify power cords.
- Do not use extension cords.
- Do not operate with wet hands.



- Use the specified supply cord.
- If the supply cord is damaged, it must be replaced by the manufacturer, its service agent or similarly qualified persons in order to avoid a hazard.



- This equipment must be earthed and strongly recommended to be installed with Earth Leakage Circuit Breaker (ELCB) or Residual Current Device (RCD). Otherwise, it may cause electrical shock or fire in case of malfunction.



- In case of emergency or abnormal conditions (burnt smell, etc), turn off the power supply, and please consult authorized dealer.

### Power Supply



- Switch off the power supply before cleaning or servicing.
- Turn off the power supply if the unit is not used for a long period of time.
- This air conditioner is equipped with a built-in surge protective device. However, in order to further protect your air conditioner from being damaged by abnormally strong lightning activity, you may want to disconnect it from the power supply. Do not touch the air conditioner during lightning, it may cause electric shock.

### Outdoor Unit



- Do not insert your fingers or other objects into the unit, rotating parts may cause injury.

### Outdoor Unit



- Do not sit or step on the unit, you may fall down accidentally.



- Do not touch the sharp aluminium fin, sharp parts may cause injury.



- Ensure that the drainage pipe is connected properly. Otherwise, leakage may occur.
- After long periods of use, make sure the installation rack is not damaged.

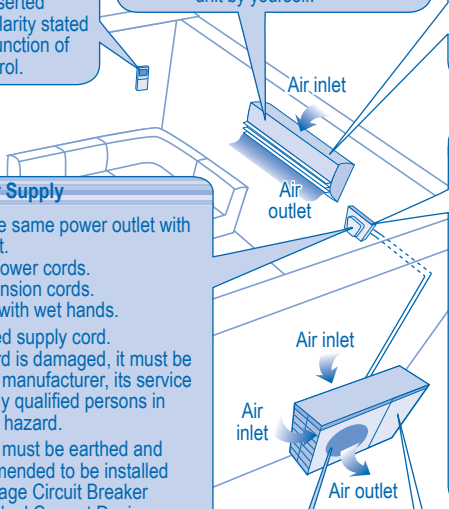

# REGULATORY INFORMATION

Thank you for purchasing  
Panasonic Air Conditioner

This appliance is not intended for use by persons (including children) with reduced physical, sensory or mental capabilities, or lack of experience and knowledge, unless they have been given supervision or instruction concerning use of the appliance by a person responsible for their safety. Children should be supervised to ensure that they do not play with the appliance.

## OPERATION CONDITION

Use this air conditioner under the following temperature range  
(CU-E18JKR, CU-E21JKR)

Temperature (°C)		Indoor		Outdoor	
		*DBT	*WBT	*DBT	*WBT
COOLING	Maximum	32	23	43	26
	Minimum	16	11	16	11
HEATING	Maximum	30	-	24	18
	Minimum	16	-	-5	-6

(CU-E24JKR, CU-E28JKR)

Temperature (°C)		Indoor		Outdoor	
		*DBT	*WBT	*DBT	*WBT
COOLING	Maximum	32	23	43	26
	Minimum	16	11	16	11
HEATING	Maximum	30	-	24	18
	Minimum	16	-	-10	-11

\* **DBT**: Dry bulb temperature

\* **WBT**: Wet bulb temperature

## TABLE OF CONTENTS

SAFETY PRECAUTIONS	2
REGULATORY INFORMATION	3
PRODUCT OVERVIEW & OPERATIONS	4~5
CARE & CLEANING	6
TROUBLESHOOTING	7
QUICK GUIDE	BACK COVER

### NOTE :

The illustrations in this manual are for explanation purposes only and may differ from the actual unit. It is subjected to change without notice for future improvement.

## Information for Users on Collection and Disposal of Old Equipment and used Batteries



### [Information on Disposal in other Countries outside the European Union]

These symbols are only valid in the European Union. If you wish to discard these items, please contact your local authorities or dealer and ask for the correct method of disposal.



### Note for the battery symbol (bottom two symbol examples):

This symbol might be used in combination with a chemical symbol. In this case it complies with the requirement set by the Directive for the chemical involved.



Pb

- Do not switch ON the unit when waxing the floor. After waxing, aerate the room properly before operating the unit.
- Do not install the unit in oily and smoky areas.

# PRODUCT OVERVIEW & OPERATIONS

## e-ion AIR PURIFYING SYSTEM



Do not touch during operation

e-ion filters

e-ion charging wire

Active e-ion Generator

Front panel

Receiver

Airflow direction louver  
 • Do not adjust by hand.

Maximum distances: 8m

## Auto OFF/ON button

- Used when remote control is misplaced or malfunction.

Action	Mode
Press once.	Auto
Press and hold until 1 beep is heard, then release.	Cooling
Press and hold until 1 beep is heard, then release. Press again until 2 beeps, then release.	Heating
Press the button to turn off.	

## INDICATOR

### PATROL SENSOR

POWER	(Blue)
TIMER	(Green)
QUIET	(Orange)
POWERFUL	(Orange)
ECONOMY	(Green)
MILD DRY COOLING	(Blue)

Remote control display



## TO TURN ON OR OFF THE UNIT



- Please be aware of the OFF indication on the remote control display to prevent the unit from starting / stopping improperly.



TEMP

## TO SET TEMPERATURE

- Selection range: 16°C ~ 30°C.
- Operating the unit within the recommended temperature could induce energy saving.  
 HEAT mode : 20°C ~ 24°C.  
 COOL mode : 26°C ~ 28°C.  
 DRY mode : 1°C ~ 2°C lower than room temperature.



## TO SELECT OPERATION MODE

### AUTO mode - For your convenience

- Unit selects operation mode every 30 minutes according to temperature setting, outdoor and room temperature. During operation mode selection the power indicator blinks.

### HEAT mode - To enjoy warm air

- Unit takes a while to warm up. The power indicator blinks during this operation.

### COOL mode - To enjoy cool air

### DRY mode - To dehumidify the environment

- Unit operates at low fan speed to give a gentle cooling operation.

FAN SPEED

## TO SELECT FAN SPEED (5 OPTIONS)



- For AUTO, the indoor fan speed is automatically adjusted according to the operation mode.



## TO ADJUST AIRFLOW DIRECTION (5 OPTIONS)



- Keeps the room ventilated.
- In COOL/DRY mode, if AUTO is set, the louver swing left/right and up/down automatically.
- In HEAT mode, if AUTO is set, the horizontal louver fix at predetermined position. The vertical louver swing left/right after the temperature rises.

PATROL

## TO MONITOR AIR QUALITY



- Patrol sensor detects air quality.
- When air quality is unsatisfactory, e-ion operation will start automatically.

ECONOMY

## TO SAVE ELECTRICAL POWER CONSUMPTION



- Save power consumption at unoccupied room by adjust set temperature up to 3°C automatically.
- Brightness of all indicators will be dimmed.

QUIET/POWERFUL

QUIET → POWERFUL → NORMAL

## TO ENJOY QUIET ENVIRONMENT



- This operation reduces indoor and outdoor units noise.

## TO ACHIEVE TEMPERATURE QUICKLY



- This operation will stop automatically after 20 minutes.

MILD DRY

## TO IMPROVE HUMIDITY AND MOISTURE LEVEL



- This operation reduces air dryness and provides you with a comfortable living environment.
- When vertical airflow direction is set to AUTO, it stops at lower position to avoid cold air contact. However, you can adjust the louver direction manually.

- PATROL**, **ECONOMY** and  can be activated in all modes and can be cancelled by pressing the respective button again.

- MILD DRY** only can be activated in COOL mode and can be cancelled by pressing the button again.

- MILD DRY**, **ECONOMY** and  cannot be activated at the same time.

- PATROL** can be activated even when the unit is turned off. In this condition, once e-ion operation is ON, the unit will operate with AUTO fan speed and air swing.

## TO SET THE TIMER

- 2 sets of ON and OFF timers are available to turn ON or OFF the unit at different preset time.

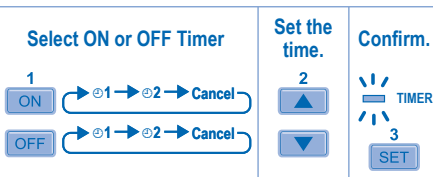

- Example of application at living room:  
Morning: ON ① at 07:00 (Wake up)  
OFF ① at 08:00 (Out for work)  
Evening: ON ② at 17:00 (Back home)  
OFF ② at 22:00 (Sleep)
- To cancel ON or OFF timer, press **ON** or **OFF** to select respective ① or ② then press **CANCEL**.
- If timer is cancelled manually or due to power failure, you can restore the timer again by pressing **ON** or **OFF** to select respective ① or ② then press **SET**.

- Upcoming timer will be displayed and will be activated in sequence.
- When ON Timer is set, the unit may start earlier (up to 35 minutes) before the actual set time in order to achieve the desired temperature on time.
- Timer operation is based on the clock set in the remote control and repeats daily once set. For clock setting, please refer to Remote Control Preparation at back cover.

## OPTIONAL SETTINGS

- PATROL** starts automatically with the unit switched on with **OFF/ON**.
- Press and hold for 5 seconds, then release to disable or restore this setting.

-  Press and hold for 5 seconds to dim or restore the unit's indicator brightness.

-  Press and hold for approximately 10 seconds to show temperature setting in °C or °F.

- RC** **RESET** Press to restore the remote control's default setting.

- SET** **AG** **RESET** Not used in normal operations.

Use curtains to screen off sunlight and outdoor heat to reduce power consumption during cool mode.

# CARE & CLEANING



## CAUTION

- Switch off the power supply before cleaning.
- Do not touch the aluminium fin, sharp parts may cause injury.

## WASHING INSTRUCTIONS

- Do not use benzene, thinner or scouring powder.
- Use only soap ( $\approx$  pH7) or neutral household detergent.
- Do not use water hotter than 40°C.

## HINT

- To ensure optimal performance of the unit, cleaning maintenance have to be carried out at regular intervals. Dirty unit may caused malfunction and you may retrieve error code "H99". Please consult authorized dealer.

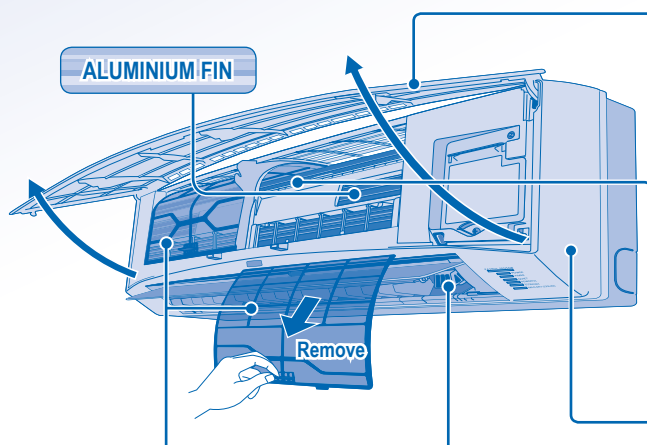

ALUMINIUM FIN

Remove

## e-ion FILTERS

- Clean the filters regularly.
- Wash/rinse the filters gently with water to avoid damage to the filter surface.
- Dry the filters thoroughly under the shade, away from fire or direct sunlight.
- Replace any damage filter.

## FRONT-PANEL

### Remove Front Panel

- Raise and pull to remove the front panel.
- Wash gently and dry.

### Close Front Panel



- Press down both ends of the front panel to close it securely.

## e-ion CHARGING WIRE

## INDOOR UNIT

Wipe the unit gently with a soft, dry cloth.

## ACTIVE e-ion GENERATOR

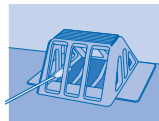

Clean with dry cotton bud.

- Active e-ion generator cleaning is recommended every 6 months.

## FOR SEASONAL INSPECTION AFTER EXTENDED NON-USE

- Checking of remote control batteries.
- No obstruction at air inlet and air outlet vents.
- Use Auto OFF/ON button to select Cooling/Heating operation, after 15 minutes of operation, it is normal to have the following temperature difference between air inlet and air outlet vents:  
Cooling:  $\geq 8^{\circ}\text{C}$                       Heating:  $\geq 14^{\circ}\text{C}$

## FOR EXTENDED NON-USE

- Activate Heat mode for 2-3 hours to remove moisture left in the internal parts thoroughly to prevent mould growth.
- Turn off the power supply.
- Remove the remote control batteries.

## NON SERVICEABLE CRITERIAS

TURN OFF POWER SUPPLY then please consult authorized dealer under the following conditions:

- Abnormal noise during operation.
- Water/foreign particles have entered the remote control.
- Water leaks from Indoor unit.
- Circuit breaker switches off frequently.
- Power cord becomes unnaturally warm.
- Switches or buttons are not functioning properly.



# TROUBLESHOOTING

## The following symptoms do not indicate malfunction.

Symptom	Cause
Mist emerges from indoor unit.	• Condensation effect due to cooling process.
Water flowing sound during operation.	• Refrigerant flow inside the unit.
The room has a peculiar odour.	• This may due to damp smell emitted by the wall, carpet, furniture or clothing.
Indoor fan stops occasionally during automatic fan speed setting.	• This helps to remove the surrounding odours.
Airflow continues even after operation has stopped.	• Extraction of remaining heat from the indoor unit (maximum 30 seconds).
Operation is delayed a few minutes after restart.	• The delay is a protection to the unit's compressor.
Outdoor unit emits water/steam.	• Condensation or evaporation occurs on pipes.
Timer indicator is always on.	• The timer setting repeats daily once set.
Power indicator blinks during operation, the indoor fan is stopped and vane is closed.	• The unit is in defrost mode, and the melted frost is drained from the outdoor unit.
Indoor fan stops occasionally during heating operation.	• To avoid unintended cooling effect.
Power indicator blinks before the unit is switched on.	• This is a preliminary step in preparation for the operation when the ON timer has been set.
Cracking sound during operation.	• Changes of temperature cause the expansion/contraction of the unit.

## Check the following before calling for servicing.

Symptom	Check
Heating/Cooling operation is not working efficiently.	<ul style="list-style-type: none"> <li>• Set the temperature correctly.</li> <li>• Close all doors and windows.</li> <li>• Clean or replace the filters.</li> <li>• Clear any obstruction at the air inlet and air outlet vents.</li> </ul>
Noisy during operation.	<ul style="list-style-type: none"> <li>• Check if the unit has been installed at an incline.</li> <li>• Close the front panel properly.</li> </ul>
Remote control does not work. (Display is dim or transmission signal is weak.)	<ul style="list-style-type: none"> <li>• Insert the batteries correctly.</li> <li>• Replace weak batteries.</li> </ul>
The unit does not work.	<ul style="list-style-type: none"> <li>• Check if the circuit breaker is tripped.</li> <li>• Check if timers have been set.</li> </ul>
The unit does not receive the signal from the remote control.	<ul style="list-style-type: none"> <li>• Make sure the receiver not obstructed.</li> <li>• Certain fluorescent lights may interfere with signal transmitter. Please consult your nearest dealer.</li> </ul>
PATROL operation does not work.	<ul style="list-style-type: none"> <li>• Press and hold <b>PATROL</b> for 15 seconds until beep sound is heard, press <b>PATROL</b> again.</li> </ul>
Patrol sensor indicator on the indoor unit is blinking.	<ul style="list-style-type: none"> <li>• Press <b>PATROL</b> twice. If the patrol sensor indicator still blinking, please consult authorized dealer.</li> </ul>

## The unit stops and the timer indicator blinks.

Use remote control to retrieve error code.

- 1 Press for 5 seconds.
- 2 Press until you hear beep sound, then jot down the error code.
- 3 Press for 5 seconds to quit checking.
- 4 Turn the unit off and reveal the error code to authorized dealer.

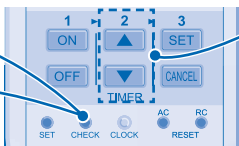

### Note:

- For certain error, you may restart the unit with limited operation with 4 beeps during operation starts.

# QUICK GUIDE

## Remote Control Preparation

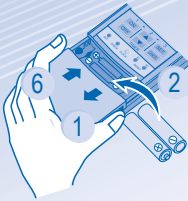

- 1 Press and pull out
- 2 Insert AAA or R03 batteries (can be used ~ 1 year)
- 3 Press CLOCK
- 4 Set time
- 5 Confirm
- 6 Close the cover

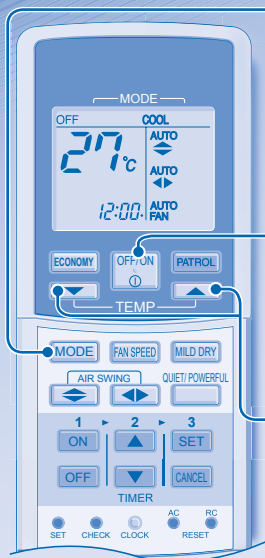
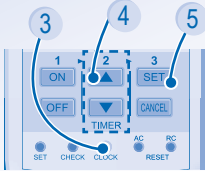

**1** MODE

Select the desired mode.

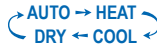

**2**

Start/stop the operation.



**3**

Set the desired temperature.



Panasonic Corporation

Website: <http://panasonic.net/>