



INSTRUCTIONS

-J05758

REV. 2015-04-14

LED TAIL LAMP

GENERAL

Kit Numbers

67800355, 67800356, 67800357, 67800358, 67800614, 67800615, 67800616, 67800617

Models

For model fitment information, see the P&A Retail Catalog or the Parts and Accessories section of www.harley-davidson.com (English only).

Additional Parts Required

NOTE

This instruction sheet references service manual information. A service manual for your model motorcycle is required for this installation, and is available from a Harley-Davidson Dealer.

Kit Contents

See Figure 3 and Table 1.

INSTALLATION

For models **WITH** main fuse:

⚠ WARNING

To prevent accidental vehicle start-up, which could cause death or serious injury, remove main fuse before proceeding. (00251b)

1. Refer to the owner's manual and follow the instructions to remove the seat and main fuse. Retain all seat mounting hardware.

For models **WITHOUT** main fuse:

⚠ WARNING

To prevent accidental vehicle start-up, which could cause death or serious injury, disconnect negative (-) battery cable before proceeding. (00048a)

NOTE

*For 2004 and later XL (Sportster®) models, the negative battery cable is most easily disconnected **at the engine crankcase**.*

1. Refer to the owner's manual and follow instructions to remove seat and disconnect negative (black) battery cable from negative battery terminal. Retain all seat mounting hardware.

NOTE

Figure 1 shows the original equipment tail/stop lamp mounted to a full fender.

2. See Figure 1. Loosen the two screws (2) retaining the tail/stop lamp assembly (1) to the lamp base (3). Pull the lamp assembly away from the base.
3. Push the locking tab (button), and disconnect the tail/stop lamp connector [93B] (4) from the circuit board. Remove the lamp from the vehicle.

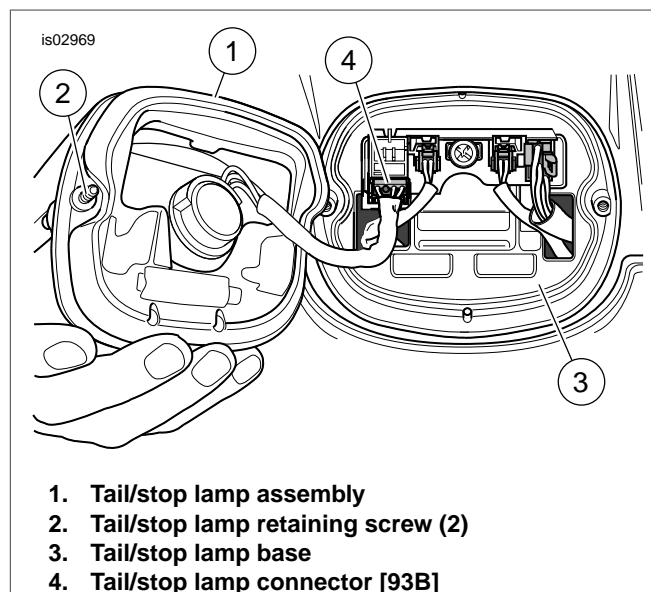

Figure 1. Removing the Tail/Stop Lamp Assembly

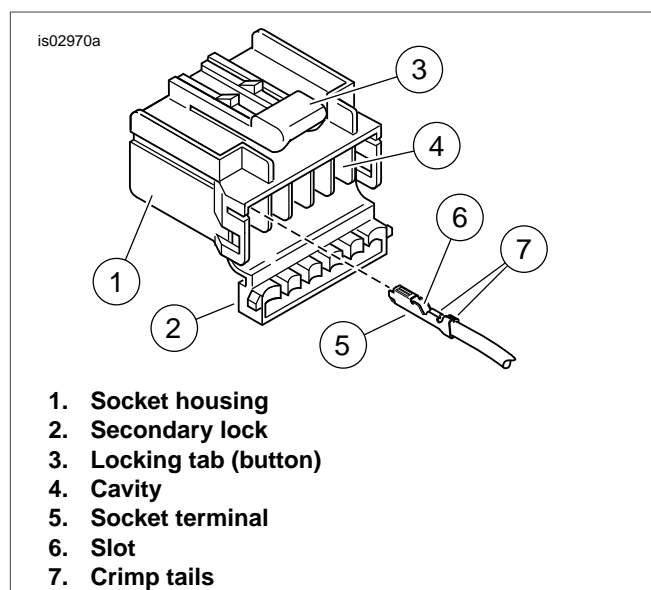

Figure 2. Socket Terminal Installation

4. On the **new** tail/stop lamp assembly, the wires and socket terminals are not installed in the four-way socket housing.

Refer to the original lamp removed in Step 3, and observe which cavity contains which wires.

The cavities are numbered on the face of the secondary lock. The blue, red/yellow and black wires and terminals must be installed into the **same** cavities in the socket housing of the new lamp as follows:

- a. See Figure 2. On the secondary lock (2) side of the socket housing (1), position the socket terminal (5) with the slot (6) and crimp tails (7) facing up (in the same direction as the button (3) on the top of the socket housing).
- b. Insert the terminal into the correct cavity 1, 2, 3 or 4 (4) until it snaps into place with an audible "click".
- c. Gently tug on wire ends to verify that all terminals are locked.
- d. Rotate the hinged secondary lock inward until tabs fully engage latches on both sides of connector.

NOTES

If the terminal must be removed and reinstalled, refer to the **MULTILOCK ELECTRICAL CONNECTORS** section of the appropriate Service Manual.

Fill pin cavities in the circuit board with dielectric grease from the packet in the kit before assembling connector halves.

- 5. Connect the socket housing on the **new** tail/stop lamp assembly to the four-way pin housing in the circuit board.

NOTE

Do not over-tighten screws. Over-tightening the screws can crack the tail/stop lamp lens or scratch the fender paint.

- 6. Install the tail/stop lamp to the vehicle. Alternately tighten the screws to 20-24 **in-lbs** (2.3-2.7 Nm).

NOTE

See Figure 1. Lamp assembly (1) attaches as shown on full fender models.

NOTICE

Do not over-tighten bolts on battery terminals. Use recommended torque values. Over-tightening battery terminal bolts could result in damage to battery terminals. (00216a)

- 7. Verify that the ignition/ light key switch is in the OFF position.

Models WITH main fuse: Refer to the Owner's Manual and follow the instructions to install the main fuse.

Models WITHOUT main fuse: Connect the negative battery cable per the instructions in the Owner's Manual.

Apply a light coat of petroleum jelly or corrosion retardant material to battery terminals.

Refer to the Owner's Manual, and follow the instructions to install the seat.

WARNING

After installing seat, pull upward on seat to be sure it is locked in position. While riding, a loose seat can shift causing loss of control, which could result in death or serious injury. (00070b)

WARNING

Be sure headlamp, tail and stop lamp and turn signals are operating properly before riding. Poor visibility of rider to other motorists can result in death or serious injury. (00478b)

- 8. Turn the ignition/ light key switch to ON, but do not start motorcycle. Check operation of all lamps.

SERVICE PARTS

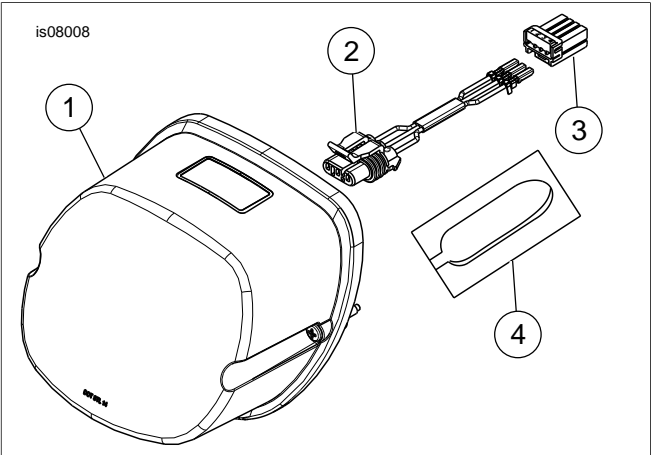

Figure 3. Service Parts

Table 1. Service Parts Table

Item	Description	Part Number
1	Lens	Not sold separately
2	Tail lamp jumper harness	69200905
3	4-way socket housing	73154-96BK
4	5 gram package dielectric grease	76001-04