



# INSTRUCTIONS

-J02821

REV. 2003-04-14

## SISSY BAR SIDE PLATE KIT

### GENERAL

#### Kit Number

53925-04

#### Models

This kit is designed for installation on all 2004 and Later XL Sportster® model motorcycles.

### WARNING

**The rider's safety depends upon the correct installation of this kit. Use the appropriate service manual procedures. If the procedure is not within your capabilities or you do not have the correct tools, have a Harley-Davidson dealer perform the installation. Improper installation of this kit could result in death or serious injury. (00333a)**

#### NOTE

*This instruction sheet references Service Manual information. A Service Manual for your model motorcycle is required for this installation and is available from a Harley-Davidson Dealer.*

#### Kit Contents

See Figure 1 and Table 1.

### INSTALLATION

#### NOTE

*When removing rear fender reflectors, be careful not to damage fender paint.*

1. Carefully remove the rear reflector. Remove any remaining adhesive from the back side of the reflector and any adhesive from the side of the fender.
2. See Service Parts Illustration. Remove the screws, washers, locknuts and clipnuts that attach the fender support cover and fender support to fender. Discard the button head screws but retain the washers (A), locknuts (B,C) and clipnuts (D) for installation.

#### NOTE

*Prior to performing the following step, obtain a little slack for the turn signal assembly by reaching under the fender and bending open the aluminum tab on the clip securing wiring to fender.*

3. Remove the locknut (B) from the turn signal stud (E) and gently remove the turn signal assembly from fender support cover, fender support and fender. Save locknut for installation. The turn signal will remain loosely attached to motorcycle by rear directional wire.
4. Carefully position the side plate between fender support and fender. While holding sideplate in position, line up the screw mounting holes and make sure the turn signal wiring passes through the cutout (slot) in the side plate. Coat threads of screws (1 and 2) from kit with Loctite 243 (blue) (Harley-Davidson part number 99642-97) and install locknut and clipnut, however do not tighten completely.
5. Add Loctite 243 (blue) (Harley-Davidson part number 99642-97) to turn signal stud and install through fender support cover, fender support, side plate and fender. Install locknut and tighten to 8-13 ft-lbs (11-18 Nm). Making sure sideplate remains aligned, return to fender support screws and tighten to 8-13 ft-lbs (11-18 Nm).
6. Reach under fender and position turn signal wiring into tab on clipnut.
7. Obtain reflector (3) from kit. Peel off protective strip backing and firmly press reflector (3) to side plate (4), centering reflector horizontally and vertically.
8. Repeat steps 1 through 7 on opposite side of fender.

### WARNING

**Federal Motor Vehicle Safety Standard (FMVSS) 108 requires motorcycles to be equipped with rear and side reflectors. Be sure rear and side reflectors are properly mounted. Poor visibility of rider to other motorists can result in death or serious injury. (00336b)**

### SERVICE PARTS

See Figure 1 and Table 1.

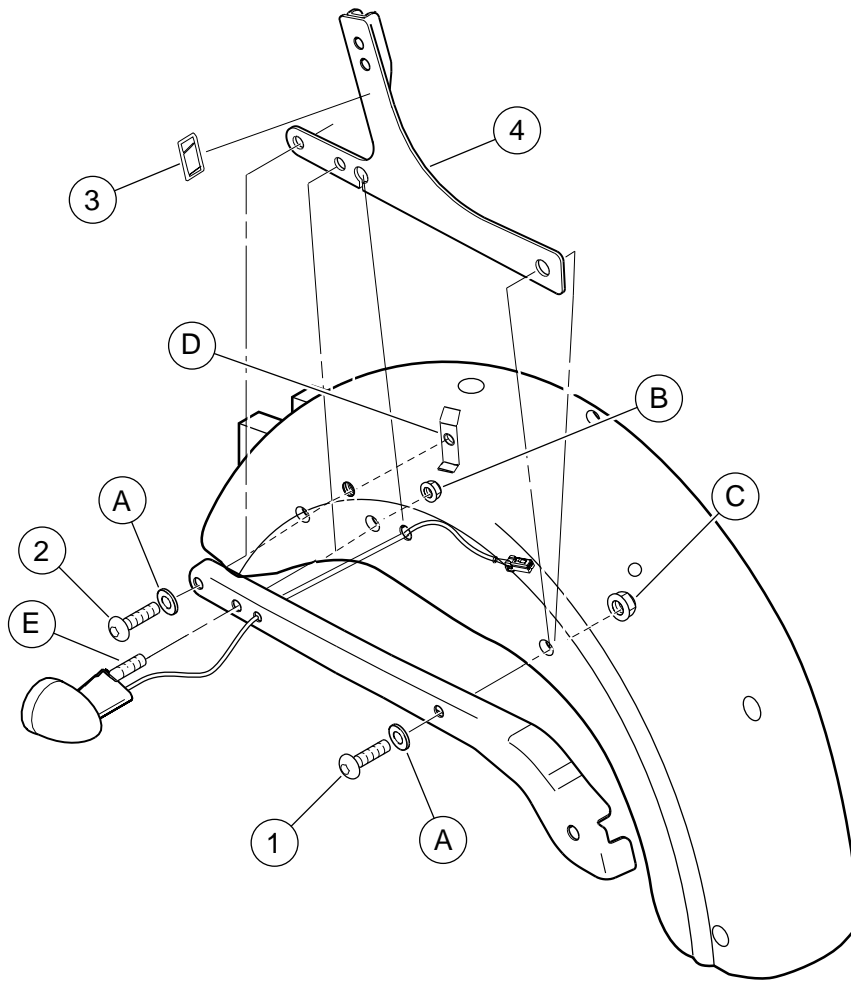

**Figure 1. Service Parts: Sissy Bar Side Plate Kit**

**Table 1. Service Parts Table**

Item	Description (Quantity)	Part Number
1	Screw, TORX 1-3/4 inch (2)	4783
2	Screw, TORX 1-3/8 inch (2)	4187
3	Reflector, framed red (2)	59259-90
4	Side plate, rigid (right side)	53927-04
5	Side plate, rigid (left side), (not shown)	53926-04
<b>Items mentioned in text, but not included in kit:</b>		
A	Washer	
B	Locknut	
C	Locknut	
D	Clipnut	
E	Turn signal stud	