

Clad Casemaster Produced Before 3/31/03

Reglazing Instructions

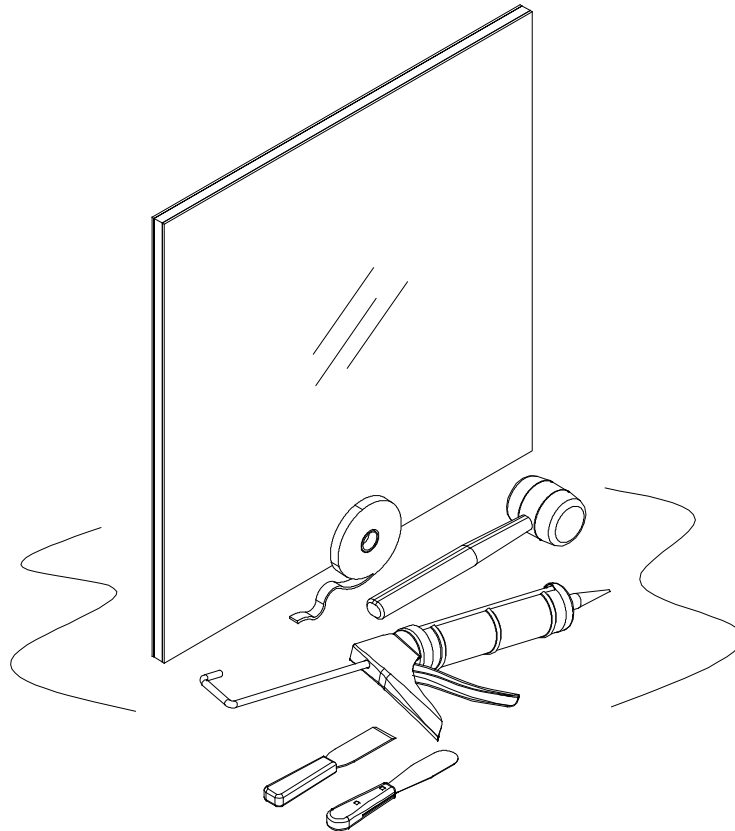

BEFORE YOU BEGIN

- Read these instructions thoroughly **BEFORE** beginning to reglaze your Marvin window or door product.
- Alterations to Marvin products including window films, insulating or reflective interior window treatments or additional glazings can cause excessive heat buildup and/or condensation. This may lead to premature failures not covered under warranty by Marvin Windows and Doors.
- Prior to beginning, inspect new glass for: size and type, cracks, scratches, collapse, water spots, dirt or other imperfections.

- Replacement parts listed within these instructions may be obtained by contacting your Marvin representative.

WARNING: Practice safety! Wear safety glasses or goggles and appropriate safety equipment when installing or performing adjustments to a Marvin window or door product.

ATTENTION: Specifications and technical data are subject to change without notice.

NOTE: Numbers listed in parentheses () are metric equivalents in millimeters rounded to the nearest whole number.

The following **EXTERIOR GLAZED** product incorporates an interior glass rabbet, interior sealant glazing, exterior vinyl glazing bead and exterior aluminum glazing cap.

INDEX	Page
Reglazing Exterior Glazed Sash	6.1.7
Removing Old Glass	6.1.7
Installing New Glass	6.1.8

REGLAZING EXTERIOR GLAZED SASH

STANDARD PARTS NEEDED

Exterior vinyl glazing bead
 Aluminum glazing cap
 Replacement glass

YOU WILL NEED TO SUPPLY

Safety glasses	Protective gloves
Small pry bar	Side cutter
Rubber mallet	Stiff bladed putty knife
Flexible putty knife	
Grade NS Class 25 sealant per ASTM C920	

CAUTION: Use extreme care when reglazing or handling broken glass. Always use proper eye and hand protection.

Removing Old Glass

1. If possible, remove sash from frame and place on flat sturdy surface exterior side up (stationary sash are normally reglazed in position).

2. If applicable, remove aluminum glazing cap by sliding a small pry bar between the cap and glass and prying away from the vinyl glazing bead. See illustration 1.

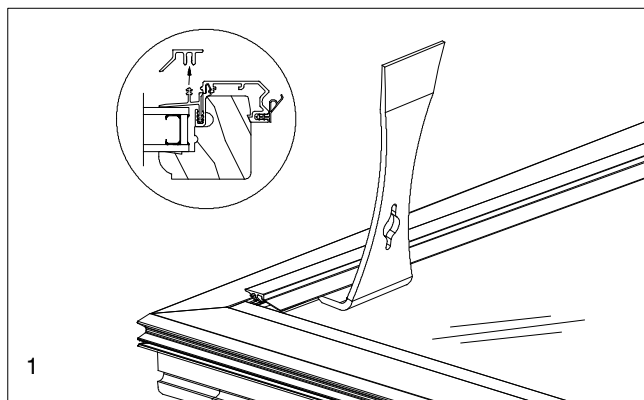

NOTE: Not necessary on clad sash that use only an exterior vinyl glazing bead.

3. Remove vinyl glazing bead from the sash leg by prying up with a small pry bar as shown in illustration 2.

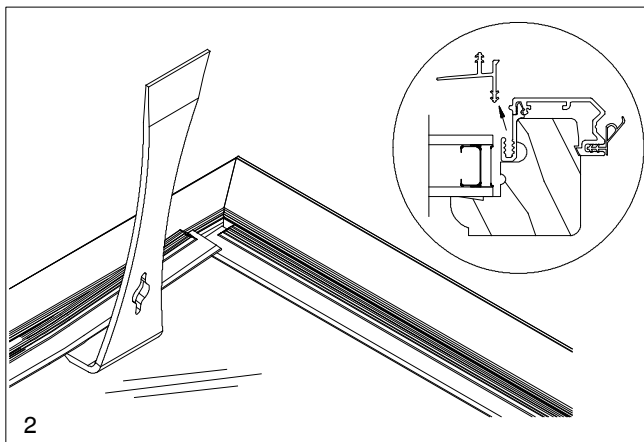

CAUTION: If reglazing sash installed in unit frame, assistance will be necessary while attempting the following procedures. Glass may fall out if not held in place from the exterior while cutting the interior glazing seal.

4. Carefully turn sash over. Slide a flexible putty knife between interior glass rabbet and glass. Push knife around perimeter of glass. See illustration 3. More than one pass may be needed to completely free glass from sash frame. If necessary carefully push the glass out from interior and remove. Note position of setting blocks, remove, and set aside for later use.

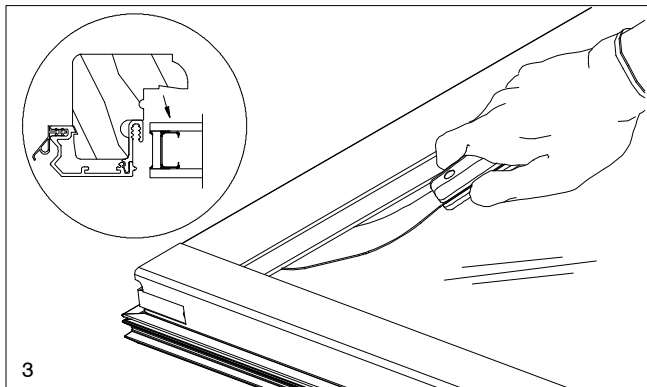

5. Clean all remaining glazing sealant or adhesive tape residue from glass rabbet. It is very important that glazing surfaces are free from debris to ensure a proper seal on new glass.

Installing New Glass

CAUTION: Always wear proper eye and hand protection when handling replacement glass.

6. Run a 3/16" - 1/4" (5-6) bead of sealant on the interior glazing bevel of glass rabbet as shown in illustration 4.

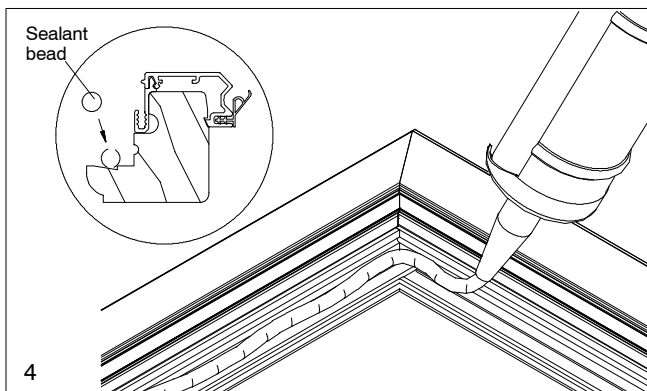

NOTE: If reglazing with sash installed in frame be sure to replace setting blocks on bottom rail prior to installing glass.

7. Carefully set replacement glass into sash frame. If reglazing with sash installed set bottom of glass on bottom rail then tip into place.
8. Glass must be blocked on bottom rail and at least one side at quarter points before the sealant sets. If possible reuse glass setting blocks removed previously. See illustration 5 for correct location of setting blocks. Press glass into sealant at edges to ensure a proper seal.

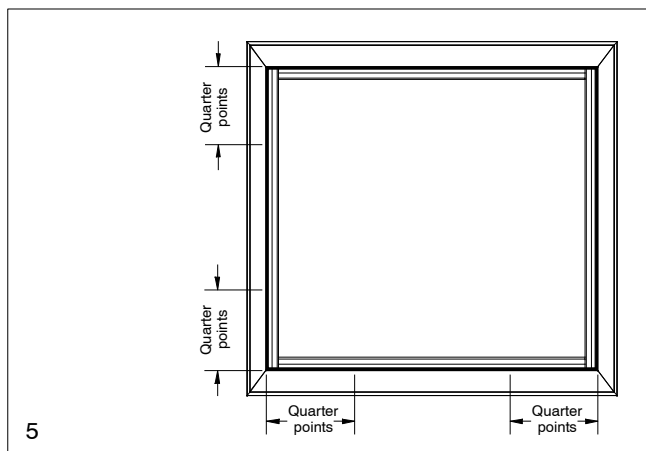

9. Starting with the rails, install vinyl glazing bead. Press connecting barb into sash cladding glazing leg as shown in illustration 6. Next, install stile glazing bead flush against rail bead.

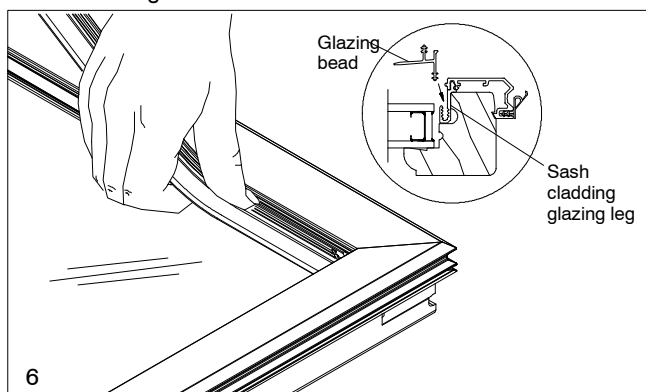

10. If applicable, install aluminum glazing cap, starting with the rails first. Slide cap flush with sash cladding and tap onto vinyl glazing bead connecting barb with a rubber mallet as shown in illustration 7. Install stile glazing cap in the same manner flush against rail cap.

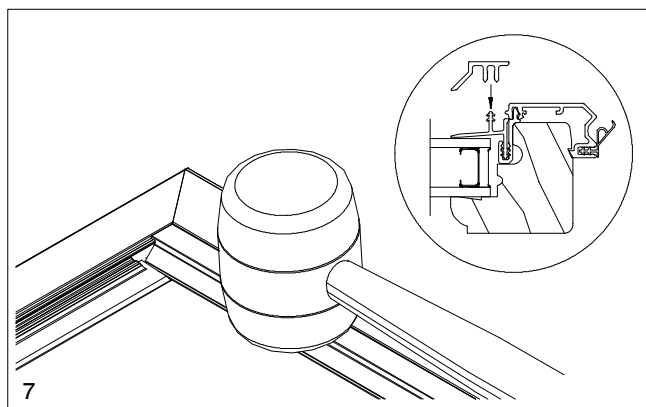

11. Replace sash if removed from frame.

NOTE: Do not clean excess sealant from glass until fully cured (at least 24 hours).