

**BEFORE YOU BEGIN**

Check replacement panel and parts for damage and that the replacement panel has been manufactured with the same specifications as the panel being replaced, such as size, glazing, finish and lite cut, prior to proceeding with the replacement of your Ultimate Sliding French Door and Sliding Patio Door Stationary Panels.

*NOTE: This instruction can be used to replace the stationary panel on all configurations of sliding doors except on the non-interlocking stationary panel on the Sliding Patio Door.*

INDEX	Page
Stationary Panel Removal .....	9.2.2
Stationary Panel Installation .....	9.2.4

**YOU WILL NEED TO SUPPLY**

- |   |                      |
|---|----------------------|
| Safety glasses                                | Hammer               |
| Stiff putty knife                             | Phillips screwdriver |
| Hearing protection                            | Wood block           |
| Rubber mallet                                 | Masonry chisel       |
| Sealant - ASTM C920 Class NS 25 or equivalent |                      |

**PARTS NEEDED**

- 1 - Stationary panel
- 1 - Head jamb bracket (2 for IZ3)
- 4 - #8 x 1" flat head screws (8 for IZ3)
- 4 - Side jamb brackets (8-0 panel requires 5 brackets)
- 8-10 - #7 x 5/8" flat head screws, side jamb bracket to jamb
- 8-10 - #7 x 1 1/4" flat head screws, side jamb bracket to panel



**WARNING! Improper use of hand or power tools could result in personal injury and/or product damage. Follow equipment manufacturer's instructions for safe operation.**



**WARNING: Operator Panel is heavy, take care not to let the panel fall. Assistance is recommended for this procedure.**

**Stationary Panel Removal**

*NOTE: Clad unit shown for illustrative purposes. Unless otherwise noted all parts are to be saved for reinstalling the new stationary panel.*

1. Sliding door units with screens will need to have the screen removed and placed aside. For removal refer to the appropriate instruction for your screen type.
2. Remove the header and sill bumper blocks from the stationary side of the unit. See illustration 1.

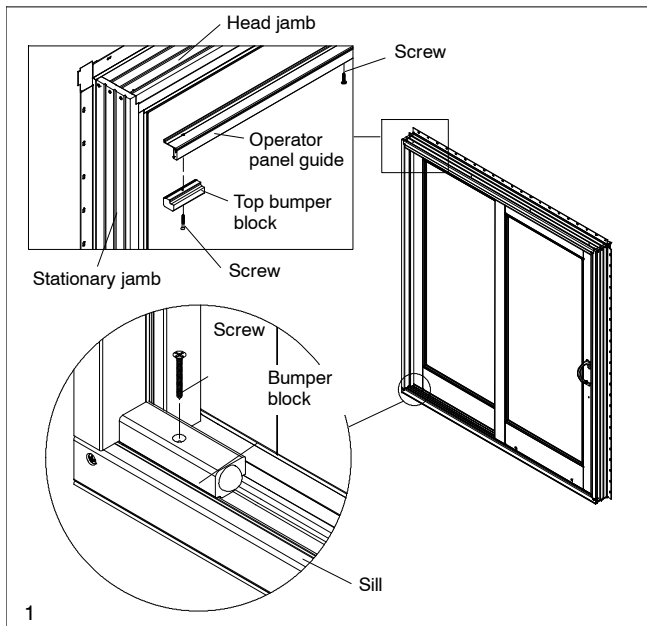

3. Slide operating panel to the stationary jamb side of the frame. Remove exposed screws securing the panel guide to the head jamb. Next, move the operating panel to the closed position and remove remaining screws securing the panel guide to the head jamb. See illustration 2.

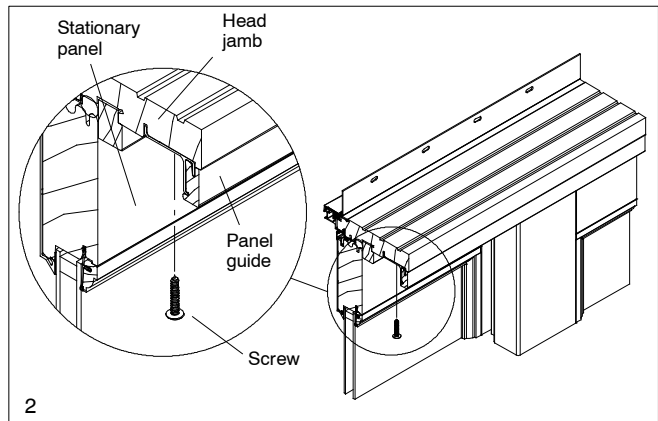

4. Open operating panel and allow door panel to tilt inward, lift panel guide off of top stile. Save for reuse later. Lift upward on panel until rollers are disengaged from the sill and remove from frame. See illustration 3.

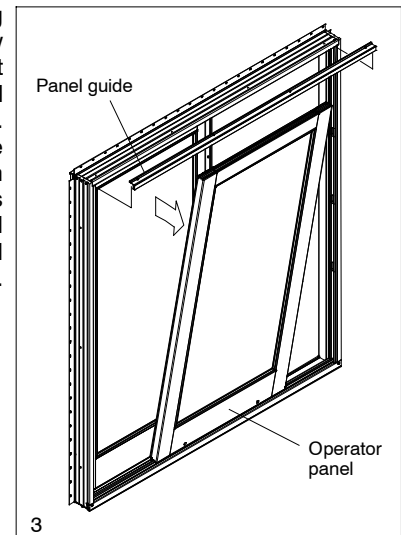

19972102

# STATIONARY PANEL REMOVAL AND REPLACEMENT

- Remove the stationary panel cover by backing out the three flat head screws fastening it to the head jamb. Remove the backer rod located between the panel and header. See illustration 4.

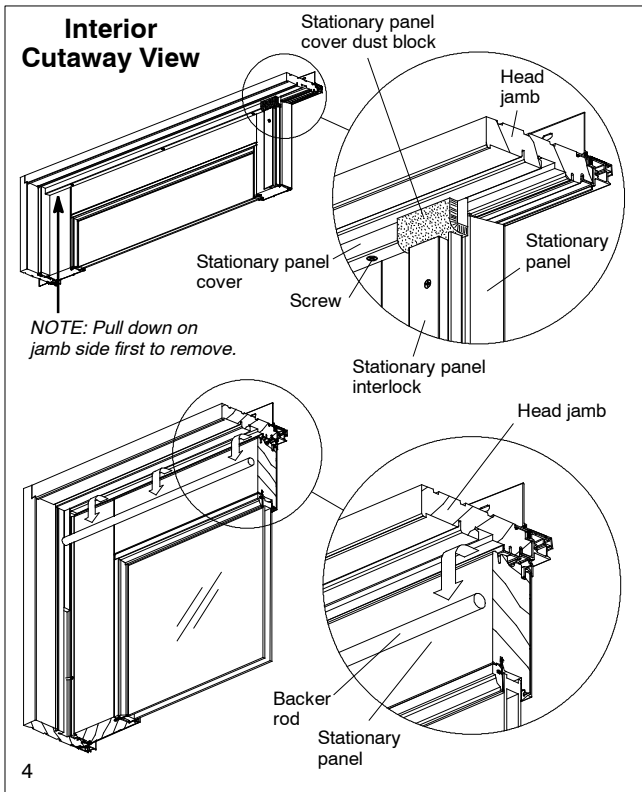

- Starting at the top, remove the stationary jamb cover using a stiff putty knife. Note: The cover is attached to the jamb by a vinyl barb. See illustration 5.

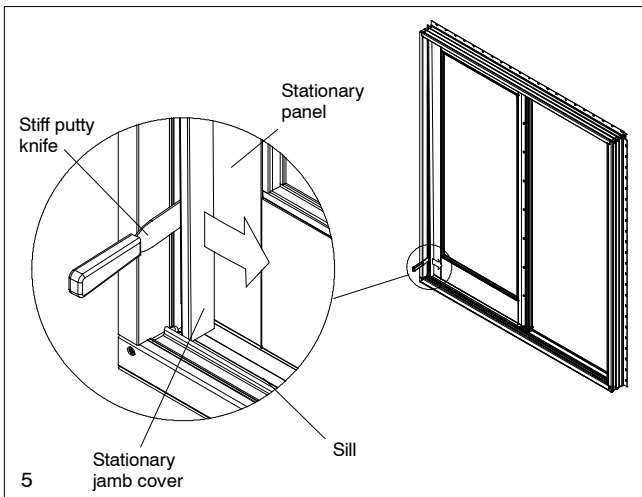

- Remove the condensation cover from the sill by using a stiff putty knife. Note: The condensation cover is secured to the sill by a vinyl barb. See illustration 6.

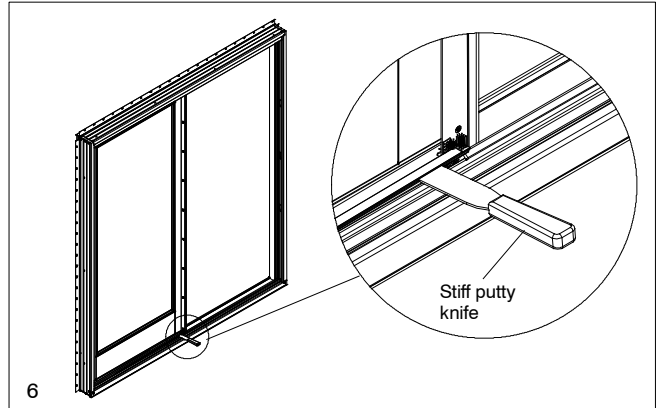

- If your panel has a head jamb bracket, remove the two screws (or 4 screws for IZ3) and bend the bracket(s) down until it is parallel with the head jamb. See illustration 7a. If your panel does not have a head jamb bracket, locate the screw that is installed through the header and into the interlocking stile. Cut the screw by using a masonry chisel and hammer. See illustration 7b.

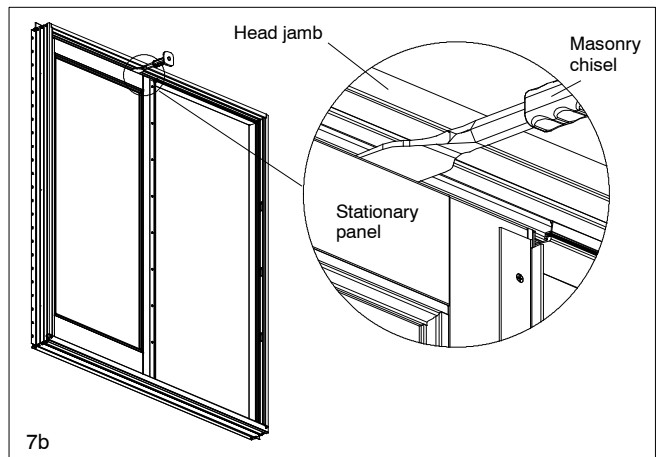
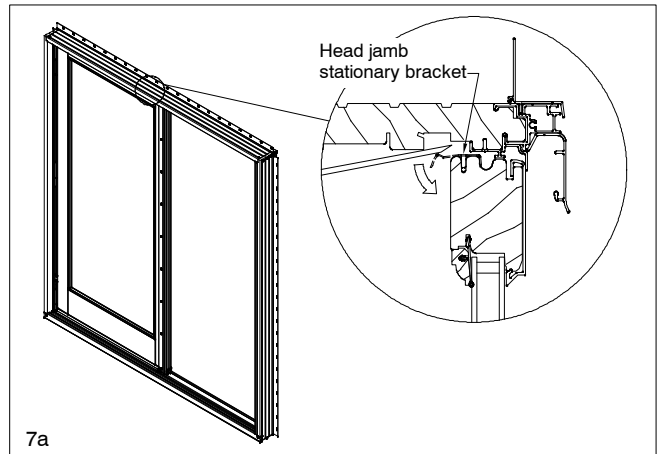

# STATIONARY PANEL REMOVAL AND REPLACEMENT

9. Locate three screws that are installed through the jamb into the stationary panel. Cut the screws by using a masonry chisel and hammer and remove the three stationary jamb fillers. *Note: Discard the fillers.* See illustration 8.

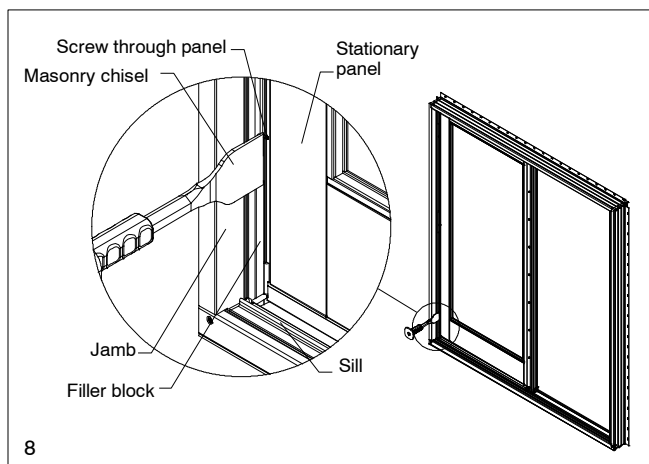

10. Remove the head jamb part stop by inserting a putty knife, from exterior, between the part stop and header and pry down gently. See illustration 9.

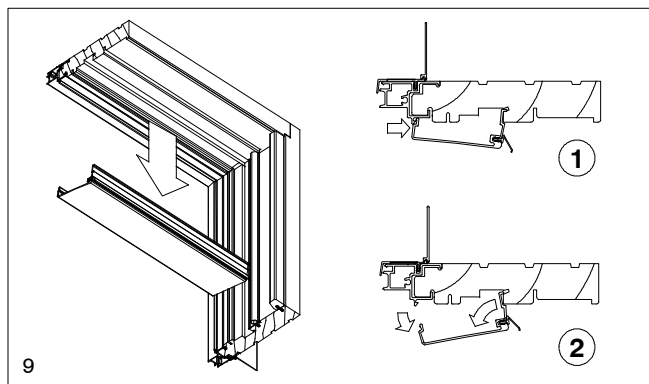

11. Slide the stationary panel 1/2" away from the stationary jamb to disengage the stile from the jamb. Tilt the stationary panel in from the top and slide the bottom of the panel toward the interior to unlock the leveling block from the stationary panel retainer. Lift and remove the stationary panel. See illustration 10.

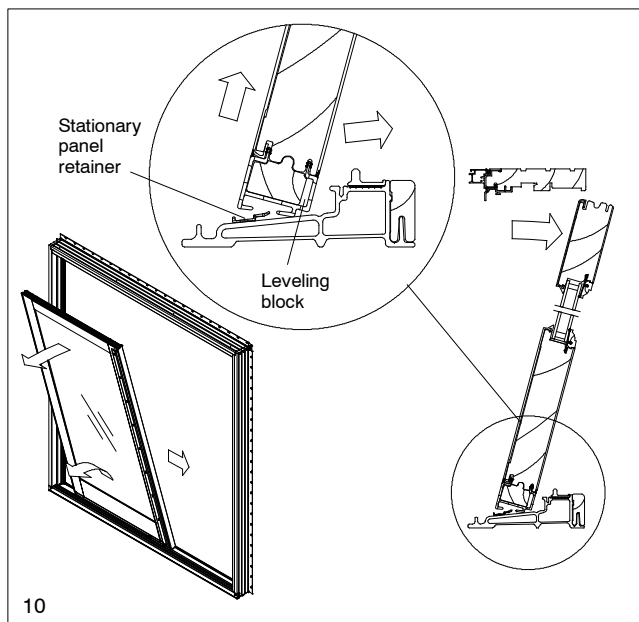

## Installing Stationary Panel

1. Fasten 4 (5 on 8-0) side jamb brackets to the jamb side of the stationary interlock panel and/or stationary panel through the predrilled holes with #7x 1 1/4" flat head screws. See illustration 11a.
2. Fasten stationary head jamb bracket(s) to the stationary interlock panel through the predrilled holes with #8x1" flat head screws. See illustration 11b.

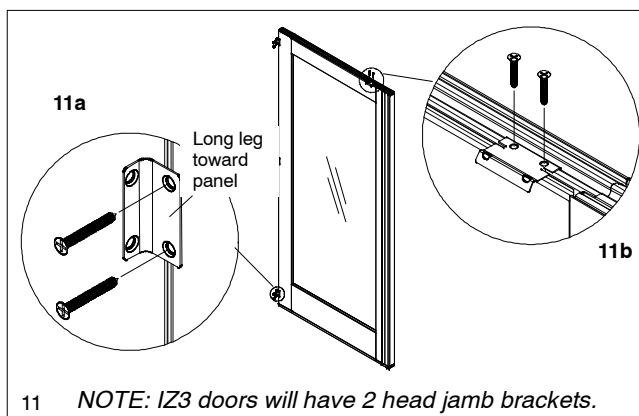

NOTE: IZ3 doors will have 2 head jamb brackets.

3. From the interior place the stationary panel(s) 6" away from the jamb at an approx. 75 degree angle. For 3 wide units install non-interlocking panel first followed by the stationary interlocking panel. See illustration 12.

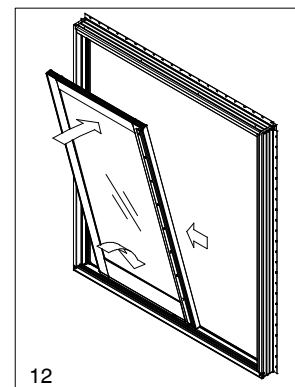

# STATIONARY PANEL REMOVAL AND REPLACEMENT

4. Insert the panel leveling block with the sill clip. See illustration 13. Tilt panel to 90 degrees and slide to side jamb.

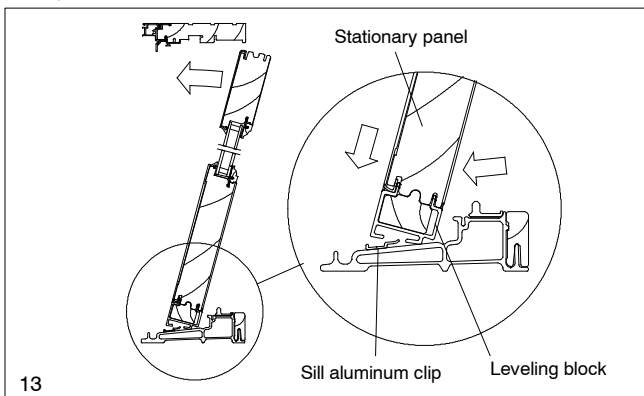

5. Fasten the interlock (and stationary panel) side jamb brackets to the side jamb (and center jamb for 3 wide units) with #7x5/8" flat head screws. See illustration 14.

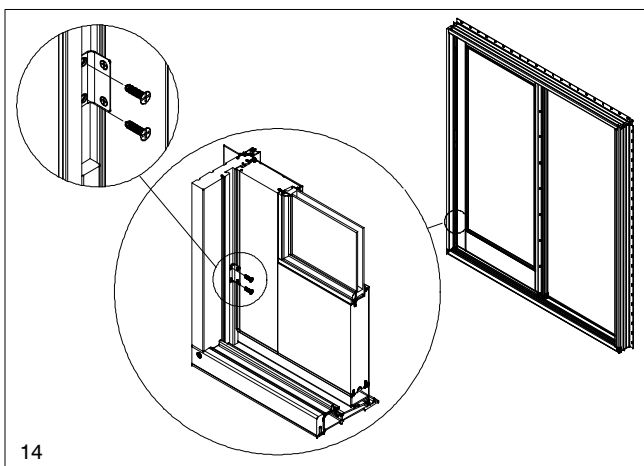

6. Reinstall the backer rod between the panel and header. See illustration 15.

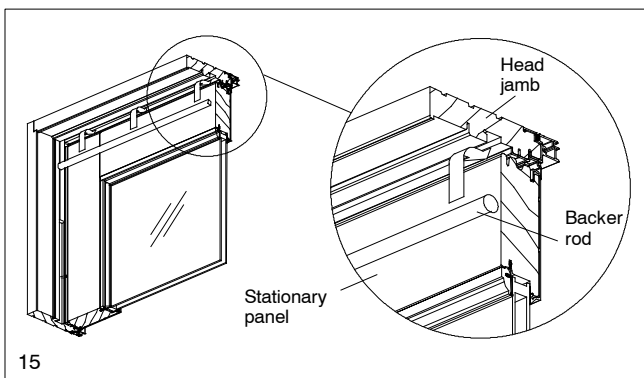

7. Use a stiff putty knife to bend the head jamb brackets into place. See illustration 16. Fasten the head jamb bracket to the head jamb with four #8x1" flat head screws placed at a 45° angle. See illustration 16.

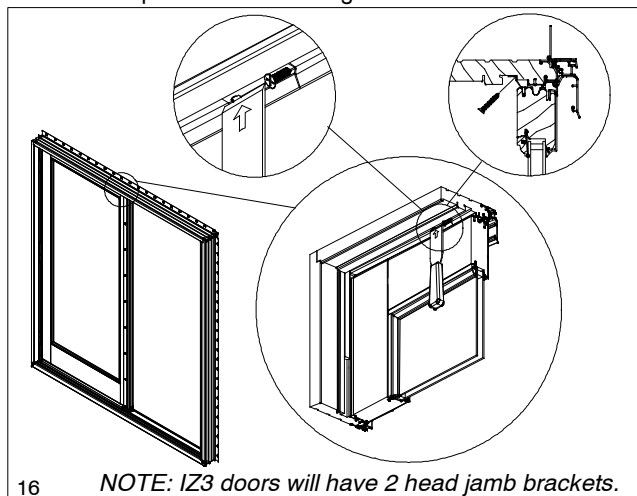

8. Place the dust block end of condensation cover under interlock and slide into place. Tap until seated with a wood block and rubber mallet. See illustration 17.

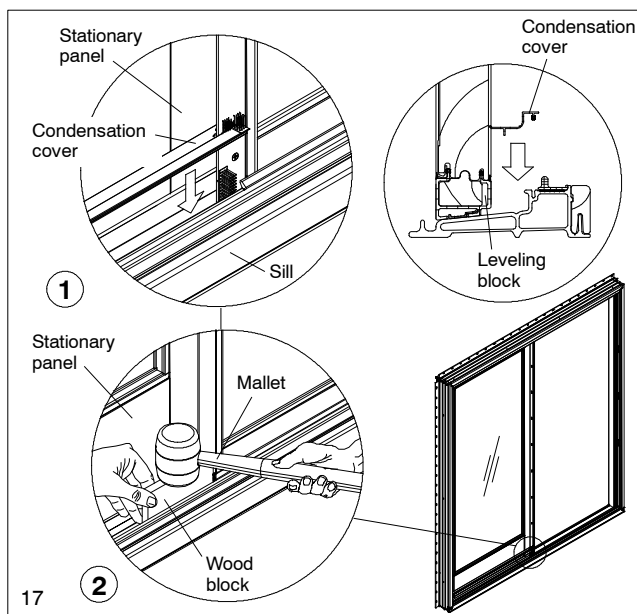

9. Reinstall head jamb part stop. See Illustration 18.

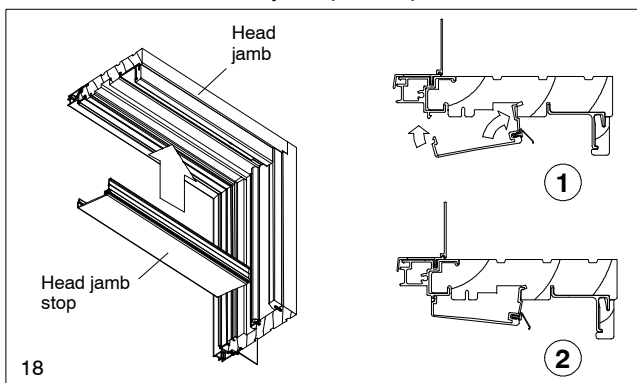

# STATIONARY PANEL REMOVAL AND REPLACEMENT

10. To reinstall the stationary jamb cover, place sealant with a continuous bead starting 6" from sill and continue down to the end of wood grain and continue along the sill to the interior oak sill liner. Next install the stationary jamb cover using a wood block and rubber mallet. See illustration 19.

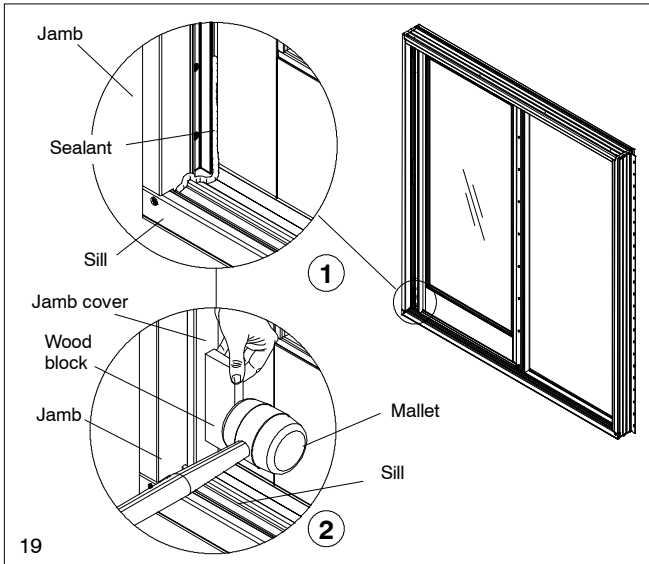

11. Insert dust block end of stationary panel cover over interlock and slide into place. Fasten the stationary panel cover with three screws. See illustration 20.

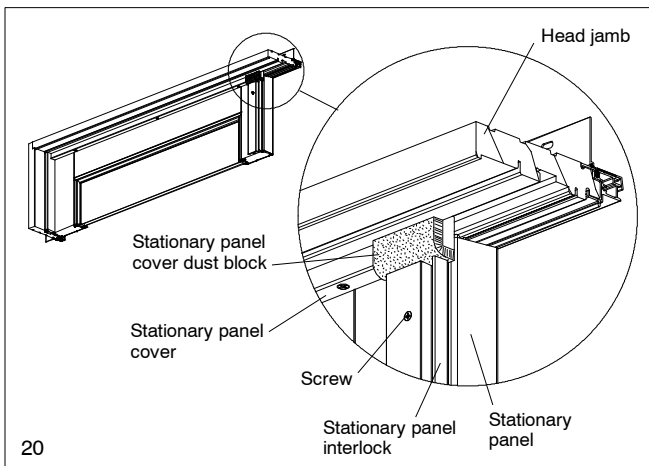

12. Reinstall bottom bumper block. See Illustration 21.

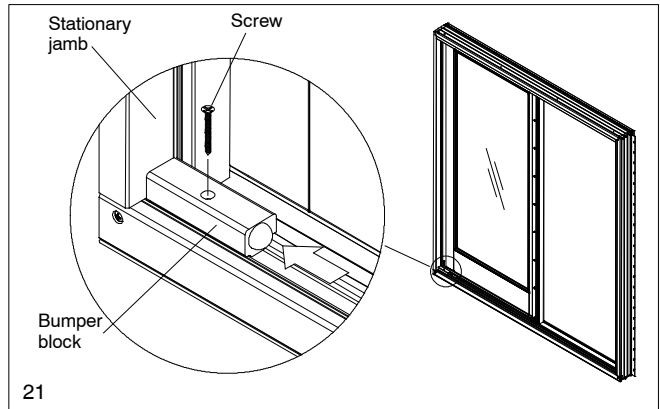

13. Set the operator panel onto the track. Reinstall the operator panel guide and top bumper block. See illustration 22.

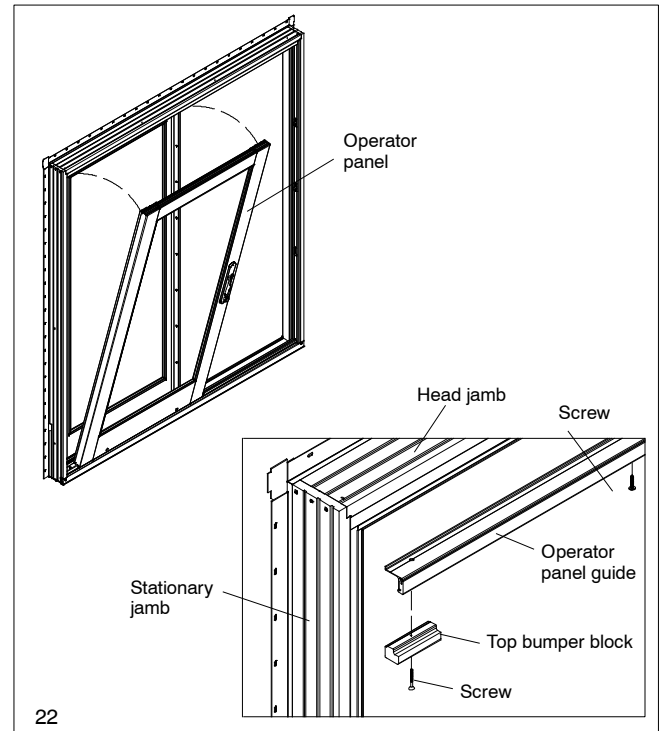

14. On units with screens, reinstall screen.