



RIVA RACING

PERFORMANCE PRODUCTS & ACCESSORIES

RXP Pro-Series Power Filter Kit

PART# - RS13056

APPLICATION(S): Sea-Doo RXP (all models)

Required tools

1/4" Drill Bit
2-3/8" Hole Saw Bit
Torx screw adapter (`04~05 models)

Part#

N/A
N/A
N/A

Recommended tools

Hydraulic Press
Service Manual

Part#

N/A
Please call

***** NOTE: Allow craft's engine to cool thoroughly before performing installation. *****

- INSTALLATION INSTRUCTIONS -

1. Remove D.E.S.S. lanyard and disconnect battery cables.
2. Unclip engine coolant overflow tank, remove from engine compartment cowling and lay on top of engine. Take care not to tip overflow tank allowing coolant to drain.
3. Remove engine compartment cowling by first removing the two forward-most M10 socket head cap bolts and rear-most M10 socket head cap bolt completely (see illustration #1). Remove the two remaining M10 socket head cap bolts and clamps completely at lower inside rear edge of engine compartment cowling. (see illustration #2)
4. Install the supplied pre-filter adapter onto the grab handle. (see illustration #3) Using the adapter bolt hole locations as a guide drill two 1/4" holes. Secure adapter to grab handle using supplied M6 bolts, washers and nuts. **NOTE: Do not over tighten bolts.**
5. From inside of engine compartment cowling drill two 2-3/8" holes (one on each side) using a hole saw bit through both inner and outer pieces of cowling. (see illustration #4) **NOTE: It is important that you drill in the exact area specified in the illustration from the inside and the holes are no larger than 2-3/8" in diameter.**
6. Smooth edges of 2-3/8" holes. Carefully install supplied Flo-rite[®] vents from outside of engine compartment cowling. (see illustration #5) **NOTE: It is important that you make sure the vents "securely snap" into place. Inspect from inside after installing.**
7. Remove regulator/rectifier from air intake and install onto supplied aluminum bracket using supplied hardware (M6 x 35mm socket head cap bolts, M6 flat washers and M6 nylock nuts). (see illustration #7)
8. Mount regulator/rectifier bracket:
`09 Models:
 1. At right side of lower hood cowling remove the plastic side cover. (see illustration #6)
 2. Where the hull is visible through the hood cowling drill a 5/16" hole dead center. (see illustration #7)
 3. Mount regulator/rectifier bracket to inside of hull using supplied M8 bolt, M8 washers and M8 nylock nut. (see illustration #9)
 4. Replace plastic side cover.
`08 Models see illustration #10.
`07 & Older Models see illustration #11.
9. `08 Models ONLY. `07 & Older Models Proceed to Step 10.
 - 9.1. It is necessary to modify the stock wiring harness so the connectors will reach the regulator/rectifier. Carefully unwrap the electrical tape and slice open the protective sheathing securing the regulator/rectifier connectors where they are spliced into the wiring harness. (see illustration #10)
 - 9.2. Cut the supplied split loom sheathing in half. Separate the regulator/rectifier wires from the other wires. Place one half around the regulator/rectifier wires and the other around the exposed wiring harness. (see illustration #12) Secure using electrical tape.
10. Reconnect regulator/rectifier to wiring harness.

11. Remove OE intake ducting from supercharger inlet forward and discard. (see illustration #13) If using an aftermarket air intake system completely remove it and any hardware associated and discard. Retain engine breather hose.
12. Remove connection to supercharger outlet.
13. Disconnect exhaust gooseneck from exhaust manifold. Disconnect left muffler restraining strap and slide muffler rearward.
14. Remove the three M6 x 35mm Torx bolts (2 lower/front & 1 upper/rear) securing supercharger unit to engine. (see illustration #14) **NOTE:** You will need a special Torx adapter to remove and replace upper/rear Torx bolt. This can be purchased through our parts department, at any Sea•Doo Dealer or through a reputable tool company.
15. Remove supercharger unit from engine.
16. Liberally coat inside of supplied adapter with glass cleaner. Install adapter onto supercharger housing inlet using a manual press by slowly pressing ring onto housing until it seats completely. (see illustration #15) If a manual press is not available place adapter inlet side down on a smooth, clean surface. Insert supercharger inlet into adapter and press straight downward. Be sure to apply even force with both hands. **NOTE: You will hear a distinctive “snap” when adapter installs completely. Inspect inside of adapter/supercharger inlet to ensure there is not a gap.** (see illustration #16)
17. Inspect o-rings on engine side of supercharger housing. If either is damaged replace both.
18. Coat unpainted area on engine side of supercharger unit with anti-seize and install into engine. **NOTE:** It may be necessary to rotate supercharger impeller to allow supercharger gear to mesh with flywheel gear.
19. Secure supercharger unit to engine using the three OE M6 x 35mm bolts removed in step 14. **NOTE: Use BLUE Loc-Tite. Torque to 22 ft•lbs / 30 N•m.**
20. Replace connection to supercharger outlet.
21. Liberally coat outside of supercharger adapter with glass cleaner. Install supplied coupler and two large hose clamps onto adapter completely. (see illustration #17)
22. Liberally coat flange on supplied Power Filter Tube with glass cleaner and install into silicone coupler completely. (see illustration #18) **NOTE:** This step cannot be rushed and/or forced. Insert tube into coupler at a slight angle. Be sure Power Filter Tube inserts completely into coupler and against adapter.
23. While pushing Power Filter Tube towards supercharger slide coupler towards tube (rotating slightly will ease process). Tighten clamp securing coupler to adapter. (see illustration #19) **NOTE: Do not over tighten clamp.** Loosely tighten second clamp securing Power Filter Tube to coupler.
24. Replace engine compartment cowling. Do not secure. Ventilation opening at grab handle will insert into Power Filter Tube. (see illustration #20) **NOTE: If engine compartment cowling does not meet hull DO NOT FORCE DOWN.** Power Filter Tube can be cut down to allow engine compartment cowling to meet hull.
25. If there is a gap between engine compartment cowling and hull (see illustration #20) remove engine compartment cowling and Power Filter Tube. There are seven lines molded into the outside of inlet end of Power Filter Tube. These are to aid in trimming down Power Filter Tube to allow engine compartment cowling to meet hull. **NOTE:** Due to variances in engine compartment cowlings we cannot give an exact amount to remove from Power Filter Tube. We recommend removing only 2 sections initially if your engine compartment cowling is approximately 1” above hull.
26. Smooth edge of Power Filter Tube and test fit again. Remove additional sections as needed. **Remove one section at a time!** You will know you have trimmed Power Filter Tube enough when engine compartment cowling rests on hull and there is a slight gap between engine compartment cowling ventilation opening reinforcement ribs and Power Filter Tube. (see illustration #21) Be sure to smooth edge after trimming.
27. Tighten clamp securing Power Filter Tube to adapter. **NOTE: Do not over tighten clamp.** Secure engine compartment cowling. **NOTE: Use BLUE Loc-Tite. Do not over tighten bolts.** Replace engine coolant overflow tank.

Remember, the water belongs to everyone. Please ride responsibly!

Technical Support

For answers to questions regarding installation or trouble shooting RIVA Performance Products contact:
RIVA Technical Support directly at (954) 247-0705 or by e-mail at tech_support@rivamotorsports.com

Limited Warranty

RIVA RXP Pro-Series Power Filter Kits carry a 1-year limited warranty to the original purchaser. They are warranted to be free of defects in materials and workmanship under normal use and service. Customer modified components will be void of warranty. This warranty is limited to defects in the primary components only. Finish and/or wear marks in or on primary components are not covered under this warranty.

RIVA Racing's liability is expressly limited to the repair or replacement of the components contained within or associated with this kit. RIVA Racing agrees to repair or at RIVA's option, replace any defective unit without charge, if product is returned to RIVA Racing freight prepaid within the warranty period. Any equipment returned which, in RIVA's opinion, has been subjected to misuse, abuse, overheating or accident shall not be covered by this warranty.

RIVA Racing shall have no liability for special, incidental or consequential damages or injury to persons or property from any cause arising from the sale, installation or use of this product.

No other warranty, express or implied, including, but not limited to the implied warranties of merchantability and fitness for a particular purpose, applies. Various states do not allow for the limitation of incidental or consequential damages and therefore the above exclusion or limitation may not apply to you.

Warranty does not include the expenses related to freight or transportation of parts or compensation for any inconvenience or loss of use while being repaired. A copy of the original invoice must accompany all warranty claims.

Warranted replacement parts will be returned freight collect.

- INSTALLATION IMAGES -

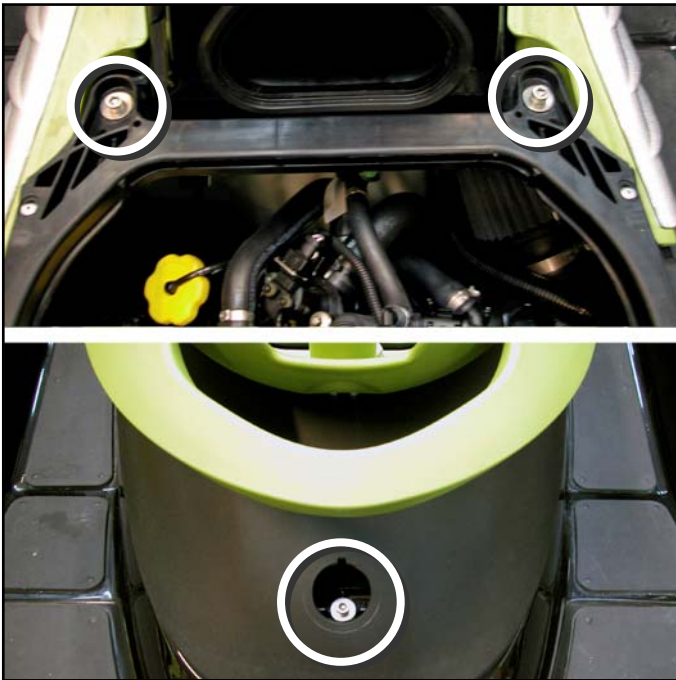

Illustration #1



Illustration #2



Illustration #3

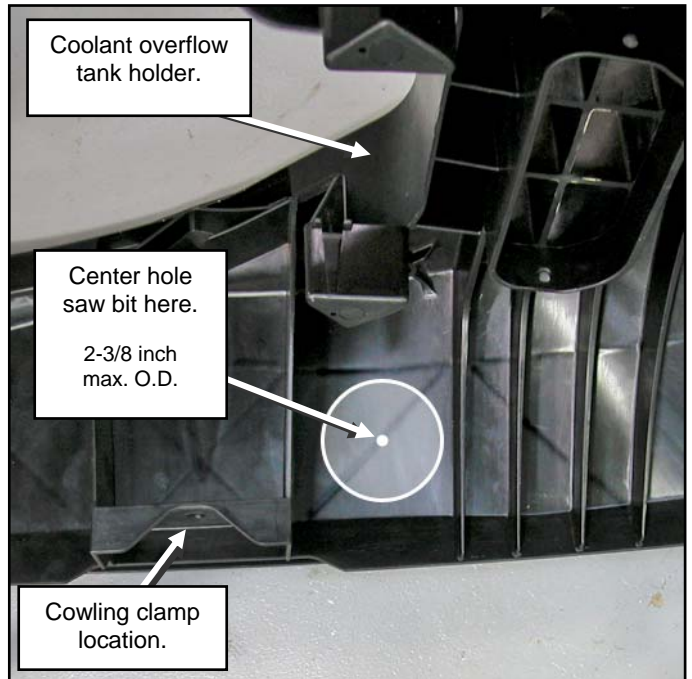

Illustration #4



Illustration #5

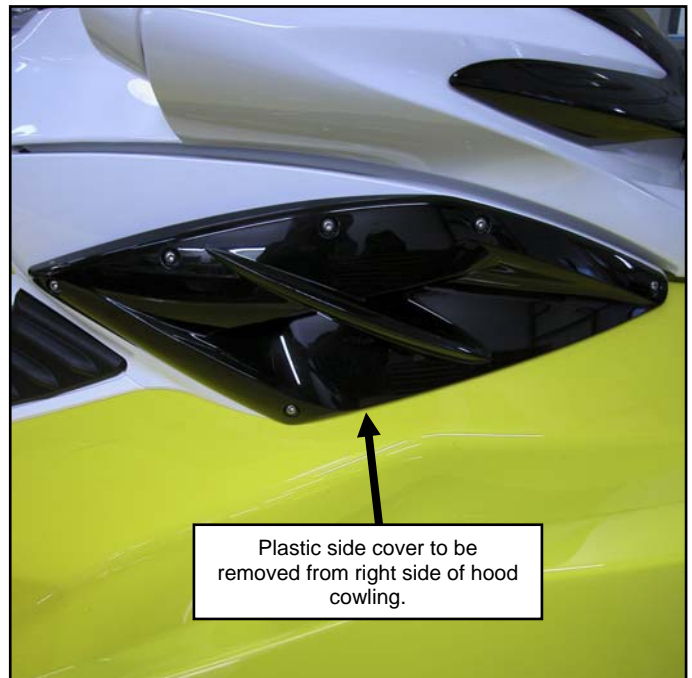

Illustration #6

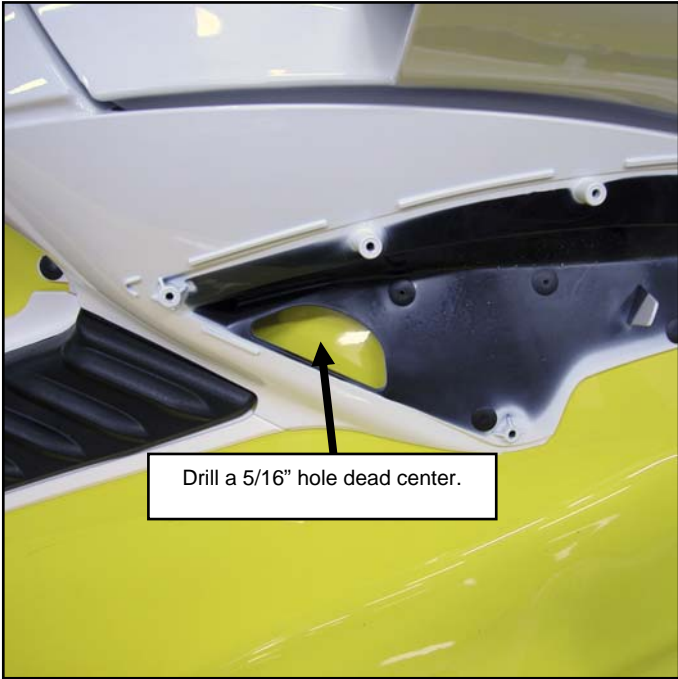

Illustration #7



Illustration #8



Illustration #9

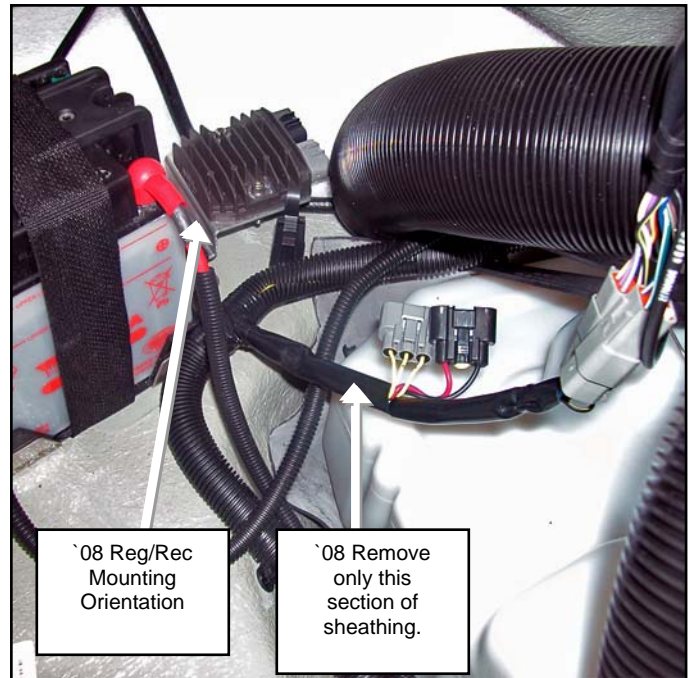

Illustration #10



Illustration #11

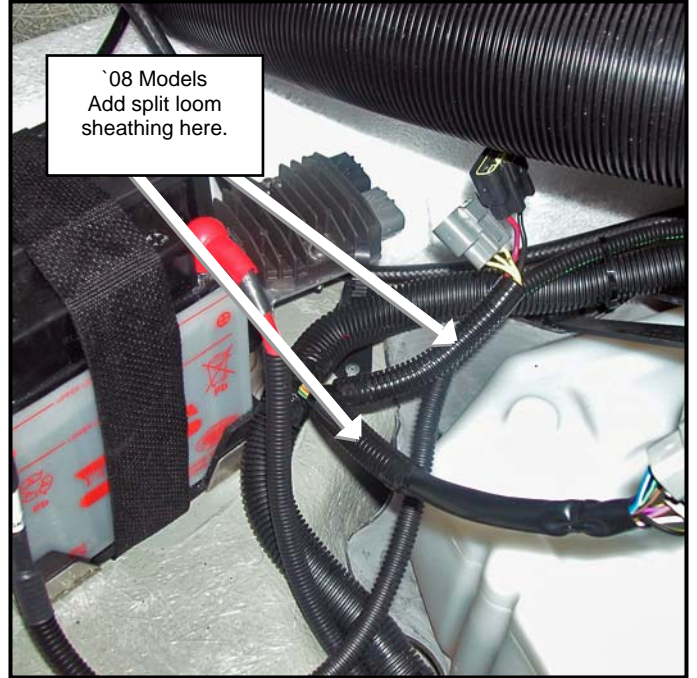

Illustration #12



Illustration #13

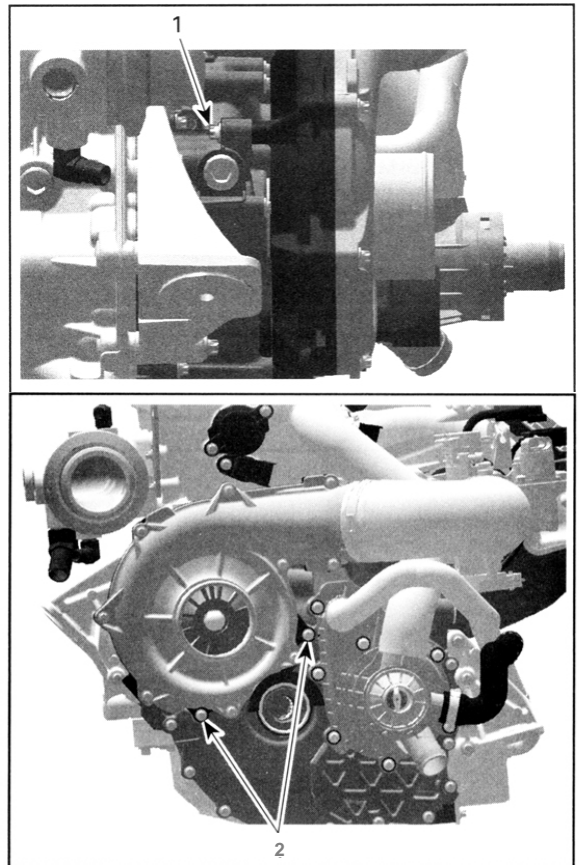

Illustration #14

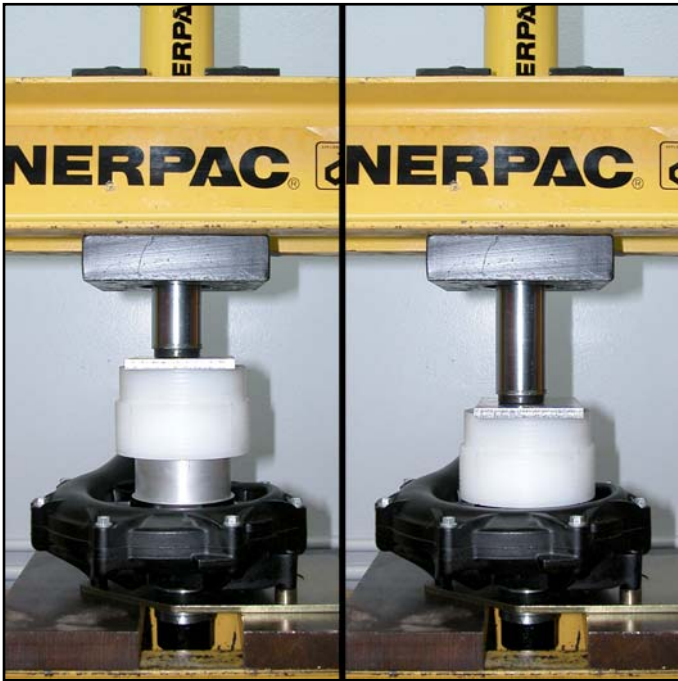

Illustration #15



Press straight down with even pressure.



Illustration #16

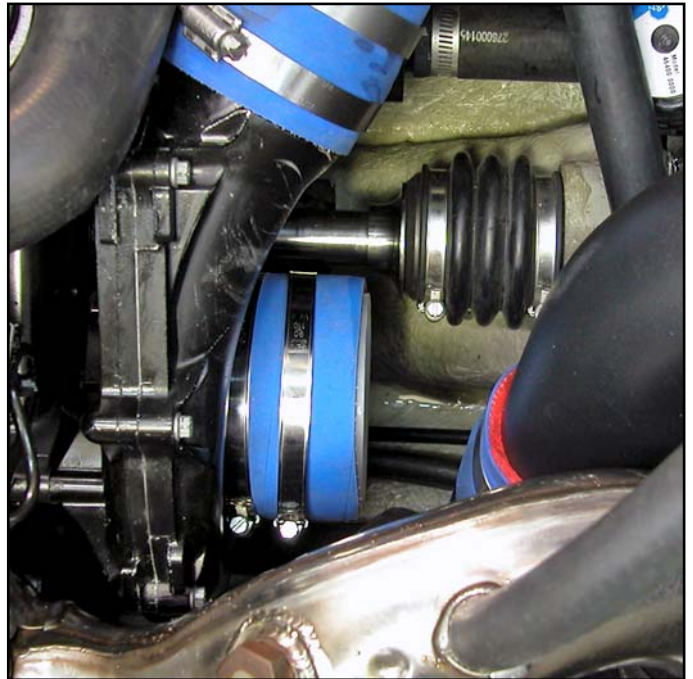
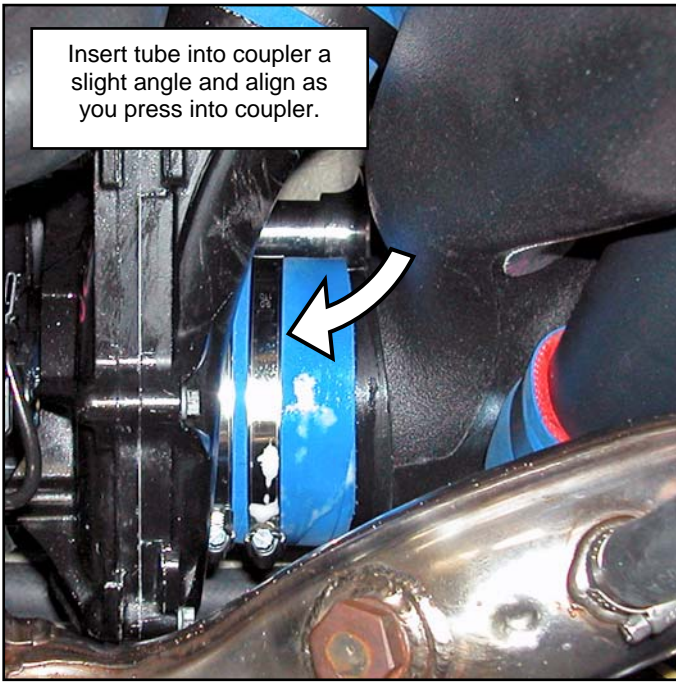
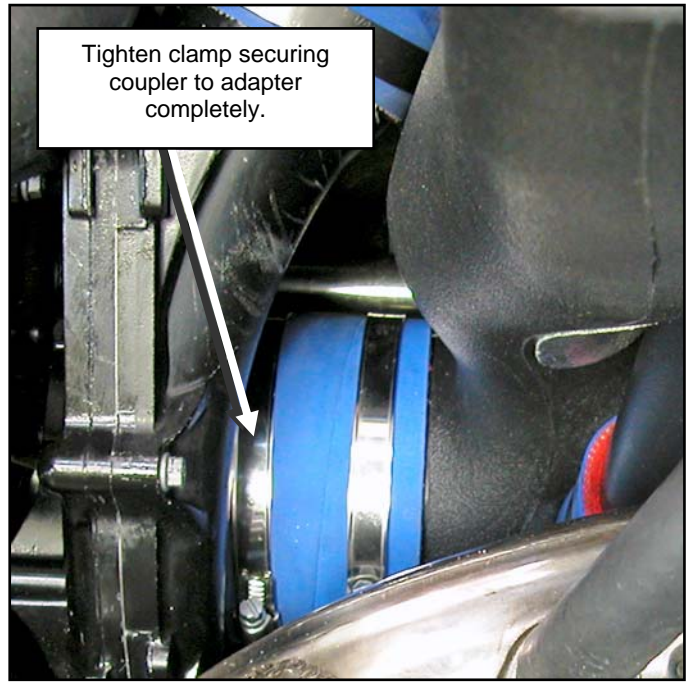

Illustration #17



Insert tube into coupler a slight angle and align as you press into coupler.

Illustration #18



Tighten clamp securing coupler to adapter completely.

Illustration #19

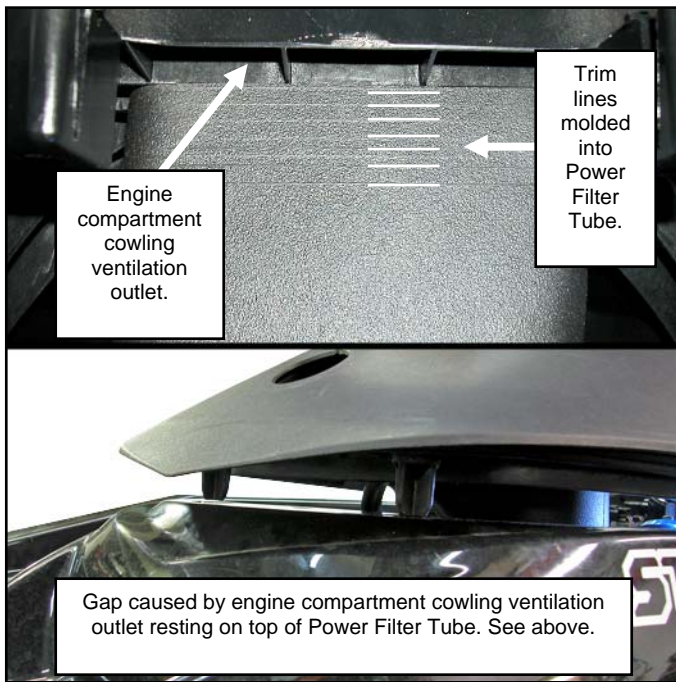

Engine compartment cowling ventilation outlet.

Trim lines molded into Power Filter Tube.

Gap caused by engine compartment cowling ventilation outlet resting on top of Power Filter Tube. See above.

Illustration #20

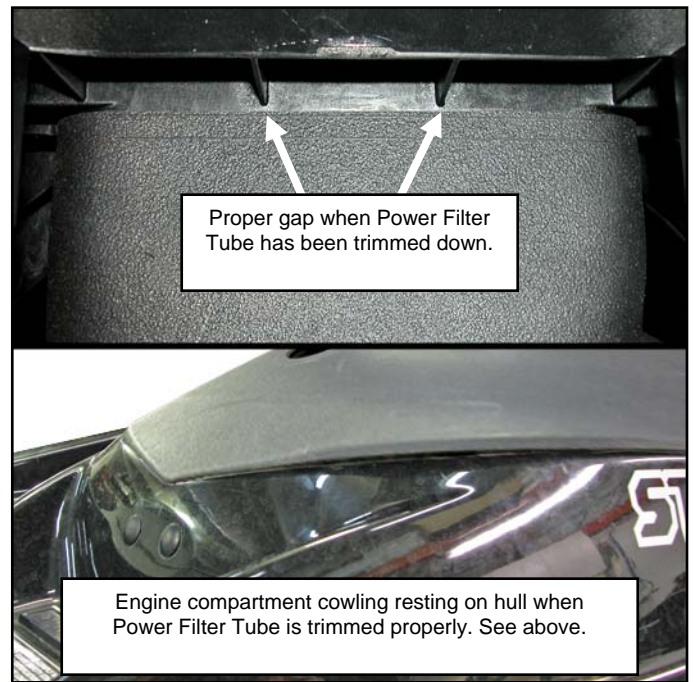

Proper gap when Power Filter Tube has been trimmed down.

Engine compartment cowling resting on hull when Power Filter Tube is trimmed properly. See above.

Illustration #21

Oil Catch Can/Breather System **PART# - RS19050-BCC**

APPLICATION(S): RXP/RXT/GTX 4-TEC

***** NOTE: Allow craft's engine to cool thoroughly before performing installation. *****

- INSTALLATION INSTRUCTIONS -

1. Remove two forward most bolts (one upper/one lower) securing exhaust manifold to cylinder.
2. Install supplied Oil Breather/Catch Can and secure with OE bolts. (see illustration #2) **NOTE: Use BLUE Loc-Tite. Torque to 7 ft•lbs / 10 N•m.**

`03~05 Models

3. Remove OE hose between air intake system and oil separator housing and discard. Retain hose clamps.
4. Install supplied hose between oil separator housing and Oil Catch Can/Breather. (see illustration #1&2) Secure using OE hose clamps. **NOTE: Do not over tighten hose clamps.**
5. Install supplied block-off cap onto oil breather hose fitting on air intake system where applicable and secure with supplied zip tie. (see illustration #4)

`06 & Newer Models

3. Disconnect end of oil breather hose from air intake system.
4. Relocate forward most hose retainer bracket on exhaust manifold. (see illustration #2) **NOTE: Use BLUE Loc-Tite. Torque to 7 ft•lbs / 10 N•m.**
5. Align hose with Oil Catch Can/Breather and remove excess hose. (see illustration #3) Install and secure to Oil Catch Can/Breather using OE hose clamp. **NOTE: Do not over tighten hose clamp.**

Drain Oil Catch Can/Breather as needed by rotating valve arm at base to 6 o'clock position. To close rotate back to 3 o'clock position.

Remember, the water belongs to everyone. Please ride responsibly!

Technical Support

For answers to questions regarding installation or trouble shooting RIVA Performance Products contact:
RIVA Technical Support directly at (954) 247-0705 or by e-mail at tech_support@rivamotorsports.com

Limited Warranty

RIVA Oil Catch Can/Breather Systems carry a 6-month limited warranty to the original purchaser. They are warranted to be free of defects in materials and workmanship under normal use and service. Customer modified components will be void of warranty. This warranty is limited to defects in the primary components only. Finish and/or wear marks in or on primary components are not covered under this warranty.

RIVA Racing's liability is expressly limited to the repair or replacement of the components contained within or associated with this kit. RIVA Racing agrees to repair or at RIVA's option, replace any defective unit without charge, if product is returned to RIVA Racing freight prepaid within the warranty period. Any equipment returned which, in RIVA's opinion, has been subjected to misuse, abuse, overheating or accident shall not be covered by this warranty.

RIVA Racing shall have no liability for special, incidental or consequential damages or injury to persons or property from any cause arising from the sale, installation or use of this product.

No other warranty, express or implied, including, but not limited to the implied warranties of merchantability and fitness for a particular purpose, applies. Various states do not allow for the limitation of incidental or consequential damages and therefore the above exclusion or limitation may not apply to you.

Warranty does not include the expenses related to freight or transportation of parts or compensation for any inconvenience or loss of use while being repaired. A copy of the original invoice must accompany all warranty claims.

Warranted replacement parts will be returned freight collect.

- INSTALLATION IMAGES -

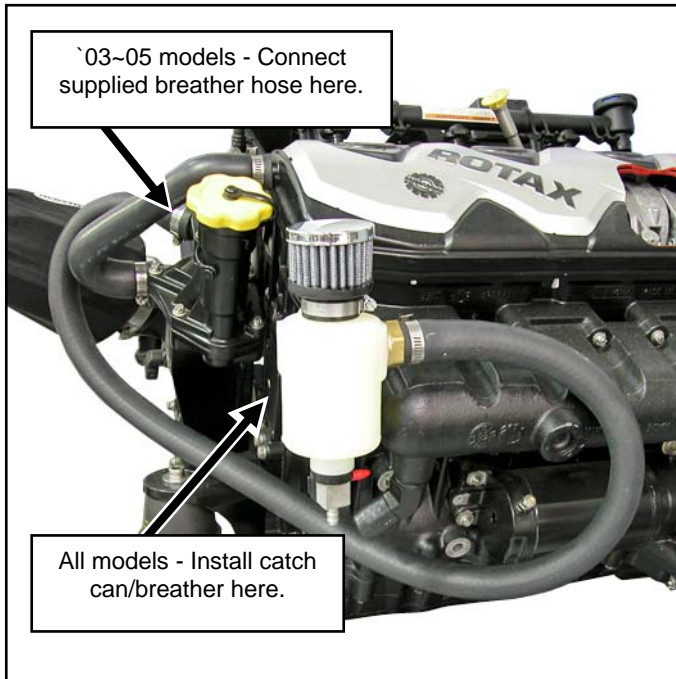

Illustration #1

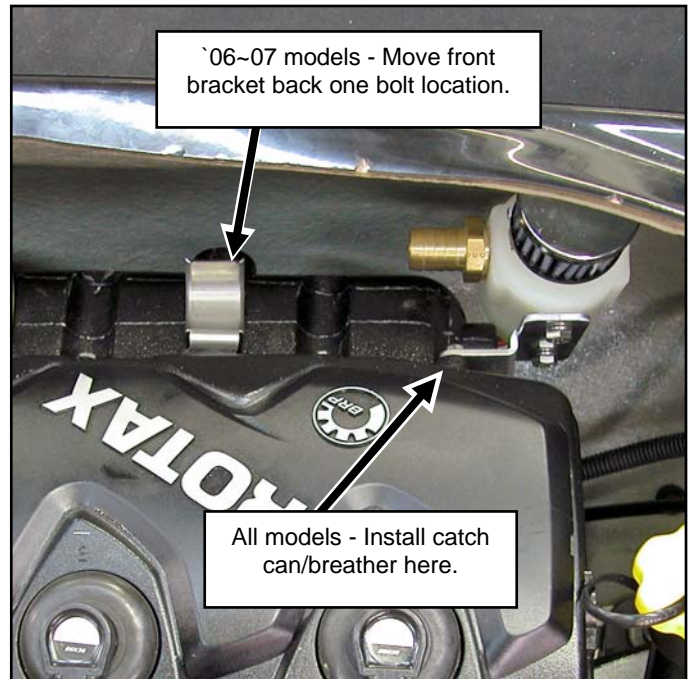

Illustration #2

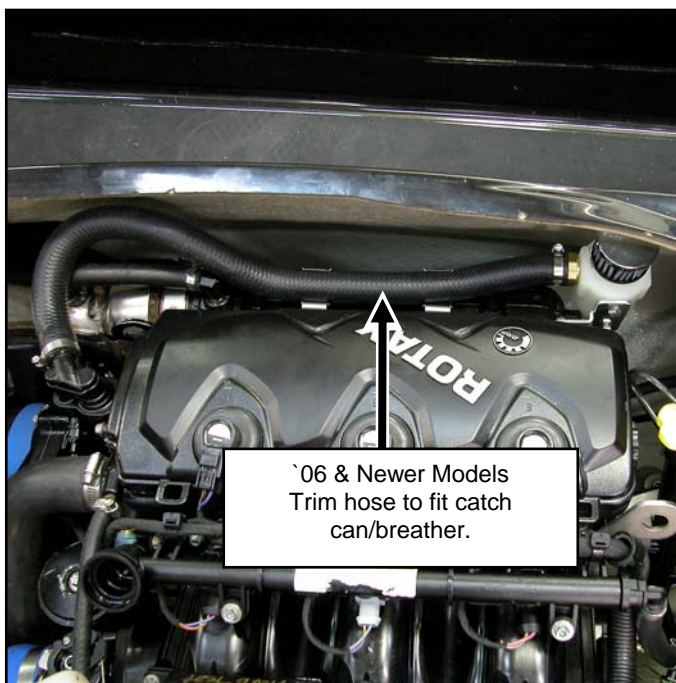

Illustration #3