

Classification:

ST12-006

Reference:

ITB12-050

COPYRIGHT © NISSAN NORTH AMERICA, INC.

Date:

August 14, 2012

## EX35, G35, G37; STEERING WHEEL SWITCH FINISHER SERVICE PARTS

**APPLIED VEHICLES:**

- 2007-2008 G35 Sedan (V36)
- 2009-2012 G37 Sedan (V36)
- 2008-2013 G37 Coupe (CV36)
- 2009-2013 G37 Convertible (HV36)
- 2008-2012 EX35 (J50)

### SERVICE INFORMATION

If you confirm there is a need to replace the steering wheel switch finisher on an Applied Vehicle for any reason:

- Do not replace the steering wheel assembly. The steering wheel switch finisher is now available as a separate service part.

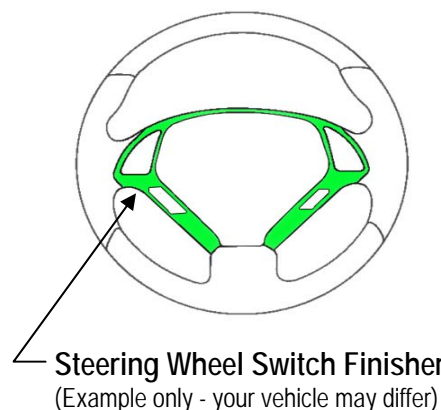

Refer to the Service Procedure in this bulletin for instruction on how to remove and install the steering wheel switch finisher.

### CLAIMS INFORMATION

Submit a Primary Part (PP) type line claim using the following claims coding:

DESCRIPTION	PFP	OP CODE	SYM	DIA	FRT
RPL ASCD SET/CANCEL/PHONE SWITCH	(1)	RM32AA	ZE	32	(2)

- (1) Refer to the electronic parts catalog (FAST or equivalent) and use the Steering wheel part number (48430-\*\*\*\*\*) as the primary failed part.
- (2) Reference the current Infiniti Warranty Flat Rate Manual and use the indicated flat rate time.

Infiniti Bulletins are intended for use by qualified technicians, not 'do-it-yourselfers'. Qualified technicians are properly trained individuals who have the equipment, tools, safety instruction, and know-how to do a job properly and safely. NOTE: If you believe that a described condition may apply to a particular vehicle, DO NOT assume that it does. See your Infiniti dealer to determine if this applies to your vehicle.

**PARTS INFORMATION**

DESCRIPTION	PART NUMBER	QUANTITY
FIN-STRG LID, RH	Refer to the electronic parts catalog (FAST or equivalent) and order the appropriate FIN-STRG LID, RH and COVER - BACK, STRG WHEEL	1
COVER - BACK, STRG WHEEL		1
SCREW (for attaching switches to finisher)	48469-JK00A	6*
SCREW (for attaching switches and finisher to steering wheel assembly)	48469-JK10A	3
BOLT (for driver air bag module)	87850-8990A	2

\*Only three (3) screws are needed if the switches are on one side only.

## SERVICE PROCEDURE

**IMPORTANT:** Follow all cautions, warnings, and notes in the Electronic Service Manual (ESM) when working on or near a Supplemental Restraint System (SRS), such as an airbag.

1. Write down all radio station presets.

Presets	1	2	3	4	5	6
AM						
FM1						
FM2						
XM1						
XM2						
XM3						

2. Disconnect both battery cables, negative cable first.
3. After disconnecting the battery cables, wait at least three minutes before proceeding with step 4.
4. Remove the steering wheel.
  - Refer to section **ST, STEERING WHEEL > Removal and Installation** in the applicable ESM for removal instructions.

5. Remove the steering wheel back cover.

**CAUTION:** The steering wheel assembly has sharp edges.

- a. Push and release the two (2) clips shown in Figure 1.

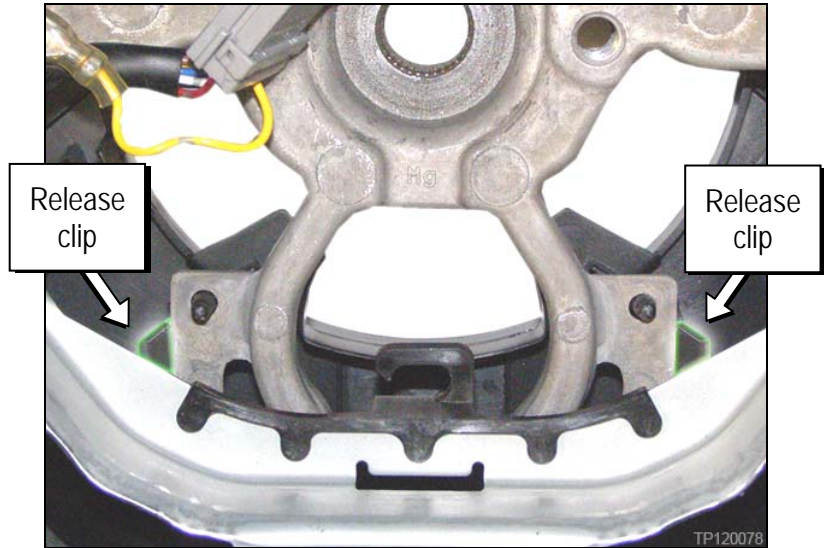

Figure 1

- b. To prevent the clips from snapping back into place:

- Insert a plastic trim tool between the back cover and the steering wheel assembly, as shown in Figure 2.

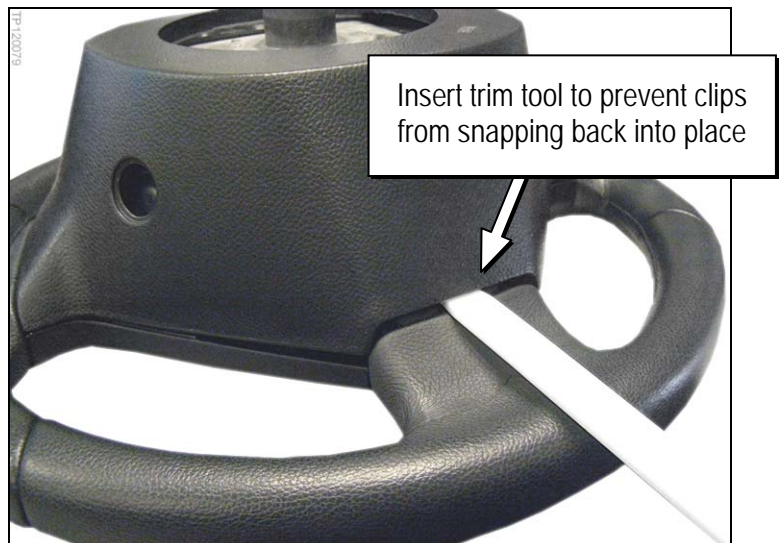

Figure 2

- c. Cover the tip of a flathead screwdriver with fabric/tape.
- d. Use the screwdriver to release the two (2) clips shown in Figure 3.
  - While pushing the clip with the screwdriver, lift the handle to pry up the cover until the clip releases.

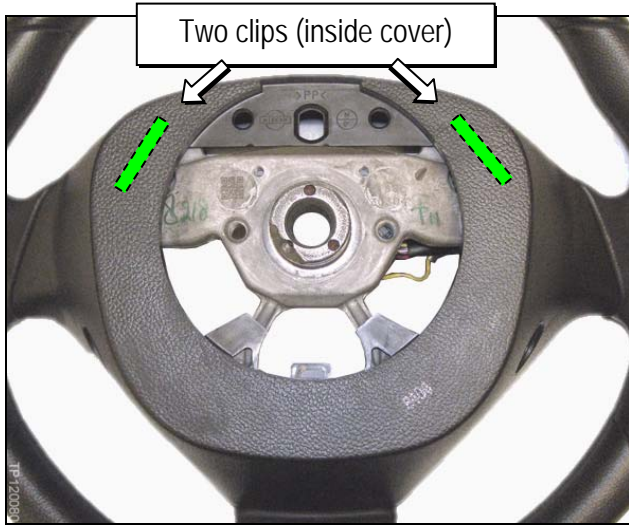

Figure 3

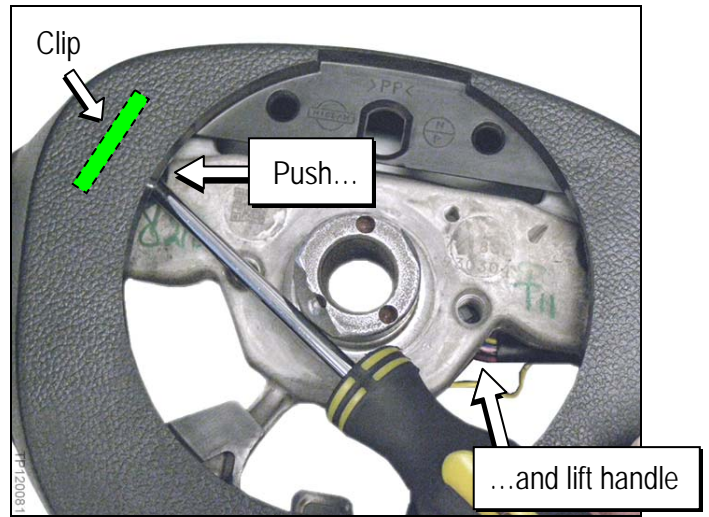

Figure 4

- e. Dispose of the back cover once removed. The back cover cannot be reused.

6. Disconnect the horn ground.

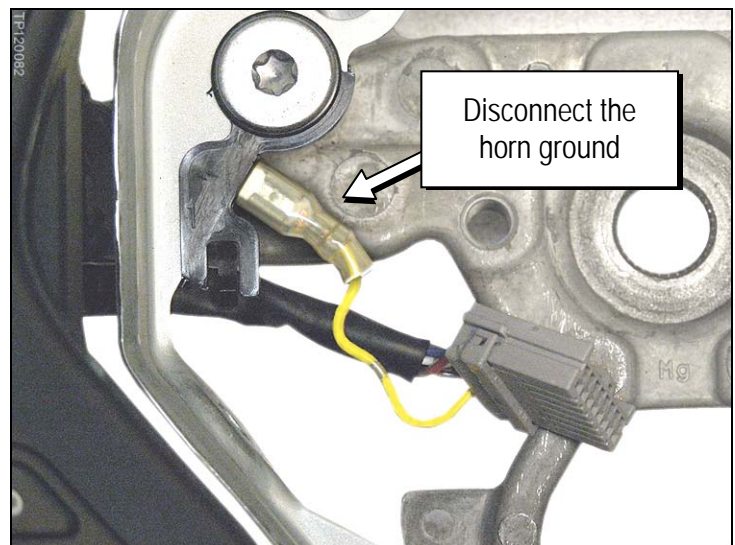

Figure 5



7. Turn over the steering wheel assembly and detach the harness from the clip.

Next, move the harness to the side.

**NOTE:** Be careful to not let the harness come into contact with sharp edges.

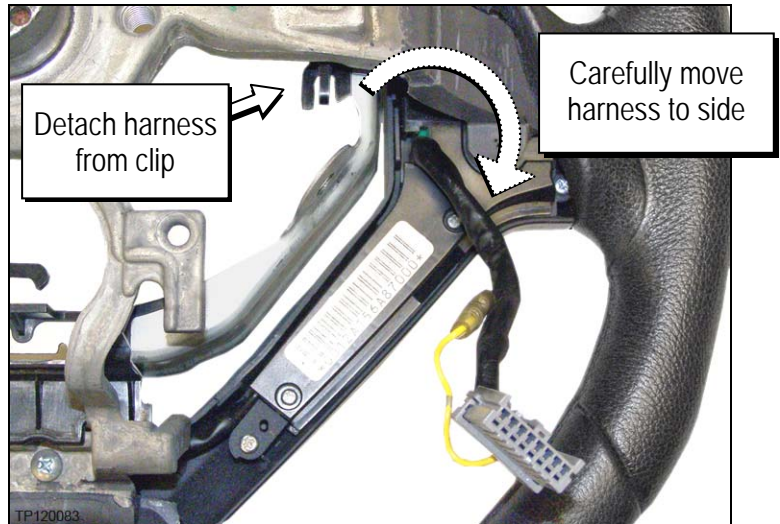

Figure 6

8. Remove the three (3) screws shown in Figure 7.

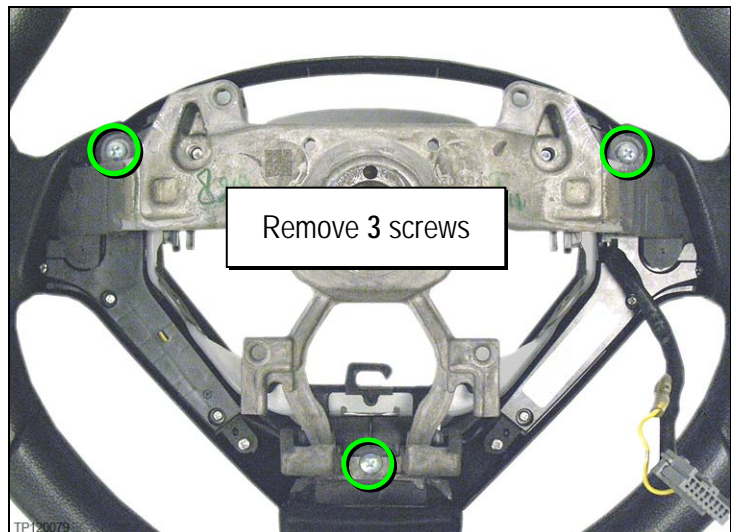

Figure 7

9. Separate the switches and finisher from the steering wheel assembly.

10. Remove the six (6) screws shown in Figure 8.

**NOTE:** You will remove three (3) screws if the switches are on one side only.



Figure 8

11. Detach the finisher from the switches.



Figure 9

12. Install the new steering wheel switch finisher listed in the Parts Information section.

a. Align the holes and posts of the switches and finisher, then push the pieces together.

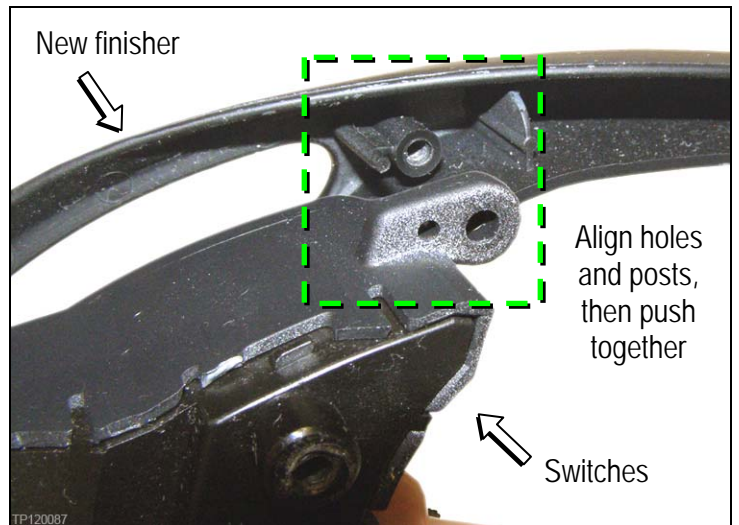

Figure 10

b. Tuck the harness into the finisher as shown in Figure 11.



Figure 11

- c. Install six (6) new screws listed in the Parts Information section. See Figure 12.

**NOTE:** You will install three (3) new screws if the steering wheel switches are on one side only.



Figure 12

- 13. Attach the switches and finisher to the steering wheel assembly.

- a. While holding up the switches and finisher from below, install three (3) new screws listed in the Parts Information section. See Figures 13 and 14.



Figure 13

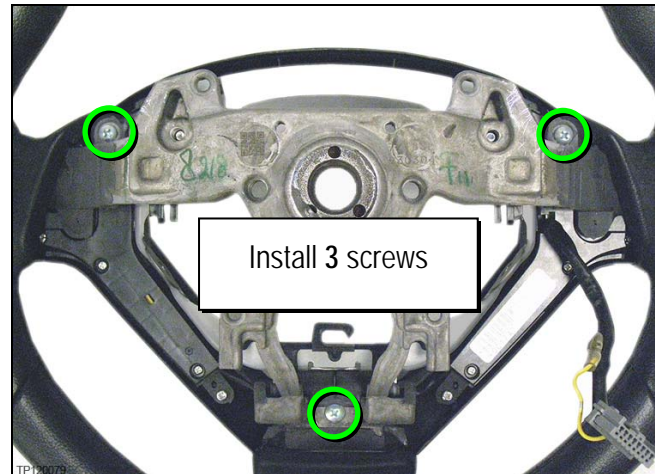

Figure 14



- b. Confirm there are no gaps between the finisher and steering wheel assembly.

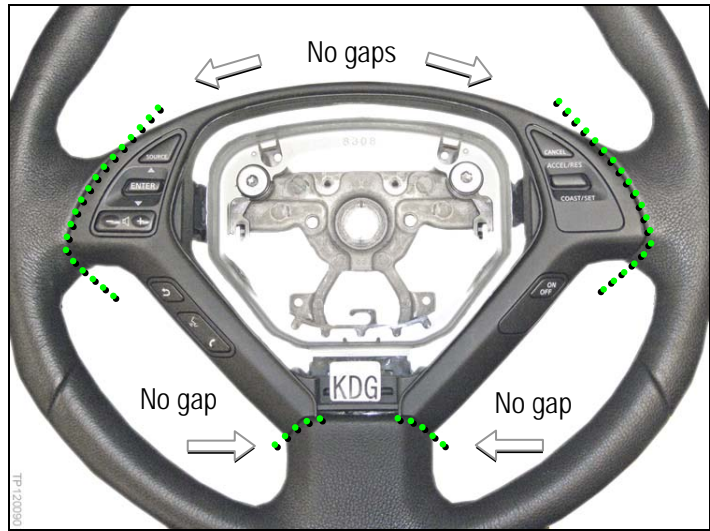

Figure 15

- c. Move the harness up and over into the horn plate as shown in Figure 16.

**NOTE:** Be careful to not let the harness come into contact with sharp edges.

- d. Insert the harness into the clip.

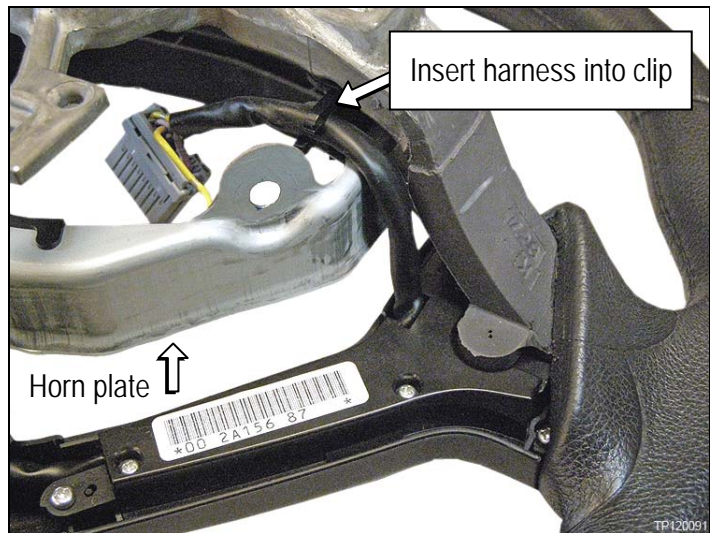

Figure 16

14. Install the new steering wheel back cover listed in the Parts Information section.

- a. Align the posts on the back cover with the holes on the steering wheel assembly.

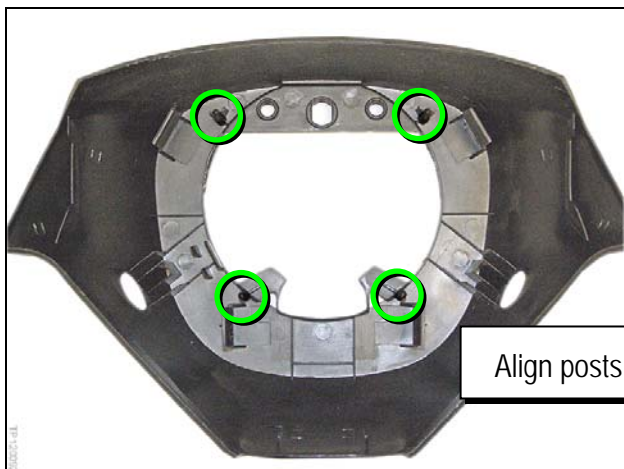

Figure 17

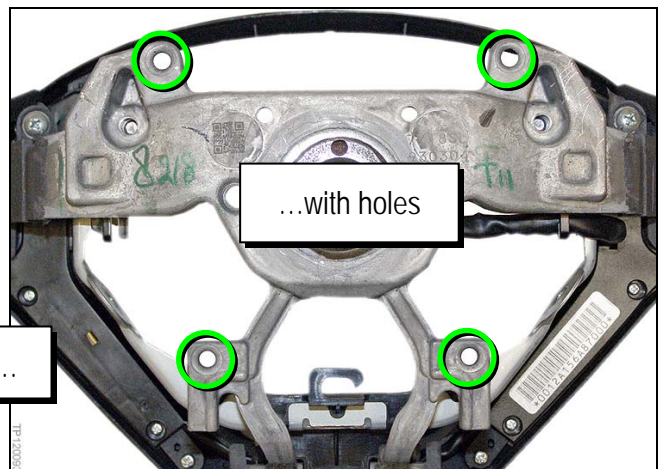

Figure 18

- b. Push the back cover onto the steering wheel assembly.
  - Apply pressure equally front to back and side to side.



Figure 19

15. Reconnect the horn ground.

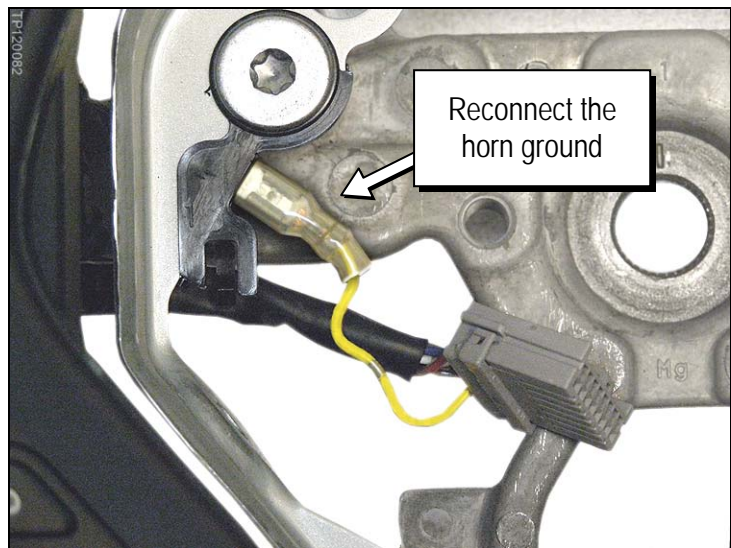

Figure 20

16. Reinstall the steering wheel.

- Refer to section **ST, STEERING WHEEL > Removal and Installation** in the applicable ESM for installation instructions.

- Use the new driver air bag module bolts listed in the Parts Information section when reinstalling the air bag module.

17. Reconnect the battery cables, negative cable last.

18. Reset the radio station presets.