



INSTRUCTIONS

-J03804

REV. 2005-05-03

DASH PAD KIT

GENERAL

Kit Number

58262-05

Models

This kit fits 1997 and later FLHT model motorcycles.

Additional Parts Required

WARNING

The rider's safety depends upon the correct installation of this kit. Use the appropriate service manual procedures. If the procedure is not within your capabilities or you do not have the correct tools, have a Harley-Davidson dealer perform the installation. Improper installation of this kit could result in death or serious injury. (00333a)

NOTE

This instruction sheet references Service Manual information. A Service Manual for your model motorcycle is required for this installation and is available from a Harley-Davidson Dealer.

Kit Contents

See Figure 2 and Table 1.

INSTALLATION

1. Refer to the appropriate Service Manual and remove the outer fairing.

NOTE

See Figure 1. Place the template in the left side position (as seen facing the forward side of the inner fairing) with the "L" showing. Place the template on the right side with "R" showing.

2. See Figure 1. Using the template supplied in the kit, mark the two hole locations on forward side of the inner fairing.
3. Drill a 1/8 in. pilot hole in each of the hole locations.
4. Drill a 1/2 in. hole in each of the pilot hole locations.
5. Install the dash panel above gauges on inner fairing and secure with screws and washers from kit. Tighten screws to 25-30 **in-lbs** (2.8-3.4 Nm).
6. Refer to the appropriate Service Manual and install the outer fairing.

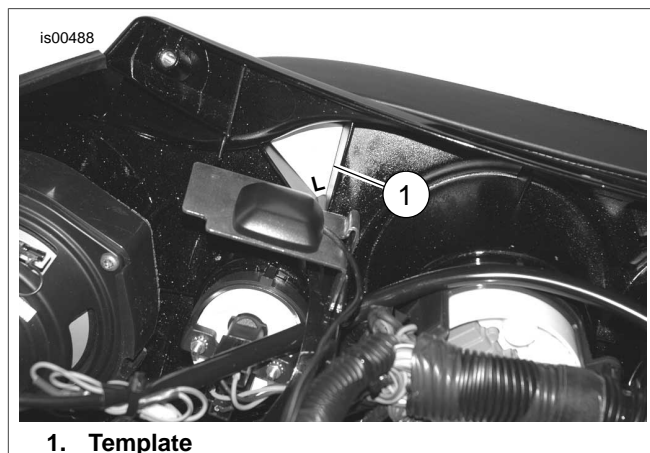

1. Template

Figure 1. Template Placement (Left Side Shown)

SERVICE PARTS

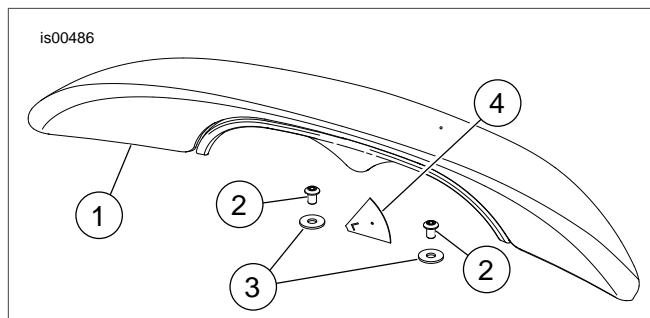

Figure 2. Service Parts for Dash Pad Kit

Table 1. Service Parts

Item	Description (Quantity)	Part Number
1	Dash pad, leather wrapped	Not Sold Separately
2	Screw (2)	Not Sold Separately
3	Washer (2)	Not Sold Separately
4	Template	58318-05