



INSTRUCTIONS

-J06214

REV. 2015-03-30

FAIRING MOUNT MIRRORS

GENERAL

Kit Number

56000098, 56000099

Models

For model fitment information, see the P&A Retail Catalog or the Parts and Accessories section of www.harley-davidson.com (English only).

Installation Requirements

WARNING

The rider's safety depends upon the correct installation of this kit. Use the appropriate service manual procedures. If the procedure is not within your capabilities or you do not have the correct tools, have a Harley-Davidson dealer perform the installation. Improper installation of this kit could result in death or serious injury. (00333a)

For model fitment information, see the P&A Retail Catalog or the Parts and Accessories section of www.harley-davidson.com (English only).

Kit Contents

See Figure 2 and Table 1.

INSTALLATION

Installing Mirrors

WARNING

To prevent accidental vehicle start-up, which could cause death or serious injury, remove main fuse before proceeding. (00251b)

1. See the service manual. Remove main fuse.

NOTE

Do not leave windshield in place with outer fairing removed. Windshield could fall and be damaged.

2. See the service manual. Remove windshield. Remove outer fairing.

3. Drill mirror mounting holes.
 - a. See Figure 1. Locate drill points (1 and 2).
 - b. Cover the finished surface opposite of the drill points with masking tape to prevent damage to painted surfaces.
 - c. Drill a 1/8 in pilot hole in the center of each drill point (1 and 2).
 - d. Drill a 13/32 hole at drill point (1) with a twist drill bit.
 - e. Drill a 7/32 hole at drill point (2) with a twist drill bit.
 - f. Remove tape.
 - g. Repeat previous step on opposite side.

NOTE

Mirror assemblies and backplates are marked with an R or L to indicate the left and right side assemblies.

4. See Figure 2. Install mirror assembly (1).
 - a. With the locating pin (A) of the mirror assembly (1) inserting into the lower hole, install the mirror assembly.
 - b. Install mirror base (2) and gasket (5).
 - c. Install backplate (3) over mirror assembly, so that the locating pin is secured in the small hole of the backplate.
 - d. Install flange nut (4). Tighten to 20-30 in-lbs (2.3-3.4 Nm).
 - e. Repeat previous step on opposite side.
5. See the service manual. Install the outer fairing and windshield.
6. See the service manual. Install main fuse.

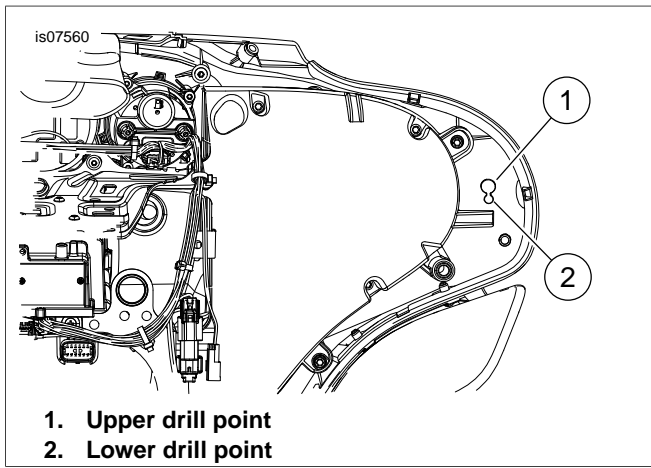

Figure 1. Drill Points (Left Side Shown)

SERVICE PARTS

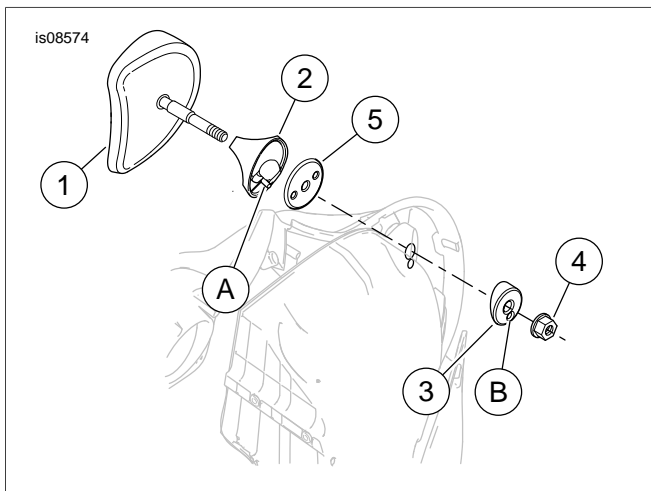

Figure 2. Service Parts: Fairing Mount Mirrors

Table 1. Service Parts

| Item | Description (Quantity) | Part Number |
|---------------------------------|---|---------------------|
| 1 | Mirror assembly, left, black | Not Sold Separately |
| | Mirror assembly, left, chrome | Not Sold Separately |
| | Mirror assembly, right, black (not shown) | Not Sold Separately |
| | Mirror assembly, left, chrome (not shown) | Not Sold Separately |
| 2 | Mirror base mount, left, black | 56000113 |
| | Mirror base mount, left, chrome | 56000112 |
| | Mirror base mount, right, black (not shown) | 56000105 |
| | Mirror base mount, left, chrome (not shown) | 56000103 |
| 3 | Backing plate, left | 56000015 |
| | Backing plate, right (not shown) | 56000016 |
| 4 | Flange nut (2) | 7687 |
| 5 | Gasket (2) | 56000122 |
| Items mentioned in text. | | |
| A | Locating pin | |
| B | Small hole | |