

# **TPC**

## Advance Operator Dental Light



## Operation and service manual

TPC

851 S. Lawson St

City Of Industry, CA 91748

P626-810-4337 Fax 626-810-4245

[www.tpcdental.com](http://www.tpcdental.com)



Table on Contents: Page







<b>GENERAL INFORMATION</b>	<b>3</b>
Installation	4
Overview of components	5
Operation instructions	6
Light head adjustment	7
Vertical arm adjustment	7
Replacement of light bulb	8
<b>Replacement Parts List</b>	<b>9</b>
<b>CLEANING &amp; DISINFECTING GUIDE</b>	<b>12</b>
<b>Warranty</b>	<b>13</b>
<b>TROUBLE SHOOTING GUIDE</b>	<b>14</b>



**Technical Assistance is available Monday through Friday, 8:00 Am to 5:00 PM PST.**

# TPC

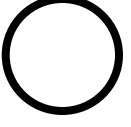
## General Information:

### Definitions of symbols

	<p>Risk of electrical shock present. Make sure power is disconnected before attempting this procedure.</p>		<p>Type B equipment (Protected against electrical shock)</p>
	<p><b>Caution:</b> Failure to carefully follow the described procedure may result in damage to the equipment or operator.</p>		<p>Dangerous Voltage</p>
	<p>AC (Alternating Current)</p>		<p>Off</p>
	<p>Protective earth (Ground)</p>		<p>On</p>

Model: L700 Lucent Dental Light  
 Serial No: L700-8675309  
 Input Voltage: 120V ~ 60Hz  
 Current: 1A  
 Warning: RISK OF FIRE - CLASS 1  
 Replace fuse as marked   
 1A Fuses  
 Manufactured: 7-2009  
**TPC**  
 Reference Owner's Manual   
 18525 E. Gale Ave.  
 City Of Industry, CA 91748

## Product Identification



## Operatory Light Installation

- The Advance Operatory Light is designed to fit into the top end of a chair or floor mounted post. The size of the included bushing is 1 11/16". For all other light post sizes you will need to obtain an additional light post adaptor bushing.
- Insert the end of wire through the silver light bushing.
- Place the end of the wire through the light post and insert the light bushing into the light post and press down to insure proper seating of the bushing.
- Attach light head wires to vertical arm this is a "white Molex connection". Insert set screw into light head to attach light to vertical arm.
- Connect the wires to the corresponding terminals on the plug. Or hard wire the connections using the included wire nuts.

# TPC

Overview of components:

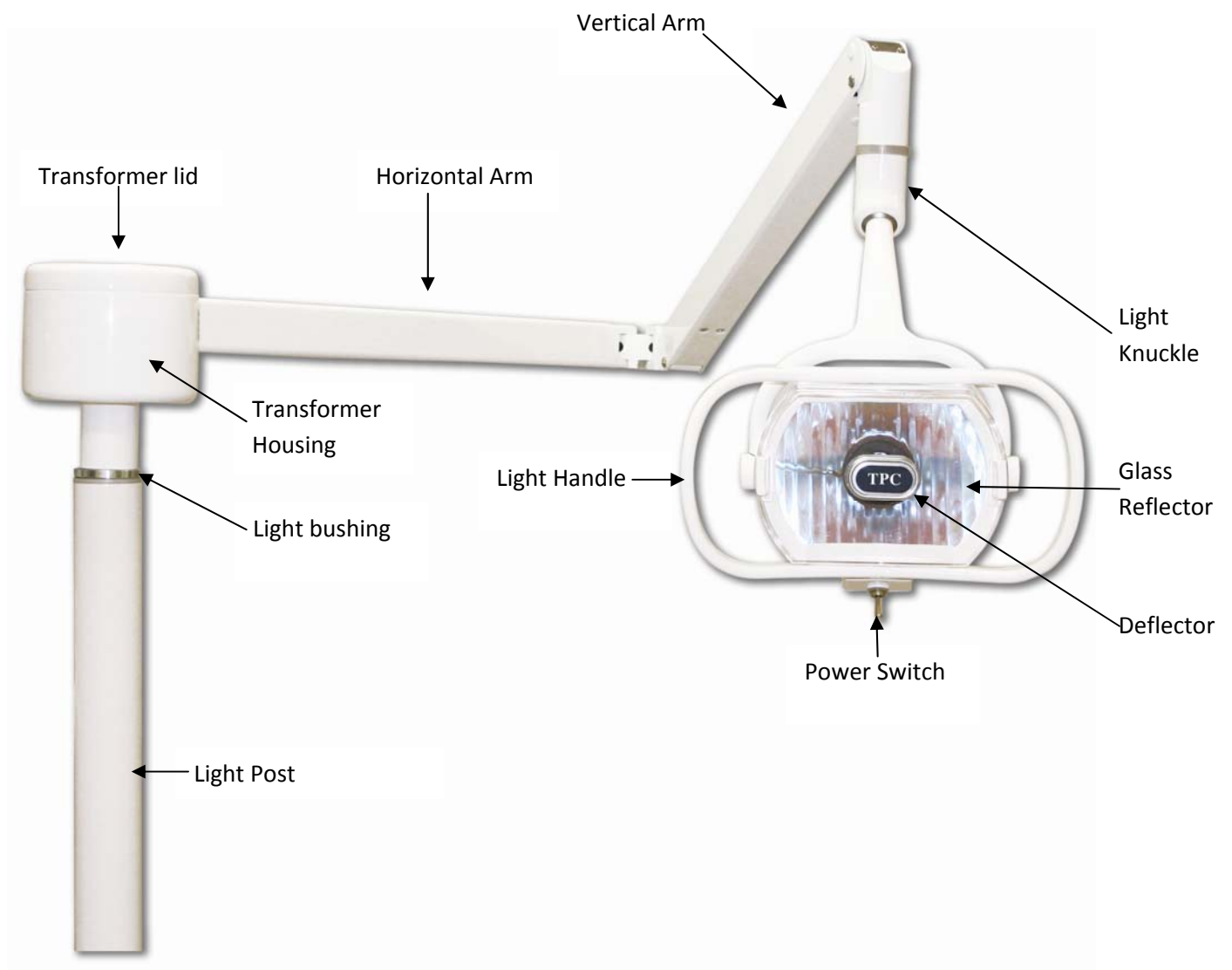

# TPC

## Operating Instructions

- Move power switch to the left to set the light to high intensity. Move the power switch back to the center position to turn it to the off position. Move the power switch to the right to right to turn it to low intensity.



- To adjust the position of the light, place your hand on the light handle and move it to the desired location. You can move the light head up and down and left and right. When turning the light head left and right it will stop, don't force any further movement of the light head as damage may occur.
- To bring the light closer to the patient or desired illuminated location pull down on the light handle to move the vertical arm. Once the light is in the desired location it will stay in that position until you move it back.

# TPC

## Light head adjustment

- If you experience a downward drift with your operatory light head please follow the procedure below.
- Tighten both set screws on the back side of the operatory light. There is one located on each side of the dental light head. Reference image below. To tighten the set screw turn it clockwise. Do not over tighten the set screw as damage may occur.



## Vertical Arm adjustment

- If you experience a downward drift with your operatory lights vertical arm please follow the producer below.
- With one hand lower the vertical arm till you see the adjustment. See image below. Adjust the inner nut till the desired tension is achieved.



# TPC

## Light Bulb replacement

- If you need to replace your operatory light bulb please follow the steps listed below.
- Remove the rear panel cover from the back of the light. Turn the thumb nut counter clockwise to remove it.

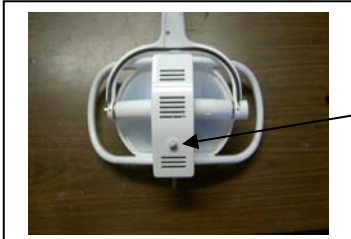

Thumb Screw

- Remove the light bulb retaining spring by pushing it down then pulling it back towards the center of the light bulb socket.

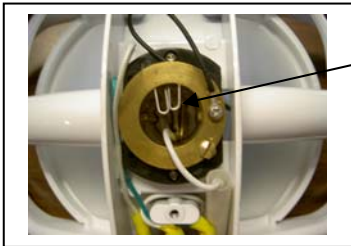

Retaining spring

- Once the spring is removed then disconnect the light bulb from the wire. Slide the high temperature heat shield back to expose the light connection.

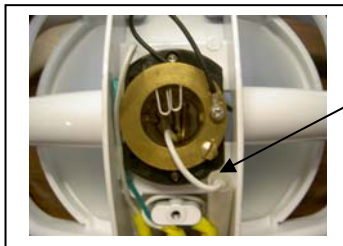

High temperature heat shield and light bulb connection.

- When handling the replacement light bulb be sure not to touch the glass as the oils on your hands can damage the bulb. Reverse the above steps once the new bulb is in place.



# TPC

## Replacement Parts List

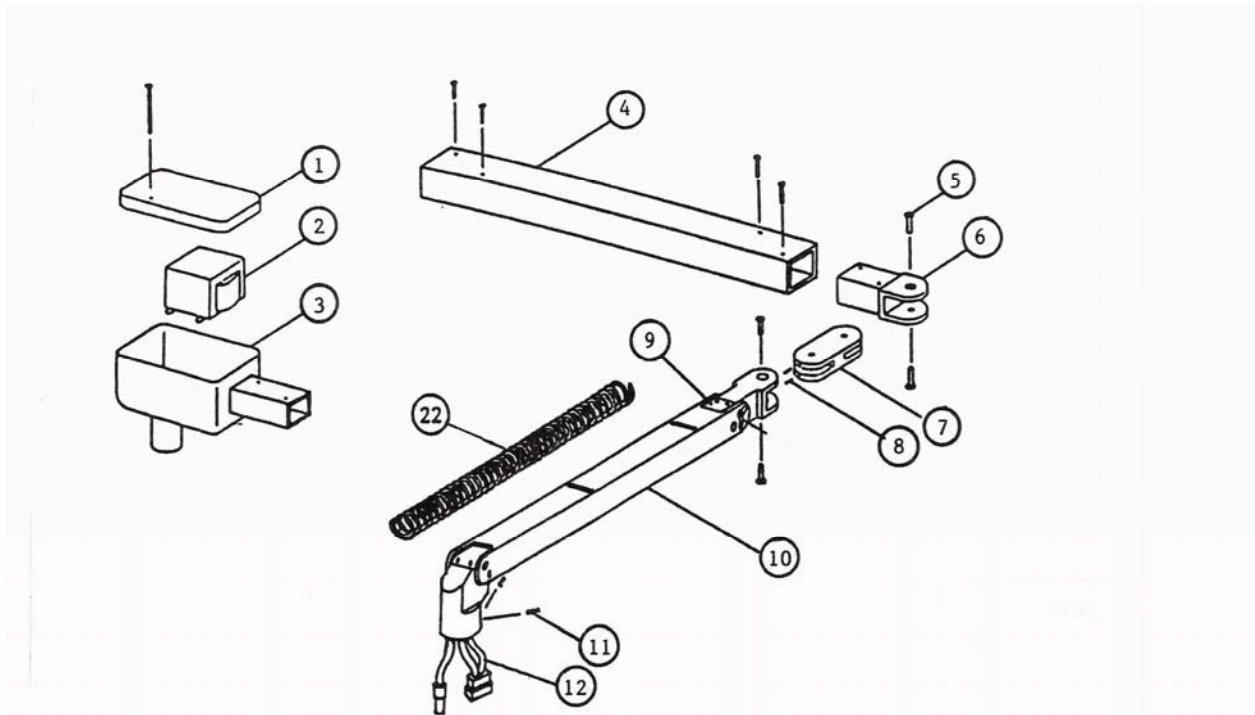

Index No.	Part Number	Description
1	L700-0001	Housing cover for transformer
2	P56004-700	110V Power Transformer
3	L700-0002	Transformer Housing
4	L700-0003	Horizontal Arm
5	L700-0004	Counter Sunk Pin
6	L700-0005	Swivel Arm Knuckle
7	L700-0006	Bridge ARM Connector
8	L700-0007	Set Screw (4 X 5 mm)
9	L700-0008	Yoke Joint Cover
10	L700-0009	Balance Arm Assembly
11	L700-0010	Set Screw (5 X 8 mm)
12	L700-0011	Wire Harness Balance Arm
13	L700-0012	Spring For Balance Arm

# TPC

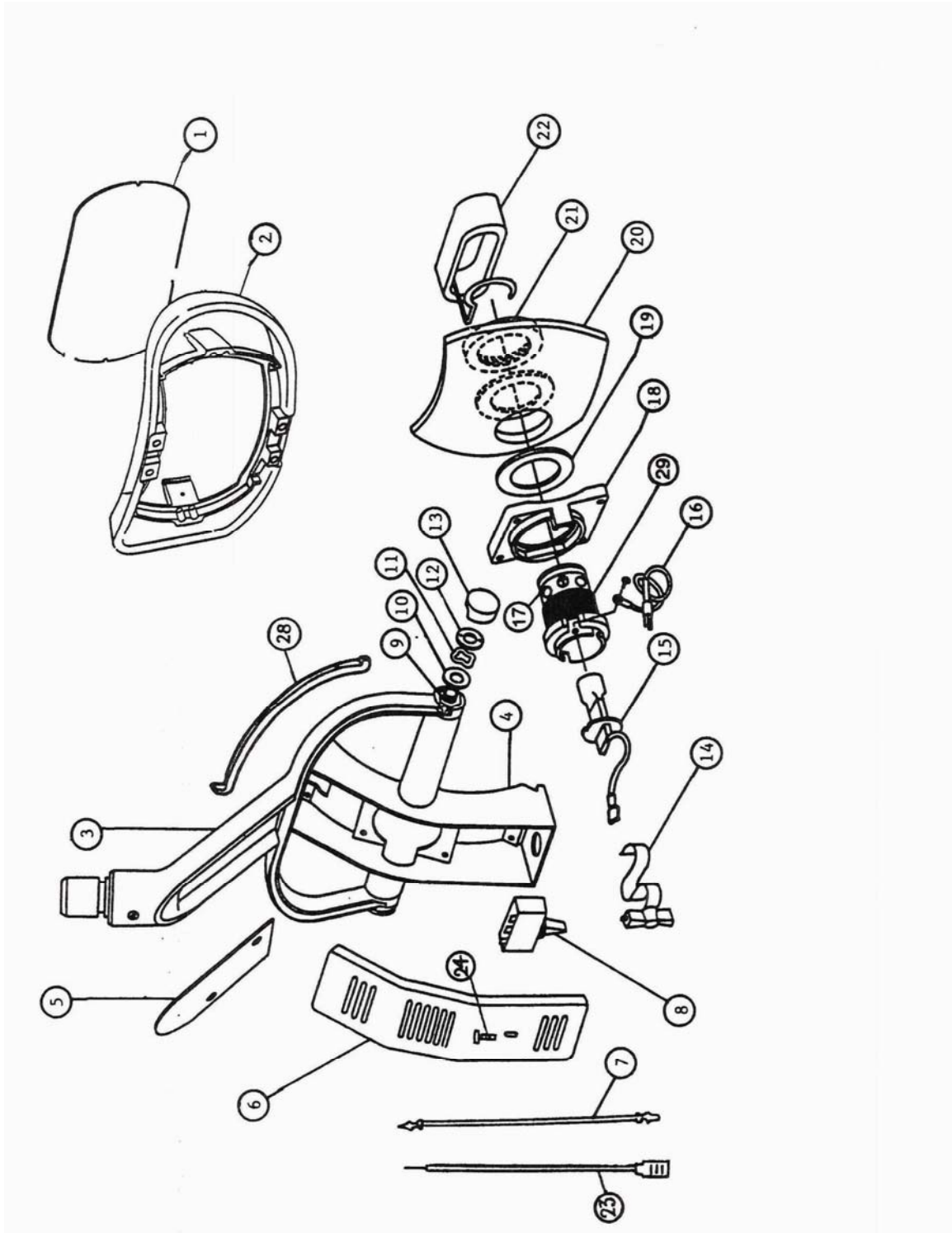

# TPC

Index No.	Part Number	Description
1	L700-703	Light Shield
2	L700-702	Light Handle
3	L700-701	Light Head Yoke
4	L700-704	Frame
5	L700-705	Yoke Cover
6	L700-706	Frame Back Cover
7	L700-707	Yoke Wire Harness
8	L700-708	Power Switch
9	L700-709	Joint Nut
10	L700-710	Flat Washer
11	L700-711	Wave Washer
12	L700-712	Nut For Joint Bolt
13	L700-713	Yoke Side Cover (CAP)
14	L700-714	Spring Holder For Light Bulb
15	L700-P107	Halogen Light Bulb
16	L700-716	Ground Wire
17	L700-717	Lamp Socket
18	L700-718	Socket Housing
19	L700-719	Rubber Washer
20	L700-P705	Reflector
21	L700-721	Nut
22	L700-722	Deflector
23	L700-723	Wire Switch
24	L700-724	Screw
28	L700-723	Rubber She eel For Yoke
29	L700-729	Socket Holder



## Cleaning and disinfecting guide

**Table 1**

\*The Manufacturer makes no representation as to the disinfectant efficacy of these products. We make no warranty expressed or implied that these disinfectants will not damage the surface finishes. Damage and discoloration of the surface finishes are not covered under the warranty. Iodophor-based disinfectants will cause yellow staining on many surfaces. Regular washing with soap and water will minimize this staining. Iodophor neutralizers such as Promedyne are also available.

<p><b>Unacceptable Disinfectants</b>          These disinfectants <b>will harm</b> the surface finishes of dental equipment and are not recommended.  <b>Use of these products will void your warranty.</b>          Chemical Composition / Trade Names          Strong Phenols / Lysol, Lysol 2, Lysol Phenol-Alcohol Professional, Coe Foam, Coe combinations Spray Pump, Vitaphene, Omni II          Sodium Hypochlorite / Clorox, Ajax, Purex Household Bleach          Alcohol          Household Cleaners</p>	<p><b>Conditionally Acceptable Disinfectants</b>          These disinfectants have been found to be the <b>least harmful</b> to the equipment surfaces by our test methods.          Chemical Composition Trade Names          Iodophors Biocide, Aseptic-IDC, Wescodyne, SD5, Promedyne, Iodo-Five          Mild Phenols Procide ES, Asepti-Steryl Aerosol          Glutaraldehyde / Sterall Spray, Coldspor Phenol Sprays          Synergized Super Dis-cide, Cavicide, Kleenaseptic          Quat          Phenol/Water Sprays Top-Cide, Sporidicin Pump Spray          Birex se</p>
-------------------------------------------------------------------------------------------------------------------------------------------------------------------------------------------------------------------------------------------------------------------------------------------------------------------------------------------------------------------------------------------------------------------------------------------------------------------------------------------------------------------------------------------------	-----------------------------------------------------------------------------------------------------------------------------------------------------------------------------------------------------------------------------------------------------------------------------------------------------------------------------------------------------------------------------------------------------------------------------------------------------------------------------------------------------------------------------------------------------------------------------------------------------------------------------



### **Warranty Information**

All of our products sold are guaranteed to be free from defects in workmanship and materials for a 1 year from date of purchase, unless otherwise stated. TPC will repair or replace any defective part at no charge. TPC will not be responsible for labor charges or shipping charges to / from the TPC facility. This guarantee does not cover normal wear or stains on surface finish. The guarantee does not cover damage resulting from improper installation, misuse or accidents incurred in shipping and handling. All claims against the freight carrier must be initiated at the time the damaged items are received. The claim is the responsibility of the customer. We are improving our products on a continuous basis. We reserve the right to make modifications without the need for prior notification and are not obliged to modify previously manufactured items. Light bulbs are not covered under any type of warranty. Only authorized service technicians should attempt to service TPC equipment. Service performed by any unauthorized technician may result in a voided warranty.

# TPC

## Troubleshooting Guide.

<b>Problem</b>	<b>Cause</b>	<b>Solution</b>
Light does not illuminate	No power to light	Check power
	Light bulb has expired	Replace light bulb
	Transformer is expired	Replace transformer
Only high or low function works	Secondary windings on transformers are expired	Replace transformer
	Main power switch is bad	Replace main power switch
Light turns on and off then the light head is moved	Short or open in power line from transformer.	Check each power line for short or open. Then replace.
Light head drifts down	Light head tension springs are loose	Tighten light head spring nuts.
Vertical arm drifts up or down	Vertical arm tension spring needs to be adjusted	Adjust vertical arm tension.
Light drifts from left to right	Light post is not level	Level light post.