

Incorrect or out of phase engine timing can result in damage to the valves. The Tool Connection cannot be held responsible for any damage caused by using these tools in anyway.

Safety Precautions – Please read

- Disconnect the battery earth leads (check radio code is available)
- Remove spark or glow plugs to make the engine turn easier
- Do not use cleaning fluids on belts, sprockets or rollers
- Always make a note of the route of the auxiliary drive belt before removal
- Turn the engine in the normal direction (clockwise unless stated otherwise)
- Do not turn the camshaft, crankshaft or diesel injection pump once the timing chain has been removed (unless specifically stated)
- Do not use the timing chain to lock the engine when slackening or tightening crankshaft pulley bolts
- Do not turn the crankshaft or camshaft when the timing belt/chain has been removed
- Mark the direction of the chain before removing
- It is always recommended to turn the engine slowly, by hand and to re-check the camshaft and crankshaft timing positions.
- Crankshafts and Camshafts may only be turned with the chain drive mechanism fully installed.
- Do not turn crankshaft via camshaft or other gears
- Check the diesel injection pump timing after replacing the chain
- Observe all tightening torques
- Always refer to the vehicle manufacturer's service manual or a suitable proprietary instruction book
- Incorrect or out of phase engine timing can result in damage to the valves
- It is always recommended to turn the engine slowly, by hand, and to re-check the camshaft and crankshaft timing positions



www.lasertools.co.uk

Guarantee



Distributed by The Tool Connection Ltd
Kineton Road, Southam, Warwickshire CV47 0DR
T +44 (0) 1926 815000 F +44 (0) 1926 815888
info@toolconnection.co.uk www.toolconnection.co.uk

If this product fails through faulty materials or workmanship, contact our service department direct on: **+44 (0) 1926 818186**. Normal wear and tear are excluded as are consumable items and abuse.

LASER®

Part No. 3573

Engine Timing Tools

Citroën | Peugeot

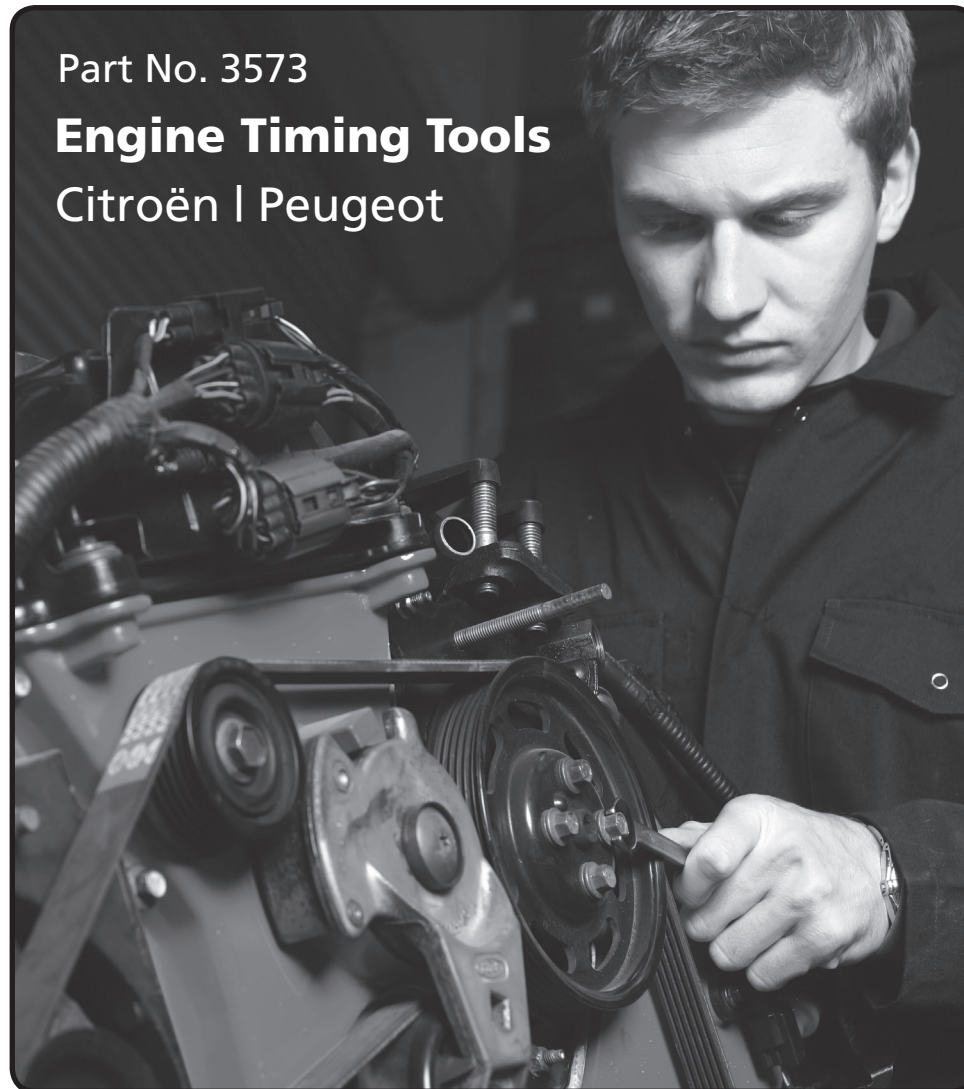

www.lasertools.co.uk

www.lasertools.co.uk

Plan Layout

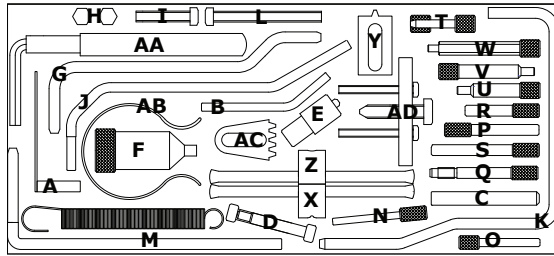
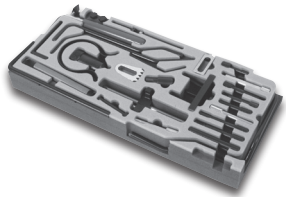

Ref	Code	Oem Code	Description
A	C208	KM-953	Crankshaft TDC Timing Pin
B	C038	KM-952	Camshaft Setting Plate
C	C039	KM-954	Timing Disc Position Gauge
D	C040	KM-955	Tensioner Retaining Pin 2.5mm
E	C041	KM-955	Tensioner Retaining Pin 4.0mm
F	C042	0189-C	Flywheel Locking Pin
G	C062	0153-N G.0153-N 0188-D 7004-TG	Crankshaft Timing Pin 8mm
H-I	C063		Locking Screw Set M8 (3)
J	C065	7017-TR	Crankshaft Timing Pin 7mm
K	C066	0153-N 0188-D 0188-Y 0288-D 7099-TM	Crankshaft Timing Pin 8mm
L	C068	0188-X	Setscrew M8 x 70mm
M	C069	0118-X	Crankshaft Timing Pin
N	C308	0132-AB 4527-T-52 5711-TD	Injection Pump Timing Pin
O	C309	0188-H	Crankshaft Timing Pin
P	C310	0189-B	Crankshaft Timing Pin
Q	C387	4527-T-51	Injection Pump Timing Pin
R	C389	0132-AJ1 4533-TAC1	Crankshaft Timing Pin
S	C323	0132-AJ2 0188-M 4533-TAC2	Crankshaft Timing Pin
T	C390	5711-TC 9041-TZ	Crankshaft Timing Pin
U	C455	0189-A	Crankshaft Timing Pin
V	C089	0189-AZ	Crankshaft Timing Pin
W	C091	0189-L	Inlet Camshaft Timing Pin (VTC)
X	C101	0178-E 0188-J/J1 5711-TE	Tensioner Adjuster
Y	C103	0134-AF 0188-F 9044-T	Flywheel Locking Tool
Z	C104	0188-J2	Tensioner Adjuster
AA	C105	7017-TW	Tensioner Adjuster 8mm Hex
AB	C106	0132-AK 0153-AK 0187-J 0188-K 0189-K 4533-TAD	Timing Belt Retaining Clip
AC	C107	D.86 0153-A 6012-T 9765-54 9044	Flywheel Locking Tool
AD	C108	0188-P/P2 7015-T	Crankshaft Pulley Remover

www.lasertools.co.uk

Instruction (DE)

Nockenwellen und Einspritzpumpe Riemenscheiben-Sicherungsstift

wird zur Sicherung der Einstellposition der Nockenwelle zur Einspritzpumpe verwendet und ist für zweiteilige Kettenräder, die durch drei Schrauben gesichert werden. Der Stift ist speziell ausgehöhlt, damit Kraftstoff den Stift nicht wieder herausdrückt.

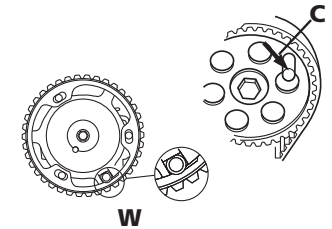

Schwungrad - Fixierdorn es gibt fünf andere Stücke, die in diesem eingeschlossen werden, das gesetzt wird. Wie mit der Nockenwelle-Timing-Nadel werden sie durch den Motorblock hineingesteckt und gebraucht, die Kurbelwelle aufzustellen, um die korrekte Timing-Position des ersten Zylinders zu erreichen. Es ist wichtig, daß diese Stücke benutzt werden, um die riemens-Position zu setzen, aber wird nicht benutzt werden, um das Schwungrad abzuschließen.

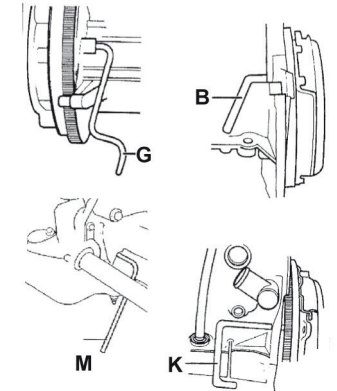

Schwungrad-Fixierwerkzeug es gibt vier andere Stücke, die in diesem Satz eingeschlossen werden, und wird benutzt, um den Kurbelwelle-whilst abzuschließen, der den Schwungrad-Rolle-Blitz löst und festwiederzieht.

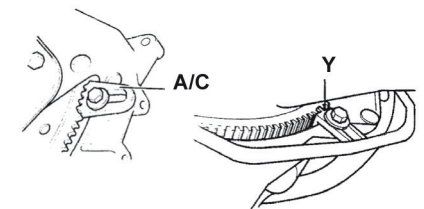

Spannwerkzeug

Es gibt vier Arten in diesem Satz, der der korrekten Spannung ermöglicht, zum riemens-Gürtel angewandt zu werden.

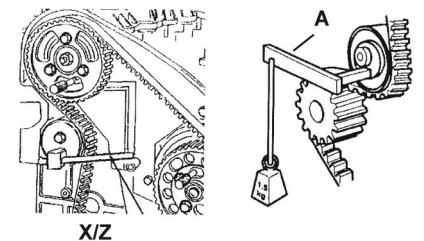

Verschiedene Werkzeuge

Der Gürtel, der Klammer behält, wird benutzt, wenn die Anprobe-Reihenfolge bei der unterst Rolle beginnt und den Gürtel verhindert, der herunterrutscht.

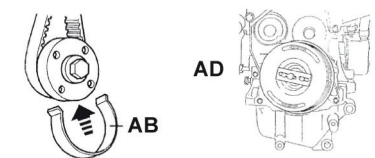

Der Kurbelwellenriemenscheibe-Entferner ist auf HDi Motoren wesentlich.

www.lasertools.co.uk

Instruction (ES)

Pin de Seguridad de Polea de Bomba de Inyección se utiliza para asegurar la posición de tiempos del eje de levas con la bomba de inyección y es para los piñones de dos piezas retenidos por tres pernos. El pin está especialmente hueco para prevenir que el combustible lo empuje afuera.

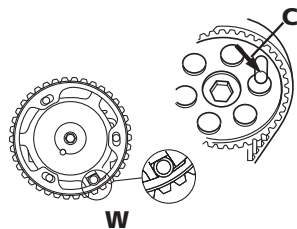

Pasadores de bloqueo del volante

Hay cinco pedazos diferentes incluidos en esto puesto. Como con el árbol de levas que cronometra el alfiler, ellos se insertan a través del bloque motor y posicionaban el cigüeñal para lograr la posición de la oportunidad correcta del primer cilindro. Es importante que estos pedazos se usan para poner la posición de la oportunidad, pero no será usado para cerrar con llave el volante.

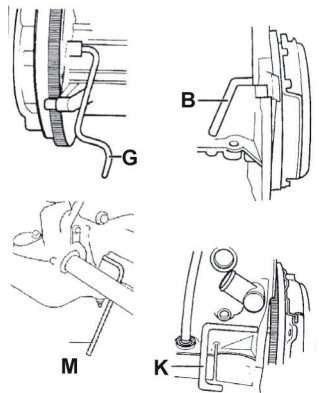

Herramienta de boqueo del cigüeñal

Hay cuatro pedazos diferentes incluidos en este juego, y se usa para cerrar con llave el cigüeñal aunque desabrochando y re-apretando la saeta de polea de volante.

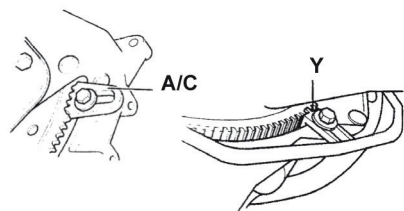

Herramienta de tensado

Hay cuatro tipos en este juego que permite aplicar la tensión correcta a la correa de distribución.

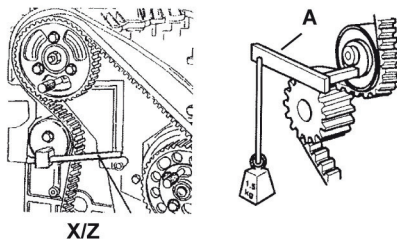

Las Herramientas misceláneas

El Clip de sujeción de la correa de distribución se usa cuando las salidas de la sucesión dignas a la polea del fondo y previene el cinturón que se resbala fuera de.

El Extractor de piñón del volante es esencial en los artefactos de HDi.

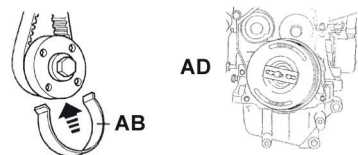

Applications

The application list for this product has been compiled cross referencing the OEM Tool Code with the Component Code.

In most cases the tools are specific to this type of engine and are necessary for Cam belt or chain maintenance.

If the engine has been identified as an interference engine valve to piston damage will occur if the engine is run with a broken Cam belt.

A compression check of all cylinders should be performed before removing the cylinder head.

Always consult a suitable work shop manual before attempting to change the Cam belt or Chain.

Autodata

Our applications data is supplied by Autodata and we are able to supply this data to you in a PDF format.

If this is a specific kit for a group of engine codes the application list has been supplied showing the main vehicles this kit is designed for and does not list every model each pin fits.

If this is a master kit then all vehicles are included.

The data is the copyright of Tool Connection and should not be reproduced.

If the application data is extensive we have included a CD with the application list in .pdf format.

Languages

We have also included where possible translations for the instructions in the following languages:

- French
- Spanish
- German
- Portuguese
- Italian
- Dutch

The use of these engine timing tools is purely down to the user's discretion and Tool Connection cannot be held responsible for any damage caused what so ever.

ALWAYS USE A REPUTABLE WORKSHOP MANUAL

Instruction (GB)

Camshaft & Injection Pump Pulley Timing Pins

There are over ten different sized pins included in this set. These are generally used to lock the correct timing position by being inserted through the camshaft sprocket into a matching hole in the cylinder head.

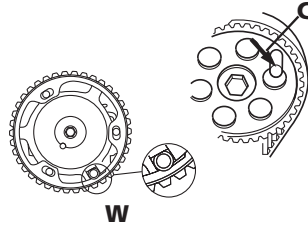

Crankshaft Timing Pins

There are five different pieces included in this set. As with the camshaft timing pin, they are inserted through the engine block and used to position the crankshaft to achieve the correct timing position of the first cylinder.

It is important that these pieces are used to set the timing position, but are not to be used to lock the flywheel when loosening the pulley fasteners.

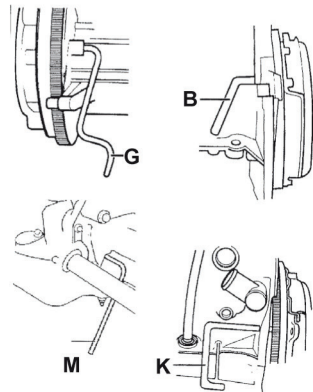

Flywheel Locking Tools

There are four different pieces included in this set, and are used to lock the crankshaft whilst unfastening and re-tightening the flywheel pulley bolt.

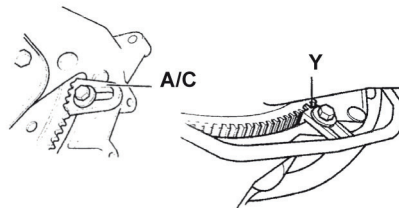

Tensioning Tools

There are four types in this set, which enable the correct tension to be applied to the timing belt.

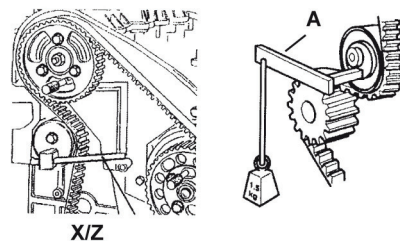

Miscellaneous Tools

The Belt Retaining Clip is used when the fitting sequence starts at the bottom pulley and prevents the belt slipping off.

The Crankshaft Pulley Remover is essential on HDi engines.

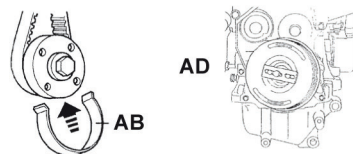

Instruction (FR)

Pige de calage et blocage d'arbre à cames et de pompe à injection:

Ceux-ci sont utilisés pour fermer à clé la place du réglage correcte en étant inséré à travers la dent de l'arbre à cames dans un trou assorti dans la tête du cylindre généralement.

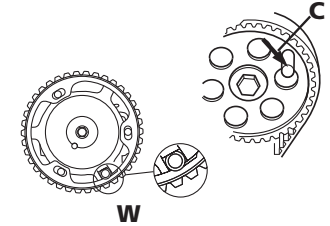

Piges de calage des volants moteurs:

Permet le calage du vilebrequin au PMH.

Outil de calage moteur de PMH, à ne pas utiliser comme outil de blocage moteur.

Il y a cinq outils différents inclus dans ceci mis.

Ils sont insérés à travers le bloc du moteur et usagé placer le vilebrequin pour accomplir la place du réglage correcte du cylindre premier. C'est important que ces pièces sont utilisés pour mettre la place du réglage correcte, mais ne sera pas utilisé pour fermer à clé le volant quand défaire les attaches de la poulie.

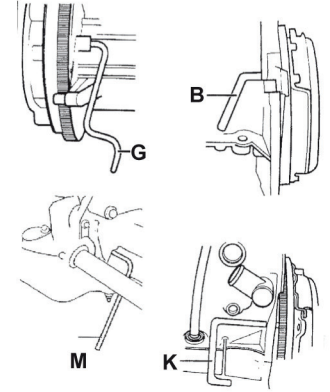

Outils de calage des volants moteurs:

Permet le calage du vilebrequin au PMH.

Outil de calage moteur de PMH, à ne pas utiliser comme outil de blocage moteur.

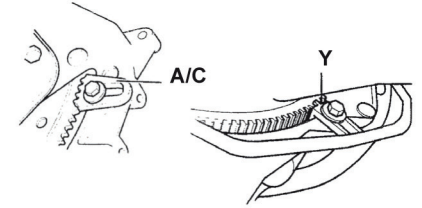

Outils de tendeur:

Ce coffret contient 5 outils pour l'application de la tension correcte sur la courroie de distribution.

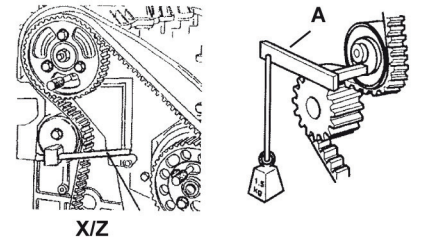

Les Outils Divers:

Clip de maintien de courroie. Cet outil sert à maintenir la courroie de distribution sur le pignon du vilebrequin pour éviter les décalages.

L'extracteur de poulie de volant moteur c'est nécessaire pour moteurs HDi.

