

Product Bulletin

TO: All Valued Beck/Arnley Customers 2011-04-PB-AL

FROM: Product Management

DATE: August 2, 2011

SUBJECT: Fuel Pump Installation Procedure for 152-0988 and 152-0989 Kits

152-0988 & 152-0989 Fuel Pump Installation Procedure

Included in this fuel pump kit is a new o-ring, which is used to seal the fuel pump outlet to the fuel filter inlet. Failure to install the pump properly will result in low fuel pressure due to leakage at the seal. Please follow the instructions below to ensure a proper installation.

1. Remove fuel pump module from the vehicle using proper procedure outlined in the vehicle's service manual.
2. Disconnect the necessary clips and connectors, and remove the filter/pump assembly from the module. Use caution to not damage the plastic clips on the fuel pump module housing or filter.

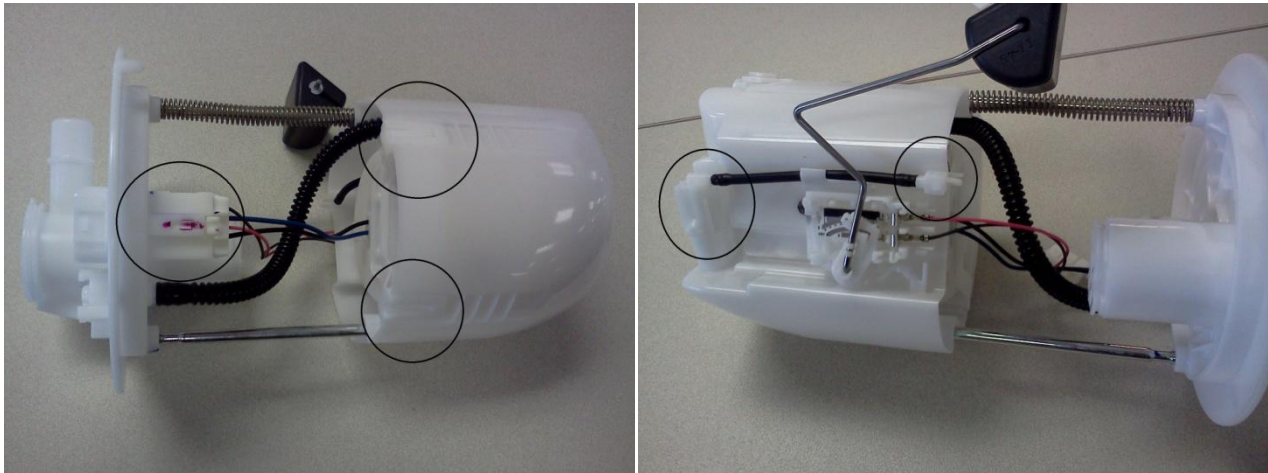

3. Remove the strainer w/ hose and fuel pump from the filter assembly. (If the original sealing o-ring is still on the filter inlet, remove it at this time).



- Lubricate the new o-ring with fuel or suitable lubricant that is safe for use with automotive fuel systems, and install on the filter inlet that is inside the fuel filter. Use of pliers may be necessary to install o-ring in place due to the inlet's location. Be sure not to damage the o-ring during this process. Re-lubricate the o-ring at this time.

Before Installation:



After Installation:



- Lubricate the inside of the fuel pump outlet and install the pump into the fuel filter. Take care not to damage the o-ring during installation. There will be a noticeable and positive engagement as the pump seats into the filter housing. When properly installed, the bottom of the fuel pump will be flush with the bottom of the fuel filter.

Improperly Installed

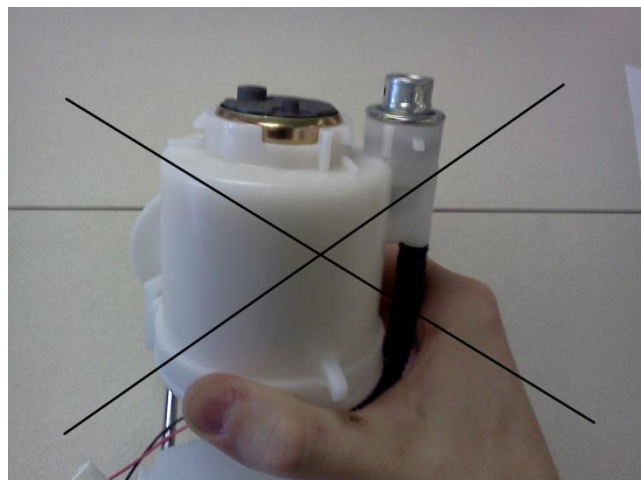

Properly Installed



- Install the new strainer onto the bottom of the fuel filter/pump assembly. Be sure to attach all clips and align the ports on the bottom of the fuel pump.
- Install the completed fuel filter/pump assembly into the module, attaching all clips and connections.
- Re-install pump into the vehicle's fuel tank using proper procedures outlined in the vehicle's service manual.