

# **Servicemanual Prover10-ED**

**Version: 2.00**

**Ident:**

**Series:**

**Pert-Number: 102712**

**This part can be ordered.**



## **Chapter**

add-on kit / construction kit Prover GS10-ED - V:

door Prover GS10-ED - V:

102722 - frame Prover GS10-ED - V:

102719 - operating unit GS manual complete Prover 10-ED - V:

102624 - operating unit IS 500 Prover GS10-ED - V:

102623 - operating unit IS 600 Prover GS10-ED - V:

102552 - tray runners GS1-ED complete (2x5) Prover GS10-ED - V:

102716 - water-energy unit complete 230V 50Hz Prover GS10-ED-MAN - V:

102650 - water-energy unit Prover10-ED-IS complete - V:

# **Servicemanual add-on kit / construction kit Prover GS10-ED**

**Version:**

**Ident:**

**Series:**

**Pert-Number:**



## **Chapter**

66055 - construction kit solenoid valve - V:

103523 - water-energy unit\_NR for Prover10-ED-Man - V:

103522 - water-energy unit\_NR für Prover10-ED-IS - V:

## Service manual construction kit solenoid valve

**Version:**

**Ident:**

**Series:**

**Pert-Number: 66055**

**This part can be ordered.**

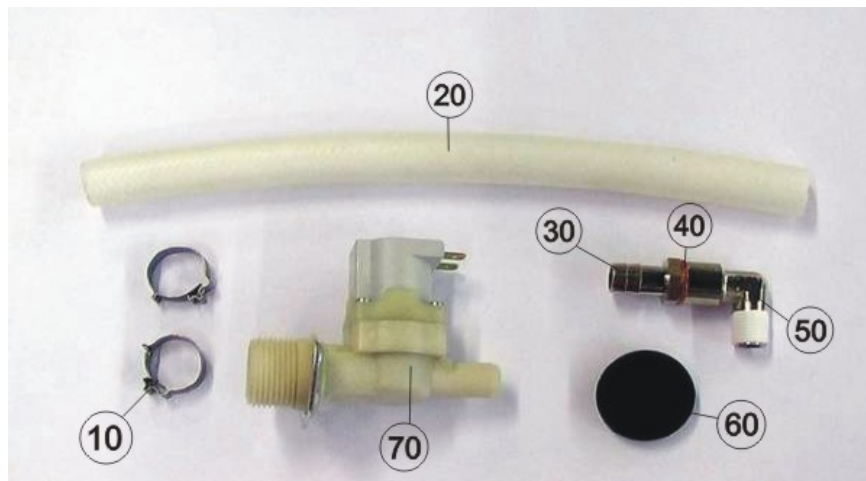

### Chapter

- [010] - 100138 - hose clamp Cobra 17/8
- [020] - 33524 - HT - hose silicone D 18xS3 LW12
- [030] - 33358 - hose connection G1/4"
- [040] - 33560 - sealing ring copper
- [050] - 33350 - brass angle
- [060] - 103330 - nozzle to lead the diaphragm through for safety temperature limiter
- [070] - 103550 - solenoid valve

## Part: hose clamp Cobra 17/8

Pert-Number: 100138



---

## Part: HT - hose silicone D 18xS3 LW12

Pert-Number: 33524



---

## Part: hose connection G1/4"

Pert-Number: 33358



---

## Part: sealing ring copper

Pert-Number: 33560



## Part: brass angle

**Pert-Number: 33350**



---

## Part: nozzle to lead the diaphragm through for safety temperature limiter

**Pert-Number: 103330**

To reset the safety temperature limit switch the fan cover which is found in the interior of the proofer must be removed. The knob is protected from spray and steam under a membrane case. By firmly pressing the covered key the safety temperature limit can be re-set. Please note that the STB does not activate without reason!



---

## Part: solenoid valve

**Pert-Number: 103550**

It is necessary to clean the dirt sieve of the solenoid valve regularly. Particles in the water line will stick to the sieve and interrupt the water flow. Please note the maximum water pressure and other warnings from the data sheets regarding the water connection. The solenoid valve is a valve for the steaming filler as well as for the automatic cleaning process Pro Clean. The solenoid valve works with a flow pressure of 150 - 600 kPa. You can test the solenoid valve function in the PC - Tool - Test. Attention the test is a continued test and this function is not protected from overload.



# Service manual water-energy unit\_NR for Prover10-ED-Man

Version:

Ident:

Series:

Pert-Number: 103523

This part can be ordered.

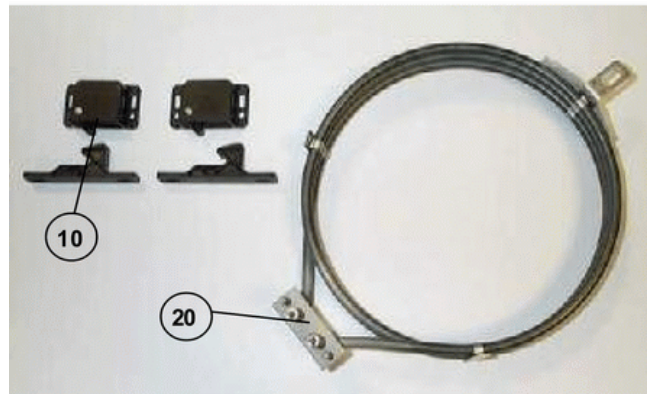

## Chapter

[010] - 103112 - vice action latch (door)

[020] - 103551 - heating 2000 W

## Part: vice action latch (door)

**Pert-Number: 103112**

If the door lock needs to be re set. loosen the screws around the door latch. Thanks to the slotted holes the door can be easily adjusted. Only a correctly aligned door can guarantee the necessary door seal which results in optimal proofing.



---

## Part: heating 2000 W

**Pert-Number: 103551**

We recommend when installing the heater the securing screws are non-threading. Please make sure the heater is correctly situated so that the securing attachments fit through the fan wheel to be connected.



# Service manual water-energy unit\_NR für Prover10-ED-IS

**Version:**

**Ident:**

**Series:**

**Pert-Number: 103522**

**This part can be ordered.**

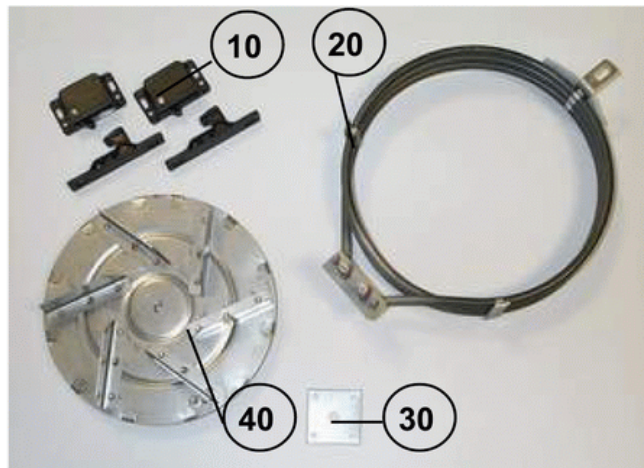

## Chapter

- [010] - 103112 - vice action latch (door)
- [020] - 103551 - heating 2000 W
- [030] - 103477 - sealing plate
- [040] - 102651 - vaporizer



## Part: vice action latch (door)

**Pert-Number: 103112**

If the door lock needs to be re set. loosen the screws around the door latch. Thanks to the slotted holes the door can be easily adjusted. Only a correctly aligned door can guarantee the necessary door seal which results in optimal proofing.



---

## Part: heating 2000 W

**Pert-Number: 103551**

We recommend when installing the heater the securing screws are non-threading. Please make sure the heater is correctly situated so that the securing attachments fit through the fan wheel to be connected.



---

## Part: sealing plate

**Pert-Number: 103477**



## Part: vaporizer

Pert-Number: 102651

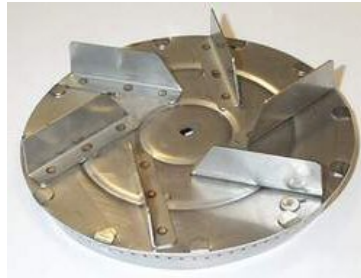

# Service manual door Prover GS10-ED

**Version:**

**Ident:**

**Series:**

**Pert-Number:**

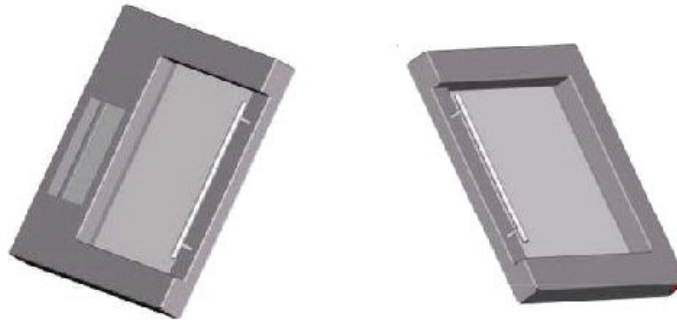

## Chapter

- [010] - 102723 - door GS10-ED, complete
- [011] - 102770 - door GS10-ED
- [012] - 102743 - cover
- [020] - 102724 - door GS10-ED with cutout , complete
- [021] - 102774 - door GS10-ED with cutout for control
- [030] - 102807 - vice action latch (door)
- [040] - 102809 - door handle GS10/GS1-ED
- [050] - 102812 - bush bearing
- [060] - 34297 - plug (door)

## Part: door GS10-ED, complete

Pert-Number: 102723



---

## Part: door GS10-ED

Pert-Number: 102770

Should the door or the glass of the proofer door show any damage the complete door must be exchanged. The doors are made from high quality plastic and should not be cleaned with abrasive cleaning agents. Please notify your customer of this. Please tell us the year of construction and the door end position when you order the spare part.



---

## Part: cover

Pert-Number: 102743

---

## **Part: door GS10-ED with cutout , complete**

**Pert-Number: 102724**



---

## **Part: door GS10-ED with cutout for control**

**Pert-Number: 102774**

---

## **Part: vice action latch (door)**

**Pert-Number: 102807**

If the door lock needs to be re set. loosen the screws around the door latch. Thanks to the slotted holes the door can be easily adjusted. Only a correctly aligned door can guarantee the necessary door seal which results in optimal proofing.



## Part: door handle GS10/GS1-ED

**Pert-Number: 102809**

To prevent damage ensure that both door handles are securely fastened. The door handle is secured with screw M4X10 article number 42392 and washer article number 42209. Additionally the handle is secured with Locite 243 article number 61905.



---

## Part: bush bearing

**Pert-Number: 102812**

To ensure the proofer door opens and closes properly check the door bearings.



---

## Part: plug (door)

**Pert-Number: 34297**



# **Servicemanual** **frame Prover GS10-ED**

**Version:**

**Ident:**

**Series:**

**Pert-Number: 102722**

**This part can be ordered.**

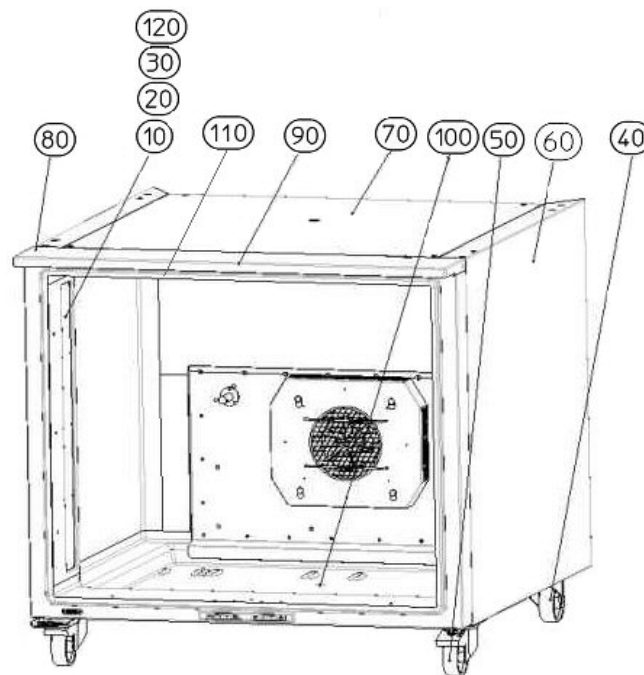

## **Chapter**

- [010] - 102567 - halogen socket
- [020] - 101731 - halogen lamp 12V 10W
- [030] - 33042 - porcelain clamp 2-pole 10A
- [040] - 105586 - castor; Attention replaced by 9050-110-004
- [040] - 9050-110-004 - castor
- [050] - 105585 - castor with arresting device => Attention, replaced by 9050-110-003
- [050] - 9050-110-003 - castor with arresting device
- [060] - 102647 - side panel
- [070] - 102823 - cover
- [080] - 102733 - panel
- [090] - 103112 - vice action latch (door)
- [100] - 36149 - plug for water tray
- [110] - 38605 - door seal
- [120] - 0600-001-010 - lighting blade

## Part: halogen socket

**Pert-Number: 102567**

Check the porcelain lamp holders and cables for damage. Please do not squeeze or kink the cable.



---

## Part: halogen lamp 12V 10W

**Pert-Number: 101731**

When changing the halogen lamps please make sure that the lamps do not come in contact with hand sweat. Hand sweat will burn into the glass bulb and reduces the life of the halogen lamp. Please use the appropriate gloves.



---

## Part: porcelain clamp 2-pole 10A

**Pert-Number: 33042**

Check the porcelain lamp holders and cables for damage. Please do not squeeze or kink the cable.



---

## Part: castor; Attention replaced by 9050-110-004

**Pert-Number: 105586**



## Part: castor

**Pert-Number: 9050-110-004**

To allow a simple driving out for maintenance, the wheels should be positioned in the direction of motion so that the wheels do not get stuck.



---

## Part: castor with arresting device => Attention, replaced by 9050-110-003

**Pert-Number: 105585**

---

## Part: castor with arresting device

**Pert-Number: 9050-110-003**

To allow a simple driving out for maintenance, the wheels should be positioned in the direction of motion so that the wheels do not get stuck.



---

## Part: side panel

**Pert-Number: 102647**

---

## Part: cover

**Pert-Number: 102823**

---

## Part: panel

**Pert-Number: 102733**

---

## Part: vice action latch (door)

**Pert-Number: 103112**

If the door lock needs to be re set, loosen the screws around the door latch. Thanks to the slotted holes the door can be easily adjusted. Only a correctly aligned door can guarantee the necessary door seal which results in optimal proofing.



---

## Part: plug for water tray

**Pert-Number: 36149**

The plug in the water tub seals the cleaning opening of the proofer. To maintain an optimal climate in the proofer it is necessary to make sure that the plug is always closed when operating the proofer.



---

## Part: door seal

**Pert-Number: 38605**

The door seal is glued with transparent heat resistant silicone (order number 60375) around the radii on the corners and long distances in between. Should the door seal be exchanged then all the silicone must be removed by using a knife. Clean the door tracks and any silicone particles. Make sure when placing the new seal that it is completely in the frame. The seal needs to be pressed around the connecting piece on the top and bottom and in front of the oven with a broach so that it can "breathe". The door seal is a spare part and can be ordered under the number 38605.



**Part: lighting blade**

**Pert-Number: 0600-001-010**

---

# **Servicemanual** **operating unit GS manual complete Prover 10-ED**

**Version:**

**Ident:**

**Series:**

**Pert-Number: 102719**

**This part can be ordered.**

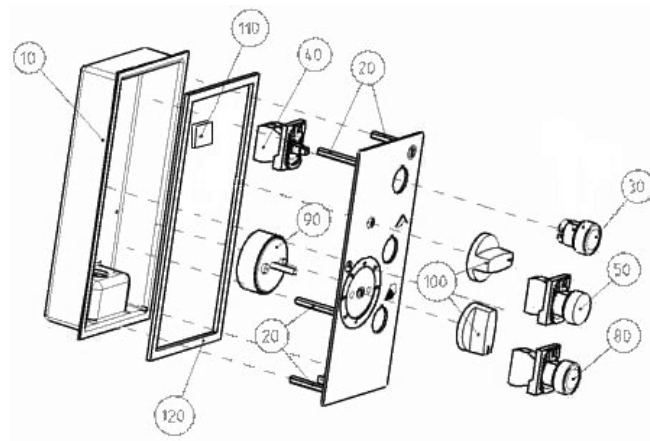

## **Chapter**

- [010] - 102450 - frame IS
- [020] - 101864 - distance bolt
- [030] - 102523 - push button illuminated
- [040] - 102524 - supporting switch block ZB AWM OM11
- [050] - 102522 - indicator light "white"
- [080] - 102521 - push button XB 5SS21 black
- [090] - 33576 - timer 60 minutes
- [100] - 38898 - knob
- [110] - 103023 - thermostat 0-45°C
- [120] - 102449 - seal for frame IS

## Part: frame IS

**Pert-Number: 102450**

Check that all securing screws are present on the frame. In addition check the grounding to frame connection



---

## Part: distance bolt

**Pert-Number: 101864**



---

## Part: push button illuminated

**Pert-Number: 102523**



## Part: supporting switch block ZB AWM OM11

Pert-Number: 102524



---

## Part: indicator light "white"

Pert-Number: 102522



---

## Part: push button XB 5SS21 black

Pert-Number: 102521



## Part: timer 60 minutes

Pert-Number: 33576



## Part: knob

Pert-Number: 38898



## Part: thermostat 0-45°C

Pert-Number: 103023

The thermostat measures the temperature in the baking chamber. The measurements comes from the fluid filled capillary tubes. Do not kink the wire of the capillary tube when inserting this will lead to a false reading of the temperature. Insulate the capillary tube on its critical spots ( e.g. on the circuit boards ) with silicone hose Article 40074.

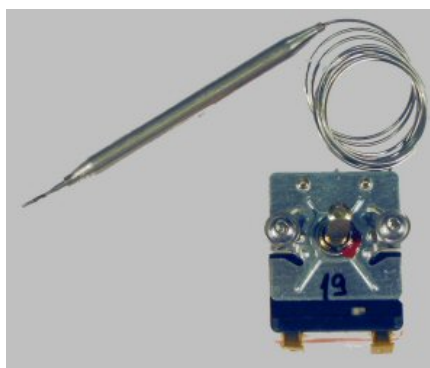

## Part: seal for frame IS

**Pert-Number: 102449**

The seal must be correctly installed to avoid moisture admittance.





# **Servicemanual** **operating unit IS 500 Prover GS10-ED**

**Version:**

**Ident:**

**Series:**

**Pert-Number: 102624**

**This part can be ordered.**

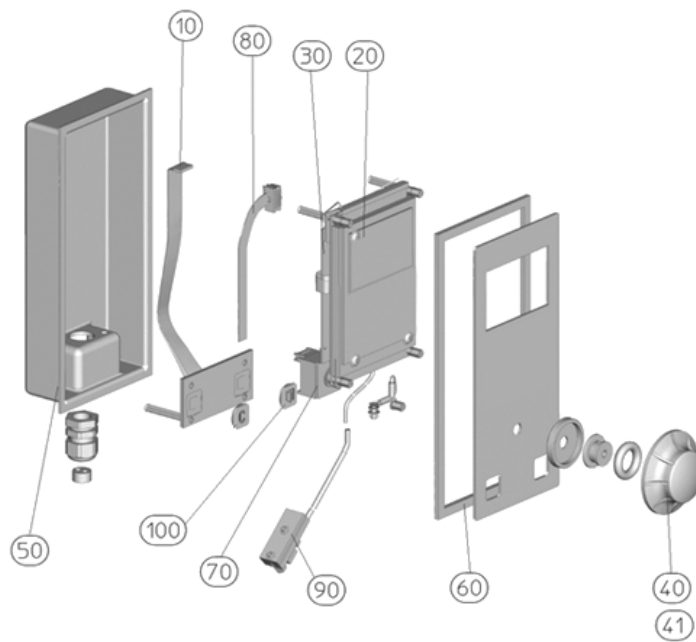

## **Chapter**

- [010] - 101563 - key block
- [020] - 100804 - display IS500 with circuit board
- [030] - 105564 - electronic circuit board IS500
- [040] - 102685 - knob grey
- [041] - 101350 - knob silver
- [050] - 102450 - frame IS
- [060] - 102449 - seal for frame IS
- [070] - 100591 - incremental encoder
- [080] - 104353 - ribbon cable for IS500
- [090] - 102806 - USB port with data wire
- [100] - 105849 - key "C / door"

## Part: key block

**Pert-Number: 101563**

Ensure that the all contact to the connector is clean and free of grease. Its function can be tested with the Wiesheu PC-Tool/Test/Navigate.



---

## Part: display IS500 with circuit board

**Pert-Number: 100804**

This article has been replaced by Articles 104 771, but is not fully compatible. Please follow the spare part instruction "EH\_196-0511-005 Display IS500"



## Part: electronic circuit board IS500

**Pert-Number: 105564**

When exchanging the electronic circuit board, please note that electrostatic charge and its components can cause major damage. Therefore please make sure that before coming in contact with the circuit board that the circuit board and its metal frame are completely discharged. Check the DIP - switch setting and the input resistance as in the enclosed document. If interference occurs when transferring data from the PC to the Control ( dark display ), use a flash cable and the programs flash writer to re-write the program. Read the operating-instructions for "Flash-Tool".

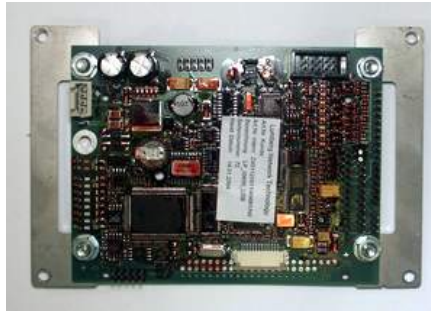

---

## Part: knob grey

**Pert-Number: 102685**

Depending on the version, the button "silver" or "grey" is used.



---

## Part: knob silver

**Pert-Number: 101350**

Depending on the version, the button "silver" or "grey" is used.



## Part: frame IS

**Pert-Number: 102450**

Check that all securing screws are present on the frame. In addition check the grounding to frame connection



---

## Part: seal for frame IS

**Pert-Number: 102449**

The seal must be correctly installed to avoid moisture admittance.

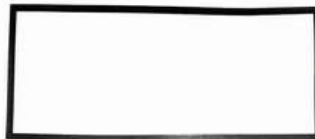

---

## Part: incremental encoder

**Pert-Number: 100591**

Check the incremental sensor using the function test in PC-Tool. To recall function test read the documents to the article.



## Part: ribbon cable for IS500

**Pert-Number: 104353**

The ribbon cable connects the circuit board IS 600 and the display. The ribbon cable has a plug on both sides. Ensure that the ribbon cable does not twist or kink.



---

## Part: USB port with data wire

**Pert-Number: 102806**

USB interface with USB connection "B". Data interface to PC.



---

## Part: key "C / door"

**Pert-Number: 105849**

The keys "C/door" are to be acquired seperately.

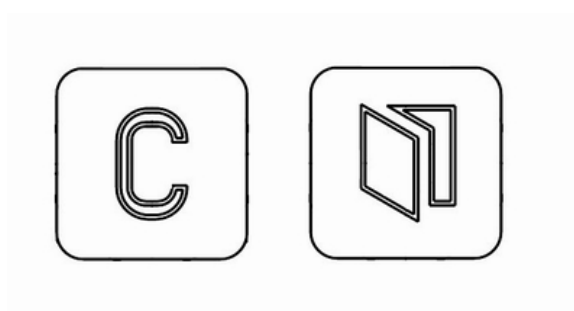

# **Servicemanual** **operating unit IS 600 Prover GS10-ED**

**Version:**

**Ident:**

**Series:**

**Pert-Number: 102623**

**This part can be ordered.**

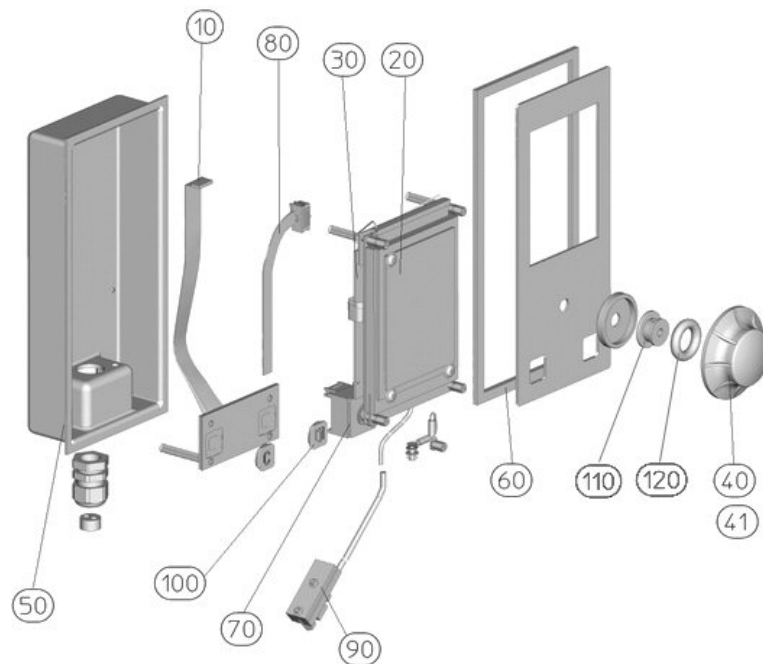

## **Chapter**

- 101438 - inner ring D40x6
- 101894 - grub screw
- [010] - 101563 - key block
- [020] - 100617 - display IS600 with circuit board
- [030] - 101107 - electronic circuit board IS600
- [040] - 102685 - knob grey
- [041] - 101350 - knob silver
- [050] - 102450 - frame IS
- [060] - 102449 - seal for frame IS
- [070] - 100591 - incremental encoder
- [080] - 104354 - ribbon cable for IS600
- [090] - 102806 - USB port with data wire
- [100] - 105849 - key "C / door"
- [110] - 101434 - adapter\_D54x22
- [120] - 101435 - O-ring\_D16x7\_NBR60

## Part: inner ring D40x6

Pert-Number: 101438



## Part: grub screw

Pert-Number: 101894



## Part: key block

Pert-Number: 101563

Ensure that the all contact to the connector is clean and free of grease. Its function can be tested with the Wiesheu PC-Tool/Test/Navigate.



## Part: display IS600 with circuit board

**Pert-Number: 100617**

Ensure that the all contact to the connector is clean and free of grease. Adjust the contrast of the screen to the surrounding area. Set the contrast by going to "Settings" - "Appliance Settings" - "Display" - "Contrast ".



---

## Part: electronic circuit board IS600

**Pert-Number: 101107**

When exchanging the electronic circuit board, please note that electrostatic charge and its components can cause major damage. Therefore, please make sure that before coming in contact with the circuit board that the circuit board and its metal frame are completely discharged. Check the DIP - switch setting and the input resistance as in the enclosed document. If interference occurs when transferring data from the PC to the Control ( dark display ), use a flash cable and the programs flash writer to re-write the program. Read the instructions about part documents.





## Part: knob grey

**Pert-Number: 102685**

Depending on the version, the button "silver" or "grey" is used.



---

## Part: knob silver

**Pert-Number: 101350**

Depending on the version, the button "silver" or "grey" is used.



---

## Part: frame IS

**Pert-Number: 102450**

Check that all securing screws are present on the frame. In addition check the grounding to frame connection



## Part: seal for frame IS

**Pert-Number: 102449**

The seal must be correctly installed to avoid moisture admittance.

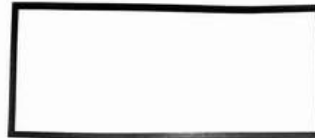

---

## Part: incremental encoder

**Pert-Number: 100591**

Check the incremental sensor using the function test in PC- Tool. To recall function test read the documents to the article.



---

## Part: ribbon cable for IS600

**Pert-Number: 104354**

The ribbon cable connects the circuit board IS 600 and the display. The ribbon cable has a plug on both sides. Ensure that the ribbon cable does not twist or kink.



## Part: USB port with data wire

**Pert-Number: 102806**

USB interface with USB connection "B". Data interface to PC.



## Part: key "C / door"

**Pert-Number: 105849**

The keys "C/door" are to be acquired seperately.

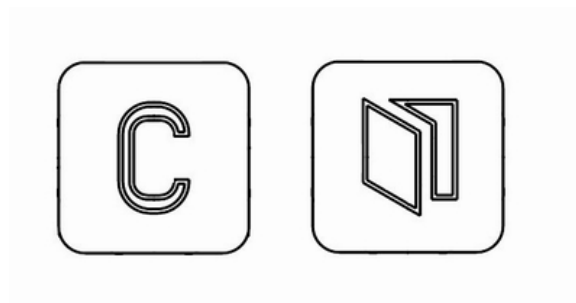

## Part: adapter\_D54x22

**Pert-Number: 101434**



**Part: O-ring\_D16x7\_NBR60**

**Pert-Number: 101435**



# **Servicemanual**

## **tray runners GS1-ED complete (2x5) Prover GS10-ED**

**Version:**

**Ident:**

**Series:**

**Pert-Number: 102552**

**This part can be ordered.**

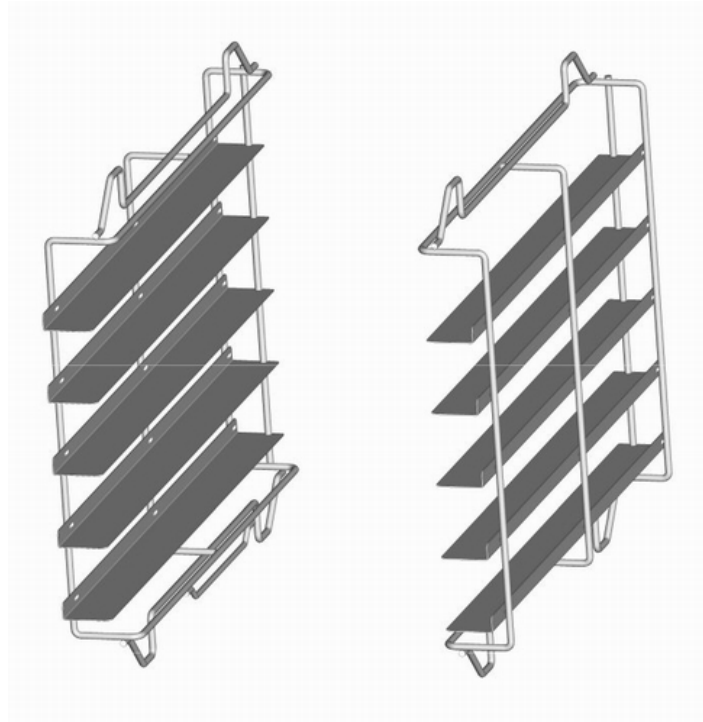

### **Chapter**

[001] - 102552 - tray runners GS1-ED complete (2x5)

[010] - 103026 - tray runners GS-ED, 5 trays left

[020] - 103027 - tray runners GS-ED, 5 trays right

## **Part: tray runners GS1-ED complete (2x5)**

**Pert-Number: 102552**

---

## **Part: tray runners GS-ED, 5 trays left**

**Pert-Number: 103026**

To remove the racks, lift the bottom of the rack upwards, over the plastic securing brackets and pull out sideways. To insert the racks, hook them into the top plastic fasteners first and then affix them to the bottom plastic fasteners.

---

## **Part: tray runners GS-ED, 5 trays right**

**Pert-Number: 103027**

To remove the racks, lift the bottom of the rack upwards, over the plastic securing brackets and pull out sideways. To insert the racks, hook them into the top plastic fasteners first and then affix them to the bottom plastic fasteners.

---

# **Servicemanual** **water-energy unit complete 230V 50Hz Prover GS10-ED-MAN**

**Version:**

**Ident:**

**Series:**

**Pert-Number: 102716**

**This part can be ordered.**

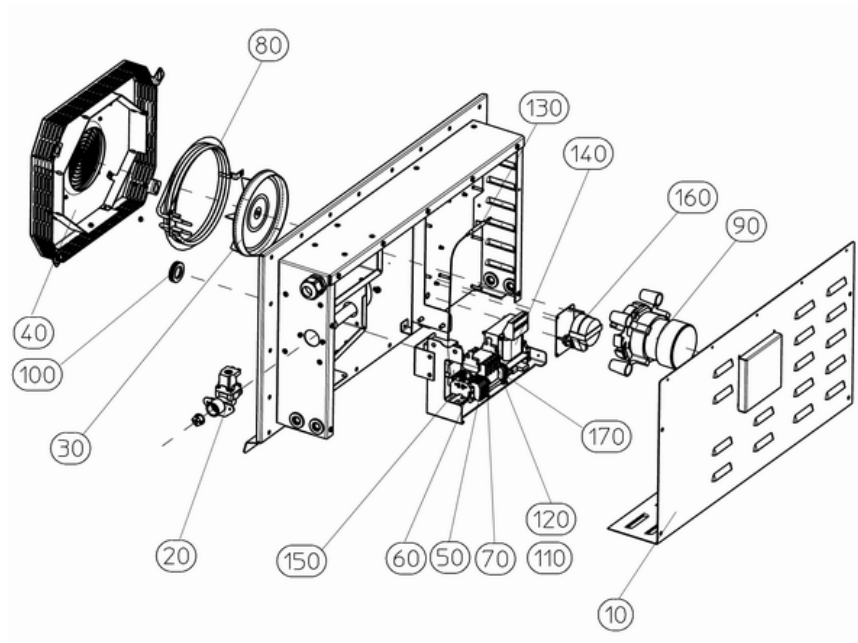

## **Chapter**

- [010] - 102641 - rear panel
- [020] - 103550 - solenoid valve
- [030] - 103068 - vaporizer
- [040] - 103076 - ventilation cover
- [050] - 34101 - base clamp
- [060] - 34102 - finishing plate
- [070] - 34112 - finishing plate
- [080] - 103551 - heating 2000 W
- [090] - 36303 - motor 75W
- [100] - 38525 - nozzle to lead the diaphragm through
- [110] - 35135 - micro-fuse 2A
- [120] - 34752 - micro-fuse 1A
- [130] - 102696 - safety limit switch
- [140] - 100840 - transformer
- [150] - 38706 - capacitor 3 $\mu$ F
- [160] - 103101 - fan reversing switch
- [170] - 33884 - relay main switch

## Part: rear panel

Pert-Number: 102641

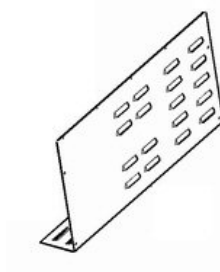

---

## Part: solenoid valve

Pert-Number: 103550

It is necessary to clean the dirt sieve of the solenoid valve regularly. Particles in the water line will stick to the sieve and interrupt the water flow. Please note the maximum water pressure and other warnings from the data sheets regarding the water connection. The solenoid valve is a valve for the steaming filler as well as for the automatic cleaning process Pro Clean. The solenoid valve works with a flow pressure of 150 - 600 kPa. You can test the solenoid valve function in the PC - Tool - Test. Attention the test is a continued test and this function is not protected from overload.



---

## Part: vaporizer

Pert-Number: 103068





## Part: ventilation cover

**Pert-Number: 103076**

Make sure at the end of working with the proofer that the fan cover and safety guard are correctly fastened otherwise there is a risk of injury.

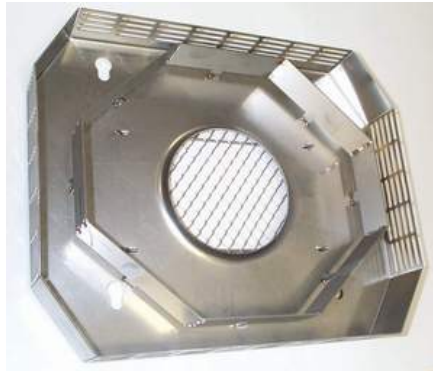

---

## Part: base clamp

**Pert-Number: 34101**



---

## Part: finishing plate

**Pert-Number: 34102**



---

## Part: finishing plate

**Pert-Number: 34112**

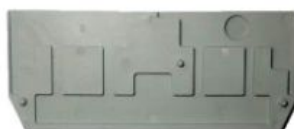

## Part: heating 2000 W

**Pert-Number: 103551**

We recommend when installing the heater the securing screws are non-threading. Please make sure the heater is correctly situated so that the securing attachments fit through the fan wheel to be connected.



---

## Part: motor 75W

**Pert-Number: 36303**

The motor is fastened with 4 M5 nuts, diagonally tighten the nuts to prevent tension. Remember that with each motor removal the motor shaft seal must be replaced.



---

## Part: nozzle to lead the diaphragm through

**Pert-Number: 38525**

To reset the safety temperature limit switch the fan cover which is found in the interior of the proofer must be removed. The knob is protected from spray and steam under a membrane case. By firmly pressing the covered key the safety temperature limit can be re-set. Please note that the STB does not activate without reason!



## Part: micro-fuse 2A

Pert-Number: 35135



---

## Part: micro-fuse 1A

Pert-Number: 34752



---

## Part: safety limit switch

Pert-Number: 102696

After transportation of the appliance please note that the safety temperature limiter (STB) automatically releases with temperatures under +8°C. To allow the appliance to acclimatize let it stand for 30 minutes at room temperature before re-setting the STB. The STB can be re-set as often as needed. Please note that the STB does not activate without reason ! Insulate the capillary tube (e.g. on the circuit board) on its critical spots with silicone hose Article number 40074.

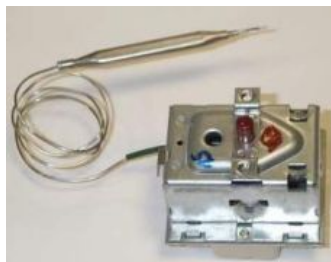



## Part: relay main switch

**Pert-Number: 33884**

The contactor switches the heater on/off.



# **Servicemanual**

## **water-energy unit Prover10-ED-IS complete**

**Version:**

**Ident:**

**Series:**

**Pert-Number: 102650**

**This part can be ordered.**

### **Chapter**

- [010] - 102641 - rear panel
- [020] - 34286 - solenoid valve
- [030] - 34675 - water flow detector
- [040] - 103068 - vaporizer
- [050] - 102530 - screwing
- [060] - 103076 - ventilation cover
- [070] - 34306 - enclosure
- [080] - 38400 - loudspeaker
- [090] - 34912 - semi-conductor relay 1-pole
- [100] - 34344 - heating 2000 W
- [110] - 101106 - power board
- [120] - 103073 - motor
- [130] - 40485 - teflon hose
- [140] - 102015 - cable loom for CAN-Bus
- [150] - 38495 - sensor for temp. and humidity
- [150] - 9030-150-001 -
- [160] - 34092 - line filter 20 VB1
- [170] - 102696 - safety limit switch
- [180] - 34108 - clamp grey 3L 2.5qmm
- [190] - 34109 - clamp 3L blue 280-684
- [200] - 34110 - clamp 3L 2.5qmm 280-687
- [210] - 100840 - transformer
- [220] - 103181 - seal (ferrite)

## Part: rear panel

Pert-Number: 102641

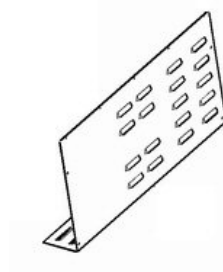

---

## Part: solenoid valve

Pert-Number: 34286

It is necessary to clean the dirt sieve of the solenoid valve regularly. Particles in the water line will stick to the sieve and interrupt the water flow. Please note that the maximum water pressure and other warnings from the data sheets regarding the water connection



---

## Part: water flow detector

Pert-Number: 34675

Please note when installing the regulator, the color codes and the correct installation. Furthermore the pressure flow regulator must be clean for the water flow to be possible.



## Part: vaporizer

Pert-Number: 103068



---

## Part: screwing

Pert-Number: 102530



---

## Part: ventilation cover

Pert-Number: 103076

Make sure at the end of working with the proofer that the fan cover and safety guard are correctly fastened otherwise there is a risk of injury.

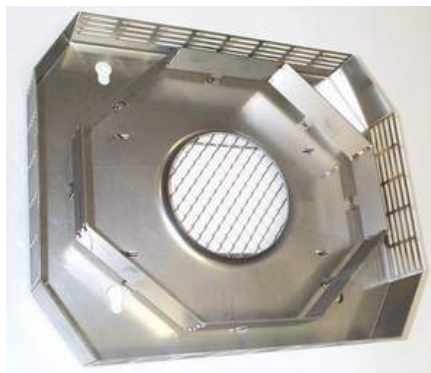



## Part: enclosure

**Pert-Number: 34306**

Make sure at the end of working with the proofer that the fan cover and safety guard are correctly fastened otherwise there is a risk of injury.

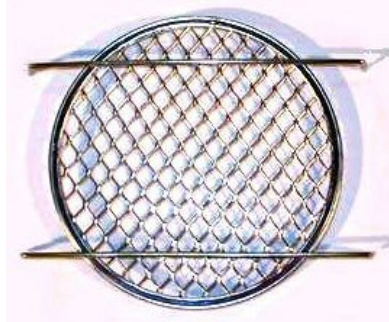

---

## Part: loudspeaker

**Pert-Number: 38400**

The loud speaker signal serves as an acoustic signal. For example notification is given for "temperature reached", "end of program". As well as when opening the door a short gong will sound. If the gong does not work, first of all check the appliance settings. You can reach the menu point "Gong" by going to "Settings - Appliance Settings - Gong". Here you can set the volume and intervals of the sound. If the volume and interval is set to 0 no acoustic signal will be given. Test the gong, by going to the PC-Tool - Function Test. Warning! The PC-Tool- Function test is an endurance test and is not protected from overload!



## Part: semi-conductor relay 1-pole

**Pert-Number: 34912**

The solid state relay controls the heater. Depending on the temperature this will automatically switch it on or off. ( type can vary )



---

## Part: heating 2000 W

**Pert-Number: 34344**

We recommend when installing the heater the securing screws are non-threading. Please make sure the heater is correctly situated so that the securing attachments fit through the fan wheel to be connected.



## Part: power board

**Pert-Number: 101106**

Disconnect power before beginning work. This article is fully prepared for servicing purposes. Please read the appropriate "Article Documents". When replacing the electronic circuit board, electrostatic can damage the circuit board and its components. Ensure before handling the electrical circuit board that a grounded metal frame discharges the electrostatic. The electrical circuit board is available as a service circuit board in a complete version under the Order Number 101106 and can also be used in other appliance models. On the circuit board you will find 3 fuses. F2 output L1 (4A tr); F3 output N (4A tr); F4 output transformer 24, 12, 5 V (1,5A tr). The circuit board has Eeprom with each current software update and an 8 pole Dip- switch (configurations switch). Attention must be given to which switch the Dip- switch is actively switched. The various switch settings can be found in the assembly instructions.



---

## Part: motor

**Pert-Number: 103073**

The motor of the proofer has two directions of motion ( reversing )



---

## Part: teflon hose

**Pert-Number: 40485**



## Part: cable loom for CAN-Bus

**Pert-Number: 102015**

This data cable is to connect additional IS controlled WIESHEU ovens. With multiple appliance operation up to 8 appliances can be connected to each other and operated by a single IS 600 Control. When using the multiple appliance operation a CAN - repeater is required or a phase balance connection X1.3 must be heeded on the power element.



---

## Part: sensor for temp. and humidity

**Pert-Number: 38495**

The combi sensor measures the moisture and proofer chamber temperature. When installing make sure the slits are always facing down so that moisture will not settle on the measuring points giving off wrong readings.



## Part:

**Pert-Number: 9030-150-001**



## Part: line filter 20 VB1

**Pert-Number: 34092**

The net filter is required to prevent customer sided interference in the net.



## Part: safety limit switch

**Pert-Number: 102696**

After transportation of the appliance please note that the safety temperature limiter (STB) automatically releases with temperatures under +8°C. To allow the appliance to acclimatize let it stand for 30 minutes at room temperature before re-setting the STB. The STB can be re-set as often as needed. Please note that the STB does not activate without reason ! Insulate the capillary tube (e.g. on the circuit board) on its critical spots with silicone hose Article number 40074.

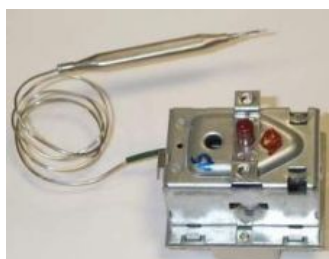

**Part: clamp grey 3L 2.5qmm**

**Pert-Number: 34108**



---

**Part: clamp 3L blue 280-684**

**Pert-Number: 34109**



---

**Part: clamp 3L 2.5qmm 280-687**

**Pert-Number: 34110**





**Copyright:**

WIESHEU GmbH retains the copyright for this service manual.  
This service manual is solely intended for authorised service partners and their personnel.  
It contains instructions and information which may not be copied, distributed or otherwise imparted as a whole or in part.

All representations, drawings, images, texts and details are protected by copyright.  
They are subject to industrial property rights.

**About this service manual:**

All figures in this document have the purpose of aiding comprehension. The figures are not to scale. In some cases the figures are similar to the original product and may differ slightly.

**Important!**

Prevent malfunctions or damage caused by wrong spare parts.  
We recommend the sole use of WIESHEU original spare parts.

**Wiesheu GmbH**  
**Daimlerstraße 10**  
**DE-71563 Affalterbach**  
**Phone: +49 (0)7144 / 3 03-0**  
**Fax: +49 (0)7144 / 3 03-11**  
**Email: [info@wiesheu.de](mailto:info@wiesheu.de)**  
**[www.wiesheu.de](http://www.wiesheu.de)**

Rev.: 10/11/2011