



Model: PPW24K  
Power Anywhere Kit

PLEASE READ THIS INFORMATION THOROUGHLY BEFORE USING THIS PRODUCT. IT CONTAINS IMPORTANT OPERATING INSTRUCTIONS FOR YOUR UNIT.

### Owner's manual

Thank you for purchasing the Power Anywhere Kit. Use it anywhere to have unlimited access to power.

### Included in the package you have purchased:

PowerPort Wave2400 (portable battery), Dual USB Wall Charger, Dual USB Car Charger, Micro USB Cable, Carrying Case & User Manual

### PowerPort Wave2400 - Portable Battery & Charger

The PowerPort Wave2400 charges your PDA, smartphone, MP3 player, game system, or almost any device that can be charged via a USB cable connection.

You have a maximum output of 1.0A with this unit's USB port.

### Charging your PowerPort Wave2400

You can charge the PowerPort Wave2400 with the included Micro-USB to USB cable. Plug the Micro-USB cable into the Micro-USB input port (labeled "in" on unit), and the other end into your computer's USB port. The Dual USB Wall Charger, or Dual USB Car Charger included in your kit.

The LED status indicators show the current charging status of the PowerPort Wave2400. The LED's will blink and become steady as it charges, ascending from the bottom to the top. Once the 4th LED has become steady, the charging process has completed.

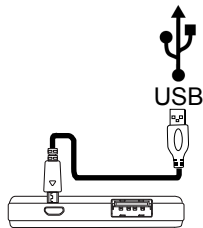
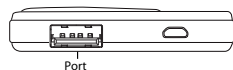

### Capacity Level / Charge Button

With the built-in "Capacity Level / Charge Button" button, you have the option of checking the remaining capacity left in the PowerPort Wave2400. Checking remaining capacity is as easy as pushing the button while the PowerPort Wave2400 is not connected to any device.

One LED indicates 20-40% power remaining.  
Two LED's indicate 40-60% power remaining.  
Three LED's indicate 60-80% power remaining.  
Four LED's indicate 80-100% power remaining.

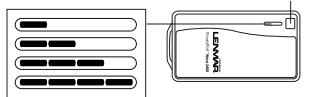

When you're ready to charge your device, plug it in and push the "Capacity Level / Charge Button" to start the charging. Once the button has been pushed, it will charge your connected device. If it senses no device is connected within 30 seconds, it will power off automatically.

### Connecting the PowerPort Wave2400 to your Device.

Attach your device using its USB charging/sync cable (not included) to the PowerPort Wave2400. Once attached via its USB cable, push the "Capacity Level / Charge Button" button once, turning it "ON".

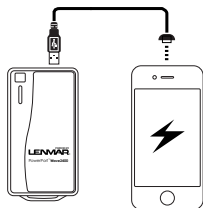

### Features:

- (1) LED Indicator
- (2) Capacity Level / Charge Button
- (3) Micro USB Input Port
- (4) USB Output Port (1.0A)
- (5) Micro USB cable

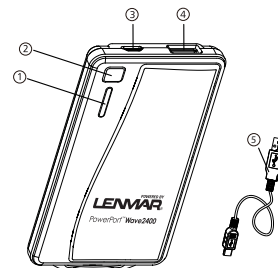

### Caution:

Do not overcharge the PowerPort Wave2400, as it will shorten its life span.

Disconnect the PowerPort Wave2400 as soon as it is practical after the charge is complete. When not in use, unplug the PowerPort Wave2400 from all cables and devices. Do not drop.

Recycle or dispose of the PowerPort Wave2400 properly. If disposed of in fire or short circuited, the PowerPort may leak or explode, causing personal injury.

### Note:

The PowerPort Wave2400 must be charged prior to first use and may become warm during charging and use.

### Specifications

Model: PPW24  
Cell type: Lithium-Polymer Battery  
Input: DC 5V 1.0A max  
Output: DC 5V 1.0A  
Capacity: 2400mAh  
Dimensions: 103.5 x 55 X 11mm  
Weight: 41g

### Dual USB Wall Charger

#### Operating your Dual USB Wall Charger

Pull out foldable prongs from unit and plug into a working power outlet. To begin charging, plug in 1 or 2 devices like smartphones, mp3 players, gaming devices, and more using your device's existing USB charge cable.

### Specifications

Model: ACUSB2K  
Input: AC100-240VAC~50/60Hz  
Output: DC 5V, 2A max (1 USB port)  
DC 5V, 1A max (2 USB ports using simultaneously)  
Dimensions: 70 x 51 x 15mm  
Weight: 45g

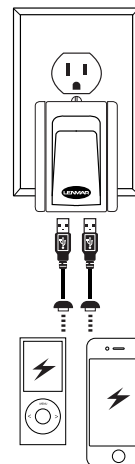

## Dual USB Car Charger

The Dual USB Car Charger is able to charge one Apple iPad® or two devices like smartphones, PDAs, GPS units and MP3 players simultaneously from your car's cigarette lighter socket.

### Operating your Dual USB Car Charger

Remove the cigarette lighter from the socket in the car. Plug the Dual USB Car Charger into the cigarette lighter socket. Once plugged into the car's cigarette lighter socket you will see the blue LED light on the front of the Dual USB Car Charger; this confirms the unit has power and is connected properly. Insert your cable into one of the available USB sockets, plug your device into the other end and it will begin receiving power.

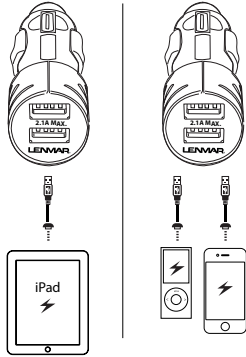

The Dual USB Car Charger is equipped with a 2A automotive type fuse to protect from an overload. This prevents unsafe excessive power usage or a short circuit from damaging your car's electrical system. To replace, pull the fuse straight out of the side of the Dual USB Car Charger and insert a new fuse in its place.

\*Please note that many new vehicles do not supply power to the cigarette lighter socket unless the key is on. If the blue LED does not come on with the key in the off position, turn the key on and verify that the LED comes on.

### Troubleshooting

If the blue LED fails to light, please check the fuse located on the side of the unit. Other than the fuse, there are no user serviceable parts.

The Dual USB Car Charger may shut off due to an excessive current draw. Unplug it from the DC socket the Dual USB Car Charger will reset itself and function properly.

#### Notice

- Keep the Dual USB Car Charger dry; if it gets wet wipe dry immediately.
- Use and store the unit in normal temperature environments.
- Use only inside your motor vehicle.
- Handle the Dual USB Car Charger carefully; avoid dropping onto hard surfaces.
- Do not use the Dual USB Car Charger when the vehicle battery is low.
- Do not use the Dual USB Car Charger if it becomes damaged.

Keep the Dual USB Car Charger away from dust and dirt; wipe it with a cloth occasionally to keep it clean. Other than the fuse there are no user serviceable parts. Modifying or tampering with its internal components can cause a malfunction and will invalidate the warranty. If your Dual USB Car Charger is not operating as it should during the warranty period, contact Lenmar for warranty service.

## Specifications

Model: AIDCU2

Input: 12-18V DC / 1A

Output: 5V DC 2100mAh max, compatible with most electronic devices

Fuse: 2A replaceable fuse.

Blue LED indicator light indicates power on.

Dimensions: 25.5 x 68.5mm

Weight: 22g

### Limited 1 Year Warranty

Lenmar product is warranted to be free of defective parts and workmanship for stated period from the original date of purchase when sold through our website or our authorized retailers. Warranties are not transferable. The warranty excludes damage resulting from accident, misuse, modification, delay or loss of use, damage to equipment or by normal wear and tear.

ALL WARRANTY CLAIMS ARE PROCESSED ONLINE AT THE FOLLOWING LINK:

[WWW.LENMAR.COM/WARRANTY](http://WWW.LENMAR.COM/WARRANTY)

Warranty claims made after 60 days from the original date of purchase, will require a processing fee. Details will be included while completing the online warranty request. Payment can be made via credit card when completing the warranty form or a check can be included with the package when it is returned to Lenmar. Once the request is completed, you will be emailed with a confirmation WRA number and instructions on how to return the item for a warranty replacement.

### Proposition 65 Notice (California)

The following statement is required in the state of California pursuant to the settlement of an action brought by the Mateel Environmental Justice Foundation against multiple electronics and appliance manufacturers

**• WARNING: Handling the cord on this product will expose you to lead, a chemical known to the state of California to cause birth defects or other reproductive harm. Wash hands after handling.**

For additional questions, comments, or to explore other Lenmar power solutions, visit our website at: [www.lenmar.com](http://www.lenmar.com) or call 800.424.2703 from 9AM – 5PM PST.

312-072-33-0224 r1 y1

Lithium-Polymer battery must be recycled or disposed of properly.

