

Handsfree Speakerphone Kit for Nokia

17-908

OWNER'S MANUAL — Please read before using this equipment.

! IMPORTANT !

If an icon appears at the end of a paragraph, go to the box on that page with the corresponding icon for pertinent information.

⚠ — Warning

! — Important

⚡ — Caution

📄 — Note

⚠ WARNING ⚠

Never place a phone where it could damage or interfere with the operation of any passive safety device (airbags or seat belts).

Thank you for purchasing a RadioShack Handsfree Speakerphone Kit. Your kit turns your cellular phone into a speakerphone in your vehicle. Just plug it into the power source, connect it to your phone and plug in the microphone. It even automatically recharges the phone's battery. ⚠

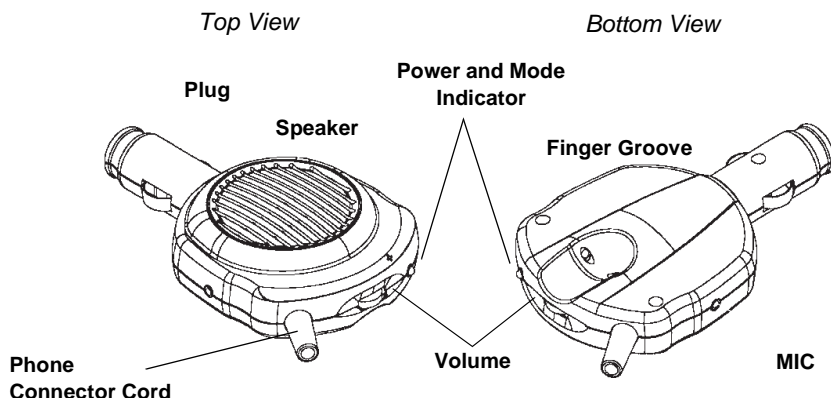

Digital Sound Processing — gives you the best possible sound quality.

Full Duplex Technology — allows you to talk and hear simultaneously so your conversation is not interrupted.

PREPARATION

For safety and the best performance, hold the phone upright with a phone holder, available at RadioShack.

1. Insert the speakerphone's plug into your vehicle's 12-volt power source or cigarette lighter. The green POWER indicator lights. Turn the speaker toward you to allow at least 2 inches of clearance so you can use the mode switch on the back. ⚠

2. To attach the connector to the phone, (1) align the phone with the connector (located on the end of the coiled cord) so TOP faces the same direction as the keypad, (2) then angle the connector behind the phone and lock it in place.

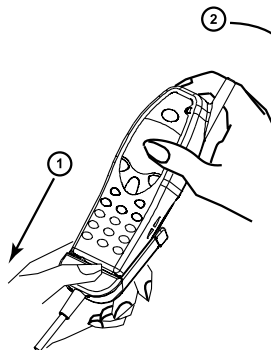

To remove the connector from the phone, (1) push the tabs out (2) then tilt the phone slightly forward and lift up.

3. Plug the microphone into the MIC Jack.

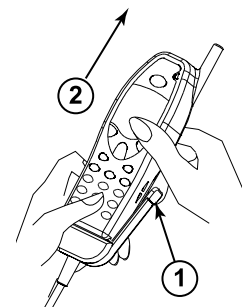

4. To attach the microphone to the visor, slide the clip onto the visor and tuck the wire between the windshield glass and trim, or under the trim. Run the wire down to and around the dash, being careful not to pinch the wire in the door.

To attach the microphone to your clothing, attach the lapel clip about 6 inches below your chin. Leave a comfortable length of cord between the microphone and the speaker. Wrap up the excess cord so it does not interfere with vehicle operation.

5. Turn the phone on if it has not turned on automatically. The POWER indicator lights and the speakerphone beeps.

📄 NOTE 📄

- If your vehicle's cigarette-lighter socket is difficult to reach, outlet adapters are available at your local RadioShack store or online at RadioShack.com.
- You might have to turn the ignition key to ACCESSORY or ON to power the cigarette-lighter socket.
- To avoid feedback, position the microphone so it is not directly in line with the speaker. You might need to turn the speaker slightly.



RadioShack®

www.radioshack.com™

© 2002 RadioShack Corporation.
All Rights Reserved.
RadioShack and RadioShack.com are trademarks
used by RadioShack Corporation.



Changing Modes

Disconnecting and reconnecting the cord does not change the mode.

Battery Discharge

The indicator lights when power is on and the phone's battery is charging.

Outgoing Calls

If you are unable to make a call in handsfree mode, contact your phone store to update the phone's software.

Adjusting the Volume

- Keep the volume as low as possible to comfortably hear the other party. If the volume is too high, the other party might hear an echo. Reduce the volume to eliminate any echo.
- On some Sanyo phones, the keypad tones' volume is not adjustable. If the tones are too loud, reduce the volume on the speakerphone. Once you complete dialing, readjust the volume to a comfortable listening level.

CHANGING MODES

You can use the speakerphone in either handsfree or privacy mode.

To change modes, briefly insert your finger in the groove on the back of the speaker. When your finger breaks the optical beam the indicator blinks.

In handsfree mode, the phone's internal microphone and speaker are disabled to operate through the speakerphone. The POWER indicator lights green. You can talk and listen without holding the phone.

In privacy mode, the phone operates normally. Pick up the phone and use it like any other handset.

BATTERY DISCHARGE

If your cigarette-lighter socket or power outlet remains on when the vehicle is turned off, and you plan to leave your vehicle for more than a week, unplug the speakerphone to prevent excessive battery discharge and difficulty starting your vehicle.

HANDSFREE OPERATION

OUTGOING CALLS

Dial a number and press TALK to begin talking. Press END when you are finished.

INCOMING CALLS

To answer an incoming call, press TALK and begin speaking. Press END when you are finished.

ADJUSTING THE VOLUME

To change the speakerphone's volume, rotate the speakerphone's volume control or adjust the volume control on your phone.

A NOTE ABOUT VOICE QUALITY

Wireless phones use radio waves which do not always provide the same voice quality and reliability as your land-line phone.

When using your wireless phone, you may experience dropped calls, crosstalk, echo, speech distortion, or other voice quality degradation caused by the wireless network.

Variations in voice quality that you experience in the privacy mode will be heard with the speaker and may be louder because they are amplified.

If you are experiencing call distortion, check to see that the phone has a good signal level. If your signal level is good and you are still experiencing poor voice quality, switch channels by hanging up and redialing the number.

CARE

Keep the speakerphone dry; if it gets wet, wipe it dry immediately. Use and store the speakerphone only in normal temperature environments. Handle the speakerphone carefully; do not drop it. Keep the speakerphone away from dust and dirt, and wipe it with a damp cloth occasionally to keep it looking new.

SERVICE AND REPAIR

If your speakerphone is not performing as it should, take it to your local RadioShack store for assistance. Modifying or tampering with the speakerphone's internal components can cause a malfunction and might invalidate its warranty [and void your FCC authorization to operate it].

Limited Ninety-Day Warranty

This product is warranted by RadioShack against manufacturing defects in material and workmanship under normal use for ninety (90) days from the date of purchase from RadioShack company-owned stores and authorized RadioShack franchisees and dealers. EXCEPT AS PROVIDED HEREIN, RadioShack MAKES NO EXPRESS WARRANTIES AND ANY IMPLIED WARRANTIES, INCLUDING THOSE OF MERCHANTABILITY AND FITNESS FOR A PARTICULAR PURPOSE, ARE LIMITED IN DURATION TO THE DURATION OF THE WRITTEN LIMITED WARRANTIES CONTAINED HEREIN. EXCEPT AS PROVIDED HEREIN, RadioShack SHALL HAVE NO LIABILITY OR RESPONSIBILITY TO CUSTOMER OR ANY OTHER PERSON OR ENTITY WITH RESPECT TO ANY LIABILITY, LOSS OR DAMAGE CAUSED DIRECTLY OR INDIRECTLY BY USE OR PERFORMANCE OF THE PRODUCT OR ARISING OUT OF ANY BREACH OF THIS WARRANTY, INCLUDING, BUT NOT LIMITED TO, ANY DAMAGES RESULTING FROM INCONVENIENCE, LOSS OF TIME, DATA, PROPERTY, REVENUE, OR PROFIT OR ANY INDIRECT, SPECIAL, INCIDENTAL, OR CONSEQUENTIAL DAMAGES, EVEN IF RadioShack HAS BEEN ADVISED OF THE POSSIBILITY OF SUCH DAMAGES.

Some states do not allow limitations on how long an implied warranty lasts or the exclusion or limitation of incidental or consequential damages, so the above limitations or exclusions may not apply to you.

In the event of a product defect during the warranty period, take the product and the RadioShack sales receipt as proof of purchase date to any RadioShack store. RadioShack will, at its option, unless otherwise provided by law: (a) correct the defect by product repair without charge for parts and labor; (b) replace the product with one of the same or similar design; or (c) refund the purchase price. All replaced parts and products, and products on which a refund is made, become the property of RadioShack. New or reconditioned parts and products may be used in the performance of warranty service. Repaired or replaced parts and products are warranted for the remainder of the original warranty period. You will be charged for repair or replacement of the product made after the expiration of the warranty period.

This warranty does not cover: (a) damage or failure caused by or attributable to acts of God, abuse, accident, misuse, improper or abnormal usage, failure to follow instructions, improper installation or maintenance, alteration, lightning or other incidence of excess voltage or current; (b) any repairs other than those provided by a RadioShack Authorized Service Facility; (c) consumables such as fuses or batteries; (d) cosmetic damage; (e) transportation, shipping or insurance costs; or (f) costs of product removal, installation, set-up service adjustment or reinstallation.

This warranty gives you specific legal rights, and you may also have other rights which vary from state to state.

RadioShack Customer Relations, 200 Taylor Street, 6th Floor, Fort Worth, TX 76102

12/99