

SONY

4-287-198-12(1)

Personal Audio Docking System

Reference Guide



* 4 2 8 7 1 9 8 1 2 * (1)

©2011 Sony Corporation Printed in China

<http://www.sony.net/>

RDP-X500iP

English

Owner's Record

The model number and the serial number are located on the bottom.

Record the serial number in the space provided below. Refer to them whenever you call upon your Sony dealer regarding this product.

Model No. RDP-X500iP

Serial No. _____

For customers in the USA

Please register this product on line at <http://www.sony.com/productregistration>. Proper registration will enable us to send you periodic mailings about new products, services, and other important announcements. Registering your product will also allow us to contact you in the unlikely event that the product needs adjustment or modification. Thank you.

WARNING

To reduce the risk of fire or electric shock, do not expose this apparatus to rain or moisture.

To reduce the risk of fire, do not cover the ventilation opening of the apparatus with newspapers, tablecloths, curtains, etc. Do not place the naked flame sources such as lighted candles on the apparatus.

To reduce the risk of fire or electric shock, do not expose this apparatus to dripping or splashing, and do not place objects filled with liquids, such as vases, on the apparatus.

Do not install the appliance in a confined space, such as a bookcase or built-in cabinet.

Do not expose batteries or apparatus with battery installed to excessive heat such as sunshine, fire or the like.

As the main plug is used to disconnect the system from the mains, connect the system to an easily accessible AC outlet. Should you notice an abnormality in the system, disconnect the main plug from the AC outlet immediately.

The system is not disconnected from the mains as long as it is connected to the AC outlet, even if the system itself has been turned off.

The dating code and the nameplate are located on the bottom exterior.

CAUTION

You are cautioned that any changes or modifications not expressly approved in this manual could void your authority to operate this equipment.

CAUTION

Danger of explosion if battery is incorrectly replaced. Replace only with the same type.

For USA customers only

NOTE

This equipment has been tested and found to comply with the limits for a Class B digital device, pursuant to Part 15 of the FCC Rules. These limits are designed to provide reasonable protection against harmful interference in a residential installation. This equipment generates, uses and can radiate radio frequency energy and, if not installed and used in accordance with the instructions, may cause harmful interference to radio communications. However, there is no guarantee that interference will not occur in a particular installation. If this equipment does cause harmful interference to radio or television reception, which can be determined by turning the equipment off and on, the user is encouraged to try to correct the interference by one or more of the following measures:

- Reorient or relocate the receiving antenna.
- Increase the separation between the equipment and receiver.
- Connect the equipment into an outlet on a circuit different from that to which the receiver is connected.
- Consult the dealer or an experienced radio/TV technician for help.

WARNING

- Replace the battery for the remote commander with a Sony CR2025 lithium battery only. Use of another battery may present a risk of fire or explosion.
- Battery may explode if mistreated. Do not recharge, disassemble or dispose of in fire.
- Dispose of used battery promptly. Keep away from children.
- Keep the lithium battery out of the reach of children. Should the battery be swallowed, immediately consult a doctor.

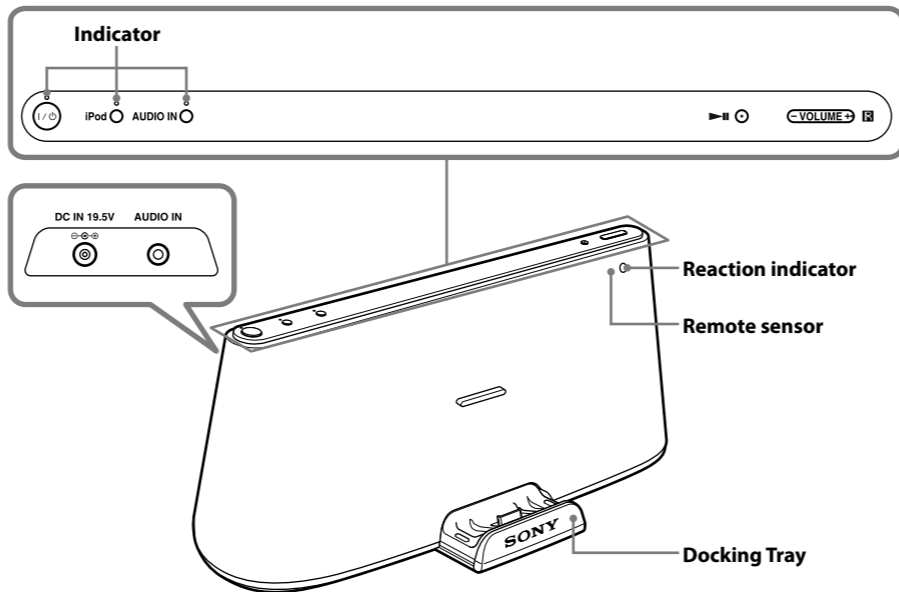

Important Safety Instructions

- 1) Read these instructions.
- 2) Keep these instructions.
- 3) Heed all warnings.
- 4) Follow all instructions.
- 5) Do not use this apparatus near water.
- 6) Clean only with dry cloth.
- 7) Do not block any ventilation openings. Install in accordance with the manufacturer's instructions.
- 8) Do not install near any heat sources such as radiators, heat registers, stoves, or other apparatus (including amplifiers) that produce heat.
- 9) Do not defeat the safety purpose of the polarized or grounding-type plug. A polarized plug has two blades with one wider than the other. A grounding type plug has two blades and a third grounding prong. The wide blade or the third prong are provided for your safety. If the provided plug does not fit into your outlet, consult an electrician for replacement of the obsolete outlet.
- 10) Protect the power cord from being walked on or pinched particularly at plugs, convenience receptacles, and the point where they exit from the apparatus.
- 11) Only use attachments/accessories specified by the manufacturer.
- 12) Use only with the cart, stand, tripod, bracket, or table specified by the manufacturer, or sold with the apparatus. When a cart is used, use caution when moving the cart/apparatus combination to avoid injury from tip-over.



- 13) Unplug this apparatus during lightning storms or when unused for long periods of time.
- 14) Refer all servicing to qualified service personnel. Servicing is required when the apparatus has been damaged in any way, such as power-supply cord or plug is damaged, liquid has been spilled or objects have fallen into the apparatus, the apparatus has been exposed to rain or moisture, does not operate normally, or has been dropped.

For the customers in Canada

This Class B digital apparatus complies with Canadian ICES-003.

For the state of California USA only

Perchlorate Material –special handling may apply, see www.dtsc.ca.gov/hazardouswaste/perchlorate
Perchlorate Material: Lithium battery contains perchlorate

Operations

Power source

Power management system

After playback of the iPod (or component connected to **AUDIO IN** jack) has finished, if no operation is performed for about 20 minutes, the unit will automatically turn off.

To prepare a power source

Connect the supplied AC adaptor to the **DC IN 19.5V** jack on the back of this unit firmly, and plug it into a wall outlet.

Note on the AC adaptor

- Use the supplied Sony AC adaptor only. The polarity of the plugs of other manufacturers may be different. Failure to use the supplied AC adaptor may cause the unit to malfunction.



To charge your iPod

You can use the unit as a battery charger for your iPod when the power is supplied by the AC adaptor.

Charging begins when the iPod is connected to the unit. The charging status appears in the display on iPod. For details, see the user's guide of your iPod.

Note

- The iPod continues to be charged when powered by the AC adaptor and turned on or off.

To turn the unit on/off

Press I/⏻ (power).

The I/⏻ indicator will light up when the unit is turned on.

To adjust the volume

Press **VOLUME +/-**.

To select iPod or AUDIO IN as the source

Press **iPod** or **AUDIO IN**.

The iPod or AUDIO IN indicator will light up when the button is pressed.

To play/pause the iPod

Press **▶||**.

The **Reaction indicator** flashes when the command is received.

Remote commander

Before using the supplied remote commander for the first time, remove the insulation film.

Aim the remote commander at the front of the unit near the remote sensor **■**.

The **Reaction indicator** flashes when the remote commander's command is received.

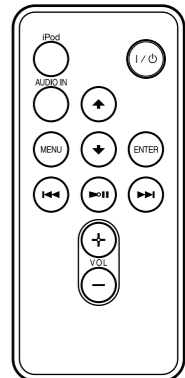

VOL + and ▶|| buttons have a tactile dot.

I/⏻ (Power)

- Turn the unit on/off. The I/⏻ indicator lights up when the unit is turned on.

▶|| (Play/Pause)

- Start playing iPod. Press again to pause/resume playback.
- Press and hold to turn off the iPod.

▶▶ (Forward)

- Go to the next track.
- Press and hold while listening to the sound to locate a desired point.
- Press and hold in pause while observing the display on iPod to locate a desired point.

◀◀ (Backward)

- Go back to the previous track. During playback, this operation returns to the beginning of the current track. To go back to the previous track, press twice.
- Press and hold while listening to the sound to locate a desired point.
- Press and hold in pause while observing the display on iPod to locate a desired point.

↑ (Up)/↓ (Down)

- Select a menu item or track for playback.

iPod

- Select iPod as source.

AUDIO IN

- Select AUDIO IN as source.

MENU

- Go back to the previous menu.

ENTER

- Execute the selected menu item or begin playback.

VOL +/- (Volume plus/minus)

- Adjust the volume.

Note

- The iPod nano (6th generation) cannot be controlled by the remote when the command of “**MENU**,” “**↑**,” “**↓**,” and “**ENTER**” is pressed.

When to replace the battery

With normal use, the battery (CR2025) should last for about 6 months. When the remote commander no longer operates the unit, replace the battery with a new one.

the ⊕ side facing up

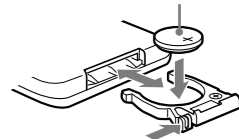

Note

- If you are not going to use the remote commander for a long time, remove the battery to avoid any damage that may be caused by leakage and corrosion.

Playing an iPod

Compatible iPod models

The compatible iPod models are as follows. Update software of your iPod to the latest version before using it with this unit.

iPod touch (4th generation)
iPod touch (3rd generation)
iPod touch (2nd generation)
iPod nano (6th generation)*
iPod nano (5th generation)
iPod nano (4th generation)
iPod nano (3rd generation)

iPod classic
iPhone 4
iPhone 3GS
iPhone 3G
iPad 2
iPad

* The iPod nano (6th generation) cannot be controlled by the remote when the command of “**MENU**,” “**▲**,” “**▼**,” and “**ENTER**” is pressed.

On copyrights

iPad, iPhone, iPod, iPod classic, iPod nano, and iPod touch are trademarks of Apple Inc., registered in the U.S. and other countries.

“Made for iPod,”“Made for iPhone,” and “Made for iPad” mean that an electronic accessory has been designed to connect specifically to iPod, iPhone, or iPad, respectively, and has been certified by the developer to meet Apple performance standards. Apple is not responsible for the operation of this device or its compliance with safety and regulatory standards. Please note that the use of this accessory with iPod, iPhone, or iPad may affect wireless performance.

To set an iPod on the Docking Tray

- Press the Docking Tray on the front of the unit to open it.
- Set your iPod on the Dock connector.

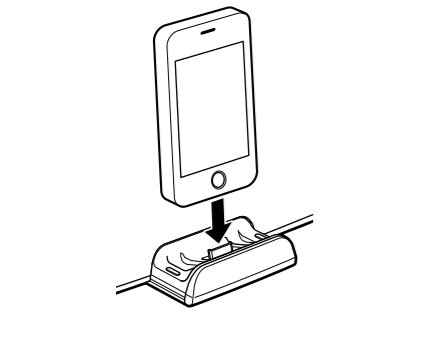

Note

- If a pop-up message appears on the display of the iPod touch/iPhone/iPad, see “About App.”

To close the Docking Tray

- Remove the iPod from the Dock connector.
- Press the Docking Tray on the front of the unit until it is locked.

To play back

Press **▶||**.

The iPod begins to play back.

You can operate the connected iPod via this unit or the iPod itself.

Notes

- Remove the case or cover from your iPod before setting it in the Docking Tray to ensure a stable connection.
- When placing or removing the iPod, hold the iPod at the same angle as that of the connector on this unit, and do not twist or bend the iPod as it may result in connector damage.
- Do not carry the unit with an iPod set on the Docking Tray. Doing so may cause a malfunction.
- When placing or removing the iPod, hold the Docking Tray securely.
- Before disconnecting the iPod, pause playback.
- If the battery of your iPod is extremely low, charge it for a while before operation.
- Sony cannot accept responsibility in the event that data recorded to an iPod is lost or damaged when using an iPod connected to this unit.
- For details of environmental conditions for operating your iPod, check the website of Apple Inc.

To adjust the volume

Press **VOLUME +/-** (**VOL +/-** on the remote commander).

Tip

- The **Reaction indicator** flashes three times when the volume is set to either maximum or minimum volume.

Connecting optional components

You can enjoy the sound from an optional component, such as a portable digital music player, through the speakers of this unit. Be sure to turn off the power of each component before making any connections.

- Firmly connect the line output jack of a portable digital music player (or other component) to the **AUDIO IN** jack on the back of the unit, using a suitable audio connecting cable (not supplied).
- Press **I/⏻** to turn on the unit.
- Turn the connected component on.
- Press **AUDIO IN** to select the source.
- Play the connected component. The sound from the connected component is output from the speakers of this unit.

Notes

- The audio connecting cable required depends on the external equipment. Make sure the cable is correct for the external equipment to be connected.
- If the volume is low, adjust the volume level on the connected equipment first. If the volume is still too low, adjust the volume level on the unit.

About App

A dedicated dock app for iPod touch, iPhone, and iPad available at Apple App Store. Search for “**D-Sappli**” and download the free app to find out more about the functions.

Features

- The Sound EQ function allows you to create your own equalizer settings. You can select equalizer presets, or customize settings to your taste.

This function is available only when the iPod touch/iPhone/iPad is set on the Dock connector.

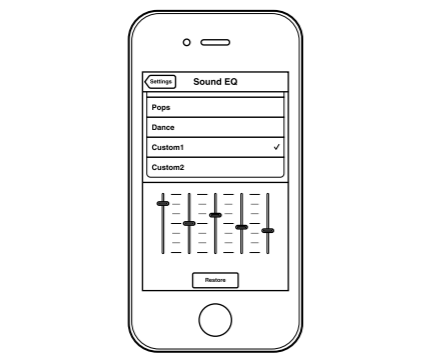

- D-Sappli includes two timer functions: Music Play Timer and Sleep Timer. The Music Play Timer allows you to play/pause desired music at a desired time. The Sleep Timer allows you to specify a time at which to stop music playback. The Music Play Timer and Sleep Timer work in combination with the power supply of the unit.
- D-Sappli also includes a clock display enlarge feature.

Notes

- If the App to link with this unit is not downloaded to your iPod touch/iPhone/iPad, a pop-up message prompting you to download D-Sappli may appear repeatedly. Deactivate the App’s link function to stop the pop-up message.
- To deactivate the App’s link function: Connect the AC adaptor, and then press **I/⏻** to turn on the unit. Remove your iPod touch/iPhone/iPad from the Dock connector, and then press and hold **VOLUME –** and **▶||** simultaneously for more than 2 seconds. (The indicator for iPod flashes rapidly when deactivated.)
- To re-activate the App’s link function, repeat the above steps. The indicator for iPod will flash slowly.
- When you remove the iPod touch/iPhone/iPad from the docking tray, the Sound EQ function setting will return to the default.
- When the sound volume is high, the Sound EQ function may not be effective.

Additional Information

Troubleshooting

General

The power does not turn on when the AC adaptor is connected.

- Make sure the AC adaptor is connected to the wall outlet firmly.

There is no audio.

- Adjust **VOLUME +/-** (**VOL +/-** on the remote commander).

Noise is heard.

- Ensure that the unit is not in the vicinity of in-use portable phones, etc.

Resetting the unit (default setting).

- Press **I/⏻** to turn on the unit. Remove your iPod from the Dock connector, and then while holding down **VOLUME –**, hold down **I/⏻**. (Hold both buttons down for at least 5 seconds.) After resetting, the **I/⏻** indicator flashes for 2 seconds.

All indicators flash and no buttons can be operated.

- Remove the AC adaptor and connect it again.

iPod

There is no audio.

- Make sure the iPod is connected firmly.
- Update your iPod to use the latest software beforehand.
- Make sure the iPod is compatible.
- Make sure the function for iPod is selected.

Operation is not performed.

- Make sure the iPod is connected firmly.

The iPod does not charge.

- Make sure the iPod is connected firmly.
- Make sure the AC adaptor is connected firmly.

AUDIO IN

There is no audio.

- Make sure the audio connecting cable is connected firmly.
- Make sure the AUDIO IN function is selected.

The sound is low.

- Confirm the volume of the connected external component.

Remote commander

The remote commander does not function.

- Replace the battery in the remote commander with a new one if it is weak.
- Make sure that you are pointing the remote commander at the remote sensor on the unit.
- Remove any obstacles in the path of the remote commander and the unit.
- Make sure the remote sensor is not exposed to strong light such as direct sunlight or fluorescent lamp light.
- Move closer to the unit when using the remote commander.

If the problem persists, consult your nearest Sony dealer.

<p>SONY[®]</p> <p style="text-align: right;">Portable Audio</p> <p>LIMITED WARRANTY (U.S. Only)</p>
<p>Sony Electronics Inc. (“Sony”) warrants this product against defects in material or workmanship for the time periods and as set forth below when purchased directly from Sony or a Sony Retailer. Pursuant to this Limited Warranty, Sony will, at its option, (i) repair the product using new or refurbished parts or (ii) replace the product with a new or refurbished product. For purposes of this Limited Warranty, “refurbished” means a product or part that has been returned to its original specifications. In the event of a defect, these are your exclusive remedies.</p> <p>Labor: For a period of one (1) year from the original date of purchase of the product (“Labor Warranty”), Sony will, at its option, repair or replace with new or refurbished product, product determined to be defective. If Sony elects to replace the product after this Labor Warranty has expired but while the Parts Warranty below is still in effect, it will do so for the applicable labor charge.</p> <p>Parts: For a period of one (1) year from the original date of purchase of product (“Parts Warranty”), Sony will supply new or refurbished replacement parts in exchange for parts determined to be defective.</p> <p>This Limited Warranty covers only the hardware components packaged with the Product. It does not cover technical assistance for hardware or software usage and it does not cover any software products whether or not contained in the Product; any such software is provided “AS IS” unless expressly provided for in any enclosed software Limited Warranty. Please refer to the End User License Agreements included with the Product for your rights and obligations with respect to the software.</p> <p>Instructions: To obtain warranty service, you must deliver the product, freight prepaid, in either its original packaging or packing affording an equal degree of protection to the Sony authorized service facility specified. It is your responsibility to backup any data, software or other materials you may have stored or preserved on your unit. It is likely that such data, software, or other materials will be lost or reformatted during service and Sony will not be responsible for any such damage or loss. A dated purchase receipt from Sony or a Sony Retailer is required. For specific instructions on how to obtain warranty service for your product,</p>
<p>Visit Sony’s Web Site: www.sony.com/support</p> <p>Or call the Sony Customer Information Service Center 1-800-222-SONY (7669)</p>
<p>For an accessory or part not available from your authorized dealer, call:</p> <p style="text-align: center;">1-800-488-SONY (7669)</p>
<p>Repair / Replacement Warranty: This Limited Warranty shall apply to any repair, replacement part or replacement product for the remainder of the original Limited Warranty period or for ninety (90) days, whichever is longer. Any parts or product replaced under this Limited Warranty will become the property of Sony.</p> <p>This Limited Warranty only covers product issues caused by defects in material or workmanship during ordinary consumer use; it does not cover product issues caused by any other reason, including but not limited to product issues due to commercial use, acts of God, misuse, limitations of technology, or modification of or to any part of the Sony product or product purchased from other than Sony or a Sony Retailer. To determine if a retailer is part of the Sony Retailer Network, please contact Sony’s Customer Service Call Center or go to www.sony.com/support. This Limited Warranty does not cover Sony products sold AS IS or WITH ALL FAULTS or consumables (such as fuses or batteries). This Limited Warranty is invalid if the factory-applied serial number has been altered or removed from the product. This Limited Warranty is valid only in the United States.</p> <p>LIMITATION ON DAMAGES: SONY SHALL NOT BE LIABLE FOR ANY INCIDENTAL OR CONSEQUENTIAL DAMAGES FOR BREACH OF ANY EXPRESS OR IMPLIED WARRANTY ON THIS PRODUCT.</p> <p>DURATION OF IMPLIED WARRANTIES: EXCEPT TO THE EXTENT PROHIBITED BY APPLICABLE LAW, ANY IMPLIED WARRANTY OF MERCHANTABILITY OR FITNESS FOR A PARTICULAR PURPOSE ON THIS PRODUCT IS LIMITED IN DURATION TO THE DURATION OF THIS WARRANTY.</p> <p>Some states do not allow the exclusion or limitation of incidental or consequential damages, or allow limitations on how long an implied warranty lasts, so the above limitations or exclusions may not apply to you. This Limited Warranty gives you specific legal rights and you may have other rights which vary from state to state.</p>

Specifications

AUDIO POWER SPECIFICATIONS

POWER OUTPUT AND TOTAL HARMONIC DISTORTION:

With 8 ohm loads
Satellite channels and with 4 ohm loads
Subwoofer channel driven, from 100 Hz - 10,000 Hz; rated 10 watts per channel
minimum RMS power, with no more than 10% total harmonic distortion.

Section for iPod

DC out: 5 V

MAX: 2.1 A

General

Speaker

Satellite: 4.8cm (1 ⁵/₁₆ inches) dia. 8Ω

Subwoofer: 9.0cm (3 ³/₈ inches) dia. 4Ω

Input

AUDIO IN jack (ø 3.5 mm stereo minijack)

Power output

15 W + 15 W + 30 W (at no more than 10% harmonic distortion)

Power requirements

DC IN 19.5 V

Dimensions

Approx. 401 mm × 176 mm × 160 mm (w/h/d)
(15 ⁷/₈ inches × 7 inches × 6 ³/₈ inches)

Mass

Approx. 3.15 kg (6 lb 15 oz)

Supplied accessories

Remote commander (1)

AC adaptor (1)

AC power cord (1)*

Reference Guide (this document) (1)

Startup Guide (1)

CR2025 lithium battery (1) (Pre-installed in the remote commander for trial use)

* The supplied AC power cord may differ to the illustration depending on the country.

Design and specifications are subject to change without notice.