



HOME OF PRIMO® BELT DRIVES

PRO-CLUTCH™

INSTALLATION INSTRUCTIONS



1056-0003
1986-1989
Evo Big-Twin
chain drive primary

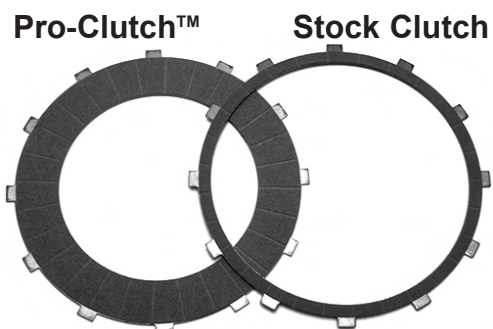

1056-0005
1990-1997
Evo Big-Twin
chain drive primary

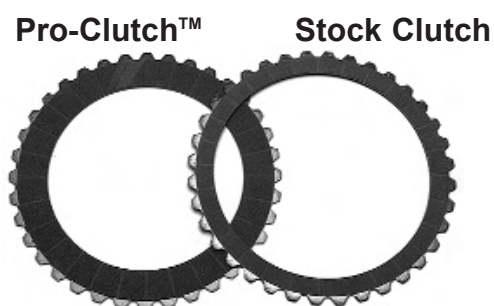

1056-0006
1998-2006
Evo Big-Twin
& Twin-Cam
(except 2006 Dyna)
chain drive primary

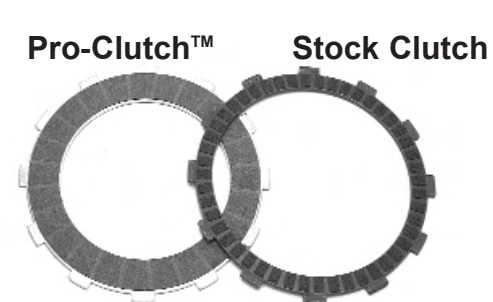

1056-0020
2006 Dyna Models
&
All 2007-up
Big Twin Models

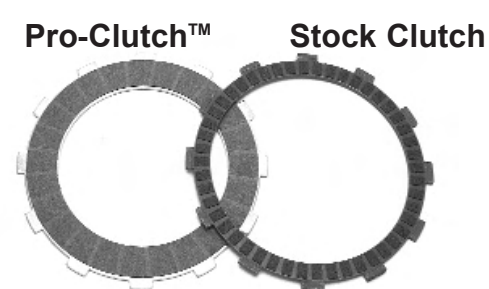

Congratulations you have just purchased Riviera Primo's Pro-Clutch™, the best clutch upgrade in the world. Please read and follow the directions for a simple, trouble free installation. If you have any questions about this installation please contact Riviera Primo, and a knowledgeable Pro-Clutch™ technician will assist you. Thank you for purchasing Pro-Clutch™.

Riviera Primo's Pro-Clutch™ for 1990 & later Evolution & Twin Cam Big Twin motorcycles increases clutch area almost 100%. For 1986-1989 applications clutch area is increased 325%. More clutch surface means more performance potential. Installation is very simple. Pro-Clutch™ installs quickly into the existing clutch basket by removing the OEM hub, and then installing the Pro-Clutch™ hub, followed by the Pro-Clutch™ clutch pack assembly. Pro-Clutch™ will easily transmit all your motor's horsepower to the transmission without slipping or grabbing. Smooth, easy hand control makes Riviera Primo's Pro-Clutch™ a must for any stock or high performance Big Twin Harley motorcycle.

SAFETY FIRST

When performing work on any motorcycle, and prior to starting this installation disconnect BOTH battery cables. If the motorcycle is on a lift, fasten the motorcycle securely to prevent it from falling. Please read and become familiar with the Pro-Clutch™ instructions before starting. A hydraulic press is required to remove the OEM clutch hub and install the Rivera Primo Pro-Clutch™ hub. For safety use only the proper tools for a given task and wear eye protection.

STEP 1:

As you disassemble the Pro-Clutch™ prior to installation, keep the clutch plates in exactly the same sequence as shipped. The clutch plates must be re-installed in exactly the same order. Drain the primary lubricant from the chain-case, and remove the outer primary cover. Loosen the primary chain adjuster and remove the OEM clutch basket and all of the OEM clutch components.



STEP 2:

Remove the snap ring from the rear of the OEM clutch hub using the appropriate snap-ring tool. ALWAYS wear eye protection during this procedure.



STEP 3:

Using a hydraulic press remove the OEM clutch hub from the clutch basket! Firmly support the OEM clutch bearing as shown during this operation. After pressing the hub out, check the bearing for smoothness by rotating the clutch basket while holding the inner bearing race. If the bearing feels rough or binds, it must be replaced.



Press out the OEM hub

STEP 4:

Using the press, install the Rivera Primo Pro-Clutch™ hub into the OEM clutch basket. Securely support the INNER bearing races during this process. Carefully bottom the Pro-Clutch™ hub in the OEM basket. After pressing in the Pro-Clutch™ hub, check the bearing for smoothness again!



Carefully align the Pro-Clutch™ hub.

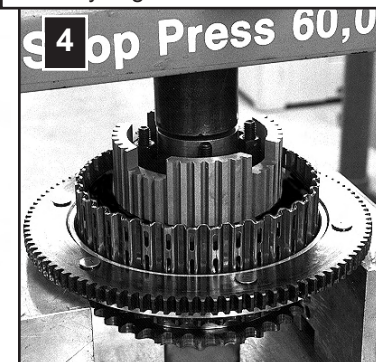

Press until the hub bottoms.

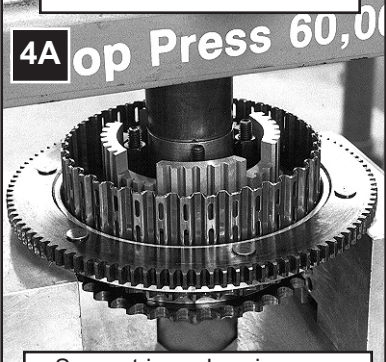

Support inner bearing race

STEP 5:

Install the snap ring onto the rear of the Pro-Clutch™ hub as shown. Make sure the snap ring is correctly installed into the snap-ring groove.

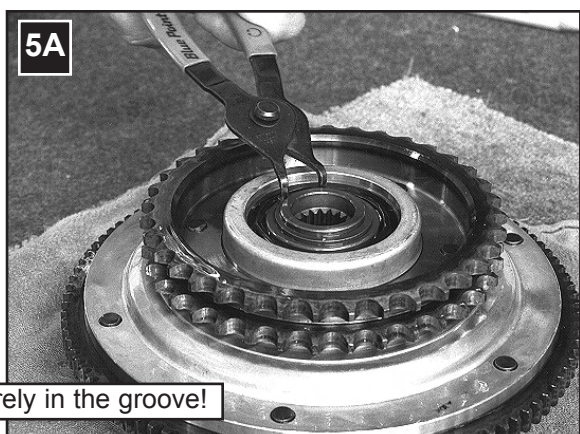
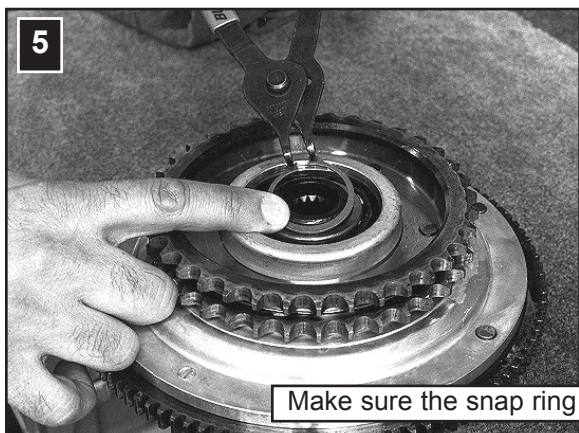

Make sure the snap ring is fitted securely in the groove!

STEP 6:

Thoroughly wipe down the primary case & components to remove the OEM lubricant. Re-install the clutch basket into the primary case with chain & associated components. Dexron III ATF is recommended as the primary lubricant for use with Pro-Clutch™ units.

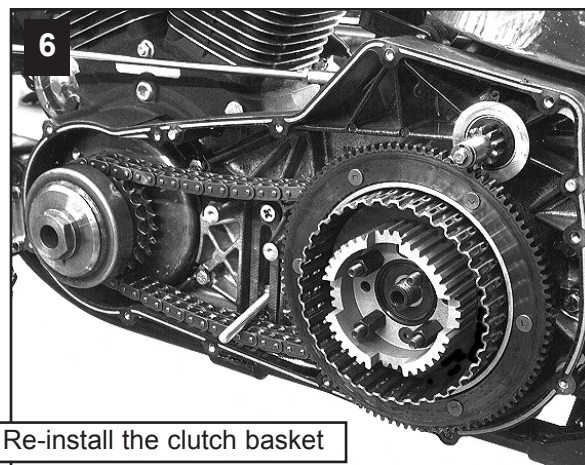

Re-install the clutch basket

STEP 6A:

Put two drops of blue thread lock on the transmission main shaft prior to installing the clutch hub nut. Tighten the clutch hub nut using the factory torque specifications (50-60 foot pounds of torque for 86-89 models, or 70-80 foot pounds for 90 & later models) indicated by your original equipment service manual.

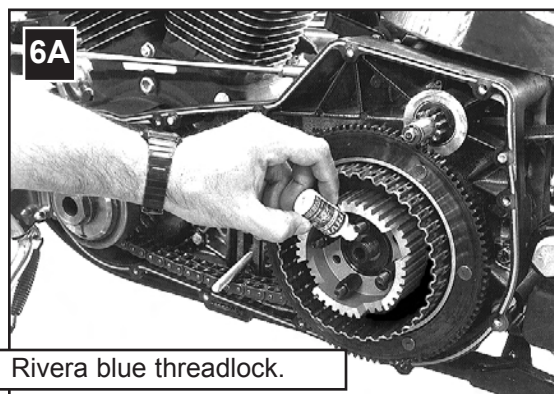

Rivera blue threadlock.

STEP 7: Soak friction discs in Dexron III ATF (wipe away excess before installation) lubricant for a minute prior to installation. Install steel & friction clutch plates exactly as they were shipped. Install the .120" steel plate first, then friction, alternating until all are installed. Never install 2 friction or 2 steel plates together.

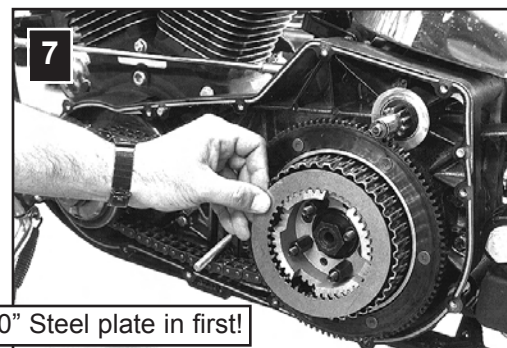

.120" Steel plate in first!

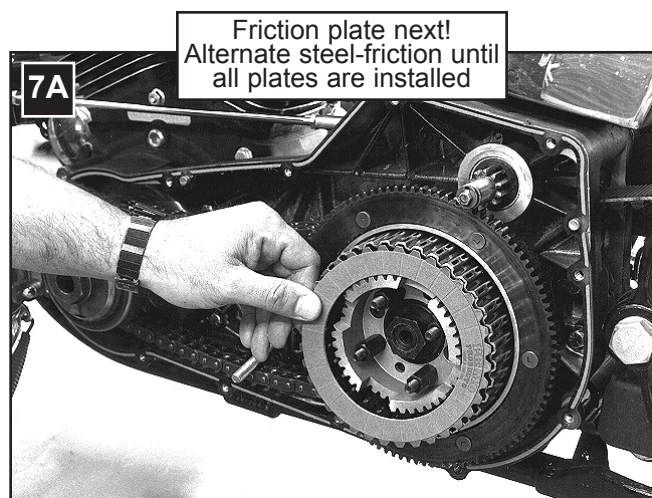
Friction plate next!
Alternate steel-friction until
all plates are installed

STEP 8: Generously dab some quality anti-seize on the stud threads of the Pro-Clutch hub!

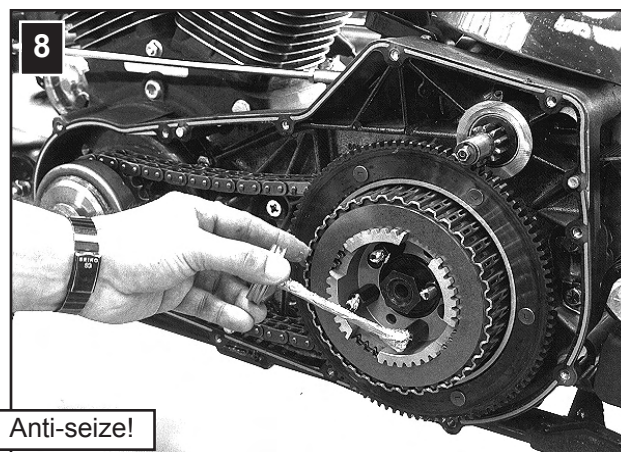

Anti-seize!

STEP 9: Install the pressure plate as shown!
Use your OEM adjuster screw!

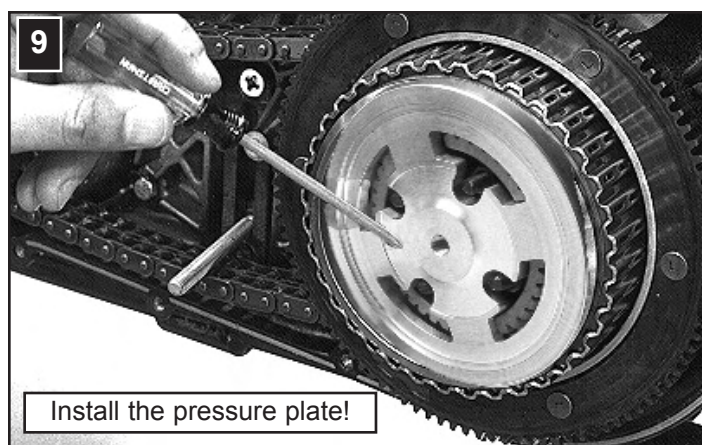
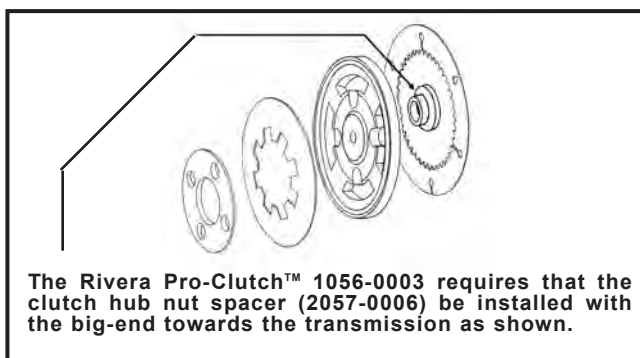

STEP 10: The diaphragm spring & spring retainer are installed next. (spring retainer goes beveled side in). Tighten the shouldered nuts equally (cross pattern) until they bottom.

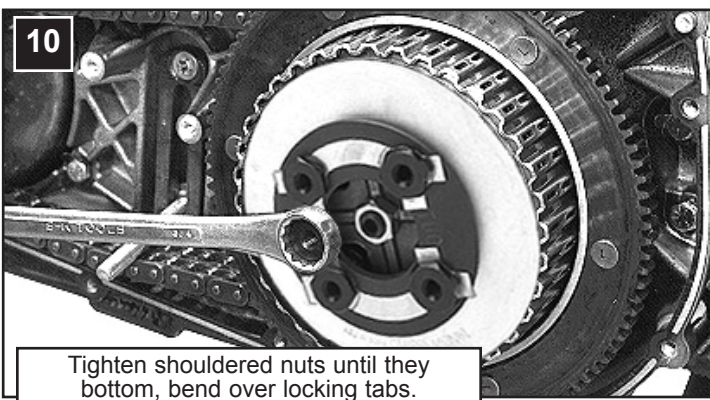
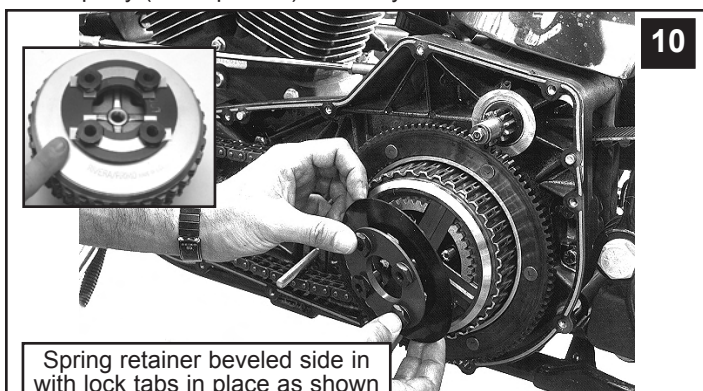

STEP 11: Adjust the clutch as you would normally using the center bolt adjuster.

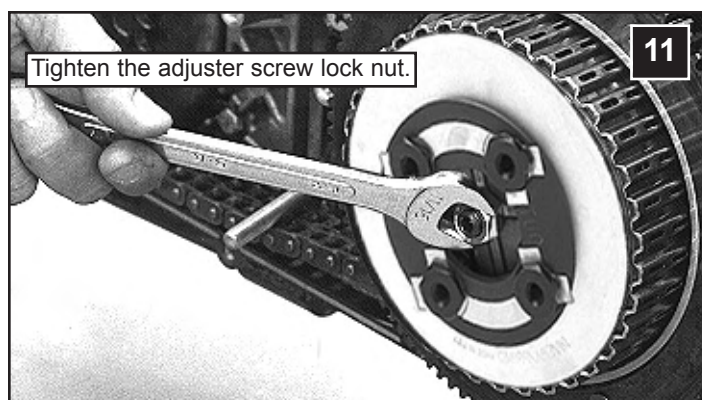
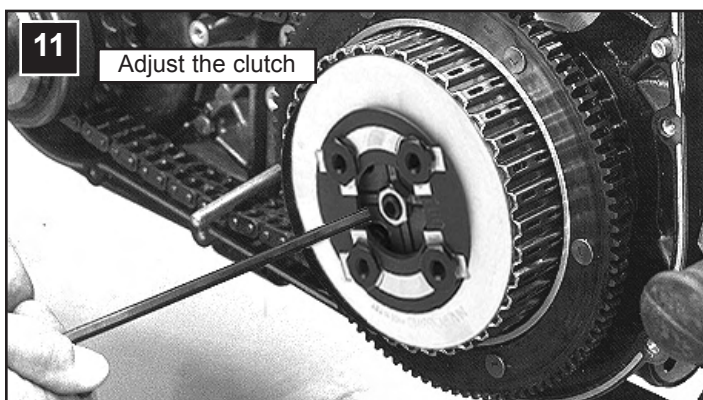

STEP 12: Check and adjust primary chain tension as needed. Re-install the outer primary cover using a new gasket, and fill the chain case with Dextron III ATF to the bottom of the ring gear.

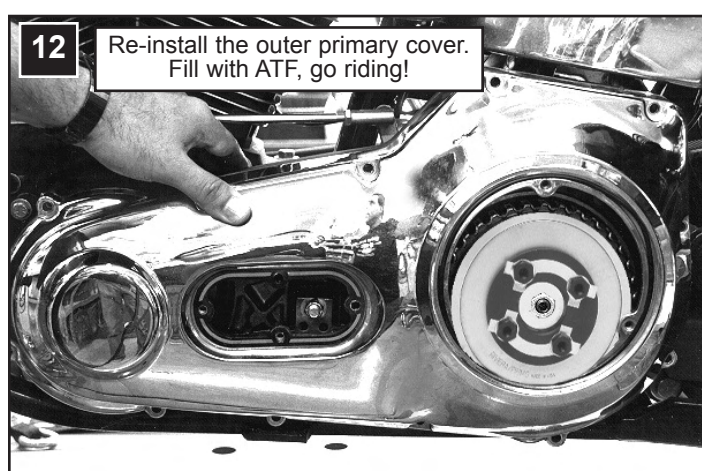
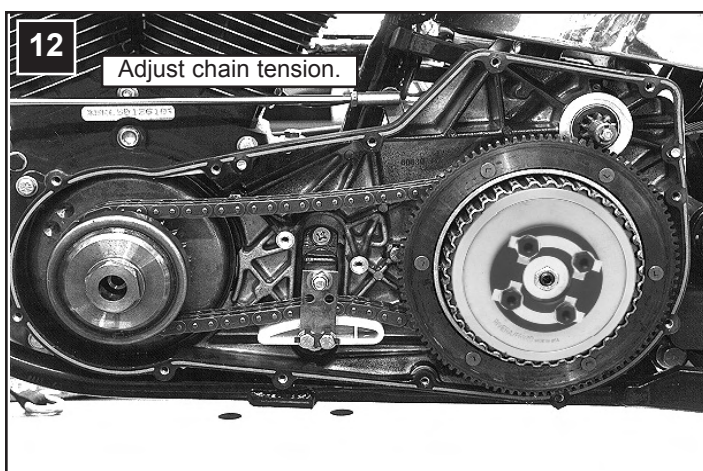

PRO-CLUTCH ADJUSTMENT

As delivered, the Pro-Clutch™ clutch-pack requires no adjustment, having been set at the factory.

After the Pro-Clutch™ has accumulated significant mileage, it may require some adjustment due to normal wear. Use the procedures outlined below if & when adjustment is required. For best performance the diaphragm spring **MUST** be compressed to within .010"-.020" of being flat when the shouldered spring retainer nuts have been properly tightened (bottomed)! This will provide maximum spring pressure to the clutch pack, with minimum hand effort at the handlebar!

Three clutch springs are available: A stock replacement spring (black in color), a medium spring for street performance (silver in color), and a competition spring (gold in color) for drag race only applications.

If the diaphragm spring adjustment requires LESS ARCH, this can be accomplished by using one or more of the special .020" washers on each of the shouldered nuts. (photo A)

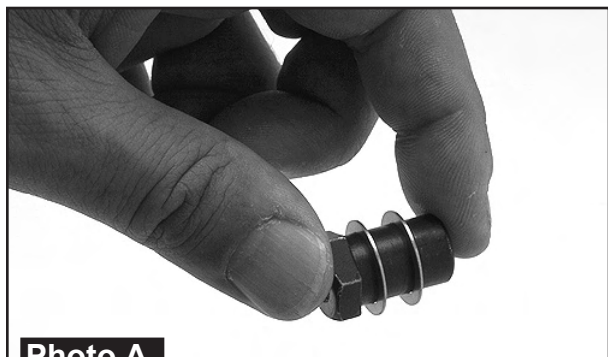

Photo A

If the diaphragm spring adjustment requires IMORE ARCH, this can be accomplished by using one or more of the special .030" washers on the clutch hub studs nuts as pictured.

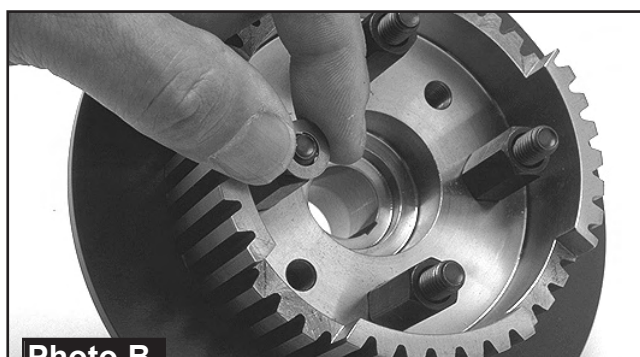

Photo B

The diaphragm spring will be compressed to within .010"-to-.020" of being flat when correctly installed & adjusted

Photo C shows a diaphragm spring that is compressed too far, and needs to be adjusted. Special adjustment washers be added to the clutch hub studs as shown in photo B.



Photo C

This is a diaphragm spring that is correctly adjusted. A little daylight is showing at either edge, because the spring is within .010"-to-.020" of being flat! (Slightly bowed outward) as seen in photo D.

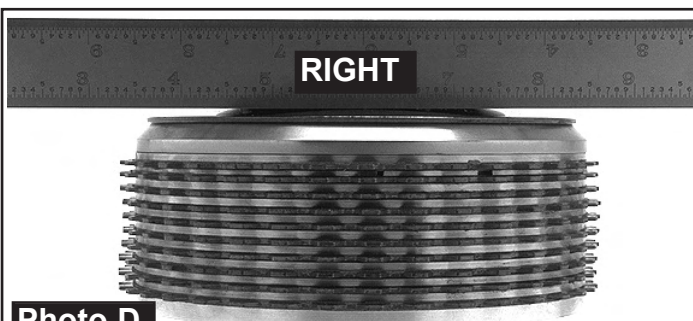

Photo D

GENERAL WARRANTY

Rivera Primo Inc.'s sole obligation and the customer's sole remedy is limited to replacement or repair of products free of charge in the event products fail to perform as warranted for a period of one year from actual date of purchase. Proof of purchase must accompany any warranty claim. In no event shall Rivera Primo Inc. be liable for claims for any other damages, whether direct, incidental, foreseeable, consequential, or special (including but not limited to loss of use, revenue or profit), whether based upon warranty, contract, tort (including negligence) or strict liability arising in connection with the sale or the failure of Rivera Primo Inc. products to perform in accordance with the stated specifications.

Rivera Primo Inc. makes no other warranty of any kind whatsoever, and specifically disclaims and excludes all other warranties of any kind or nature whatsoever, directly or indirectly, express or implied, including, without limitation, as to the suitability, productivity, durability, fitness for a particular purpose or use, merchantability, condition, or any other matter with respect to Rivera Primo Inc. products.

1056-0006

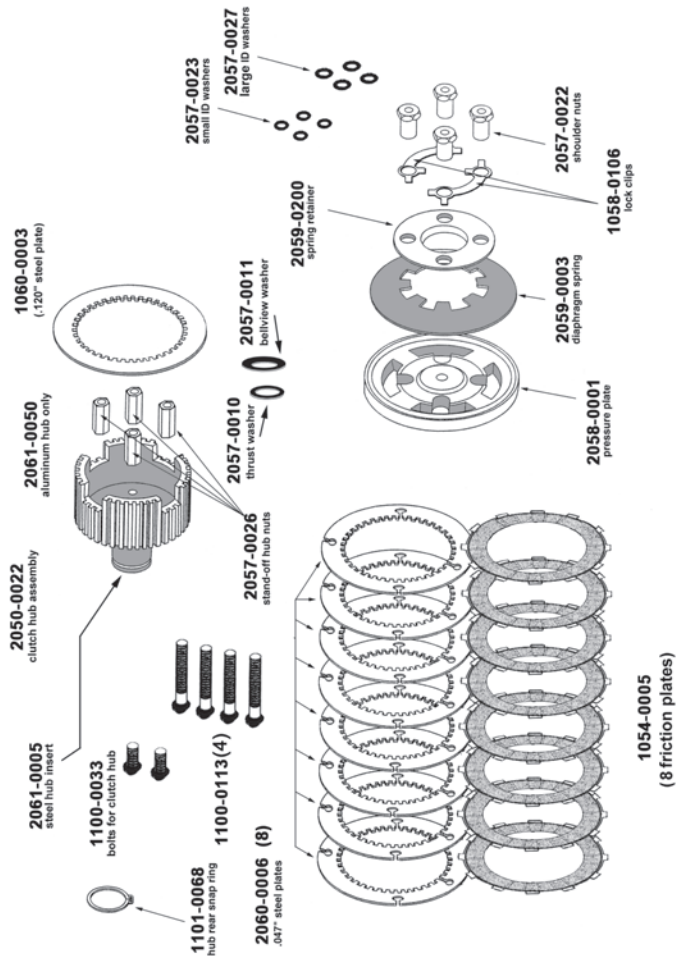

1056-0005

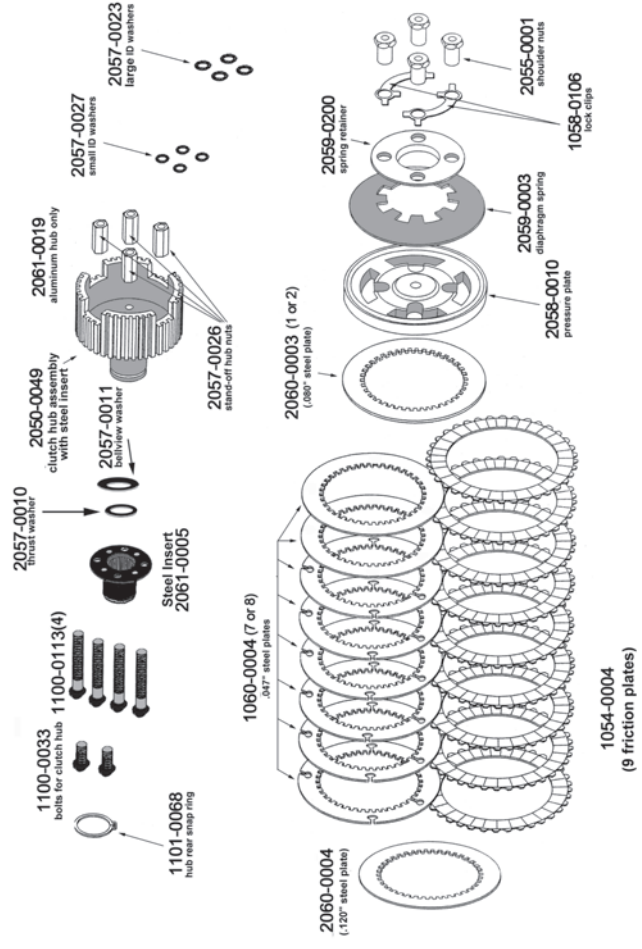

1056-0003

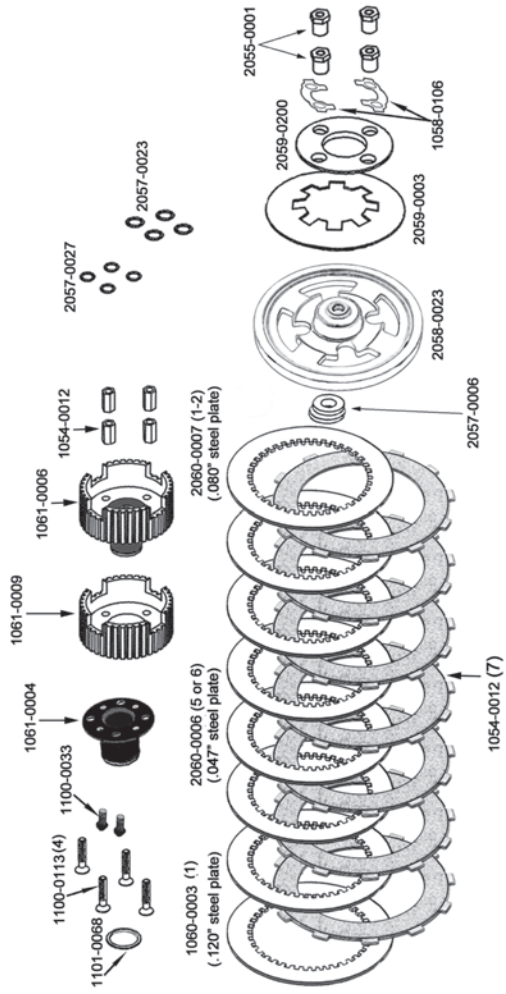

1056-0020

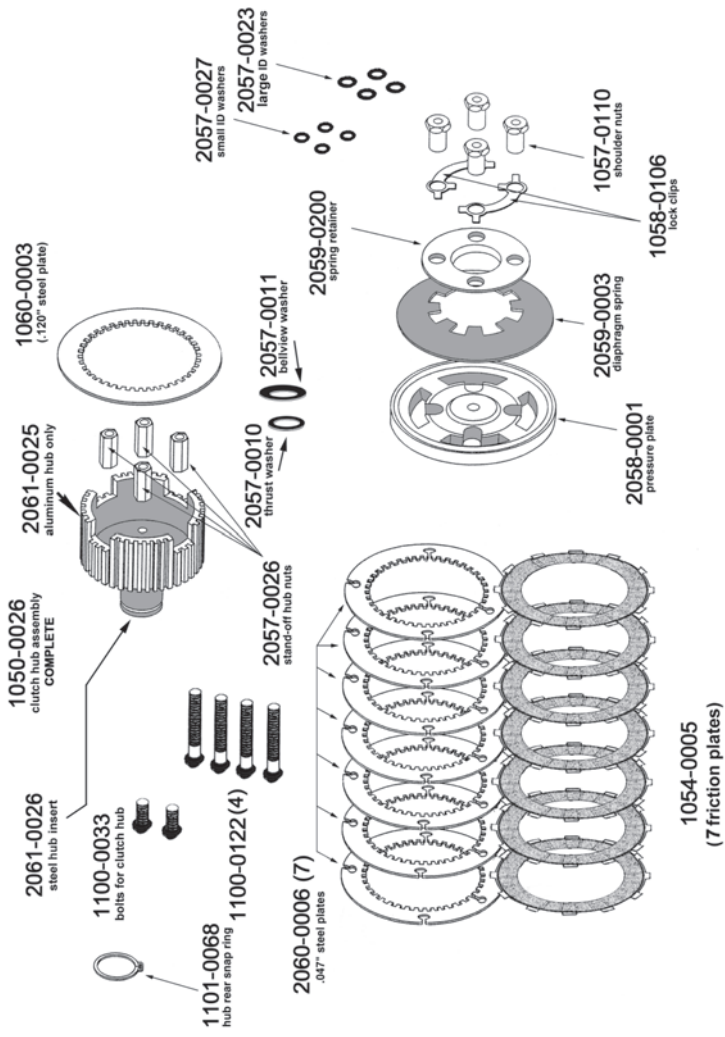

1056-0003

Fits 1986-1989 Evo Big Twin

Qty	Part #	Description		
1	1101-0068Small snap ring (hub rear)	4	1100-0113.....Bolts for clutch hub
1	1061-0004Steel inner hub	4	2057-0027Washer (stud side adjustment)(4 req)
1	1100-0132Nut for clutch hub screw (need 4)	7	1054-0012Clutch friction plate
1	2059-0003Diaphragm clutch spring (silver/medium)	1	2060-0007Clutch plate steel (.080")
1	2059-0200Diaphragm spring retainer	1	2058-0023Pressure plate (center hump)
4	2055-0001Shouldered nut (retainer)(need 4)	1	2057-0006Clutch hub nut spacer
2	1058-0106Locking clip for retainer nuts (2 req)	6	2060-0006Steel plate (.047")
4	2057-0023Washer for nut (need 4)	1	1060-0003Steel plate (.120")
1	1061-0009Outer hub aluminum	2	1100-0033Screws for clutch hub(2)
			1	1108-0006Installation instructions

1056-0005

Fits 1990-1997 Evo Big Twin

Qty	Part #	Description		
1	2061-0005Steel inner hub	2	2060-0003Clutch plate steel (.080")
1	2061-0019Outer hub (aluminum)	7	1060-0004Clutch plate steel (.047")
1	2057-0010Thrust washer	1	2060-0004Clutch plate steel (.120)
1	2057-0011Bellview washer	1	1101-0068.....Snap ring small
2	1100-0033Screws for clutch hub	1	2058-0010Pressure plate
4	1100-0113Bolts for clutch hub	1	2059-0003Diaphragm clutch spring (silver/medium)
4	2057-0026Nuts for clutch hub screws	4	2055-0001Shouldered nuts (for retainer)
9	1054-0004Clutch friction plate(s)/Kevlar	2	1058-0106Lock clips for shouldered nuts
			1	2059-0200Diaphragm spring retainer
			1	2057-0024Washer set (4 plus 4)
			1	1108-0006.....Installation instructions

1056-0006

Fits 1998-2006 Evo & Twin Cam (except 2006 Dyna)

Qty	Part #	Description		
1	2061-0005Steel inner hub	8	2060-0006Clutch plate steel (.047")
1	2061-0050Outer hub (aluminum)	1	1060-0003Clutch plate steel (.120)
1	2057-0010Thrust washer	1	1101-0068.....Snap ring small
1	2057-0011Bellview washer	1	2058-0001Pressure plate
2	1100-0033Screws for clutch hub	1	2059-0003Diaphragm clutch spring (silver/medium)
4	1100-0113Bolts for clutch hub	4	2057-0022Shouldered nuts (for retainer)
4	2057-0026Nuts for clutch hub screws	2	1058-0106Lock clips for shouldered nuts
8	1054-0005Clutch friction plate(s)/Kevlar	1	2059-0200Diaphragm spring retainer
			1	2057-0024Washer set (4 plus 4)
			1	1108-0006.....Installation instructions

1056-0020

Fits 2006 Dyna & 2007-Up All Big Twin

Qty	Part #	Description		
1	1050-0026Complete clutch hub assembly	7	2060-0006.....Clutch plate steel (.047")
1	2061-0026Steel inner hub only	1	1060-0003.....Clutch plate steel (.120")
1	2061-0025Outer hub (aluminum) only	1	1101-0068.....Small snap ring
1	2057-0010Thrust washer	1	2058-0001.....Pressure plate
1	2057-0011Bellview washer	1	2059-0003.....Diaphragm clutch spring (silver/medium)
2	1100-0033Screws for clutch hub	1	2059-0200.....Diaphragm spring retainer
4	1100-0122Bolts for mounting alum. plate	4	1057-0110Shouldered nuts (for retainer)
4	2057-0026Stand-off hub nuts	2	1058-0106.....Lock clips for retainer nuts
7	1054-0005Clutch friction plate/Kevlar	1	2057-0024.....Shims for clutch pack (4 large / 4 small)
			1	1108-0006.....Installation instructions

TAPERED SHAFT HUB REMOVER TOOL

1062-0002. Tapered hub removal tool (all applications). Simply mount the tool on the left hand threads of the transmission main shaft, and give the end of the tool a sharp tap with a medium weight hammer and the clutch hub simply “pops” off. Available now for all tapered shaft clutch hubs.

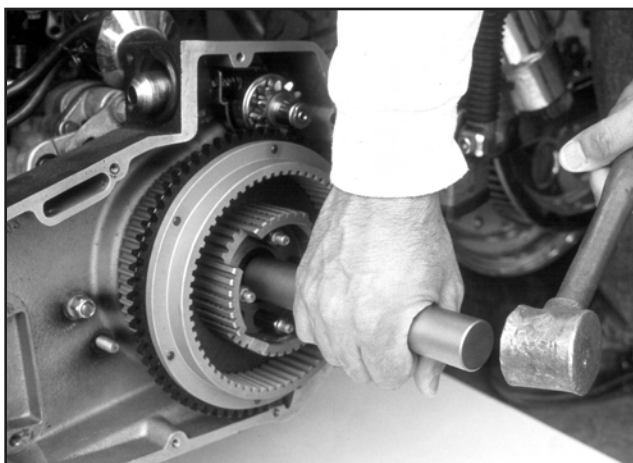
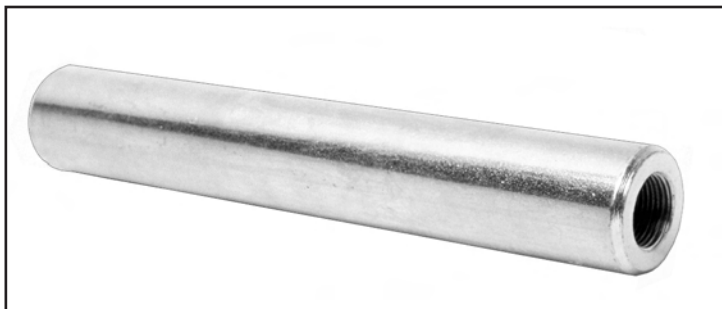

CLUTCH HUB PULLER



1062-0003 . . . Quickly attaches to most Pro-Clutch™ or Primo Belt Drives diaphragm-spring style clutch hub to allow quick easy removal.



CLUTCH HUB HOLDER

1062-0001 . . Engages & holds clutch hub splines to allow correct torque specification to be applied to the clutch hub nut (left-hand thread) when installing a Pro-Clutch™ or Primo Belt drive. Also holds clutch hub for de-installation.

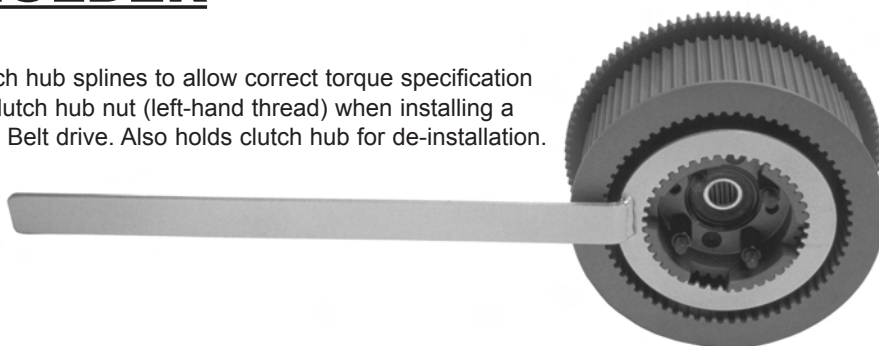

Rivera Primo Inc. 12450 Whittier Blvd., Whittier, CA 90602

TEL: (562) 907-2600 FAX: (562) 907 2606 / www.riveraprimo.com / E-mail: info1@riveraprimo.com