

Please read these instructions carefully and thoroughly before beginning work.

Before installing accessory, carefully consider whether one possesses the necessary technical skills and workshop tools to complete the installation properly. Otherwise, any Motorcycle Retailer will be glad to install this accessory.

Dealers, if installing the Highway Bar for a customer please supply them this manual. It contains the instructional and reference material needed to properly maintain and use this product.

At time of purchase report any missing parts directly to National Cycle, Inc. The following information is necessary: BAG NUMBER on outside of plastic fastener bag and DATE STAMP located on the end panel of the outer box.

**Thank you.**

The following symbols are used in these instructions:



Special notes and cautionary measures.



Tips for facilitation of operation, control and adjustment, as well as maintenance work.

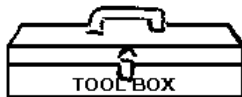

4mm Allan Wrench  
8mm Hex  
Ratchet  
10mm Socket  
14mm Socket  
1/2" Socket  
Torque Wrench  
*Motorcycle Service Manual for  
Torque Specifications.*



#### **PARTS LIST**

<u>Index</u>	<u>Part No.</u>	<u>Description</u>	<u>Qty.</u>
1	90-970205-000	Highway Bar, Left	1
2	90-970206-000	Highway Bar, Right	1
3	51-513052-000	"U" Bolt	2
4	42-431010-000	Whizlock Nut, Chrome	4
5	51-515965-000	CS M10 1.25 x 65	2
6	51-515951-000	CS M10 1.25 x 50	2
7	49-495531-000	Spacer	4
	Bag#795	Replacement Parts Items 3-7	

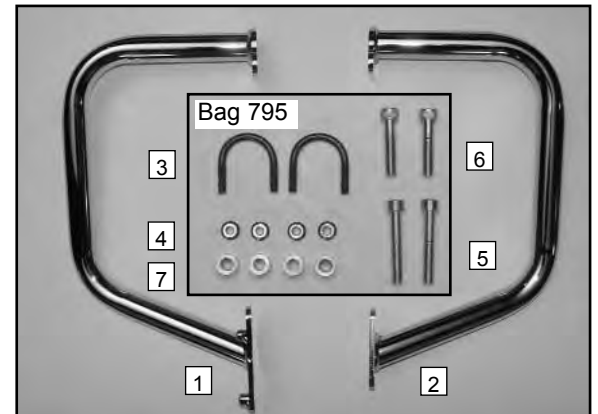

Right and Left side of Motorcycle is determined while sitting on the bike.

#### **PREPARATION**

1. Insure that the motorcycle is on flat level ground.
2. It is recommended that the motorcycle sit for at least one hour prior to installation to allow the engine to cool.
3. To facilitate installing the U-clamps to the down tube, loosen the radiator frame cover. **(4mm Allan Wrench)**  
**Figure 1.**



During installation tighten all fasteners to hold. Wait until you check all clearances and operation of the brake and shift lever to firmly tighten and torque all fasteners.



Figure 1

## INSTALLATION

### Right Side Highway Bar

1. Remove the bottom engine mount bolt. Store bolts they will not be re-used. **(14mm Socket) Figure 2.**
2. Select the right side Highway Bar. Using one supplied spacer and one 50mm bolt, loosely install the Highway Bar at the lower mount point. **(8mm Hex) Figure 3.**
3. Repeat procedure at upper engine mount bolt using the supplied 50mm bolt and one spacer. **Do not fully tighten bolts. (14mm Socket, 8mm Hex) Figure 4.**

### Install Upper “U” Bolt

 While installing the Whizlock Nuts (step #4 below), tighten the nuts evenly, alternating left and right as you tighten. When complete you want the same amount of threads exposed on the ends of the “U” to insure the bolt does not rotate. **Do not fully tighten at this time.**

4. Place “U” Bolt between the radiator and the down tube at the location shown in **Figure 5**. Threaded ends of “U” will face outward. Install Whizlock Nuts. **(1/2” Socket) Do not fully tighten.**



Figure 5



Figure 2



Figure 3

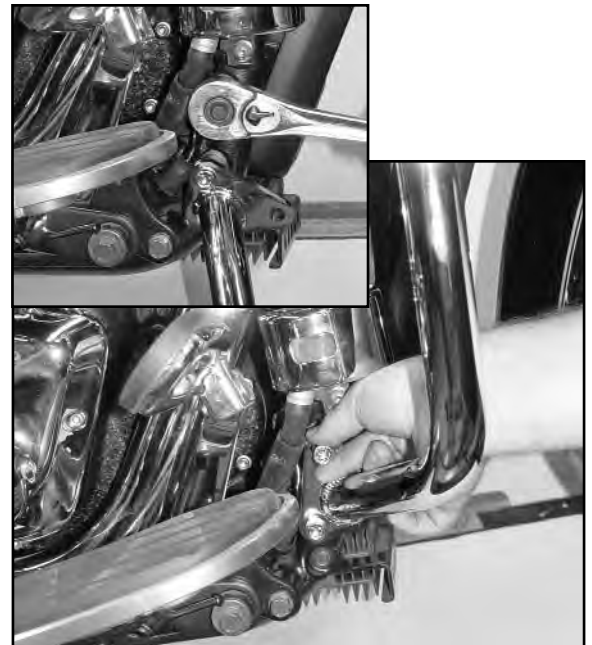

Figure 4

## LEFT SIDE INSTALLATION



To expose the engine mount bolts you need to loosen the wire connector cover. See step #6.

1. Remove the two bolts holding the wire connector cover. Bolts will be reused. **(10mm Socket) Figure 6.**

2. Remove the lower engine mount bolt. **(14mm Socket) Figure 7.**

3. Install Highway Bar at lower engine mount point using the supplied 65mm bolt and one spacer. Place spacer to the inside of Highway Bar. Do not fully tighten. **(8mm Hex) Figure 8 and 9.**

4. Use remaining 65mm bolt, and spacer to install Engine Guard to upper mount point. Spacer is located to the inside of Highway Bar. **Do not fully tighten. (14mm Socket and 8mm Hex)**



On the **Left Side** due to tight clearances between the radiator and the down tube you must locate the point where the radiator is "notched out" slightly. **Figure 10.**

5. Repeat Step #3 to install "U" Clamp. **Do not fully tighten. (1/2" Socket) Figure 10.**



Figure 6



Figure 7



Figure 8



Figure 9



Figure 10

## CHECK CLEARANCE AND TIGHTEN ALL FASTENERS



Check clearance and operation of foot brake and shift lever. Check clearance of Highway Bar at a full fork lock left and right. Adjust as necessary.

12. Tighten all Screws (left and right side) at the lower mount points to the specified torque in your service manual. Tighten the 4 Whizlock Nuts firmly. (8mm Hex and 1/2" Socket) Figure 11.

13. Reinstall the Wire Connector Cover. (Hex Key) Figure 12.

Check hardware for tightness after you ride the motorcycle. Re-tighten fasteners if necessary.

## MAINTENANCE / CAUTION

The high quality chrome finish of your National Cycle Highway Bar can be maintained with any quality chrome cleaner or polish applied with a soft cloth.



Check hardware for tightness regularly. Never ride with loose mounting hardware. Check to be sure your Highway Bar does not contact any part of the motorcycle at a full turn left and right. Correct any problem before using the motorcycle.

If the additional of an accessory(ies) adversely affects your motorcycle's stability immediately remove the accessory(ies). Do Not ride a motorcycle that exhibits unsafe handling traits. Have experienced service personnel correct any problem before riding with the accessory(ies) installed. For further questions concerning handling problems associated with an accessory(ies), contact your dealer, motorcycle manufacturer, or accessory manufacturer.



Figure 11



Figure 12