



Heritage Beauty  
**WinterWarm**  
Wood Fireplace Inserts



St  
Performance  
Go state-of-the-art  
warm with WinterWarm.

# WinterWarm Wood Fireplace Inserts



**The WinterWarm System. Easy. Efficient. Perfect.**

The WinterWarm Fireplace Insert slips easily into your existing fireplace to instantly transform it into an efficient heat source. You'll enjoy all of the beauty of an open fireplace, with all of the convenience and performance of a state-of-the-art wood stove. Two sizes are available to suit a wide range of fireplace and room sizes.



**WinterWarm Small Insert**

## WinterWarm Small Inserts

### Standard Features

- High Efficiency - more heat from less wood – 74%
- Large fireviewing area with clean, durable, ceramic glass
- Easy ash pan handling
- High heat output of 30,000 BTUs/hr
- Adjustable front for recessed or flush installation
- Rheostat controlled twin fans
- Solid durable cast iron construction
- Long overnight burn times
- Conveniently located, front mounted controls
- Thermostatic control for steady, even heat

### Options

- Cast iron or steel surround panels in Classic Black
- Outside Air Kit





WinterWarm Fireplace System

## WinterWarm Fireplace System

The WinterWarm System allows you to add the elegance of a fireplace almost anywhere in your home. The system includes everything you need – Large WinterWarm insert, the zero clearance cabinet and gravity vent ducts. It's beautiful. Functional. And it's only by Vermont Castings®.

### Standard Features

- High Efficiency – 78% – more heat from less wood
- Large fireviewing area with clean, durable, ceramic glass
- Easy swing-out ash pan with cover
- High heat output – up to 50,000 BTU/hr
- Rheostat controlled twin fans for heat circulation
- Very low smoke emissions – 2.1 grams/hr
- Standard sparkscreen for open fireviewing
- Solid, durable cast iron construction
- Long overnight burn times
- Solid brass trim around door
- Conveniently located controls
- Thermostatic control for steady, even heat
- Classic Black Endcaps (ordered separately)
- Classic Black Front (ordered separately)
- Outside Air Kit
- Cabinet Blower Kit
- Surround Panels

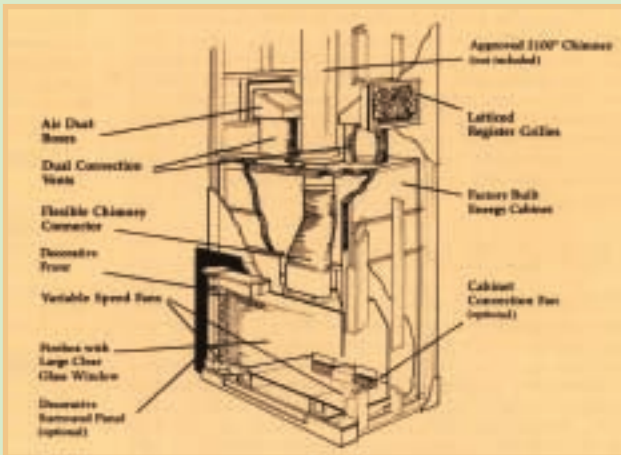

## WinterWarm Large Inserts

### Standard Features

- High Efficiency - more heat from less wood - 78.3%
- Large fireviewing area with clean, durable, ceramic glass
- Easy ash pan handling
- High heat output of 50,000 BTUs/hr
- Rheostat controlled twin fans
- Standard sparkscreen for open fireviewing
- Solid durable cast iron construction
- Long overnight burn times
- Conveniently located, front mounted controls
- Thermostatic control for steady, even heat
- Classic Black Surround (order separately)

### Options

- Outside Air Kit
- Steel surround panels available for larger opening in Classic Black only
- Vent starters and adaptors



WinterWarm Large Insert

# WinterWarm Wood Fireplace Inserts

## Models • Small • Large • Fireplace System



### WINTERWARM SMALL INSERT

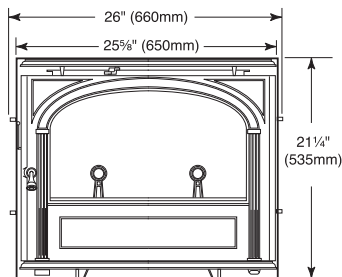

FRONT VIEW

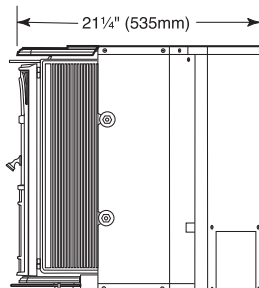

SIDE VIEW

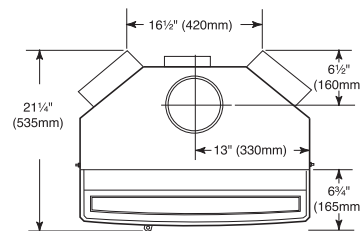

TOP VIEW

**Specifications:** Small Model  
 Log Length: 18"  
 Burn Time: 6 - 8 hours  
 Heating Capacity: 500 - 1,000 sq. ft.  
 Maximum Heat Output: 30,000 BTU/hr  
 Efficiency Rating: 74%  
 EPA Emissions Rating: 2.1 grams/hr  
 Weight: 285lbs

**Minimum Fireplace Dimensions:**  
 Height: 21 1/2"  
 Width: 26 1/2"  
 Depth: 15"

**Flue Collar Size:** 6" round

**Optional Surround Packages:**  
 6" steel covers: 36 1/2" W x 27" H  
 10" steel cover: 44 1/2" W x 3" H  
 7" Cast covers: 40" W x 28 1/2" H  
 10" Cast covers: 45" W x 31" H

### WINTERWARM LARGE INSERT

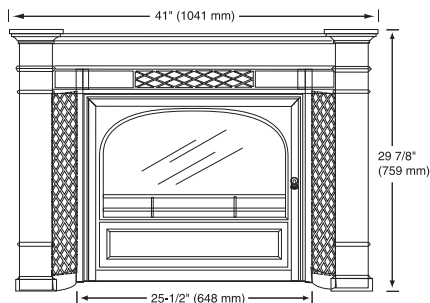

FRONT VIEW

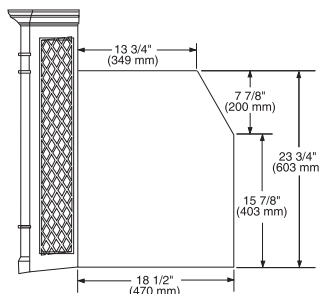

SIDE VIEW

**Specifications:** Large Model  
 Log Length: 24"  
 Burn Time: Up to 9 hours  
 Heating Capacity: 750 - 1,500 sq. ft.  
 Maximum Heat Output: 50,000 BTU/hr  
 Efficiency Rating: 78.3%  
 EPA Emissions Rating: 2.1 grams/hr  
 Weight: 475lbs

**Minimum Fireplace Dimensions:**  
 Height: 24"  
 Width: 34"  
 Depth: 19"

**Flue Collar Size:** 8" oval  
 Optional Surround covers up to 51" W x 36" H

### WINTERWARM FIREPLACE SYSTEM - Specifications: Fireplace System Model. (Specifications same as WinterWarm Large)

Log Length: 24"  
 Burn Time: Up to 9 hr  
 Heating Capacity: 750 - 1,500 sq. ft.  
 Maximum Heat Output: 50,000 BTU/hr  
 Clearances of Cabinet: To Wall Studs: 1/2"

Efficiency Rating: 78.3%  
 EPA Emissions Rating: 2.1 grams/hr  
 Weight: 840lbs  
 Chimney: 8" High Temperature

**Cabinet Dimensions:**  
 Height: 59 1/2"  
 Width: 39 1/2"  
 Depth: 28 1/2"  
 Visible Front: 41" W x 34 1/2" H



ph: 1.800.525.1898  
 www.vermontcastings.com  
 www.majesticproducts.com

YOUR DEALER