



INSTRUCTIONS

#307500 and #307501 FAST™ Fuel System Kits

Thank you for choosing FAST™ products; we are proud to be your manufacturer of choice. Please read this instruction sheet carefully before beginning the installation.

Kit Contents:

1 ea	fuel pump wiring kit	1 ea	Pump
1 ea	3ft length of 10 ga. Black wire	1 ea	Filter 100 Micron SS
1 ea	25ft length of 10 ga. Red wire	1 ea	Filter 10 Micron Paper
1 ea	30 amp circuit breaker	1 ea	Fuel Pressure Regulator
1 ea	30 amp automotive relay	1 ea	Y-block Assembly
2 ea	blue female blade connector	2 ea	AN-08 cutoff union
2 ea	yellow female blade connector	2 ea	AN-08 o-ring
5 ea	yellow #10 stud ring connector	1 ea	AN-10 cutoff to AN-08 union
1 ea	yellow 3/8" stud ring connector	1 ea	AN-10 o-ring
6 ea	tie-wraps	12 ea	tie-wraps
1 ea	AN-06 cutoff union	1 ea	AN-06 o-ring
3 ea	AN-10 cutoff union	8 ea	AN-10 o-ring
3 ea	AN-10 cutoff to AN-08 union		

Caution: Installation of this product requires detailed knowledge of automotive systems and repair procedures. We recommend that this installation be carried out by a qualified automotive technician. Installation of this product requires handling of gasoline. Ensure you are working in a well ventilated area with an approved fire extinguisher nearby. Extinguish all open flames, prohibit smoking and eliminate all sources of ignition in the area of the vehicle before proceeding with the installation. When installing this product, wear eye goggles and other safety apparel as needed to protect yourself from debris and sprayed gasoline.

Warning: The fuel system is under pressure. Do not open the fuel system until the pressure has been relieved. Refer to the appropriate vehicle service manual for the procedure and precautions for relieving the fuel system pressure. FAST™ fuel system components are not legal for sale or use on emission controlled motor vehicles. The included FAST™ fuel pump is not compatible with alcohol based fuels or fuel additives!

This kit assumes you have a sumped fuel tank or fuel cell with accommodations for an AN-10 supply line and an AN-06 return line. Fuel tank pickups will not work properly with FAST™ fuel systems and will be detrimental to your fuel systems life. If your fuel tank is not sumped, we recommend having your fuel tank sumped by a qualified professional. No fuel rails are provided with this kit, your fuel rails must have accommodations to accept AN-08 hose ends in order to install this kit properly.



FAST™
 3400 Democrat Rd.
 Memphis, TN 38118
 Phone: (901) 260-3278 Fax: (901) 375-3408
 www.fuelairspark.com

Part #30161
 Revised 8/14/07

The following steps are typical of most installations:

- Section 1 – Fuel Pump Installation
- Section 2 – Fuel Regulator Installation and Fuel Line Plumbing
- Section 3 – Fuel Line Hose End Installation
- Section 4 – Electrical Installation
- Section 5 – Final Checks and System Start-up, Fuel Pump Template

Typical hose end to fitting connection:

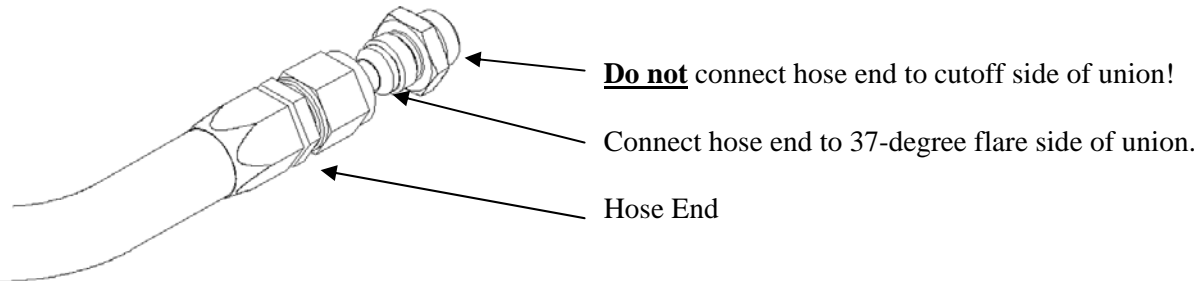

Typical o-ring sealed port connection:

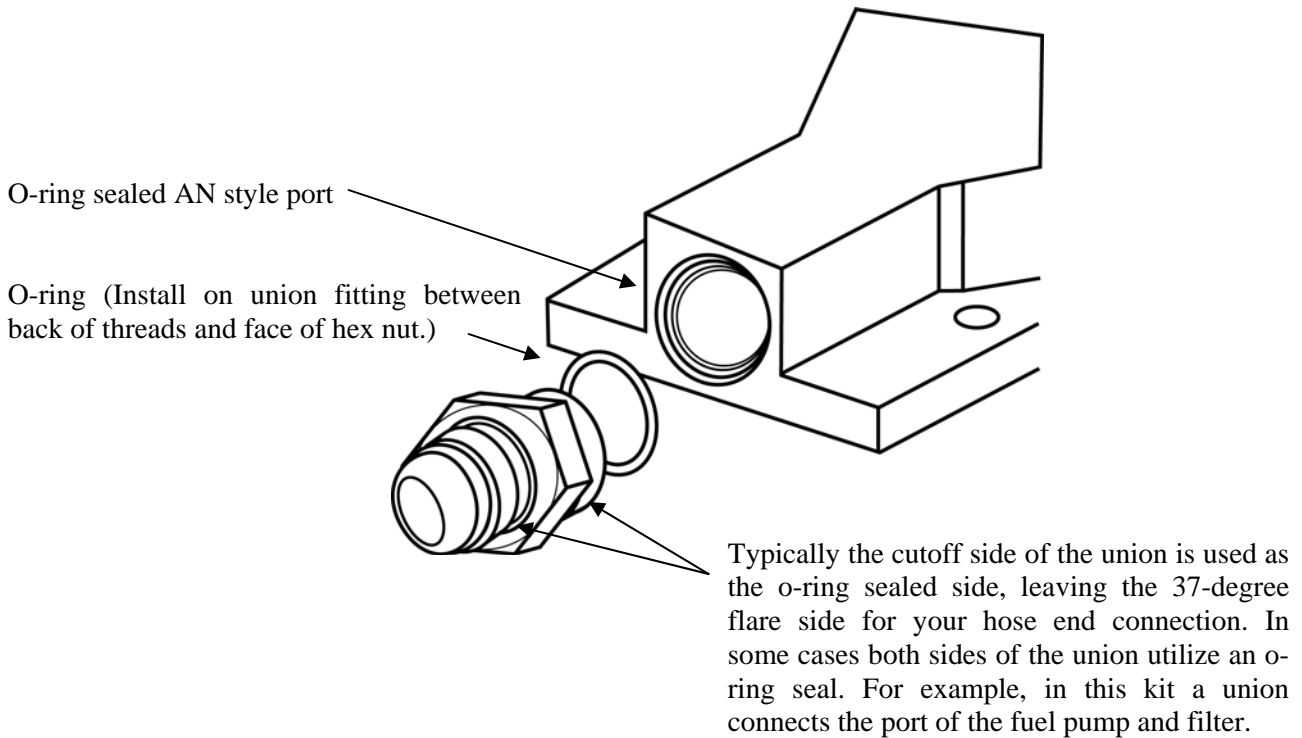

Section 1 - Fuel Pump Installation:

1. Once the engine has been allowed to cool, disconnect the negative battery cable and relieve the fuel system of all pressure.
2. Raise the vehicle and support it with jack stands.
3. Referring to the appropriate vehicle service manual for instructions, drain, disconnect any electrical and fuel component connections.
4. In the kit, find two AN-10 cutoff union fittings and four of the AN-10 o-rings. Install each of the four o-rings on each end of the two AN-10 cutoff union fittings.

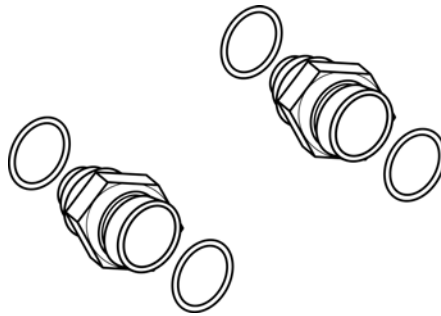

5. Install each of the two fittings into each end of the provided FAST™ fuel pump.

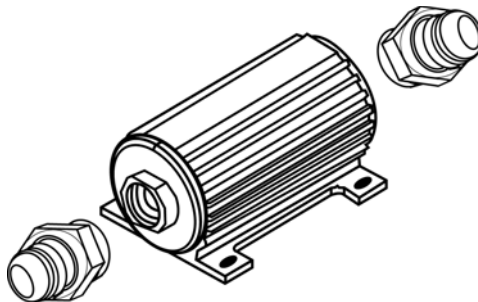

6. Noting the appropriate flow directions, install the provided fuel filter. If you get the two filters mixed up, the fuel pump inlet side filter will have a 100 micron stainless steel filter element inside, where as the fuel pump outlet filter will have a 10 micron paper filter element inside.

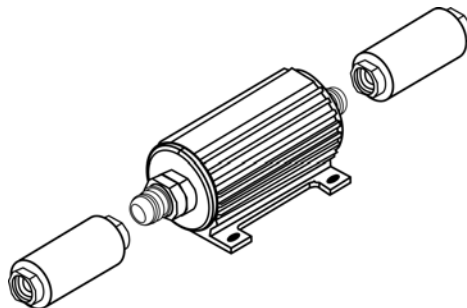

7. Install one of the supplied AN-10 o-rings on the cutoff side of the AN-10 cutoff union fitting, if not already installed, and install on the inlet side of the pump/filter assembly.

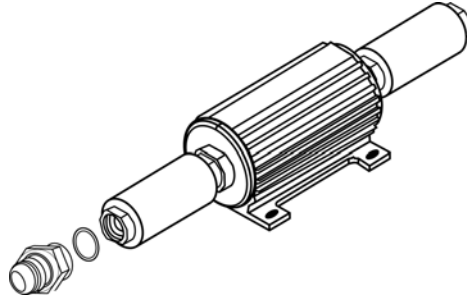

8. Install one of the supplied AN-10 o-rings on the AN-10 cutoff side of the AN-10 cutoff to AN-08 reducer union fitting, and install the fitting on the outlet side of the pump/filter assembly.

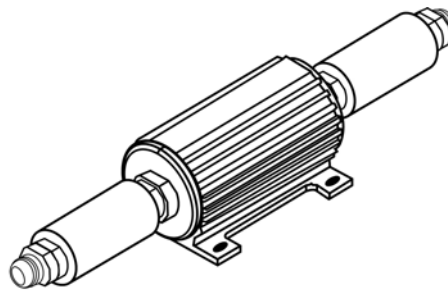

9. Find a suitable mounting location for the above pump/filter assembly. **Warning: Do not mount on the gas tank shield; the typical mounting location is the inside of the frame rail.** The fuel pump should be mounted as close to the fuel tank as possible and as low as possible. Using the fuel pump as a guide or using the pump mounting template, mark the four pump mounting holes. Ensure there are no obstructions behind the mounting surface and drill four 1/4" mounting holes.

Note: Be sure to route all fuel lines clear of any moving suspension or drivetrain components and any exhaust components! Protect fuel lines from abrasion and road obstructions or debris.

10. Secure the fuel pump to the mounting surface using four 1/4" bolts, nuts, and lock washers (not provided).

Note: Be sure to route all fuel lines clear of any moving suspension or drivetrain components and any exhaust components! Protect fuel lines from abrasion and road obstructions or debris.

11. Using the two supplied AN-10 hose ends as a guide, measure the length of AN-10 steel braided line needed to connect your fuel tank sump or fuel cell outlet to the fuel pump/filter assembly inlet.

12. Connect one end to the outlet of the fuel tank sump and the other end to the fuel pump/filter assembly inlet and tighten.

Note: It is recommended that a fuel shut off valve be installed between the fuel tank outlet and the fuel pump & filter assembly inlet, these valves are available from most popular racing fitting manufactures; Aeroquip, Earl's, Goodridge, Russell, etc.

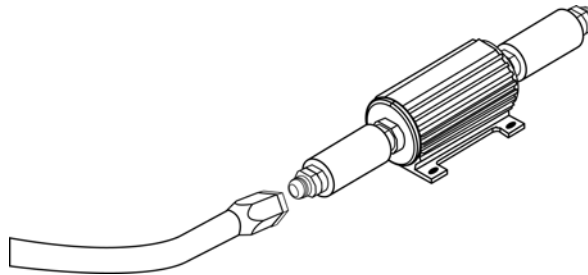

13. In vehicles engine compartment, locate a suitable mounting location for the supplied fuel pressure regulator.
14. Starting from the determined regulator mounting location in the engine compartment, plan a route to run an AN-06 return line back to the fuel tank or fuel cell return port and measure the required length.

Note: Be sure to route all fuel lines clear of any moving suspension or drivetrain components and any exhaust components! Protect fuel lines from abrasion and road obstructions or debris.

15. Thread one end of the AN-06 return line onto the AN-06 return line accommodations of your fuel tank or fuel cell and tighten.
16. Make any line or electrical adjustments necessary to clear the vehicles exhaust, suspension, and drivetrain components.

Section 2 – Fuel Regulator Installation and Fuel Line Plumbing

1. In the vehicle's engine compartment, mount the supplied fuel pressure regulator in the location established in step 1 – 15. Using the supplied mounting bracket as a template, mark the bracket mounting holes and drill to accept a #10 screw.
2. With the bracket attached to the regulator, mount the bracket and regulator to the vehicle using two #10 screws, nuts and lock washers (not provided).
3. Install two of the supplied AN-10 o-rings on the cutoff side of two AN-10 cutoff to AN-08 reducer union fittings, if not already installed, and install in each of the AN-10 ports located on the sides of the supplied fuel pressure regulator.

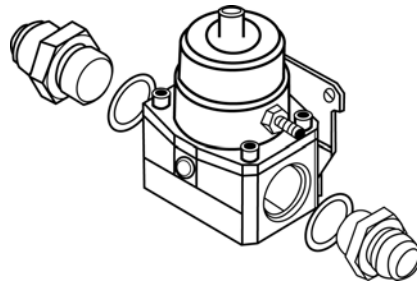

4. Install one of the supplied AN-06 o-rings on the cutoff side of the AN-06 cutoff union fitting, if not already installed, and install in the AN-06 port located on the bottom of the supplied fuel pressure regulator.

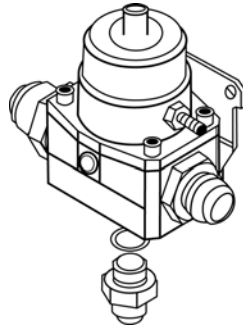

5. Starting from the fuel rails, plan a route to run an AN-08 supply line from each fuel rail to each side of the regulator. Cut the two supply lines to the determined length and install the AN-08 hose ends, as detailed in Section 3.

Note: Be sure to route all fuel lines clear of any moving suspension or drivetrain components and any exhaust components! Protect fuel lines from abrasion and road obstructions or debris.

6. Using the above steel braided hose assemblies, connect one end to the side of the fuel pressure regulator and the other end to the fuel rails and tighten.

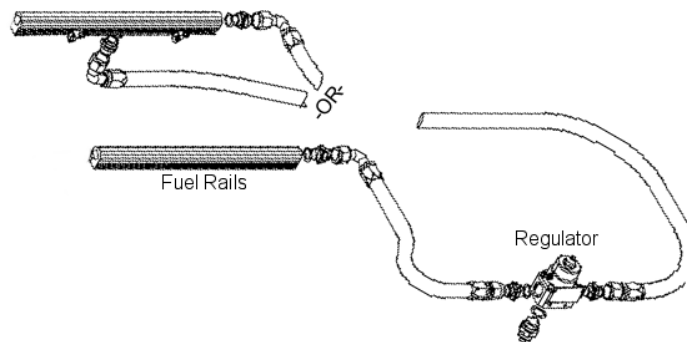

7. In the vehicle's engine compartment, find a suitable mounting location near the fuel rails for the supplied Y-block, using the Y-block as a template, mark the mounting holes and drill to accept a #10 screw.

8. Attach the Y-block to the vehicle using two #10 screws, nuts and lock washers.
9. Install two of the supplied AN-08 o-rings on the cutoff side of two AN-08 cutoff union fittings, if not already installed, and install in each of the AN-08 ports located on the supplied Y-Block. Install one of the supplied AN-10 o-rings on the cutoff side of the AN-10 to AN-08 reducer union fitting, if not already installed, and install in the AN-10 port located on the supplied Y-block.

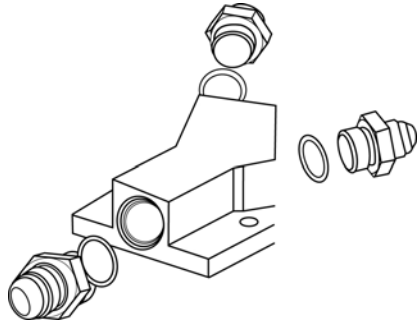

10. Starting from the fuel rails, plan a route to run an AN-08 supply line from each fuel rail to each side of the Y-block.

Note: Be sure to route all fuel lines clear of any moving suspension or drivetrain components and any exhaust components! Protect fuel lines from abrasion and road obstructions or debris.

11. Using the above steel braided hose assemblies, connect one end to the Y-block and the other end to the fuel rails and tighten.

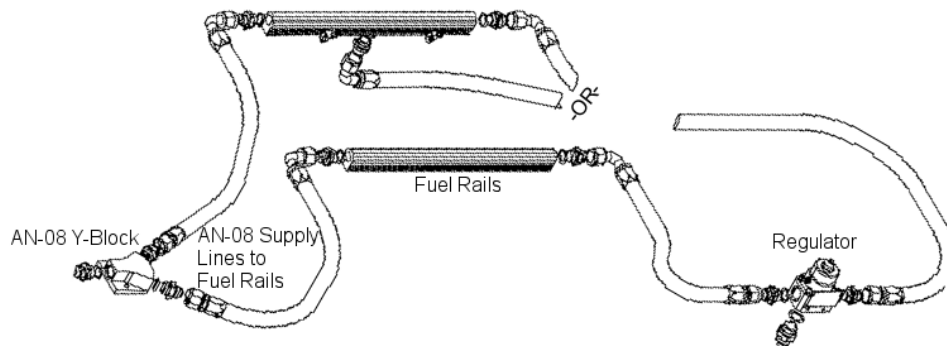

12. Starting from the outlet of the fuel pump/filter assembly; plan a route to run an AN-08 supply line from fuel pump/filter assembly to the Y-block, this line should be run along the same route you planned to run the return line in section 1, step 16.

Note: Be sure to route all fuel lines clear of any moving suspension or drivetrain components and any exhaust components! Protect fuel lines from abrasion and road obstructions or debris.

13. Using the above steel braided hose assembly, connect one end to the outlet of the fuel pump/filter assembly. Keeping both the supply line and return line from the fuel tank together, secure both lines to the vehicle along the predetermined route using the supplied tie-wraps. Once both lines are secure, connect the supply line to the Y-block and the return line to the bottom of the regulator and tighten.

Note: Be sure to route all fuel lines clear of any moving suspension or drivetrain components and any exhaust components! Protect fuel lines from abrasion and road obstructions or debris.

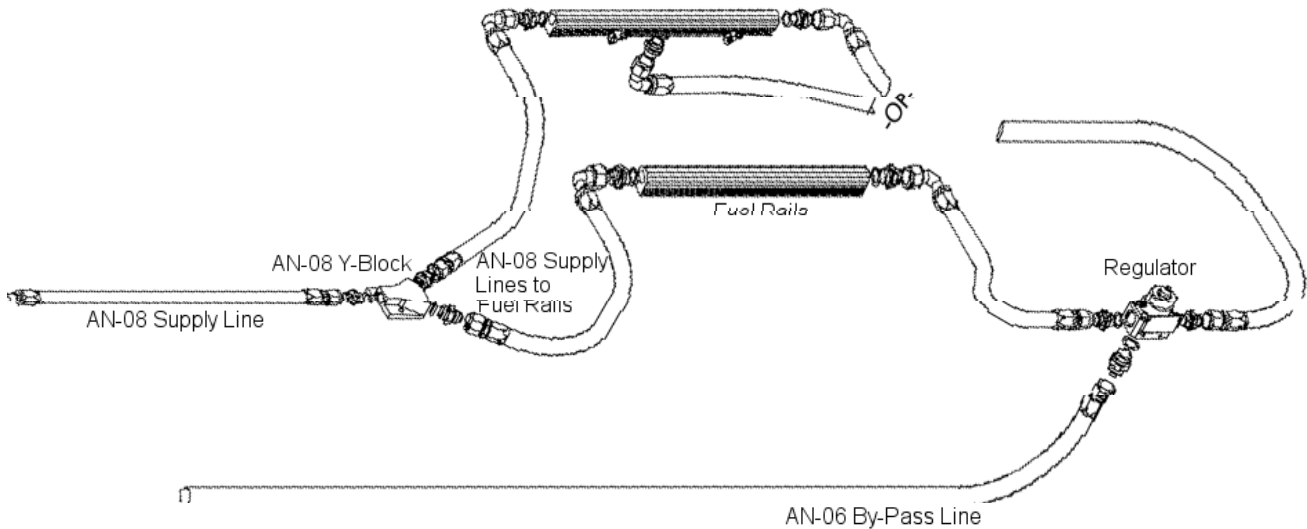

14. Once the regulator is installed, attach a suitable fuel pressure gauge (not supplied) to the 1/8 NPT port on the fuel pressure regulator.

Section 3 - Fuel Line Hose End Installation

Caution: When assembling this product, wear eye goggles and other safety apparel as needed to protect yourself from debris and sharp edges.

1. Wrap hose with masking tape at the desired cutoff length. Cut hose through masking tape squarely to desired length using a cut-off machine or a fine tooth hacksaw and remove the masking tape.
2. Unthread the hose socket from the rest of the hose end fitting.



3. Insert hose in the socket with a twisting and pushing motion until the hose is fully seated in the socket.



4. Using a grease pencil, marker or tape; mark the location of the hose in relation to the hose socket that you just installed.
5. Using a light oil, lubricate the inside of the hose and hose end mating parts.
6. Carefully thread the hose end onto the hose socket, making sure that the hose does not push out of socket, by observing the mark you placed on the hose in step 4 of this section.



7. Using a properly sized wrench, complete threading the two components together (The maximum allowable gap between the two fitting components is .030 inches).



8. Inspect the hose for push out by comparing the mark you made on the hose in step 3-4 to the hose end socket location.

9. Clean all debris from exterior and interior of hose.
10. All lines should be tested to twice their operation pressure prior to use.

Section 4 - Electrical Installation

1. Find a suitable place to mount the supplied relay, the relay is typically mounted by the OEM fuel pump wiring connector (**Never mount the relay inside of the fuel tank or next to fuel tank vents!**). Ensure the relay and any associated parts are clear of the exhaust, any moving suspension or drivetrain components and any possible road obstructions or debris.
2. Attach the OEM fuel pump wires to relay terminals 85 and 86 using two of the supplied blue female blade connectors (See Figure Below).

Note: Be sure to route all electrical wires clear of any moving suspension or drivetrain components, and any exhaust components! Protect wires from abrasion and road obstructions or debris.

3. Find a suitable location for mounting the supplied circuit breaker. For optimal circuit protection, the circuit breaker needs to be mounted as close to the battery as possible.
4. Connect terminal number 30 on the relay to the circuit breaker by using the supplied red 10 ga. wire, one of the yellow female blade connectors on the relay end of the wire and one of the yellow #10 ring connectors on the circuit breaker side of the wire.

Note: Be sure to route all electrical wires clear of any moving suspension or drivetrain components and any exhaust components! Protect wires from abrasion and road obstructions or debris.

5. Connect terminal number 87 on the relay to the positive terminal on the fuel pump. This is accomplished by using the supplied red 10 gauge wire, one of the yellow female blade connectors on the relay side of the wire and one of the yellow #10 ring connectors on the fuel pump side of the wire.
6. Connect the negative terminal on the fuel pump to a clean chassis ground using the supplied black 10 gauge wire and two yellow #10 ring connectors.
7. Connect 12VDC to the circuit breaker using the supplied red wire and one of the yellow #10 ring connectors and the supplied yellow 3/8" ring connector.
8. Ensure that electrical components and wires are connected properly (See Figure 4-1) and are clear of any moving suspension or drivetrain components and any exhaust components! Protect wires from abrasion and road obstructions or debris.



FAST™
 3400 Democrat Rd.
 Memphis, TN 38118
 Phone: (901) 260-3278 Fax: (901) 375-3408
 www.fuelairspark.com

Part #30161
Revised 8/14/07

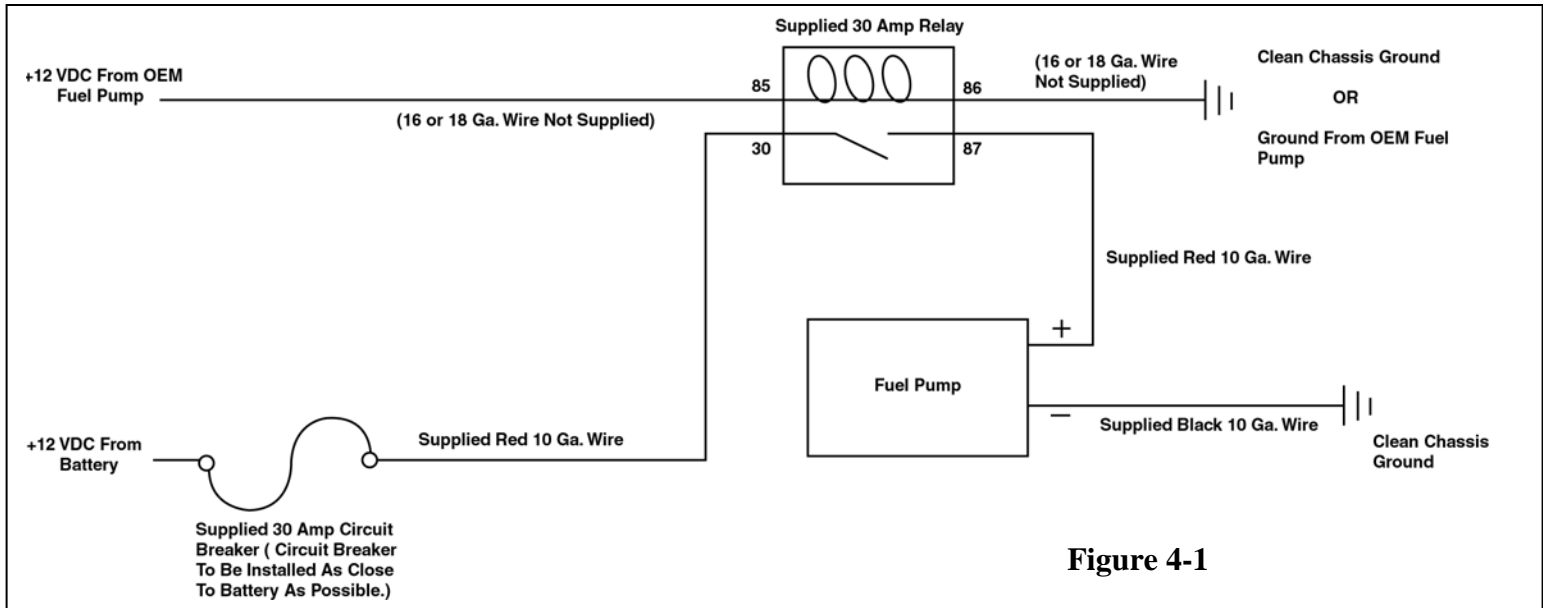

Section 5 – Final Checks and System Start-up

1. Ensure that any spilled gasoline and any gasoline soaked shop towels are cleaned up and removed from the vicinity of the vehicle!
2. Carefully lower the car to the ground.
3. Fill the fuel tank with gasoline and check for any leaks in the system, if any leaks are found repair immediately.

Caution: While performing the following steps, if any fuel leaks are detected, immediately turn the ignition OFF, remove any spilled fuel and repair the leak(s) before proceeding!

4. Reconnect the battery and turn the ignition to the ON position WITHOUT starting the car. After several seconds check the fuel pressure. If there is no fuel pressure, turn the ignition key to the OFF position, wait one minute, return the ignition to the ON position, and recheck the fuel pressure. Repeat this ignition OFF and ON procedure until the fuel pressure gauge registers fuel pressure.
5. With the fuel pressure gauge registering fuel system pressure, check for leaks throughout the entire fuel system! If any leaks are found, turn the ignition key to the OFF position, remove any spilled fuel and repair the leak before proceeding!
6. Once the fuel pressure gauge registers fuel system pressure and there are no fuel leaks, start the engine and adjust the regulator to the desired fuel pressure. Turning the adjustment screw clockwise will increase the fuel pressure. OEM regulators are typically set at approximately 43 psi, without the vacuum line attached. The fuel pressure adjustment range for this regulator is 35-80 psi.

7. Once the desired fuel pressure is achieved, tighten the regulator adjustment jam nut & attach vacuum line.
8. Test drive the car to ensure proper operation and re-check the fuel system for leaks. **If any leaks are found, immediately discontinue use of the vehicle and repair the leak(s)!**

Limited Warranty

FAST, Inc. warrants that all of its products are free from defects in material and workmanship for a period of 1 year from the date of purchase. This limited warranty shall cover the original purchaser.

FAST, Inc.'s obligation under this warranty is limited to the repair or replacement of its product. To make a warranty claim, the part must be returned within 1 year of purchase to the address listed below, freight prepaid. Items covered under warranty will be returned to you freight collect.

It is the responsibility of the installer to ensure that all of the components are correct before installation. We assume no liability for any errors made in tolerances, component selection, or installation.

There is absolutely no warranty on the following:

- **Any parts used in racing applications.**
- **Any product that has been physically altered, improperly installed or maintained.**
- **Any product used in improper applications, abused, or not used in conjunction with the proper parts.**

There are no implied warranties of merchantability or fitness for a particular purpose. There are no warranties, which extend beyond the description of the face hereof. FAST, Inc. will not be responsible for incidental and consequential damages, property damage or personal injury damages to the extent permitted by law. Where required by law, implied warranties or merchantability and fitness are limited to a term of 1 year from the date of original purchase. This warranty gives you specific legal rights and you may also have other legal rights, which vary from state to state.



FAST™
3400 Democrat Rd.
Memphis, TN 38118
Phone: (901) 260-3278 Fax: (901) 375-3408
www.fuelairspark.com

Part #30161
Revised 8/14/07