

Service Bulletin

Issue No	DR-Z400SM-5
Date	22/03/2012
Page	1 of 3

Subject	SERVICE CAMPAIGN FRONT WHEEL REPLACEMENT
Applicable Model	DR-Z400SML0
Effective Engine or Frame No	JS1B8111300100849 - JS1B8111300100873
Reference	SERVICE MANUAL 99500-43090-01E

Service Campaign SSC10-02

We have investigated this matter and have elected to conduct a service campaign on this issue.

We have had some reports from the market relating to the front wheel assembly of DR-Z400SML0. In some cases there is not enough clearance between the inside diameter of the front wheel hub and the outside diameter axle tube. This can cause the hub to interfere with the axle tube and may lead to unsmooth rotation of the front wheel or damage to the speedo drive.

If you have an issue with a DR-Z400SML0 turning the Speedo Drive or you have a unit in for servicing within the effected vehicle identification number range please replace the wheel assembly. **NOTE: Please check Suzuki on Line for the campaign status before proceeding.**

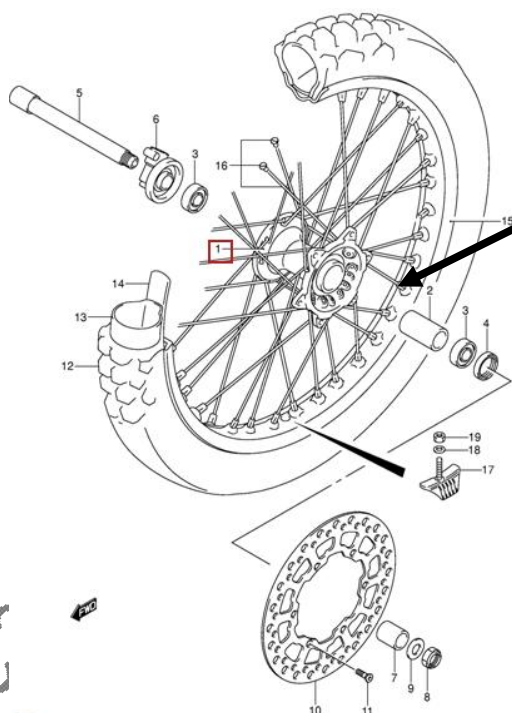

Reference

Inside diameter of wheel hub at the axle tube: 29 – 30 mm
Outside diameter of axle tube: 27.3 mm



SUZUKI AUSTRALIA PTY. LIMITED A.C.N. 001 828 164

DEALER CIRCULATION:

Dealer Principal	Service Manager	Parts Dept	Sales Manager	Service Administration	Workshop Technician	Workshop Technician	Workshop Technician

Procedure

Once you have identified the need please order a wheel kit using the attached order form. You can fax or email these orders to the contacts below.

Fax- 039931 0511

E-mail- motorcycle_warranty@suzuki.com.au

The wheel kit contents are:

1. 1 x Assembled wheel with bearings seal and spacer fitted.
2. 6 x Disc Bolts

Please refer to the DR-Z400SM Service Manual 99500-43090-01E on Suzukinet for removal and replacement of the front wheel assembly Chapter 6-Chassis Section 3-8, Chapter 14 Section-28

Warranty Claim Procedure

Claim Type	2 (Campaign)
Causal Part	54111-29F10 Hub
Quantity	0
Trouble/Defect	99-UC
Basic Code	HP9999
Time	1.2

It is important that the old wheel hub is not able to be reused in any way. For this reason please remove the hub from the wheel assembly for return to Suzuki Australia (SAPL). When you have claimed 4 hubs a pick up will be created to return the hubs to SAPL for destruction. Please ensure the hubs are tagged with warranty tags. If we are unable to obtain or identify the old hubs because they have no warranty tags, the warranty claims will be reversed. If it is not likely that you will do 4 hubs pick ups will be created for one or two etc. We will monitor this at SAPL.

DR-Z400SML0 Front Wheel Kit

Fax to SAPL - (03) 9931 0511

Model	Start Vin	End Vin
DR-Z400SML0	JS1B8111300100849	JS1B8111300100873

Replacement Kit - 55311-29FIX-010

Quantity required - 1

Dealership_____

Address_____

VIN of Unit Requiring Wheel Kit

MODEL	VIN																

Please do not order kits unless an owner has contacted you and wants this campaign carried out by your dealership.