

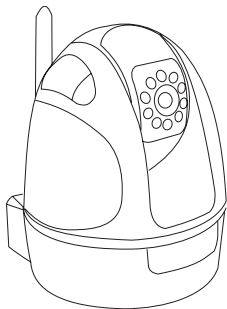

WIRELESS DIGITAL PAN & TILT SURVEILLANCE SYSTEM

Model No. : WSS-I

USER MANUAL



Please read this user manual carefully before using this product!

Packing List:

- ① 2.4 GHz Wireless Camera (1)
- ② 2.4 GHz Wireless Receiver (1)
- ③ Power Adapters (2)
- ④ AV Cable (1)
- ⑤ Earphone (1)
- ⑥ 2.5 to 3.5mm Earphone Adapter (1)
- ⑦ Antenna (1)



***WSS-I = WSS-2 (Camera) + WSS-3 (Receiver)**

****WSS-6 = Ceiling/Wall Camera Mounting Bracket (sold separately)**

Structure:

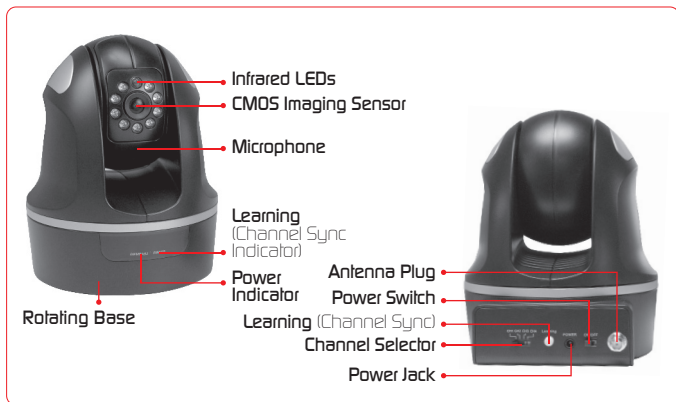



*2.5 to 3.5mm Adapter Included

Installation Diagram:

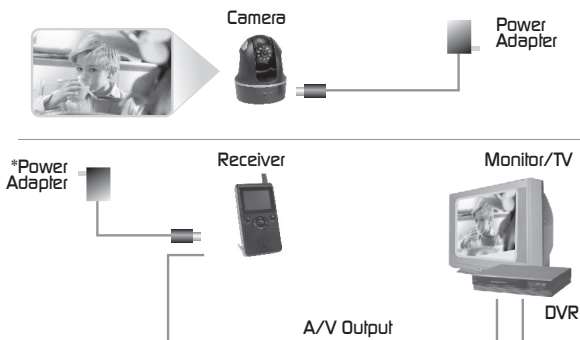

*Receiver also works with (4) AAA Batteries (not included)

Installation:

Attach the antenna to the antenna plug at the back of the camera by screwing it in place. Then place the camera on a flat, stable surface.

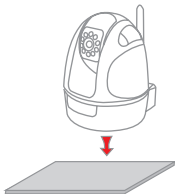

Connect one of the provided power adapters to the power jack and then into a power outlet, then slide the power switch to the ON position. The power indicator will light up and the camera will calibrate itself by automatically running through its full range of motions.

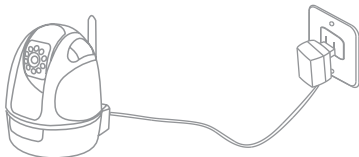

Connect one of the provided power adapters to the power jack of the receiver and then into a power outlet. Then slide the power switch to the ON position.



NOTE!

This receiver can also work on battery power. Please insert four (4) AAA batteries into their appropriate slots at the back of the

(Note: It will not charge the batteries.)

receiver, with proper orientation as indicated on the battery compartment.

If the receiver is left unused for an extended period of time, please disconnect it from the power adapter or remove batteries if they have been installed.

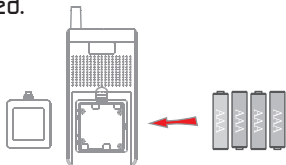

Channel Synchronization (*for adding additional cameras only): Press and hold the Channel button on the receiver until the Learning indicator flashes, and then press the Learning button on the back of the camera while the indicator flashes (about 8 seconds) on the receiver, at which point the channel number displayed on the receiver should match the channel selected on the back of the camera. You may now control this additional camera with the direction pad on the receiver.

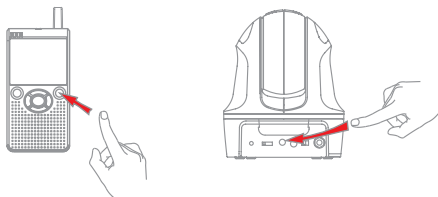

You may adjust the brightness and the volume to your desired level by rotating the dials on the side of the receiver.

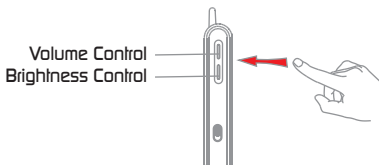

Zooming:

You can enlarge the picture seen on the receiver by two (2) times by pressing the ZOOM button once: press again to return to normal viewing mode.

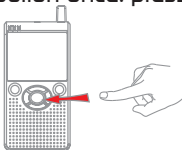

Channel Looping Setup:

The receiver supports up to 4 cameras working at the same time. Press and hold the ZOOM button on the receiver until "scanning..." appears to enable the automatic looping function. The channels are shown on the monitor one by one every 5 seconds. Press and hold the ZOOM button on the receiver again to exit the looping function.

You can also press the CHANNEL button to exit the looping function.

Adjusting Viewing Angle of Camera:

The direction pad buttons on the receiver act as a remote control for the viewing angle of the camera.

1.) Use the ◀ / ▶ keys to rotate the camera horizontally. The maximum angle of rotation is 270 degrees.

2.) use the ▲ / ▼ keys to rotate the camera vertically. The maximum angle of rotation in this direction is 120 degrees.

Rotate Image:

Hold the CTRL button for 3 seconds to rotate the image seen on the receiver by 180 degrees. This optional mode is useful for users who have installed their cameras upside down.

Other Functions:

Press the CTRL button once to turn off the LCD screen for sleep mode; press it again to turn it back on. While in sleep mode you will still be able to hear the sounds picked up by the microphone.

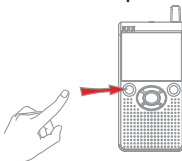

You may connect the receiver to any display device with an A/V input for a larger, clearer picture, which can be recorded!

Specifications:

	Item	Value
General	Transmission Frequency	ISM 2,400 - 2,483 MHz
	Transmission Power	17±3dBm
	Unobstructed Effective Range	1,000ft. (Min.)
	Spread Spectrum	FHSS
	Modulation Mode	GFSK
	Operating Temperature	32°F - 122°F
	Operating Humidity	15% - 85%
Camera	Imaging Sensor Type	CMOS
	Picture Total Pixels	640 x 480
	Minimum Illumination	0Lux (IR ON); 5Lux (IR OFF)
	Night Vision Distance	16ft. (Min.)
	View Angle	55°
	Bandwidth	3MHz
	Sound Detection Sensitivity	<38dB
	Consumption Current (Max.)	500mA
Receiver	Power Supply	5VDC
	Dimensions (W x D x H) (inches)	4.41 x 4.29 x 5.24
	Weight	.93lbs.
	LCD Screen Type	2.36 TFT-LCD
	Effective Pixels	480 (R,G,B.) x 234
	Receiving Sensitivity	<80dBm
	Consumption Current (Max.)	200mA
	Battery Working Time	3 hours
	Power Supply	5VDC
	Dimensions (W x D x H) (inches)	2.68 x 5.87 x 1.02
	Weight	.30lbs.

Actual transmission range may vary according to weather, location, interference or building construction.
All specifications are subject to minor change without prior notice.

WARRANTY

1 Year Warranty: This product is warranted to be free from defects in materials and workmanship and meet applicable specifications when tested to ratings. This warranty is in lieu of any other warranty expressed, implied, or statutory. NTE's liability under this warranty is limited to repairing, replacing, or issuing credit (at the discretion of NTE) for such products that become defective or fail to meet specification during the warranty period of one year from the date of sale. The technical data shown is intended to provide safe areas of operation for this product. Determination as to whether a product is actually defective rests with NTE. In no event will NTE be liable for consequential or special damages.

FCC Information:

This device complies with part 15 of FCC Rules. Operation is subject to the following two conditions:

- (1) This device does not cause harmful interference.
- (2) This device must accept any interference received, including interference that may cause undesired operation.

Changes or modifications not expressly approved by the party responsible for compliance could void the users authority to operate the equipment.

Warnings:

- **WSS-I should not be exposed to dripping or splashing liquid.**
- **No objects filled with liquids shall be placed on the unit.**
- **Turn off the camera & receiver if the system is not in use.**
- **Do not cut the DC power cable of the unit to fit with another power source.**
- **Attention should be given to the environment in regards to battery disposal.**

Environmental Protection

Electrical waste products should not be disposed of with household waste. Please recycle where facilities exist. Check with your Local Authority or retailer for recycling advice

