

## User's manual and safety instructions of the unique, patented Ruby Fires Ceramic Burner a product by Ruby Decor B.V., The Netherlands

**Keep this user's manual carefully for the life of this product. This product is only to be sold in combination with this user's manual.**

Please read the instructions below thoroughly before putting your Ruby Fires ceramic burner to use. Make sure that the guidelines as provided are followed.

The Ruby Fires ceramic burner can only be used by people of age, who are competent and who have read and understood these user's manual and safety instructions.

### Installation of the ceramic burner:

- The ceramic burner is to be placed or hung on a heat resistant foundation or wall.
- When attaching to a wall, we advise to keep a safety distance of minimum 1 cm from the wall in order to ensure a natural flow of air.
- Never remove the isolation layer on the backside. Risk of fire!
- Make sure that during installation the ceramic burner is levelled, both horizontally and vertically. This to make sure that liquid cannot flow out of the burner.
- Keep a safety distance of at least 1 meter (on left-, right- and front side) to objects. Keep flammable objects (e.g. curtains, furniture or bookshelves) away from the Ceramic Burner.
- Do not place the ceramic burner next to, underneath or on top of a windowsill. Risk of fire!
- Use the ceramic burner only in a draft-free room, otherwise soot can be a result. However, it is important to have sufficient ventilation.
- Ruby Fires delivers its own unique fuel: Ruby Fires bio ethanol 98% called LEF. The ceramic burner can only function optimally in combination with this Ruby Fires bio ethanol 98%. Never use another liquid or gel to fill or refill the ceramic burner: this may cause blockage of or damage to the ceramic element on the inside of the burner, resulting in flames of poor quality. As a consequence, the warranty expires as well. Exceptions need to be agreed upon by Ruby Fires.

### Installation in a Ruby Fires surround:

- Place the ceramic burner in the insert (make sure this is levelled)

### Installation in an existing fireplace:

- Place the Ceramic burner in the therefore appointed space (make sure this is levelled) Minimum distance necessary above top of the burner: 50 cm. Risk of fire!

### Installation of the enclosed glass screens:

- We advise you to use the enclosed glass screens. The glass plates can be installed on the burner with the torques supplied with the burner. This prevents the flames to hit the back (see pictures below). Contact your dealer if flames keep on hitting the back.

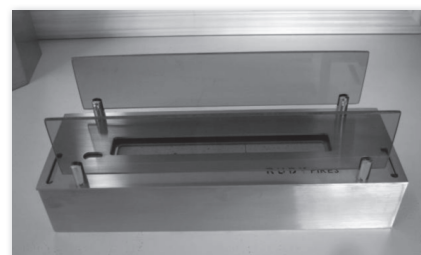
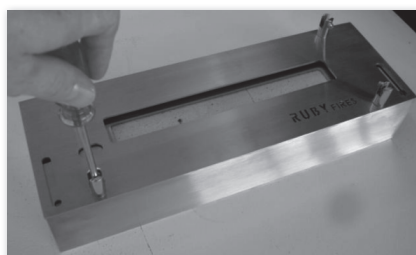

### Installation of the logset/pebbles:

- Ruby Fires has developed a special ceramic log set and pebbles for decoration purposes of the ceramic burner. Place these around the fire opening (the (white) ceramic element) of the burner. The fire opening should remain free. When decoration material is placed into the flames, unnecessary soot will be formed and an unsafe situation may arise. Do not touch decoration material until it has cooled down for at least 30 minutes. Risk of burns!
- For safety reasons never use any other decoration material for the ceramic burner except the original Ruby Fires ceramic log set or pebbles. Risk of fire!
- When placing a ceramic burner against a back wall (e.g. (wall)surround), make sure the flames burn vertically at all times. This by using glass, log set, pebbles or a spoiler. In case the flames do hit the back, extinguish the fire immediately and contact your supplier! Check our website for different examples.

# RUBY FIRES®

## Filling the ceramic burner with Ruby Fires bio ethanol 98% LEF, use only LEF to fill the ceramic burner.

- It is of great importance that the liquid never flows outside the filling opening.
- Make sure to fill the ceramic burner carefully and slowly, so it cannot be overfilled.
- In case liquid is spilled, use a soft, absorbing cloth to clean.
- For an optimal fire the burner has to be filled not higher than 1 cm below the surface of the ceramic element.

When the ceramic burner is filled with LEF for the first time, the ceramic element on the inside will be saturated completely. The liquid will always remain partly absorbed by the brick. Therefore it is necessary to use more bio ethanol the first time the burner is filled than the following times.

	First filling	Refill
Ceramic burner Mini (4114)	± 1 liter	± 0.8 liter
Ceramic burner Small (4120 + Silo)	± 1.5 liter	± 1 liter
Ceramic burner Big (5820)	± 2 liter	± 1,5 liter
Ceramic line Burner (8014)	± 2,5 liter	± 2 liter

## How to fill the ceramic burner:

- Open the latch for one third, so the filling-opening is visible. With square burner: open fully.
- Place the enclosed funnel in the filling-opening.
- Carefully pour the Ruby Fires bio ethanol 98% in the funnel until the ceramic brick is saturated, but make sure that the liquid level remains underneath the surface of the element: at least 1 cm!

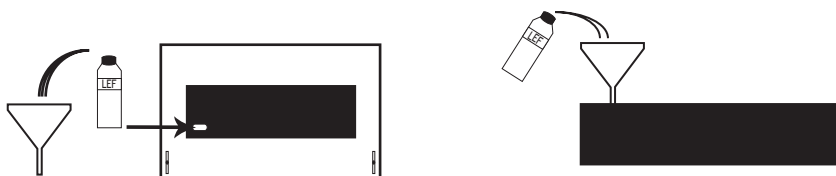

- **Warning:** Make sure that the liquid does not flow outside the filling-opening. In case liquid has been spilled outside the filling-opening, make sure this is dried up before lighting the fire. Risk of fire! There should never be fire outside the fire-opening. This is dangerous and can also cause the insert to de-form and damage of the paint of the insert.
- **Warning:** Keep on filling the burner until the level remains visible in the filling-opening. The level must remain at least 1 cm underneath the surface.
- When the ceramic burner is filled, remove the funnel. You can now fully open the latch. The burner-opening is visible and the ceramic burner is ready for use.

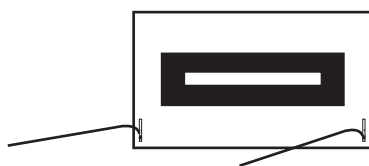

Latch open



Latch closed

## How to re-fill the ceramic burner:

- Close the latch when the ceramic burner is burnt empty.
- Check carefully that there is no longer any fire on the surface.
- Warning: Never fill a burning burner – Life threatening!
- Wait at least 30 minutes for the Bio Flame Burner to cool down.
- For further instructions see: 'How to fill the ceramic burner'

## Lighting the ceramic burner:

- There is a latch for the fire-opening on the topside of the ceramic burner.
- When the ceramic burner is not lit, this latch is closed (to prevent the bio ethanol from evaporating).
- By opening the latch the fire-opening with the ceramic brick becomes visible.
- The ceramic burner can be lit using a long lighter or a long matchstick, but only when nothing is placed on the opening and the Ruby Fires bio ethanol 98% is well filled as described in: 'How to fill the ceramic burner'

### Opening and closing the latch:

The latch can be opened using the enclosed handles.

### Maintenance

- When the ceramic burner has been used very often, discolorations on the top can occur. This is normal and does no harm to the quality of the product.
- Do not use an abrasive product for cleaning the insert. Clean the surfaces with a moist piece of cloth or a non-abrasive stainless steel cleanser.
- Glass screens can be cleaned with a ceramic cook top cleaner.

Possible problems and solutions:

Problem	Possible cause	Solution
Existence of soot	Wrong fuel	Use ONLY Ruby Fires bio ethanol 98%
Existence of soot	Fire-opening is covered with decoration material	Make sure the fire-opening is free of decoration material
Duration of fire too short	Wrong fuel (e.g. gel)	Use ONLY Ruby Fires bio ethanol 98%
Duration of fire too short	Burner has not been filled completely	Extinguish the burner. Let it cool down for at least 30 minutes and then re-fill.
Flames too high	Wrong fuel or draft	Use ONLY Ruby Fires bio ethanol 98%
Flames too low, not visible	Burner has not been filled completely	Extinguish the burner. Let it cool down for at least 30 minutes and then re-fill.
Burner makes a rustling noise	Wrong fuel (e.g. gel) or overfilled	Use ONLY Ruby Fires bio ethanol 98%
Flames are blue, not visible	Fuel is almost finished	Extinguish the burner. Let it cool down for at least 30 minutes and then re-fill.
Flames remain after the latch has been closed		Open the latch and quickly close it again to refrain the oxygen supply

Changes and/or alterations to the insert, surface or burner are unacceptable and will cause the warranty to expire.

Ruby Fires cannot be held responsible for possible damages or personal injuries caused by misuse or incompetent use of the insert and ceramic burner.

### Important:

- The ceramic burner is to be used for decorative purposes only and not as a primary source of heating.
- Bio ethanol is a hazardous material of danger level UN 1987, level 3
- The use of the ceramic burner as a multi-burner or open fire for liquid or solid combustible materials is not permitted.
- The ceramic burner is to be extinguished using the latch on the top side.
- When the ceramic burner is overfilled there is a risk of spilling the liquid fuel e.g. when it is bumped into. This can cause uncontrollable flames.
- The flames cannot be adjusted by using the latch. This should always be completely opened when in use.
- Do not smoke while (re)filling or lighting the burner. Risk of explosion!
- Never change the construction of the ceramic burner.
- **Warning! Never re-fill a hot or warm ceramic burner. Risk of explosion!**
- The flames should never directly touch the inside of the metal insert.
- Avoid physical contact with the bio ethanol.
- It is prohibited for children, people under the influence of alcohol, drugs or medications, or people who are physically or mentally not in good condition, to use the Ceramic Burner.
- Keep children and pets at a safe distance.

- Be careful with inflammable clothes or hair.
- Do not blow into the fire.
- Never leave the fire unattended.
- Do not place inflammable material e.g. paper, cardboard, fabric (clothes) etc. on the burner or surround.
- Keep the latch closed when the burner is not in use.
- The use of the ceramic burner for burning any other material besides the Ruby Fires bio ethanol is not permitted
- Warning! In case the flames hit the back of the insert extinguish the fire immediately and contact your supplier.
- Keep a fire-extinguisher or extinguishing blanket within reach.

#### Ventilation of the room:

When the ceramic burner is used in closed spaces, adequate ventilation has to be provided! In addition to carbon dioxide (CO<sub>2</sub>) an adequate supply of fresh air (150 cm<sup>2</sup> opening) should be ensured. Insufficient ventilation can cause poisoning by the odourless carbon monoxide. There are requirements for the supply of fresh air quantity per fire:

The room must be a minimum area of 25 m<sup>2</sup> and has to be ventilated at least 1/hr.

Type burner	Content (liters)	Measurem. (cm)	Heat (kW)	room (m <sup>2</sup> )	consumpt. (ltr p. hr.)	Burning time (hours)
4114	1	41x14x8	ca. 2	min 25	0,30	3
4120 + Silo	1,5	41x20x8	ca. 2,5	min 25	0.32	3
5820	2	58x20x8	ca. 3	min 35	0.47	4
8014	2	80x14x8	ca. 3,5	min 35	0.49	3,5 / 4

**Attention!! Temperature of glass and metal screens placed in front of the fire can reach 90°-140°C and top of the bio burner even 200°C, when the burner is in use!**

#### Warranty

The warranty on this product is 2 years. Any changes on the surface or inside of the ceramic burner, due to the usage of the product, are not included in the warranty of the ceramic burner.

Ruby Fires reserves the right to make any technical alterations in order to improve the product and its characteristics / safety.

Ruby Fires would like to thank you for the purchase of the ceramic burner. If all the instructions are carefully followed, the ceramic burner will burn free of soot and scent.