

know your no!no!

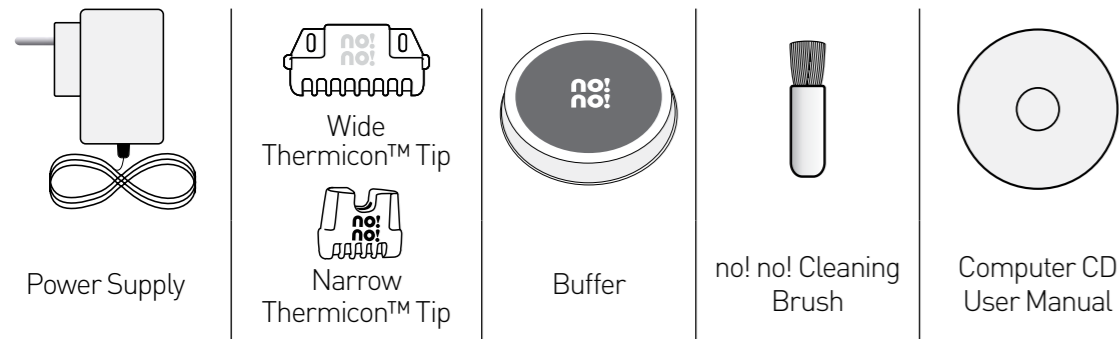
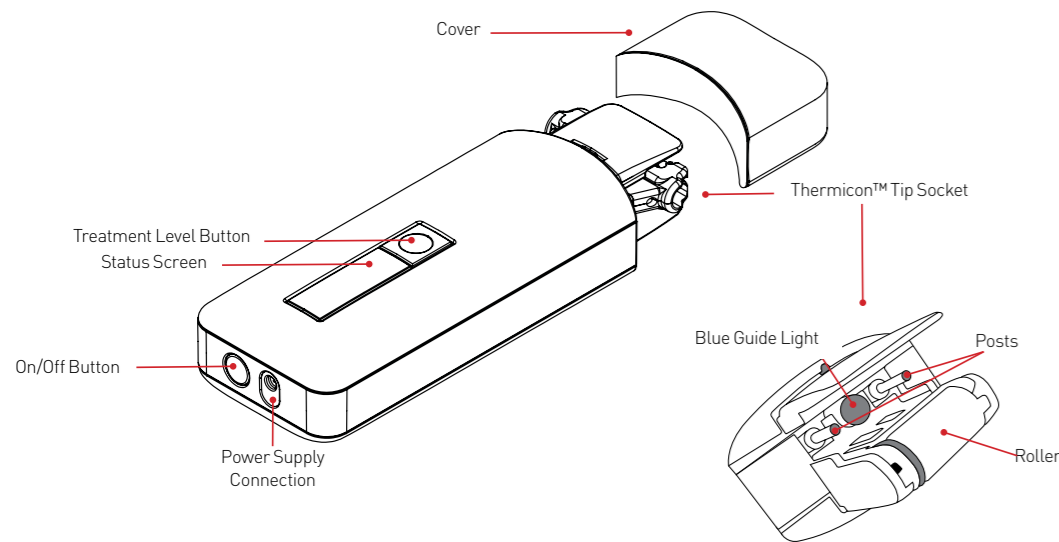

1. ready?

■ Before you start

- **Make sure your no!no! is fully charged.**
- Before using it for the first time, charge your no!no! at least 5 hours.
- When charging is complete, the full battery icon will flicker until the device is removed from the charger.
- Unplug no!no! before you start treatment. The device will not work while it is plugged in.

■ Remove the cover.

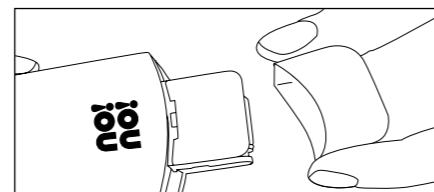

- Select the right tip.

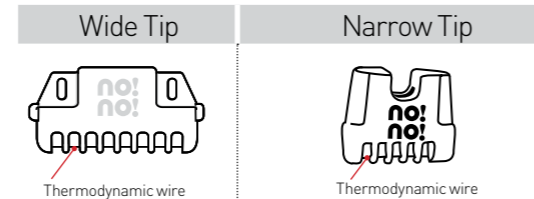

Use the wide tip for large areas like the arms, legs and back.

Use the narrow tip for small and sensitive areas like the face, nape of the neck, underarms and bikini line.

■ Install the Thermicon™ Tip.

- Hold no!no! in one hand and the tip of your choice in the other. Make sure the no!no! logos are facing the same direction. Then line up the posts in the socket with the holes in the Thermicon™ Tip and gently push into place (Figure 5, 6).

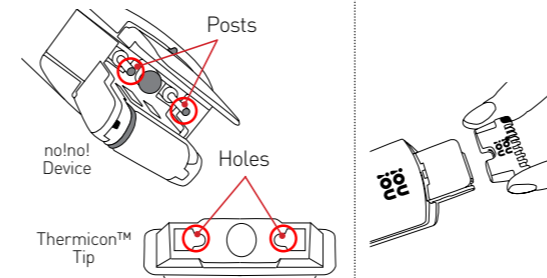
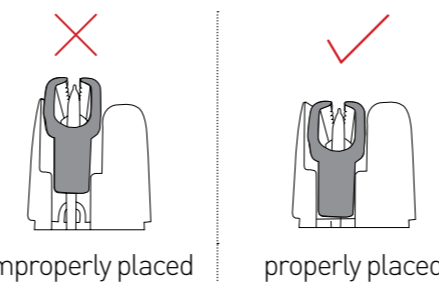

Figure 5

Figure 6

- Make sure the Thermicon™ Tip is properly inserted. It should be pushed all the way into the socket.



- **If you are treating facial hair, please see the Treating Facial Hair section on the other side of this Guide.**

2. get set...

■ Turn it on

Hold the on/off button (Figure 9) down for a few seconds until the Status Screen appears.

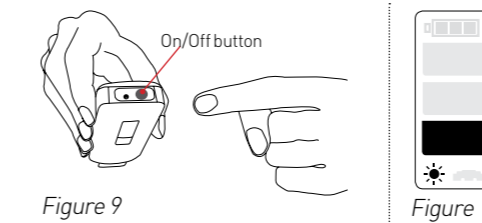

Figure 9

Figure 10

■ Adjust the Treatment Level.

- The default screen is as shown in Figure 10.
- Press the button under the status screen (Figure 11) to adjust your treatment level. Press once for Medium, twice for High, and once more to return to Low (Figure 12).
- When you first no!no!, always begin at the lowest treatment level and work your way up.

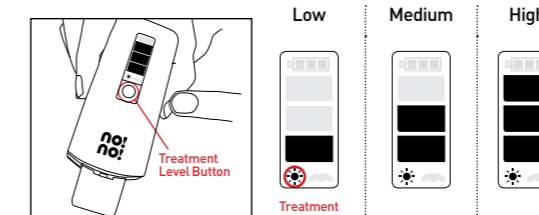

Figure 11

Figure 12

*When you turn it on again, it will display the last used Treatment Level

3. no!no!

■ Glide

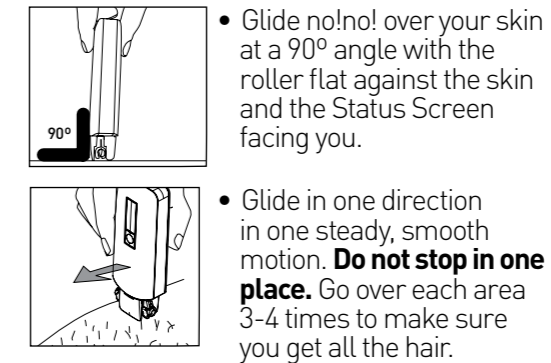

- Glide no!no! over your skin at a 90° angle with the roller flat against the skin and the Status Screen facing you.
- Glide in one direction in one steady, smooth motion. **Do not stop in one place.** Go over each area 3-4 times to make sure you get all the hair.

- Keep the blue guide light steady. If it flickers, you may be going too slow, adjust your speed accordingly.
- DO NOT press on any buttons while you glide. no!no! will do the work for you

***The red light will turn on if you are not gliding properly. Simply restart your no!no! and let the blue light guide you.**

■ Buff - the Finishing Touch

After you no!no!, there will be coarse stubble-like hair left behind and it is essential that you Buff. Hold the Buffer by the flaps and firmly rub in a circular or back-and-forth motion over the treated area.

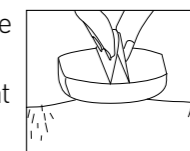

See no!no! in action!
Go to www.howtonono.com
for helpful hints, videos and more.

■ Important Note:

Do not be alarmed when the number of bars changes on the Status Screen. When you first start to Glide, the Status Screen will automatically switch the Treatment Level display (1) to the Thermicon™ Tip display (2). Check the icon to determine what information is being displayed.

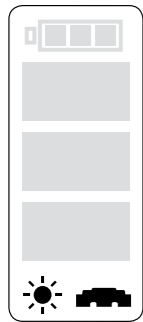

1 2

The Status Screen

Thermicon™ Tip Status

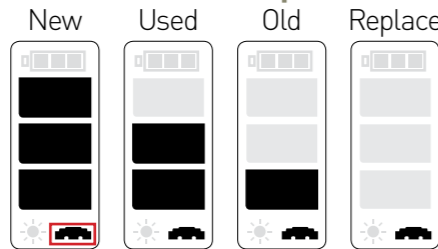

Replace your Thermicon™ Tip...

- When there are no status bars left
- When the tip icon flickers
- If the tip is no longer working efficiently
- If the wire is damaged in any way

Top of Screen – the battery

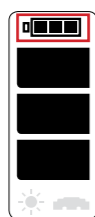

Battery Status

Full Charge

Partial Charge

Low Charge

Charge immediately

- After the 5 hour initial charge, charge your no!no! as needed. When charging is complete, the full battery icon will flicker until you disconnect the charger.

Treatment Level Status

See section 2. no!no!, Adjust the Treatment Level for a complete explanation.

no!no! Helpful Hints

- Hair should be between 1-3 mm, about stubble length, for best treatment.
- Make sure your skin is clean and dry before use.
- If the no!no! doesn't turn on, press the on/off button down for at least 5 seconds. If it still doesn't turn on, check the battery status, it may need to be charged.
- You will need to go over an area more than once – but don't over do it, 3-4 passes is enough. If there is more hair left, wait a few minutes and return to that area if necessary.
- The burnt hair smell means your no!no! is working properly. You can use an aromatic candle or other air fresheners to help mask the smell.
- On concave, folded or loose skinned areas, stretch the skin and make sure it is as straight as possible to avoid cuts and burns.
- Follow the natural curve of the body when working on rounded, curved areas like the knees, elbows and underarms
- IMPORTANT! Buff after you no!no! for a smooth, polished look and feel.
- Use a moisturizing lotion like no!no! Smooth After Treatment Cream after you no!no!
- Keep your Thermicon™ Tip clean! Clean by using the no!no! cleaning brush.

Treating Facial Hair

Your face is very sensitive. Take a few minutes and read these important tips for the safest, most effective treatment. And remember, **If there is any discomfort – STOP.**

■ Test

Before you begin, use the instructions below and treat a small, discreet section of your face to see how your skin reacts to a no!no! facial hair treatment. Remember to always start with the lowest treatment level and work your way up.

If there is any discomfort – STOP.

■ Upper Lip and Mustache Area

When treating the upper lip area – start under the nose and work your way outwards – be careful not to touch your lips or let your skin bunch up into the tip – hold the skin tight and/or purse your lips inward to create a straight, smooth surface.

DO NOT allow your lips to come in contact with the Thermicon™ wire.

DO NOT go over one place excessively.

If there is any discomfort – STOP.

■ Chin & Jaw Line

Working from just below the jaw or chin line, glide your no!no! up and around the curve.

If you need to, pull skin straight and/or purse your lips inward to give your chin and jaw a straighter, smoother line.

If there is any discomfort – STOP.

■ Sideburns

Start at the base of the chin and glide upwards following the curve of your face. If you need to, pull your skin tight and straight for a flat, smooth working surface.

If there is any discomfort – STOP.

■ Important Note:

The area just below the eye and around the eyelid is especially sensitive. **DO NOT** treat this area.

Safety Instructions

READ ALL INSTRUCTIONS BEFORE USE. ALL WARNINGS AND CAUTIONS SHOULD BE STRICTLY FOLLOWED.

WARNINGS – to reduce the risk of burns or injury

Do not use this device on the genitals or nipples. • Do not use this device on the sensitive skin around the eyes, especially the area under the eyes. • Do not use this appliance on sunburned skin, open cuts, bruises, blisters, moles or on raised areas such as scars. • If you have any skin condition other than those listed above, like cold sores, please consult your physician before using this device. • Keep out of reach of children. • Do not use deodorants, lubricants, liquids, creams, gels, water, before use. • Do not allow the thermodynamic wire to touch your skin. • Only use this device for its intended purpose as described in this manual.

CAUTIONS - to reduce the risk of fire, electric shock, etc.

Do not reach for a device that has fallen into water while it is plugged in. Unplug the charger before removing it from the water. • Do not place or store device near a sink or bathtub. • This device should never be left unattended when plugged in. • Do not use the Thermicon™ Tip if the wire is bent or damaged in any way. • Turn off the device while changing the Thermicon™ Tip. • Do not use the charger if the cord or plug is damaged in any way. • Do not use this device near or rest it on flammable objects such as paper, cloth, etc. • Always unplug the power cord from the electrical outlet immediately after charging or use and before cleaning or maintenance. • Do not place this device near water or other liquids. • This device should only be used with the supplied charger. • Always turn off this device when you have finished working with it. • Do not open the outer casing of the device. This might harm the device and it will void any warranty.

Technical Specifications:

Weight: 104gr
Physical Dimensions:
120 X 40 X 15mm
(4.7 X 1.6 X 0.6 in)
Mode of Operation:
Continuous

Operating Conditions:

Temperature: 5° C-30° C
Humidity: 30%-80% RH
Power Supply/Battery
Charger Rating:
Input 100-240VAC/50-60Hz.
0.2A Output 8.4VDC 0.5A

Transport and Storage

Temperature: -20° C to 80° C
Humidity: 05-95% RH
Atmospheric pressure: 0.1-1.5 atm.

Electrical Safety:

Power Supply: Class II equipment – double insulation
This appliance is not suitable for use in the presence of flammable anesthetic mixture with air or with Oxygen or Nitrous Oxide.

The Quality Management System of Radiancy Ltd. complies with the Quality Management Standard ISO 13485. no!no! complies with IEC 60335 and with Low Voltage Directive (Electric Safety) LVD: 2006/95/EC
Design and technical specifications are subject to change without notice.

Manufacturer:

Radiancy Israel Ltd.
5 Hanagar Street
45240 Hod Hasharon
Israel

EC Representative:

Obelis S.A Av.de Tervuren 34 Bte. 44 B-1040 Brussels,
BELGIUM Tel: 32 (0) 2 732 59 54 Fax: 32 (0) 2 732 60 03
GSM: 07545 46 60 Email: mail@obelis.net

Quick Start User Manual

Your 10 minute guide to no!no!

Model 8800

Please go to

www.howtonono.com

or read the full user manual in your
PC computer before using no!no!

To check out no!no! FAQs
and other information go to
www.my-no-no.com