

# Mini Tracker 505 User Manual

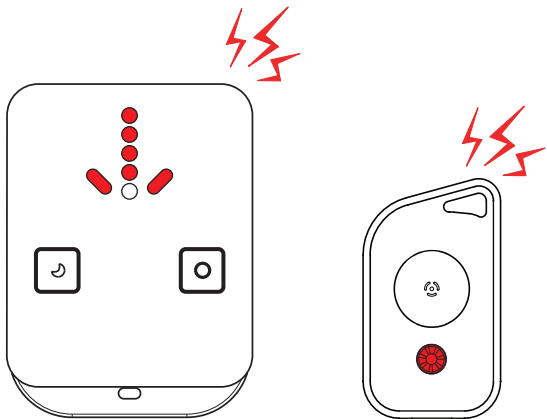



# Warning

- (a) Keep the device dry. Precipitation, humidity, and all types of liquids or moisture can contain minerals that will corrode electronic circuits. If your device does get wet, remove the battery, and allow the device to dry completely before replacing it.
- (b) Do not use or store the device in dusty, dirty areas. Its moving parts and electronic components can be damaged.
- (c) Do not store the device in hot areas. High temperatures can shorten the life of electronic devices, damage batteries, and warp or melt certain plastics.
- (d) Do not store the device in cold areas. When the device returns to its normal temperature, moisture can form inside the device and damage electronic circuit boards.
- (e) Do not put Master and Slave at same place in case of this set is unable playing functions to guard your valued goods.
- (f) This product only assists to provide the warning alarm for reminding the user. It does not guarantee to prevent steal or rob by personal safety and property if any urgent need. This product does not guarantee any damage of personal safety, property, material or the information loss, or other related loss.
- (g) We reserve the right in changing the specification of the hardware and software designs to manuals at any time and without prior notice. Information in this document is subject to change without notice.
- (h) This product operational temperature is between 0 °C ~ +55 °C. Storage temperature is between -10 °C ~ +60 °C.

Warning: Do not put the battery into the fire or heat resource. It will be cause dangerous or even explosion.



# Caution

- (a) Do not attempt to open the device other than instructed in this guide.
- (b) Do not drop, knock, or shake the device. Rough handling can break internal circuit boards and fine mechanics.
- (c) Do not use harsh chemicals, cleaning solvents, or strong detergents to clean the device.
- (d) Do not paint the device. Paint can clog the moving parts and prevent proper operation.

## ◆ Care and Maintenance

- (e) The working range, alarm range, searching and detection are depends the terrain environment because of radio wave efficiency.
- (f) If the beeps sound are not loud enough, it may means the battery low. Change new battery for louder alarm sound.
- (g) If you want to apply this product during the flight trip, please comply with the flight safety law according to each country.



Recycle: The Battery provided in this product should be recycled to protect the local environment. Please contact with local recycle department for detail.

## FCC Certifications

### Federal Communication Commission Interference Statement

This equipment has been tested and improved to comply with the limits of a Class B digital device, pursuant to Part 15 of the FCC Rules. These limits are designed to provide reasonable protection against harmful interference in a residential installation. This equipment generates, uses and can radiate radio frequency energy, if installed and used not in accordance with the instructions, may cause harmful interference to radio communications. However, there is no guarantee that interference will not occur in a particular installation. If this equipment does cause harmful interference to radio or television reception, which can be determined by turning the equipment off and on, the user is encouraged to try to correct the interference by one of the following measures:

- Reorient or relocate the receiving antenna.
- Increase the separation between the equipment and receiver.
- Connect the equipment into an outlet on a circuit different from that to which the receiver is connected.
- Consult the dealer or an experienced radio/TV technician for help.

This device complies with Part 15 of the FCC Rules. Operation is subject to the following two conditions:

(1) This device may not cause harmful interference, and (2) this device must accept an interference received, including interference that may cause undesired operation.

**FCC Caution:** Any changes or modifications are not expressly approved by the party responsible for compliance which could void the user's authority to operate this equipment.

FCC ID Master: WMPM05A01

Slave: WMPS05A01

EU Declaration Conformity

This product is carrying the CE-Mark in accordance with the related European Directives.

## Master

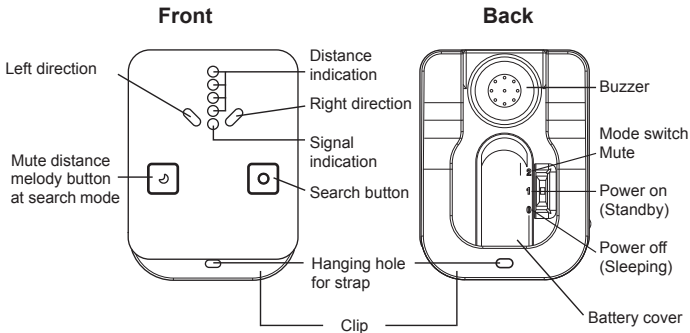

## Slave

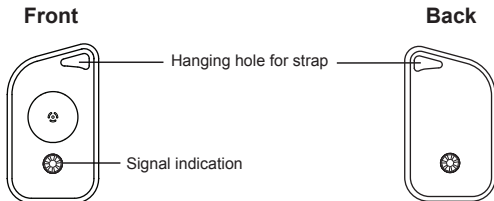

## ◆ Working Method

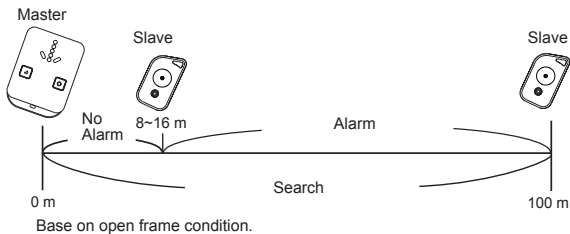

## ◆ Specification



	Master	Slave
Size	39×48×6.8 mm	19×28×7.5 mm
Frequency	2.4GHz ISM	2.4GHz ISM
Battery	LR 44 × 2	LR 1130 × 2
Switch	ON / OFF / MUTE	
Button	2 buttons	



## ◆ The Battery Installment

### Master

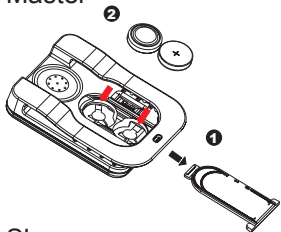

1. Press the clip on battery cover then push backwardly.
2. Put 2pcs batteries into.  
\*\*\* Make sure the installment direction of positive (+) & negative (-) of battery are followed up the drawing showed on battery cover.
3. Set the battery cover back.

### Slave



1. Open from the fillister on the bottom of housing or curve side by your nail, like open shell.

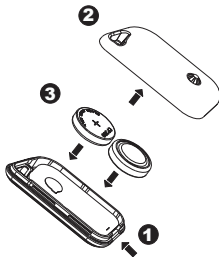

2. Put 2pcs batteries into.  
\*\*\* Make sure the installment direction of positive (+) & negative (-) of battery are followed up the drawing showed on the inside of back battery cover.
3. Set back the battery cover.

## ◆ Getting Started

For the first time use, please set the battery into Master according to above battery installment .

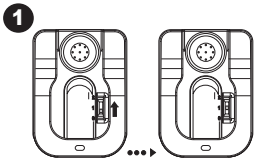

Switch to power on

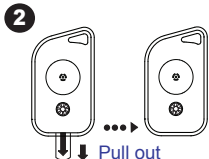

Plastic isolation

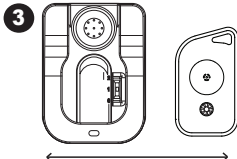

Place two devices no more than 10 cm apart.

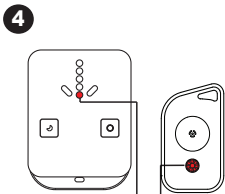

Signal indication

Signal LED ON for re-linking.

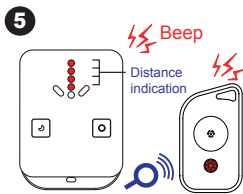

Re-link successful!  
Master shows the distance with Slave via LED and melody (beep).  
Press Search button to stop melody.



1

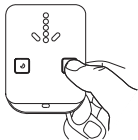

Press Search button  
2~3 seconds

2

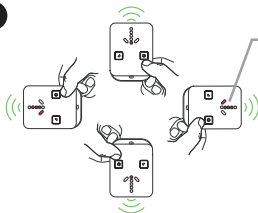

Start to detect the location  
of Slave.



- 1.) LED light: more closer, more lights.
- 2.) Search melody: more closer, more rapid.



Correct  
holding

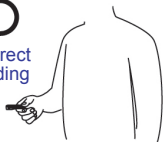

Wrong holding

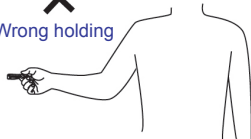

Error indication - whole direction LED goes off but signal LED lights up 3 seconds then displays new searched distance.

- 1.) Search from correct direction to wrong direction
- 2.) Over pass



2 — 1

Turn to different directions  
for signal comparison

One Distance  
LED only

East

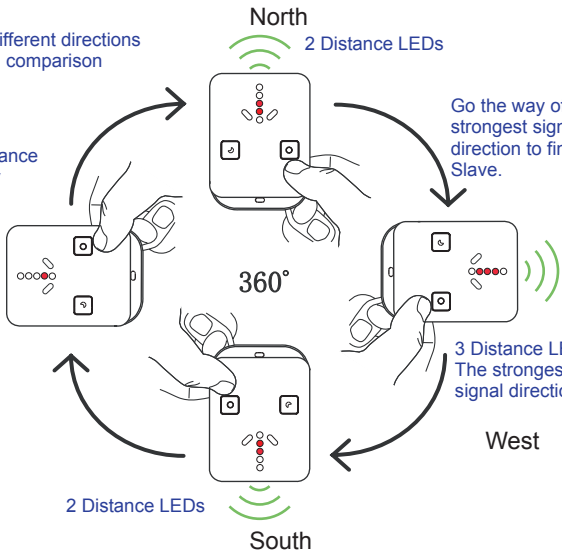

2 — 2

Mute searching melody from Master. Listen beep sound from Slave to assist short range searching.

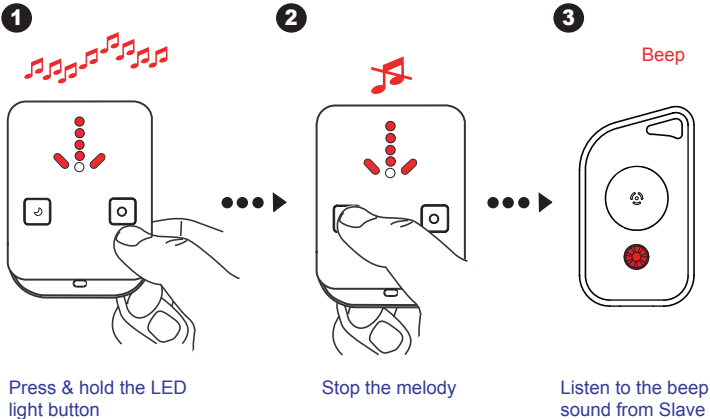

3

Stop  
searching

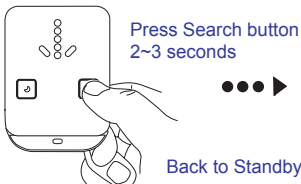

Back to Standby mode

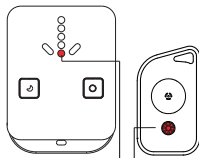

Signal LED flashes every  
second for re-linking



Error indication - whole direction LED goes off but  
signal LED lights up 3 seconds then displays new  
searched distance.

- 1.) Search from correct direction to wrong direction
- 2.) Over pass

## ◆ Searching Example

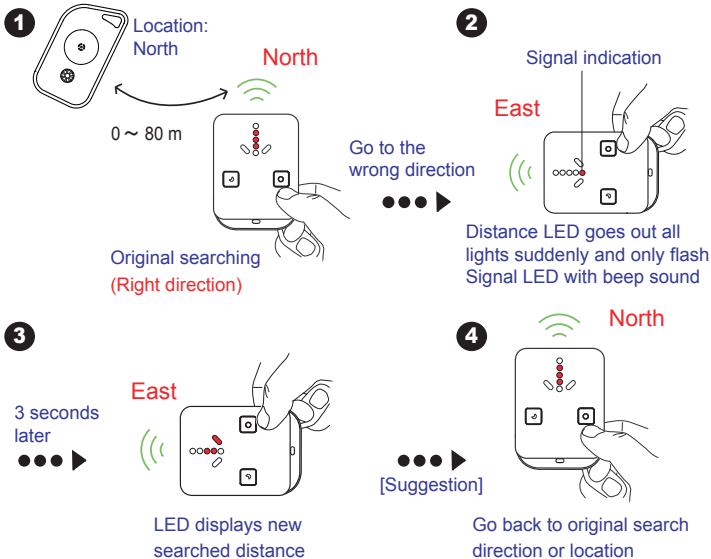

# Alarm

1

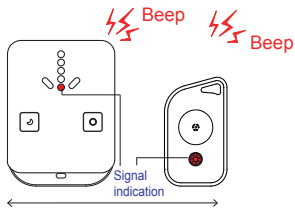

Over 8~16 meter.  
Come with beep!

2

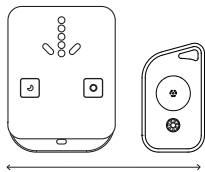

Stop alarm (beep) if both devices  
comes within 8 meter again.



Caution

When Slave and Master are over 100  
meter or lose signal

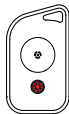

Slave flashes half minute to  
wait for re-linking

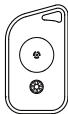

No linking then into sleeping  
mode and stop flash

## ◆ Sleeping

### 1 Switch to sleeping mode

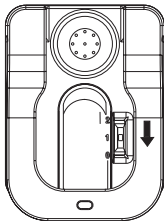

Under Standby mode

Switch the button to  
section 0 (OFF)

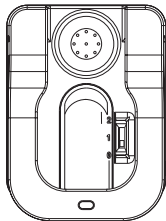

Stop signal to Slave

### 2 Slave flashes half minute to wait for re-linking

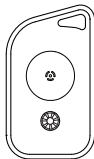
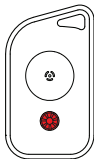

No linking then into sleeping mode and stop flash

## ◆ Re-link / Wake up

1

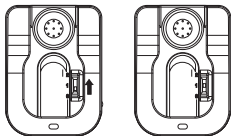

Switch the button to section 1 (ON)

2

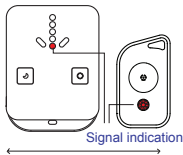

Signal LED ON for re-linking  
Available for distance within 80 meter

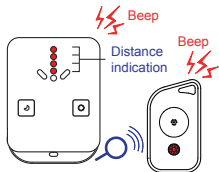

Re-link successful!  
Master shows the distance between Slave via LED and melody (beep)

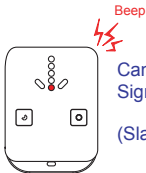

Can't get signal from Slave.  
Signal LED flashes each second & comes with beep.

(Slave maybe out of working range 100 meter, or no power.)

## ◆ Mute

### Mute (Mute At Search mode, Or No Need The Guard Service)

- 1 Switch to Mute mode

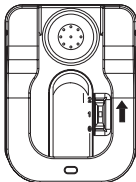

Under Standby mode

- 2

Switch the button to section 2 (MUTE)

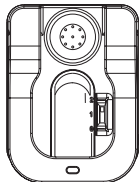

- 3 Press Search button



Only Display the distance indication LED without searching melody



Under mute mode, the Alarm function is disabled.



## ◆ Low Battery

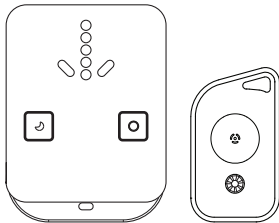

1 beep sound every 120 seconds continuously.



If this kit is under low battery stage, it may cause abnormal display to alarm, beeps or non-working to confuse actual working stage.

Please change new battery as soon as possible.

## ◆ Suggested setting place



Correct holding

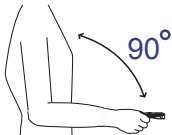

Wrong holding

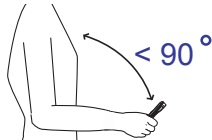

Correct holding

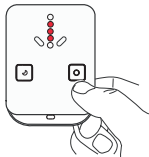

Wrong holding

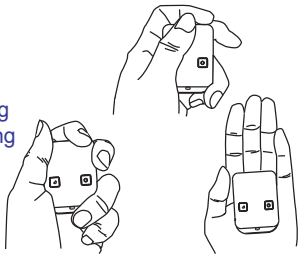

\*\*\* Do not cover the top side of Master.

## ◆ Suggested setting place

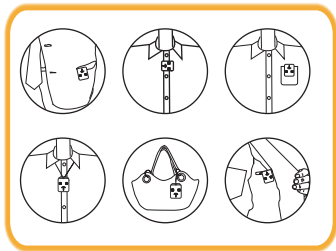

Master

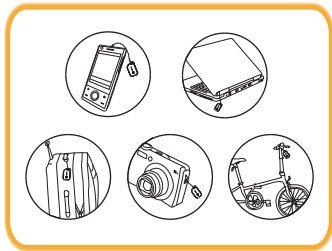
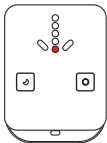

Slave

