



KORYOTM



USER'S MANUAL



KVC 120
Turbo Clean
VACUUM CLEANER
1200W
High Power

Dear Customer,

Congratulations! Thank you for buying this KORYO appliance. Your new Vacuum Cleaner has been designed for your convenience. We are sure you will get many years of trouble free service from this appliance.

Before commissioning this device please read this user manual carefully. Please retain this user manual, warranty certificate, sales receipt and if possible carton with the inner packaging.

CONTENTS

Safety Instructions	3
Parts Name.....	3
Operation Method.....	4
Filter Cleaning.....	6
E-Waste Disposal	6
Warranty	7

SAFETY INSTRUCTIONS

Read all the safety instructions before you use your vacuum cleaner

Power Source

- You should only plug your Vacuum Cleaner into a 230V, 50Hz, AC supply

Using your Vacuum

- For safety reasons you should not vacuum wet surfaces, pick up wet objects or use in wet conditions.
- Do not use the vacuum cleaner to pick up burning objects as this is fire risky
- Do not pick up hot objects such as coal and ashes.
- Do not use the vacuum cleaner to pick up large objects that are likely to cause damage.
- Do not run over the main table with your vacuum cleaner. Do not use with damage cord.
- Use only for domestic use. Industrial or commercial use invalidates the warranty.
- Most new carpets have a breaking in period in which only light vacuuming is recommended.
- Do not let children use the vacuum. Keep hair, loose clothing, fingers, feet and body parts away from openings or moving parts.
- Do not use without filters in place.
- To remove your vacuum cleaner from room to room, unplug the unit and carry using the carry handle.
- Never pull the vacuum cleaner by its cord or the flexible hose when moving.

Servicing and Maintenance

- Ensure you replace the filters when necessary.
- Always empty the dust when indicated on the vacuum cleaner.
- The plug of the power cord must be removed from the wall socket before changing the filters, cleaning the appliance or undertaking any maintenance operations.
- If the power cord becomes damaged, do not use the vacuum cleaner, it must be replaced by an authorized service agent.

PARTS NAME

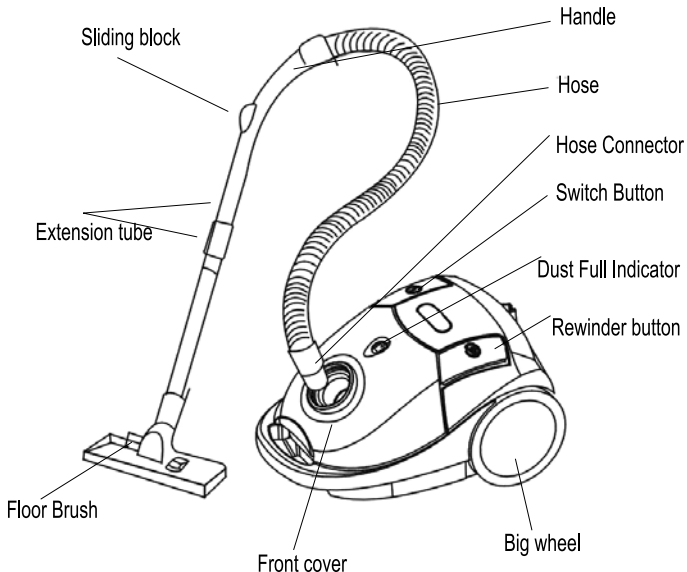



Floor brush
For carpet and wooden floor etc.

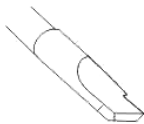

Crevice nozzle
For corners, cracks, etc.



Bristle brush
For sofa, bookshelf, curtain and furniture etc.

DUST BAG

- The bag full indicator will automatically change to red when the dust bag is full or when the tube is blocked. The bag should be changed and / or blockage should be removed from the hose or tubes to prevent the vacuum from overloading and causing damage.

To change the dust bag

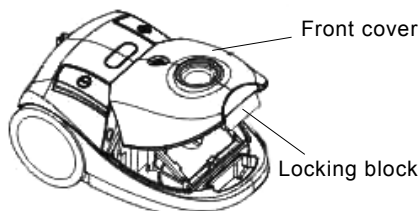

Press the locking block to open the front cover

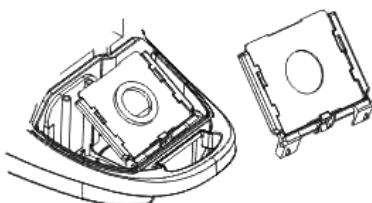

Take out the dust bag holder
Take out the dust bag



Paper dust bag can't be reused; cloth bag can be re used after cleaning.
Attention: The opening of the cloth bag must be completely closed by the clip.

OPERATION METHOD

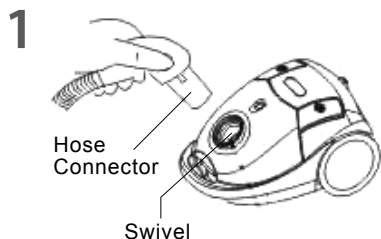

Insert the Hose connector into the swivel of the vacuum cleaner.

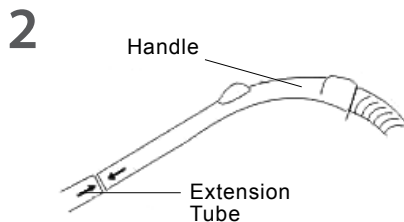

Insert the handle into the tube with a twisting force

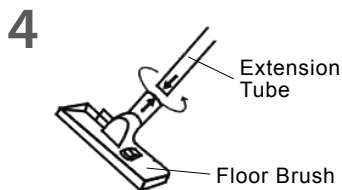
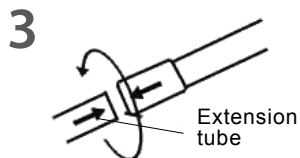

5

Cable
rewinder
button

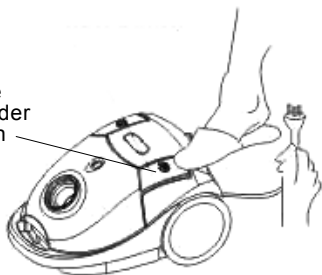

(1) Pull out the cord as long as you need but do not exceed the mark of red & yellow.

(2) Hold the plug when rewinding, you can press the button with your foot to retract the cable into the machine.

6

Switch

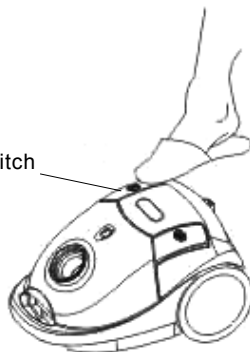

Press the switch button to turn ON / OFF the cleaner

7

Sliding block

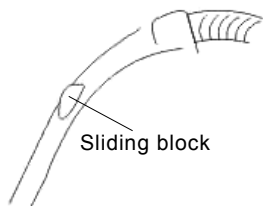

You can adjust the inflow by pushing the sliding block up and down.

8

Dust full indicator

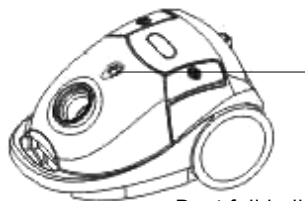

If the red buoy of the dust indicator moves into the middle of the small window, please check, if

- (A) The dust bag has been full or
- (B) somewhere has been locked up.

(A) Replace or clean the dust bag.

(B) Please solve it as soon as possible.

9

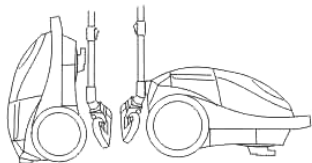

Standing position : Put the fixing block into the hole on the body.

FILTER CLEANING

The filter should be removed and rinsed twice a year or whenever it is visibly clogged. Always operate the unit with the filter installed or damage may occur to the unit.

1

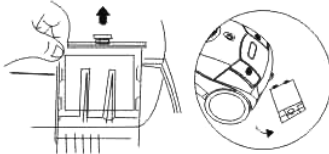

Remove the filters

2

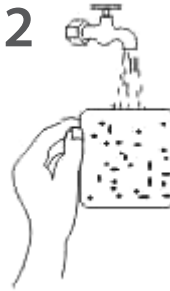

Hand wash in cool soapy water, rinse thoroughly under running water to remove all particles and soap.

3

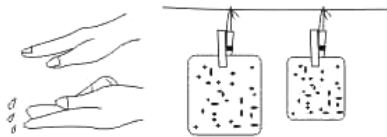

Allow to dry naturally

4

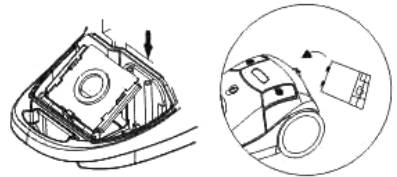

Replace filters when dry, Do not machine wash the filter and do not attempt to dry using any kind of heated appliance.

E-WASTE DISPOSAL



This symbol on the product or on the container indicates that this product cannot be eliminated with the general waste. The user is responsible for eliminating this kind of waste by throwing them away at a "recycling point" specifically for electrical and electronic waste. Selective collection and electrical equipment recycling contribute to preserve natural resources and warrant waste recycling to protect environment and health. In order to receive further information about electrical and electronic waste collecting and recycling, contact your Local Council, the service of household waste or the establishment where the product was acquired.

WARRANTY

This product comes with a warranty of 12 months from the date of purchase as specified on the warranty card. This is against all defective material or workmanship. In the event of a defect, Future Retail Limited or KORYO Authorized Service Centre undertakes to repair the set, free of charge, during the warranty period.

In the event of a defect developing in the product, contact KORYO Customer Care or KORYO Authorized Service Centre and provide information about the defect, the model number and serial number of the product.

THIS WARRANTY IS VOID IF

1. The completely filled warranty card is not presented to the authorised personnel at the time of servicing of the product.
2. The product is not operated according to the instructions given in the user manual.
3. Defects are caused by improper or reckless use.
4. Modifications or alterations have been made to the product or if the product has been tampered with, in any manner whatsoever.
5. Repairs to the product are carried out by anyone other than an authorised company representative.
6. For defects other than faulty parts or workmanship such as damage due to lightning, abnormal voltage, spillages, dust, accidental damage, etc.
7. The serial number is deleted or altered.
8. Used for any non-domestic purpose.

OTHER TERMS AND CONDITIONS

1. Repairs or replacement will be carried out either by a Future Retail Limited authorised customer care centre or by a representative.
2. All expenses incurred in collecting the unit(s) or part(s) thereof from the Customer Service Centre, as well as any other expenses and incidentals will be borne by the customer.
3. Whilst the company will make every effort to carry out repairs at the earliest, it is made expressly clear that the company is under no obligation to do so in a specified period of time.
4. The company or its authorised customer centre reserves the right to retain any part(s) or component(s) replaced at its discretion, in the event of a defect being noticed in the equipment during the warranty

WARRANTY CARD

THIS CARD IS VALID ONLY IF IT IS FILLED IN COMPLETELY,
SIGNED AND STAMPED BY THE DEALER ON DATE OF PURCHASE

MODEL NO : _____ SERIAL NO : _____

CUSTOMER NAME : _____

ADDRESS : _____

PHONE NO : RESIDENCE : _____ OFFICE : _____

INVOICE/CASH BILL NO : _____

DEALER'S STAMP

DATE OF PURCHASE : _____

CUSTOMER SIGNATURE : _____

* For service request kindly contact Customer Care Centre at : 1800-425-7722, 080-26577722

* Please mail in queries to feedback@koryoworld.com



Also Available

Chopper	Food Steamer	Juicer Mixer Grinder
Slow Juicer	Dry Iron	Geyser
Microwave Oven	Split Air Conditioners	Electric Cooker
Hair Dryer	Mixer Grinder	Stabilizer
Electric Kettle	Hand Blender	Oven Toaster Griller
Steam Iron	Electric Pressure Cooker	Immersion Heater
Pop-Up Toaster	Vacuum Cleaner	Emergency Light
Induction Cook-Top	Room Heater	Washing Machine
Fan	Juice Extractor	Sandwich Maker
Window Air Conditioners		



Imported by:

Future Retail Limited

Tower C, 9th Floor, 247 Park, L.B.S. Marg, Vikhroli (West),
Mumbai - 400 083, Maharashtra, India.