

User Manual



MOCCA BTB

Your retail dealer

U_EN

Rev. 090821

1.	Table of contents	page.	2
2.	General		3
3.	Overview of the components, front.		4
3.	Overview of the components, mixer system.		5
4.	Installation and start		6-7
	Safety instructions for grinder		7
5.	Operation;		
	Brewing of coffee in cup		8
	Hot water		8
	Brewing of jug		9
6.	Cleaning program		
	Automatic cleaning of In/Outlet valves		10
	Rotate brew mechanism without water or ingredients		11
	Automatic cleaning of brew mechanism, mixing bowl		12 - 13
7.	Cleaning and maintenance		14
	Inspection of Grinder		14
	Cleaning and dismantling of coffee filter		15
8.	Cup counter and Easy access		16
9.	Safety functions		17
10.	Failure messages		17
11.	Storage and transportation		17
12.	Installation of coin mechanism		18
13.	Circuit diagram		19

We congratulate to your choice of a Mocca BTB.

Please read this manual before you take the machine into operation for the first time.

The manual contains important instructions for a safe and proper use of the machine.

Always keep this manual within reach for the user!

All electrical installations must be done by a qualified electrician and within safety regulations that applies for each country where the appliance are installed.

All installations must be done by a qualified person.

Mocca BTB

- Making freshly coffee cup by cup
- Internal grinder for grinding of coffee beans
- Jug facility with key switch
- Brewing mechanism with coffee filter
- Electronically temperature controlled
- Adjustable coffee strength
- Illuminated cup while brewing

Facts:

Height + bean container	790 mm
Width	270 mm
Depth	530 mm
Weight	16 kg
Tank volume	2.0 litre
Electricity:	230V/2200W
Water connection:	½" outside thread
Capacity:	200 cups / filling

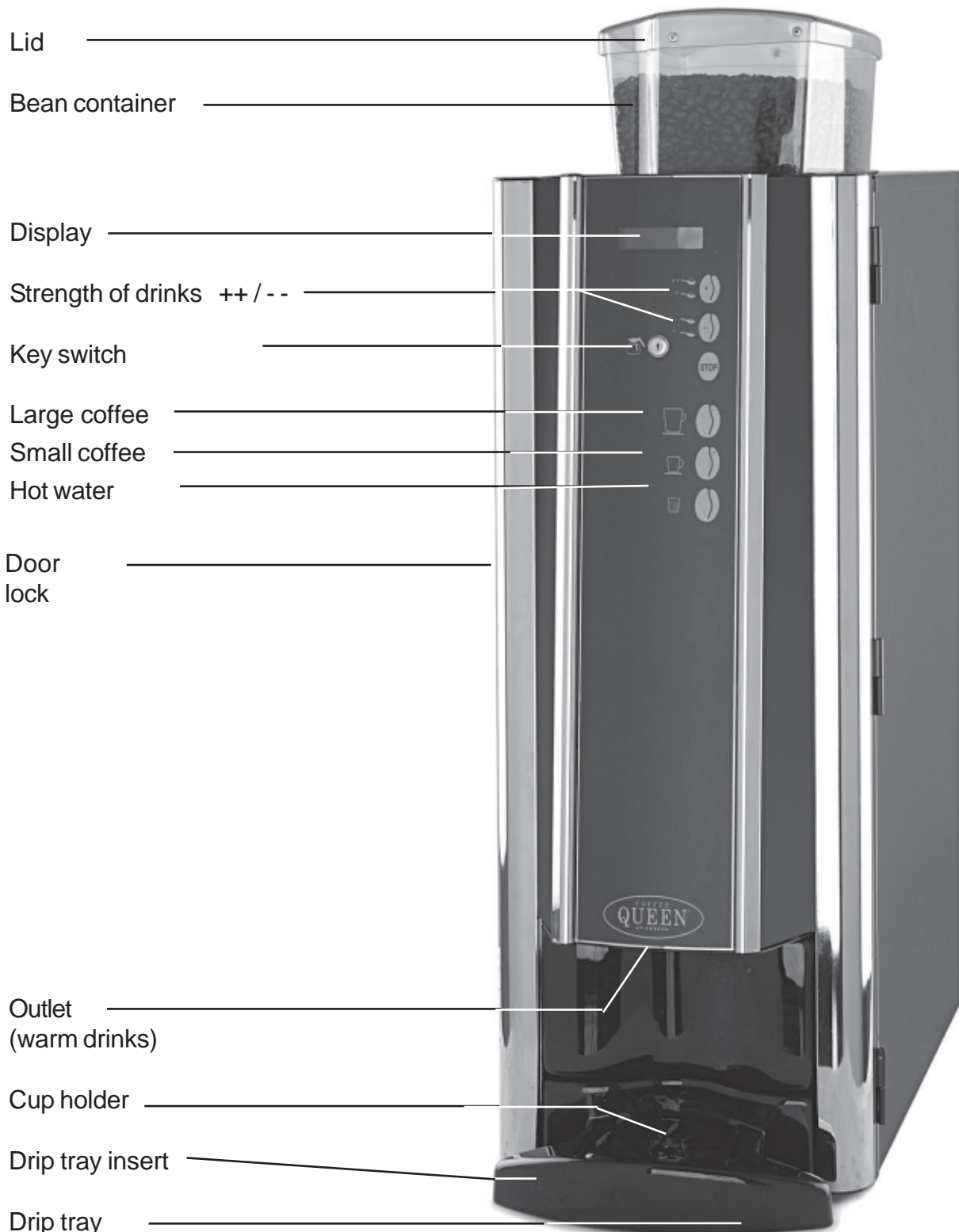

Options:

Base cabinet
with waste box

3. Overview of components, mixing system.

MOCCA BTB

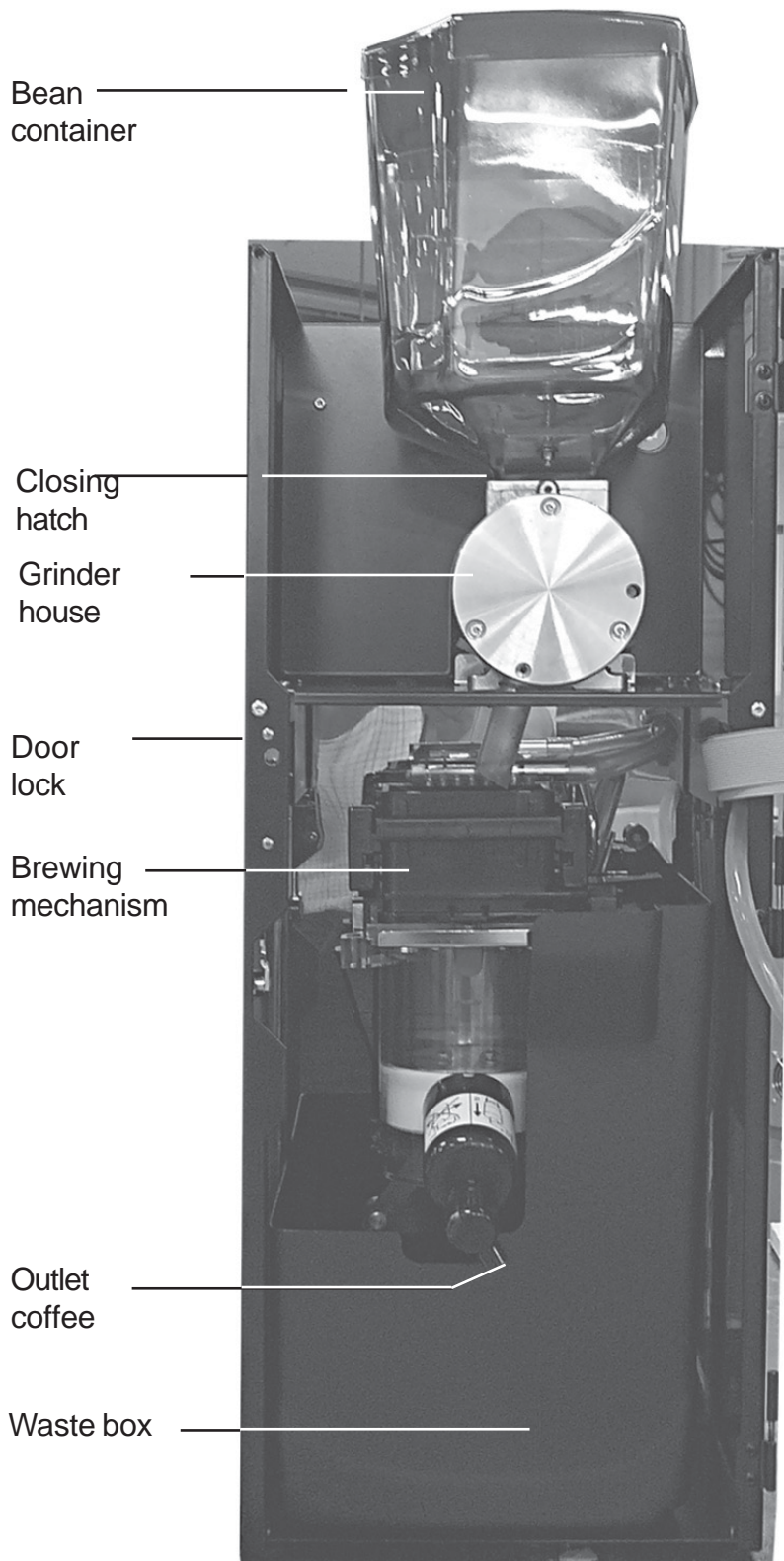

Fuse holder

ON/OFF switch



Outlet hot water

Detail;	Ingredients;	Width;	Height;	Amount/unit
Canister;	Coffee beans	165	190	1

1. Place the brewer on a flat level and waterproof surface.



Connect the electrical plug to a separate grounded wall socket



90°

OBSERVE!

Make sure there is a space behind the machine for free flow of air.(minimum 10cm).

2. Connect attached water tube to cold water with an R 1/2".
Make sure that the water hose not are kinked anywhere when machine is pushed into place.
Please flush the water tube before connecting to machine, this to avoid any particles to damage the inlet valve.

3. Open the water inlet.
4. Turn on the ON-OFF switch

Water is been filled into the tank automatically with 2,0 litres of water. The heating will not start before the water level reaches the level sensor.

Set temperature is approx 97°C.



Fuse holder

ON/OFF switch

5. Close door.

6. Fill bean container with coffee beans.

1. Remove lid on bean container and fill bean container with coffee beans without additives (as tasted oils or sugar).
2. Open closing hatch on bean container.



When water in tank have the right temperature the message "low temp" will disappear and the machine is ready to use.

"low temp"

Important! Safety and maintenance of grinder.

Warning! Cleaning of grinder shall be done by qualified personnel only.
Exchange and basic adjustments of the grinder shall be done by an authorized service technician

See service manual: **Maintenance instructions** for grinder.

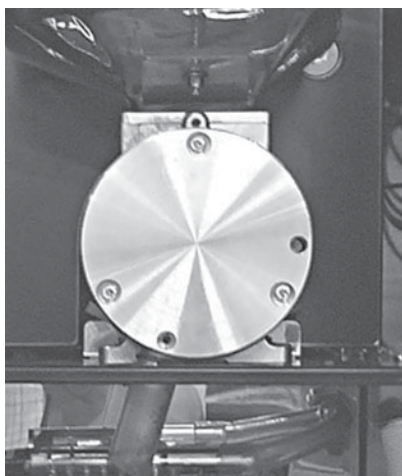

Never put your fingers or objects into the rotating grinding mechanism inside the input-shaft.

NOTE!

Coffee grinder is only constructed to grind coffee beans without additives (as tasted oils or sugar). Any kind of use apart from that is improper and therefore unauthorized, the producer refuses all responsibility for damages arising from improper use of the coffee grinder described in this instruction.

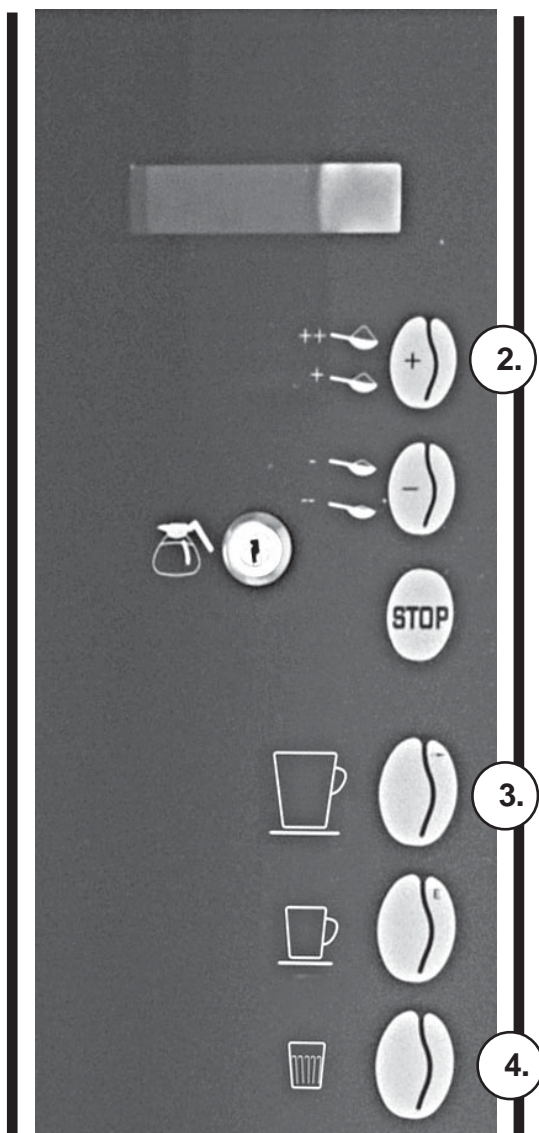

1. Place a cup in the centre of the cup holder.
2. The strength has a standard setting, if you wish to increase or decrease it, do as follows if not continue to point 3.

Stronger drink;
Increase by pushing + or ++ for 5% or 10%
 alternative
Weaker drink;
Decrease by pushing - or -- for 5% or 10%
 (the indication lamp will go up or down depending of choice).

3. Choose drink by pushing on the button of menu. The display will show; "Please wait", and the cup will be illuminated.

Wait until the light on cup and the message "Please wait" has been turned off before you take your cup.

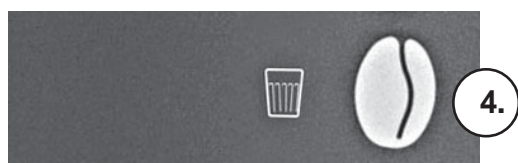

4. Hot water.

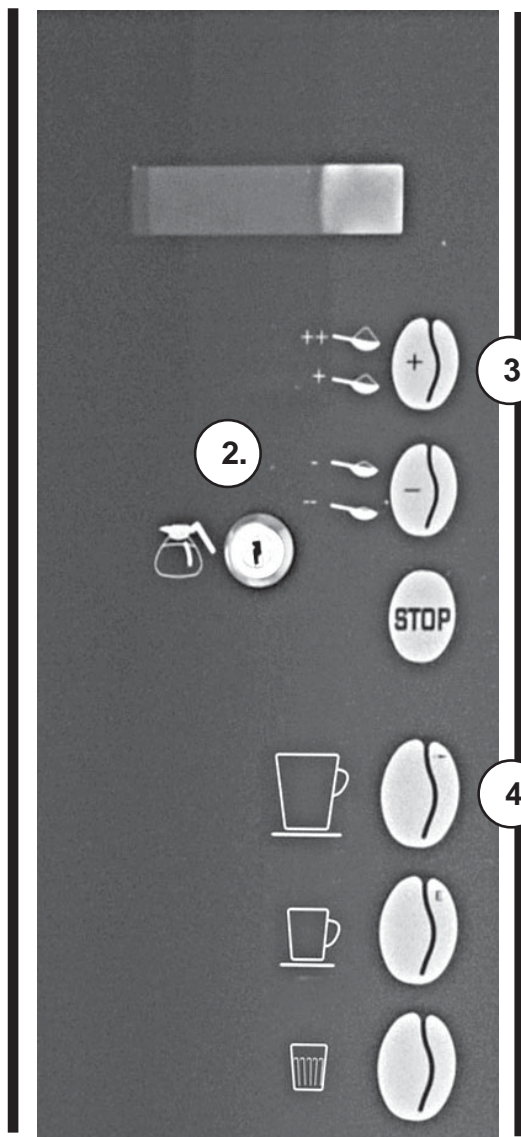

Brewing of jug.

1. Place a jug in the centre of drip tray by lifting up the cupholder.
2. Turn on the key with jug symbol clockwise.
3. 3 cups of brewing is standard setting. Change amount of cups by pushing + or - button. Optional up to 12 cups or down to 1 cup brewing.
4. Push the button for drink 1.

Wait until the light and message "Please wait" has been turned off before you take out the jug.

Automatic cleaning of In/Outlet valves:

The In/Outlet valves can easily be cleaned with the key switch in "cup" (normal) position.

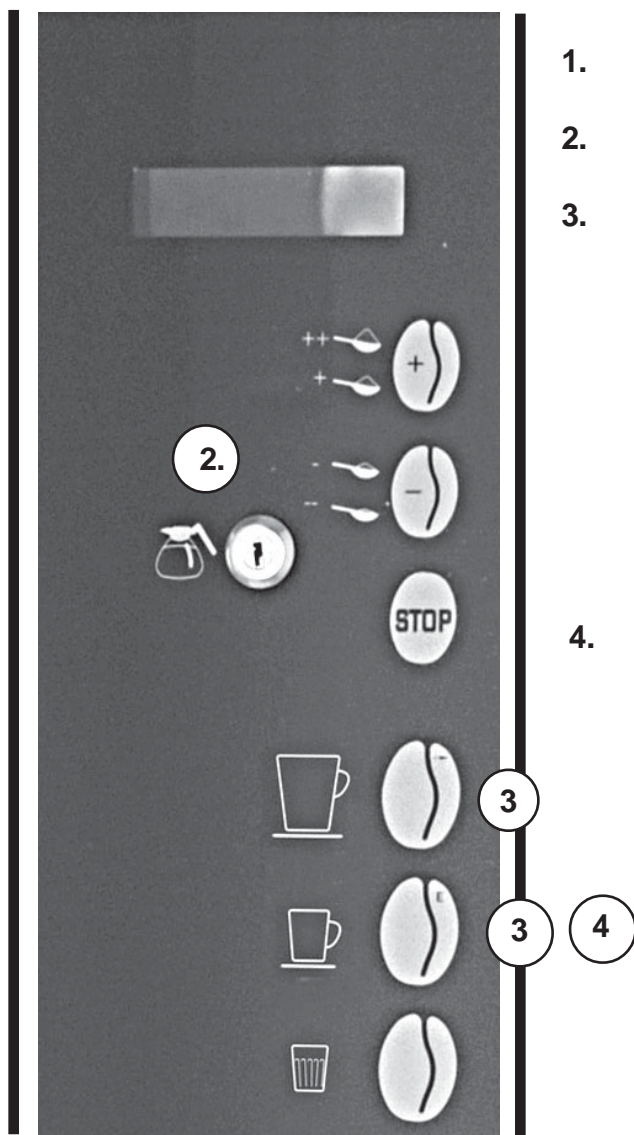

1. Place a jug in the drip tray.
2. Turn the key slowly ninety degrees and back again.
3. Push button for drink 1 and 2 at the same time for 6 seconds.

Keep buttons down.

All In/Outlet valves will now start to open and close with 2 pulses/second in 10 seconds or as long as you hold the buttons.

The display shows: "Cleaning valves".

4. Push button for drink 2 for making a brew cycle and flush remaining water and scale from the cleaning.

By cleaning is meant that valves "knocks" away eventual scale and other particles which has been attached in the cylinders and that they are flushed away with the water.

Rotate brew mechanism without water or ingredients:

The brew mechanism can be rotated without water and ingredients with the key switch in "cup" (normal) position. To be used when brew mechanism has been dismantled for washing and shall be remounted.

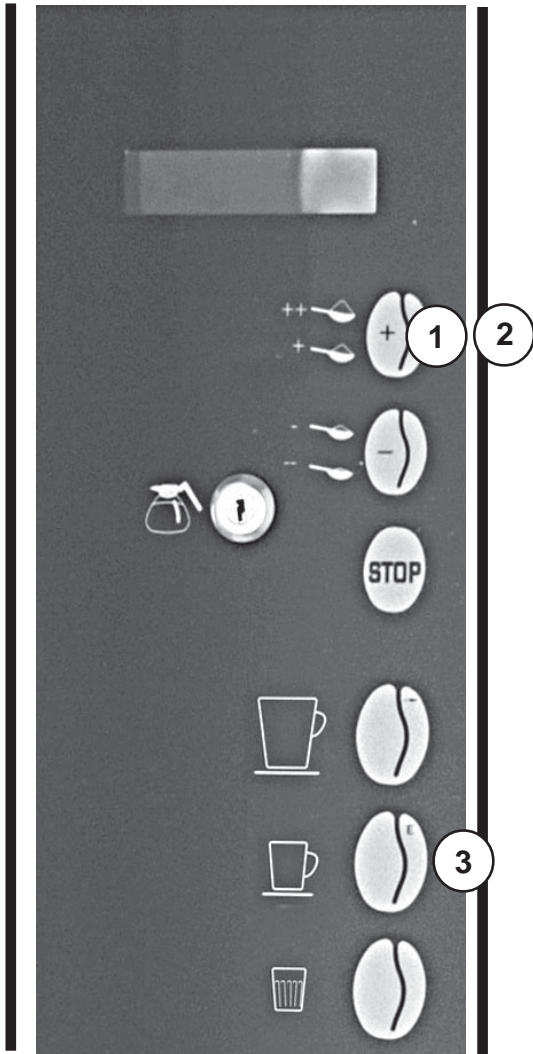

1. **Push "+" button for 6 seconds**
After 4 seconds the signal will go faster.

The display shows: "Change paper/Rotate"
"Push E/ +"

2. **Push + button.**

The display shows: "Rotate cycle without water".

3. Push button for drink 2.
The display shows: "Rotate"

The brew mechanism rotate one turn without water and ingredients and the mechanism falls into position if it has been dismantled.

Observe! The push rod shall be in position "8 o'clock"

If not take out again and repeat the procedure.

Eight (8) o'clock.

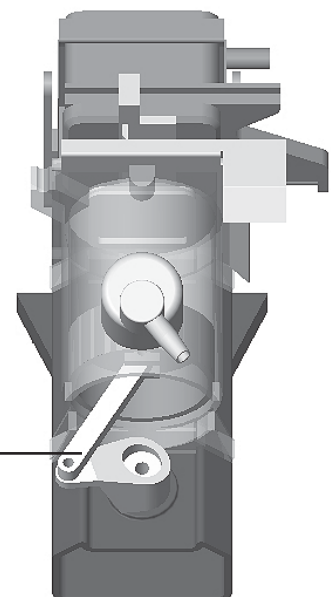

Automatic cleaning of brew mechanism, mixing bowl: Shall been done every week.

The brewmechanism can easily be cleaned with the key switch in "cup" (normal) position.

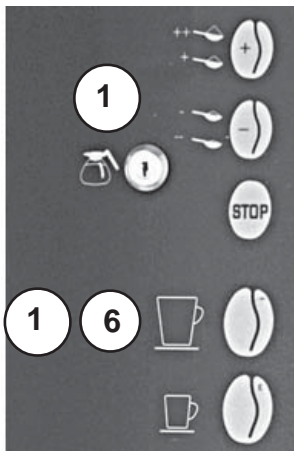

1. Turn the key slowly ninety degrees and back again.
Push button for drink 1 for 6 seconds. Fig. A
2. After 4 seconds the signal will go faster.
3. After 6 seconds **The display shows;** "Open door"
"load detergent".
4. Fill 25gr detergent (one portion bag, see fig. A) into the brew mechanism. fig. B.(Detergent will be supplied from your dealer)
5. **The display shows;** "Close door"
6. **The display shows;** " When ready press key"
Place a jug into the drip tray and push button for drink 1

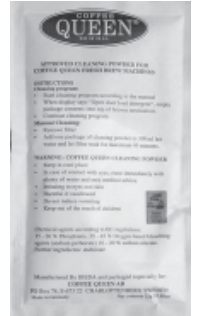
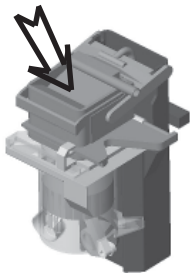

Fig. B



7. **The display shows;** "Cleaning mixer" (2....)
8. **The display shows:** "Rinsing coffee" "Soak time:"
The machine start to count down from 300 seconds.
9. **The display shows.** "Brewer cycle" the machine is counting down.

To stop cleaning process: push "Stop" button.

The brew mechanism will go back to start position.

NOTE! Dont stop the process when detergent has been loaded the cleaning process must be finished.

IMPORTANT! Cleaning of brew house.

After the automatic cleaning program is finished. Clean brew house! This must be done, to make sure that you will remove residual detergents and coffee remains!

Dismantling and cleaning/washing brew house: Do as follow in paragraph 10- 19.



10. **Push "+" button for 6 seconds**
11. The display shows: "Change paper/Rotate" "Push E/ +"
12. Push button for drink 2.
13. The display shows; "Preparing paperload".
14. The machine will rotate in position.
15. The display shows,"Change paper"
16. **Open door, dismantle,** clean and reassemble brew house.
see page 20.
17. Close door.
18. Machine is ready to use again.
19. Take out a cup of coffee and pour it out to make sure that there is nothing left of detergent.

If machine not will go back in start position. Restart machine.

Dismantling and cleaning brew house:

Dismantle brew house:

1.

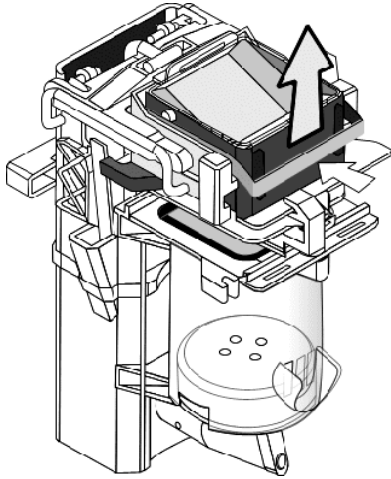

2.

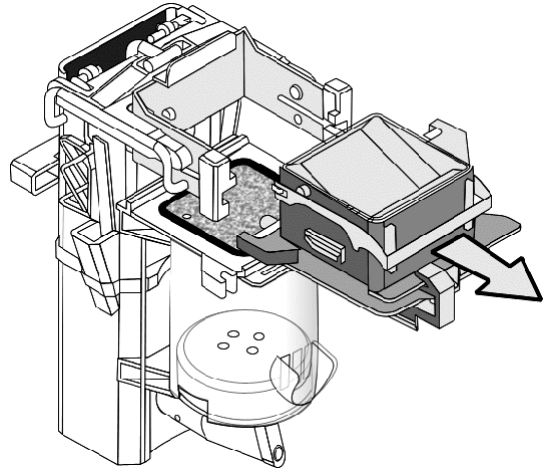

3. Flush brew house!

To remove detergent and coffee remnants.

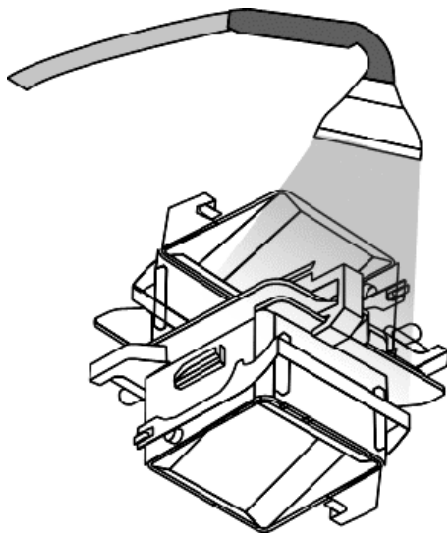

Reassemble brew house.

NOTE! When reassemble brew house make sure that (B) wiper are between (A) arms.

4.

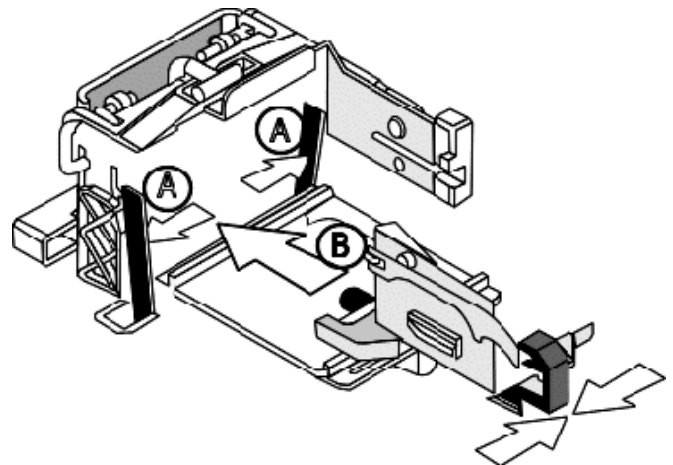

Important! wash carefully

To remove cleaning
and coffee remains

Cleaning when needed.

Outside cleaning; use a soft rag and liquid cleaning agent to prevent scratches.

Grinder:

Visual Inspection every month!

Approximately every month the grinder housing and spout should be inspected for coffee residues and obvious damages. In case of too much coffee residues around the spout, check if the silicone flapper inside the spout is in place.



Cleaning bean container

1. Lock close hatch.
2. Dismantle bean container.

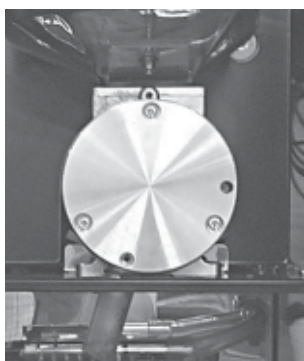

Use a soft rag and liquid cleaning agent to prevent scratches.

Note! Make sure that all parts are dry before use.



Cleaning of parts.

Drip tray and its insert to be washed by hand in ordinary dishwater.

CAUTION! Must not be washed in a dish washing machine!

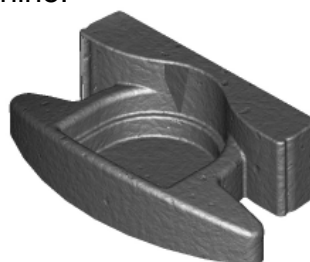

Dismantling and cleaning coffee filter.

A tool dismantling the coffee filter, comes with machine.

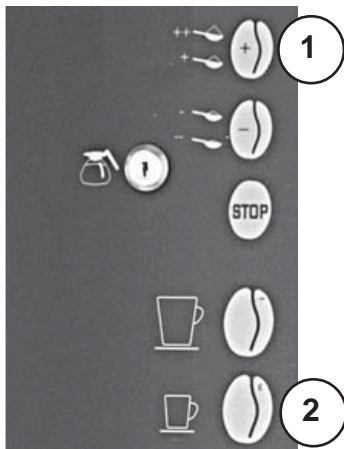

1. Push **"+" button** for 6 seconds.
After 6 seconds the display shows; "Change paper/ Rotate"
"Push E/+".

2. **Push button for drink 2.**

The display shows; "Preparing paperload".

The machine will rotate in position.

When the display shows, "Change paper" open the door and insert the dismantling tool (A) through the brewer spout all the way to the back of the cylinder, then slide it up until contact is made with the screen assembly. Fig. 1.

Push up on the rear of the screen assembly until it pops out of the cylinder. Fig. 2.

3. Soak the screen assembly in a solution of 25gr. cleaning agent in 3dl water for a maximum of 10 minutes. Fig. 3.

Fig. 3.

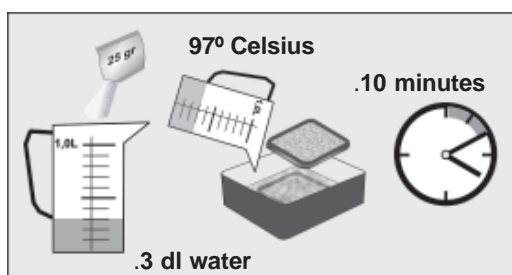

3

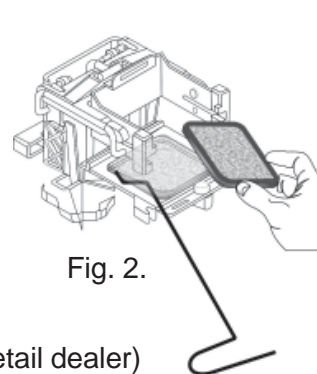
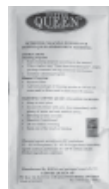

Fig. 2.

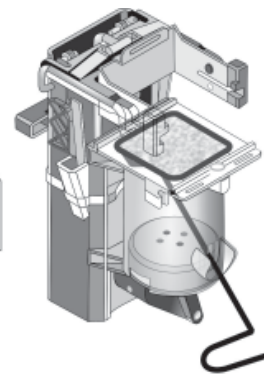

Fig. 1.

(Cleaning agent is supplied by your retail dealer)

(A)

4. Remount the screen assembly and close the door. Then the machine will return to start position and the machine is ready for use.
If machine not will go back in start position. Restart machine!
5. Make a cup of coffee and throw it out.
To make sure that there is nothing left of detergent.

Prolonged contact with cleaning agent may damage the screen assembly. Once this is done, the screen should then be thoroughly rinsed with dish soap and warm water to remove any leftover residue.

Cleaning agent: (brew mechanism)
Filter: (brew mechanism)
Tool: (dismantling filter)

Coffee Queen article no 1104161
Coffee Queen article no 47200213
Coffee Queen article no 4720090

Cup counter:

The machine has a cup counter which is available to see and reset with the key switch in "cup" (normal) position.

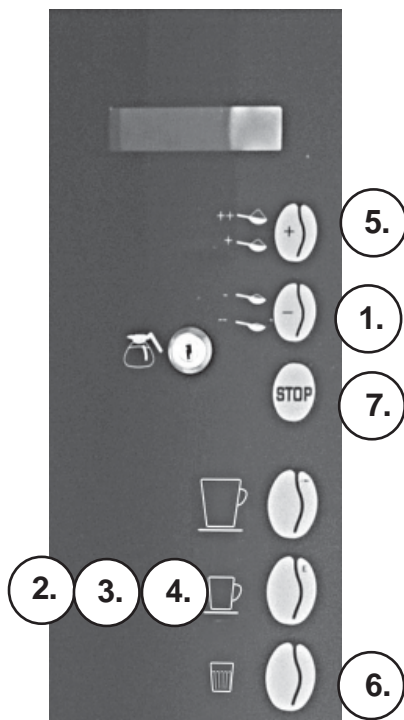

1. **Push "-" button for 6 seconds.**
After 4 seconds the signal will go faster..
The display shows: **"Total xxx cups"**
2. Push button for drink 2.
The display shows: **"Choice 1 free xxx cups"**
3. Push button for drink 2.
The display shows **"Choice 1 coin xxx cups"**
4. Push button for drink 2.
The display shows **"Choice 1 xxx cups in can"**
5. Push "+" button to reach to "choice 2" etc.
6. Push choice 3 to reset the counter.
7. Push "Stop" button to go back to user mode.

Easy Access:

Volume and strength can be adjusted with $\pm 15\%$ with the key switch in "cup" (normal) position.

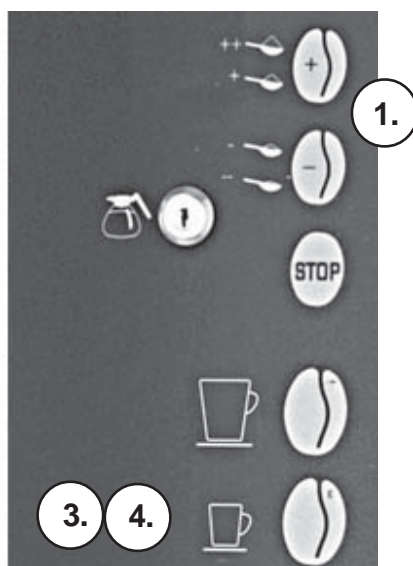

1. **Push "+" and "-" button at the same time.**
After 4 seconds the signal will go faster.
The display shows: **"Easy access" "strength 1 100%"**
2. Choose the drink you want to change by pushing "+" or "-" button.
3. Push button for drink 2.
The display shows: for example. Volume 4 and"
Blinking 100%"
Change by pushing "+" or "-" button.
4. Push button for drink 2 to confirm the change.
Press "stop" to go back to user mode.

The machine is equipped with following safety functions

1. Indication of door
Door not closed
The display shows; "Door open" **"Door open"**
2. When machine is not in use:
Valves are blocked.

10. Failure messages.

Failure messages which can mostly be corrected without any help from service company

1. The display shows; " Blocked" "Water level low"
**Please check incoming water connection
Turn off the machine with the main switch
wait for 10 sec. and turn on again.** **"Blocked"**
2. The display shows normal: but no drink is coming.
Possible cause of failure:
Mechanical stop in the ingredients canisters.

**Measure: Try to find the cause of failure. Clean the mixer system
and try again.**

11. Storage / Transport.

Transport and no use in long time.

1. Turn off the switch, pull out the plug and close incoming water tube.
2. Empty the water tank.
3. Keep machine free from frost.

Long machine storage at temperatures below 0°C (zero degrees celsius) can cause damage of the machine. Total emptying of water is recommended.

12. Installation of coin mechanism.

Installation of coin mechanism for freshbrew machines CQ.

IMPORTANT: Installation must be done of an authorized technician.

1. Assemble coin mec and connect to display-card, placed inside door.
(see fig. 10).
(Connect with the enclosed cable (A). Make sure that power is off.

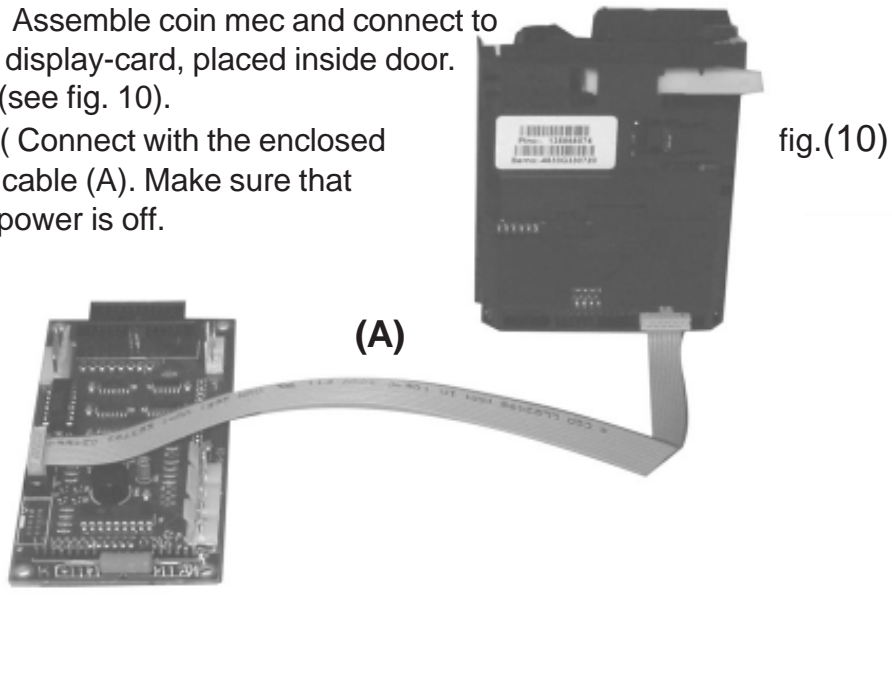
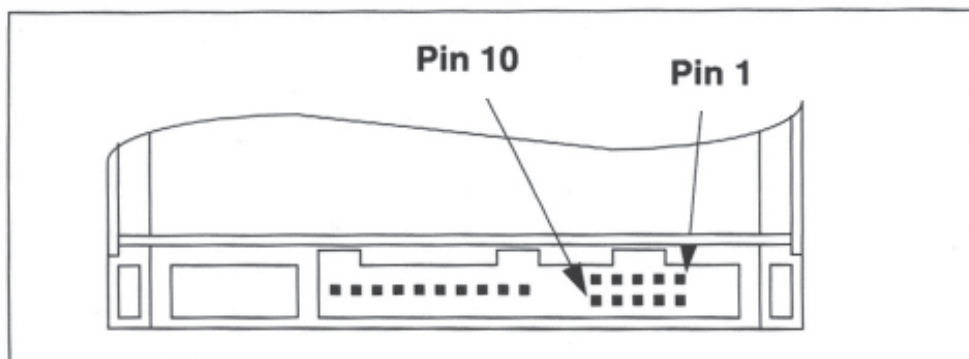

fig.(10)



Connection



Connection placement; Version 212

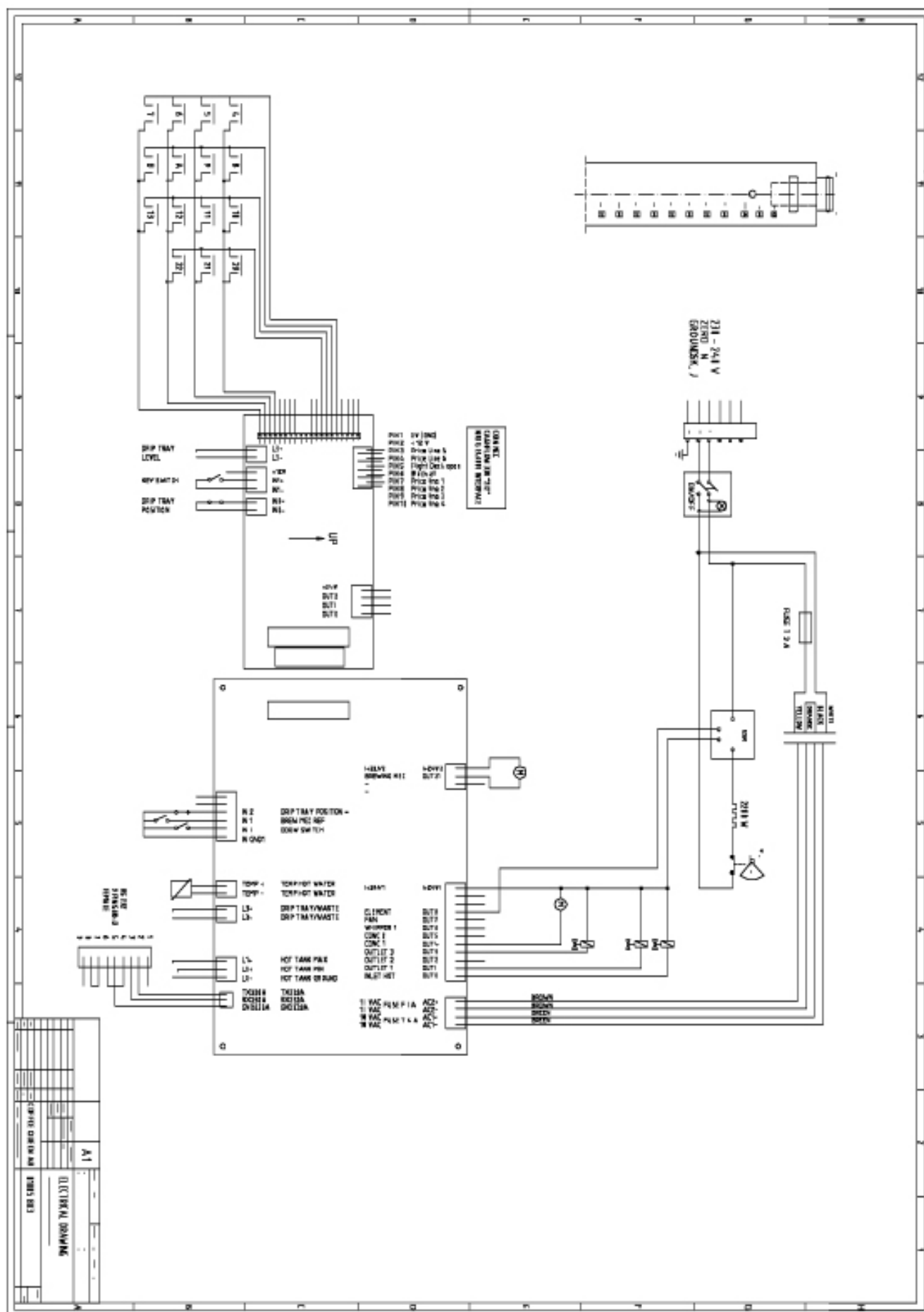

Mocca BTB



**FOR SERVICE
please contact**

Your retail dealer

.....

.....

.....

CREM International AB

Box 960, 671 29 ARVIKA, Sweden

Tel: +46 (0)570-477 00, Fax: +46 (0)570-47719

E-mail: info.se@creminternational.com www.creminternational.com

Art. nr/Art. no. 1730048