

Register your product and get support at  
[www.philips.com/welcome](http://www.philips.com/welcome)

MCD1065



---

User manual

1

使用手冊

23

---

**PHILIPS**

# Contents

---

<b>1 Important</b>	2
Safety	2
Notice	4

---

<b>2 Your Micro Music System</b>	5
Feature introduction	5
What's in the box	6
Overview of the main unit	6
Overview of remote control	7

---

<b>3 Before use</b>	8
Place the unit	8
Connect	8

---

<b>4 Get started</b>	9
Prepare the remote control	9
Turn on	9
Auto install radio stations	10
Find the correct video input channel	11
Select the correct TV system	11
Select a language for on-screen display	11

---

<b>5 Play disc/USB</b>	11
Basic operation	11
Play a disc	11
Play recorded files	12
Control the play	12
Picture view options	13
Play slideshow and music simultaneously	14
Adjust sound	14

---

<b>6 Listen to radio</b>	15
Tune to a radio station	15
Program radio stations automatically	15
Program radio stations manually	15
Select a preset radio station	15

---

<b>7 Setup</b>	16
General setup	16
Video setup	16
Audio setup	16
Preference setup	17

---

<b>8 Other features</b>	17
Set the timer	17
Set the sleep timer	18
Play from an external device	18
Headphone	18

---

<b>9 Product information</b>	19
Specifications	19
Supported disc formats	20
USB playability information	20
Maintenance	21

---

<b>10 Troubleshooting</b>	21
---------------------------	----

# 1 Important

---

## Safety

---

### Know these safety symbols



This 'bolt of lightning' indicates uninsulated material within your unit may cause an electrical shock. For the safety of everyone in your household, please do not remove product covering.

The 'exclamation point' calls attention to features for which you should read the enclosed literature closely to prevent operating and maintenance problems.

**WARNING:** To reduce the risk of fire or electric shock, this apparatus should not be exposed to rain or moisture and objects filled with liquids, such as vases, should not be placed on this apparatus.

**CAUTION:** To prevent electric shock, match wide blade of plug to wide slot, fully insert.

---

### Important Safety Instructions

- ① Read these instructions.
- ② Keep these instructions.
- ③ Heed all warnings.

- ④ Follow all instructions.
- ⑤ Do not use this apparatus near water.
- ⑥ Clean only with dry cloth.
- ⑦ Do not block any ventilation openings. Install in accordance with the manufacturer's instructions.
- ⑧ Do not install near any heat sources such as radiators, heat registers, stoves, or other apparatus (including amplifiers) that produce heat.
- ⑨ Protect the power cord from being walked on or pinched, particularly at plugs, convenience receptacles, and the point where they exit from the apparatus.
- ⑩ Only use attachments/accessories specified by the manufacturer.
- ⑪ Use only with the cart, stand, tripod, bracket, or table specified by the manufacturer or sold with the apparatus. When a cart is used, use caution when moving the cart/apparatus combination to avoid injury from tip-over.



- ⑫ Unplug this apparatus during lightning storms or when unused for long periods of time.
- ⑬ Refer all servicing to qualified service personnel. Servicing is required when the apparatus has been damaged in any way, such as power-supply cord or plug is damaged, liquid has been spilled or objects have fallen into the apparatus, the apparatus has been exposed to rain or moisture, does not operate normally, or has been dropped.

**14 Battery usage CAUTION – To prevent battery leakage which may result in bodily injury, property damage, or damage to the unit:**

- Install all batteries correctly, + and - as marked on the unit.
- Do not mix batteries (old and new or carbon and alkaline, etc.).
- Remove batteries when the unit is not used for a long time.
- Batteries (battery pack or batteries installed) shall not be exposed to excessive heat such as sunshine, fire or the like.

**15 Apparatus shall not be exposed to dripping or splashing.**

**16 Do not place any sources of danger on the apparatus (e.g. liquid filled objects, lighted candles).**

**17 Where the MAINS plug or an appliance coupler is used as the disconnect device, the disconnect device shall remain readily operable.**



**Warning**

- Never remove the casing of this unit.
- Never lubricate any part of this unit.
- Place this unit on a flat, hard and stable surface.
- Never place this unit on other electrical equipment.
- Only use this unit indoors. Keep this unit away from water, moisture and liquid-filled objects.
- Keep this unit away from direct sunlight, naked flames or heat.
- Never look into the laser beam inside the unit.



**Caution**

- Use of controls or adjustments or performance of procedures other than herein may result in hazardous radiation exposure or other unsafe operation.

produce sounds in decibel ranges that may cause hearing loss for a normal person, even for exposure less than a minute. The higher decibel ranges are offered for those that may have already experienced some hearing loss.

- Sound can be deceiving. Over time your hearing 'comfort level' adapts to higher volumes of sound. So after prolonged listening, what sounds 'normal' can actually be loud and harmful to your hearing. To guard against this, set your volume to a safe level before your hearing adapts and leave it there.

**To establish a safe volume level:**

- Set your volume control at a low setting.
- Slowly increase the sound until you can hear it comfortably and clearly, without distortion.

**Listen for reasonable periods of time:**

- Prolonged exposure to sound, even at normally 'safe' levels, can also cause hearing loss.
- Be sure to use your equipment reasonably and take appropriate breaks.

**Be sure to observe the following guidelines when using your headphones.**

- Listen at reasonable volumes for reasonable periods of time.
- Be careful not to adjust the volume as your hearing adapts.
- Do not turn up the volume so high that you can't hear what's around you.
- You should use caution or temporarily discontinue use in potentially hazardous situations. Do not use headphones while operating a motorized vehicle, cycling, skateboarding, etc.; it may create a traffic hazard and is illegal in many areas.

## Hearing safety

**Listen at a moderate volume.**

- Using headphones at a high volume can impair your hearing. This product can

---

## Notice

Any changes or modifications made to this device that are not expressly approved by Philips Consumer Lifestyle may void the user's authority to operate the equipment.



This product complies with the radio interference requirements of the European Community.



Your product is designed and manufactured with high quality materials and components, which can be recycled and reused.



When this crossed-out wheeled bin symbol is attached to a product it means that the product is covered by the European Directive 2002/96/EC.

Please inform yourself about the local separate collection system for electrical and electronic products.

Please act according to your local rules and do not dispose of your old products with your normal household waste. Correct disposal of your old product helps to prevent potential negative consequences for the environment and human health.



Your product contains batteries covered by the European Directive 2006/66/EC, which cannot be disposed with normal household waste. Please inform yourself about the local

rules on separate collection of batteries because correct disposal helps to prevent negative consequences for the environmental and human health.

### Environmental information

All unnecessary packaging has been omitted. We have tried to make the packaging easy to separate into three materials: cardboard (box), polystyrene foam (buffer) and polyethylene (bags, protective foam sheet.)

Your system consists of materials which can be recycled and reused if disassembled by a specialized company. Please observe the local regulations regarding the disposal of packaging materials, exhausted batteries and old equipment.

---

### Copyright notice



This item incorporates copy protection technology that is protected by U.S. patents and other intellectual property rights of Rovi Corporation. Reverse engineering and disassembly are prohibited.

---

### Trademark notice



Manufactured under license from Dolby Laboratories.

"Dolby" and the double-D symbol are trademarks of Dolby Laboratories.



Windows Media and the Windows logo are trademarks, or registered trademarks of Microsoft Corporation in the United States and/or other countries.



'DVD Video' is a trademark of DVD Format/ Logo Licensing Corporation.



DivX<sup>®</sup>, DivX Ultra<sup>®</sup>, DivX Certified<sup>®</sup> and associated logos are trademarks of Rovi Corporation or its subsidiaries and are used under license.

DivX Ultra<sup>®</sup> Certified to play DivX<sup>®</sup> video with advanced features and premium content.

**ABOUT DIVX VIDEO:** DivX<sup>®</sup> is a digital video format created by DivX, LLC, a subsidiary of Rovi Corporation. This is an official DivX Certified<sup>®</sup> device that plays DivX video. Visit [divx.com](http://divx.com) for more information and software tools to convert your files into DivX videos.

**ABOUT DIVX VIDEO-ON-DEMAND:** This DivX Certified<sup>®</sup> device must be registered in order to play purchased DivX Video-on-Demand (VOD) movies. To obtain your registration code, locate the DivX VOD section in your device setup menu. Go to [vod.divx.com](http://vod.divx.com) for more information on how to complete your registration.

This apparatus includes this label:



#### Note

- The type plate is located at the rear of the apparatus.

## 2 Your Micro Music System

Congratulations on your purchase, and welcome to Philips! To fully benefit from the support that Philips offers, register your product at [www.philips.com/welcome](http://www.philips.com/welcome).

If you contact Philips, you will be asked for the model and serial number of this apparatus. The model number and serial number are on the rear of the apparatus. Write the numbers here:

Model No. \_\_\_\_\_

Serial No. \_\_\_\_\_

### Feature introduction

This unit can play videos, audios, and display pictures from discs and USB storage devices.

For the details of supported media, refer to "Specifications".



---

## What's in the box

Check and identify the contents of your package:

- Main unit
- 2 x Speakers
- Power cord
- Remote control with 2 AAA batteries
- 1 x Video cable
- User manual
- Quick start guide

---

## Overview of the main unit

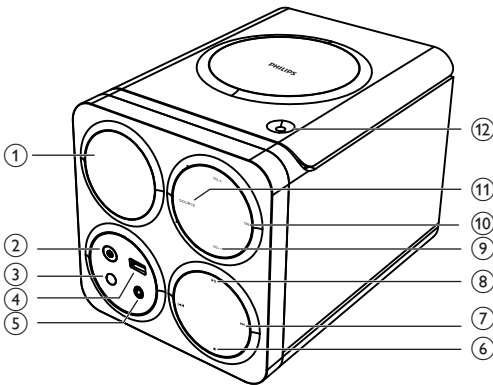

**① Display panel**

- Show current status.

**② **

- Turn on the unit, or switch to standby mode, or switch to Eco Power standby.

**③ Remote sensor**

**④ **

- Connector for a USB device.

**⑤ MP3 LINK**

- Connector (3.5mm) for an external audio device.

**⑥ **

- Stop play or erase a program.

**⑦ **

- Skip to the previous/next track.
- Search within a track.
- Tune to a radio station.

**⑧ **

- Start or pause play.

**⑨ VOL +/-**

- Adjust volume.
- Adjust time.

**⑩ DBB**

- Turn the dynamic bass enhancement on or off.
- Select a preset sound effect.

**⑪ SOURCE**

- Select a source: Disc, USB, tuner, or MP3 link.

**⑫ **

- Open or close the disc compartment.

## Overview of remote control

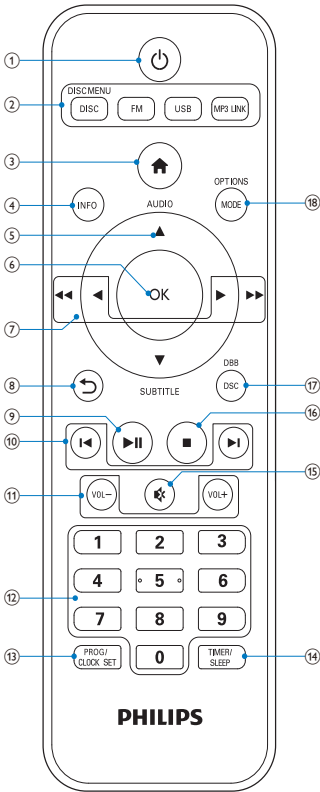

- ① **⏻**
  - Switch the micro system on/off.
  - Switch to standby mode or Eco Power standby.
- ② **DISC/DISC MENU/FM/USB/MP3 LINK**
  - Select the source.
  - Access the main menu of the system.
- ③ **🏠**
  - Access the home menu.
- ④ **INFO**
  - Show the disk information such as title, chapter, subtitle, time elapsed, total time etc.
- ⑤ **▲AUDIO / ▼SUBTITLE**
  - For menus: navigate up/down.
  - Invert a picture.
  - **▲AUDIO**: Toggle between stereo and mono.
- ⑥ **OK**
  - Confirm a selection.
- ⑦ **◀▶ / ◀◀▶▶**
  - Search in a track or disc.
  - Fast backward or forward.
  - For menus, navigate left/right.
  - Rotate a picture.
  - Select a preset radio station.
- ⑧ **↶**
  - Return to a previous display menu.
- ⑨ **▶▶**
  - Start, pause or resume play.
- ⑩ **◀◀ / ▶▶**
  - Skip to the previous/next track, title, or file.
  - Select a programmed radio station.
- ⑪ **VOL +/-**
  - Adjust the volume.
- ⑫ **Numeric buttons**
  - Select a title/chapter/track to play.
- ⑬ **PROG/CLOCK SET**
  - Program radio stations.
  - Set clock.
- ⑭ **TIMER/SLEEP**
  - Set sleep timer.
  - Set alarm timer.
- ⑮ **🔇**
  - Mute.
- ⑯ **■**
  - Stop play.
  - Erase a programmed radio station.
  - Activate/deactivate the demonstration mode.
- ⑰ **DSC/DBB**
  - Select a preset sound setting.
  - Turn on or off dynamic bass enhancement.
- ⑱ **MODE/OPTIONS**
  - Select repeat play or random play.
  - Accesses options relating to the current activity or selection.



# 3 Before use

## Place the unit

### Note

- Risk of overheating! Never install this apparatus in a confined space. Always leave a space of at least 4 inches around this apparatus for ventilation. Ensure curtains or other objects never cover the ventilation slots on this apparatus.
- Place this unit on a flat, hard, and stable surface.
- Never place this unit in an enclosed cabinet, nor on any other electrical equipment.
- Do not insert any object other than indicated into ventilation openings nor other openings.
- Install this unit near the AC outlet where the AC power plug can be easily reached.
- To avoid magnetic interference or unwanted noise, never place the main unit and speakers too close to any radiation devices.

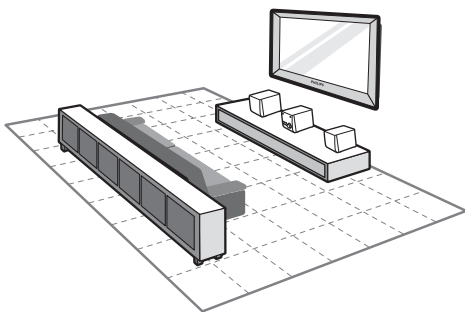

- 1 Place the unit near to the TV.
- 2 Place the speakers at a suitable distance from the TV and at an angle of approximately 45 degrees from the listening position.

## Connect

### Connect speakers

#### Note

- For optimal sound, use the supplied speakers only.
- Connect only speakers with impedance that is the same or higher than the supplied speakers. Refer to the Specifications section of this manual.

Insert the speaker wires completely into the speaker input sockets on the back of the unit.

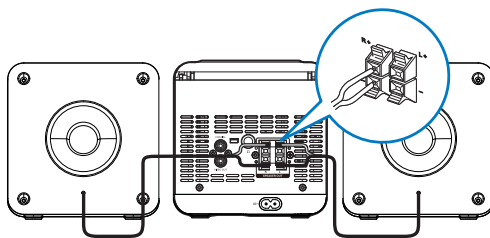

### Connect TV

#### Connect through composite video

Connect the supplied composite video cable to:

- the **VIDEO OUT** socket on this unit.
- the video input socket on the TV.

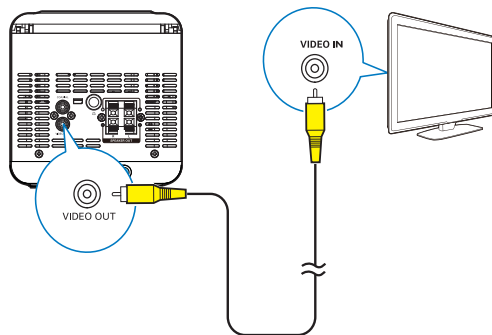

## Connect audio from TV or other devices

### Connect audio through a digital coaxial cable

Connect a coaxial cable to:

- **COAXIAL** jack on this product.
- the **COAXIAL/DIGITAL** input jack on the TV or other device.

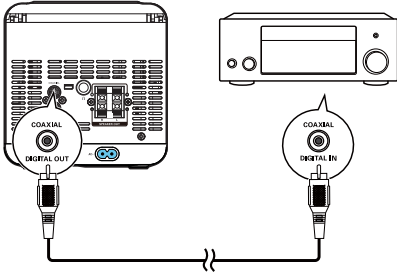

## Connect power



### Caution

- Risk of product damage! Make sure that the power supply voltage corresponds to the voltage printed on the rear of the main unit.
- Before connecting the AC cord, make sure that you have completed all other connections.



### Note

- The type plate is located on the rear of the main unit.

- 1 Connect the power cord to the **AC~** jack on the main unit.
- 2 Connect the power plug to the wall outlet.

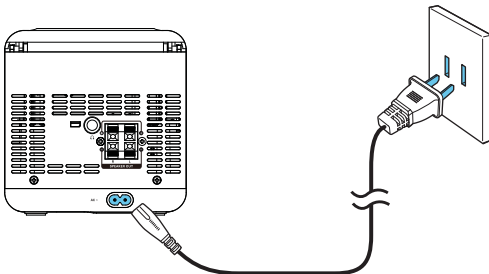

# 4 Get started

## Prepare the remote control



### Caution

- Risk of explosion! Keep batteries away from heat, sunshine, or fire. Never discard batteries in fire.

To insert the remote control battery:

- 1 Open the battery compartment.
- 2 Insert 2 AAA batteries with correct polarity (+/-) as indicated.
- 3 Close the battery compartment.

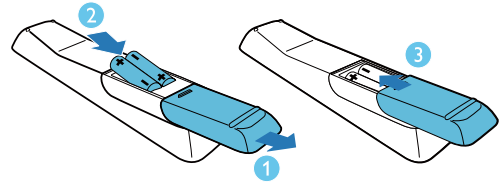

### Note

- If you are not going to use the remote control for a long time, remove the batteries.
- Do not use old and new or different types of batteries in combination.
- Batteries contain chemical substances, so they should be disposed of properly.

## Turn on

Press .

- ↳ The unit switches to the last selected source.

---

## Switch to standby

When the unit is turned on, press **⏻** to switch the unit to standby.

- In standby, press and hold **⏻** over three seconds to switch from normal standby to Eco power standby or vice versa.
- ↳ In normal standby, the clock (if set) appears on the display panel.
- ↳ In Eco power standby, the backlight on the display panel turns off.

### Note

- If no source is played within 15 minutes, the unit switches to standby mode.
- If no operation is performed within 15 minutes in standby mode, the unit switches to Eco-power standby mode.
- Press **⏻** to switch the unit to the last source when it was turned off.

---

## Demonstrate features

In the standby mode, press **■**.

- ↳ **[WELCOME TO PHILIPS]** (welcome to Philips) scrolls on the display.
- ↳ **[DEMO ON]** (demo on) scrolls on the display.
- ↳ The feature names are displayed one by one.
- To exit the feature demonstration, press **■** again.
- ↳ **[DEMO OFF]** (demo off) scrolls on the display.

---

## Set clock

### Note

- You can set the clock in standby mode only.

- 1 Press **⏻** to switch the unit to standby.
- 2 Make sure that **--:--** (or clock) is displayed.
- 3 Press and hold **PROG/CLOCK SET** to activate the clock setting mode.
  - ↳ **[CLOCK SET]** (clock set) is displayed.
  - ↳ The 12 hour or 24 hour format is displayed.
- 4 Press **▲ / ▼** or **VOL -/+** to select 12 hour or 24 hour format.
- 5 Press **PROG/CLOCK SET**.
  - ↳ The hour digits begin to blink.
- 6 Press **▲ / ▼** or **VOL -/+** to set the hour.
- 7 Press **PROG/CLOCK SET**.
  - ↳ The minute digits begin to blink.
- 8 Press **▲ / ▼** or **VOL -/+** to set the minute.
- 9 Press **PROG/CLOCK SET** to confirm.

### Note

- To exit clock setting mode without storing, press **■**.
- If no button is pressed in 90 seconds, the system exits clock setting mode automatically.

---

## Auto install radio stations

When you connect power and no radio stations are stored, the unit automatically begins to store radio stations.

- 1 Connect the unit to the power supply.
  - ↳ **[AUTO INSTALL - PRESS PLAY-STOP CANCEL]** (press **▶||** to start automatic installation, or press **■** to cancel) is displayed.
- 2 Press **▶||** on the main unit to start installation.
  - ↳ The unit automatically stores radio stations with sufficient signal strength.

- ↳ When all the available radio stations are stored, the first preset radio station is broadcast automatically.

## Find the correct video input channel

- 1 Turn on your unit.
- 2 Press **DISC** to select the disc source.
  - Turn on the TV and switch to the correct video-in channel.

### Note

- See the user manual of your TV for how to switch between video-in channels.

## Select the correct TV system

This unit is compatible with both NTSC and PAL. If the picture is abnormally displayed with the default setting, select a TV system that matches your TV. (Refer to "Setup" > "Video Setup" > [TV System] for details)

## Select a language for on-screen display

English is the default language options for this setting. (See "Setup" > "General Setup" > [OSD Language] for details)

# 5 Play disc/USB

### ! Caution

- Risk of damage to the unit! During play, never move the unit.
- Never put any object other than a disc into the disc compartment.
- Never look at the laser beam inside the unit.
- Never play discs with accessories such as disc stabilizer rings or disc treatment sheets.

## Basic operation

The listed operations are applicable for all supported media.

Function	Action
Stop play	Press <b>■</b> .
Pause or resume play	Press <b>▶  </b> .
Skip to the previous/next title, chapter, track, or file	Press <b>◀ </b> / <b> ▶</b> .

## Play a disc

- 1 Press **DISC** to select the disc source.
- 2 Press **▲** on the main unit to eject the disc tray.
- 3 Place a disc onto the disc tray with the printed side upward, and then press **▲**.
- 4 The unit starts playing automatically.
  - To start the play manually, press **▶||**.
  - To play a DVD that has a rating level higher than your setting, enter the 6-digit password (136900) first.

---

## Select a subtitle language

You can select a subtitle language for a DVD or DivX (Ultra) video.

During play, press **SUBTITLE** repeatedly.

### Note

- For some DVDs, the language can only be changed from the disc menu. Press **DISC MENU** to access the menu.

---

## Play recored files

You can play DivX/MP3/WMA/JPEG files that are copied onto a CD-R/RW, recordable DVD, or USB storage device.

### Note

- You can only play DivX videos that are rented or purchased with DivX® registration code of this unit. (See "Setup" > "General setup" > [DivX(R) VOD Code])
- Subtitle files with the following file extensions (.srt, .smi, .sub, .ssa, .ass) are supported but not displayed in the file list.
- The subtitle filename has to be the same as the filename of the DivX video (the file extension excluded).
- The DivX video file and the subtitle files must be saved under the same directory.

---

## Connect a USB storage device

- 1 Press **USB** to select the source for USB storage device.
- 2 Insert the USB storage device.
  - ↳ The unit starts playing automatically.
  - ↳ The user interface is displayed.

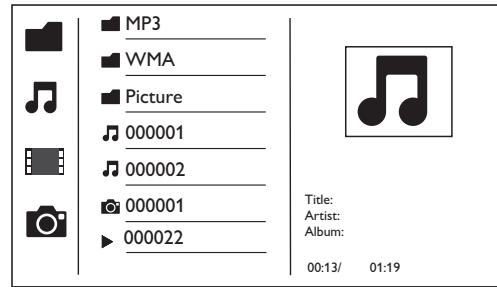

- On the left: the information source.
- In the middle: the folder and file list.
- On the right: the detailed file information, time elapsed, total time for the audio/video.

---

## Access a folder

- 1 Press **▲** / **▼** to highlight the selected folder name.
- 2 Highlight [**Previous**] and press **OK** back to the last-level menu.

---

## Play a file

- 1 Access the selected folder.
- 2 Press **▲** / **▼** to highlight the selected file name.
- 3 Press **OK** to confirm.
  - ↳ The selected file starts playing.
  - ↳ The unit stops playing automatically at the end of the last file of same category.

---

## Control the play

---

### Display play information

During play, press **INFO** to display play information on the TV.

---

## Search forward/backward

During video/audio play, press ◀◀ / ▶▶ repeatedly to select a search speed.

- To resume play at normal speed, press ▶▶.

---

## PBC menu

- 1 During video playback, press **OPTIONS** to access PBC menu.

PBC
Aspect ratio
Zoom
Angle
Repeat
Goto
Slow Forward
Slow Backward

- 2 Use ▲ / ▼ to highlight desired option.
  - [PBC]
  - [Aspect ratio]
  - [Zoom]
  - [Angle]
  - [Repeat]
  - [Goto]
  - [Slow Forward]
  - [Slow Backward]
- 3 Press ▶ to access sub options, and use ▲ / ▼ too select the right sub option.
- 4 Press **OK** to confirm the selection.

---

## Slow forward/backward play

- 1 During video play, press **OPTIONS** to access PBC menu.
- 2 Use ▲ / ▼ to highlight the slow forward/backward option.
- 3 Press ▶, and use ▲ / ▼ to select the right ratio.
- 4 Press **OK** to confirm the selection.

---

## Search by time or title/chapter/track number

- 1 During play, press **OPTIONS** to access **PBC** menu.
- 2 Use ▲ / ▼ to highlight [Goto].
- 3 Press ▶ to access menu.
- 4 Use ▲ / ▼ to highlight the title number, chapter number, track number, or time field.
- 5 Press **OK** to confirm.
  - ↳ the selected segment is displayed.
  - ↳ Play starts automatically.

---

## Picture view options

---

### Image playback control

- 1 Press **OPTIONS** to access image options.

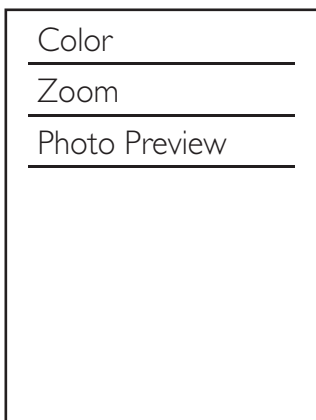

- 2 Use ▲ / ▼ to highlight the desired option.
  - [Color]
  - [Zoom]
  - [Photo Preview]
- 3 Press ►, and use ▲ / ▼ to select the sub options.
- 4 Press OK to confirm the selection.

## Rotate a picture

During play, press ◀ / ▶ to rotate the picture counterclockwise/clockwise.

## Play slideshow and music simultaneously

### Note

- Make sure that the USB storage device or the disc contains both WMA/MP3 files and JPEG photos.

- 1 Play a WMA/MP3 file.
- 2 Access a photo folder.
- 3 Select a photo file.
- 4 Press OK to start the slideshow.
  - The slideshow stops after all photos are displayed for one time.
  - To stop the slideshow, press ■

### Note

- This function is only available when you select the folder as the play source.
- This unit can only display digital camera pictures with JPEG-EXIF format, which is widely used in digital cameras. It cannot display Motion JPEG, nor pictures in formats other than JPEG. Sound clips associated with pictures cannot be displayed either.
- If the JPEG photo is not recorded with an "exif" type file, it is displayed as a "blue mountain" thumbnail picture.

## Adjust sound

During play, you can adjust volume through following operations.

Key	Function
VOL +/-	To increase/decrease the volume.
✱	To mute/restore sound.
DBB/DSC	To select your desired sound effect: [POP] (pop) [JAZZ] (jazz) [ROCK] (rock) [CLASSIC] (classic) [DBB] (DBB) [FLAT] (flat)

## 6 Listen to radio

### Tune to a radio station

- 1 Press **FM**.
- 2 Press and hold **◀◀ / ▶▶** on the unit over two seconds.
  - ↳ **[SEARCH]** (search) is displayed.
  - ↳ The radio tunes to a station with strong reception automatically.
- 3 Repeat step 2 to tune to more stations.
  - To tune to a weak station, press **◀◀ / ▶▶** repeatedly until you find optimal reception.
  - To achieve sound quality, press **OK** on remote control repeatedly to select stereo or mono sound.



#### Tip

- Position the antenna as far as possible from TV, VCR, or other radiation source.
- For optimal reception, fully extend and adjust the position of the antenna.

### Program radio stations automatically

You can program a maximum of 20 preset radio stations (FM).

- In FM mode, press and hold **PROG/CLOCK SET** over two seconds to activate automatic program mode.
- ↳ **[AUTO]** (auto) is displayed.
  - ↳ All available stations are programmed.
  - ↳ The first programmed radio station is broadcast automatically.

### Program radio stations manually

#### Note

- You can program a maximum of 20 preset radio stations.

- 1 Tune to a radio station.
- 2 Press **PROG/CLOCK SET** to activate program mode.
  - ↳ **[PROG]** (program) begins to blink.
- 3 Press **▲ / ▼** to allocate a number (1 to 20) to this radio station, and then press **PROG/CLOCK SET** to confirm.
- 4 Repeat the previous steps to program other stations.

#### Note

- To overwrite a programmed station, store another station in its place.

### Select a preset radio station

In FM mode, press **▲ / ▼** to select a preset number.





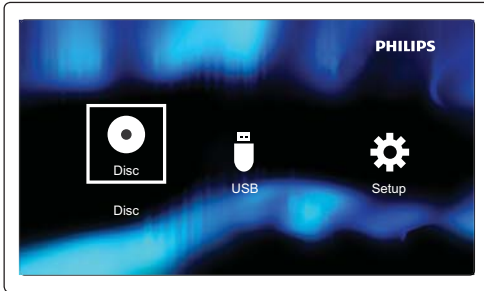

# 7 Setup



- 1 After you press the button .  
↳ The home menu appears.





- 2 Select  to access the system menu.

 General	Disc Lock
	OSD Language • English
 Video	Sleep Timer • Off
	DivX(R) VOD Code • Registration
 Audio	
 Preference	

## Note

- You cannot change a menu option that is grayed out.
- To return to the previous menu, press . To exit the menu, press  again.

## General setup



- 1 Press  button.
- 2 Select  to access the setup menu.
- 3 Select  to access the [GENERAL] options.
  - **[Disc Lock]**: Turn Disc lock.
  - **[OSD Language]**: Select an on-screen display menu language.

- **[Sleep Timer]**: Sets a sleep timer to switch the home theater to standby after a specific time.
- **[DivX(R) VOD Code]**: Get registration code of DivX Video On Demand Registration.



## Note

- If you select a language which is not available on a disc, this unit uses the default language of the disc.

## Video setup

- 1 Press  button.
- 2 Select  to access the setup menu.
- 3 Select  to access the [Video] options.
  - **[TV System]**: Selects a TV system that is compatible with the TV.
  - **[Aspect ratio]**: Set screen display format (Pan Scan, Letter Box, or Wide Screen).
  - **[Picture Setting]**: Select a predefined color setting or set the color manually.

## Audio setup

- 1 Press  button.
- 2 Select  to access the setup menu.
- 3 Select  to access the [Audio] options.
  - **[Analogue Output]**: Selects the analog audio setting based on the audio device that is connected through the analog audio jacks.
  - **[Digital Audio]**: Select audio formats supported by the connected device.
  - **[Sound Mode]**: Selects a preset sound effect to enhance the audio output.

- **[Night Mode]:** Select quiet or full dynamic sound. Night mode decreases the volume of loud sound and increases the volume of soft sound (such as speech).

## Preference setup

- 1 Press **⬆** button.
- 2 Select **⚙** to access the setup menu.
- 3 Select **⬆** to access the **[Preference]** options.
  - **[Audio]:** Select an audio language for video.
  - **[Subtitle]:** Select a subtitle language for video.
  - **[Disc Menu]:** Select a menu language for a video disc.
  - **[Parental Control]:** Set the rating level to a disc. Restrict access to discs that are encoded with ratings. These discs must be recorded with rating levels.
  - **[PBC]:** Display or skip the content menu for VCD and SVCD.
  - **[Password]:** Set or change a password to play a restricted disc.
  - **[DivX Subtitle]:** Select the language of the DivX.
  - **[Version Info]:** Display the software version.
  - **[Default]:** Reset the home theater to the default settings programmed at the factory.



### Note

- Ensure that the subtitle file has the exact same file name as the movie file. If for example the file name of the movie is 'Movie.avi', then you need to name the text file 'Movie.sub' or 'Movie.srt'.

## 8 Other features

### Set the timer

This unit can be used as a timer. The disc/tuner/USB is activated to play at a preset time.



### Note

- Make sure that you have set the clock correctly.

- 1 In standby mode, press and hold **TIMER/SLEEP** until **[TIMER SET]** (timer set) scrolls on the display.
  - ↳ **[SELECT SOURCE]** (select source) scrolls on the display.
- 2 Press **DISC**, or **USB**, or **TUNER** to select a source.
- 3 Press **TIMER/SLEEP** to confirm.
  - ↳ The clock digits are displayed and begin to blink.
- 4 Press **▲ / ▼** or **VOL -/+** to set hour, then press **TIMER/SLEEP** to confirm.
  - ↳ The minute digits are displayed and begin to blink.
- 5 Press **▲ / ▼** or **VOL -/+** to set minute, then press **TIMER/SLEEP** to confirm.
  - ↳ **[VOL]** (volume) is displayed and begins to blink.
- 6 Press **▲ / ▼** or **VOL -/+** to adjust volume, then press **TIMER/SLEEP** to confirm.
  - ↳ The timer is set and activated, and **⌚** is displayed.



### Tip

- Minimum volume and maximum volume can be set, volume 1 to volume 31 can be adjusted.

### To deactivate or re-activate an alarm timer

- 1 Press **⏻** to switch to standby mode.
- 2 Press **TIMER/SLEEP** repeatedly to activate or deactivate timer.
  - ↳ If timer is activated, **⌚** is displayed.
  - ↳ If timer is deactivated, **⌚** disappears.

#### Note

- In MP3 link mode, the timer cannot be set.
- If disc/USB source is selected and the audio cannot be played, tuner is activated automatically.

## Set the sleep timer

This unit can switch to standby automatically after a set period of time.

When the unit is turned on, press **TIMER/SLEEP** repeatedly to select a set period of time (in minutes):

- **[60 SLEEP]**
  - **[45 SLEEP]**
  - **[30 SLEEP]**
  - **[15 SLEEP]**
- ↳ When sleep timer is activated, **zZ** is displayed.

### To deactivate sleep timer

Press **TIMER/SLEEP** repeatedly until **[OFF SLEEP]** (off sleep) is displayed.

- ↳ When sleep timer is deactivated, **zZ** disappears.

## Play from an external device

You can also listen to an external audio device through this unit.

- 1 Press **MP3 LINK** to select the MP3 link source.

- 2 Connect MP3 link cable to:
  - the **MP3 LINK** connector (3.5mm) on the unit.
  - the headphone connector on an external device.
- 3 Start to play the device (see user manual of the device).

## Headphone

Plug headphones (not supplied) into the  connector on the unit to listen through the headphones.

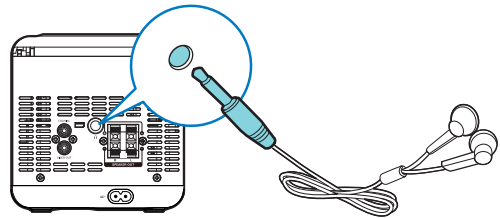

# 9 Product information

## Note

- Product information is subject to change without prior notice.

## Specifications

### Region Code

You can play DVD discs marked with the following region code.

DVD region code	Countries
 	Southeast Asia, South Korea, Taiwan, Hong Kong, Macau

### General information

AC power	AC 110-240 V~, 50/60 Hz
Operation Power Consumption	20 W
Eco Standby Power Consumption	<0.5 W
USB Direct	Version 2.0/1.1
Composite Video Output	1.0 Vp-p, 75 ohm
Coaxial Output	0.5 Vpp±0.1Vpp, 75 ohm
Dimensions	
- Main Unit (W x H x D)	140 x 143 x 210 mm
- Speaker box (W x H x D)	140 x 143 x 198 mm

Weight	
- Main Unit	0.86 kg
- Speaker box	0.72 kg x 2

### Amplifier

Max Output Power	2 x 12W (-1dB)
Frequency Response	40 Hz - 20 kHz, ±3 dB
Signal to Noise Ratio	>72 dBA
MP3 link input	500-1000 mV, RMS 20 kohm

### Disc

Laser Type	Semiconductor
Disc Diameter	12 cm/8 cm
Video Decoding	MPEG-1 / MPEG-2 / DivX
Video DAC	12 Bits
Signal System	PAL / NTSC
Video Format	4:3 / 16:9
Video S/N	> 57 dB
Audio DAC	24 Bits / 96 kHz
Total Harmonic Distortion	< 1% (1 kHz)
Frequency Response	4 Hz - 20 kHz (44.1 kHz) 4 Hz - 22 kHz (48 kHz) 4 Hz - 24 kHz (96 kHz)
S/N Ratio	> 82 dBA

### Tuner

Tuning Range	FM: 87.5 - 108 MHz
Tuning grid	50 KHz
FM sensitivity	
- Mono	26 dB
Total Harmonic Distortion	<2%
Signal to Noise Ratio	>55 dB
Number of presets	20 (FM)

---

## Speakers

---

Speaker Impedance	4 ohm
Speaker Driver	2 X 3" full range
Sensitivity	>82 dB/m/W

---

---

## Supported disc formats

### Supported video media:

- DivX Ultra
- Digital Video Discs (DVDs)
- Picture CD
- Video CDs (VCDs)
- Super-Video CDs (SVCDs)
- DVD-R/-RW
- MP3-CD
- CD-R/CD-RW
- DVD+R/+RW
- Compact Discs (CDs)

### Supported compression formats:

- MPEG1, MPEG2, DivX(DivX Ultra+addendum 1.0), XivD, AVI(MPG)
- JPEG file

### Supported audio media:

- CD
- CD-R/RW
- MP3-CD
- WMA-CD

### Supported following audio formats:

- Dolby Digital Plus/5.1
- PCM Audio
- MP3, MP3 ID3 Tag
- WMA, WMA Tags

### Unsupported formats:

- Files like \*.VMA,, \*.DLF, \*.M3U
- \*.PLS, \*.WAV

- Discs recorded in Joliet format
- MP3 Pro
- MPEG4, ASF

---

## USB playability information

### Compatible USB storage devices:

- USB flash memory (USB 2.0 or USB1.1)
- USB flash players (USB 2.0 or USB1.1)
- memory cards (requires an additional card reader to work with this system)

### Supported formats:

- USB or memory file format FAT12, FAT16, FAT32 (sector size: 512 bytes)
- MP3 bitrate (data rate): 32-320 Kbps and variable bitrate
- Directory nesting up to a maximum of 8 levels
- Number of albums/ folders: maximum 99
- Number of tracks/titles: maximum 999
- ID3 tag v2.0 or later
- File name in Unicode UTF8 (maximum length: 128 bytes)

### Unsupported formats:

- Empty albums: an empty album is an album that does not contain MP3 files, and is not shown in the display.
- Unsupported file formats are skipped. For example, Word documents (.doc) or MP3 files with extension .dlf are ignored and not played.
- AAC, WAV, PCM audio files
- DRM protected WMA files (\*.wav, \*.m4a, \*.m4p, \*.mp4, \*.aac)
- WMA files in Lossless format

## Maintenance

### Clean the cabinet

- Use a soft cloth slightly moistened with a mild detergent solution. Do not use a solution containing alcohol, spirits, ammonia or abrasives.

### Clean discs

- When a disc becomes dirty, clean it with a cleaning cloth. Wipe the disc from the centre out.

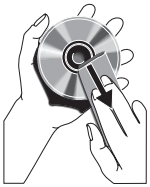

- Do not use solvents such as benzene, thinner, commercially available cleaners, or antistatic spray intended for analogue records.

### Clean the disc lens

- After prolonged use, dirt or dust may accumulate at the disc lens. To ensure good play quality, clean the disc lens with Philips CD lens cleaner or any commercially available cleaner. Follow the instructions supplied with cleaner.

## 10 Troubleshooting



### Warning

- Never remove the casing of this apparatus.

To keep the warranty valid, never try to repair the system yourself.

If you encounter problems when using this apparatus, check the following points before requesting service. If the problem remains unsolved, go to the Philips web site ([www.philips.com/welcome](http://www.philips.com/welcome)). When you contact Philips, ensure that the apparatus is nearby and the model number and serial number are available.

### No power

- Ensure that the AC power plug of the unit is connected properly.
- Ensure that there is power at the AC outlet.
- To save power, the unit switches to standby automatically 15 minutes after a play reaches the end and no control is operated.

### No disc detected

- Insert a disc.
- Check if the disc is inserted upside down.
- Wait until the moisture condensation at the lens has cleared.
- Replace or clean the disc.
- Use a finalized CD or correct format disc.

### No picture

- Check the video connection.
- Turn on the TV to the correct Video-In channel.

### Black and white or distorted picture

- The disc does not match the TV color system standard (PAL/NTSC).
- Sometimes a slight picture distortion may appear. This is not a malfunction.
- Clean the disc.

**The aspect ratio of the TV screen cannot be changed even though you have set the TV display format.**

- The aspect ratio is fixed on the loaded DVD disc.
- The aspect ratio may not be changed for some TV systems.

**No sound**

- Adjust the volume.

**No response from the unit**

- Disconnect and reconnect the AC power plug, then turn on the unit again.

**Remote control does not work**

- Before pressing any function button, first select the correct source with the remote control instead of the main unit.
- Reduce the distance between the remote control and the unit.
- Insert the battery with its polarities (+/- signs) aligned as indicated.
- Replace the batteries.
- Aim the remote control directly at the sensor on the front of the unit.

**No disc detected**

- Insert a disc.
- Check if the disc is inserted with the print side facing inward.
- Wait until the moisture condensation at the lens has cleared.
- Replace or clean the disc.
- Use a finalized CD or correct format disc.

**DivX video files cannot be played.**

- Ensure that the DivX video file is complete.
- Ensure that the file extension is correct.
- Due to Digital Rights issue, the DRM-protected video files cannot be played through an analog video connection (e.g. composite, component and scart). Transfer the video content onto the Disc Media and play these files.

**Audio or subtitle languages cannot be set**

- The disc is not recorded with sound or subtitles in multiple languages.
- The audio or subtitle language setting is prohibited on the disc.

**Cannot display some files in USB device**

- The number of folders or files in the USB device has exceeded a certain limit. This phenomenon is not a malfunction.
- The formats of these files are not supported.

**USB device not supported**

- The USB device is incompatible with the unit. Try another one.

**Poor radio reception**

- Increase the distance between the unit and your TV or VCR.
- Fully extend and adjust the FM antenna.

**Timer does not work**

- Set the clock correctly.
- Switch on the timer.

**Clock/timer setting erased**

- Power has been interrupted or the power cord has been disconnected.
- Reset the clock/timer.



Specifications are subject to change without notice  
© 2012 Koninklijke Philips Electronics N.V.  
All rights reserved.

MCD1065\_98\_UM\_V1.2

